

EXHIBIT 'A'
LEGAL DESCRIPTION
TEMPORARY CONSTRUCTION EASEMENT

All that portion of Lot 63, as said parcel is shown on the map recorded in Book D of Maps, at Page 78, in the office of the El Dorado County Recorder, being a portion of the southwest quarter of Section 34, Township 10 North, Range 9 East, M.D.M., unincorporated area of the County of El Dorado, State of California, and more particularly described as follows:

That portion of said lot lying northerly of a curve concentric with and 10 feet southerly of the northerly boundary, and its westerly continuation, containing 767 sq. ft., more or less.

See attached Exhibit 'B'

END OF DESCRIPTION.

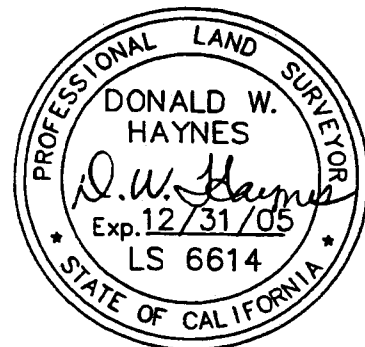

11-29-05

EXHIBIT 'B'

OXFORD
ROAD

WOOD
LANE

10'

D-78 LOT 63
083:243:03



SCALE : 1" = 40'

Drawing Name: J:\DCA\p\72343\dwg\Exhibits\083-243-02TCE.dwg. Layout Tab: Model, Last Saved: Mon, 28 Nov 2005 - 2:11pm, D:Haynes

EXHIBIT 'C'

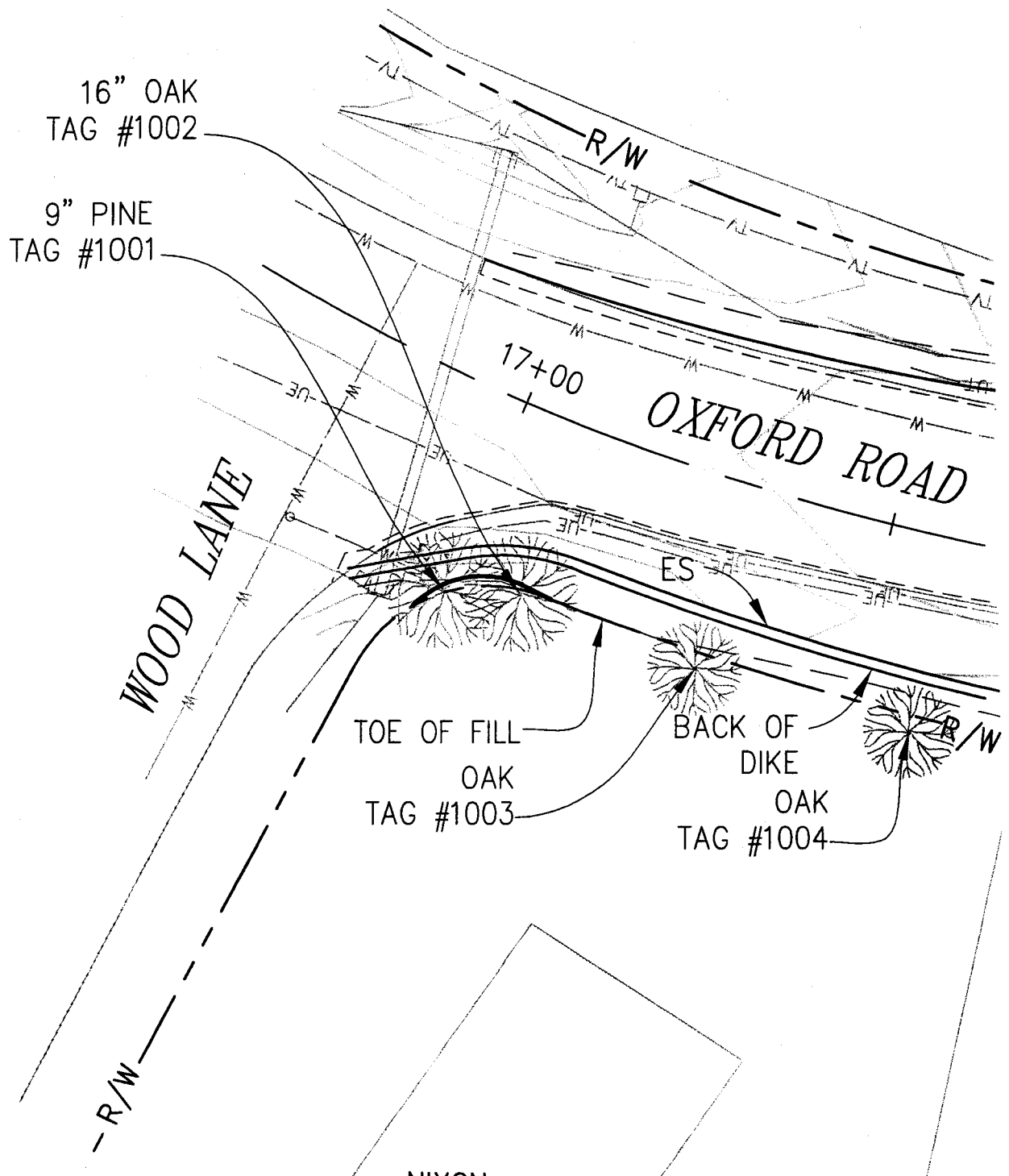

SCALE 1"=20'



NIXON
D-78 LOT 63
083:243:03