

**INDEX OF SHEETS**

SHEET	PLAN SHEET	TITLE
1		TITLE SHEET
2	CD-1	KEY MAP & SURVEY CONTROL
3	L-1	LAYOUT
4	L-2	LAYOUT
5	C-1	CONSTRUCTION DETAILS
6	C-2	CONSTRUCTION DETAILS
7	C-3	CONSTRUCTION DETAILS
8	G-1	CONTOUR GRADING
9	D-1	DRAINAGE DETAILS
10	D-2	DRAINAGE DETAILS
11	EC-1	EROSION CONTROL PLAN
12	F-1	FENCING PLAN
13	S-1	STRUCTURE GENERAL PLAN
14	S-2	STRUCTURE INDEX TD PLANS
15	S-3	STRUCTURE FOUNDATION PLAN
16	S-4	STRUCTURE ABUTMENT LAYOUT
17	S-5	STRUCTURE ABUTMENT DETAILS
18	S-6	STRUCTURE WINGWALL LAYOUT
19	S-7	STRUCTURE APPROACH RAILING DETAILS
20	S-8	STRUCTURE ROCK SLOPE PROTECTION
21	S-9	LOG OF TEST BORINGS

# COUNTY OF EL DORADO, CA DEPARTMENT OF TRANSPORTATION

## PROJECT PLANS FOR THE CONSTRUCTION OF NEW YORK CREEK TRAIL (EAST) PHASE 2

IN THE COUNTY OF EL DORADO, DISTRICT 1  
BETWEEN EL DORADO HILLS BOULEVARD AND NEW YORK CREEK IN EL DORADO HILLS, CA.  
To be supplemented with Standard Plans and Specifications dated 2010, including  
the 2010 Revised Standard Specifications, of the California Department of  
Transportation, unless otherwise noted.

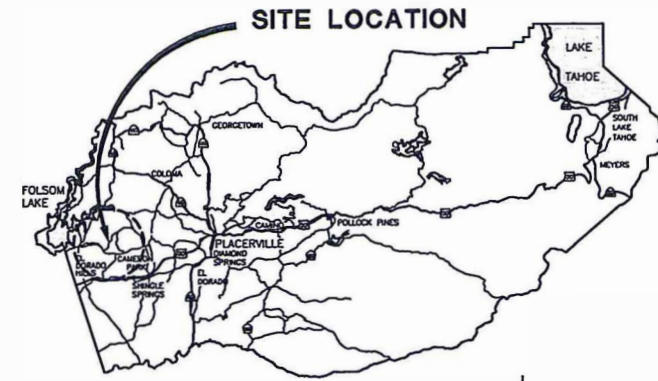

**VICINITY MAP**  
COUNTY OF EL DORADO

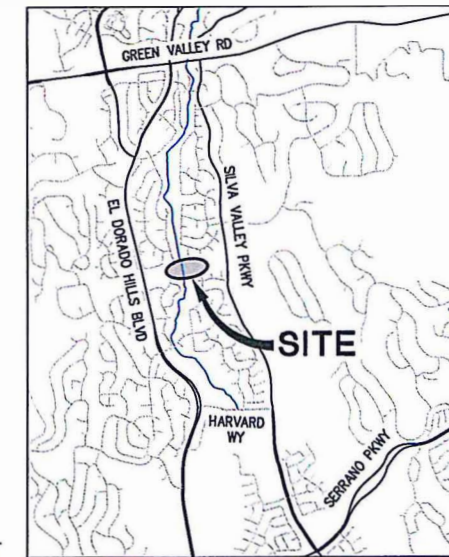

**LOCATION MAP**  
NOT TO SCALE

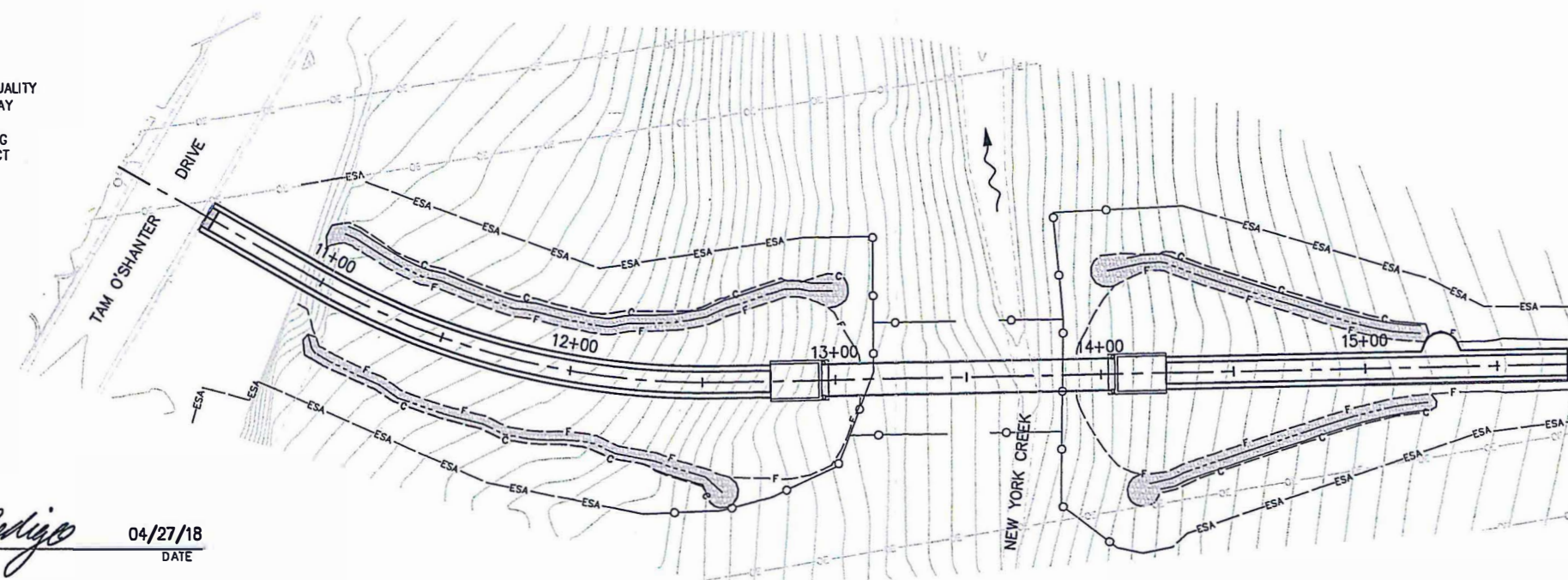

**SITE PLAN**  
SCALE: 1" = 30'

**FUNDING AGENCY**

CMAQ - CONGESTION MITIGATION AND AIR QUALITY IMPROVEMENT PROGRAM OF THE FEDERAL HIGHWAY AUTHORITY (FHWA) AND THE FEDERAL TRANSIT AUTHORITY (FTA) AS AUTHORIZED BY THE MOVING AHEAD FOR PROGRESS IN THE 21ST CENTURY ACT (MAP-21) ADMINISTERED BY CALTRANS

FEDERAL AID PROJECT  
CML 5925 (131)



*Monika Pedigo*  
SUBMITTED BY:  
CIVIL ENGINEER  
STATE OF CALIFORNIA NO. \_\_\_\_\_  
DATE: 04/27/18

CONTRACTOR'S LICENSE CLASSIFICATION: Bidders shall be properly licensed to perform the Work pursuant to the State Contractor's License Act (Business and Professions Code section 7000 et seq.) and shall possess a CLASS A LICENSE or equivalent combination of Classes required by the categories and type of Work included in the Contract Documents and Plans. If the Contractor possesses a Class A license instead of the equivalent combination of Classes required by the categories and type of work included in the Contract Documents and Plans, then the Contractor or a subcontractor must also possess a CLASS C27 "Landscaping Contractor" license. Failure of the successful Bidder to obtain proper and adequate licensing at the time bids are submitted shall constitute a failure to execute the Contract, and forfeiture as provided under that section.

**REVISIONS**

MARK	DATE	BY



**WARNING - PG&E AND SMUD OVERHEAD AND BELOW GROUND LINES ARE LIVE - ELECTROCUTION POTENTIAL.**

CONTRACTOR SHALL TAKE ALL APPROPRIATE SAFETY MEASURES WHEN WORKING NEAR, UNDER OR ABOVE LINES, INCLUDING PLACEMENT OF OSHA-REQUIRED WARNING SIGNAGE. ON-SITE PG&E AND SMUD INSPECTION REQUIRED WHEN WORKING NEAR PG&E AND SMUD FACILITIES. CONTRACTOR SHALL CONTACT PG&E AT (530) 889-3160 AND SMUD AT (916) 732-5905 OR (916) 799-5733 TO SCHEDULE INSPECTION. 72-HOUR ADVANCE NOTICE IS REQUIRED. CONTRACTOR SHALL PROTECT PG&E AND SMUD FACILITIES DURING CONSTRUCTION AND NOTIFY PG&E AND SMUD IMMEDIATELY IF FACILITIES ARE DAMAGED. ANY DAMAGE TO EXISTING FACILITIES SHALL BE REPAIRED AT THE CONTRACTOR'S EXPENSE.

**WARNING - EID BELOW GROUND LINES ARE ACTIVE.**

CONTRACTOR SHALL TAKE ALL APPROPRIATE SAFETY AND PROTECTION MEASURES WHEN WORKING NEAR E.I.D. FACILITIES. CONTRACTOR SHALL PROVIDE 72 HOUR ADVANCED NOTIFICATION TO E.I.D. SKIP HASKELL AT (530) 417-4230 OR MAIN LINE AT (530) 622-4513. CONTRACTOR SHALL PROTECT E.I.D. FACILITIES DURING CONSTRUCTION AND NOTIFY E.I.D. IMMEDIATELY IF FACILITIES ARE DAMAGED. ANY DAMAGE TO EXISTING FACILITIES SHALL BE REPAIRED AT THE CONTRACTORS EXPENSE.

**BOARD OF SUPERVISORS**

I	JOHN HIDAHL
II	SHIVA FRENTZEN
III	BRIAN VEERKAMP
IV	MICHAEL RANALLI
V	SUE NOVA

**COUNTY OF EL DORADO  
DEPARTMENT OF TRANSPORTATION**

(530) 621-5900  
2850 FAIRLANE CT  
PLACERVILLE, CA 95667

APPROVED BY: *[Signature]* DATE: 5/18/18  
APPROVED BY: *[Signature]* DATE: 05/16/18  
APPROVED BY: *[Signature]* DATE: 05/16/18

JOHN HASKELL, P.E. NO. C032426  
DEPUTY DIRECTOR, ENGINEERING

PW NO. 15-301B PROJECT NO. 7250 B

**NEW YORK CREEK TRAIL (EAST)  
PHASE 2**

**TITLE SHEET**

SH 1 of 21