



EL DORADO COUNTY

DEPARTMENT OF TRANSPORTATION

<http://www.edcgov.us/DOT/>

PLACERVILLE OFFICES:

MAIN OFFICE:
2850 Fairlane Court, Placerville, CA 95667
(530) 621-5900 / (530) 626-0387 Fax

CONSTRUCTION & MAINTENANCE:
2441 Headington Road, Placerville, CA 95667
(530) 642-4909 / (530) 642-0508 Fax

LAKE TAHOE OFFICES:

ENGINEERING:
924 B Emerald Bay Road, South Lake Tahoe, CA 96150
(530) 573-7900 / (530) 541-7049 Fax

MAINTENANCE:
1121 Shakori Drive, South Lake Tahoe, CA 96150
(530) 573-3180 / (530) 577-8402 Fax

DATE: March 19, 2020

TO: All Prospective Bidders

SUBJECT: **Addendum No. 1**
Hanks Exchange Road at Squaw Hollow Creek Bridge Replacement Project
Contract No. 3916, Project No. 77135

Submit proposals for this work with the understanding and full consideration of this Addendum No. 1. The revisions declared in this Addendum are essential parts of the Contract.

ITEM NO.	LOCATION, PAGE, OR DRAWING NO.	DESCRIPTION OF CHANGE
1.01	Notice to Bidders Page N-1	Bidders are instructed to replace the bid opening date and time for Notice to Bidders page N-1 from March 20, 2020 to <u>April 10, 2020 at 1:30 PM</u>
1.02	Special Provisions § 13-4.03C(1)	Bidders are instructed to add the following to Section 13-4.03C(1) of the Special Provisions: If critical equipment must be refueled within 300 feet of the waterway, spill prevention and countermeasures must be implemented to avoid spills. Please see note 9 of the 401 permit in Appendix B for specifications.
1.03	Agreement Page C-11	Bidders are instructed to replace page C-11 in the agreement with the attached page C-11 REV.
1.04	Agreement Page C-34 through C-83	Bidders are instructed to replace pages C-34 through C-83 in the agreement with the attached pages C-34 REV through C-74 REV.
1.05	Proposal Page P-3	Bidders are instructed to replace page P-3 with the attached page P-3 REV.
1.06	Plan Sheet TR-1 and TR-2	Bidders are instructed to replace sheets TR-1 and TR-2 of the plans with the attached sheets TR-1r and TR-2r.

Hanks Exchange Road at Squaw Hollow Creek Bridge Replacement Project
Contract No. 3916, Project No. 77135
Addendum No. 1

County of El Dorado
Page 1 of 2

Indicate receipt of this Addendum No. 1 by filling in the number of this Addendum in the space provided on the signature page of the Proposal. Holders who have already mailed their Proposal can contact Brian Franklin at 530-621-5311 (email: brian.franklin@edcgov.us) to arrange return of their Proposal. Inform all suppliers and subcontractors as necessary. The Community Development Services, Department of Transportation is only sending this Addendum by posting on QuestCDN's website at: <https://www.questcdn.com/>. You must be a Contract Documents holder on the Quest Plan Holder Report and comply with the requirements of this Addendum No. 1 when submitting your bid.

End of Addendum No. 1



Recommended by:
John Kahling, Deputy Director
Headington Engineering Unit

03/19/20
Date



Approved by:
Rafael Martinez, Director
Community Development Services
Department of Transportation

3/19/2020
Date

EXHIBIT A
 CONTRACTOR'S BID AND BID PRICE SCHEDULE
 HANKS EXCHANGE ROAD AT SQUAW HOLLOW CREEK BRIDGE REPLACEMENT
 CONTRACT NO. 3916, CIP NO. 77135

ITEM NO.	ITEM CODE	ITEM DESCRIPTION	UNIT OF MEASURE	ESTIMATED QUANTITY	UNIT PRICE (IN FIGURES)	ITEM TOTAL (IN FIGURES)
1	70030	LEAD COMPLIANCE PLAN	LS	1		
2	72007A	EXCAVATION SAFETY	LS	1		
3	80050	PROGRESS SCHEDULE (CRITICAL PATH METHOD)	LS	1		
4	100100	DEVELOP WATER SUPPLY	LS	1		
5	120090	CONSTRUCTION AREA SIGNS	LS	1		
6	120090A	CONSTRUCTION PROJECT INFORMATION SIGNS	LS	1		
7	120100	TRAFFIC CONTROL SYSTEM	LS	1		
8	128601A	PORTABLE TEMPORARY SIGNAL SYSTEM	LS	1		
9	128651A	PORTABLE CHANGEABLE MESSAGE SIGN	SWD	231		
10	129000	TEMPORARY RAILING (TYPE K)	LF	160		
11	129110	TEMPORARY CRASH CUSHION	EA	1		
12	130100	JOB SITE MANAGEMENT	LS	1		
13	130300	PREPARE STORM WATER POLLUTION PREVENTION PLAN	LS	1		
14	130310	RAIN EVENT ACTION PLAN	EA	5		
15	130330	STORM WATER ANNUAL REPORT	EA	1		
16	130580A	TEMPORARY STREAM DIVERSION	LS	1		
17	130680	TEMPORARY SILT FENCE	LF	550		
18	131103	WATER QUALITY SAMPLING AND ANALYSIS DAY	EA	5		
19	131104	WATER QUALITY MONITORING REPORT	EA	5		

Hanks Exchange Road at Squaw Hollow Creek Bridge Replacement
 Contract No. 3916, CIP No 77135
 February 25, 2020

County of El Dorado
 Agreement
 C-11 REV

**EXHIBIT E
FEDERAL WAGE RATES**

"General Decision Number:
CA20200007 03/13/2020

Superseded General Decision
Number: CA20190007

State: California

Construction Types: Building,
Heavy (Heavy and Dredging) and
Highway

Counties: Alpine, Amador, Butte,
Colusa, El Dorado, Glenn,
Lassen, Marin, Modoc, Napa,
Nevada, Placer, Plumas,
Sacramento,
Shasta, Sierra, Siskiyou, Solano,
Sonoma, Sutter, Tehama,
Trinity, Yolo and Yuba Counties
in California.

BUILDING CONSTRUCTION PROJECTS
(excluding Amador County only);
DREDGING CONSTRUCTION PROJECTS
(does not include hopper dredge
work); HEAVY CONSTRUCTION
PROJECTS (does not include water
well
drilling); AND HIGHWAY
CONSTRUCTION PROJECTS

Note: Under Executive Order (EO)
13658, an hourly minimum wage
of \$10.80 for calendar year 2020
applies to all contracts
subject to the Davis-Bacon Act
for which the contract is
awarded (and any solicitation was
issued) on or after January
1, 2015. If this contract is
covered by the EO, the contractor
must pay all workers in any
classification listed on this
wage
determination at least \$10.80 per
hour (or the applicable wage
rate listed on this wage
determination, if it is higher)
for
all hours spent performing on the
contract in calendar year
2020. If this contract is
covered by the EO and a

Hanks Exchange Road at Squaw Hollow Creek Bridge Replacement
Contract No. 3916, CIP No 77135
February 25, 2020

classification considered
necessary for performance of work
on
the contract does not appear on
this wage determination, the
contractor must pay workers in
that classification at least the
wage rate determined through the
conformance process set forth
in 29 CFR 5.5(a)(1)(ii) (or the
EO minimum wage rate, if it is
higher than the conformed wage
rate). The EO minimum wage rate
will be adjusted annually.
Please note that this EO applies
to
the above-mentioned types of
contracts entered into by the
federal government that are
subject to the Davis-Bacon Act
itself, but it does not apply to
contracts subject only to the
Davis-Bacon Related Acts,
including those set forth at 29
CFR
5.1(a)(2)-(60). Additional
information on contractor
requirements and worker
protections under the EO is
available
at www.dol.gov/whd/govcontracts.

Modification Number
Publication Date

	0
01/03/2020	1
01/24/2020	2
01/31/2020	3
03/06/2020	4
03/13/2020	
* ASBE0016-001	01/01/2020

AREA 1: MARIN, NAPA, SAN BENITO,
SAN FRANCISCO, SOLANO, &
SONOMA COUNTIES

AREA 2: ALPINE, AMADOR, BUTTE,
COLUSA, EL DORADO, GLENN,
MODOC, NEVADA, PLACER, PLUMAS,
SACRAMENTO, SHASTA, SIERRA,

County of El Dorado
Agreement
C-34 REV

SISKIYOU, SUTTER, TEHEMA,
TRINITY, YOLO, & YUBA COUNTIES

BOILERMAKER
(1) Marin & Solano
Counties.\$ 43.28 37.91
(2) Remaining
Counties.....\$ 39.68
35.71

Rates Fringes
Asbestos Workers/Insulator
(Includes the application of
all insulating materials,
Protective Coverings,
Coatings, and Finishes to all
types of mechanical systems)
Area
1.....\$ 71.16
23.39
Area
2.....\$ 54.26
23.39

BRCA0003-001 08/01/2019

Rates Fringes
MARBLE
FINISHER.....\$ 35.41
16.45

BRCA0003-004 05/01/2019

ASBE0016-007 01/01/2019
AREA 1 : ALPINE, AMADOR, BUTTE,
COLUSA, EL DORADO, GLENN,
LASSEN, MODOC, NEVADA, PLACER,
PLUMAS, SACRAMENTO, SHASTA,
SIERRA, SISKIYOU, SOLANO, SONOMA,
SUTTER, TEHAMA, TRINITY, YOLO
& YUBA COUNTIES

AREA 1: ALPINE, AMADOR, BUTTE,
COLUSA, EL DORADO, GLENN,
LASSEN, MODOC, NEVADA, PLACER,
PLUMAS, SACRAMENTO, SHASTA,
SIERRA, SUTTER, TEHAMA, YOLO AND
YUBA COUNTIES

AREA 2: MARIN, NAPA, SISKIYOU,
SOLANO, SONOMA AND TRINITY
COUNTIES

AREA 2: MARIN & NAPA COUNTIES

Rates Fringes
BRICKLAYER
AREA
1.....\$ 43.24
21.63
AREA
2.....\$ 45.92
26.70

Rates Fringes
Asbestos Removal
worker/hazardous material
handler (Includes
preparation, wetting,
stripping, removal,
scrapping, vacuuming, bagging
and disposing of all
insulation materials from
mechanical systems, whether
they contain asbestos or not)
AREA
1.....\$ 30.81
22.71
AREA
2.....\$ 36.53
9.27

SPECIALTY PAY:
(A) Underground work such as
tunnel work, sewer work,
manholes, catch basins, sewer
pipes and telephone conduit
shall be paid \$1.25 per hour
above the regular rate. Work
in direct contact with raw
sewage shall receive \$1.25 per
hour in addition to the above.
(B) Operating a saw or grinder
shall receive \$1.25 per hour
above the regular rate.
(C) Gunite nozzle person shall
receive \$1.25 per hour above
the regular rate.

BOIL0549-002 10/01/2016

Rates Fringes

Hanks Exchange Road at Squaw Hollow Creek Bridge Replacement
Contract No. 3916, CIP No 77135
February 25, 2020

County of El Dorado
Agreement
C-35 REV

 BRCA0003-008 07/01/2019

Rates	Fringes
TERRAZZO FINISHER.....	\$ 37.58
17.33	
TERRAZZO WORKER/SETTER.....	\$ 48.53
26.84	

 BRCA0003-010 04/01/2019

Rates	Fringes
TILE FINISHER Area	
1.....	\$ 27.31
14.75	
Area	
2.....	\$ 27.10
16.50	
Area	
3.....	\$ 29.94
16.38	
Area	
4.....	\$ 28.06
15.82	
Tile Layer Area	
1.....	\$ 45.51
17.64	
Area	
2.....	\$ 45.15
19.06	
Area	
3.....	\$ 49.90
19.16	
Area	
4.....	\$ 46.77
19.08	

AREA 1: Butte, Colusa, El
 Dorado, Glenn, Lassen, Modoc,
 Nevada, Placer, Plumas,
 Sacramento, Shasta, Sierra,
 Sutter,
 Tehema, Yolo, Yuba
 AREA 2: Alpine, Amador
 AREA 3: Marin, Napa, Solano,
 Siskiyou
 AREA 4: Sonoma

 Hanks Exchange Road at Squaw Hollow Creek Bridge Replacement
 Contract No. 3916, CIP No 77135
 February 25, 2020

BRCA0003-014 08/01/2019

Rates	Fringes
MARBLE MASON.....	\$ 49.42
27.86	

 CARP0034-001 07/01/2019

Rates	Fringes
Diver Assistant Tender, ROV	
Tender/Technician.....	\$ 49.75
33.40	
Diver standby.....	\$ 55.73
33.40	
Diver Tender.....	\$ 54.73
33.40	
Diver wet.....	\$ 99.27
33.40	
Manifold Operator (mixed gas).....	\$ 59.73
33.40	
Manifold Operator (Standby) .	\$ 54.73
33.40	

DEPTH PAY (Surface Diving):
 050 to 100 ft \$2.00 per foot
 101 to 150 ft \$3.00 per foot
 151 to 220 ft \$4.00 per foot
 221 ft.-deeper \$5.00 per foot

SATURATION DIVING:
 The standby rate shall apply until saturation starts. The saturation diving rate applies when divers are under pressure continuously until work task and decompression are complete. The diver rate shall be paid for all saturation hours.

DIVING IN ENCLOSURES:
 Where it is necessary for Divers to enter pipes or tunnels, or other enclosures where there is no vertical ascent, the

County of El Dorado
 Agreement
 C-36 REV

following premium shall be paid: Distance traveled from entrance 26 feet to 300 feet: \$1.00 per foot. When it is necessary for a diver to enter any pipe, tunnel or other enclosure less than 48" in height, the premium will be \$1.00 per foot.

WORK IN COMBINATION OF CLASSIFICATIONS:
 Employees working in any combination of classifications within the diving crew (except dive supervisor) in a shift are paid in the classification with the highest rate for that shift.

 CARP0034-003 07/01/2019

Rates	Fringes
Piledriver.....	
\$ 50.75	33.40

 CARP0035-001 08/01/2019

AREA 1: MARIN, NAPA, SOLANO & SONOMA

AREA 3: SACRAMENTO, WESTERN EL DORADO (Territory west of an including highway 49 and the territory inside the city limits of Placerville), WESTERN PLACER (Territory west of and including highway 49), & YOLO

AREA 4: ALPINE, BUTTE, COLUSA, EASTERN EL DORADO, GLENN, LASSEN, MODOC, NEVADA, EASTERN PLACER, PLUMAS, SHASTA, SIERRA, SISKIYOU, SUTTER, TEHAMA, TRINITY, & YUBA

Rates	Fringes
Drywall Installers/Lathers:	
Area	
1.....	\$ 50.50
30.64	

Hanks Exchange Road at Squaw Hollow Creek Bridge Replacement
 Contract No. 3916, CIP No 77135
 February 25, 2020

Area	
3.....	\$ 45.12
30.64	
Area	
4.....	\$ 43.77
30.64	
Drywall Stocker/Scrapper	
Area	
1.....	\$ 25.25
17.86	
Area	
3.....	\$ 22.56
17.86	
Area	
4.....	\$ 21.89
17.86	

CARP0035-009 07/01/2019	

Marin County

Rates	Fringes
CARPENTER	
Bridge Builder/Highway	
Carpenter.....	\$
50.50	30.20
Hardwood Floorlayer, Shingler, Power Saw Operator, Steel Scaffold & Steel Shoring Erector, Saw	
Filer.....	\$
50.65	30.20
Journeyman	
Carpenter.....	\$ 50.50
30.20	
Millwright.....	\$
50.60	31.79

CARP0035-010 07/01/2017	

AREA 1: Marin, Napa, Solano & Sonoma Counties

AREA 2: Monterey, San Benito and Santa Cruz

AREA 3: Alpine, Butte, Colusa, El Dorado, Glenn, Lassen, Modoc, Nevada, Placer, Plumas, Sacramento, Shasta, Sierra, Siskiyou, Sutter, Tehama, Trinity, Yolo & Yuba counties

County of El Dorado
 Agreement
 C-37 REV

Rates	Fringes
Modular Furniture Installer	
Area 1	
Installer	
I.....\$ 24.91	
19.63	
Installer	
II.....\$ 22.18	
20.42	
Lead	
Installer.....\$ 29.06	
20.92	
Master	
Installer.....\$ 33.28	
20.92	
Area 2	
Installer	
I.....\$ 22.96	
20.42	
Installer	
II.....\$ 20.01	
20.42	
Lead	
Installer.....\$ 25.93	
20.92	
Master	
Installer.....\$ 29.56	
20.92	
Area 3	
Installer	
I.....\$ 22.01	
20.42	
Installer	
II.....\$ 19.24	
20.42	
Lead	
Installer.....\$ 24.81	
20.92	
Master	
Installer.....\$ 31.83	
20.92	

 CARP0046-001 07/01/2019
 El Dorado (West), Placer (West),
 Sacramento and Yolo Counties

Rates	Fringes
Carpenters	
Bridge Builder/Highway	
Carpenter.....\$	
50.50	30.20

Hanks Exchange Road at Squaw Hollow Creek Bridge Replacement
Contract No. 3916, CIP No 77135
 February 25, 2020

Hardwood Floorlayer,
 Shingler, Power Saw
 Operator, Steel Scaffold &
 Steel Shoring Erector, Saw

Filer.....\$	
44.77	30.20
Journeyman	
Carpenter.....\$ 44.62	
30.20	
Millwright.....\$	
47.12	31.79

Footnote: Placer County (West)
 includes territory West of and
 including Highway 49 and El
 Dorado County (West) includes
 territory West of and including
 Highway 49 and territory
 inside the city limits of
 Placerville.

 CARP0046-002 07/01/2019
 Alpine, Colusa, El Dorado (East),
 Nevada, Placer (East),
 Sierra, Sutter and Yuba Counties

Rates	Fringes
Carpenters	
Bridge Builder/Highway	
Carpenter.....\$	
50.50	30.20
Hardwood Floorlayer, Shingler, Power Saw Operator, Steel Scaffold & Steel Shoring Erector, Saw	
Filer.....\$	
43.42	30.20
Journeyman	
Carpenter.....\$ 42.27	
30.20	
Millwright.....\$	
45.77	31.79

 CARP0152-003 07/01/2019
 Amador County

County of El Dorado
Agreement
 C-38 REV

Rates	Fringes
Carpenters Bridge Builder/Highway	
Carpenter.....\$	
50.50	30.20
	Hardwood Floorlayer, Shingler, Power Saw Operator, Steel Scaffold & Steel Shoring Erector, Saw
Filer.....\$	
43.42	30.20
	Journeyman
Carpenter.....\$ 43.27	
30.20	
Millwright.....\$	
45.77	31.79

CARP0180-001 07/01/2019	

Solano County

Rates	Fringes
Carpenters Bridge Builder/Highway	
Carpenter.....\$	
50.50	30.20
	Hardwood Floorlayer, Shingler, Power Saw Operator, Steel Scaffold & Steel Shoring Erector, Saw
Filer.....\$	
50.65	30.20
	Journeyman
Carpenter.....\$ 50.50	
30.20	
Millwright.....\$	
50.60	31.79

CARP0751-001 07/01/2019	

Napa and Sonoma Counties

Rates	Fringes
Carpenters Bridge Builder/Highway	

Hanks Exchange Road at Squaw Hollow Creek Bridge Replacement
Contract No. 3916, CIP No 77135
 February 25, 2020

Carpenter.....\$	
50.50	30.20
	Hardwood Floorlayer, Shingler, Power Saw Operator, Steel Scaffold & Steel Shoring Erector, Saw
Filer.....\$	
50.65	30.20
	Journeyman
Carpenter.....\$ 50.50	
30.20	
Millwright.....\$	
50.60	31.79

CARP1599-001 07/01/2019	

Butte, Glenn, Lassen, Modoc,
 Plumas, Shasta, Siskiyou, Tehama
 and Trinity Counties

Rates	Fringes
Carpenters Bridge Builder/Highway	
Carpenter.....\$	
50.50	30.20
	Hardwood Floorlayer, Shingler, Power Saw Operator, Steel Scaffold & Steel Shoring Erector, Saw
Filer.....\$	
43.42	30.20
	Journeyman
Carpenter.....\$ 43.27	
30.20	
Millwright.....\$	
45.77	31.79

ELEC0180-001 06/01/2019	

NAPA AND SOLANO COUNTIES

Rates	Fringes
CABLE SPLICER.....\$	
56.26	24.16
ELECTRICIAN.....	
\$ 50.01	23.98

County of El Dorado
Agreement
 C-39 REV

ELEC0180-003 12/01/2018

NAPA AND SOLANO COUNTIES

Rates	Fringses
Sound & Communications	
Installer.....\$	
38.42	19.70
Technician.....\$	
44.18	19.88

SCOPE OF WORK INCLUDES-
 SOUND & VOICE TRANSMISSION
 (Music, Intercom, Nurse Call,
 Telephone); FIRE ALARM SYSTEMS
 [excluding fire alarm work
 when installed in raceways
 (including wire and cable
 pulling) and when performed on
 new or major remodel
 building projects or jobs],
 TELEVISION & VIDEO SYSTEMS,
 SECURITY SYSTEMS, COMMUNICATIONS
 SYSTEMS that transmit or
 receive information and/or
 control
 systems that are intrinsic to
 the above.

EXCLUDES-
 Excludes all other data systems
 or multiple systems which
 include control function or
 power supply; excludes
 installation of raceway
 systems, line voltage work,
 industrial work, life-safety
 systems (all buildings having
 floors located more than 75'
 above the lowest floor level
 having building access);
 excludes energy management
 systems.

ELEC0340-002 02/01/2018

ALPINE, AMADOR, BUTTE, COLUSA, EL
DORADO, GLENN, LASSEN,
NEVADA, PLACER, PLUMAS,
SACRAMENTO, TRINITY, YOLO, YUBA
COUNTIES

Hanks Exchange Road at Squaw Hollow Creek Bridge Replacement
Contract No. 3916, CIP No 77135
February 25, 2020

Rates	Fringses
Communications System	
Sound & Communications	
Installer.....\$	
29.35	3%+15.35
Technician.....\$	
33.75	3%+15.35

SCOPE OF WORK
 Includes the installation
 testing, service and maintenance,
 of the following systems which
 utilize the transmission
 and/or transference of voice,
 sound, vision and digital for
 commercial, education, security
 and entertainment purposes
 for the following TV monitoring
 and surveillance,
 background-foreground music,
 intercom and telephone
 interconnect, inventory control
 systems, microwave
 transmission, multi-media,
 multiplex, nurse call system,
 radio page, school intercom and
 sound, burglar alarms, and
 low voltage master clock
 systems.

A. SOUND AND VOICE
 TRANSMISSION/TRANSFERENCE SYSTEMS
 Background foreground music
 Intercom and telephone
 interconnect systems, Telephone
 systems, Nurse call
 systems, Radio page systems,
 School intercom and sound
 systems, Burglar alarm systems,
 Low voltage master clock
 systems, Multi-media/multiplex
 systems, Sound and musical
 entertainment systems, RF
 systems, Antennas and Wave Guide.

B. FIRE ALARM SYSTEMS
 Installation, wire pulling and
 testing

C. TELEVISION AND VIDEO SYSTEMS
 Television monitoring and
 surveillance systems, Video
 security systems, Video

County of El Dorado
Agreement
C-40 REV

entertainment systems, Video educational systems, Microwave transmission systems, CATV and CCTV

D. SECURITY SYSTEMS
 Perimeter security systems
 Vibration sensor systems
 Card access systems Access control systems
 Sonar/infrared monitoring equipment

E. COMMUNICATIONS SYSTEMS THAT TRANSMIT OR RECEIVE INFORMATION AND/OR CONTROL SYSTEMS THAT ARE INTRINSIC TO THE ABOVE LISTED SYSTEMS
 SCADA (Supervisory Control and Data Acquisition) PCM (Pulse Code Modulation)
 Inventory Control Systems
 Digital Data Systems
 Broadband and Baseband and Carriers Point of Sale Systems VSAT Data Systems
 Data Communication Systems RF and Remote Control Systems Fiber Optic Data Systems WORK EXCLUDED
 Raceway systems are not covered (excluding Ladder-Rack for the purpose of the above listed systems). Chases and/or nipples (not to exceed 10 feet) may be installed on open wiring systems. Energy management systems. SCADA (Supervisory Control and Data Acquisition) when not intrinsic to the above listed systems (in the scope). Fire alarm systems when installed in raceways (including wire and cable pulling) shall be performed at the electrician wage rate, when either of the following two (2) conditions apply:
 1. The project involves new or major remodel building trades construction.
 2. The conductors for the fire alarm system are installed in conduit.

 ELEC0340-003 08/01/2018

Hanks Exchange Road at Squaw Hollow Creek Bridge Replacement
 Contract No. 3916, CIP No 77135
 February 25, 2020

ALPINE (West of Sierra Mt. Watershed), AMADOR, BUTTE, COLUSA,
 EL DORADO (West of Sierra Mt. Watershed), GLENN, LASSEN, NEVADA (West of Sierra Mt. Watershed), PLACER, PLUMAS, SACRAMENTO, SHASTA, SIERRA (West of Sierra Mt. Watershed), SUTTER, TEHAMA, TRINITY, YOLO & YUBA COUNTIES

Rates	Fringes
ELECTRICIAN	
Remaining	
area.....\$ 40.06	
28.54	
Sierra Army Depot,	
Herlong..\$ 48.83	18.54
Tunnel	
work.....\$ 41.01	
18.54	

CABLE SPLICER: Receives 110% of the Electrician basic hourly rate.

 ELEC0401-005 07/01/2019

ALPINE (east of the main watershed divide), EL DORADO (east of the main watershed divide), NEVADA (east of the main watershed), PLACER (east of the main watershed divide) and SIERRA (east of the main watershed divide) COUNTIES:

Rates	Fringes
ELECTRICIAN.....	
\$ 40.50	19.39

ELEC0551-004 06/01/2019	

MARIN AND SONOMA COUNTIES

Rates	Fringes
ELECTRICIAN.....	
\$ 51.40	22.83

County of El Dorado
 Agreement
 C-41 REV

 ELEC0551-005 12/01/2018

MARIN & SONOMA COUNTIES

Rates	Fringes
Sound & Communications	
Installer.....\$	
38.42	20.11
Technician.....\$	
44.18	20.29

SCOPE OF WORK INCLUDES-
 SOUND & VOICE TRANSMISSION
 (Music, Intercom, Nurse Call,
 Telephone); FIRE ALARM SYSTEMS
 [excluding fire alarm work
 when installed in raceways
 (including wire and cable
 pulling) and when performed on
 new or major remodel
 building projects or jobs],
 TELEVISION & VIDEO SYSTEMS,
 SECURITY SYSTEMS, COMMUNICATIONS
 SYSTEMS that transmit or
 receive information and/or
 control
 systems that are intrinsic to
 the above.

EXCLUDES-
 Excludes all other data systems
 or multiple systems which
 include control function or
 power supply; excludes
 installation of raceway
 systems, line voltage work,
 industrial work, life-safety
 systems (all buildings having
 floors located more than 75'
 above the lowest floor level
 having building access);
 excludes energy management
 systems.

 ELEC0659-006 01/01/2020

DEL NORTE, MODOC and SISKIYOU
 COUNTIES

Rates	Fringes
-------	---------

Hanks Exchange Road at Squaw Hollow Creek Bridge Replacement
Contract No. 3916, CIP No 77135
 February 25, 2020

ELECTRICIAN.....
 \$ 36.59 17.39

 ELEC0659-008 02/01/2019

DEL NORTE, MODOC & SISKIYOU
 COUNTIES

Rates	Fringes
Line Construction	
(1) Cable	
Splicer.....\$	59.09
20.22	
(2) Lineman, Pole Sprayer, Heavy Line Equipment	
Man....\$	52.76 19.96
(3) Tree	
Trimmer.....\$	31.10
11.32	
(4) Line Equipment	
Man.....\$	52.76 19.96
(5) Powdermen,	
Jackhammermen.....\$	
33.80	13.35
(6)	
Groundman.....\$	33.24
14.79	

 ELEC1245-004 01/01/2020

ALL COUNTIES EXCEPT DEL NORTE,
 MODOC & SISKIYOU

Rates	Fringes
LINE CONSTRUCTION	
(1) Lineman; Cable	
splicer..\$	58.09 19.74
(2) Equipment specialist (operates crawler tractors, commercial motor vehicles, backhoes, trenchers, cranes (50 tons and below), overhead & underground distribution line equipment).....\$	
18.55	46.40
(3)	
Groundman.....\$	35.47
18.17	
(4)	
Powderman.....\$	51.87
18.79	

County of El Dorado
Agreement
 C-42 REV

HOLIDAYS: New Year's Day, M.L. King Day, Memorial Day, Independence Day, Labor Day, Veterans Day, Thanksgiving Day and day after Thanksgiving, Christmas Day

 ELEV0008-001 01/01/2020

Rates	Fringes
ELEVATOR	
MECHANIC.....	\$ 69.78
34.765+a+b	

FOOTNOTE:
 a. PAID VACATION: Employer contributes 8% of regular hourly rate as vacation pay credit for employees with more than 5 years of service, and 6% for 6 months to 5 years of service.
 b. PAID HOLIDAYS: New Years Day, Memorial Day, Independence Day, Labor Day, Veterans Day, Thanksgiving Day, Friday after Thanksgiving, and Christmas Day.

 ENGI0003-008 07/01/2017

Rates	Fringes
Dredging: (DREDGING: CLAMSHELL & DIPPER DREDGING; HYDRAULIC SUCTION DREDGING:)	
AREA 1:	
(1)	
Leverman.....	\$ 44.77
31.25	
(2) Dredge Dozer; Heavy duty repairman.....	\$ 39.81
31.25	
(3) Booster Pump Operator; Deck Engineer; Deck mate; Dredge Tender; Winch	
Operator.....	\$
38.69	31.25
(4) Bargeman; Deckhand;	

Fireman; Leveehand;	
Oiler..	\$ 35.39
31.25	
AREA 2:	
(1)	
Leverman.....	\$ 46.77
31.25	
(2) Dredge Dozer; Heavy duty repairman.....	\$ 41.81
31.25	
(3) Booster Pump Operator; Deck Engineer; Deck mate; Dredge Tender; Winch	
Operator.....	\$
40.69	31.25
(4) Bargeman; Deckhand; Fireman; Leveehand;	
Oiler..	\$ 37.39
31.25	

AREA DESCRIPTIONS

AREA 1: ALAMEDA, BUTTE, CONTRA COSTA, KINGS, MARIN, MERCED, NAPA, SACRAMENTO, SAN BENITO, SAN FRANCISCO, SAN JOAQUIN, SAN MATEO, SANTA CLARA, SANTA CRUZ, SOLANO, STANISLAUS, SUTTER, YOLO, AND YUBA COUNTIES

AREA 2: MODOC COUNTY

THE REMAINGING COUNTIES ARE SPLIT BETWEEN AREA 1 AND AREA 2 AS NOTED BELOW:

ALPINE COUNTY:
 Area 1: Northernmost part
 Area 2: Remainder

CALAVERAS COUNTY:
 Area 1: Remainder
 Area 2: Eastern part

COLUSA COUNTY:
 Area 1: Eastern part
 Area 2: Remainder

ELDORADO COUNTY:
 Area 1: North Central part
 Area 2: Remainder

FRESNO COUNTY:
 Area 1: Remainder
 Area 2: Eastern part

GLENN COUNTY:
 Area 1: Eastern part
 Area 2: Remainder

Hanks Exchange Road at Squaw Hollow Creek Bridge Replacement
 Contract No. 3916, CIP No 77135
 February 25, 2020

County of El Dorado
 Agreement
 C-43 REV

LASSEN COUNTY:
 Area 1: Western part along the Southern portion of border with Shasta County
 Area 2: Remainder

MADERA COUNTY:
 Area 1: Except Eastern part
 Area 2: Eastern part

MARIPOSA COUNTY
 Area 1: Except Eastern part
 Area 2: Eastern part

MONTERREY COUNTY
 Area 1: Except Southwestern part
 Area 2: Southwestern part

NEVADA COUNTY:
 Area 1: All but the Northern portion along the border of Sierra County
 Area 2: Remainder

PLACER COUNTY:
 Area 1: Al but the Central portion
 Area 2: Remainder

PLUMAS COUNTY:
 Area 1: Western portion
 Area 2: Remainder

SHASTA COUNTY:
 Area 1: All but the Northeastern corner
 Area 2: Remainder

SIERRA COUNTY:
 Area 1: Western part
 Area 2: Remainder

SISKIYOU COUNTY:
 Area 1: Central part
 Area 2: Remainder

SONOMA COUNTY:
 Area 1: All but the Northwestern corner
 Area 2: Remainder

TEHAMA COUNTY:
 Area 1: All but the Western border with Mendocino & Trinity Counties
 Area 2: Remainder

TRINITY COUNTY:

Area 1: East Central part and the Northeastern border with Shasta County
 Area 2: Remainder

TUOLUMNE COUNTY:
 Area 1: Except Eastern part
 Area 2: Eastern part

 ENGI0003-018 06/26/2017

"AREA 1" WAGE RATES ARE LISTED BELOW

"AREA 2" RECEIVES AN ADDITIONAL \$2.00 PER HOUR ABOVE AREA 1 RATES.

SEE AREA DEFINITIONS BELOW

Rates	Fringes
OPERATOR: Power Equipment (AREA 1:)	
GROUP	
1.....	\$ 44.67
30.39	
GROUP	
2.....	\$ 43.14
30.39	
GROUP	
3.....	\$ 41.66
30.39	
GROUP	
4.....	\$ 40.28
30.39	
GROUP	
5.....	\$ 39.01
30.39	
GROUP	
6.....	\$ 37.69
30.39	
GROUP	
7.....	\$ 36.55
30.39	
GROUP	
8.....	\$ 35.41
30.39	
GROUP 8-	
A.....	\$ 33.20
30.39	
OPERATOR: Power Equipment (Cranes and Attachments - AREA 1:)	
GROUP 1	

Hanks Exchange Road at Squaw Hollow Creek Bridge Replacement
 Contract No. 3916, CIP No 77135
 February 25, 2020

County of El Dorado
 Agreement
 C-44 REV

Cranes.....\$
 46.30 30.39

 Oiler.....\$
 36.63 30.39
 Truck crane
 oiler.....\$ 39.20
 30.39
 GROUP 2

 Cranes.....\$
 43.79 30.39

 Oiler.....\$
 36.36 30.39
 Truck crane
 oiler.....\$ 38.98
 30.39
 GROUP 3

 Cranes.....\$
 42.05 30.39

 Hydraulic.....\$
 38.32 30.39

 Oiler.....\$
 36.14 30.39
 Truck Crane
 Oiler.....\$ 38.71
 30.39
 GROUP 4

 Cranes.....\$
 39.01 30.39
 OPERATOR: Power Equipment
 (Piledriving - AREA 1:)
 GROUP 1
 Lifting
 devices.....\$ 45.89
 30.39

 Oiler.....\$
 36.63 30.39
 Truck crane
 oiler.....\$ 39.20
 30.39
 GROUP 2
 Lifting
 devices.....\$ 44.07
 30.39

 Oiler.....\$
 36.36 30.39
 Truck Crane
 Oiler.....\$ 38.98
 30.39
 GROUP 3

 Lifting
 devices.....\$ 42.39
 30.39

 Oiler.....\$
 36.14 30.39
 Truck Crane
 Oiler.....\$ 38.71
 30.39
 GROUP 4
 Lifting
 devices.....\$ 40.62
 30.39
 GROUP 5
 Lifting
 devices.....\$ 39.32
 30.39
 GROUP 6
 Lifting
 devices.....\$ 37.98
 30.39
 OPERATOR: Power Equipment
 (Steel Erection - AREA 1:)
 GROUP 1

 Cranes.....\$
 46.30 30.39

 Oiler.....\$
 36.63 30.39
 Truck Crane
 Oiler.....\$ 39.20
 30.39
 GROUP 2

 Cranes.....\$
 43.79 30.39

 Oiler.....\$
 36.36 30.39
 Truck Crane
 Oiler.....\$ 38.98
 30.39
 GROUP 3

 Cranes.....\$
 42.05 30.39

 Hydraulic.....\$
 38.32 30.39

 Oiler.....\$
 36.14 30.39
 Truck Crane
 Oiler.....\$ 38.71
 30.39
 GROUP 4

 Cranes.....\$
 39.01 30.39

Hanks Exchange Road at Squaw Hollow Creek Bridge Replacement
 Contract No. 3916, CIP No 77135
 February 25, 2020

County of El Dorado
 Agreement
 C-45 REV

GROUP 5

Cranes.....\$ 35.13
 30.39
 OPERATOR: Power Equipment
 (Tunnel and Underground Work
 - AREA 1:)
 SHAFTS, STOPES, RAISES:
 GROUP
 1.....\$ 40.77
 30.39
 GROUP 1-
 A.....\$ 43.24
 30.39
 GROUP
 2.....\$ 39.51
 30.39
 GROUP
 3.....\$ 38.18
 30.39
 GROUP
 4.....\$ 37.04
 30.39
 GROUP
 5.....\$ 35.90
 30.39
 UNDERGROUND:
 GROUP
 1.....\$ 40.67
 30.39
 GROUP 1-
 A.....\$ 43.14
 30.39
 GROUP
 2.....\$ 39.41
 30.39
 GROUP
 3.....\$ 38.08
 30.39
 GROUP
 4.....\$ 36.94
 30.39
 GROUP
 5.....\$ 35.80
 30.39

FOOTNOTE: Work suspended by
 ropes or cables, or work on a
 Yo-Yo Cat: \$.60 per hour
 additional.

POWER EQUIPMENT OPERATOR
 CLASSIFICATIONS

GROUP 1: Operator of helicopter
 (when used in erection work);
 Hydraulic excavator, 7 cu. yds.
 and over; Power shovels,
 over 7 cu. yds.

Hanks Exchange Road at Squaw Hollow Creek Bridge Replacement
 Contract No. 3916, CIP No 77135
 February 25, 2020

GROUP 2: Highline cableway;
 Hydraulic excavator, 3-1/2 cu.
 yds. up to 7 cu. yds.; Licensed
 construction work boat
 operator, on site; Power blade
 operator (finish); Power
 shovels, over 1 cu. yd. up to
 and including 7 cu. yds.
 m.r.c.

GROUP 3: Asphalt milling
 machine; Cable backhoe;
 Combination
 backhoe and loader over 3/4 cu.
 yds.; Continuous flight tie
 back machine assistant to
 engineer or mechanic; Crane
 mounted continuous flight tie
 back machine, tonnage to
 apply; Crane mounted drill
 attachment, tonnage to apply;
 Dozer, slope brd; Gradall;
 Hydraulic excavator, up to 3 1/2
 cu. yds.; Loader 4 cu. yds. and
 over; Long reach excavator;
 Multiple engine scraper (when
 used as push pull); Power
 shovels, up to and including 1
 cu. yd.; Pre-stress wire
 wrapping machine; Side boom
 cat, 572 or larger; Track
 loader 4 cu. yds. and over;
 Wheel excavator (up to and
 including 750 cu. yds. per
 hour)

GROUP 4: Asphalt plant
 engineer/box person; Chicago
 boom;
 Combination backhoe and loader
 up to and including 3/4 cu.
 yd.; Concrete batch plant (wet
 or dry); Dozer and/or push
 cat; Pull- type elevating
 loader; Gradesetter, grade
 checker (GPS, mechanical or
 otherwise); Grooving and
 grinding machine; Heading
 shield operator; Heavy-duty
 drilling equipment, Hughes,
 LDH, Watson 3000 or similar;
 Heavy-duty repairperson and/or
 welder; Lime spreader;
 Loader under 4 cu. yds.;
 Lubrication and service engineer
 (mobile and grease rack);
 Mechanical finishers or spreader
 machine (asphalt, Barber-Greene
 and similar); Miller

County of El Dorado
 Agreement
 C-46 REV

Formless M-9000 slope paver or similar; Portable crushing and screening plants; Power blade support; Roller operator, asphalt; Rubber-tired scraper, self-loading (paddle-wheels, etc.); Rubber-tired earthmoving equipment (scrapers); Slip form paver (concrete); Small tractor with drag; Soil stabilizer (P & H or equal); Spider plow and spider puller; Tubex pile rig; Unlicensed construction work boat operator, on site; Timber skidder; Track loader up to 4 yds.; Tractor-drawn scraper; Tractor, compressor drill combination; Welder; Woods-Mixer (and other similar Pugmill equipment)

GROUP 5: Cast-in-place pipe laying machine; Combination slusher and motor operator; Concrete conveyor or concrete pump, truck or equipment mounted; Concrete conveyor, building site; Concrete pump or pumpcrete gun; Drilling equipment, Watson 2000, Texoma 700 or similar; Drilling and boring machinery, horizontal (not to apply to waterliners, wagon drills or jackhammers); Concrete mixer/all; Person and/or material hoist; Mechanical finishers (concrete) (Clary, Johnson, Bidwell Bridge Deck or similar types); Mechanical burm, curb and/or curb and gutter machine, concrete or asphalt); Mine or shaft hoist; Portable crusher; Power jumbo operator (setting slip-forms, etc., in tunnels); Screed (automatic or manual); Self-propelled compactor with dozer; Tractor with boom D6 or smaller; Trenching machine, maximum digging capacity over 5 ft. depth; Vermeer T-600B rock cutter or similar

GROUP 6: Armor-Coater (or similar); Ballast jack tamper; Boom-type backfilling machine; Assistant plant engineer;

Bridge and/or gantry crane; Chemical grouting machine, truck-mounted; Chip spreading machine operator; Concrete saw (self-propelled unit on streets, highways, airports and canals); Deck engineer; Drilling equipment Texoma 600, Hughes 200 Series or similar up to and including 30 ft. m.r.c.; Drill doctor; Helicopter radio operator; Hydro-hammer or similar; Line master; Skidsteer loader, Bobcat larger than 743 series or similar (with attachments); Locomotive; Lull hi-lift or similar; Oiler, truck mounted equipment; Pavement breaker, truck-mounted, with compressor combination; Paving fabric installation and/or laying machine; Pipe bending machine (pipelines only); Pipe wrapping machine (tractor propelled and supported); Screed (except asphaltic concrete paving); Self-propelled pipeline wrapping machine; Tractor; Self-loading chipper; Concrete barrier moving machine

GROUP 7: Ballast regulator; Boom truck or dual-purpose A-frame truck, non-rotating - under 15 tons; Cary lift or similar; Combination slurry mixer and/or cleaner; Drilling equipment, 20 ft. and under m.r.c.; Firetender (hot plant); Grouting machine operator; Highline cableway signalperson; Stationary belt loader (Kolman or similar); Lift slab machine (Vagtborg and similar types); Maginnes internal full slab vibrator; Material hoist (1 drum); Mechanical trench shield; Pavement breaker with or without compressor combination); Pipe cleaning machine (tractor propelled and supported); Post driver; Roller (except asphalt); Chip Seal; Self-propelled automatically applied concrete curing machine (on streets, highways, airports and canals);

Hanks Exchange Road at Squaw Hollow Creek Bridge Replacement
Contract No. 3916, CIP No 77135
 February 25, 2020

County of El Dorado
Agreement
 C-47 REV

Self-propelled compactor (without dozer); Signalperson; Slip-form pumps (lifting device for concrete forms); Tie spacer; Tower mobile; Trenching machine, maximum digging capacity up to and including 5 ft. depth; Truck-type loader

GROUP 8: Bit sharpener; Boiler tender; Box operator; Brakeperson; Combination mixer and compressor (shotcrete/gunite); Compressor operator; Deckhand; Fire tender; Forklift (under 20 ft.); Generator;

Gunite/shotcrete equipment operator; Hydraulic monitor; Ken seal machine (or similar); Mixermobile; Oiler; Pump operator; Refrigeration plant; Reservoir-debris tug (self-propelled floating); Ross Carrier (construction site); Rotomist operator; Self-propelled tape machine; Shuttlecar;

Self-propelled power sweeper operator (includes vacuum sweeper); Slusher operator; Surface heater; Switchperson; Tar pot firetender; Tugger hoist, single drum; Vacuum cooling plant; Welding machine (powered other than by electricity)

GROUP 8-A: Elevator operator; Skidsteer loader-Bobcat 743 series or smaller, and similar (without attachments); Mini excavator under 25 H.P. (backhoe-trencher); Tub grinder wood chipper

ALL CRANES AND ATTACHMENTS

GROUP 1: Clamshell and dragline over 7 cu. yds.; Crane, over 100 tons; Derrick, over 100 tons; Derrick barge pedestal-mounted, over 100 tons; Self-propelled boom-type lifting device, over 100 tons

GROUP 2: Clamshell and dragline over 1 cu. yd. up to and including 7 cu. yds.; Crane, over 45 tons up to and including 100 tons; Derrick barge, 100 tons and under; Self-propelled boom-type lifting device, over 45 tons; Tower crane

GROUP 3: Clamshell and dragline up to and including 1 cu. yd.; Cranes 45 tons and under; Self-propelled boom-type lifting device 45 tons and under;

GROUP 4: Boom Truck or dual purpose A-frame truck, non-rotating over 15 tons; Truck-mounted rotating telescopic boom type lifting device, Manitex or similar (boom truck) over 15 tons; Truck-mounted rotating telescopic boom type lifting device, Manitex or similar (boom truck) - under 15 tons;

PILEDRIVERS

GROUP 1: Derrick barge pedestal mounted over 100 tons; Clamshell over 7 cu. yds.; Self-propelled boom-type lifting device over 100 tons; Truck crane or crawler, land or barge mounted over 100 tons

GROUP 2: Derrick barge pedestal mounted 45 tons to and including 100 tons; Clamshell up to and including 7 cu. yds.; Self-propelled boom-type lifting device over 45 tons; Truck crane or crawler, land or barge mounted, over 45 tons up to and including 100 tons; Fundex F-12 hydraulic pile rig

GROUP 3: Derrick barge pedestal mounted under 45 tons; Self-propelled boom-type lifting device 45 tons and under; Skid/scow piledriver, any tonnage; Truck crane or crawler,

land or barge mounted 45 tons and under

GROUP 4: Assistant operator in lieu of assistant to engineer; Forklift, 10 tons and over; Heavy-duty repairperson/welder

GROUP 5: Deck engineer

GROUP 6: Deckhand; Fire tender

STEEL ERECTORS

GROUP 1: Crane over 100 tons; Derrick over 100 tons; Self-propelled boom-type lifting device over 100 tons

GROUP 2: Crane over 45 tons to 100 tons; Derrick under 100 tons; Self-propelled boom-type lifting device over 45 tons to 100 tons; Tower crane

GROUP 3: Crane, 45 tons and under; Self-propelled boom-type lifting device, 45 tons and under

GROUP 4: Chicago boom; Forklift, 10 tons and over; Heavy-duty repair person/welder

GROUP 5: Boom cat

--

TUNNEL AND UNDERGROUND WORK

GROUP 1-A: Tunnel bore machine operator, 20' diameter or more

GROUP 1: Heading shield operator; Heavy-duty repairperson; Mucking machine (rubber tired, rail or track type); Raised bore operator (tunnels); Tunnel mole bore operator

GROUP 2: Combination slusher and motor operator; Concrete

Hanks Exchange Road at Squaw Hollow Creek Bridge Replacement
Contract No. 3916, CIP No 77135
February 25, 2020

pump or pumpcrete gun; Power jumbo operator

GROUP 3: Drill doctor; Mine or shaft hoist

GROUP 4: Combination slurry mixer cleaner; Grouting Machine operator; Motorman

GROUP 5: Bit Sharpener; Brakeman; Combination mixer and compressor (gunite); Compressor operator; Oiler; Pump operator; Slusher operator

AREA DESCRIPTIONS:

POWER EQUIPMENT OPERATORS, CRANES AND ATTACHMENTS, TUNNEL AND UNDERGROUND [These areas do not apply to Piledrivers and Steel Erectors]

AREA 1: ALPINE, AMADOR, BUTTE, COLUSA, EL DORADO, GLENN, LASSEN, MARIN, NAPA, NEVADA, PLACER, PLUMAS, SACRAMENTO, SHASTA, SIERRA, SISKIYOU, SOLANO, SONOMA, SUTTER, TEHAMA, TRINITY, YOLO, YUBA
AREA 2 - MODOC COUNTY

THE REMAINING COUNTIES ARE SPLIT BETWEEN AREA 1 AND AREA 2 AS

NOTED BELOW:

ALPINE COUNTY:
Area 1: Northernmost part
Area 2: Remainder

COLUSA COUNTY:
Area 1: Eastern part
Area 2: Remainder

DEL NORTE COUNTY:
Area 1: Extreme Southwestern corner
Area 2: Remainder

ELDORADO COUNTY:
Area 1: North Central part
Area 2: Remainder

GLENN COUNTY:
Area 1: Eastern part
Area 2: Remainder

County of El Dorado
Agreement
C-49 REV

LASSEN COUNTY:
 Area 1: Western part along the Southern portion of border with Shasta County
 Area 2: Remainder

NEVADA COUNTY:
 Area 1: All but the Northern portion along the border of Sierra County
 Area 2: Remainder

PLACER COUNTY:
 Area 1: All but the Central portion
 Area 2: Remainder

PLUMAS COUNTY:
 Area 1: Western portion
 Area 2: Remainder

SHASTA COUNTY:
 Area 1: All but the Northeastern corner
 Area 2: Remainder

SIERRA COUNTY:
 Area 1: Western part
 Area 2: Remainder

SISKIYOU COUNTY:
 Area 1: Central part
 Area 2: Remainder

SONOMA COUNTY:
 Area 1: All but the Northwestern corner
 Area 2: Remainder

TEHAMA COUNTY:
 Area 1: All but the Western border with Mendocino & Trinity Counties
 Area 2: Remainder

TRINITY COUNTY:
 Area 1: East Central part and the Northeast border with Shasta County
 Area 2: Remainder

 ENGI0003-019 07/26/2017

SEE AREA DESCRIPTIONS BELOW

Rates Fringes
 Hanks Exchange Road at Squaw Hollow Creek Bridge Replacement
Contract No. 3916, CIP No 77135
 February 25, 2020

County of El Dorado
Agreement
 C-50 REV

OPERATOR: Power Equipment
 (LANDSCAPE WORK ONLY)
 GROUP 1
 AREA
 1.....\$ 34.05
 28.73
 AREA
 2.....\$ 36.05
 28.73
 GROUP 2
 AREA
 1.....\$ 30.45
 28.73
 AREA
 2.....\$ 32.45
 28.73
 GROUP 3
 AREA
 1.....\$ 25.84
 28.73
 AREA
 2.....\$ 27.84
 28.73

GROUP DESCRIPTIONS:
 GROUP 1: Landscape Finish Grade Operator: All finish grade work regardless of equipment used, and all equipment with a rating more than 65 HP.
 GROUP 2: Landscape Operator up to 65 HP: All equipment with a manufacturer's rating of 65 HP or less except equipment covered by Group 1 or Group 3. The following equipment shall be included except when used for finish work as long as manufacturer's rating is 65 HP or less: A-Frame and Winch Truck, Backhoe, Forklift, Hydragraphic Seeder Machine, Roller, Rubber-Tired and Track Earthmoving Equipment, Skiploader, Straw Blowers, and Trencher 31 HP up to 65 HP.
 GROUP 3: Landscape Utility Operator: Small Rubber-Tired Tractor, Trencher Under 31 HP.

AREA DESCRIPTIONS:
 AREA 1: ALAMEDA, BUTTE, CONTRA COSTA, KINGS, MARIN, MERCED,

NAPA, SACRAMENTO, SAN BENITO,
SAN FRANCISCO, SAN JOAQUIN,
SAN MATEO, SANTA CLARA, SANTA
CRUZ, SOLANO, STANISLAUS,
SUTTER, YOLO, AND YUBA COUNTIES

AREA 2 - MODOC COUNTY

THE REMAINING COUNTIES ARE
SPLIT BETWEEN AREA 1 AND AREA 2
AS

NOTED BELOW:

ALPINE COUNTY:

Area 1: Northernmost part
Area 2: Remainder

CALAVERAS COUNTY:

Area 1: Except Eastern part
Area 2: Eastern part

COLUSA COUNTY:

Area 1: Eastern part
Area 2: Remainder

DEL NORTE COUNTY:

Area 1: Extreme Southwestern
corner
Area 2: Remainder

ELDORADO COUNTY:

Area 1: North Central part
Area 2: Remainder

FRESNO COUNTY

Area 1: Except Eastern part
Area 2: Eastern part

GLENN COUNTY:

Area 1: Eastern part
Area 2: Remainder

HUMBOLDT COUNTY:

Area 1: Except Eastern and
Southwestern parts
Area 2: Remainder

LAKE COUNTY:

Area 1: Southern part
Area 2: Remainder

LASSEN COUNTY:

Area 1: Western part along the
Southern portion of border
with Shasta County
Area 2: Remainder

MADERA COUNTY

Area 1: Remainder
Area 2: Eastern part

Hanks Exchange Road at Squaw Hollow Creek Bridge Replacement
Contract No. 3916, CIP No 77135
February 25, 2020

MARIPOSA COUNTY

Area 1: Remainder
Area 2: Eastern part

MENDOCINO COUNTY:

Area 1: Central and Southeastern
parts
Area 2: Remainder

MONTEREY COUNTY

Area 1: Remainder
Area 2: Southwestern part

NEVADA COUNTY:

Area 1: All but the Northern
portion along the border of
Sierra County
Area 2: Remainder

PLACER COUNTY:

Area 1: All but the Central
portion
Area 2: Remainder

PLUMAS COUNTY:

Area 1: Western portion
Area 2: Remainder

SHASTA COUNTY:

Area 1: All but the Northeastern
corner
Area 2: Remainder

SIERRA COUNTY:

Area 1: Western part
Area 2: Remainder

SISKIYOU COUNTY:

Area 1: Central part
Area 2: Remainder

SONOMA COUNTY:

Area 1: All but the Northwestern
corner
Area 2: Remainder

TEHAMA COUNTY:

Area 1: All but the Western
border with Mendocino & Trinity
Counties
Area 2: Remainder

TRINITY COUNTY:

Area 1: East Central part and
the Northeast border with
Shasta County
Area 2: Remainder

TULARE COUNTY;

County of El Dorado
Agreement
C-51 REV

Area 1: Remainder
Area 2: Eastern part

TUOLUMNE COUNTY:
Area 1: Remainder
Area 2: Eastern Part

IRON0377-002 07/01/2019

Rates	Fringes
Ironworkers:	
Fence	
Erector.....\$ 33.58	
24.66	
Ornamental, Reinforcing	
and	
Structural.....\$ 40.00	
33.30	

PREMIUM PAY:

\$6.00 additional per hour at the following locations:

China Lake Naval Test Station,
Chocolate Mountains Naval Reserve-
Niland,
Edwards AFB, Fort Irwin Military Station,
Fort Irwin Training Center-Goldstone,
San Clemente Island, San Nicholas Island,
Susanville Federal Prison, 29 Palms -
Marine Corps, U.S. Marine Base -
Barstow, U.S. Naval Air Facility -
Sealey, Vandenberg AFB

\$4.00 additional per hour at the following locations:

Army Defense Language Institute -
Monterey, Fallon Air Base, Naval Post
Graduate School - Monterey, Yermo
Marine Corps Logistics Center

\$2.00 additional per hour at the following locations:

Port Hueneme, Port Mugu, U.S. Coast
Guard Station - Two Rock

LABO0067-001 01/01/2020

Hanks Exchange Road at Squaw Hollow
Creek Bridge Replacement
Contract No. 3916, CIP No 77135
February 25, 2020

AREA "A" - MARIN COUNTY

AREA "B" - ALPINE, AMADOR, BUTTE
COLUSA EL DORADO, GLENN, LASSEN,
MODOC, NAPA, NEVADA, PLACER,
PLUMAS, SACRAMENTO, SHASTA,
SIERRA, SISKIYOU, SOLANO, SONOMA,
SUTTER, TEHAMA, TRINITY, YOLO,
AND YUBA COUNTIES

Rates	Fringes
Asbestos Removal	
Laborer.....\$ 24.00	
11.30	
LABORER (Lead Removal)	
Marin	
County.....\$ 31.81	
24.61	
Remaining	
Counties.....\$ 30.81	
24.61	

LABO0067-005 06/27/2017

AREA "A" - ALAMEDA, CONTRA COSTA,
MARIN, SAN FRANCISCO, SAN MATEO
AND SANTA CLARA COUNTIES

AREA "B" - ALPINE, AMADOR, BUTTE,
CALAVERAS, COLUSA, DEL NORTE, EL
DORADO, FRESNO, GLENN, HUMBOLDT,
KINGS, LAKE, LASSEN, MADERA,
MARIPOSA, MENDOCINO, MERCED,
MODOC, MONTEREY, NAPA, NEVADA,
PLACER, PLUMAS, SACRAMENTO,
SAN BENITO, SAN JOAQUIN, SANTA
CRUZ, SIERRA, SHASTA, SISKIYOU,
SOLANO, SONOMA, STANISLAUS,
TEHAMA, TRINITY, TULARE, TUOLUMNE,
YOLO AND YUBA COUNTIES

Rates	Fringes
LABORER (TRAFFIC CONTROL/LANE CLOSURE)	
Escort Driver, Flag Person	
Area	
A.....\$ 29.54	
22.17	
Area	
B.....\$ 28.54	
22.17	

County of El Dorado
Agreement
C-52 REV

Traffic Control Person I
Area
A.....\$ 29.84
22.17
Area
B.....\$ 28.84
22.17
Traffic Control Person II
Area
A.....\$ 27.34
22.17
Area
B.....\$ 26.34
22.17

TRAFFIC CONTROL PERSON I:
Layout of traffic control, crash
cushions, construction area and
roadside signage.

TRAFFIC CONTROL PERSON II:
Installation and removal of
temporary/permanent signs,
markers, delineators and crash
cushions.

LABO0185-002 07/01/2018

ALPINE, AMADOR, BUTTE, COLUSA, EL
DORADO, GLENN, LASSEN, MODOC,
NEVADA, PLACER, PLUMAS,
SACRAMENTO, SHASTA, SIERRA,
SISKIYOU,
SUTTER, TEHAMA, TRINITY, YOLO AND
YUBA COUNTIES

Rates Fringes

LABORER
Mason Tender-
Brick.....\$ 31.20
22.20

LABO0185-005 06/25/2018

ALPINE, AMADOR, BUTTE, COLUSA, EL
DORADO, GLENN, LASSEN, MODOC,
NEVADA, PLACER, PLUMAS,
SACRAMENTO, SHASTA, SIERRA,
SISKIYOU,
SUTTER, TEHAMA, TRINITY, YOLO AND
YUBA COUNTIES

Hanks Exchange Road at Squaw Hollow Creek Bridge Replacement
Contract No. 3916, CIP No 77135
February 25, 2020

County of El Dorado
Agreement
C-53 REV

Rates Fringes
Tunnel and Shaft Laborers:
GROUP
1.....\$ 37.82
24.11
GROUP
2.....\$ 37.59
24.11
GROUP
3.....\$ 37.34
24.11
GROUP
4.....\$ 36.89
24.11
GROUP
5.....\$ 36.35
24.11
Shotcrete
Specialist.....\$ 38.34
24.11

TUNNEL AND SHAFT CLASSIFICATIONS

GROUP 1: Diamond driller;
Groundmen; Gunite and shotcrete
nozzlemen

GROUP 2: Rodmen; Shaft work &
raise (below actual or
excavated ground level)

GROUP 3: Bit grinder; Blaster,
driller, powdermen, heading;
Cherry pickermen - where car is
lifted; Concrete finisher
in tunnel; Concrete screedman;
Grout pumpman and potman;
Gunite & shotcrete gunman &
potman; Headermen; High
pressure nozzleman; Miner -
tunnel, including top and
bottom man on shaft and raise
work; Nipper; Nozzleman on
slick line; Sandblaster -
potman, Robotic Shotcrete Placer,
Segment Erector, Tunnel Muck
Hauler, Steel Form raiser and
setter; Timberman, retimberman
(wood or steel or substitute
materials therefore); Tugger
(for tunnel laborer work);
Cable tender; Chuck tender;
Powderman - primer house

GROUP 4: Vibrator operator,
pavement breaker; Bull gang -
muckers, trackmen; Concrete
crew - includes rodding and

spreading, Dumpmen (any method)

GROUP 5: Grout crew;
Reboundman; Swamper/ Brakeman

LABO0185-006 06/25/2018

ALPINE, AMADOR, BUTTE, COLUSA, EL
DORADO, GLENN, LASSEN, MODOC,
NEVADA, PLACER, PLUMAS,
SACRAMENTO, SHIASTA, SIERRA,
SISKIYOU,
SUTTER, TEHAMA, TRINITY, YOLO,
YUBA COUNTIES

Rates	Fringes
LABORER (CONSTRUCTION CRAFT LABORERS - AREA B:) Construction Specialist	
Group.....\$	
30.49	23.20
GROUP	
1.....\$ 29.79	
23.20	
GROUP 1-	
a.....\$ 30.01	
23.20	
GROUP 1-	
c.....\$ 30.01	
23.20	
GROUP 1-	
e.....\$ 30.34	
23.20	
GROUP 1-	
f.....\$ 30.37	
23.20	
GROUP	
2.....\$ 29.64	
23.20	
GROUP	
3.....\$ 29.54	
23.20	
GROUP	
4.....\$ 23.23	
23.20	
See groups 1-b and 1-d under laborer classifications.	
LABORER (GARDENERS, HORTICULTURAL & LANDSCAPE LABORERS - AREA B:)	
(1) New	
Construction.....\$ 29.54	
23.20	
(2) Establishment Warranty	

Hanks Exchange Road at Squaw Hollow Creek Bridge Replacement
Contract No. 3916, CIP No 77135
February 25, 2020

County of El Dorado
Agreement
C-54 REV

Period.....\$	
23.23	23.20
LABORER (GUNITE - AREA B:)	
GROUP	
1.....\$ 29.75	
22.31	
GROUP	
2.....\$ 29.25	
22.31	
GROUP	
3.....\$ 28.66	
22.31	
GROUP	
4.....\$ 28.54	
22.31	
LABORER (WRECKING - AREA B:)	
GROUP	
1.....\$ 29.79	
23.20	
GROUP	
2.....\$ 29.64	
23.20	

FOOTNOTES:

Laborers working off or with or from bos'n chairs, swinging scaffolds, belts shall receive \$0.25 per hour above the applicable wage rate. This shall not apply to workers entitled to receive the wage rate set forth in Group 1-a below.

LABORER CLASSIFICATIONS

CONSTRUCTION SPECIALIST GROUP:
Asphalt ironer and raker;
Chainsaw; Laser beam in connection with laborers' work;
Cast-in-place manhole form setter; Pressure pipelayer;
Davis trencher - 300 or similar type (and all small trenchers); Blaster; Diamond driller; Multiple unit drill; Hydraulic drill

GROUP 1: Asphalt spreader boxes (all types); Barko, Wacker and similar type tampers; Buggymobile; Caulker, bander, pipewrapper, conduit layer, plastic pipelayer; Certified

hazardous waste worker including Leade Abatement; Compactors of all types; Concrete and magnesite mixer, 1/2 yd. and under; Concrete pan work; Concrete sander; Concrete saw; Cribber and/or shoring; Cut granite curb setter; Dri-pak-it machine; Faller, logloader and buckler; Form raiser, slip forms; Green cutter; Headerboard, Hubsetter, aligner, by any method; High pressure blow pipe (1-1/2" or over, 100 lbs. pressure/over); Hydro seeder and similar type; Jackhammer operator; Jacking of pipe over 12 inches; Jackson and similar type compactor; Kettle tender, pot and worker applying asphalt, lay-kold, creosote, lime, caustic and similar type materials (applying means applying, dipping or handling of such materials); Lagging, sheeting, whaling, bracing, trenchjacking, lagging hammer; Magnesite, epoxyresin, fiberglass, mastic worker (wet or dry); No joint pipe and stripping of same, including repair of voids; Pavement breaker and spader, including tool grinder; Perma curb; Pipelayer (including grade checking in connection with pipelaying); Precast-manhole setter; Pressure pipe tester; Post hole digger, air, gas and electric; Power broom sweeper; Power tampers of all types (except as shown in Group 2); Ram set gun and stud gun; Riprap stonepaver and rock-slinger, including placing of sacked concrete and/or sand (wet or dry) and gabions and similar type; Rotary scarifier or multiple head concrete chipping scarifier; Roto and Ditch Witch; Rototiller; Sandblaster, pot, gun, nozzle operators; Signalling and rigging; Tank cleaner; Tree climber; Turbo blaster; Vibrascreed, bull float in connection with laborers' work;

Vibrator; Hazardous waste worker (lead removal); Asbestos and mold removal worker

GROUP 1-a: Joy drill model TWM-2A; Gardner-Denver model DH143 and similar type drills; Track driller; Jack leg driller; Wagon driller; Mechanical drillers, all types regardless of type or method of power; Mechanical pipe layers, all types regardless of type or method of power; Blaster and powder; All work of loading, placing and blasting of all powder and explosives of whatever type regardless of method used for such loading and placing; High scalers (including drilling of same); Tree toppler; Bit grinder

GROUP 1-b: Sewer cleaners shall receive \$4.00 per day above Group 1 wage rates. "Sewer cleaner" means any worker who handles or comes in contact with raw sewage in small diameter sewers. Those who work inside recently active, large diameter sewers, and all recently active sewer manholes shall receive \$5.00 per day above Group 1 wage rates.

GROUP 1-c: Burning and welding in connection with laborers' work; Synthetic thermoplastics and similar type welding

GROUP 1-d: Maintenance and repair track and road beds. All employees performing work covered herein shall receive \$.25 per hour above their regular rate for all work performed on underground structures not specifically covered herein. This paragraph shall not be construed to apply to work below ground level in open cut. It shall apply to cut and cover work of subway construction after the temporary cover has been placed.

Hanks Exchange Road at Squaw Hollow Creek Bridge Replacement
Contract No. 3916, CIP No 77135
February 25, 2020

County of El Dorado
Agreement
C-55 REV

GROUP 1-e: Work on and/or in bell hole footings and shafts thereof, and work on and in deep footings. (A deep footing is a hole 15 feet or more in depth.) In the event the depth of the footing is unknown at the commencement of excavation, and the final depth exceeds 15 feet, the deep footing wage rate would apply to all employees for each and every day worked on or in the excavation of the footing from the date of inception.

GROUP 1-f: Wire winding machine in connection with guniting or shot crete

GROUP 2: Asphalt shoveler; Cement dumper and handling dry cement or gypsum; Choke-setter and rigger (clearing work); Concrete bucket dumper and chute; Concrete chipping and grinding; Concrete laborer (wet or dry); Driller tender, chuck tender, nipper; Guinea chaser (stake), grout crew; High pressure nozzle, adductor; Hydraulic monitor (over 100 lbs. pressure); Loading and unloading, carrying and hauling of all rods and materials for use in reinforcing concrete construction; Pittsburgh chipper and similar type brush shredders; Sloper; Single foot, hand-held, pneumatic tamper; All pneumatic, air, gas and electric tools not listed in Groups 1 through 1-f; Jacking of pipe - under 12 inches

GROUP 3: Construction laborers, including bridge and general laborer; Dump, load spotter; Flag person; Fire watcher; Fence erector; Guardrail erector; Gardener, horticultural and landscape laborer; Jetting; Limber, brush loader and piler; Pavement marker (button setter); Maintenance, repair track and road beds; Streetcar and railroad construction track laborer; Temporary air and water lines, Victaulic or

Hanks Exchange Road at Squaw Hollow Creek Bridge Replacement
Contract No. 3916, CIP No 77135
February 25, 2020

similar; Tool room attendant (jobsite only)

GROUP 4: Final clean-up work of debris, grounds and building including but not limited to: street cleaner; cleaning and washing windows; brick cleaner (jobsite only); material cleaner (jobsite only). The classification "material cleaner" is to be utilized under the following conditions:
A: at demolition site for the salvage of the material.

B: at the conclusion of a job where the material is to be salvaged and stocked to be reused on another job.

C: for the cleaning of salvage material at the jobsite or temporary jobsite yard.

The material cleaner classification should not be used in the performance of "form stripping, cleaning and oiling and moving to the next point of erection".

GUNITE LABORER CLASSIFICATIONS

GROUP 1: Structural Nozzleman

GROUP 2: Nozzleman, Gunman, Potman, Groundman

GROUP 3: Reboundman

GROUP 4: Guniting laborer

WRECKING WORK LABORER CLASSIFICATIONS

GROUP 1: Skilled wrecker (removing and salvaging of sash, windows and materials)

GROUP 2: Semi-skilled wrecker (salvaging of other building materials)

County of El Dorado
Agreement
C-56 REV

 LABO0185-008 07/01/2018

Rates	Fringes
Plasterer tender.....\$ 32.02 23.00	

Work on a swing stage scaffold:
 \$1.00 per hour additional.

GROUP
 3.....\$ 37.34
 24.11
 GROUP
 4.....\$ 36.89
 24.11
 GROUP
 5.....\$ 36.35
 24.11
 Shotcrete
 Specialist.....\$ 38.34
 24.11

 LABO0261-002 06/25/2018

MARIN COUNTY

Rates	Fringes
LABORER (TRAFFIC CONTROL/LANE CLOSURE) Escort Driver, Flag Person..\$ 30.54 23.65 Traffic Control Person I....\$ 30.84 23.65 Traffic Control Person II...\$ 28.34 23.65	

TRAFFIC CONTROL PERSON I:
 Layout of traffic control, crash
 cushions, construction area and
 roadside signage.

TRAFFIC CONTROL PERSON II:
 Installation and removal of
 temporary/permanent signs,
 markers, delineators and crash
 cushions.

TUNNEL AND SHAFT CLASSIFICATIONS

GROUP 1: Diamond driller;
 Groundmen; Gunite and shotcrete
 nozzlemen

GROUP 2: Rodmen; Shaft work &
 raise (below actual or
 excavated ground level)

GROUP 3: Bit grinder; Blaster,
 driller, powdermen, heading;
 Cherry pickermen - where car is
 lifted; Concrete finisher
 in tunnel; Concrete screedman;
 Grout pumpman and potman;
 Gunite & shotcrete gunman &
 potman; Headermen; High
 pressure nozzleman; Miner -
 tunnel, including top and
 bottom man on shaft and raise
 work; Nipper; Nozzleman on
 slick line; Sandblaster -
 potman, Robotic Shotcrete Placer,
 Segment Erector, Tunnel Muck
 Hauler, Steel Form raiser and
 setter; Timberman, retimberman
 (wood or steel or substitute
 materials therefore); Tugger
 (for tunnel laborer work);
 Cable tender; Chuck tender;
 Powderman - primer house

 LABO0261-004 06/25/2018

MARIN COUNTY

Rates	Fringes
Tunnel and Shaft Laborers: GROUP 1.....\$ 37.82 24.11 GROUP 2.....\$ 37.59 24.11	

GROUP 4: Vibrator operator,
 pavement breaker; Bull gang -
 muckers, trackmen; Concrete
 crew - includes rodding and
 spreading, Dumpmen (any method)

GROUP 5: Grout crew;
 Reboundman; Swamper/ Brakeman

 LABO0261-007 07/01/2018

MARIN AND NAPA COUNTIES

Hanks Exchange Road at Squaw Hollow Creek Bridge Replacement
 Contract No. 3916, CIP No 77135
 February 25, 2020

County of El Dorado
 Agreement
 C-57 REV

Rates Fringes
 LABORER
 Mason Tender-
 Brick.....\$ 32.45
 22.20

 LABO0261-010 06/25/2018

GROUP
 1.....\$ 30.75
 22.31
 GROUP
 2.....\$ 30.25
 22.31
 GROUP
 3.....\$ 29.66
 22.31
 GROUP
 4.....\$ 29.54
 22.31

MARIN COUNTY
 Rates Fringes
 LABORER (CONSTRUCTION CRAFT
 LABORERS - AREA A:)
 Construction Specialist

LABORER (WRECKING - AREA A:)
 GROUP
 1.....\$ 30.79
 23.20
 GROUP
 2.....\$ 30.64
 23.20

Group.....\$
 31.49 23.20
 GROUP
 1.....\$ 30.79
 23.20
 GROUP 1-
 a.....\$ 31.01
 23.20
 GROUP 1-
 c.....\$ 30.84
 23.20
 GROUP 1-
 e.....\$ 31.34
 23.20
 GROUP 1-
 f.....\$ 31.37
 23.20
 GROUP
 2.....\$ 30.64
 23.20
 GROUP
 3.....\$ 30.54
 23.20
 GROUP
 4.....\$ 24.23
 23.20

FOOTNOTES:
 Laborers working off or with or
 from bos'n chairs, swinging
 scaffolds, belts shall receive
 \$0.25 per hour above the
 applicable wage rate. This
 shall not apply to workers
 entitled to receive the wage
 rate set forth in Group 1-a
 below.

See groups 1-b and 1-d under
 laborer classifications.
 LABORER (GARDENERS,
 HORTICULTURAL & LANDSCAPE
 LABORERS - AREA A:)
 (1) New
 Construction.....\$ 30.54
 23.20
 (2) Establishment Warranty
 Period.....\$
 24.23 23.20
 LABORER (GUNITE - AREA A:)

LABORER CLASSIFICATIONS
 CONSTRUCTION SPECIALIST GROUP:
 Asphalt ironer and raker;
 Chainsaw; Laser beam in
 connection with laborers' work;
 Cast-in- place manhole form
 setter; Pressure pipelayer;
 Davis trencher - 300 or similar
 type (and all small
 trenchers); Blaster; Diamond
 driller; Multiple unit drill;
 Hydraulic drill
 GROUP 1: Asphalt spreader boxes
 (all types); Barko, Wacker
 and similar type tampers;
 Buggymobile; Caulker, bander,
 pipewrapper, conduit layer,
 plastic pipelayer; Certified
 hazardous waste worker
 including Leade Abatement;
 Compactors of all types;
 Concrete and magnesite mixer, 1/2

Hanks Exchange Road at Squaw Hollow Creek Bridge Replacement
 Contract No. 3916, CIP No 77135
 February 25, 2020

County of El Dorado
 Agreement
 C-58 REV

yd. and under; Concrete pan work; Concrete sander; Concrete saw; Cribber and/or shoring; Cut granite curb setter; Dri-pak-it machine; Faller, logloader and buckler; Form raiser, slip forms; Green cutter; Headerboard, Hubsetter, aligner, by any method; High pressure blow pipe (1-1/2" or over, 100 lbs. pressure/over); Hydro seeder and similar type; Jackhammer operator; Jacking of pipe over 12 inches; Jackson and similar type compactor; Kettle tender, pot and worker applying asphalt, lay-kold, creosote, lime, caustic and similar type materials (applying means applying, dipping or handling of such materials); Lagging, sheeting, whaling, bracing, trenchjacking, lagging hammer; Magnesite, epoxyresin, fiberglass, mastic worker (wet or dry); No joint pipe and stripping of same, including repair of voids; Pavement breaker and spader, including tool grinder; Perma curb; Pipelayer (including grade checking in connection with pipelaying); Precast-manhole setter; Pressure pipe tester; Post hole digger, air, gas and electric; Power broom sweeper; Power tampers of all types (except as shown in Group 2); Ram set gun and stud gun; Riprap stonepaver and rock-slinger, including placing of sacked concrete and/or sand (wet or dry) and gabions and similar type; Rotary scarifier or multiple head concrete chipping scarifier; Roto and Ditch Witch; Rototiller; Sandblaster, pot, gun, nozzle operators; Signalling and rigging; Tank cleaner; Tree climber; Turbo blaster; Vibrascreed, bull float in connection with laborers' work; Vibrator; Hazardous waste worker (lead removal); Asbestos and mold removal worker

GROUP 1-a: Joy drill model TWM-2A; Gardner-Denver model DH143 and similar type drills; Track driller; Jack leg driller; Wagon driller; Mechanical drillers, all types regardless of type or method of power; Mechanical pipe layers, all types regardless of type or method of power; Blaster and powder; All work of loading, placing and blasting of all powder and explosives of whatever type regardless of method used for such loading and placing; High scalers (including drilling of same); Tree topper; Bit grinder

GROUP 1-b: Sewer cleaners shall receive \$4.00 per day above Group 1 wage rates. "Sewer cleaner" means any worker who handles or comes in contact with raw sewage in small diameter sewers. Those who work inside recently active, large diameter sewers, and all recently active sewer manholes shall receive \$5.00 per day above Group 1 wage rates.

GROUP 1-c: Burning and welding in connection with laborers' work; Synthetic thermoplastics and similar type welding

GROUP 1-d: Maintenance and repair track and road beds. All employees performing work covered herein shall receive \$.25 per hour above their regular rate for all work performed on underground structures not specifically covered herein. This paragraph shall not be construed to apply to work below ground level in open cut. It shall apply to cut and cover work of subway construction after the temporary cover has been placed.

GROUP 1-e: Work on and/or in bell hole footings and shafts thereof, and work on and in deep footings. (A deep footing

is a hole 15 feet or more in depth.) In the event the depth of the footing is unknown at the commencement of excavation, and the final depth exceeds 15 feet, the deep footing wage rate would apply to all employees for each and every day worked on or in the excavation of the footing from the date of inception.

GROUP 1-f: Wire winding machine in connection with guniting or shot crete

GROUP 2: Asphalt shoveler; Cement dumper and handling dry cement or gypsum; Choke-setter and rigger (clearing work); Concrete bucket dumper and chute; Concrete chipping and grinding; Concrete laborer (wet or dry); Driller tender, chuck tender, nipper; Guinea chaser (stake), grout crew; High pressure nozzle, adductor; Hydraulic monitor (over 100 lbs. pressure); Loading and unloading, carrying and hauling of all rods and materials for use in reinforcing concrete construction; Pittsburgh chipper and similar type brush shredders; Sloper; Single foot, hand-held, pneumatic tamper; All pneumatic, air, gas and electric tools not listed in Groups 1 through 1-f; Jacking of pipe - under 12 inches

GROUP 3: Construction laborers, including bridge and general laborer; Dump, load spotter; Flag person; Fire watcher; Fence erector; Guardrail erector; Gardener, horticultural and landscape laborer; Jetting; Limber, brush loader and piler; Pavement marker (button setter); Maintenance, repair track and road beds; Streetcar and railroad construction track laborer; Temporary air and water lines, Victaulic or similar; Tool room attendant (jobsite only)

GROUP 4: Final clean-up work of debris, grounds and building including but not limited to: street cleaner; cleaning and washing windows; brick cleaner (jobsite only); material cleaner (jobsite only). The classification "material cleaner" is to be utilized under the following conditions: A: at demolition site for the salvage of the material. B: at the conclusion of a job where the material is to be salvaged and stocked to be reused on another job. C: for the cleaning of salvage material at the jobsite or temporary jobsite yard.

The material cleaner classification should not be used in the performance of "form stripping, cleaning and oiling and moving to the next point of erection".

GUNITE LABORER CLASSIFICATIONS

- GROUP 1: Structural Nozzleman
- GROUP 2: Nozzleman, Gunman, Potman, Groundman
- GROUP 3: Reboundman
- GROUP 4: Gunitite laborer

WRECKING WORK LABORER CLASSIFICATIONS

- GROUP 1: Skilled wrecker (removing and salvaging of sash, windows and materials)
- GROUP 2: Semi-skilled wrecker (salvaging of other building materials)

LABO0261-015 07/01/2018

Hanks Exchange Road at Squaw Hollow Creek Bridge Replacement
Contract No. 3916, CIP No 77135
February 25, 2020

County of El Dorado
Agreement
C-60 REV

Rates Fringes
 Plasterer
 tender.....\$ 32.02
 23.00
 Work on a swing stage scaffold:
 \$1.00 per hour additional.

 LABO0324-004 06/25/2018
 NAPA, SOLANO, AND SONOMA,
 COUNTIES

Rates Fringes
 LABORER (TRAFFIC CONTROL/LANE
 CLOSURE)
 Escort Driver, Flag
 Person..\$ 29.54 23.65
 Traffic Control Person
 I...\$ 29.84 23.65
 Traffic Control Person
 II...\$ 27.34 23.65
 TRAFFIC CONTROL PERSON I:
 Layout of traffic control, crash
 cushions, construction area and
 roadside signage.
 TRAFFIC CONTROL PERSON II:
 Installation and removal of
 temporary/permanent signs,
 markers, delineators and crash
 cushions.

 LABO0324-008 06/25/2018
 NAPA, SOLANO, AND SONOMA COUNTIES

Rates Fringes
 Tunnel and Shaft Laborers:
 GROUP
 1.....\$ 37.82
 24.11
 GROUP
 2.....\$ 37.59
 24.11
 GROUP
 3.....\$ 37.34
 24.11

GROUP
 4.....\$ 36.89
 24.11
 GROUP
 5.....\$ 36.35
 24.11
 Shotcrete
 Specialist.....\$ 38.34
 24.11

TUNNEL AND SHAFT CLASSIFICATIONS

GROUP 1: Diamond driller;
 Groundmen; Gunite and shotcrete
 nozzlemen

GROUP 2: Rodmen; Shaft work &
 raise (below actual or
 excavated ground level)

GROUP 3: Bit grinder; Blaster,
 driller, powdermen, heading;
 Cherry pickermen - where car is
 lifted; Concrete finisher
 in tunnel; Concrete screedman;
 Grout pumpman and potman;
 Gunite & shotcrete gunman &
 potman; Headermen; High
 pressure nozzleman; Miner -
 tunnel, including top and
 bottom man on shaft and raise
 work; Nipper; Nozzleman on
 slick line; Sandblaster -
 potman, Robotic Shotcrete Placer,
 Segment Erector, Tunnel Muck
 Hauler, Steel Form raiser and
 setter; Timberman, retimberman
 (wood or steel or substitute
 materials therefore); Tugger
 (for tunnel laborer work);
 Cable tender; Chuck tender;
 Powderman - primer house

GROUP 4: Vibrator operator,
 pavement breaker; Bull gang -
 muckers, trackmen; Concrete
 crew - includes rodding and
 spreading, Dumpmen (any method)

GROUP 5: Grout crew;
 Reboundman; Swamper/ Brakeman

 LABO0324-010 07/01/2018

SOLANO AND SONOMA COUNTIES

Rates Fringes
 Hanks Exchange Road at Squaw Hollow Creek Bridge Replacement
 Contract No. 3916, CIP No 77135
 February 25, 2020

County of El Dorado
 Agreement
 C-61 REV

LABORER
 Mason Tender-
 Brick.....\$ 31.45
 22.20

 LABO0324-013 06/25/2018
 NAPA, SOLANO, AND SONOMA COUNTIES

Rates	Fringes
LABORER (CONSTRUCTION CRAFT LABORERS - AREA B:) Construction Specialist	
Group.....\$	
30.49	23.20
GROUP	
1.....\$ 29.79	
23.20	
GROUP 1-	
a.....\$ 30.01	
23.20	
GROUP 1-	
c.....\$ 29.84	
23.20	
GROUP 1-	
e.....\$ 30.34	
23.20	
GROUP 1-	
f.....\$ 29.37	
23.20	
GROUP	
2.....\$ 29.64	
23.20	
GROUP	
3.....\$ 29.54	
23.20	
GROUP	
4.....\$ 23.23	
23.20	
See groups 1-b and 1-d under laborer classifications.	
LABORER (GARDENERS, HORTICULTURAL & LANDSCAPE LABORERS - AREA B:)	
(1) New	
Construction.....\$ 29.54	
23.20	
(2) Establishment Warranty	
Period.....\$	
23.23	23.20
LABORER (GUNITE - AREA B:)	
GROUP	
1.....\$ 29.75	
22.31	
Hanks Exchange Road at Squaw Hollow Creek Bridge Replacement	
Contract No. 3916, CIP No 77135	
February 25, 2020	

GROUP	
2.....\$ 29.25	
22.31	
GROUP	
3.....\$ 28.66	
22.31	
GROUP	
4.....\$ 28.54	
22.31	
LABORER (WRECKING - AREA B:)	
GROUP	
1.....\$ 29.79	
23.20	
GROUP	
2.....\$ 29.64	
23.20	
FOOTNOTES:	
Laborers working off or with or from bos'n chairs, swinging scaffolds, belts shall receive \$0.25 per hour above the applicable wage rate. This shall not apply to workers entitled to receive the wage rate set forth in Group 1-a below.	
----- -----	

LABORER CLASSIFICATIONS

CONSTRUCTION SPECIALIST GROUP:
 Asphalt ironer and raker;
 Chainsaw; Laser beam in
 connection with laborers' work;
 Cast-in- place manhole form
 setter; Pressure pipelayer;
 Davis trencher - 300 or similar
 type (and all small
 trenchers); Blaster; Diamond
 driller; Multiple unit drill;
 Hydraulic drill

GROUP 1: Asphalt spreader boxes
 (all types); Barko, Wacker
 and similar type tampers;
 Buggymobile; Caulker, bander,
 pipewrapper, conduit layer,
 plastic pipelayer; Certified
 hazardous waste worker
 including Leade Abatement;
 Compactors of all types;
 Concrete and magnesite mixer, 1/2
 yd. and under; Concrete pan
 work; Concrete sander; Concrete
 saw; Cribber and/or shoring;
 Cut granite curb setter;

County of El Dorado
 Agreement
 C-62 REV

Dri-pak-it machine; Faller, logloader and buckler; Form raiser, slip forms; Green cutter; Headerboard, Hubsetter, aligner, by any method; High pressure blow pipe (1-1/2" or over, 100 lbs. pressure/over); Hydro seeder and similar type; Jackhammer operator; Jacking of pipe over 12 inches; Jackson and similar type compactor; Kettle tender, pot and worker applying asphalt, lay-kold, creosote, lime, caustic and similar type materials (applying means applying, dipping or handling of such materials); Lagging, sheeting, whaling, bracing, trenchjacking, lagging hammer; Magnesite, epoxyresin, fiberglass, mastic worker (wet or dry); No joint pipe and stripping of same, including repair of voids; Pavement breaker and spader, including tool grinder; Perma curb; Pipelayer (including grade checking in connection with pipelaying); Precast-manhole setter; Pressure pipe tester; Post hole digger, air, gas and electric; Power broom sweeper; Power tampers of all types (except as shown in Group 2); Ram set gun and stud gun; Riprap stonepaver and rock-slinger, including placing of sacked concrete and/or sand (wet or dry) and gabions and similar type; Rotary scarifier or multiple head concrete chipping scarifier; Roto and Ditch Witch; Rototiller; Sandblaster, pot, gun, nozzle operators; Signalling and rigging; Tank cleaner; Tree climber; Turbo blaster; Vibrascreed, bull float in connection with laborers' work; Vibrator; Hazardous waste worker (lead removal); Asbestos and mold removal worker

GROUP 1-a: Joy drill model TWM-2A; Gardner-Denver model DH143 and similar type drills; Track driller; Jack leg driller;

Wagon driller; Mechanical drillers, all types regardless of type or method of power; Mechanical pipe layers, all types regardless of type or method of power; Blaster and powder; All work of loading, placing and blasting of all powder and explosives of whatever type regardless of method used for such loading and placing; High scalars (including drilling of same); Tree topper; Bit grinder

GROUP 1-b: Sewer cleaners shall receive \$4.00 per day above Group 1 wage rates. "Sewer cleaner" means any worker who handles or comes in contact with raw sewage in small diameter sewers. Those who work inside recently active, large diameter sewers, and all recently active sewer manholes shall receive \$5.00 per day above Group 1 wage rates.

GROUP 1-c: Burning and welding in connection with laborers' work; Synthetic thermoplastics and similar type welding

GROUP 1-d: Maintenance and repair track and road beds. All employees performing work covered herein shall receive \$.25 per hour above their regular rate for all work performed on underground structures not specifically covered herein. This paragraph shall not be construed to apply to work below ground level in open cut. It shall apply to cut and cover work of subway construction after the temporary cover has been placed.

GROUP 1-e: Work on and/or in bell hole footings and shafts thereof, and work on and in deep footings. (A deep footing is a hole 15 feet or more in depth.) In the event the depth of the footing is unknown at the commencement of

excavation, and the final depth exceeds 15 feet, the deep footing wage rate would apply to all employees for each and every day worked on or in the excavation of the footing from the date of inception.

GROUP 1-f: Wire winding machine in connection with guniting or shot crete

GROUP 2: Asphalt shoveler; Cement dumper and handling dry cement or gypsum; Choke-setter and rigger (clearing work); Concrete bucket dumper and chute; Concrete chipping and grinding; Concrete laborer (wet or dry); Driller tender, chuck tender, nipper; Guinea chaser (stake), grout crew; High pressure nozzle, adductor; Hydraulic monitor (over 100 lbs. pressure); Loading and unloading, carrying and hauling of all rods and materials for use in reinforcing concrete construction; Pittsburgh chipper and similar type brush shredders; Sloper; Single foot, hand-held, pneumatic tamper; All pneumatic, air, gas and electric tools not listed in Groups 1 through 1-f; Jacking of pipe - under 12 inches

GROUP 3: Construction laborers, including bridge and general laborer; Dump, load spotter; Flag person; Fire watcher; Fence erector; Guardrail erector; Gardener, horticultural and landscape laborer; Jetting; Limber, brush loader and piler; Pavement marker (button setter); Maintenance, repair track and road beds; Streetcar and railroad construction track laborer; Temporary air and water lines, Victaulic or similar; Tool room attendant (jobsite only)

GROUP 4: Final clean-up work of debris, grounds and building including but not limited to: street cleaner; cleaning and

washing windows; brick cleaner (jobsite only); material cleaner (jobsite only). The classification "material cleaner" is to be utilized under the following conditions: A: at demolition site for the salvage of the material. B: at the conclusion of a job where the material is to be salvaged and stocked to be reused on another job. C: for the cleaning of salvage material at the jobsite or temporary jobsite yard.

The material cleaner classification should not be used in the performance of "form stripping, cleaning and oiling and moving to the next point of erection".

GUNITE LABORER CLASSIFICATIONS

- GROUP 1: Structural Nozzleman
- GROUP 2: Nozzleman, Gunman, Potman, Groundman
- GROUP 3: Reboundman
- GROUP 4: Guniting laborer

WRECKING WORK LABORER CLASSIFICATIONS

- GROUP 1: Skilled wrecker (removing and salvaging of sash, windows and materials)
- GROUP 2: Semi-skilled wrecker (salvaging of other building materials)

LABO0324-019 07/01/2018

Rates Fringes

Hanks Exchange Road at Squaw Hollow Creek Bridge Replacement
Contract No. 3916, CIP No 77135
February 25, 2020

County of El Dorado
Agreement
C-64 REV

Plasterer
tender.....\$ 32.02
23.00

Work on a swing stage scaffold:
\$1.00 per hour additional.

PAIN0016-004 01/01/2019

MARIN, NAPA, SOLANO & SONOMA
COUNTIES

Rates Fringes
Painters:.....
\$ 42.67 24.03

PREMIUMS:
EXOTIC MATERIALS - \$0.75
additional per hour.
SPRAY WORK: - \$0.50 additional
per hour.
INDUSTRIAL PAINTING - \$0.25
additional per hour
[Work on industrial buildings
used for the manufacture and
processing of goods for sale or
service; steel construction
(bridges), stacks, towers,
tanks, and similar structures]

HIGH WORK:
over 50 feet - \$2.00 per hour
additional
100 to 180 feet - \$4.00 per hour
additional
Over 180 feet - \$6.00 per hour
additional

PAIN0016-005 01/01/2020

ALPINE, BUTTE, COLUSA, EL DORADO
(west of the Sierra Nevada
Mountains), GLENN, LASSEN (west
of Hwy. 395, excluding Honey
Lake); MARIN, MODOC, NAPA, NEVADA
(west of the Sierra Nevada
Mountains), PLACER (west of the
Sierra Nevada Mountains),
PLUMAS, SACRAMENTO, SHASTA,
SIERRA (west of the Sierra Nevada
Mountains), SISKIYOU, SOLANO,
SONOMA, SUTTER, TEHAMA, TRINITY,
YOLO AND YUBA COUNTIES

Hanks Exchange Road at Squaw Hollow Creek Bridge Replacement
Contract No. 3916, CIP No 77135
February 25, 2020

Rates Fringes

DRYWALL
FINISHER/TAPER.....\$ 47.38
25.99

PAIN0016-007 01/01/2019

ALPINE, AMADOR, BUTTE, COLUSA. EL
DORADO (west of the Sierra
Nevada Mountains), GLENN, LASSEN
(west of Highway 395,
excluding Honey Lake), MODOC,
NEVADA (west of the Sierra Nevada
Mountains), PLACER (west of the
Sierra Nevada Mountains),
PLUMAS, SACRAMENTO, SHASTA,
SIERRA (west of the Sierra Nevada
Mountains), SISKIYOU, SUTTER,
TEHAMA, TRINITY, YOLO & YUBA
COUNTIES

Rates Fringes

Painters:.....
\$ 33.68 20.24

SPRAY/SANDBLAST: \$0.50 additional
per hour.
EXOTIC MATERIALS: \$1.00
additional per hour.
HIGH TIME: Over 50 ft above
ground or water level \$2.00
additional per hour. 100 to
180 ft above ground or water
level \$4.00 additional per
hour. Over 180 ft above ground
or water level \$6.00 additional
per hour.

PAIN0016-008 01/01/2019

MARIN, NAPA, SOLANO AND SONOMA
COUNTIES

Rates Fringes

SOFT FLOOR
LAYER.....\$ 48.60
27.43

PAIN0169-004 07/01/2019

County of El Dorado
Agreement
C-65 REV

MARIN , NAPA & SONOMA COUNTIES;
 SOLANO COUNTY (west of a line
 defined as follows: Hwy. 80
 corridor beginning at the City of
 Fairfield, including Travis Air
 Force Base and Suisun City;
 going north of Manakas Corner
 Rd., continue north on Suisun
 Valley Rd. to the Napa County
 line; Hwy. 80 corridor south on
 Grizzly Island Rd. to the Grizzly
 Island Management area)

Rates	Fringes
GLAZIER.....	
\$ 50.62	29.10

* PAIN0567-001 07/01/2018	

EL DORADO COUNTY (east of the
 Sierra Nevada Mountains); LASSEN
 COUNTY (east of Highway 395,
 beginning at Stacey and including
 Honey Lake); NEVADA COUNTY (east
 of the Sierra Nevada
 Mountains); PLACER COUNTY (east
 of the Sierra Nevada
 Mountains); AND SIERRA COUNTY
 (east of the Sierra Nevada
 Mountains)

Rates	Fringes
Painters:	
Brush and	
Roller.....	\$ 26.70
13.04	
Spray Painter &	
Paperhanger.	\$ 28.04
13.04	

PREMIUMS:
 Special Coatings (Brush), and
 Sandblasting = \$0.50/hr
 Special Coatings (Spray), and
 Steeplejack = \$1.00/hr
 Special Coating Spray Steel =
 \$1.25/hr
 Swing Stage = \$2.00/hr

*A special coating is a coating
 that requires the mixing of 2
 or more products.

Hanks Exchange Road at Squaw Hollow Creek Bridge Replacement
Contract No. 3916, CIP No 77135
 February 25, 2020

County of El Dorado
Agreement
 C-66 REV

 PAIN0567-007 07/01/2019

EL DORADO COUNTY (east of the
 Sierra Nevada Mountains); LASSEN
 COUNTY (east of Highway 395,
 beginning at Stacey and including
 Honey Lake); NEVADA COUNTY (east
 of the Sierra Nevada
 Mountains); PLACER COUNTY (east
 of the Sierra Nevada Mountains)
 AND SIERRA COUNTY (east of the
 Sierra Nevada Mountains)

Rates	Fringes
SOFT FLOOR	
LAYER.....	\$ 30.30
14.44	

PAIN0567-010 07/01/2019	

EL DORADO COUNTY (east of the
 Sierra Nevada Mountains); LASSEN
 COUNTY (east of Highway 395,
 beginning at Stacey and including
 Honey Lake); NEVADA COUNTY (east
 of the Sierra Nevada
 Mountains); PLACER COUNTY (east
 of the Sierra Nevada
 Mountains); AND SIERRA COUNTY
 (east of the Sierra Nevada
 Mountains)

Rates	Fringes
Drywall	
(1)	
Taper.....	\$ 33.41
13.63	
(2) Steeplejack - Taper, over 40 ft with open space	
below.....	\$
34.91	13.63

PAIN0767-004 07/01/2019	

ALPINE, AMADOR, BUTTE, COLUSA, EL
 DORADO, GLENN, LASSEN, MODOC,

NEVADA, PLACER, PLUMAS,
 SACRAMENTO, SHASTA, SIERRA,
 SISKIYOU,
 SOLANO (Remainder), SUTTER,
 TEHAMA, TRINITY, YOLO, YUBA

Rates	Fringes
GLAZIER.....	
\$ 39.06	29.31

PAID HOLIDAYS: New Year's Day,
 Martin Luther King, Jr. Day,
 President's Day, Memorial Day,
 Independence Day, Labor Day,
 Veteran's Day, Thanksgiving
 Day, and Christmas Day.

Employee required to wear a body
 harness shall receive \$1.50
 per hour above the basic hourly
 rate at any elevation.

 PAIN1176-001 07/01/2019

HIGHWAY IMPROVEMENT

Rates	Fringes
Parking Lot Striping/Highway Marking: GROUP	
1.....	\$ 37.68
15.38	
GROUP	
2.....	\$ 32.03
15.38	
GROUP	
3.....	\$ 32.40
15.38	

CLASSIFICATIONS

GROUP 1: Striper: Layout and
 application of painted traffic
 stripes and marking; hot thermo
 plastic; tape, traffic
 stripes and markings

GROUP 2: Gamecourt & Playground
 Installer

GROUP 3: Protective Coating,
 Pavement Sealing

Hanks Exchange Road at Squaw Hollow Creek Bridge Replacement
 Contract No. 3916, CIP No 77135
 February 25, 2020

County of El Dorado
 Agreement
 C-67 REV

 PAIN1237-001 01/01/2020

ALPINE; COLUSA; EL DORADO (west
 of the Sierra Nevada
 Mountains); GLENN; LASSEN (west
 of Highway 395, beginning at
 Stacey and including Honey Lake);
 MODOC; NEVADA (west of the
 Sierra Nevada Mountains); PLACER
 (west of the Sierra Nevada
 Mountains); PLUMAS; SACRAMENTO;
 SHASTA; SIERRA (west of the
 Sierra Nevada Mountains);
 SISKIYOU; SUTTER; TEHAMA;
 TRINITY;
 YOLO AND YUBA COUNTIES

Rates	Fringes
SOFT FLOOR LAYER.....	\$ 39.61
22.59	

 PLAS0300-003 07/01/2018

Rates	Fringes
PLASTERER	
AREA 295: Alpine, Amador, Butte, Colusa, El Dorado, Glenn, Lassen, Modoc, Nevada, Placer, Plumas, Sacramento, Shasta, Sierra, Siskiyou, Solano, Sutter, Tehama, Trinity, Yolo & Yuba Counties.....	\$ 32.70
31.68	
AREA 355:	
Marin.....	\$ 36.73
31.68	
AREA 355: Napa & Sonoma Counties.....	\$ 32.70
32.70	31.68

 PLAS0300-005 07/01/2017

Rates	Fringes
-------	---------

CEMENT MASON/CONCRETE
 FINISHER...\$ 33.49
 23.67

PLUMBER.....
 \$ 41.25 33.14

 PLUM0038-002 07/01/2019
 MARIN AND SONOMA COUNTIES

 PLUM0343-001 07/01/2019
 NAPA AND SOLANO COUNTIES

Rates	Fringes
PLUMBER (Plumber, Steamfitter, Refrigeration Fitter)	
	(1) Work on wooden frame structures 5 stories or less excluding hgih-rise buildings and commercial work such as hospitals, prisons, hotels, schools, casinos, wastewater treatment plants, and resarch facilities as well as refrigeration pipefitting, service and repair work - MARKET RECOVERY
RATE.....\$ 74.16	
43.59	
	(2) All other work - NEW CONSTRUCTION
RATE.....\$ 74.16	
43.59	

Rates	Fringes
PLUMBER/PIPEFITTER	
Light	
Commercial.....\$ 30.85	
20.40	
	All Other
Work.....\$ 52.50	
37.37	

DEFINITION OF LIGHT COMMERCIAL:
 Work shall include strip
 shopping centers, office
 buildings,
 schools and other commercial
 structures which the total
 plumbing bid does not exceed
 Two Hundred and Fifty Thousand
 (\$250,000) and the total
 heating and cooling does not
 exceed Two Hundred Fifty
 Thousand (\$250,000); or Any
 projects bid in phases shall
 not qualify unless the total
 project is less than Two
 Hundred Fifty Thousand (\$250,000)
 for the plumbing bid; and Two
 Hundred Fifty Thousand
 (\$250,000) for the heating and
 cooling bid. Excluded are
 hospitals, jails, institutions
 and industrial projects,
 regardless size of the project

 PLUM0038-006 07/01/2019
 MARIN & SONOMA COUNTIES

Rates	Fringes
Landscape/Irrigation Fitter (Underground/Utility Fitter).....\$ 63.04	
31.48	

FOOTNOTES: While fitting
 galvanized material: \$.75 per
 hour
 additional. Work from trusses,
 temporary staging,
 unguarded structures 35' from
 the ground or water: \$.75 per
 hour additional. Work from
 swinging scaffolds, boatswains
 chairs or similar devices: \$.75
 per hour additional.

 PLUM0228-001 01/01/2020
 BUTTE, COLUSA, GLENN, LASSEN,
 MODOC, PLUMAS, SHASTA, SIERRA,
 SISKIYOU, SUTTER, TEHAMA, TRINITY
 & YUBA COUNTIES

 PLUM0350-001 08/01/2019

Rates	Fringes
-------	---------

Hanks Exchange Road at Squaw Hollow Creek Bridge Replacement
Contract No. 3916, CIP No 77135
 February 25, 2020

County of El Dorado
Agreement
 C-68 REV

EL DORADO COUNTY (Lake Tahoe area only); NEVADA COUNTY (Lake Tahoe area only); AND PLACER COUNTY (Lake Tahoe area only)

Journeyman.....\$
 49.67 25.00
 Light Commercial
 Work.....\$ 36.23
 17.72

Rates Fringes
 PLUMBER/PIPEFITTER.....
 \$ 45.84 13.81

 ROOF0081-006 08/01/2019

 MARIN, NAPA, SOLANO AND SONOMA
 COUNTIES

 PLUM0355-001 07/01/2019

 ALPINE, AMADOR, BUTTE, COLUSA, EL
 DORADO, GLENN, LASSEN, MODOC,
 NAPA, NEVADA, PLACER, PLUMAS,
 SACRAMENTO, SHASTA, SIERRA,
 SISKIYOU, SOLANO, SUTTER, TEHAMA,
 TRINITY, YOLO, AND YUBA
 COUNTIES

Rates Fringes
 Roofer.....
 \$ 40.10 18.88

 ROOF0081-007 08/01/2019

Rates Fringes
 Underground Utility Worker
 /Landscape
 Fitter.....\$ 29.00
 15.80

 ALPINE, BUTTE, COLUSA, EL DORADO,
 GLENN, LASSEN, MODOC, NEVADA,
 PLACER, PLUMAS, SACRAMENTO,
 SHASTA, SIERRA, SISKIYOU, SUTTER,
 TEHAMA, TRINITY, YOLO, AND YUBA
 COUNTIES

 PLUM0442-003 01/01/2020

 AMADOR (South of San Joaquin
 River) and ALPINE COUNTIES

Rates Fringes
 Roofer.....
 \$ 38.28 18.56

 SFCA0483-003 07/29/2019

Rates Fringes
 PLUMBER.....
 \$ 44.50 31.39

 MARIN, NAPA, SOLANO AND SONOMA
 COUNTIES

 PLUM0447-001 07/01/2018

 AMADOR (north of San Joaquin
 River), EL DORADO (excluding Lake
 Tahoe area), NEVADA (excluding
 Lake Tahoe area); PLACER
 (excluding Lake Tahoe area),
 SACRAMENTO AND YOLO COUNTIES

Rates Fringes
 SPRINKLER FITTER (Fire
 Sprinklers).....
 \$ 65.52 32.67

 SFCA0669-003 04/01/2019

Rates Fringes
 PLUMBER/PIPEFITTER

 ALPINE, BUTTE, COLUSA, EL DORADO,
 GLENN, LASSEN, MODOC, NEVADA,
 PLACER, PLUMAS, SACRAMENTO,
 SHASTA, SIERRA, SISKIYOU, SUTTER,
 TEHAMA, TRINITY, YOLO AND YUBA
 COUNTIES

Hanks Exchange Road at Squaw Hollow Creek Bridge Replacement
 Contract No. 3916, CIP No 77135
 February 25, 2020

County of El Dorado
 Agreement
 C-69 REV

Rates Fringes

SPRINKLER
 FITTER.....\$ 40.77
 23.93

 SHEE0104-006 07/01/2019

MARIN, NAPA, SOLANO SONOMA &
 TRINITY COUNTIES

Rates Fringes

Sheet Metal Worker
 Mechanical Contracts
 \$200,000 or
 less.....\$ 53.67
 44.62
 All other
 work.....\$ 61.36
 46.11

 SHEE0104-009 07/01/2019

AMADOR, COLUSA, EL DORADO,
 NEVADA, PLACER, SACRAMENTO,
 SUTTER,
 YOLO AND YUBA COUNTIES

Rates Fringes

SHEET METAL
 WORKER.....\$ 44.00
 39.63

 SHEE0104-010 07/01/2019

ALPINE COUNTY

Rates Fringes

SHEET METAL
 WORKER.....\$ 41.20
 36.84

 SHEE0104-011 07/01/2019

BUTTE, COLUSA, EL DORADO, GLENN,
 LASSEN, MODOC, NEVADA, PLACER,
 PLUMAS, SACRAMENTO, SHASTA,
 SIERRA, SISKIYOU, SUTTER, TEHAMA,

Hanks Exchange Road at Squaw Hollow Creek Bridge Replacement
 Contract No. 3916, CIP No 77135
 February 25, 2020

YOLO AND YUBA COUNTIES

Rates Fringes

Sheet Metal Worker (Metal
 decking and siding
 only).....\$ 44.00
 39.63

 SHEE0104-014 07/01/2019

MARIN, NAPA, SOLANO, SONOMA AND
 TRINITY COUNTIES

Rates Fringes

SHEET METAL WORKER (Metal
 Decking and Siding
 only).....\$ 42.33
 35.30

 SHEE0104-019 07/01/2019

BUTTE, GLENN, LASSEN, MODOC,
 PLUMAS, SHASTA, SIERRA, SISKIYOU
 AND TEHAMA COUNTIES

Rates Fringes

SHEET METAL WORKER
 Mechanical Jobs \$200,000 &
 under.....\$
 33.31 35.30
 Mechanical Jobs over
 \$200,000.....\$
 44.00 35.30

 TEAM0094-001 07/01/2018

Rates Fringes

Truck drivers:
 GROUP
 1.....\$ 31.68
 27.86
 GROUP
 2.....\$ 31.98
 27.86

County of El Dorado
 Agreement
 C-70 REV

GROUP
 3.....\$ 32.28
 27.86
 GROUP
 4.....\$ 32.63
 27.86
 GROUP
 5.....\$ 32.98
 27.86

Rubber-tired muck car (not self-loaded); Rubber-tired truck jumbo; Winch truck and "A" frame drivers; Combination winch truck with hoist; Road oil truck or bootperson; Buggymobile; Ross, Hyster and similar straddle carriers; Small rubber-tired tractor

FOOTNOTES:

Articulated dump truck; Bulk cement spreader (with or without auger); Dumpcrete truck; Skid truck (debris box); Dry pre-batch concrete mix trucks; Dumpster or similar type; Slurry truck: Use dump truck yardage rate.
 Heater planer; Asphalt burner; Scarifier burner; Industrial lift truck (mechanical tailgate); Utility and clean-up truck: Use appropriate rate for the power unit or the equipment utilized.

GROUP 3: Dump trucks, 8 yds. and including 24 yds.; Transit mixers, over 10 yds.; Water trucks, 7,000 gals. and over; Jetting trucks, 7,000 gals. and over; Vacuum trucks under 7500 gals. Trucks towing tilt bed or flat bed pull trailers; Lowbed heavy duty transport; Heavy duty transport tiller person; Self-propelled street sweeper with self-contained refuse bin; Boom truck - hydro-lift or Swedish type extension or retracting crane; P.B. or similar type self-loading truck; Tire repairperson; Combination bootperson and road oiler; Dry distribution truck (A bootperson when employed on such equipment, shall receive the rate specified for the classification of road oil trucks or bootperson); Ammonia nitrate distributor, driver and mixer; Snow Go and/or plow

TRUCK DRIVER CLASSIFICATIONS

GROUP 1: Dump trucks, under 6 yds.; Single unit flat rack (2-axle unit); Nipper truck (when flat rack truck is used appropriate flat rack shall apply); Concrete pump truck (when flat rack truck is used appropriate flat rack shall apply); Concrete pump machine; Fork lift and lift jitneys; Fuel and/or grease truck driver or fuel person; Snow buggy; Steam cleaning; Bus or personhaul driver; Escort or pilot car driver; Pickup truck; Teamster oiler/greaser and/or serviceperson; Hook tender (including loading and unloading); Team driver; Tool room attendant (refineries)

GROUP 4: Dump trucks, over 25 yds. and under 65 yds.; Water pulls - DW 10's, 20's, 21's and other similar equipment when pulling Aqua/pak or water tank trailers; Helicopter pilots (when transporting men and materials); Lowbedk Heavy Duty Transport up to including 7 axles; DW10's, 20's, 21's and other similar Cat type, Terra Cobra, LeTourneau Pulls, Tournorocker, Euclid and similar type equipment when pulling fuel and/or grease tank trailers or other miscellaneous trailers; Vacuum Trucks 7500 gals and over and truck repairman

GROUP 2: Dump trucks, 6 yds. and under 8 yds.; Transit mixers, through 10 yds.; Water trucks, under 7,000 gals.; Jetting trucks, under 7,000 gals.; Single-unit flat rack (3-axle unit); Highbed heavy duty transport; Scissor truck;

GROUP 5: Dump trucks, 65 yds. and over; Holland hauler; Low

Hanks Exchange Road at Squaw Hollow Creek Bridge Replacement
 Contract No. 3916, CIP No 77135
 February 25, 2020

County of El Dorado
 Agreement
 C-71 REV

bed Heavy Duty Transport over 7
axles

WELDERS - Receive rate prescribed
for craft performing
operation to which welding is
incidental.

=====
=====

Note: Executive Order (EO) 13706,
Establishing Paid Sick Leave
for Federal Contractors applies
to all contracts subject to the
Davis-Bacon Act for which the
contract is awarded (and any
solicitation was issued) on or
after January 1, 2017. If this
contract is covered by the EO,
the contractor must provide
employees with 1 hour of paid
sick leave for every 30 hours
they work, up to 56 hours of paid
sick leave each year.
Employees must be permitted to
use paid sick leave for their
own illness, injury or other
health-related needs, including
preventive care; to assist a
family member (or person who is
like family to the employee) who
is ill, injured, or has other
health-related needs, including
preventive care; or for reasons
resulting from, or to assist a
family member (or person who is
like family to the employee) who
is a victim of, domestic
violence, sexual assault, or
stalking. Additional information
on contractor requirements and
worker protections under the EO
is available at
www.dol.gov/whd/govcontracts.

Unlisted classifications needed
for work not included within
the scope of the classifications
listed may be added after
award only as provided in the
labor standards contract clauses
(29CFR 5.5 (a) (1) (ii)).

Hanks Exchange Road at Squaw Hollow Creek Bridge Replacement
Contract No. 3916, CIP No 77135
February 25, 2020

The body of each wage
determination lists the
classification
and wage rates that have been
found to be prevailing for the
cited type(s) of construction in
the area covered by the wage
determination. The
classifications are listed in
alphabetical
order of "identifiers" that
indicate whether the particular
rate is a union rate (current
union negotiated rate for local),
a survey rate (weighted average
rate) or a union average rate
(weighted union average rate).

Union Rate Identifiers

A four letter classification
abbreviation identifier enclosed
in dotted lines beginning with
characters other than "SU" or
"UAVG" denotes that the union
classification and rate were
prevailing for that
classification in the survey.

Example:

PLUM0198-005 07/01/2014. PLUM is
an abbreviation identifier of
the union which prevailed in the
survey for this
classification, which in this
example would be Plumbers. 0198
indicates the local union number
or district council number
where applicable, i.e., Plumbers
Local 0198. The next number,
005 in the example, is an
internal number used in
processing
the wage determination.
07/01/2014 is the effective date
of the
most current negotiated rate,
which in this example is July 1,
2014.

Union prevailing wage rates are
updated to reflect all rate
changes in the collective
bargaining agreement (CBA)
governing
this classification and rate.

Survey Rate Identifiers

County of El Dorado
Agreement
C-72 REV

Classifications listed under the "SU" identifier indicate that no one rate prevailed for this classification in the survey and the published rate is derived by computing a weighted average rate based on all the rates reported in the survey for that classification. As this weighted average rate includes all rates reported in the survey, it may include both union and non-union rates. Example: SULA2012-007 5/13/2014. SU indicates the rates are survey rates based on a weighted average calculation of rates and are not majority rates. LA indicates the State of Louisiana. 2012 is the year of survey on which these classifications and rates are based. The next number, 007 in the example, is an internal number used in producing the wage determination. 5/13/2014 indicates the survey completion date for the classifications and rates under that identifier.

Survey wage rates are not updated and remain in effect until a new survey is conducted.

Union Average Rate Identifiers

Classification(s) listed under the UAVG identifier indicate that no single majority rate prevailed for those classifications; however, 100% of the data reported for the classifications was union data. EXAMPLE: UAVG-OH-0010 08/29/2014. UAVG indicates that the rate is a weighted union average rate. OH indicates the state. The next number, 0010 in the example, is an internal number used in producing the wage determination. 08/29/2014 indicates the survey completion date for the classifications and rates under that identifier.

A UAVG rate will be updated once a year, usually in January of each year, to reflect a weighted average of the current

Hanks Exchange Road at Squaw Hollow Creek Bridge Replacement
Contract No. 3916, CIP No 77135
February 25, 2020

negotiated/CBA rate of the union locals from which the rate is based.

WAGE
DETERMINATION APPEALS PROCESS

1.) Has there been an initial decision in the matter? This can be:

- * an existing published wage determination
- * a survey underlying a wage determination
- * a Wage and Hour Division letter setting forth a position on a wage determination matter
- * a conformance (additional classification and rate) ruling

On survey related matters, initial contact, including requests for summaries of surveys, should be with the Wage and Hour Regional Office for the area in which the survey was conducted because those Regional Offices have responsibility for the Davis-Bacon survey program. If the response from this initial contact is not satisfactory, then the process described in 2.) and 3.) should be followed.

With regard to any other matter not yet ripe for the formal process described here, initial contact should be with the Branch of Construction Wage Determinations. Write to:

Branch of
Construction Wage Determinations
Wage and Hour
Division
U.S. Department of
Labor
200 Constitution
Avenue, N.W.
Washington, DC 20210

County of El Dorado
Agreement
C-73 REV

2.) If the answer to the question in 1.) is yes, then an interested party (those affected by the action) can request review and reconsideration from the Wage and Hour Administrator (See 29 CFR Part 1.8 and 29 CFR Part 7). Write to:

Wage and Hour
Administrator
U.S. Department of
Labor
200 Constitution
Avenue, N.W.
Washington, DC 20210

The request should be accompanied by a full statement of the interested party's position and by any information (wage payment data, project description, area practice material, etc.) that the requestor considers relevant to the issue.

3.) If the decision of the Administrator is not favorable, an interested party may appeal directly to the Administrative Review Board (formerly the Wage Appeals Board). Write to:

Administrative Review
Board
U.S. Department of
Labor
200 Constitution
Avenue, N.W.
Washington, DC 20210

4.) All decisions by the Administrative Review Board are final.

=====
=====

END OF GENERAL
DECISION"

PROPOSAL PAY ITEMS AND BID PRICE SCHEDULE
HANKS EXCHANGE ROAD AT SQUAW HOLLOW CREEK BRIDGE REPLACEMENT
CONTRACT NO. 3916, CIP NO. 77135

ITEM NO.	ITEM CODE	ITEM DESCRIPTION	UNIT OF MEASURE	ESTIMATED QUANTITY	UNIT PRICE (IN FIGURES)	ITEM TOTAL (IN FIGURES)
1	70030	LEAD COMPLIANCE PLAN	LS	1		
2	72007A	EXCAVATION SAFETY	LS	1		
3	80050	PROGRESS SCHEDULE (CRITICAL PATH METHOD)	LS	1		
4	100100	DEVELOP WATER SUPPLY	LS	1		
5	120090	CONSTRUCTION AREA SIGNS	LS	1		
6	120090A	CONSTRUCTION PROJECT INFORMATION SIGNS	LS	1		
7	120100	TRAFFIC CONTROL SYSTEM	LS	1		
8	128601A	PORTABLE TEMPORARY SIGNAL SYSTEM	LS	1		
9	128651A	PORTABLE CHANGEABLE MESSAGE SIGN	SWD	231		
10	129000	TEMPORARY RAILING (TYPE K)	LF	160		
11	129110	TEMPORARY CRASH CUSHION	EA	1		
12	130100	JOB SITE MANAGEMENT	LS	1		
13	130300	PREPARE STORM WATER POLLUTION PREVENTION PLAN	LS	1		
14	130310	RAIN EVENT ACTION PLAN	EA	5		
15	130330	STORM WATER ANNUAL REPORT	EA	1		
16	130580A	TEMPORARY STREAM DIVERSION	LS	1		
17	130680	TEMPORARY SILT FENCE	LF	550		
18	131103	WATER QUALITY SAMPLING AND ANALYSIS DAY	EA	5		
19	131104	WATER QUALITY MONITORING REPORT	EA	5		
20	141000A	TEMPORARY FENCE (TYPE ESA)	LF	2,000		
21	149001A	PREPARE FUGITIVE DUST CONTROL PLAN	LS	1		
22	170103	CLEARING AND GRUBBING (LS)	LS	1		

Hanks Exchange Road at Squaw Hollow Creek Bridge Replacement
Contract No. 3916, CIP No. 77135
February 25, 2020

County of El Dorado
Proposal
Page P-3 REV

ORIGINAL SCALE IS IN INCHES
 Drawing name: C:\Civil_3D\Projects\77135 Hanks Exchange Rd. at Squaw Hollow Creek Bridge\CADD Files\Streets\TR-Sheets.dwg Layout Tab: TR-1 Mar 18, 2020 - 11:36am SMC\ey
 FOR REDUCED PLANS
 2
 1
 0

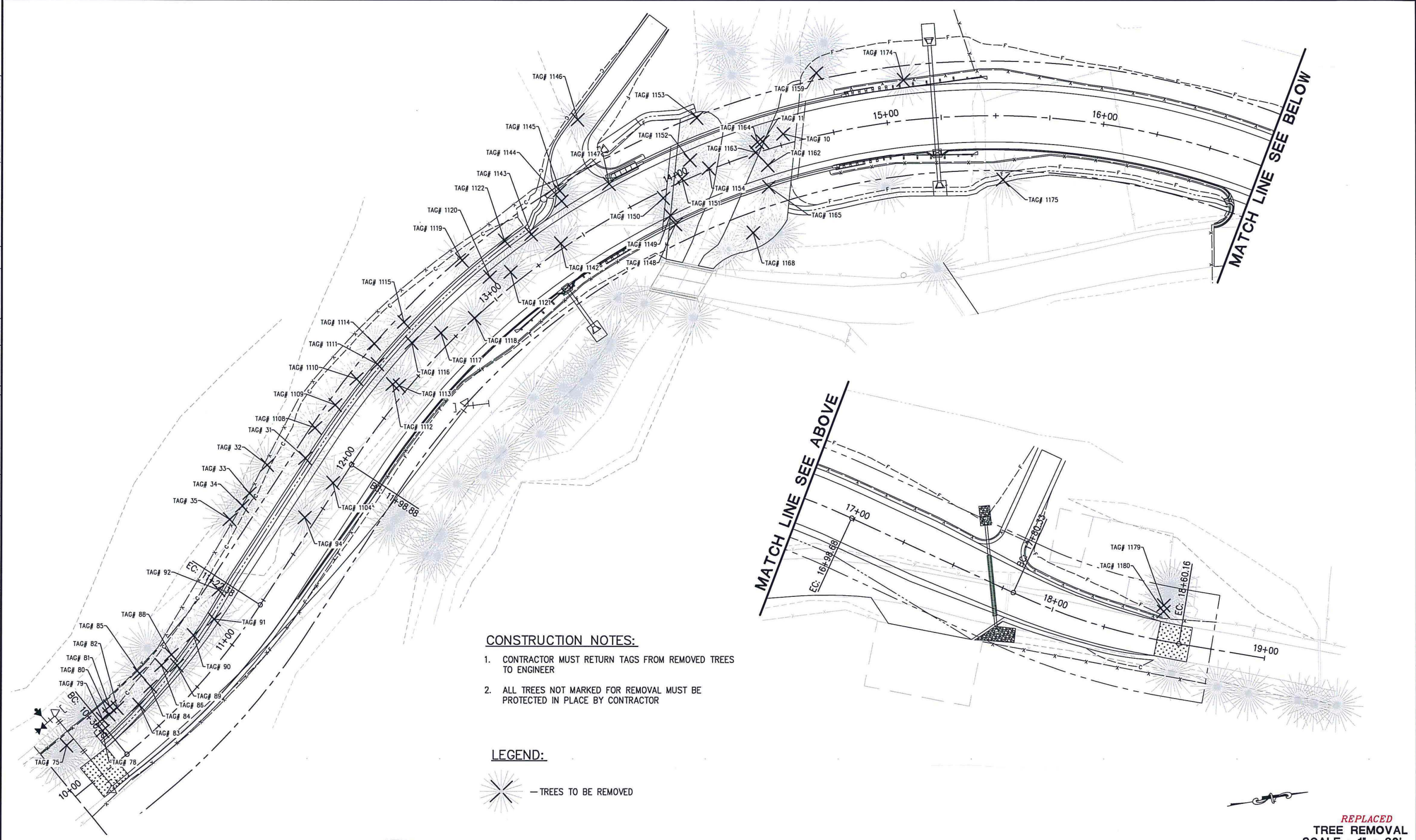

- CONSTRUCTION NOTES:**
1. CONTRACTOR MUST RETURN TAGS FROM REMOVED TREES TO ENGINEER
 2. ALL TREES NOT MARKED FOR REMOVAL MUST BE PROTECTED IN PLACE BY CONTRACTOR

LEGEND:

— TREES TO BE REMOVED

REVISION	NUMBER	DATE	DESCRIPTION	BY
	1	03/17/20	ADDENDUM #1	ZO



PREPARED UNDER THE SUPERVISION OF:

ZSO

REGISTERED CIVIL ENGINEER
 DATE: 02/07/20

DESIGNED: ZO
 DRAWN: SGM
 CHECKED: CG
 DATE: 01/09/20
 ROAD NUMBER: 032



COUNTY OF EL DORADO
 DEPARTMENT OF TRANSPORTATION

HANKS EXCHANGE RD AT SQUAW
 HOLLOW CREEK

REPLACED
 TREE REMOVAL
 SCALE : 1" = 20'

SHEET
 TR-17
 24 OF 44
 W.D. No. 77135

ORIGINAL SCALE IS IN INCHES
 Drawing name: C:\Civil 3D Projects\77135 Hanks Exchange Rd. at Squaw Hollow Creek Bridge\CADD Files\Sheets\TR-Sheets.dwg Layout Tab: TR-2 Mar 19, 2020 - 8:18am SMC\lev

TREE REMOVAL TABLE			
TAG NUMBER	'OAK' LINE STATION	OFFSET	DESCRIPTION & DIA.
10	14+52.30	4.76' LT	0.80" CEDAR
11	14+42.33	4.11' LT	0.86" RIPARIAN
31	11+90.01	19.38' LT	0.89" PINE
32	11+77.89	32.27' LT	0.83" CEDAR
33	11+62.60	31.98' LT	1.08" CEDAR
34	11+55.92	31.62' LT	1.31" CEDAR
35	11+47.61	33.08' LT	1.11" CEDAR
75	10+11.74	20.61' LT	0.67" CEDAR
78	10+28.67	15.30' LT	1.02" CEDAR
79	10+32.15	19.48' LT	0.80" CEDAR
80	10+35.92	19.25' LT	0.83" CEDAR
81	10+38.87	21.86' LT	0.95" CEDAR
82	10+41.11	19.10' LT	0.89" CEDAR
83	10+49.92	13.30' LT	1.02" CEDAR
84	10+60.11	15.77' LT	0.80" OAK (FORKED)
85	10+60.76	23.41' LT	1.15" CEDAR
86	10+71.15	18.75' LT	1.24" CEDAR
88	10+78.25	18.70' LT	1.18" CEDAR
89	10+76.16	13.53' LT	0.89" OAK
90	10+92.35	16.64' LT	0.73" OAK
91	11+04.61	13.68' LT	0.86" OAK
92	11+17.45	19.75' LT	1.72" CEDAR
94	11+67.01	4.79' LT	0.38" OAK (CLUSTER)
1104 *	11+87.39	2.63' LT	2.67" PINE
1108 *	12+03.80	23.24' LT	2.04" CEDAR
1109	12+16.74	21.66' LT	0.95" CEDAR
1110 *	12+31.30	21.03' LT	2.04" CEDAR
1111 *	12+42.01	17.82' LT	2.36" CEDAR
1112	12+39.54	6.55' LT	1.37", 0.89" CEDAR (FORKED)
1113 *	12+40.98	3.80' LT	2.26" CEDAR
1114 *	12+47.82	25.11' LT	2.99" CEDAR
1115 *	12+63.32	21.55' LT	3.28" CEDAR
1116 *	12+59.07	12.43' LT	1.69" PINE
1117	12+71.31	5.85' LT	0.57", 1.50" CEDAR (FORKED)
1118 *	12+87.03	0.12' LT	2.01" PINE
1119	12+99.85	23.61' LT	0.99" OAK
1120	13+04.45	9.63' LT	0.76" CEDAR
1121	13+13.09	5.33' LT	0.51" CEDAR
1122	13+19.49	18.46' LT	1.15" OAK

TREE REMOVAL TABLE			
TAG NUMBER	'OAK' LINE STATION	OFFSET	DESCRIPTION & DIA.
1142	13+39.06	2.37' LT	1.31" OAK
1143	13+30.56	13.46' LT	1.37" CEDAR
1144	13+49.72	18.36' LT	0.57" OAK
1145	13+51.43	22.80' LT	0.76" CEDAR
1146	13+72.85	46.65' LT	0.48" OAK
1147 *	13+71.60	13.97' LT	2.26" CEDAR
1148	13+90.44	16.55' RT	1.46" OAK
1149 *	13+90.06	11.85' RT	2.32" PINE
1150 *	13+90.56	3.28' RT	2.13" CEDAR
1151 *	14+02.10	1.13' LT	1.88" OAK
1152 *	14+08.82	7.47' LT	1.97" OAK
1153 *	14+18.48	24.26' LT	2.26" OAK
1154	14+15.31	0.72' LT	1.21" ALDER
1159	14+72.91	28.12' LT	1.59" OAK
1162 *	14+41.50	7.02' RT	2.13" OAK
1163	14+37.86	0.33' LT	0.48", 0.41" ALDER (FORKED)
1164	14+40.11	4.55' LT	0.51" ALDER
1165	14+38.82	16.52' RT	1.11" CEDAR
1168 *	14+24.14	34.05' RT	2.42", 0.92" PINE (FORKED)
1174 *	15+09.57	18.48' LT	2.83" OAK
1175	15+53.89	29.26' RT	0.76", 1.02", 0.95" FRUIT (CLUSTER)
1179	18+49.86	16.09' LT	1.27" OAK
1180	18+50.46	13.25' LT	0.83" OAK

 * TREES TO BE CUT INTO 16' LENGTHS AND STORED IN DESIGNATED AREA APPROVED BY PROPERTY OWNER

REVISED
 TREE REMOVAL
 SCALE : NONE

REVISION	NUMBER	DATE	DESCRIPTION	BY
	1	03/17/20	ADDendum #1	ZO

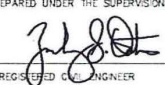

PREPARED UNDER THE SUPERVISION OF:

 REGISTERED CIVIL ENGINEER
 DATE: 02/07/20

DESIGNED: ZO
 DRAWN: SGM
 CHECKED: CG
 DATE: 01/09/20
 ROAD NUMBER: 032



COUNTY OF EL DORADO
 DEPARTMENT OF TRANSPORTATION

HANKS EXCHANGE RD AT SQUAW
 HOLLOW CREEK

SHEET
 TR-27
 25 OF 44
 W.O. No. 77135