

**STANDARD AGREEMENT** — APPROVED BY THE ATTORNEY GENERAL

D. 2 (REV. 5-91)

CONTRACT NUMBER CTA-97014	AM. NO. 1
TAXPAYER'S FEDERAL EMPLOYER IDENTIFICATION NUMBER	

THIS AGREEMENT, made and entered into this 1st day of January, 1999, between the State of California, by and between State of California, through its duly elected or appointed, qualified and acting

OFFICER ACTING FOR STATE Executive Officer	AGENCY California Tahoe Conservancy
---	--

hereafter called the State, and

CONTRACTOR'S NAME  
County of El Dorado

hereafter called the Contractor.

WITNESSETH: That the Contractor for and in consideration of the covenants, conditions, agreements, and stipulations of the State hereinafter expressed, does hereby agree to furnish to the State services and materials as follows: (Set forth service to be rendered by Contractor, amount to be paid Contractor, time for performance or completion, and attach plans and specifications, if any.)

The Agreement numbered CTA-97014 (hereafter "the Agreement") between the California Tahoe Conservancy (hereafter "the Conservancy") and the County of El Dorado (hereafter "Grantee") is hereby amended as follows:

1. The amount of the grant from the Conservancy to Grantee, for the purpose of the acquisition of real property or interests, therein for the Cascade, Silvertip, Upper Angora Creek and Woodland/Tamarack/Lonely Gulch Erosion Control Project(s) as provided in Paragraph 1a - Scope of Agreement and Paragraph 4 - Costs and Disbursements, is increased by one hundred twenty-eight thousand one hundred dollars (\$128,100) to a total of four hundred sixty-three thousand eight hundred dollars (\$463,800).

ATTEST: DIXIE L. FOOTE, Clerk of the Board of Supervisors

By Margaret B. Moody  
Deputy 3-2-99

CONTINUED ON 2 SHEETS, EACH BEARING NAME OF CONTRACTOR AND CONTRACT NUMBER.

The provisions on the reverse side hereof constitute a part of this agreement.

WITNESS WHEREOF, this agreement has been executed by the parties hereto, upon the date first above written.

<b>STATE OF CALIFORNIA</b>		<b>CONTRACTOR</b>				
AGENCY California Tahoe Conservancy		CONTRACTOR (If other than an individual, state whether a corporation, partnership, etc.) County of El Dorado <u>3-2-99</u>				
AUTHORIZED SIGNATURE <u>Dennis T. Machida</u>		BY (AUTHORIZED SIGNATURE) <u>E. Mark Nielsen</u> Chairman				
PRINTED NAME OF PERSON SIGNING Dennis T. Machida		PRINTED NAME AND TITLE OF PERSON SIGNING <b>E. MARK NIELSEN</b>				
TITLE Executive Officer		ADDRESS 360 Fair Lane, Placerville, CA 95667				
AMOUNT ENCUMBERED BY THIS AGREEMENT 128,100	PROGRAM/CATEGORY (CODE AND TITLE) Capital Outlay & Local Assistance (OPTIONAL USE) CTC Code 145714	FUND TITLE General Fund		Department of General Services Use Only  <b>RECEIVED</b>  APR 01 1999  CALIFORNIA TAHOE CONSERVANCY		
GRAND TOTAL AMOUNT ENCUMBERED FOR CONTRACT 335,700	ITEM 3125-301-0001(3)	CHAPTER 282	STATUTE 97			FISCAL YEAR 98/99
AMOUNT ENCUMBERED TO DATE 463,800	OBJECT OF EXPENDITURE (CODE AND TITLE) <u>3125-751-32000</u>					
I certify upon my own personal knowledge that budgeted funds are available for the period and purpose of the expenditure stated above.		T.B.A. NO.	B.R. NO.			
SIGNATURE OF ACCOUNTING OFFICER <u>Leonora P. Company</u>		DATE <u>3/29/99</u>				

# STANDARD AGREEMENT

CS 2 (REV. 5-91) (REVISED)

1. The Contractor agrees to indemnify, defend and save harmless the State, its officers, agents and employees from any and all claims and losses accruing or resulting to any and all contractors, subcontractors, materialmen, laborers and any other person, firm or corporation furnishing or supplying work services, materials or supplies in connection with the performance of this contract, and from any and all claims and losses accruing or resulting to any person, firm or corporation who may be injured or damaged by the Contractor in the performance of this contract.
2. The Contractor, and the agents and employees of Contractor, in the performance of the agreement, shall act in an independent capacity and not as officers or employees or agents of State of California.
3. The State may terminate this agreement and be relieved of the payment of any consideration to Contractor should Contractor fail to perform the covenants herein contained at the time and in the manner herein provided. In the event of such termination the State may proceed with the work in any manner deemed proper by the State. The cost to the State shall be deducted from any sum due the Contractor under this agreement, and the balance, if any, shall be paid the Contractor upon demand.
4. Without the written consent of the State, this agreement is not assignable by Contractor either in whole or in part.
5. Time is of the essence in this agreement.
6. No alteration or variation of the terms of this contract shall be valid unless made in writing and signed by the parties hereto, and no oral understanding or agreement not incorporated herein, shall be binding on any of the parties hereto.
7. The consideration to be paid Contractor, as provided herein, shall be in compensation for all of Contractor's expenses incurred in the performance hereof, including travel and per diem, unless otherwise expressly so provided.

2. Paragraph 2 - Incorporation of Documents by reference is amended as provided below:

Exhibit A, the Conservancy's staff recommendation containing the Conservancy's resolution of April 24, 1998, is amended through the addition of Exhibit A-1, the Conservancy's staff recommendation containing the Conservancy's resolution of December 11, 1998.

Exhibit B, the Project Schedule and Budget is amended through the addition of Exhibit-B-1 the Revised Project Schedule and Budget for Silvertip Erosion Control Project.

In the event of any inconsistency between or among the main body of this Agreement and the above documents, the inconsistency shall be resolved, except as otherwise provided herein, by giving precedence in the following order: (1) Conservancy Resolution; (2) the body of the Agreement; (3) the detailed description of the property; (4) the Model Deed language; (5) the Project Schedule; (6) the Conservancy staff recommendation; (7) the Grantee's List of Assurance's and (8) the Sample Request for Disbursement Form.

3. The signature of the Executive Officer of the Conservancy on this amendment certifies that at its December 11, 1998 meeting, the Conservancy approved an amendment and augmentation of the grant to Grantee under Agreement CTA-97014 of one hundred twenty-eight thousand one hundred dollars (\$128,100), for the implementation of the project described in Exhibit A, as amended by the addition of Exhibit A-1.
4. All other terms and conditions of the original Agreement numbered CTA-97014 shall remain unchanged in full force and effect.

EXHIBIT A-1

Tahoe Conservancy  
Staff Recommendation  
12-98-2  
December 11, 1998

Silvertip Erosion Control Project  
Land Acquisition Grant Augmentation

**REQUESTED ACTION:** Authorization of an acquisition grant augmentation to El Dorado County for the implementation of the Silvertip Erosion Control Project.

**LOCATION:** On the west shore of Lake Tahoe in the Meeks Bay Vista Subdivision. The project is located between State Highway 89 and Lake Tahoe, just north of Silvertip Drive (Exhibit 1).

**FISCAL SUMMARY:**

Requested Acquisition Augmentation: \$128,100  
Source of Funds: General Fund

Prior Conservancy Grants:  
April 1998 Acquisition Grant: 22,400  
April 1998 Site Improvement Grant: 193,900  
Total of Previously Authorized  
Conservancy Grants: \$216,300

**OTHER FUNDING SOURCES:**

Tahoe Regional Planning Agency (TRPA)  
Water Quality Mitigation Funds \$241,400

**RECOMMENDATION:** Staff recommends that the Conservancy adopt the following resolution pursuant to Government Code Sections 66905 et seq. and 66907.7:

"The California Tahoe Conservancy hereby authorizes a grant augmentation of up to \$128,100 to the County of El Dorado for the acquisition of various interests in real property and related costs, and authorizes staff to amend the existing standard grant agreement and to take all other steps, as substantially described and subject to provisions and conditions discussed in the accompanying staff report and exhibits, necessary to fund and implement the Silvertip Erosion Control Project.

"The augmentation of the grant and the disbursement of funds is conditioned upon a commitment by resolution and through execution of a standard agreement by the County to undertake the project in a manner consistent with the purpose and scope of the grant, to monitor the effectiveness of the project, and to manage and maintain the project consistent with the purposes and scope of the grant."

## STAFF DISCUSSION:

### I. Introduction

On November 22, 1985, the Conservancy adopted program guidelines and criteria and authorized staff to take steps to initiate a soil erosion control grants program. Since 1985, the Conservancy has approved grants totalling \$39.2 million for 80 projects, including \$30.6 million for site improvements and \$8.6 million for the acquisition of various interests in real property.

The Silvertip Erosion Control Project is in a problem area south of Meeks Bay where pollution is discharging directly into Lake Tahoe. Runoff from the undeveloped watershed and the subdivision west of State Highway 89 collects along El Dorado County roads and the State highway and is discharged to the east through an 18-inch culvert just north of Silvertip Drive. During heavy runoff events, flows from the culvert discharge onto well-vegetated, but steep, Conservancy and California Department of Transportation (Caltrans) parcels. Below these undeveloped parcels, the uncontrolled flows pass through properties and roads in the Meeks Bay Vista Subdivision and cause erosion along a steep lakeside cliff just above Lake Tahoe. Storm flows carry nutrient and sediment through the project area, and can contribute to instability on the steep slopes above the lake. The problem areas are shown on Exhibit 2A.

In April 1998, the Conservancy awarded a total of \$216,300 in site improvement (\$193,900) and land acquisition (\$22,400) grants for the project. Additional funds for site improvements are available from TRPA and are being sought from Caltrans. The small Conservancy acquisition grant enabled the County to start the acquisition process, and it was anticipated in the April 1998 staff recommendation that the County would apply for additional acquisition funding in the 1998-99 fiscal year. The County is designing the project this winter and has asked for an acquisition augmentation at this time to keep the project on schedule for construction during the 1999 field season.

### II. Project Background

During planning for a 1994 Caltrans project along State Highway 89, Caltrans requested a license to construct an outlet basin and check dams on the Conservancy parcel and the USFS parcel below the existing culvert. Since the Caltrans proposal did not include provisions to convey flows between the Conservancy parcel and Lake Tahoe, Conservancy and El Dorado County staff worked on a conceptual plan for a more comprehensive project. The conceptual plan proposed to convey flows below the steep Conservancy parcel in culverts or rock-lined ditches to a treatment basin on two Conservancy parcels with gentler slopes, just west of Meeks Bay Avenue. All of the narrow lakefront parcels east of Meeks Bay Avenue have been developed, so easements will be needed for improvements to carry flows across developed parcels and down the steep cliff above Lake Tahoe.

The County did not proceed with this proposal due to property owner concerns. Instead, the landowners supported a Caltrans proposal to install a basin and dam on the steep parcels below an 18-inch roadside culvert. In June 1994, staff notified the Conservancy of the Caltrans request for a license to construct an outlet basin and a check dam on Conservancy property (El Dorado County Assessor Parcel Number 16-101-56) just east of State Highway 89. A license agreement between the Conservancy, Caltrans and El Dorado County was signed on June 30, 1994 for the

purpose of allowing Caltrans to construct, and El Dorado County to operate and maintain, these improvements on the Conservancy parcel.

The improvements were built on the Conservancy and Caltrans parcels in 1994. Minor erosion and sediment accumulation problems were seen after large storms, and residents continued to construct small diversions to keep uncontrolled runoff from damaging their property. The January 1997 rain-on-snow storm sent large, uncontrolled flows through the subdivision, and a significant slope failure occurred on the lakeside slope on one of the privately-owned parcels. Because of the 1997 storm damage, residents now recognize the need for a comprehensive project to convey flows through the subdivision, and the County believes that easements necessary to construct the proposed improvements can be obtained.

After obtaining Conservancy acquisition and site improvement grant funding last spring, County staff held a public meeting with project area property owners to answer questions about the project and receive property owner input on the project design. The County met with the owners of the three proposed easements in September 1998, and the site visit for appraisal work has been completed. Since the previous grant only covered pre-acquisition activities, funds are needed at this time to acquire the critical lakefront easements, identified in the April 1998 grant, on parcels that had been damaged by the January 1997 storms. Land acquisition costs are approximately \$37,000 higher than originally estimated in the initial grant because it reflected estimates prepared before the preliminary appraisal work began, and additional County staff time is needed for negotiations with the property owners and discussions with affected owners and nearby residents about the appearance and function of improvements in the easements. If it is determined during project design that additional acquisitions are needed to increase the effectiveness of the project, the County may request additional funds at a later date.

### III. Project Description

Staff is recommending approval of a \$128,100 grant augmentation request by El Dorado County. This augmentation will provide funds needed for the purchase of drainage easements to safely convey flows to treatment areas and down to Lake Tahoe. If approved by the board, the cumulative total of the acquisition grant will be \$150,510. The total amount of authorized grants for this project will be \$344,400.

The project objectives are to reduce soil erosion and sediment deposition caused by stormwater runoff flowing through the project area, and to collect, convey and treat stormwater runoff originating within the project area. To reduce sediment and nutrient delivery to Lake Tahoe, the County proposes to:

- infiltrate and treat runoff from small or moderate events in sediment traps and in a new basin on relatively gentle slopes on Conservancy parcels west of Meeks Bay Avenue;
- construct stable rock-lined ditches and install culverts to reduce erosion while conveying flows below the State highway into and below the treatment basin and down the steep slopes to the lake; and
- stabilize disturbed slopes with vegetation, erosion control blankets, or other measures needed to protect the conveyance improvements while blending in with existing vegetation and structures.

Rock-lined ditches are proposed to complement the existing improvements and to help convey flows down the steep slopes below State Highway 89. Culverts will carry the runoff northeast to the Conservancy parcels west of Meeks Bay Avenue. An infiltration basin on these parcels will be designed to provide storage for storm runoff, while fitting into the neighborhood. Flows that exceed the basin capacity will be routed into a culvert and conveyed under Meeks Bay Avenue and down the steep slopes to the lake. The owner of the lakefront property damaged by the January 1997 storms has already stabilized this steep slope, and the County will shore up the culvert down the steep slope with measures such as a slurry mix backfill. An energy dissipation structure at the lake outfall will be needed to complete the system to convey storms flows from the State Highway 89 culvert to the lake. The conceptual improvement plan (Exhibit 2B) shows the proposed improvements.

As described in the April 1998 Project Synopsis, the County anticipates a need to acquire easements on three privately-owned parcels and license agreements on three Conservancy parcels. Upon completion of the final design, staff proposes to grant easements or licenses, pursuant to a previous board authorization, to construct and maintain improvements on the Conservancy parcels. Exhibit 3 contains a preliminary list and map showing proposed acquisitions and the publicly-owned parcels for which license agreements or use permits are needed.

Improvements currently proposed for the project include approximately 320 feet of storm drain culverts, three sediment traps, 180 feet of rock-lined ditches, one water quality treatment basin, one outlet structure at the lake, and 17,000 square feet of revegetation.

### III. Project Budget and Schedule

The following is the estimated budget and schedule for the augmented acquisition grant:

<b>ACQUISITION BUDGET ITEMS</b>			
Easements		(3 Parcels)	\$94,930
Appraisals, Escrow, Negotiations			\$6,300
Survey for R.O.W.			\$12,800
Design and Administration			\$22,800
Contingency			\$13,670
<b>TOTAL</b>			<b>\$150,500</b>
Appraisals, Escrow, Negotiations			\$3,700
Survey for R.O.W.			\$6,400
Design and Administration			\$10,270
Contingency			\$2,040
Available from PREVIOUS GRANT	(April 1998 CTC acquisition grant)		\$22,400
<b>TOTAL Required for Acquisition Augmentation</b>			<b>\$128,100</b>

ACQUISITION SCHEDULE	
Request Preliminary Title Reports	September 1998
Request Appraisals	September 1998
Submit Appraisal and Preliminary Title Reports for CTC Review	December 1998
CTC Approval of Appraisal and Preliminary Title Reports	February 1999
Negotiation and Agreement of Sales	March 1999
CTC Approval of Instruments of Conveyance, Escrow Instructions and Purchase Agreements	May 1999
Close of Escrow	June 1999

It should be noted that the project budget and schedule should be viewed as preliminary. The final determination of costs may necessitate reallocation of funds between budget items. However, changes will not exceed the total amount awarded in the grant.

#### IV. Consistency With Criteria

##### Significant and documentable benefit to Lake Tahoe water quality

Erosion and drainage problems are evident on this site. Sediment accumulation and scouring are evident below the culvert at State Highway 89. The steep slopes above the lake are threatened by uncontrolled storm runoff. Runoff carried through the subdivision discharges directly into Lake Tahoe. Stabilizing the drainageways and providing sediment traps and detention basins for treatment will reduce the nutrient and sediment delivery to the lake.

TRPA's Lake Tahoe Basin Water Quality Plan (208 Plan) states that management practices necessary to control the problems associated with streets, roads, and highways should be geared toward infiltration of runoff, revegetation of denuded areas, and stabilization of unstable drainages, slopes, and shoulders. Without proper stabilization these areas are potential sediment sources which can affect Lake Tahoe. According to the 208 Plan, street and road networks, in combination with existing development, represent by far the largest source of elevated sediment and nutrient loads from watersheds. Studies in other parts of the country indicate that best management practices (BMPs) can reduce yields of suspended sediment from small urbanized areas by 80 to 100 percent, and yields of phosphorus and nitrogen by 40 to 80 percent. The long-term decline in lake clarity has been associated with increased algal productivity. Studies by the Tahoe Research Group have indicated that the lake is now phosphorus-limited; adding phosphorus to the lake increases algal productivity more than other nutrients like nitrogen. Algal growth is particularly responsive to the combination of nutrients, trace elements, and natural organic compounds released by the erosion of Tahoe watersheds. Since phosphorus adheres to sediment, it enters Lake Tahoe attached to sediment contained in surface runoff, particularly fine sediment. Soil erosion control projects work to control phosphorus and other waterborne nutrient inputs to tributaries and the lake by reducing and preventing excess erosion with site improvements incorporating BMPs. Reducing sediment transport through erosion control projects is one of the most implementable methods to reduce delivery of the nutrients that most stimulate algal growth in the lake.



Drainage improvements, such as rock-lined channels and storm drain culverts, reduce erosion by decreasing the velocity of runoff and by protecting underlying soils. Sediment traps and infiltration and treatment basins help remove sediment and nutrients from storm runoff. The infiltration and treatment improvements also may attenuate the peak flows. Site improvements from this project will contribute to the goal of bringing all County roads into compliance with the 208 Plan's BMPs by 2008, and will reduce the threat that uncontrolled runoff from large storms poses to steep slopes above the lake. This project will assist in meeting the TRPA thresholds and is consistent with the objectives of the Environmental Improvement Program.

#### Adequacy of design

The proposed combination of treatment measures and their placement on the site are appropriate for addressing the identified problems within the project area. Proven erosion control techniques will be used, including rock-lined ditches, sediment traps and basins, culverts, and revegetation. These treatment measures will reduce the sediment and nutrient loads currently being discharged to Lake Tahoe.

#### Comprehensiveness

The proposed improvements address the identified erosion problems within the project area, and indicate the County is willing to treat problems and stabilize flows that are conveyed in a culvert under State Highway 89.

#### Implementability

The project is expected to be implementable since many of the improvements will be constructed on Conservancy parcels. The County proposes to acquire three easements which are located along existing flow paths. Uncontrolled runoff from the January 1997 storms has caused problems on these parcels, and the owners appear to support this project. The County is in the process of settling a claim with one of these parcel owners related to damage from this storm. County staff has been in contact with owners of adjacent parcels. Based on correspondence and meetings with these property owners, the County believes that residents of the project area support the project.

#### Support

Both Lahontan Regional Water Quality Control Board and TRPA staff support the proposed improvements.

#### V. California Environmental Quality Act (CEQA) Compliance

As part of the application for the previous grant approved in April 1998, El Dorado County prepared a Mitigated Negative Declaration for the project. The County determined that, with the proposed mitigation measures, this project will not have a significant effect on the environment, and the County filed a Notice of Determination with the State Clearinghouse (Exhibit 4). A copy of the Mitigated Negative Declaration for the project is being transmitted separately to the board and is available for review at the Conservancy's office.

In accordance with Section 15096 of the State CEQA Guidelines, the Conservancy is required to consider the environmental effects of a project as shown in a Negative Declaration prior to reaching a decision on this project. The board, as part of its approval of the April 1998 grant for the Silvertip project, concurred with the County's findings and also filed a Notice of Determination (Exhibit 5). In staff's opinion, based, in part, on consultation with staff from the Department of General Services' Real Estate Services Division, the current funding request is for project elements that are within the project description contained in the Negative Declaration, and there are no new significant environmental impacts that were not previously analyzed. Therefore, if the board concurs, no new environmental documents will be filed.

EXHIBIT 1

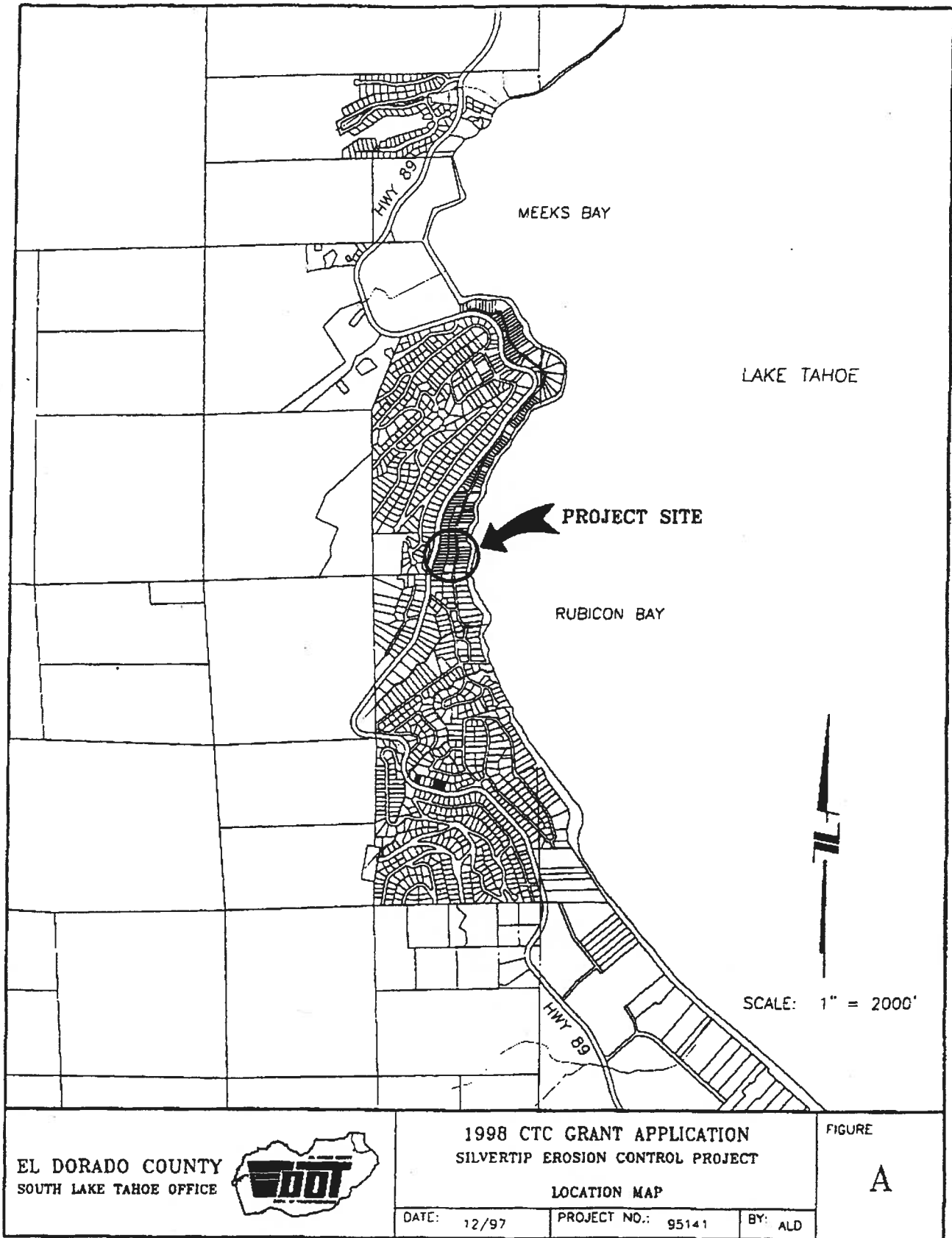

EL DORADO COUNTY  
SOUTH LAKE TAHOE OFFICE



1998 CTC GRANT APPLICATION  
SILVERTIP EROSION CONTROL PROJECT

LOCATION MAP

FIGURE

A

DATE: 12/97

PROJECT NO.: 95141

BY: ALD

EXHIBIT 2A

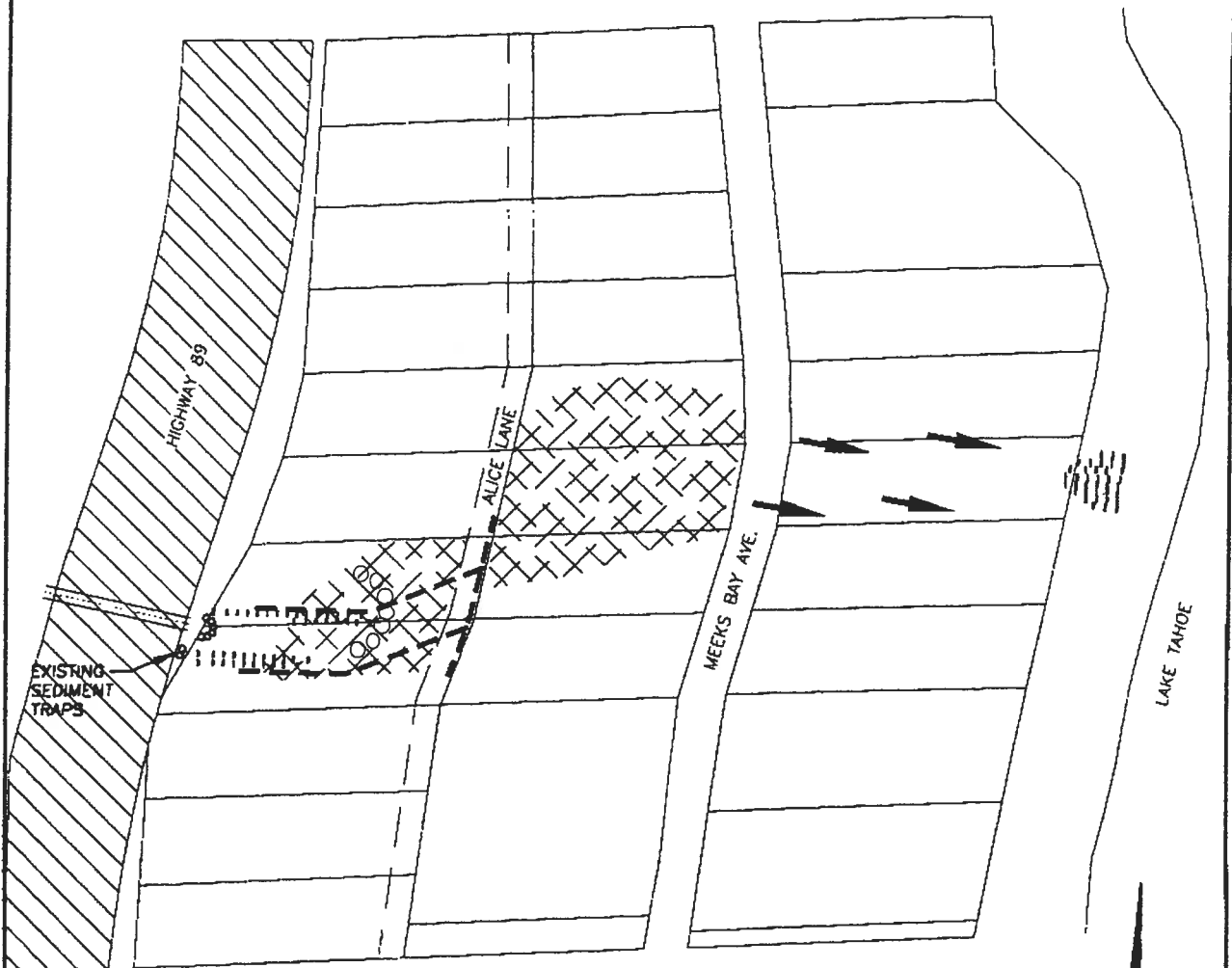

**LEGEND**

- DIRECTION OF RUNOFF
- ERODING SLOPE OR SHOULDER
- ERODING DRAINAGE
- WINTER SAND APPLICATION
- AREAS OF SEDIMENT ACCUMULATION
- APPROX. LOCATION OF EXIST. PIPE
- APPROX. LOCATION OF EXISTING ROCK CHECK DAM

SCALE: 1" = 100'



EL DORADO COUNTY  
SOUTH LAKE TAHOE OFFICE



1998 CTC GRANT APPLICATION  
SILVERTIP EROSION CONTROL PROJECT  
PROBLEM AREA MAP

FIGURE  
B

DATE: 1/98	PROJECT NO.: 95141	BY: ALD
------------	--------------------	---------

EXHIBIT 2B

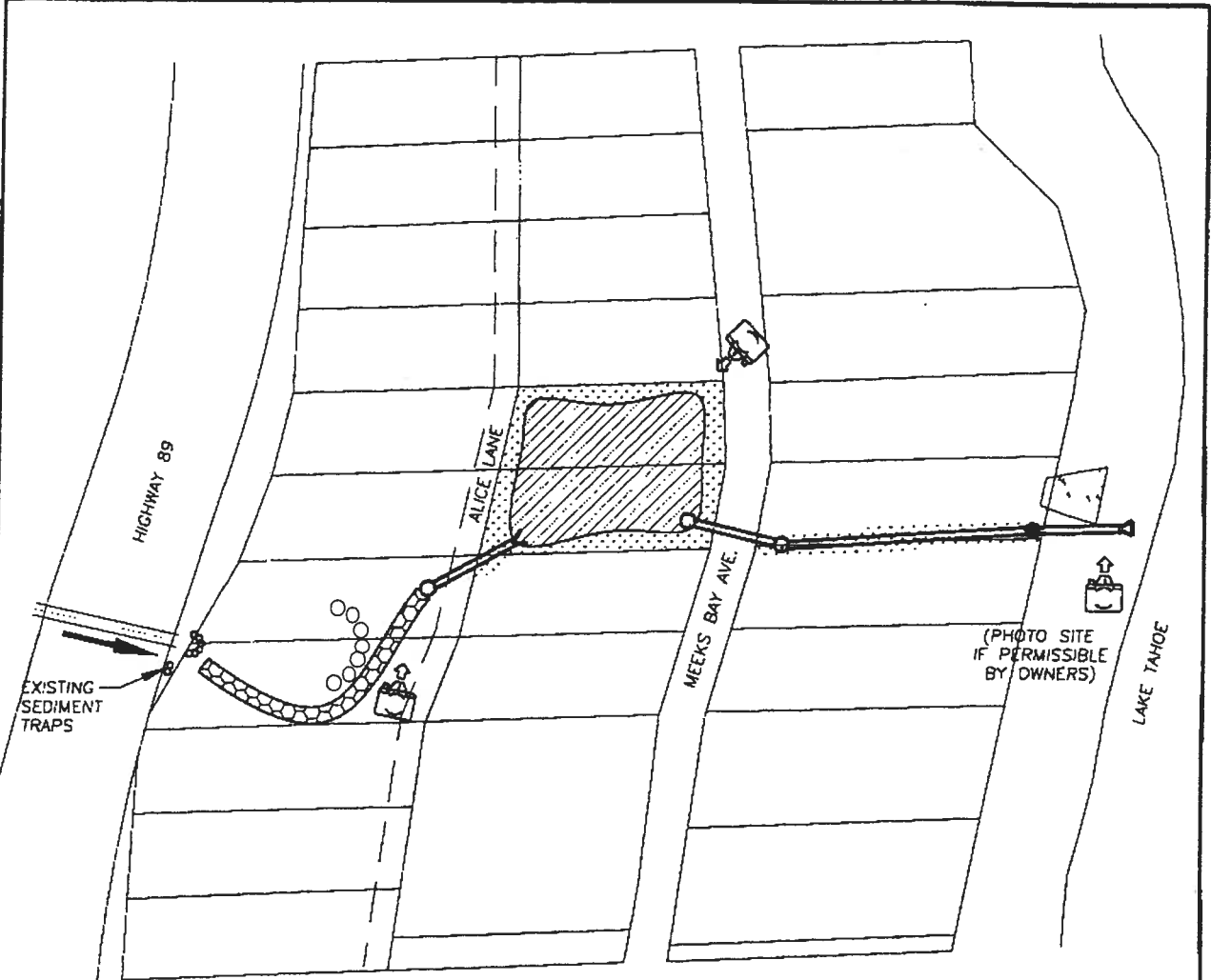

**LEGEND**

	PERMEATION GROUTING		FES
	RIP-RAP OR ROCK LINED CHANNEL		BASIN
	EXISTING DRAINAGE		REVEGETATION
	SEDIMENT TRAP OR RISER		PHOTO POINT
	CULVERT PIPE		SDMH (MANHOLE)
	OUTLET STRUCTURE		
	APPROX. LOCATION OF EXIST. PIPE		
	APPROX. LOCATION OF EXISTING ROCK CHECK DAM		

SCALE: 1" = 100'



EL DORADO COUNTY  
SOUTH LAKE TAHOE OFFICE



1998 CTC GRANT APPLICATION  
SILVERTIP EROSION CONTROL PROJECT  
PROPOSED SITE IMPROVEMENTS AND  
PHOTO MONITORING POINTS

FIGURE  
**D**

DATE: 1/98	PROJECT NO.: 95141	BY: ALO
------------	--------------------	---------

EXHIBIT 3

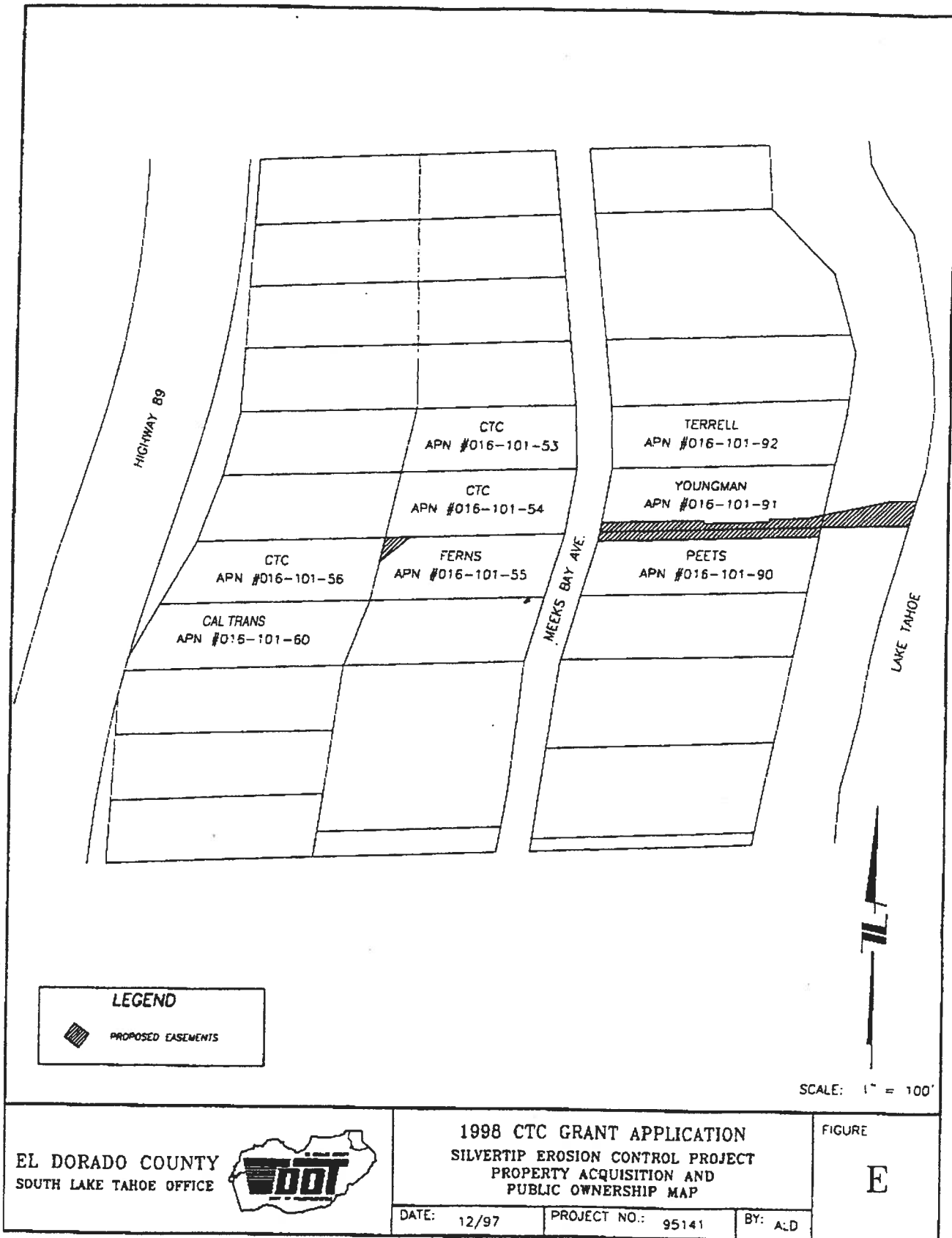

EL DORADO COUNTY  
 SOUTH LAKE TAHOE OFFICE



1998 CTC GRANT APPLICATION  
 SILVERTIP EROSION CONTROL PROJECT  
 PROPERTY ACQUISITION AND  
 PUBLIC OWNERSHIP MAP

DATE: 12/97	PROJECT NO.: 95141	BY: A.D
-------------	--------------------	---------

**EXHIBIT 4**

**SILVERTIP EROSION CONTROL PROJECT**

The Negative Declaration for the Silvertip Erosion Control Project has not been included here. Copies are available for review at the Conservancy's office and will be made available at the meeting.

## NOTICE OF DETERMINATION

**TO:** Office of Planning and Research  
1400 - 10th Street, Room 121  
Sacramento, CA 95814

**FROM:** California Tahoe Conservancy  
2161 Lake Tahoe Boulevard  
South Lake Tahoe, CA 96150

**SUBJECT:** Filing of Notice of Determination in compliance with Section 21108 or 21152 of the Public Resources Code.

**Project Title:** Silvertip Erosion Control Project

**State Clearinghouse Number**  
97112067

**Contact Person**  
Renée T. Dixon

**Telephone Number**  
(916) 324-0207

**Project Location:** Meeks Bay Vista Subdivision, south of Meeks Bay, east of Highway 89, west shore of Lake Tahoe in South Lake Tahoe, El Dorado County, California.

**Project Description:** The proposed project will control erosion within the project site by reducing slope failure. Erosion control methods will include applying permeation grouting, installing culverts, increasing sediment retention, and conveying flows in a controlled manner using rock-lined channels. Infiltrators, basins, sediment traps will be installed. The site will be re-vegetated. Right-of-way acquisition for easements will be obtained.

This is to advise that the California Tahoe Conservancy, acting as a responsible agency, has approved the above-described project and has made the following determinations regarding the above-described project:

1. The project will not have a significant effect on the environment.
2. A Negative Declaration for the project was prepared and approved by the lead agency, the County of El Dorado. The Notice of Determination, Negative Declaration, and record of project approval may be examined at: El Dorado County Department of Transportation, 1121 Shakori Drive, South Lake Tahoe, California. The California Tahoe Conservancy reviewed and considered the Negative Declaration prepared by the County of El Dorado prior to project approval.
3. Mitigation measures were made a condition of the approval of the project by the California Tahoe Conservancy.
4. A Statement of Overriding Considerations was not adopted for this project.
5. Findings were not required pursuant to the provisions of CEQA.
6. A California Department of Fish and Game Certificate of Fee Exemption is attached and has been filed with this notice.

**FISH & GAME FEES:** See Above

**Date Received for Filing:**

RECEIVED

MAY 04 1998

*Dennis T. Machida*  
Dennis T. Machida  
Executive Officer  
(April 24, 1998 Board Meeting)

FILED  
MAY 1 1998  
STATE  
CLEARINGHOUSE



CALIFORNIA DEPARTMENT OF FISH AND GAME  
CERTIFICATE OF FEE EXEMPTION

De Minimis Impact Finding

Project Title:

Silvertip Erosion Control Project

Location:

Meeks Bay Vista Subdivision, south of Meeks Bay, east of Highway 89, west shore of Lake Tahoe in South Lake Tahoe, El Dorado County, California.

Project Description:

The proposed project will control erosion within the project site by reducing slope failure. Erosion control methods will include applying permeation grouting, installing culverts, increasing sediment retention, and conveying flows in a controlled manner using rock-lined channels. Infiltrators, basins, sediment traps will be installed. The site will be re-vegetated. Right-of-way acquisition for easements will be obtained.

Findings of Exemption:

The County of El Dorado prepared a Negative Declaration, which was approved by the El Dorado County Board of Supervisors. The Initial Study found that no potential individual or cumulative impacts on wildlife resources would result from the project. There is no evidence before the California Tahoe Conservancy that implementing the Silvertip Erosion Control Project will have potential for an adverse effect on wildlife resources. This finding is supported by the fact that mitigation measures have been incorporated into the project to prevent effects on wildlife resources. The project will result in improved water quality, which has a beneficial effect on environmental conditions for fish and wildlife in the area.

Certification:

I hereby certify that the California Tahoe Conservancy has made the above finding and that the project will not individually or cumulatively have an adverse effect on wildlife resources, as defined in Section 711.2 of the Fish and Game Code.

  
Dennis T. Machida  
Executive Officer

APR 24 1998

\_\_\_\_\_  
Date

EXHIBIT B-1  
 REVISED ESTIMATED PROJECT SCHEDULE AND BUDGET  
 Project Name: Silvertip (acquisition)

<b>ACQUISITION SCHEDULE</b>	
Request Preliminary Title Reports	September 1998
Request Appraisals	September 1998
Submit Appraisal and Preliminary Title Reports for CTC Review	December 1998
CTC Approval of Appraisal and Preliminary Title Reports	February 1999
Negotiation and Agreement of Sales	March 1999
CTC Approval of Instruments of Conveyance, Escrow Instructions and Purchase Agreements	May 1999
Close of Escrow	June 1999
Final Date for Submittal of Acquisition Invoices	May 2000

<b>ACQUISITION BUDGET</b>			
Easements		(3 Parcels)	\$94,930
Appraisals, Escrow, Negotiations			\$6,300
Survey for R.O.W.			\$12,800
Design and Administration			\$22,800
Contingency			\$13,670
<b>TOTAL</b>			<b>\$150,500</b>