

PLANS FOR THE IMPROVEMENT OF

# WEST VALLEY

## UNIT 2 (TM-99-1359-2)

COUNTY OF EL DORADO, CALIFORNIA

### SHEET INDEX

NO.	REVISION DESCRIPTION	CHECKED BY	DATE
15.	COPPERWOOD WAY & COURT - STA. 17+00 TO STA. 21+66.24		
16.	RAEFORD LOOP - STA. 10+00 TO STA. 19+92.50		
17.	OPAL LANE - STA. 10+00 TO STA. 11+55.53		
18.	BLISTER - GEMWOOD WAY - STA. 10+00 TO STA. 11+01.54		
19.	BLISTER - LARKSTONE PLACE - STA. 10+00 TO STA. 11+01.41		
20.	STORM DRAIN/LATERAL A - STA. 0+50 TO STA. 4+00		
21.	STORM DRAIN/LATERAL B - STA. 10+00 TO STA. 12+25.24		
22.	GRADING PLAN		
23.	UTILITY LAYOUT		
24.	LARKSTONE PLACE - STA. 10+00 TO STA. 17+00		
25.	EROSION CONTROL PLAN		
26.	EROSION CONTROL PLAN		
27.	EROSION CONTROL PLAN		
28.	EROSION CONTROL PLAN		
29.	EROSION CONTROL PLAN		
30.	EROSION CONTROL PLAN		
31.	EROSION CONTROL PLAN		
32.	EROSION CONTROL PLAN		
33.	EROSION CONTROL PLAN		
34.	EROSION CONTROL PLAN		

**GRADING AND GEOTECHNICAL SPECIFICATIONS:**  
 ALL GRADING SHALL BE DONE UNDER OBSERVATION AND TESTING BY A QUALIFIED CIVIL ENGINEER OR GEOTECHNICAL ENGINEER AND IF REQUIRED BOTH A QUALIFIED CIVIL ENGINEER OR GEOTECHNICAL ENGINEER AND A REGISTERED GEOTECHNICAL ENGINEER SHALL BE REQUIRED TO PERFORM AN INSURANCE WITH ADEQUATE COUNTY FINANCING. THE RECORD SPECIFICATIONS SET FORTH IN THE SOILS REPORT OR GEOTECHNICAL/GEOTECHNICAL INVESTIGATION ENTITLED:  
 SEE BELOW (TITLE, PROJECT NUMBER, SOILS ENGINEERING COMPANY NAME, DATE)  
 ALL FILL MATERIAL SHALL BE COMPACTED TO A MINIMUM OF 95% OF THE MAXIMUM DRY DENSITY AS DETERMINED BY THE MOST RECENT VERSION OF ASTM D-1557 OR AN APPROVE ALTERNATIVE STANDARD.  
 AT COMPLETION OF THE GRADING OPERATIONS, AN AS-GRADED SOILS, OR IF REQUIRED, AND AS-GRADED SOILS REPORT SHALL BE SUBMITTED TO THE COUNTY ENGINEER FOR REVIEW AND APPROVAL.  
 EACH THE DOT INSPECTOR AND DOT DEVELOPMENT SERVICES UNIT, WITHIN 15 DAYS OF THE COMPLETION OF GRADING.

**GEOTECHNICAL ENGINEERS STATEMENT:**  
 THESE GRADING PLANS HAVE BEEN REVIEWED BY THE UNDERSIGNED AND FOUND TO BE IN SUBSTANTIAL CONFORMANCE WITH THE RECOMMENDATIONS AND SPECIFICATIONS OUTLINED IN THE REFERENCE SOILS REPORT OR GEOTECHNICAL/GEOTECHNICAL INVESTIGATION PREPARED FOR THE DEVELOPMENT.

REGISTERED PROFESSIONAL ENGINEER  
 DONALD T. MCCORMICK  
 CIVIL ENGINEER  
 R.C.E. 42556  
 DATE: 12-31-06  
 EXPIRES: 12-31-06  
 (SEAL)  
 DATE: 12-31-06  
 EXPIRES: 12-31-06  
 (SEAL)

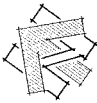

### SITE PLAN SCALE: 1"=200'

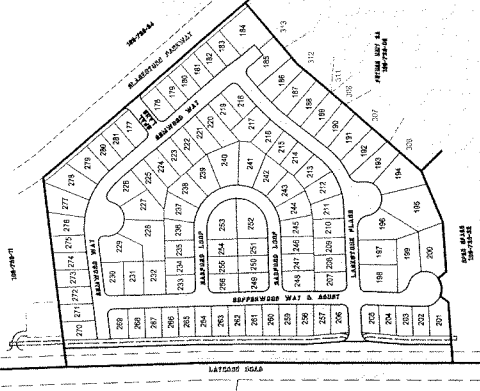

**NOTES:**  
 THE COUNTY'S SIGNATURE IS FOUNDED ON THE PREMISE THAT THE OWNER AND ENGINEER OF RECORD HAVE OBTAINED ALL NECESSARY PERMITS FROM THE COUNTY. IF ANY OF THE INFORMATION IS FOUND TO BE INCONSISTENT, THEN THE COUNTY MAY REQUIRE THE OWNER, ENGINEER OF RECORD AND CONTRACTOR TO CORRECT THE INFORMATION AND RE-APPLY FOR PERMITS UNTIL THE DISCREPANCY IS RECTIFIED TO THE SATISFACTION OF THE COUNTY.

**PERMITS AND NUMBERS**  
 US ARMY CORPS OF ENGINEERS 404 PERMIT 199400449  
 CALIFORNIA DEPARTMENT OF FISH AND GAME 1602 PERMIT 1-136-F-0110  
 NPDES GENERAL PERMIT FOR DISCHARGE TO SURFACE WATERS CAS000002  
 CALIFORNIA DEPARTMENT OF WATER RESOURCES CONTROL BOARD ORDER NUMBER 5309C331225

**GENERAL NOTES:**  
**OWNER OF RECORD:**  
 CENTER HOMES  
 14500 S. BARKLE AVENUE, SUITE 150  
 ROSELAND, CA 90661  
 916-788-9000

**GEOTECHNICAL ENGINEERING REPORT**  
 PREPARED BY: YOUNGDAHL CONSULTING GROUP, INC.  
 5100 GARDEN VALLEY COURT, SUITE 200  
 EL DORADO HILLS, CA 95762  
 916-833-5482

**RECYCLED WATER SERVICE CERTIFICATION:**  
 I HEREBY CERTIFY THAT THE RECYCLED WATER SYSTEM AS SHOWN ON DRAWING NUMBER SHEETS 1 THROUGH 19, HAS BEEN DESIGNED TO PROVIDE EACH LOT (OR FACILITY) OF THIS TRACT (PROJECT) WITH ADEQUATE WATER PRESSURE AND FLOW AS OF THE DATE SHOWN, BASED ON CRITERIA SUPPLIED BY THE EL DORADO IRRIGATION DISTRICT.

**SEWER SERVICE CERTIFICATION:**  
 I HEREBY CERTIFY THAT THE SEWER SYSTEM AS SHOWN ON DRAWING NUMBER SHEETS 1 THROUGH 19, HAS BEEN DESIGNED TO PROVIDE EACH LOT (OR FACILITY) OF THIS TRACT (PROJECT) WITH SEWER SERVICE AS SHOWN, BASED ON CRITERIA SUPPLIED BY THE EL DORADO IRRIGATION DISTRICT.

**RECORD DRAWING CERTIFICATE:**  
 THIS SET OF PLANS, HAVING BEEN REVIEWED BY ME, REFLECT ALL APPROVED REVISIONS TO THE PROJECT KNOWN TO ME, AND ALL FIELD DEVIATIONS TO THE PLANNED IMPROVEMENTS BY THE CONSTRUCTION CONTRACTOR, AS REPORTED VERIFICATION OF PLANNED IMPROVEMENTS TO ME.

### VICINITY MAP

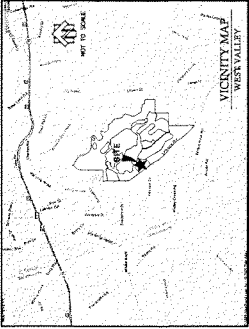

#### RECYCLED WATER MATERIAL LIST

ITEM	SUPPLIER AND/OR MANUFACTURER	MODEL/TYPE/ SIZE/TOTAL	QUANTITY
PIPE			
FITTINGS			
SERVICES			
VALVES			
ARV VALVES			

#### SEWER MATERIAL LIST

ITEM	SUPPLIER AND/OR MANUFACTURER	MODEL/TYPE/ SIZE/TOTAL	QUANTITY
PIPE			
FITTINGS			
MANHOLES			
SERVICES			

#### WATER MATERIAL LIST

ITEM	SUPPLIER AND/OR MANUFACTURER	MODEL/TYPE/ SIZE/TOTAL	QUANTITY
PIPE			
FIRE HYDRANTS			
SERVICES			
VALVES			
ARV VALVES			

**EL DORADO IRRIGATION DISTRICT**  
 RECEIVED BY: [Signature]  
 DATE: 05-26-06  
 PROJECT NO.: 751278  
 SHEET NO.: 2 OF 2

**DESIGNED UNDER THE DIRECTION OF**  
 DONALD T. MCCORMICK  
 CIVIL ENGINEER  
 R.C.E. 42556  
 DATE: 03/15/06

**COUNTY OF EL DORADO**  
 DONALD T. MCCORMICK  
 COUNTY ENGINEER  
 R.C.E. 42556  
 DATE: 20/06/06

**FIRE DEPARTMENT APPROVAL:**  
 [Signature]  
 DATE: 3-9-06  
 EL DORADO HILLS FIRE DEPARTMENT