

ORIGINAL SCALE IS IN INCHES  
 Drawing name: C:\Civil\_3D\Projects\72310\_Silva\_Valley\_Parkway\_Bike\_Path\CADD\_Files\Sheets\DE-sheets.dwg Layout Tab: DE-1 May 22, 2017 - 9:51am DFriedstod  
 FOR REDUCED PLANS

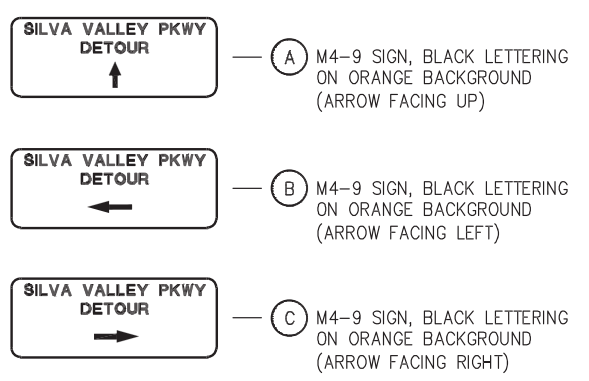
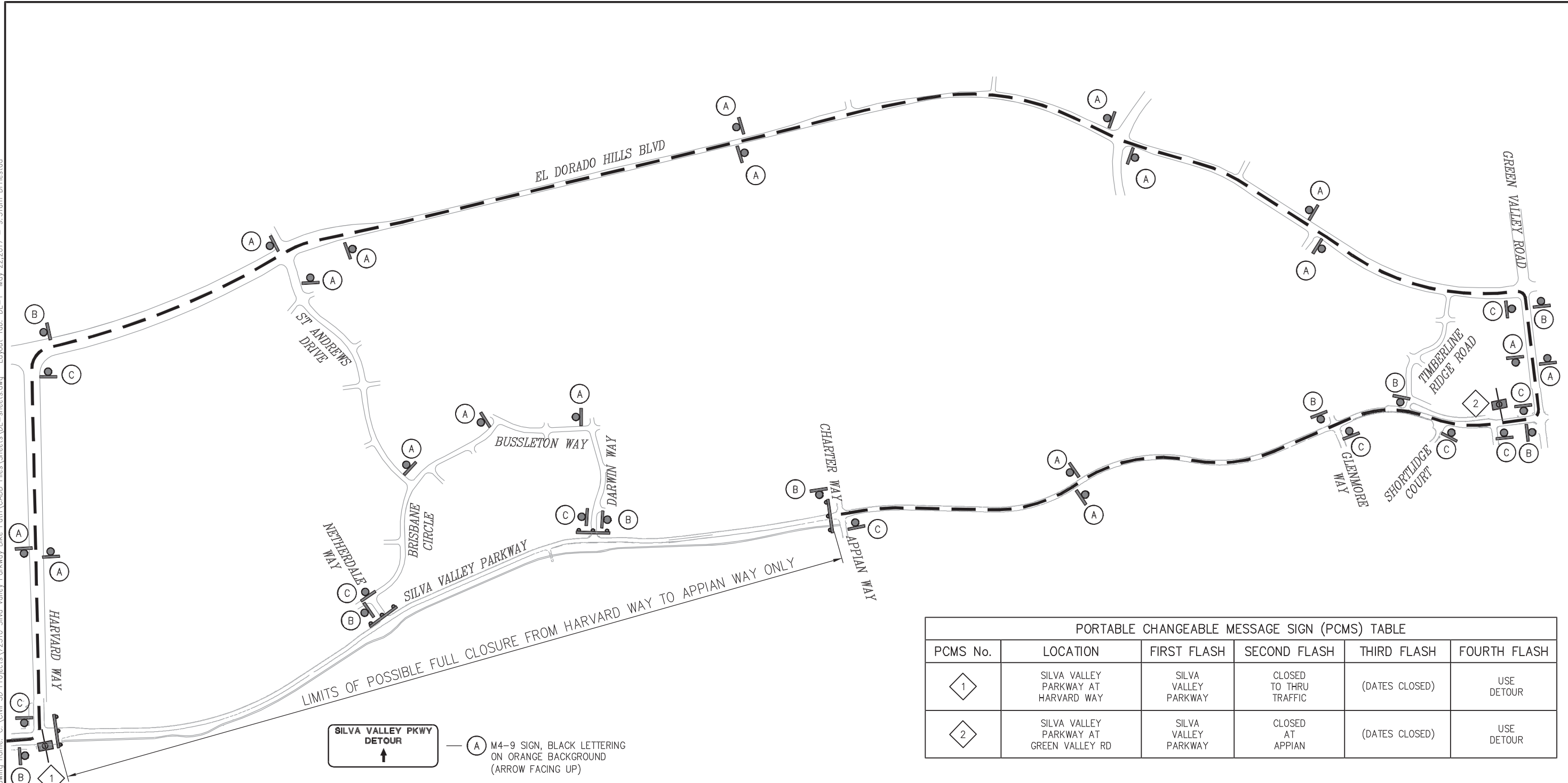

PORTABLE CHANGEABLE MESSAGE SIGN (PCMS) TABLE					
PCMS No.	LOCATION	FIRST FLASH	SECOND FLASH	THIRD FLASH	FOURTH FLASH
1	SILVA VALLEY PARKWAY AT HARVARD WAY	SILVA VALLEY PARKWAY	CLOSED TO THRU TRAFFIC	(DATES CLOSED)	USE DETOUR
2	SILVA VALLEY PARKWAY AT GREEN VALLEY RD	SILVA VALLEY PARKWAY	CLOSED AT APPIAN	(DATES CLOSED)	USE DETOUR

- NOTES:**
- THIS PLAN ACCURATE FOR DETOUR LAYOUT ONLY
  - FOR FULL CLOSURE OF TWO LANE CONVENTIONAL HIGHWAY SEE CALTRANS STANDARD PLANS AND MOST RECENT UPDATES TO THE CALIFORNIA MUTCD
  - REFER TO SECTION 12, MAINTAINING TRAFFIC, OF THE CONTRACT DOCUMENTS FOR CLOSURE DAYS AND TIMES AND OTHER DETAILS NOT SHOWN HEREIN

**DETOUR PLAN**  
**(FOR OPTIONAL FULL CLOSURE)**

SCALE: 1"=300'

**DETOUR PLAN**  
**SCALE : AS SHOWN**

REVISION	NUMBER	DATE	DESCRIPTION	BY



PREPARED UNDER THE SUPERVISION OF :  
 REGISTERED CIVIL ENGINEER  
 DATE:

DESIGNED: DRF  
 DRAWN: DRF  
 CHECKED: MJP  
 DATE: 6/6/2017  
 ROAD NUMBER: 2347



**EL DORADO COUNTY**  
**DEPARTMENT OF TRANSPORTATION**

**SILVA VALLEY PARKWAY**  
**CLASS 1 AND CLASS 2 BIKE LANES**  
**(HARVARD TO GREEN VALLEY)**

SHEET  
**DE-1**  
 38 OF 38  
 W.O. No. **72310**