



ORDINANCE NO. 5053

THE BOARD OF SUPERVISORS OF THE COUNTY OF EL DORADO DOES ORDAIN AS FOLLOWS:

RELATED TO REZONING IN THE EL DORADO HILLS AREA, (Serrano Village J5/J6):

Section 1. The Official Zoning Map for the El Dorado Hills area is hereby amended to rezone the following described lands:

From: Community Commercial-Planned Development (CC-PD)

To: Single-Unit Residential-Planned Development (R1-PD)

El Dorado Hills Area:

Approximately 4.27-acre portion of Assessor's Parcel No. 123-570-03, being described as a portion of Sections 31 and 32, T10N, R9E, M.D.M, consisting of 20.42 acres as shown on Exhibit A hereto.

Section 2. This ordinance shall take effect and shall become effective thirty (30) days following the adoption hereof.

PASSED AND ADOPTED by the Board of Supervisors of the County of El Dorado at a regular meeting of said Board, held on the 27th day of June, 2017, by the following vote of said Board:

Ayes: Hidahl, Ranalli, Frentzen, Veerkamp, Novasel

ATTEST

JAMES S. MITRISIN

Clerk of the Board of Supervisors

By

Deputy Clerk

Noes: None

Absent: None

Chairman, Board of Supervisors

Shiva Frentzen

APPROVED AS TO FORM

MICHAEL J. CICCOCI

County Counsel

By

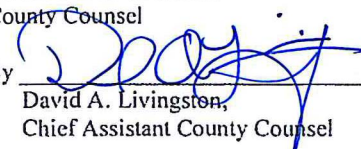
David A. Livingston,

Chief Assistant County Counsel

SERRANO VILLAGE J5 & J6

PROPOSED ZONE EXHIBIT
EL DORADO COUNTY CALIFORNIA MARCH 6, 2017



LEGEND

CC	17.58 ACRES
R1-PD	31.76 ACRES
TOTAL	49.34 ACRES

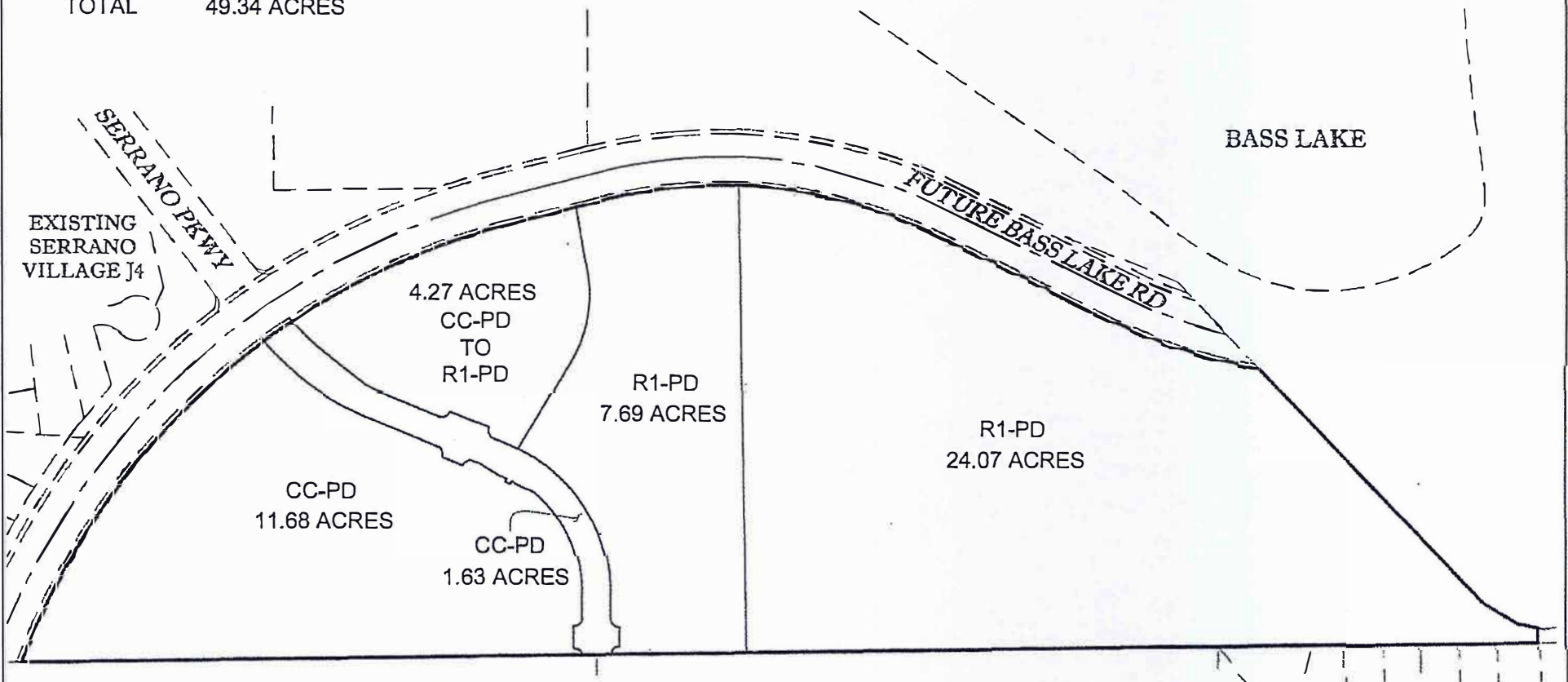

Note: Calculated parcel areas are based on future Bass Lake Road right-of-way.

Exhibit A



SERRANO

R.E.Y. ENGINEERS