



PC 8/22/19
#3
Charlene Tim <charlene.tim@edcgov.us>
28 pages

Additional Public Comments: August 22, 2019 EDC Planning Commission Agenda Item 3 Serrano Village J7 PD18-0005 / TM18-1536

John Davey <jdavey@daveygroup.net> Mon, Aug 19, 2019 at 4:21 PM
To: Aaron Mount <aaron.mount@edcgov.us>, Planning Department <planning@edcgov.us>, Charlene Tim <charlene.tim@edcgov.us>, Jon/ Stacy Vegna <jvegna@edcgov.us>, james.williams@edcgov.us, brian.shinault@edcgov.us, gary.miller@edcgov.us
Cc: The BOSONE <bosone@edcgov.us>, The BOSTWO <bostwo@edcgov.us>, bosthree@edcgov.us, bosfour@edcgov.us, bosfive@edcgov.us, Rafael Martinez <rafael.martinez@edcgov.us>, Joe Harn <joe.harn@edcgov.us>, edctc@edctc.org, mail@edhcsd.org, Kevin Loewen <kloewen@edhcsd.org>, Marshall Cox <mcox@edhfire.com>

Hello,



The Bass Lake Action Committee wishes to submit the following letter and exhibits as additional public comment for the August 22, 2019 County of El Dorado Planning Commission Hearing regarding Agenda Item 3, Serrano Village J7 PD18-0005/TM18-1536

Thank you,
John.

John Davey
Vice President
Bass Lake Action Committee
A non-profit 501(C)(4) corporation representing Bass Lake area home owners
<http://basslakeaction.org>

Cell 916-752-8183

3 attachments

-  **BLAC_J7_Comment_Letter_Followup_Aug-19-2019.pdf**
215K
-  **CHP-BLR-1.pdf**
661K
-  **BLB-V-NO12-2007.pdf**
1821K



BASS LAKE ACTION COMMITTEE TRAFFIC & SAFETY COMMITTEE

August 15, 2019
501 Kirkwood Court
El Dorado Hills CA 95762

The County of El Dorado Planning & Building Department Planning Services Division
The County of El Dorado Planning Commission

2850 Fairlane Court Building C
Placerville, CA 95667

Honorable Commissioners,

The Bass Lake Action Committee (BLAC) Traffic Safety Committee (TSC), would like to submit the following public comments, with respect to Serrano Village J7 (PD18-0005 / TM18-1536), on the impacts to Bass Lake area transportation, circulation, and pedestrian safety. The TSC is comprised of residents of Bridlewood Canyon, Woodridge, and The Hills of El Dorado villages in the Bass Lake Area of El Dorado Hills.

We collected collision data from the California Highway Patrol's Statewide Integrated Traffic Records System (SWITRS) for the ten-year period of 2009 – 2019 for the segment of Bass Lake Rd from Serrano Pkwy in the south, to Green Valley Rd in the north. Oddly, there were a handful of collisions, known to BLAC members, that don't show up in this data: 1) A BLAC Member's collision on Bass Lake Rd at Bridlewood Dr in 2010, 2) A rollover accident on Bass Lake Rd just north of Lambeth Rd where a BLAC member assisted in removing a victim from their overturned vehicle in 2017, and 3) A BLAC member rendered assistance to a vehicle on Bass Lake Rd, just south of Madera Way in 2018, that had lost control and crossed into oncoming traffic, damaging their vehicle, before coming to rest in the opposite lane of travel.

The California Highway Patrol only has collision data retained for a ten-year period. Prior to the 2009-2019 data we were able to collect, there were at least four fatal accidents on Bass Lake Rd between Madera Way and Hill Rd in the 1995–2008 time frame. There was also a fatal motorcycle accident in June 2019 at Bass Lake Rd and Sandhurst Hill Rd that is not reflected in the 2009-2019 data, as well as three recent collisions in the last four weeks between Serrano Pkwy and Magnolia Hills Dr.

<http://basslakeaction.org> email: blacinfo@aol.com
501 Kirkwood Ct., El Dorado Hills, CA 95762
Bass Lake Action Committee is a 501(c)(4) organization



BASS LAKE ACTION COMMITTEE TRAFFIC & SAFETY COMMITTEE

SOURCE: California Highway Patrol Statewide Integrated Traffic Records System (SWITRS) DATA

BASS LAKE RD: SERRANO PARKYWAY to GREEN VALLEY ROAD Collision Data 2009-2019

113 Reported Collisions on Bass Lake Rd

73 between Bridlewood Dr and Woodleigh Ln: Distance of 4968 feet

LOCATION	OVERTURNED	HEAD-ON	REAR-END	BROADSIDE	HIT OBJECT	SIDESWIPED
Madera Way	6	2	1	0	11	2
Hill Rd	1	1	0	0	2	0
Sandhurst Hill Rd	2	1	0	1	5	1
Magnolia Hills Dr	1	0	0	1	4	0
Bridlewood Dr	1	0	7	1	7	1
Woodleigh Lane	0	1	3	2	3	3

See full Exhibit [CHP-BLR1](#)

It is interesting to note, that there were almost the same number of rear-end collisions in the 2009-2019 time period occurring at Bass Lake Rd & Bridlewood Dr (QTY 7) with only four lanes of travel, as there were at Green Valley Rd and Bass Lake Rd (QTY 8) with a cumulative eleven lanes of travel.

We would also like to submit for review the following articles from the November 2007 issue of the Bass Lake Bulletin in regards to historic concerns with the impact of the J7 project on Bass Lake Rd:

1) EDH APAC REVIEWS SERRANO VILLAGE J-7 DEVELOPMENT PLANS

APAC is concerned that the traffic circulation pattern for the proposed project provides that future residents may make unregulated left turns across Bass Lake Road to enter or leave the project. The Committee is concerned that Bass Lake Road is becoming a well-traveled road, and such left turns may be hazardous. APAC recommends that the County Department of Transportation do a very thorough review of the left-turn traffic pattern associated with entering and exiting the proposed project.

2) BLAC COMMENTS ON SERRANO VILLAGE J-7 DEVELOPMENT

BLAC shares the concerns of the El Dorado Area Planning Advisory Committee, in that the proposed three-story houses planned along the boundary of neighboring Bridlewood Canyon would be incompatible with the existing Bridlewood architecture. BLAC is also concerned that the fifteen-foot rear setbacks of the project would create substantial visual impact and the smaller lot densities would be inconsistent with the policies set forth in the El Dorado Hills Specific Plan. BLAC is additionally concerned that the addition of an entry and exit from the J-7 homes will add to a series of driveways on a short-curved stretch of Bass Lake Road that requires left turns in order for emerging motorists to travel south on the roadway. Another issue is that any road improvements will require that the roadway be relocated to the center of the 100-foot right-of-way along that route. Such a realignment could take out a substantial part of the existing land and driveway now in front of Bridlewood Canyon (see photos on this and the front page).

<http://basslakeaction.org> email: blacinfo@aol.com
501 Kirkwood Ct., El Dorado Hills, CA 95762
Bass Lake Action Committee is a 501(c)(4) organization



BASS LAKE ACTION COMMITTEE TRAFFIC & SAFETY COMMITTEE

3) COUNTY HOLDS TAC MEETING ON J-7 PROJECT

BLAC representative Greg Violette attended the TAC meeting and raised BLAC's concerns about the project, including the setback distance, three story structures and traffic. Greg suggested that it was the responsibility of the Department of Transportation to do a thorough review of the Bass Lake Road traffic corridor as a whole and not as unrelated parts.

Greg specifically raised the issue of line-of-sight for cars exiting Village J-7 onto Bass Lake Road.

Parker Development representative Kirk Bone also urged DOT to thoroughly review the entire Bass Lake Road corridor, not only the portions of the road that front Parker's developments.

The DOT representatives at the meeting sought to allay the BLAC concerns by asserting that the proposed modifications to Bass Lake Road would address that issue. Present plans call for the road to narrow over the portion of road way that crosses the waters of Bass Lake then widen out in front of Bridlewood Canyon. DOT informed Parker that Parker would be responsible for road improvements to the right of way, though Parker would be eventually eligible for reimbursement for doing so.

Bass Lake Bulletin December 2007 articles attached: Exhibit BLB-V-NO12-2007

Again, we appreciate the opportunity to provide public comment on this project.

Warm regards,

John Davey
2019 Vice President
Bass Lake Action Committee

BLAC TSC members
John Thomson Ph. D.
Bass Lake Bulletin Editor
Woodridge resident

Frank Sultzberger
Bridlewood Canyon resident

Steve Slattery
Woodridge resident

<http://basslakeaction.org> email: blacinfo@aol.com
501 Kirkwood Ct., El Dorado Hills, CA 95762
Bass Lake Action Committee is a 501(c)(4) organization



BASS LAKE ACTION COMMITTEE TRAFFIC & SAFETY COMMITTEE

Ron Cassity

Bridlewood Canyon HOA Director
Bass Lake Action Committee Director At Large
Bridlewood resident

John Davey

Vice President Bass Lake Action Committee
2019 Chair El Dorado Hills Area Planning Advisory Committee
The Hills of El Dorado resident

cc:

The County of El Dorado District 1 Supervisor John Hidahl
The County of El Dorado District 2 Supervisor Shiva Frentzen
The County of El Dorado District 3 Supervisor Brian Veerkamp
The County of El Dorado District 4 Supervisor Lori Parlin
The County of El Dorado District 5 Supervisor Sue Novasel
The County of El Dorado Hills Department of Transportation
The County of El Dorado Auditor Controller Joe Harn
The El Dorado County Transportation Commission
The El Dorado Hills Community Services District
The El Dorado Hills Fire Department

<http://basslakeaction.org> email: blacinfo@aol.com
501 Kirkwood Ct., El Dorado Hills, CA 95762
Bass Lake Action Committee is a 501(c)(4) organization

Total Count: 113

Primary Rd BASS LAKE RD Distance (ft) 500 Direction N Secondary Rd LAMBETH DR NCIC 9245 State Hwy? N Route Postmile Prefix Postmile Side of Hwy City PLACERVILLE County EL DORADO Population 2 Rpt Dist Beat 002 Type 3 CalTrans Dist Badge 18590 Collision Date 20090111 Time 0148 Day SUN Primary Collision Factor IMPROP TURN Violation 22107 Collision Type HIT OBJECT Severity PDO # Killed 0 # Injured 0 Tow Away? Y Process Date 20090909 Weather1 CLOUDY Weather2 Rdwy Surface DRY Rdwy Cond1 NO UNUSL CND Rdwy Cond2 Spec Cond 0 Hit and Run Motor Veh Involved With FIXED OBJ Lighting DARK - ST LTS Ped Action Cntrl Dev NT PRS/FCTR Loc Type Ramp/Int																									
PARTY INFO										VICTIM INFO															
Party Type	Age	Sex	Race	Sobriety1	Sobriety2	Move Pre Coll	Dir	SW Veh	CHP Veh	Year	Sp Info	OAF1 Viol	OAF2 Safety Equip	Role	Ext of Inj	Age	Sex	Seat Pos	Safety Equip	Ejected					
1F	DRVR	19	M	W	HNBD	PROC ST	N	A	0100	CHEVR	1995	-	3	N	-	M	G								
Primary Rd BASS LAKE RD Distance (ft) 1 Direction N Secondary Rd PARKDALE LN NCIC 9260 State Hwy? N Route Postmile Prefix Postmile Side of Hwy City UNINCORP. County EL DORADO Population 9 Rpt Dist Beat 002 Type 3 CalTrans Dist Badge 12781 Collision Date 20090217 Time 0800 Day TUE Primary Collision Factor STOP SGN SIG Violation 22450A Collision Type BROADSIDE Severity INJURY # Killed 0 # Injured 1 Tow Away? Y Process Date 20091021 Weather1 CLOUDY Weather2 Rdwy Surface WET Rdwy Cond1 NO UNUSL CND Rdwy Cond2 Spec Cond 0 Hit and Run Motor Veh Involved With OTHER MV Lighting DAYLIGHT Ped Action Cntrl Dev FNCTNG Loc Type Ramp/Int																									
PARTY INFO										VICTIM INFO															
Party Type	Age	Sex	Race	Sobriety1	Sobriety2	Move Pre Coll	Dir	SW Veh	CHP Veh	Year	Sp Info	OAF1 Viol	OAF2 Safety Equip	Role	Ext of Inj	Age	Sex	Seat Pos	Safety Equip	Ejected					
1F	DRVR	30	M	W	HNBD	PROC ST	S	D	2200	CHEVR	2002	-	3	N	-	M	G								
2	DRVR	33	F	W	HNBD	PROC ST	E	A	0100	BMW	2002	-	3	N	-	M	G	DRVR	COMP PN	33	F	1	M	G	0
Primary Rd GREEN VALLEY RD Distance (ft) 150 Direction W Secondary Rd BASS LAKE RD NCIC 9260 State Hwy? N Route Postmile Prefix Postmile Side of Hwy City UNINCORP. County EL DORADO Population 9 Rpt Dist Beat 203 Type 3 CalTrans Dist Badge 12781 Collision Date 20090318 Time 0747 Day WED Primary Collision Factor UNSAFE SPEED Violation 22350 Collision Type REAR END Severity INJURY # Killed 0 # Injured 1 Tow Away? N Process Date 20091215 Weather1 CLEAR Weather2 Rdwy Surface DRY Rdwy Cond1 NO UNUSL CND Rdwy Cond2 Spec Cond 0 Hit and Run Motor Veh Involved With OTHER MV Lighting DAYLIGHT Ped Action Cntrl Dev NT PRS/FCTR Loc Type Ramp/Int																									
PARTY INFO										VICTIM INFO															
Party Type	Age	Sex	Race	Sobriety1	Sobriety2	Move Pre Coll	Dir	SW Veh	CHP Veh	Year	Sp Info	OAF1 Viol	OAF2 Safety Equip	Role	Ext of Inj	Age	Sex	Seat Pos	Safety Equip	Ejected					
1F	DRVR	22	F	W	HNBD	PROC ST	E	D	2200	NISSA	2004	-	3	N	-	M	G								
2	DRVR	36	M	W	HNBD	SLOWING	E	A	0100	ACURA	2003	-	3	N	-	M	G	DRVR	COMP PN	36	M	1	M	G	0
Primary Rd BASS LAKE RD Distance (ft) 10 Direction N Secondary Rd BRIDLEWOOD DR NCIC 9260 State Hwy? N Route Postmile Prefix Postmile Side of Hwy City UNINCORP. County EL DORADO Population 9 Rpt Dist Beat 203 Type 3 CalTrans Dist Badge 13560 Collision Date 20090423 Time 1305 Day THU Primary Collision Factor UNSAFE SPEED Violation 22350 Collision Type REAR END Severity PDO # Killed 0 # Injured 0 Tow Away? N Process Date 20091214 Weather1 CLEAR Weather2 Rdwy Surface DRY Rdwy Cond1 NO UNUSL CND Rdwy Cond2 Spec Cond 0 Hit and Run Motor Veh Involved With OTHER MV Lighting DAYLIGHT Ped Action Cntrl Dev NT PRS/FCTR Loc Type Ramp/Int																									
PARTY INFO										VICTIM INFO															
Party Type	Age	Sex	Race	Sobriety1	Sobriety2	Move Pre Coll	Dir	SW Veh	CHP Veh	Year	Sp Info	OAF1 Viol	OAF2 Safety Equip	Role	Ext of Inj	Age	Sex	Seat Pos	Safety Equip	Ejected					
1	DRVR	20	F	W	HNBD	SLOWING	S	A	0100	FORD	2006	-	3	N	-	M	G								
2F	DRVR	38	M	W	HNBD	PROC ST	S	A	0700	ISUZU	1993	-	3	N	-	P	G								
Primary Rd BASS LAKE RD Distance (ft) 260 Direction S Secondary Rd MADERA WY NCIC 9260 State Hwy? N Route Postmile Prefix Postmile Side of Hwy City UNINCORP. County EL DORADO Population 9 Rpt Dist Beat 203 Type 3 CalTrans Dist Badge 012781 Collision Date 20090427 Time 2500 Day MON Primary Collision Factor IMPROP TURN Violation 22107 Collision Type OVERTURNED Severity FATAL # Killed 1 # Injured 0 Tow Away? Y Process Date 20100920 Weather1 CLEAR Weather2 Rdwy Surface DRY Rdwy Cond1 NO UNUSL CND Rdwy Cond2 Spec Cond 0 Hit and Run Motor Veh Involved With NON-CLSN Lighting DARK - NO ST LTS Ped Action Cntrl Dev NT PRS/FCTR Loc Type Ramp/Int																									
PARTY INFO										VICTIM INFO															
Party Type	Age	Sex	Race	Sobriety1	Sobriety2	Move Pre Coll	Dir	SW Veh	CHP Veh	Year	Sp Info	OAF1 Viol	OAF2 Safety Equip	Role	Ext of Inj	Age	Sex	Seat Pos	Safety Equip	Ejected					
1F	DRVR	39	M	W	HNBD	RAN OFF RD	N	C	0200	HARLE	2004	-	3	N	-	P	W	DRVR	KILLED	39	M	1	P	W	1
Primary Rd BASS LAKE RD Distance (ft) 77 Direction N Secondary Rd WOODLEIGH LN NCIC 9260 State Hwy? N Route Postmile Prefix Postmile Side of Hwy City UNINCORP. County EL DORADO Population 9 Rpt Dist Beat 202 Type 2 CalTrans Dist Badge 012781 Collision Date 20090729 Time 0735 Day WED Primary Collision Factor DRVR ALC DRG Violation 23152A Collision Type SIDESWIPE Severity PDO # Killed 0 # Injured 0 Tow Away? N Process Date 20100406 Weather1 CLEAR Weather2 Rdwy Surface DRY Rdwy Cond1 NO UNUSL CND Rdwy Cond2 Spec Cond 0 Hit and Run Motor Veh Involved With PKD MV Lighting DAYLIGHT Ped Action Cntrl Dev NT PRS/FCTR Loc Type Ramp/Int																									
PARTY INFO										VICTIM INFO															
Party Type	Age	Sex	Race	Sobriety1	Sobriety2	Move Pre Coll	Dir	SW Veh	CHP Veh	Year	Sp Info	OAF1 Viol	OAF2 Safety Equip	Role	Ext of Inj	Age	Sex	Seat Pos	Safety Equip	Ejected					
1F	DRVR	58	F	H	HBD-UJ	RAN OFF RD	N	A	0100	TOYOT	2000	-	3	A	22107	-	M	G							
2	PRKD	998				PARKED	N	A	0100	FORD	1999	-	3	N	-	-	-								

Total Count: 113

VALLEY RD, EL DORADO COUNTY

Primary Rd BASS LAKE RD Distance (ft) 529 Direction N Secondary Rd MADERA WY NCIC 9260 State Hwy? N Route Postmile Prefix Postmile Side of Hwy
 City UNINCORP. County EL DORADO Population 9 Rpt Dist Beat 002 Type 3 CalTrans Dist Badge 18340 Collision Date 20090816 Time 0223 Day SUN
 Primary Collision Factor DRVR ALCIDRG Violation 23152A Collision Type HIT OBJECT Severity PDO # Killed 0 # Injured 0 Tow Away? Y Process Date 20100504
 Weather1 CLEAR Weather2 Rdwy Surface DRY Rdwy Cond1 NO UNUSL CND Rdwy Cond2 Spec Cond 0
 Hit and Run Motor Veh Involved With FIXED OBJ Lighting DARK - NO ST LTS Ped Action Cntrl Dev NT PRS/FCTR Loc Type Ramp/Int

PARTY INFO

VICTIM INFO

Party	Type	Age	Sex	Race	Sobriety1	Sobriety2	Move Pre Coll	Dir	SW Veh	CHP Veh	Veh Make	Year	Sp Info	OAF1 Viol	OAF2 Safety Equip	Role	Ext of Inj	Age	Sex	Seat Pos	Safety Equip	Ejected	
1F	DRVR	21	F	W	HBD-UI		OTHER	S	A	0100	ACURA	1994	- 3	A	22107	-	L	H					

Primary Rd BASS LAKE RD Distance (ft) 1 Direction Secondary Rd GREEN VALLEY RD NCIC 9260 State Hwy? N Route Postmile Prefix Postmile Side of Hwy
 City UNINCORP. County EL DORADO Population 9 Rpt Dist Beat 203 Type 3 CalTrans Dist Badge 16685 Collision Date 20090905 Time 1820 Day SAT
 Primary Collision Factor STOP SGNISIG Violation 21453A Collision Type BROADSIDE Severity PDO # Killed 0 # Injured 0 Tow Away? Y Process Date 20100616
 Weather1 CLEAR Weather2 Rdwy Surface DRY Rdwy Cond1 NO UNUSL CND Rdwy Cond2 Spec Cond 0
 Hit and Run Motor Veh Involved With OTHER MV Lighting DAYLIGHT Ped Action Cntrl Dev FNCTNG Loc Type Ramp/Int

PARTY INFO

VICTIM INFO

Party	Type	Age	Sex	Race	Sobriety1	Sobriety2	Move Pre Coll	Dir	SW Veh	CHP Veh	Veh Make	Year	Sp Info	OAF1 Viol	OAF2 Safety Equip	Role	Ext of Inj	Age	Sex	Seat Pos	Safety Equip	Ejected			
1F	DRVR	27	M	W	HNBD		LFT TURN	N	A	0700	DODGE	1998	- 3	N	-	M	G	PASS		26	F	3	M	G	0
2	DRVR	40	M	A	HNBD		PROC ST	E	D	2200	DODGE	2004	- 3	N	-	B	G								

Primary Rd BASS LAKE RD Distance (ft) 1 Direction Secondary Rd MAGNOLIA HILLS D NCIC 9260 State Hwy? N Route Postmile Prefix Postmile Side of Hwy
 City UNINCORP. County EL DORADO Population 9 Rpt Dist Beat 002 Type 3 CalTrans Dist Badge 18140 Collision Date 20090917 Time 1350 Day THU
 Primary Collision Factor R-O-W AUTO Violation 21802A Collision Type BROADSIDE Severity PDO # Killed 0 # Injured 0 Tow Away? N Process Date 20091020
 Weather1 CLEAR Weather2 Rdwy Surface DRY Rdwy Cond1 NO UNUSL CND Rdwy Cond2 Spec Cond 0
 Hit and Run Motor Veh Involved With OTHER MV Lighting DAYLIGHT Ped Action Cntrl Dev FNCTNG Loc Type Ramp/Int

PARTY INFO

VICTIM INFO

Party	Type	Age	Sex	Race	Sobriety1	Sobriety2	Move Pre Coll	Dir	SW Veh	CHP Veh	Veh Make	Year	Sp Info	OAF1 Viol	OAF2 Safety Equip	Role	Ext of Inj	Age	Sex	Seat Pos	Safety Equip	Ejected	
1F	DRVR	16	M	W	IMP UNK	IMP UNK	LFT TURN	W	D	2200	GMC	2000	- 3	N	-	M	G						
2	DRVR	36	F	W	IMP UNK	IMP UNK	PROC ST	N	A	0100	VOLVO	2001	- 3	N	-	M	G						

Primary Rd BASS LAKE RD Distance (ft) 1 Direction Secondary Rd BRIDLEWOOD DR NCIC 9260 State Hwy? N Route Postmile Prefix Postmile Side of Hwy
 City UNINCORP. County EL DORADO Population 9 Rpt Dist Beat 002 Type 3 CalTrans Dist Badge 12718 Collision Date 20091020 Time 1719 Day TUE
 Primary Collision Factor UNSAFE SPEED Violation 22350 Collision Type REAR END Severity INJURY # Killed 0 # Injured 1 Tow Away? Y Process Date 20100701
 Weather1 CLOUDY Weather2 Rdwy Surface DRY Rdwy Cond1 NO UNUSL CND Rdwy Cond2 Spec Cond 0
 Hit and Run Motor Veh Involved With OTHER MV Lighting DAYLIGHT Ped Action Cntrl Dev NT PRS/FCTR Loc Type Ramp/Int

PARTY INFO

VICTIM INFO

Party	Type	Age	Sex	Race	Sobriety1	Sobriety2	Move Pre Coll	Dir	SW Veh	CHP Veh	Veh Make	Year	Sp Info	OAF1 Viol	OAF2 Safety Equip	Role	Ext of Inj	Age	Sex	Seat Pos	Safety Equip	Ejected			
1	DRVR	20	M	W	HNBD		PROC ST	S	A	0100	VOLKS	2005	- 3	N	-	M	G	DRVR	COMP PN	20	M	1	M	G	0
2F	DRVR	19	F	W	HNBD		PROC ST	S	A	0800	FORD	1998	- 3	A	22107	F	L	G							

Primary Rd BASS LAKE RD Distance (ft) 1 Direction Secondary Rd WOODLEIGH LN NCIC 9260 State Hwy? N Route Postmile Prefix Postmile Side of Hwy
 City UNINCORP. County EL DORADO Population 9 Rpt Dist Beat 002 Type 3 CalTrans Dist Badge 014749 Collision Date 20091116 Time 1740 Day MON
 Primary Collision Factor WRONG SIDE Violation 21460A Collision Type BROADSIDE Severity PDO # Killed 0 # Injured 0 Tow Away? N Process Date 20100902
 Weather1 CLEAR Weather2 Rdwy Surface DRY Rdwy Cond1 NO UNUSL CND Rdwy Cond2 Spec Cond 0
 Hit and Run MSDMNR Motor Veh Involved With OTHER MV Lighting DARK - NO ST LTS Ped Action Cntrl Dev NT PRS/FCTR Loc Type Ramp/Int

PARTY INFO

VICTIM INFO

Party	Type	Age	Sex	Race	Sobriety1	Sobriety2	Move Pre Coll	Dir	SW Veh	CHP Veh	Veh Make	Year	Sp Info	OAF1 Viol	OAF2 Safety Equip	Role	Ext of Inj	Age	Sex	Seat Pos	Safety Equip	Ejected	
1F	DRVR	998			IMP UNK	IMP UNK	OPPOS LN	-	-	-00	-	-	- 3	N	-	-	-						
2	DRVR	44	F	W	HNBD		PROC ST	N	A	0700	LEXUS	2004	- 3	N	-	M	G						

Primary Rd BASS LAKE RD Distance (ft) 100 Direction S Secondary Rd GREEN VALLEY RD NCIC 9260 State Hwy? N Route Postmile Prefix Postmile Side of Hwy
 City UNINCORP. County EL DORADO Population 9 Rpt Dist Beat 002 Type 3 CalTrans Dist Badge 18140 Collision Date 20091120 Time 1530 Day FRI
 Primary Collision Factor UNSAFE SPEED Violation 22350 Collision Type HIT OBJECT Severity PDO # Killed 0 # Injured 0 Tow Away? N Process Date 20100111
 Weather1 CLOUDY Weather2 RAINING Rdwy Surface WET Rdwy Cond1 NO UNUSL CND Rdwy Cond2 Spec Cond 0
 Hit and Run MSDMNR Motor Veh Involved With FIXED OBJ Lighting DAYLIGHT Ped Action Cntrl Dev NT PRS/FCTR Loc Type Ramp/Int

PARTY INFO

VICTIM INFO

Party	Type	Age	Sex	Race	Sobriety1	Sobriety2	Move Pre Coll	Dir	SW Veh	CHP Veh	Veh Make	Year	Sp Info	OAF1 Viol	OAF2 Safety Equip	Role	Ext of Inj	Age	Sex	Seat Pos	Safety Equip	Ejected	
1	DRVR	17	M	W	HNBD		RAN OFF RD	S	A	0700	BMW	1995	- 3	N	-	M	G						
2F	DRVR	998			IMP UNK	IMP UNK	RAN OFF RD	S	A	0700	OTHER	-	- 3	N	-	-	B						

Primary Rd BASS LAKE RD Distance (ft) 500 Direction S Secondary Rd WOODLEIGH LN NCIC 9260 State Hwy? N Route Postmile Prefix Postmile Side of Hwy
City UNINCORP. County EL DORADO Population 9 Rpt Dist Beat 201 Type 2 CalTrans Dist Badge 013464 Collision Date 20091215 Time 1548 Day TUE
Primary Collision Factor UNSAFE SPEED Violation 22350 Collision Type REAR END Severity INJURY # Killed 0 # Injured 1 Tow Away? Y Process Date 20100927
Weather1 CLOUDY Weather2 Rdwy Surface DRY Rdwy Cond1 NO UNUSL CND Rdwy Cond2 Spec Cond 0
Hit and Run Motor Veh Involved With PKD MV Lighting DAYLIGHT Ped Action Cntrl Dev NT PRS/FCTR Loc Type Ramp/Int

PARTY INFO

VICTIM INFO

Table with columns: Party Type, Age, Sex, Race, Sobriety1, Sobriety2, Move Pre Coll Dir SW Veh CHP Veh Make Year Sp Info OAF1 Viol OAF2 Safety Equip Role Ext of Inj Age Sex Seat Pos Safety Equip Ejected. Row 1: 1F DRVR 17 M W HNBD PROC ST N A 0100 NISSA 2001 - 3 N - M G DRVR COMP PN 17 M 1 M G 0

Primary Rd BASS LAKE RD Distance (ft) 457 Direction S Secondary Rd PARKDALE LN NCIC 9260 State Hwy? N Route Postmile Prefix Postmile Side of Hwy
City UNINCORP. County EL DORADO Population 9 Rpt Dist Beat 002 Type 3 CalTrans Dist Badge 18340 Collision Date 20100324 Time 0037 Day WED
Primary Collision Factor DRVR ALC/DRG Violation 23152A Collision Type HIT OBJECT Severity PDO # Killed 0 # Injured 0 Tow Away? Y Process Date 20110110
Weather1 CLEAR Weather2 Rdwy Surface DRY Rdwy Cond1 NO UNUSL CND Rdwy Cond2 Spec Cond 0
Hit and Run Motor Veh Involved With FIXED OBJ Lighting DARK - ST LTS Ped Action Cntrl Dev NT PRS/FCTR Loc Type Ramp/Int

PARTY INFO

VICTIM INFO

Table with columns: Party Type, Age, Sex, Race, Sobriety1, Sobriety2, Move Pre Coll Dir SW Veh CHP Veh Make Year Sp Info OAF1 Viol OAF2 Safety Equip Role Ext of Inj Age Sex Seat Pos Safety Equip Ejected. Row 1: 1F DRVR 18 M W HBD-UI UNS TURN N A 0100 HONDA 1995 - 3 A 22107 - M G PASS 19 M 3 M G 0

Primary Rd BASS LAKE RD Distance (ft) 150 Direction S Secondary Rd PARKDALE LN NCIC 9260 State Hwy? N Route Postmile Prefix Postmile Side of Hwy
City UNINCORP. County EL DORADO Population 9 Rpt Dist Beat 201 Type 2 CalTrans Dist Badge 13147 Collision Date 20100426 Time 1255 Day MON
Primary Collision Factor STRTNG/BCKNG Violation 22106 Collision Type REAR END Severity PDO # Killed 0 # Injured 0 Tow Away? N Process Date 20110311
Weather1 CLEAR Weather2 Rdwy Surface DRY Rdwy Cond1 NO UNUSL CND Rdwy Cond2 Spec Cond 0
Hit and Run Motor Veh Involved With OTHER MV Lighting DAYLIGHT Ped Action Cntrl Dev FNCTNG Loc Type Ramp/Int

PARTY INFO

VICTIM INFO

Table with columns: Party Type, Age, Sex, Race, Sobriety1, Sobriety2, Move Pre Coll Dir SW Veh CHP Veh Make Year Sp Info OAF1 Viol OAF2 Safety Equip Role Ext of Inj Age Sex Seat Pos Safety Equip Ejected. Row 1: 1F DRVR 47 F W HNBD PROC ST N A 0100 BMW 1996 - 3 N - M G. Row 2: 2 DRVR 38 F W HNBD STOPPED N A 0700 HONDA 2009 - 3 N - M G

Primary Rd BASS LAKE RD Distance (ft) 1 Direction S Secondary Rd BRIDLEWOOD DR NCIC 9260 State Hwy? N Route Postmile Prefix Postmile Side of Hwy
City UNINCORP. County EL DORADO Population 9 Rpt Dist Beat 002 Type 3 CalTrans Dist Badge 012718 Collision Date 20100913 Time 0755 Day MON
Primary Collision Factor UNSAFE SPEED Violation 22350 Collision Type REAR END Severity PDO # Killed 0 # Injured 0 Tow Away? Y Process Date 20110921
Weather1 CLEAR Weather2 Rdwy Surface DRY Rdwy Cond1 OBSTR ON RD Rdwy Cond2 Spec Cond 0
Hit and Run Motor Veh Involved With OTHER MV Lighting DAYLIGHT Ped Action Cntrl Dev NT PRS/FCTR Loc Type Ramp/Int

PARTY INFO

VICTIM INFO

Table with columns: Party Type, Age, Sex, Race, Sobriety1, Sobriety2, Move Pre Coll Dir SW Veh CHP Veh Make Year Sp Info OAF1 Viol OAF2 Safety Equip Role Ext of Inj Age Sex Seat Pos Safety Equip Ejected. Row 1: 1 DRVR 26 M W HNBD STOPPED S D 2200 TOYOT 1982 - 3 N - P G. Row 2: 2F DRVR 29 M O HNBD PROC ST S A 0100 MAZDA 2000 - 3 F - M G

Primary Rd BASS LAKE RD Distance (ft) 1056 Direction S Secondary Rd BRIDLEWOOD DR NCIC 9260 State Hwy? N Route Postmile Prefix Postmile Side of Hwy
City UNINCORP. County EL DORADO Population 9 Rpt Dist Beat 201 Type 2 CalTrans Dist Badge 17084 Collision Date 20100917 Time 0915 Day FRI
Primary Collision Factor UNSAFE SPEED Violation 22350 Collision Type OVERTURNED Severity INJURY # Killed 0 # Injured 1 Tow Away? Y Process Date 20111005
Weather1 CLEAR Weather2 Rdwy Surface DRY Rdwy Cond1 NO UNUSL CND Rdwy Cond2 Spec Cond 0
Hit and Run Motor Veh Involved With NON-CLSN Lighting DAYLIGHT Ped Action Cntrl Dev NT PRS/FCTR Loc Type Ramp/Int

PARTY INFO

VICTIM INFO

Table with columns: Party Type, Age, Sex, Race, Sobriety1, Sobriety2, Move Pre Coll Dir SW Veh CHP Veh Make Year Sp Info OAF1 Viol OAF2 Safety Equip Role Ext of Inj Age Sex Seat Pos Safety Equip Ejected. Row 1: 1F DRVR 26 M W HNBD PROC ST S C 0200 HONDA 2007 - 3 K - P W. Row 2: 2 DRVR 41 M W HNBD PROC ST N J 4800 FORD 2009 - 3 N - M G

Primary Rd BASS LAKE RD Distance (ft) 440 Direction N Secondary Rd MADERA WY NCIC 9260 State Hwy? N Route Postmile Prefix Postmile Side of Hwy
City UNINCORP. County EL DORADO Population 9 Rpt Dist Beat 002 Type 3 CalTrans Dist Badge 13560 Collision Date 20101117 Time 1425 Day WED
Primary Collision Factor UNSAFE SPEED Violation 22350 Collision Type HEAD-ON Severity PDO # Killed 0 # Injured 0 Tow Away? N Process Date 20120131
Weather1 CLEAR Weather2 Rdwy Surface DRY Rdwy Cond1 NO UNUSL CND Rdwy Cond2 Spec Cond 0
Hit and Run Motor Veh Involved With OTHER MV Lighting DAYLIGHT Ped Action Cntrl Dev NT PRS/FCTR Loc Type Ramp/Int

PARTY INFO

VICTIM INFO

Table with columns: Party Type, Age, Sex, Race, Sobriety1, Sobriety2, Move Pre Coll Dir SW Veh CHP Veh Make Year Sp Info OAF1 Viol OAF2 Safety Equip Role Ext of Inj Age Sex Seat Pos Safety Equip Ejected. Row 1: 1F DRVR 21 M W HNBD RAN OFF RD S A 0100 ACURA 1990 - 3 N - M G. Row 2: 2 DRVR 50 M W HNBD PROC ST N D 2200 FORD 2004 - 3 N - M G PASS 28 M 3 M G 0

Report run on: 8/5/2019
 Total Count: 113

#190942 2009 - AV 2018/2019 COLLISIONS ON BASS LAKE RD BTWN SERRANO PKWY & GREEN VALLEY RD, EL DORADO COUNTY

Case Listing
 Page 4

Primary Rd BRIDLEWOOD DR Distance (ft) 161 Direction E Secondary Rd BASS LAKE RD NCIC 9245 State Hwy? N Route Postmile Prefix Postmile Side of Hwy
 City UNINCORP. County EL DORADO Population 9 Rpt Dist Beat 001 Type 3 CalTrans Dist Badge 17604 Collision Date 20110124 Time 2215 Day MON
 Primary Collision Factor DRVR ALCDRNG Violation 23152A Collision Type HIT OBJECT Severity PDO # Killed 0 # Injured 0 Tow Away? Y Process Date 20120315
 Weather1 CLEAR Weather2 Raining Rdw Surface DRY Rdw Cond1 NO UNUSL CND Rdw Cond2 Spec Cond 0
 Hit and Run MSDMNR Motor Veh Involved With FIXED OBJ Lighting DARK - ST LTS Ped Action Cntrl Dev NT PRS/FCTR Loc Type Ramp/Int

PARTY INFO

VICTIM INFO

Party Type	Age	Sex	Race	Sobriety1	Sobriety2	Move Pre Coll	Dir	SW Veh	CHP Veh	Year	Sp Info	OAF1 Viol	OAF2 Safety Equip	Role	Ext of Inj	Age	Sex	Seat Pos	Safety Equip	Ejected	
1F	DRVR	22	M	W	HBD-UI	BACKING	W	D	2200	FORD	1997	-	3 M	-	M	G					

Primary Rd BASS LAKE RD Distance (ft) 50 Direction S Secondary Rd WOODLEIGH LN NCIC 9260 State Hwy? N Route Postmile Prefix Postmile Side of Hwy
 City UNINCORP. County EL DORADO Population 9 Rpt Dist Beat 002 Type 3 CalTrans Dist Badge 16371 Collision Date 20110218 Time 2353 Day FRI
 Primary Collision Factor WRONG SIDE Violation 21460A Collision Type SIDESWIPE Severity PDO # Killed 0 # Injured 0 Tow Away? N Process Date 20120717
 Weather1 CLOUDY Weather2 RAINING Rdw Surface WET Rdw Cond1 NO UNUSL CND Rdw Cond2 Spec Cond 0
 Hit and Run MSDMNR Motor Veh Involved With OTHER MV Lighting DARK - NO ST LTS Ped Action Cntrl Dev NT PRS/FCTR Loc Type Ramp/Int

PARTY INFO

VICTIM INFO

Party Type	Age	Sex	Race	Sobriety1	Sobriety2	Move Pre Coll	Dir	SW Veh	CHP Veh	Year	Sp Info	OAF1 Viol	OAF2 Safety Equip	Role	Ext of Inj	Age	Sex	Seat Pos	Safety Equip	Ejected	
1F	DRVR	998	M	W	HBD-UNK	OPPOS LN	S	-	9900	-	-	-	N	-	-	-	-	-	-	-	
2	DRVR	20	M	W	HNBD	PROC ST	N	A	0800	KIA	2002	-	3 N	-	M	G					

Primary Rd BASS LAKE RD Distance (ft) 1056 Direction S Secondary Rd WOODLEIGH LN NCIC 9260 State Hwy? N Route Postmile Prefix Postmile Side of Hwy
 City UNINCORP. County EL DORADO Population 9 Rpt Dist Beat 002 Type 3 CalTrans Dist Badge 12718 Collision Date 20110414 Time 0630 Day THU
 Primary Collision Factor WRONG SIDE Violation 21460A Collision Type HEAD-ON Severity INJURY # Killed 0 # Injured 1 Tow Away? N Process Date 20120518
 Weather1 CLEAR Weather2 Raining Rdw Surface DRY Rdw Cond1 NO UNUSL CND Rdw Cond2 Spec Cond 0
 Hit and Run Motor Veh Involved With OTHER MV Lighting DAYLIGHT Ped Action Cntrl Dev NT PRS/FCTR Loc Type Ramp/Int

PARTY INFO

VICTIM INFO

Party Type	Age	Sex	Race	Sobriety1	Sobriety2	Move Pre Coll	Dir	SW Veh	CHP Veh	Year	Sp Info	OAF1 Viol	OAF2 Safety Equip	Role	Ext of Inj	Age	Sex	Seat Pos	Safety Equip	Ejected				
1F	DRVR	20	F	W	HNBD	PROC ST	S	A	0100	HONDA	1995	-	3 F	-	L	G	DRVR	OTH VIS	20	F	1	L	G	0

Primary Rd BASS LAKE RD Distance (ft) 500 Direction S Secondary Rd WOODLEIGH LN NCIC 9260 State Hwy? N Route Postmile Prefix Postmile Side of Hwy
 City UNINCORP. County EL DORADO Population 9 Rpt Dist Beat 201 Type 2 CalTrans Dist Badge 013464 Collision Date 20110701 Time 1000 Day FRI
 Primary Collision Factor NOT DRIVER Violation 21460A Collision Type HIT OBJECT Severity INJURY # Killed 0 # Injured 0 Tow Away? N Process Date 20130211
 Weather1 CLEAR Weather2 Raining Rdw Surface DRY Rdw Cond1 NO UNUSL CND Rdw Cond2 Spec Cond 0
 Hit and Run Motor Veh Involved With FIXED OBJ Lighting DAYLIGHT Ped Action Cntrl Dev NT PRS/FCTR Loc Type Ramp/Int

PARTY INFO

VICTIM INFO

Party Type	Age	Sex	Race	Sobriety1	Sobriety2	Move Pre Coll	Dir	SW Veh	CHP Veh	Year	Sp Info	OAF1 Viol	OAF2 Safety Equip	Role	Ext of Inj	Age	Sex	Seat Pos	Safety Equip	Ejected		
1	DRVR	48	M	W	IMP UNK	IMP UNK	PROC ST	N	A	0700	GMC	2004	-	3 N	-	M	G					

Primary Rd BASS LAKE RD Distance (ft) 1 Direction W Secondary Rd FOXMORE LN NCIC 9260 State Hwy? N Route Postmile Prefix Postmile Side of Hwy
 City UNINCORP. County EL DORADO Population 9 Rpt Dist Beat 201 Type 2 CalTrans Dist Badge 13464 Collision Date 20110717 Time 1040 Day SUN
 Primary Collision Factor IMPROV TURN Violation 22107 Collision Type SIDESWIPE Severity PDO # Killed 0 # Injured 0 Tow Away? N Process Date 20130412
 Weather1 CLEAR Weather2 Raining Rdw Surface DRY Rdw Cond1 NO UNUSL CND Rdw Cond2 Spec Cond 0
 Hit and Run Motor Veh Involved With OTHER MV Lighting DAYLIGHT Ped Action Cntrl Dev NT PRS/FCTR Loc Type Ramp/Int

PARTY INFO

VICTIM INFO

Party Type	Age	Sex	Race	Sobriety1	Sobriety2	Move Pre Coll	Dir	SW Veh	CHP Veh	Year	Sp Info	OAF1 Viol	OAF2 Safety Equip	Role	Ext of Inj	Age	Sex	Seat Pos	Safety Equip	Ejected	
1F	DRVR	44	F	W	HNBD	RGT TURN	W	D	2200	GMC	2004	-	3 N	-	M	G					
2	DRVR	49	F	W	HNBD	STOPPED	S	A	0100	HONDA	1996	-	3 N	-	M	G					

Primary Rd GREEN VALLEY RI Distance (ft) 35 Direction W Secondary Rd BASS LAKE RD NCIC 9260 State Hwy? N Route Postmile Prefix Postmile Side of Hwy
 City UNINCORP. County EL DORADO Population 9 Rpt Dist Beat 203 Type 3 CalTrans Dist Badge 14633 Collision Date 20110826 Time 1815 Day FRI
 Primary Collision Factor UNSAFE SPEED Violation 22350 Collision Type REAR END Severity INJURY # Killed 0 # Injured 2 Tow Away? N Process Date 20121206
 Weather1 CLEAR Weather2 Raining Rdw Surface DRY Rdw Cond1 NO UNUSL CND Rdw Cond2 Spec Cond 0
 Hit and Run Motor Veh Involved With OTHER MV Lighting DAYLIGHT Ped Action Cntrl Dev NT PRS/FCTR Loc Type Ramp/Int

PARTY INFO

VICTIM INFO

Party Type	Age	Sex	Race	Sobriety1	Sobriety2	Move Pre Coll	Dir	SW Veh	CHP Veh	Year	Sp Info	OAF1 Viol	OAF2 Safety Equip	Role	Ext of Inj	Age	Sex	Seat Pos	Safety Equip	Ejected				
1F	DRVR	69	M	W	HNBD	PROC ST	E	C	0200	HARLE	2001	-	3 N	-	P	W	DRVR	OTH VIS	69	M	1	P	W	0
2	DRVR	41	M	W	HNBD	SLOWING	E	C	0200	HARLE	2002	-	3 N	-	P	W	PASS	COMP PN	70	F	2	P	W	0

Primary Rd GREEN VALLEY RI Distance (ft) 600 Direction W Secondary Rd BASS LAKE RD NCIC 9260 State Hwy? N Route Postmile Prefix Postmile Side of Hwy
 City UNINCORP. County EL DORADO Population 9 Rpt Dist Beat 203 Type 3 CalTrans Dist Badge 16429 Collision Date 20111125 Time 1727 Day FRI
 Primary Collision Factor IMPROP TURN Violation 22107 Collision Type OTHER Severity INJURY # Killed 0 # Injured 1 Tow Away? N Process Date 20130119
 Weather1 FOG Weather2 Rdwly Surface DRY Rdwly Cond1 NO UNUSL CND Rdwly Cond2 Spec Cond 0
 Hit and Run Motor Veh Involved With BICYCLE Lighting DARK - NO ST LTS Ped Action Cntrl Dev NT PRS/FCTR Loc Type Ramp/Int

PARTY INFO

VICTIM INFO

Party Type	Age	Sex	Race	Sobriety1	Sobriety2	Move Pre Coll Dir	SW Veh	CHP Veh	Make	Year	Sp Info	OAF1 Viol	OAF2 Safety Equip	Role	Ext of Inj	Age	Sex	Seat Pos	Safety Equip	Ejected	
1F	DRVR	64	M	A	HNBD	FATG	UNSTURN	E D	2200	TOYOT	2002	- 3	N	-	M G						
2	BICY	48	M	W	HNBD	PROC ST	E L	0400	-	-	- 3	N	-	-	BICY	OTH VIS	48	M	1	P	W 1

Primary Rd BASS LAKE RD Distance (ft) 24 Direction N Secondary Rd PARKDALE LN NCIC 9260 State Hwy? N Route Postmile Prefix Postmile Side of Hwy
 City UNINCORP. County EL DORADO Population 9 Rpt Dist Beat 002 Type 3 CalTrans Dist Badge 018316 Collision Date 20120110 Time 2047 Day TUE
 Primary Collision Factor UNSAFE SPEED Violation 22350 Collision Type REAR END Severity INJURY # Killed 0 # Injured 1 Tow Away? Y Process Date 20130607
 Weather1 CLEAR Weather2 Rdwly Surface DRY Rdwly Cond1 NO UNUSL CND Rdwly Cond2 Spec Cond 0
 Hit and Run Motor Veh Involved With OTHER MV Lighting DARK - ST LTS Ped Action Cntrl Dev FNCTNG Loc Type Ramp/Int

PARTY INFO

VICTIM INFO

Party Type	Age	Sex	Race	Sobriety1	Sobriety2	Move Pre Coll Dir	SW Veh	CHP Veh	Make	Year	Sp Info	OAF1 Viol	OAF2 Safety Equip	Role	Ext of Inj	Age	Sex	Seat Pos	Safety Equip	Ejected	
1F	DRVR	18	F	W	HNBD	PROC ST	S A	0100	LINCO	1995	- 3	N	-	L G							
2	DRVR	18	M	W	HNBD	PROC ST	S D	2200	FORD	2001	- 3	N	-	M G	DRVR	OTH VIS	18	M	1	M G	0

Primary Rd BASS LAKE RD Distance (ft) 80 Direction N Secondary Rd WOODLEIGH LN NCIC 9260 State Hwy? N Route Postmile Prefix Postmile Side of Hwy
 City UNINCORP. County EL DORADO Population 9 Rpt Dist Beat 201 Type 2 CalTrans Dist Badge 013147 Collision Date 20120124 Time 1830 Day TUE
 Primary Collision Factor UNSAFE SPEED Violation 22350 Collision Type REAR END Severity PDO # Killed 0 # Injured 0 Tow Away? N Process Date 20130801
 Weather1 CLEAR Weather2 Rdwly Surface DRY Rdwly Cond1 NO UNUSL CND Rdwly Cond2 Spec Cond 0
 Hit and Run Motor Veh Involved With OTHER MV Lighting DARK - NO ST LTS Ped Action Cntrl Dev NT PRS/FCTR Loc Type Ramp/Int

PARTY INFO

VICTIM INFO

Party Type	Age	Sex	Race	Sobriety1	Sobriety2	Move Pre Coll Dir	SW Veh	CHP Veh	Make	Year	Sp Info	OAF1 Viol	OAF2 Safety Equip	Role	Ext of Inj	Age	Sex	Seat Pos	Safety Equip	Ejected	
1F	DRVR	50	F	W	HNBD	PROC ST	S A	0700	HONDA	2007	- 3	N	-	M G							
2	DRVR	51	M	W	HNBD	STOPPED	S A	0100	BMW	2004	- 3	N	-	M G							
3	DRVR	37	M	W	HNBD	STOPPED	S A	0100	CHEVR	2011	- 3	N	-	M G							

Primary Rd BASS LAKE RD Distance (ft) 45 Direction E Secondary Rd SANDHURST HILL R NCIC 9260 State Hwy? N Route Postmile Prefix Postmile Side of Hwy
 City UNINCORP. County EL DORADO Population 9 Rpt Dist Beat 002 Type 3 CalTrans Dist Badge 018456 Collision Date 20120220 Time 2240 Day MON
 Primary Collision Factor DRVR ALCJDRG Violation 23152A Collision Type SIDESWIPE Severity PDO # Killed 0 # Injured 0 Tow Away? Y Process Date 20130830
 Weather1 CLOUDY Weather2 Rdwly Surface DRY Rdwly Cond1 NO UNUSL CND Rdwly Cond2 Spec Cond 0
 Hit and Run MSDMNR Motor Veh Involved With OTHER MV Lighting DARK - ST LTS Ped Action Cntrl Dev NT PRS/FCTR Loc Type Ramp/Int

PARTY INFO

VICTIM INFO

Party Type	Age	Sex	Race	Sobriety1	Sobriety2	Move Pre Coll Dir	SW Veh	CHP Veh	Make	Year	Sp Info	OAF1 Viol	OAF2 Safety Equip	Role	Ext of Inj	Age	Sex	Seat Pos	Safety Equip	Ejected	
1F	DRVR	34	M	W	HBD-UI	OPPOS LN	S D	2200	GMC	2001	- 3	A	-	M G							
2	DRVR	59	F	W	HNBD	PROC ST	N A	0100	CHEVR	2004	- 3	N	-	M G	PASS	58	M	3	G M	0	

Primary Rd BASS LAKE RD Distance (ft) 500 Direction N Secondary Rd MADERA WY NCIC 9260 State Hwy? N Route Postmile Prefix Postmile Side of Hwy
 City UNINCORP. County EL DORADO Population 9 Rpt Dist Beat 002 Type 3 CalTrans Dist Badge 12781 Collision Date 20120301 Time 1030 Day THU
 Primary Collision Factor IMPROP TURN Violation 22107 Collision Type HEAD-ON Severity INJURY # Killed 0 # Injured 2 Tow Away? Y Process Date 20130806
 Weather1 CLOUDY Weather2 RAINING Rdwly Surface WET Rdwly Cond1 NO UNUSL CND Rdwly Cond2 Spec Cond 0
 Hit and Run Motor Veh Involved With OTHER MV Lighting DAYLIGHT Ped Action Cntrl Dev NT PRS/FCTR Loc Type Ramp/Int

PARTY INFO

VICTIM INFO

Party Type	Age	Sex	Race	Sobriety1	Sobriety2	Move Pre Coll Dir	SW Veh	CHP Veh	Make	Year	Sp Info	OAF1 Viol	OAF2 Safety Equip	Role	Ext of Inj	Age	Sex	Seat Pos	Safety Equip	Ejected	
1F	DRVR	18	F	W	HNBD	UNSTURN	S D	2200	DODGE	2007	- 3	N	-	B G	DRVR	COMP PN	18	F	1	B G	0
2	DRVR	41	F	W	HNBD	PROC ST	N A	0700	HONDA	2011	- 3	N	-	L G	DRVR	COMP PN	41	F	1	L G	0

Primary Rd BASS LAKE RD Distance (ft) 500 Direction N Secondary Rd MADERA WY NCIC 9245 State Hwy? N Route Postmile Prefix Postmile Side of Hwy
 City UNINCORP. County EL DORADO Population 9 Rpt Dist Beat 001 Type 3 CalTrans Dist Badge 17728 Collision Date 20120713 Time 1605 Day FRI
 Primary Collision Factor WRONG SIDE Violation 21460A Collision Type SIDESWIPE Severity PDO # Killed 0 # Injured 0 Tow Away? Y Process Date 20140205
 Weather1 CLEAR Weather2 Rdwly Surface DRY Rdwly Cond1 NO UNUSL CND Rdwly Cond2 Spec Cond 0
 Hit and Run Motor Veh Involved With OTHER MV Lighting DAYLIGHT Ped Action Cntrl Dev NT PRS/FCTR Loc Type Ramp/Int

PARTY INFO

VICTIM INFO

Party Type	Age	Sex	Race	Sobriety1	Sobriety2	Move Pre Coll Dir	SW Veh	CHP Veh	Make	Year	Sp Info	OAF1 Viol	OAF2 Safety Equip	Role	Ext of Inj	Age	Sex	Seat Pos	Safety Equip	Ejected	
1	DRVR	18	M	O	HNBD	PROC ST	S C	0200	YAMAHA	2003	- 3	N	-	P W							
2F	DRVR	998			IMP UNK	IMP UNK	PROC ST	N -	9900	-	- 3	N	-	-							

Report run on: 8/5/2019
 Total Count: 113

#190942 2009 - AV 2018/2019 COLLISIONS ON BASS LAKE RD BTWN SERRANO PKWY & GREEN VALLEY RD, EL DORADO COUNTY

Primary Rd **MAGNOLIA HILLS I** Distance (ft) 10 Direction **E** Secondary Rd **BASS LAKE RD** NCIC 9245 State Hwy? **N** Route Postmile Prefix Postmile Side of Hwy
 City **UNINCORP.** County **EL DORADO** Population 9 Rpt Dist Beat **014** Type 2 CalTrans Dist Badge **017737** Collision Date **20120722** Time **0350** Day **SUN**
 Primary Collision Factor **IMPROP TURN** Violation **22107** Collision Type **HIT OBJECT** Severity **PDO** # Killed 0 # Injured 0 Tow Away? **Y** Process Date **20140612**
 Weather1 **CLEAR** Weather2 Rdw Surface **DRY** Rdw Cond1 **NO UNUSL CND** Rdw Cond2 Spec Cond 0
 Hit and Run Motor Veh Involved With **FIXED OBJ** Lighting **DARK - ST LTS** Ped Action Cntrl Dev **NT PRS/FCTR** Loc Type Ramp/Int

PARTY INFO

VICTIM INFO

Party Type	Age	Sex	Race	Sobriety1	Sobriety2	Move Pre Coll	Dir	SW Veh	CHP Veh	Veh Make	Year	Sp Info	OAF1 Viol	OAF2 Safety Equip	Role	Ext of Inj	Age	Sex	Seat Pos	Safety Equip	Ejected
1F	DRVR	998		IMP UNK	IMP UNK	LFT TURN	S	A	0100	HONDA	2001	- 3	N	- B							

Primary Rd **BASS LAKE RD** Distance (ft) 50 Direction **S** Secondary Rd **MADERA WY** NCIC 9245 State Hwy? **N** Route Postmile Prefix Postmile Side of Hwy
 City **UNINCORP.** County **EL DORADO** Population 9 Rpt Dist Beat **001** Type 3 CalTrans Dist Badge **18624** Collision Date **20120821** Time **1110** Day **TUE**
 Primary Collision Factor **WRONG SIDE** Violation **21650** Collision Type **HIT OBJECT** Severity **PDO** # Killed 0 # Injured 0 Tow Away? **N** Process Date **20140226**
 Weather1 **CLEAR** Weather2 Rdw Surface **DRY** Rdw Cond1 **NO UNUSL CND** Rdw Cond2 Spec Cond 0
 Hit and Run Motor Veh Involved With **OTHER OBJ** Lighting **DAYLIGHT** Ped Action Cntrl Dev **NT PRS/FCTR** Loc Type Ramp/Int

PARTY INFO

VICTIM INFO

Party Type	Age	Sex	Race	Sobriety1	Sobriety2	Move Pre Coll	Dir	SW Veh	CHP Veh	Veh Make	Year	Sp Info	OAF1 Viol	OAF2 Safety Equip	Role	Ext of Inj	Age	Sex	Seat Pos	Safety Equip	Ejected
1F	DRVR	23	F	W	HNBD	RAN OFF RD	N	A	0100	MERCE	1998	- 3	A	22107 -	L	G					

Primary Rd **BASS LAKE RD** Distance (ft) 500 Direction **S** Secondary Rd **WOODLEIGH LN** NCIC 9245 State Hwy? **N** Route Postmile Prefix Postmile Side of Hwy
 City **UNINCORP.** County **EL DORADO** Population 9 Rpt Dist Beat **001** Type 3 CalTrans Dist Badge **018240** Collision Date **20121027** Time **0130** Day **SAT**
 Primary Collision Factor **IMPROP TURN** Violation **22107** Collision Type **HIT OBJECT** Severity **PDO** # Killed 0 # Injured 0 Tow Away? **Y** Process Date **20140417**
 Weather1 **CLEAR** Weather2 Rdw Surface **DRY** Rdw Cond1 **NO UNUSL CND** Rdw Cond2 Spec Cond 0
 Hit and Run Motor Veh Involved With **FIXED OBJ** Lighting **DARK - NO ST LTS** Ped Action Cntrl Dev **NT PRS/FCTR** Loc Type Ramp/Int

PARTY INFO

VICTIM INFO

Party Type	Age	Sex	Race	Sobriety1	Sobriety2	Move Pre Coll	Dir	SW Veh	CHP Veh	Veh Make	Year	Sp Info	OAF1 Viol	OAF2 Safety Equip	Role	Ext of Inj	Age	Sex	Seat Pos	Safety Equip	Ejected
1F	DRVR	998		IMP UNK	IMP UNK	RAN OFF RD	S	A	0100	HONDA	1995	- -	N	- M	B						

Primary Rd **BASS LAKE RD** Distance (ft) 1 Direction **S** Secondary Rd **BRIDLEWOOD LN** NCIC 9245 State Hwy? **N** Route Postmile Prefix Postmile Side of Hwy
 City **UNINCORP.** County **EL DORADO** Population 9 Rpt Dist Beat **001** Type 3 CalTrans Dist Badge **16629** Collision Date **20121215** Time **1620** Day **SAT**
 Primary Collision Factor **UNSAFE SPEED** Violation **22350** Collision Type **REAR END** Severity **PDO** # Killed 0 # Injured 0 Tow Away? **Y** Process Date **20140604**
 Weather1 **RAINING** Weather2 Rdw Surface **WET** Rdw Cond1 **NO UNUSL CND** Rdw Cond2 Spec Cond 0
 Hit and Run Motor Veh Involved With **OTHER MV** Lighting **DAYLIGHT** Ped Action Cntrl Dev **NT PRS/FCTR** Loc Type Ramp/Int

PARTY INFO

VICTIM INFO

Party Type	Age	Sex	Race	Sobriety1	Sobriety2	Move Pre Coll	Dir	SW Veh	CHP Veh	Veh Make	Year	Sp Info	OAF1 Viol	OAF2 Safety Equip	Role	Ext of Inj	Age	Sex	Seat Pos	Safety Equip	Ejected		
1F	DRVR	20	F	A	HNBD	PROC ST	S	A	0100	TOYOT	2000	- 3	N	- M	G								
2	DRVR	26	F	A	HNBD	STOPPED	S	A	0100	CHEVR	2012	- 3	N	- M	G	PASS		33	M	3	M	G	0
3	DRVR	72	M	W	HNBD	STOPPED	S	A	0100	SUBAR	2011	- 3	N	- M	G	PASS		6	F	5	P	Q	0
																PASS		71	F	3	M	G	0

Primary Rd **GREEN VALLEY RI** Distance (ft) 528 Direction **W** Secondary Rd **BASS LAKE RD** NCIC 9245 State Hwy? **N** Route Postmile Prefix Postmile Side of Hwy
 City **UNINCORP.** County **EL DORADO** Population 9 Rpt Dist Beat **011** Type 2 CalTrans Dist Badge **15107** Collision Date **20130313** Time **0740** Day **WED**
 Primary Collision Factor **UNSAFE SPEED** Violation **22350** Collision Type **REAR END** Severity **INJURY** # Killed 0 # Injured 1 Tow Away? **Y** Process Date **20140206**
 Weather1 **CLEAR** Weather2 Rdw Surface **DRY** Rdw Cond1 **OTHER** Rdw Cond2 Spec Cond 0
 Hit and Run Motor Veh Involved With **OTHER MV** Lighting Ped Action Cntrl Dev **FUNCTNG** Loc Type Ramp/Int

PARTY INFO

VICTIM INFO

Party Type	Age	Sex	Race	Sobriety1	Sobriety2	Move Pre Coll	Dir	SW Veh	CHP Veh	Veh Make	Year	Sp Info	OAF1 Viol	OAF2 Safety Equip	Role	Ext of Inj	Age	Sex	Seat Pos	Safety Equip	Ejected		
1F	DRVR	22	F	W	HNBD	PROC ST	E	D	2200	CHEVR	1995	- 3	N	- M	G								
2	DRVR	48	M	W	HNBD	STOPPED	E	A	0700	SUBAR	2012	- 3	N	- M	G	DRVR COMP PN		48	M	1	M	G	0
3	DRVR	39	F	W	HNBD	STOPPED	E	A	0100	HONDA	2003	- 3	N	- M	G								
4	DRVR	43	F	W	HNBD	PROC ST	E	D	2200	DODGE	2006	- 3	A	22350	I	M	G						

Primary Rd **GREEN VALLEY RI** Distance (ft) 500 Direction **W** Secondary Rd **BASS LAKE RD** NCIC 9245 State Hwy? **N** Route Postmile Prefix Postmile Side of Hwy
 City **UNINCORP.** County **EL DORADO** Population 9 Rpt Dist Beat **011** Type 2 CalTrans Dist Badge **016451** Collision Date **20130319** Time **0738** Day **TUE**
 Primary Collision Factor **UNSAFE SPEED** Violation **22350** Collision Type **REAR END** Severity **PDO** # Killed 0 # Injured 0 Tow Away? **Y** Process Date **20140722**
 Weather1 **CLEAR** Weather2 Rdw Surface **DRY** Rdw Cond1 **NO UNUSL CND** Rdw Cond2 Spec Cond 0
 Hit and Run Motor Veh Involved With **OTHER MV** Lighting **DAYLIGHT** Ped Action Cntrl Dev **NT PRS/FCTR** Loc Type Ramp/Int

PARTY INFO

VICTIM INFO

Party Type	Age	Sex	Race	Sobriety1	Sobriety2	Move Pre Coll	Dir	SW Veh	CHP Veh	Veh Make	Year	Sp Info	OAF1 Viol	OAF2 Safety Equip	Role	Ext of Inj	Age	Sex	Seat Pos	Safety Equip	Ejected
1F	DRVR	65	M	W	HNBD	PROC ST	E	A	0100	HONDA	2005	- 3	N	- L	G						
2	DRVR	41	F	W	HNBD	SLOWING	E	A	0700	HONDA	2008	- 3	N	- M	G						

Total Count: 113

Primary Rd BASS LAKE RD Distance (ft) 40 Direction S Secondary Rd SANDHURST HILL R NCIC 9245 State Hwy? N Route Postmile Prefix Postmile Side of Hwy
 City UNINCORP. County EL DORADO Population 9 Rpt Dist Beat 001 Type 3 CalTrans Dist Badge 015607 Collision Date 20130328 Time 1923 Day THU
 Primary Collision Factor DRVR ALCDJRG Violation 23152A Collision Type HIT OBJECT Severity INJURY # Killed 0 # Injured 2 Tow Away? Y Process Date 20140206
 Weather1 CLEAR Weather2 RdwY Surface DRY RdwY Cond1 NO UNUSL CND RdwY Cond2 Spec Cond 0
 Hit and Run Motor Veh Involved With FIXED OBJ Lighting DARK - NO ST LTS Ped Action Cntrl Dev NT PRS/FCTR Loc Type Ramp/Int

PARTY INFO

VICTIM INFO

Party Type	Age	Sex	Race	Sobriety1	Sobriety2	Move Pre	Coll Dir	SW Veh	CHP Veh	Make	Year	Sp Info	OAF1 Viol	OAF2 Safety Equip	Role	Ext of Inj	Age	Sex	Seat Pos	Safety Equip	Ejected
1F	DRVR	49	M	W	HBD-UI	RAN OFF RD	S D	2200	CHEVR	2012	-	3	A 21650	F L G	DRVR OTH VIS	49	M	1	L G	0	
															PASS OTH VIS	61	M	3	L G	0	

Primary Rd BRIDLEWOOD DR Distance (ft) 350 Direction E Secondary Rd BASS LAKE RD NCIC 9245 State Hwy? N Route Postmile Prefix Postmile Side of Hwy
 City UNINCORP. County EL DORADO Population 9 Rpt Dist Beat 001 Type 3 CalTrans Dist Badge 15929 Collision Date 20130424 Time 1230 Day WED
 Primary Collision Factor HAZ PARKING Violation 22515A Collision Type HIT OBJECT Severity INJURY # Killed 0 # Injured 1 Tow Away? Y Process Date 20140213
 Weather1 CLEAR Weather2 RdwY Surface DRY RdwY Cond1 NO UNUSL CND RdwY Cond2 Spec Cond 0
 Hit and Run Motor Veh Involved With PED Lighting DAYLIGHT Ped Action Cntrl Dev NT PRS/FCTR Loc Type Ramp/Int

PARTY INFO

VICTIM INFO

Party Type	Age	Sex	Race	Sobriety1	Sobriety2	Move Pre	Coll Dir	SW Veh	CHP Veh	Make	Year	Sp Info	OAF1 Viol	OAF2 Safety Equip	Role	Ext of Inj	Age	Sex	Seat Pos	Safety Equip	Ejected
1F	DRVR	70	F	W	HNBD	STOPPED	E A	0700	DODGE	2000	-	3	O	M H	DRVR COMP PN	70	F	0	M H	0	

Primary Rd BASS LAKE RD Distance (ft) 1 Direction S Secondary Rd BRIDLEWOOD DR NCIC 9245 State Hwy? N Route Postmile Prefix Postmile Side of Hwy
 City UNINCORP. County EL DORADO Population 9 Rpt Dist Beat 001 Type 3 CalTrans Dist Badge 014956 Collision Date 20130626 Time 1050 Day WED
 Primary Collision Factor UNSAFE SPEED Violation 22350 Collision Type REAR END Severity PDO # Killed 0 # Injured 0 Tow Away? N Process Date 20140922
 Weather1 CLEAR Weather2 RdwY Surface DRY RdwY Cond1 NO UNUSL CND RdwY Cond2 Spec Cond 0
 Hit and Run Motor Veh Involved With OTHER MV Lighting DAYLIGHT Ped Action Cntrl Dev NT PRS/FCTR Loc Type Ramp/Int

PARTY INFO

VICTIM INFO

Party Type	Age	Sex	Race	Sobriety1	Sobriety2	Move Pre	Coll Dir	SW Veh	CHP Veh	Make	Year	Sp Info	OAF1 Viol	OAF2 Safety Equip	Role	Ext of Inj	Age	Sex	Seat Pos	Safety Equip	Ejected
1F	DRVR	19	F	A	HNBD	PROC ST	S A	0100	ACURA	2000	-	3	N	M G	PASS		12	F	3	M G	0
2	DRVR	19	F	W	HNBD	STOPPED	S A	0100	CHEVR	2007	-	3	N	M G	PASS		11	F	4	M G	0
															PASS		9	F	6	M G	0

Primary Rd GREEN VALLEY RI Distance (ft) 3696 Direction W Secondary Rd BASS LAKE RD NCIC 9245 State Hwy? N Route Postmile Prefix Postmile Side of Hwy
 City UNINCORP. County EL DORADO Population 9 Rpt Dist Beat 011 Type 2 CalTrans Dist Badge 13929 Collision Date 20130930 Time 1630 Day MON
 Primary Collision Factor WRONG SIDE Violation 21460A Collision Type HEAD-ON Severity INJURY # Killed 0 # Injured 1 Tow Away? Y Process Date 20140419
 Weather1 CLOUDY Weather2 RdwY Surface DRY RdwY Cond1 CONS ZONE RdwY Cond2 Spec Cond 0
 Hit and Run Motor Veh Involved With OTHER MV Lighting DAYLIGHT Ped Action Cntrl Dev NT PRS/FCTR Loc Type Ramp/Int

PARTY INFO

VICTIM INFO

Party Type	Age	Sex	Race	Sobriety1	Sobriety2	Move Pre	Coll Dir	SW Veh	CHP Veh	Make	Year	Sp Info	OAF1 Viol	OAF2 Safety Equip	Role	Ext of Inj	Age	Sex	Seat Pos	Safety Equip	Ejected
1F	DRVR	60	F	W	HNBD	PROC ST	W A	0700	JEEP	2002	-	3	N	L G	DRVR OTH VIS	36	M	1	L G	0	
2	DRVR	36	F	W	HNBD	PROC ST	E A	0100	TOYOT	2002	-	3	N	M G							
3	DRVR	44	F	W	HNBD	PROC ST	E A	0700	FORD	2005	-	3	N	L G							

Primary Rd BASS LAKE RD Distance (ft) 46 Direction S Secondary Rd GATEWAY DR NCIC 9245 State Hwy? N Route Postmile Prefix Postmile Side of Hwy
 City UNINCORP. County EL DORADO Population 9 Rpt Dist Beat 001 Type 3 CalTrans Dist Badge 18466 Collision Date 20131004 Time 2320 Day FRI
 Primary Collision Factor IMPROP TURN Violation 22107 Collision Type HIT OBJECT Severity INJURY # Killed 0 # Injured 1 Tow Away? Y Process Date 20140419
 Weather1 CLEAR Weather2 RdwY Surface DRY RdwY Cond1 NO UNUSL CND RdwY Cond2 Spec Cond 0
 Hit and Run Motor Veh Involved With FIXED OBJ Lighting DARK - NO ST LTS Ped Action Cntrl Dev NT PRS/FCTR Loc Type Ramp/Int

PARTY INFO

VICTIM INFO

Party Type	Age	Sex	Race	Sobriety1	Sobriety2	Move Pre	Coll Dir	SW Veh	CHP Veh	Make	Year	Sp Info	OAF1 Viol	OAF2 Safety Equip	Role	Ext of Inj	Age	Sex	Seat Pos	Safety Equip	Ejected
1F	DRVR	28	F	W	HNBD	RAN OFF RD	N A	0100	HYUND	2007	-	3	N	L G	DRVR COMP PN	28	F	1	L G	0	

Primary Rd BASS LAKE RD Distance (ft) 10 Direction N Secondary Rd SANDHURST HILL R NCIC 9245 State Hwy? N Route Postmile Prefix Postmile Side of Hwy
 City UNINCORP. County EL DORADO Population 9 Rpt Dist Beat 001 Type 3 CalTrans Dist Badge 17728 Collision Date 20131021 Time 1950 Day MON
 Primary Collision Factor IMPROP TURN Violation 22107 Collision Type BROADSIDE Severity PDO # Killed 0 # Injured 0 Tow Away? Y Process Date 20141114
 Weather1 CLEAR Weather2 RdwY Surface DRY RdwY Cond1 NO UNUSL CND RdwY Cond2 Spec Cond 0
 Hit and Run Motor Veh Involved With OTHER MV Lighting DARK - NO ST LTS Ped Action Cntrl Dev NT PRS/FCTR Loc Type Ramp/Int

PARTY INFO

VICTIM INFO

Party Type	Age	Sex	Race	Sobriety1	Sobriety2	Move Pre	Coll Dir	SW Veh	CHP Veh	Make	Year	Sp Info	OAF1 Viol	OAF2 Safety Equip	Role	Ext of Inj	Age	Sex	Seat Pos	Safety Equip	Ejected
1	DRVR	18	F	W	HNBD	PROC ST	S A	0100	INFN	1998	-	3	N	L G							
2F	DRVR	47	F	A	HNBD	PROC ST	N A	0700	HONDA	2004	-	3	N	M G							

Total Count: 113

PARTY INFO															VICTIM INFO										
Party Type	Age	Sex	Race	Sobriety1	Sobriety2	Move Pre Coll	Dir	SW Veh	CHP Veh	Veh Make	Year	Sp Info	OAF1 Viol	OAF2 Safety Equip	Role	Ext of Inj	Age	Sex	Seat Pos	Safety Equip	Ejected				
Primary Rd GREEN VALLEY RI Distance (ft) 4224 Direction W Secondary Rd BASS LAKE RD NCIC 9245 State Hwy? N						Route Postmile Prefix Postmile Side of Hwy						City UNINCORP. County EL DORADO Population 9 Rpt Dist Beat 011 Type 2 CalTrans Dist Badge 013929 Collision Date 20131021 Time 1315 Day MON													
Primary Collision Factor UNSAFE SPEED Violation 22350 Collision Type REAR END Severity PDO # Killed 0 # Injured 0 Tow Away? N Process Date 20141114						Weather1 CLEAR Weather2 Motor Veh Involved With OTHER MV Lighting DAYLIGHT Ped Action						Rdwy Surface DRY Rdwy Cond1 CONS ZONE Rdwy Cond2 Cntrl Dev FNCTNG Loc Type Ramp/Int													
1	DRVR	53	M	W	HNBD	PROC ST	E	A	0100	INFIN	2010	-	3	N	-	M	G								
2F	DRVR	26	M	W	HNBD	PROC ST	E	D	2200	CHEVR	2002	-	3	N	-	M	G	PASS	47	M	3	M	G	0	
Primary Rd BASS LAKE RD Distance (ft) 1 Direction Secondary Rd WOODLEIGH LN NCIC 9245 State Hwy? N						Route Postmile Prefix Postmile Side of Hwy						City UNINCORP. County EL DORADO Population 9 Rpt Dist Beat 001 Type 3 CalTrans Dist Badge 17089 Collision Date 20131024 Time 1830 Day THU													
Primary Collision Factor UNSAFE SPEED Violation 22350 Collision Type REAR END Severity PDO # Killed 0 # Injured 0 Tow Away? Y Process Date 20141114						Weather1 CLEAR Weather2 Motor Veh Involved With OTHER MV Lighting DUSK/DAWN Ped Action						Rdwy Surface DRY Rdwy Cond1 NO UNUSL CND Rdwy Cond2 Cntrl Dev NT PRS/FCTR Loc Type Ramp/Int													
1F	DRVR	17	F	W	HNBD	PROC ST	S	A	0100	MERCE	2004	-	3	N	-	M	G								
2	DRVR	46	F	W	HNBD	SLOWING	S	A	0700	MERCE	2002	-	3	N	-	M	G								
Primary Rd BASS LAKE RD Distance (ft) 1 Direction Secondary Rd BRIDLEWOOD DR NCIC 9245 State Hwy? N						Route Postmile Prefix Postmile Side of Hwy						City UNINCORP. County EL DORADO Population 9 Rpt Dist Beat 001 Type 3 CalTrans Dist Badge 15107 Collision Date 20140131 Time 0715 Day FRI													
Primary Collision Factor R-O-W AUTO Violation 21801A Collision Type BROADSIDE Severity PDO # Killed 0 # Injured 0 Tow Away? N Process Date 20140724						Weather1 CLEAR Weather2 Motor Veh Involved With OTHER MV Lighting DAYLIGHT Ped Action						Rdwy Surface WET Rdwy Cond1 NO UNUSL CND Rdwy Cond2 Cntrl Dev NT PRS/FCTR Loc Type Ramp/Int													
1F	DRVR	17	F	W	HNBD	LFT TURN	S	A	0100	VOLKS	2001	-	3	E	-	M	G								
2	DRVR	45	M	W	HNBD	PROC ST	S	J	4800	FORD	2002	-	3	N	-	M	G								
Primary Rd BASS LAKE RD Distance (ft) 25 Direction S Secondary Rd GREEN VALLEY RD NCIC 9245 State Hwy? N						Route Postmile Prefix Postmile Side of Hwy						City UNINCORP. County EL DORADO Population 9 Rpt Dist Beat 001 Type 3 CalTrans Dist Badge 017089 Collision Date 20140209 Time 1935 Day SUN													
Primary Collision Factor UNSAFE SPEED Violation 22350 Collision Type HIT OBJECT Severity PDO # Killed 0 # Injured 0 Tow Away? Y Process Date 20150206						Weather1 CLOUDY Weather2 RAINING Motor Veh Involved With FIXED OBJ Lighting DARK - ST LTS Ped Action						Rdwy Surface WET Rdwy Cond1 NO UNUSL CND Rdwy Cond2 Cntrl Dev FNCTNG Loc Type Ramp/Int													
1F	DRVR	20	M	W	HNBD	LFT TURN	S	A	0100	TOYOT	2006	-	3	N	-	M	G								
1F	DRVR	20	M	W	HNBD	LFT TURN	S	A	0100	TOYOT	2006	-	3	N	-	M	G	DRVR	OTH VIS	23	M	1	P	W	1
Primary Rd BASS LAKE RD Distance (ft) 700 Direction S Secondary Rd BRIDLEWOOD DR NCIC 9245 State Hwy? N						Route Postmile Prefix Postmile Side of Hwy						City UNINCORP. County EL DORADO Population 9 Rpt Dist Beat 001 Type 3 CalTrans Dist Badge 17737 Collision Date 20140222 Time 1430 Day SAT													
Primary Collision Factor IMPROP TURN Violation 22107 Collision Type HIT OBJECT Severity INJURY # Killed 0 # Injured 1 Tow Away? Y Process Date 20140628						Weather1 CLEAR Weather2 Motor Veh Involved With FIXED OBJ Lighting DAYLIGHT Ped Action						Rdwy Surface DRY Rdwy Cond1 NO UNUSL CND Rdwy Cond2 Cntrl Dev NT PRS/FCTR Loc Type Ramp/Int													
1F	DRVR	23	M	W	HNBD	OTHER	N	C	0200	SUZUK	2008	-	3	N	-	P	W								
1F	DRVR	23	M	W	HNBD	OTHER	N	C	0200	SUZUK	2008	-	3	N	-	P	W								
Primary Rd GREEN VALLEY RI Distance (ft) 30 Direction W Secondary Rd BASS LAKE RD NCIC 9245 State Hwy? N						Route Postmile Prefix Postmile Side of Hwy						City UNINCORP. County EL DORADO Population 9 Rpt Dist Beat 001 Type 3 CalTrans Dist Badge 17737 Collision Date 20140222 Time 1955 Day SAT													
Primary Collision Factor IMPROP PASS Violation 21755 Collision Type SIDESWIPE Severity PDO # Killed 0 # Injured 0 Tow Away? N Process Date 20150203						Weather1 CLEAR Weather2 Motor Veh Involved With OTHER MV Lighting DARK - ST LTS Ped Action						Rdwy Surface DRY Rdwy Cond1 NO UNUSL CND Rdwy Cond2 Cntrl Dev NT PRS/FCTR Loc Type Ramp/Int													
1F	DRVR	23	M	W	HNBD	PROC ST	E	A	0100	TOYOT	1992	-	3	N	-	M	G								
2	DRVR	47	M	W	HNBD	RGT TURN	E	A	0100	MERCE	2002	-	3	N	-	M	G								

Primary Rd BASS LAKE RD Distance (ft) 528 Direction S Secondary Rd MAGNOLIA HILLS D NCIC 9245 State Hwy? N Route Postmile Prefix Postmile Side of Hwy
 City UNINCORP. County EL DORADO Population 9 Rpt Dist Beat 001 Type 3 CalTrans Dist Badge 015107 Collision Date 20140225 Time 2100 Day TUE
 Primary Collision Factor IMPROP TURN Violation 22107 Collision Type HIT OBJECT Severity PDO # Killed 0 # Injured 0 Tow Away? Y Process Date 20150204
 Weather1 CLOUDY Weather2 Rdw Surface DRY Rdw Cond1 NO UNUSL CND Rdw Cond2 Spec Cond 0
 Hit and Run Motor Veh Involved With FIXED OBJ Lighting DARK - NO ST LTS Ped Action Cntrl Dev NT PRS/FCTR Loc Type Ramp/Int

PARTY INFO

VICTIM INFO

Party	Type	Age	Sex	Race	Sobriety1	Sobriety2	Move	Pre Coll	Dir	SW	Veh	CHP	Veh	Make	Year	Sp	Info	OAF1	Viol	OAF2	Safety Equip	Role	Ext of Inj	Age	Sex	Seat Pos	Safety Equip	Ejected
1F	DRVR	998			IMP UNK	IMP UNK	RAN OFF	RD	S	A	0100	VOLVO	2000	-	-	N	-	-	L	B								

Primary Rd GREEN VALLEY RI Distance (ft) 528 Direction W Secondary Rd BASS LAKE RD NCIC 9245 State Hwy? N Route Postmile Prefix Postmile Side of Hwy
 City UNINCORP. County EL DORADO Population 9 Rpt Dist Beat 011 Type 2 CalTrans Dist Badge 15107 Collision Date 20140314 Time 0730 Day FRI
 Primary Collision Factor UNSAFE SPEED Violation 22350 Collision Type REAR END Severity INJURY # Killed 0 # Injured 1 Tow Away? Y Process Date 20140627
 Weather1 CLEAR Weather2 Rdw Surface DRY Rdw Cond1 NO UNUSL CND Rdw Cond2 Spec Cond 0
 Hit and Run Motor Veh Involved With OTHER MV Lighting DAYLIGHT Ped Action Cntrl Dev NT PRS/FCTR Loc Type Ramp/Int

PARTY INFO

VICTIM INFO

Party	Type	Age	Sex	Race	Sobriety1	Sobriety2	Move	Pre Coll	Dir	SW	Veh	CHP	Veh	Make	Year	Sp	Info	OAF1	Viol	OAF2	Safety Equip	Role	Ext of Inj	Age	Sex	Seat Pos	Safety Equip	Ejected	
1F	DRVR	47	M	W	HNBD	HNBD	PROC ST	E	A	0700	CHEVR	2002	-	3	N	-	-	M	G										
2	DRVR	40	M	W	HNBD	HNBD	STOPPED	E	A	0700	JEEP	2000	-	3	N	-	-	M	G			DRVR	COMP PN	40	M	1	M	G	0

Primary Rd BASS LAKE RD Distance (ft) 170 Direction S Secondary Rd GATEWAY DR NCIC 9245 State Hwy? N Route Postmile Prefix Postmile Side of Hwy
 City UNINCORP. County EL DORADO Population 9 Rpt Dist Beat 001 Type 3 CalTrans Dist Badge 13929 Collision Date 20140818 Time 0950 Day MON
 Primary Collision Factor NOT DRIVER Violation Collision Type OVERTURNED Severity INJURY # Killed 0 # Injured 1 Tow Away? Y Process Date 20140904
 Weather1 CLEAR Weather2 Rdw Surface DRY Rdw Cond1 NO UNUSL CND Rdw Cond2 Spec Cond 0
 Hit and Run Motor Veh Involved With NON-CLSN Lighting DAYLIGHT Ped Action Cntrl Dev NT PRS/FCTR Loc Type Ramp/Int

PARTY INFO

VICTIM INFO

Party	Type	Age	Sex	Race	Sobriety1	Sobriety2	Move	Pre Coll	Dir	SW	Veh	CHP	Veh	Make	Year	Sp	Info	OAF1	Viol	OAF2	Safety Equip	Role	Ext of Inj	Age	Sex	Seat Pos	Safety Equip	Ejected	
1	DRVR	23	M	W	HNBD	HNBD	RAN OFF	RD	N	C	0200	HONDA	1987	-	3	N	-	P	W			DRVR	OTH VIS	23	M	1	P	W	1

Primary Rd FOXMORE LN Distance (ft) 221 Direction W Secondary Rd BASS LAKE RD NCIC 9245 State Hwy? N Route Postmile Prefix Postmile Side of Hwy
 City UNINCORP. County EL DORADO Population 9 Rpt Dist Beat 001 Type 3 CalTrans Dist Badge 016465 Collision Date 20141001 Time 0840 Day WED
 Primary Collision Factor UNKNOWN Violation Collision Type BROADSIDE Severity PDO # Killed 0 # Injured 0 Tow Away? N Process Date 20150618
 Weather1 CLEAR Weather2 Rdw Surface DRY Rdw Cond1 NO UNUSL CND Rdw Cond2 Spec Cond 0
 Hit and Run Motor Veh Involved With OTHER MV Lighting DAYLIGHT Ped Action Cntrl Dev NT PRS/FCTR Loc Type Ramp/Int

PARTY INFO

VICTIM INFO

Party	Type	Age	Sex	Race	Sobriety1	Sobriety2	Move	Pre Coll	Dir	SW	Veh	CHP	Veh	Make	Year	Sp	Info	OAF1	Viol	OAF2	Safety Equip	Role	Ext of Inj	Age	Sex	Seat Pos	Safety Equip	Ejected	
1	DRVR	40	F	W	HNBD	HNBD	PARKING	W	A	0700	TOYOT	2011	-	3	N	-	-	M	G			PASS		6	F	4	P	Q	0
2	DRVR	32	M	W	HNBD	HNBD	STOPPED	W	A	0700	GMC	2013	-	3	N	-	-	M	G										

Primary Rd BASS LAKE RD Distance (ft) 528 Direction N Secondary Rd GATEWAY DR NCIC 9245 State Hwy? N Route Postmile Prefix Postmile Side of Hwy
 City UNINCORP. County EL DORADO Population 9 Rpt Dist Beat 001 Type 3 CalTrans Dist Badge 15609 Collision Date 20141008 Time 0810 Day WED
 Primary Collision Factor IMPROP TURN Violation 22107 Collision Type HIT OBJECT Severity PDO # Killed 0 # Injured 0 Tow Away? Y Process Date 20150612
 Weather1 CLEAR Weather2 Rdw Surface DRY Rdw Cond1 NO UNUSL CND Rdw Cond2 Spec Cond 0
 Hit and Run Motor Veh Involved With FIXED OBJ Lighting DAYLIGHT Ped Action Cntrl Dev NT PRS/FCTR Loc Type Ramp/Int

PARTY INFO

VICTIM INFO

Party	Type	Age	Sex	Race	Sobriety1	Sobriety2	Move	Pre Coll	Dir	SW	Veh	CHP	Veh	Make	Year	Sp	Info	OAF1	Viol	OAF2	Safety Equip	Role	Ext of Inj	Age	Sex	Seat Pos	Safety Equip	Ejected
1F	DRVR	40	F	W	HNBD	HNBD	UNS TURN	N	A	0100	HONDA	2005	-	3	N	-	-	L	G									

Primary Rd BASS LAKE RD Distance (ft) 300 Direction S Secondary Rd LAMBETH DR NCIC 9245 State Hwy? N Route Postmile Prefix Postmile Side of Hwy
 City UNINCORP. County EL DORADO Population 9 Rpt Dist Beat 001 Type 3 CalTrans Dist Badge 016363 Collision Date 20141114 Time 1210 Day FRI
 Primary Collision Factor IMPROP TURN Violation 22107 Collision Type HIT OBJECT Severity PDO # Killed 0 # Injured 0 Tow Away? Y Process Date 20150626
 Weather1 CLEAR Weather2 Rdw Surface DRY Rdw Cond1 NO UNUSL CND Rdw Cond2 Spec Cond 0
 Hit and Run Motor Veh Involved With FIXED OBJ Lighting DAYLIGHT Ped Action Cntrl Dev NT PRS/FCTR Loc Type Ramp/Int

PARTY INFO

VICTIM INFO

Party	Type	Age	Sex	Race	Sobriety1	Sobriety2	Move	Pre Coll	Dir	SW	Veh	CHP	Veh	Make	Year	Sp	Info	OAF1	Viol	OAF2	Safety Equip	Role	Ext of Inj	Age	Sex	Seat Pos	Safety Equip	Ejected
1F	DRVR	16	F	B	HNBD	HNBD	RAN OFF	RD	N	A	0100	FORD	2004	-	3	N	-	M	G									

Report run on: 8/5/2019
Total Count: 113

#190942 2009 - AV 2018/2019 COLLISIONS ON BASS LAKE RD BTWN SERRANO PKWY & GREEN VALLEY RD, EL DORADO COUNTY

Case Listing
Page 10

Primary Rd BASS LAKE RD Distance (ft) 40 Direction N Secondary Rd BRIDLEWOOD DR NCIC 9245 State Hwy? N Route Postmile Prefix Postmile Side of Hwy
City UNINCORP. County EL DORADO Population 9 Rpt Dist Beat 001 Type 3 CalTrans Dist Badge 17728 Collision Date 20141124 Time 1655 Day MON
Primary Collision Factor UNSAFE SPEED Violation 22350 Collision Type REAR END Severity PDO # Killed 0 # Injured 0 Tow Away? Y Process Date 20150623
Weather1 CLEAR Weather2 Rdw Surface DRY Rdw Cond1 NO UNUSL CND Rdw Cond2 Spec Cond 0
Hit and Run Motor Veh Involved With OTHER MV Lighting DARK - ST LTS Ped Action Cntrl Dev NT PRS/FCTR Loc Type Ramp/Int

PARTY INFO														VICTIM INFO										
Party	Type	Age	Sex	Race	Sobriety1	Sobriety2	Move	Pre Coll	Dir	SW Veh	CHP Veh	Make	Year	Sp Info	OAF1 Viol	OAF2 Safety Equip	Role	Ext of Inj	Age	Sex	Seat Pos	Safety Equip	Ejected	
1	DRVR	41	F	W	HNBD		STOPPED	S	D			2200	GMC	2006	- 3	N	M G	PASS		41	M	6	M Q	0
2	DRVR	65	M	W	HNBD		STOPPED	S	A			0800	HONDA	2012	- 3	N	M G	PASS		37	F	3	M G	0
																		PASS		5	F	4	P Q	0
																		PASS		7	F	5	P Q	0
																		PASS		8	M	6	P G	0
3F	DRVR	19	M	W	HNBD		PROC ST	S	A			0700	TOYOT	2014	- 3	N	L G							

Primary Rd BASS LAKE RD Distance (ft) 375 Direction S Secondary Rd LAMBETH DR NCIC 9245 State Hwy? N Route Postmile Prefix Postmile Side of Hwy
City UNINCORP. County EL DORADO Population 9 Rpt Dist Beat 001 Type 3 CalTrans Dist Badge 13603 Collision Date 20141124 Time 2210 Day MON
Primary Collision Factor IMPROP TURN Violation 22107 Collision Type HIT OBJECT Severity INJURY # Killed 0 # Injured 1 Tow Away? Y Process Date 20150115
Weather1 CLEAR Weather2 Rdw Surface DRY Rdw Cond1 NO UNUSL CND Rdw Cond2 Spec Cond 0
Hit and Run Motor Veh Involved With FIXED OBJ Lighting DARK - NO ST LTS Ped Action Cntrl Dev FNCTNG Loc Type Ramp/Int

PARTY INFO														VICTIM INFO										
Party	Type	Age	Sex	Race	Sobriety1	Sobriety2	Move	Pre Coll	Dir	SW Veh	CHP Veh	Make	Year	Sp Info	OAF1 Viol	OAF2 Safety Equip	Role	Ext of Inj	Age	Sex	Seat Pos	Safety Equip	Ejected	
1F	DRVR	17	M	W	HNBD		RAN OFF RD	N	A			0700	TOYOT	1998	- 3	A	L G	DRVR	OTH VIS	17	M	1	L G	0
Primary Rd	BASS LAKE RD	Distance (ft)	450	Direction	N	Secondary Rd	MADERA WY	NCIC	9245	State Hwy?	N	Route	Postmile Prefix	Postmile	Side of Hwy									
City	UNINCORP.	County	EL DORADO	Population	9	Rpt Dist	Beat 001	Type	3	CalTrans Dist	Badge	15563	Collision Date	20150301	Time	1835	Day	SUN						
Primary Collision Factor	DRVR ALCDRG	Violation	23152A	Collision Type	HIT OBJECT	Severity	PDO	# Killed	0	# Injured	0	Tow Away?	Y	Process Date	20150903									
Weather1	CLEAR	Weather2		Rdw Surface	DRY	Rdw Cond1	NO UNUSL CND	Rdw Cond2		Spec Cond	0													
Hit and Run		Motor Veh Involved With	FIXED OBJ	Lighting	DUSK/DAWN	Ped Action		Cntrl Dev	FNCTNG	Loc Type	Ramp/Int													

PARTY INFO														VICTIM INFO										
Party	Type	Age	Sex	Race	Sobriety1	Sobriety2	Move	Pre Coll	Dir	SW Veh	CHP Veh	Make	Year	Sp Info	OAF1 Viol	OAF2 Safety Equip	Role	Ext of Inj	Age	Sex	Seat Pos	Safety Equip	Ejected	
1F	DRVR	26	F	W	HBD-JU		RAN OFF RD	S	A			0100	NISSA	2012	- 3	A	M G							
Primary Rd	GREEN VALLEY RD	Distance (ft)	500	Direction	W	Secondary Rd	BASS LAKE RD	NCIC	9245	State Hwy?	N	Route	Postmile Prefix	Postmile	Side of Hwy									
City	UNINCORP.	County	EL DORADO	Population	9	Rpt Dist	Beat 001	Type	3	CalTrans Dist	Badge	16363	Collision Date	20150319	Time	0735	Day	THU						
Primary Collision Factor	UNSAFE SPEED	Violation	22350	Collision Type	REAR END	Severity	PDO	# Killed	0	# Injured	0	Tow Away?	Y	Process Date	20150831									
Weather1	CLEAR	Weather2		Rdw Surface	DRY	Rdw Cond1	NO UNUSL CND	Rdw Cond2		Spec Cond	0													
Hit and Run		Motor Veh Involved With	OTHER MV	Lighting	DAYLIGHT	Ped Action		Cntrl Dev	NT PRS/FCTR	Loc Type	Ramp/Int													

PARTY INFO														VICTIM INFO										
Party	Type	Age	Sex	Race	Sobriety1	Sobriety2	Move	Pre Coll	Dir	SW Veh	CHP Veh	Make	Year	Sp Info	OAF1 Viol	OAF2 Safety Equip	Role	Ext of Inj	Age	Sex	Seat Pos	Safety Equip	Ejected	
1F	DRVR	51	M	W	HNBD		PROC ST	E	A			0100	HONDA	2008	- 3	E	N M G			4	F	5	P G	0
2	DRVR	41	M	W	HNBD		STOPPED	E	A			0800	TOYOT	2013	- 3	N	- - -			1	F	4	P G	0

Primary Rd BASS LAKE RD Distance (ft) 251 Direction N Secondary Rd MADERA WY NCIC 9245 State Hwy? N Route Postmile Prefix Postmile Side of Hwy
City UNINCORP. County EL DORADO Population 9 Rpt Dist Beat 001 Type 3 CalTrans Dist Badge 015607 Collision Date 20150425 Time 1836 Day SAT
Primary Collision Factor IMPROP TURN Violation 22107 Collision Type HIT OBJECT Severity PDO # Killed 0 # Injured 0 Tow Away? Y Process Date 20150930
Weather1 CLEAR Weather2 Rdw Surface DRY Rdw Cond1 NO UNUSL CND Rdw Cond2 Spec Cond 0
Hit and Run Motor Veh Involved With FIXED OBJ Lighting DAYLIGHT Ped Action Cntrl Dev NT PRS/FCTR Loc Type Ramp/Int

PARTY INFO														VICTIM INFO										
Party	Type	Age	Sex	Race	Sobriety1	Sobriety2	Move	Pre Coll	Dir	SW Veh	CHP Veh	Make	Year	Sp Info	OAF1 Viol	OAF2 Safety Equip	Role	Ext of Inj	Age	Sex	Seat Pos	Safety Equip	Ejected	
1F	DRVR	48	M	W	HNBD		RAN OFF RD	S	A			0100	FERRA	1999	- 3	N	M G	PASS		45	M	3	M G	0
Primary Rd	BASS LAKE RD	Distance (ft)	I	Direction	N	Secondary Rd	BRIDLEWOOD DR	NCIC	9245	State Hwy?	N	Route	Postmile Prefix	Postmile	Side of Hwy									
City	UNINCORP.	County	EL DORADO	Population	9	Rpt Dist	Beat 001	Type	3	CalTrans Dist	Badge	017737	Collision Date	20150430	Time	1715	Day	THU						
Primary Collision Factor	R-O-W AUTO	Violation	21801A	Collision Type	OTHER	Severity	PDO	# Killed	0	# Injured	0	Tow Away?	N	Process Date	20151006									
Weather1	CLEAR	Weather2		Rdw Surface	DRY	Rdw Cond1	NO UNUSL CND	Rdw Cond2		Spec Cond	0													
Hit and Run		Motor Veh Involved With	FIXED OBJ	Lighting	DAYLIGHT	Ped Action		Cntrl Dev	NT PRS/FCTR	Loc Type	Ramp/Int													

PARTY INFO														VICTIM INFO										
Party	Type	Age	Sex	Race	Sobriety1	Sobriety2	Move	Pre Coll	Dir	SW Veh	CHP Veh	Make	Year	Sp Info	OAF1 Viol	OAF2 Safety Equip	Role	Ext of Inj	Age	Sex	Seat Pos	Safety Equip	Ejected	
1F	DRVR	35	M	W	IMP UNK	IMP UNK	LFT TURN	N	A			0100	CHRY	2003	- 3	N	M G							
2	DRVR	23	F	W	HNBD		PROC ST	S	A			0100	HONDA	2003	- 3	N	M G							

Report run on: 8/5/2019
 Total Count: 113

#190942 2009 - AV 2018/2019 COLLISIONS ON BASS LAKE RD BTWN SERRANO PKWY & GREEN VALLEY RD, EL DORADO COUNTY

Case Listing
 Page 11

Primary Rd BASS LAKE RD Distance (ft) 10 Direction S Secondary Rd LAMBETH DR NCIC 9245 State Hwy? N Route Postmile Prefix Postmile Side of Hwy City UNINCORP. County EL DORADO Population 9 Rpt Dist Beat 001 Type 3 CalTrans Dist Badge 015609 Collision Date 20150509 Time 0745 Day SAT Primary Collision Factor UNSAFE SPEED Violation 22350 Collision Type HIT OBJECT Severity PDO # Killed 0 # Injured 0 Tow Away? Y Process Date 20151026 Weather1 CLEAR Weather2 Rdwy Surface DRY Rdwy Cond1 NO UNUSL CND Rdwy Cond2 Spec Cond 0 Hit and Run Motor Veh Involved With FIXED OBJ Lighting DAYLIGHT Ped Action Cntrl Dev NT PRS/FCTR Loc Type Ramp/Int														
PARTY INFO														
Party Type Age Sex Race Sobriety1 Sobriety2 Move Pre Coll Dir SW Veh CHP Veh Make Year Sp Info OAF1 Viol OAF2 Safety Equip Role Ext of Inj Age Sex Seat Pos Safety Equip Ejected 1F DRVR 21 M W HNBD PROC ST S A 0100 SUBAR 2005 - 3 N - M G PASS 20 M 3 M G 0														
Primary Rd GREEN VALLEY RD Distance (ft) 40 Direction W Secondary Rd BASS LAKE RD NCIC 9245 State Hwy? N Route Postmile Prefix Postmile Side of Hwy City UNINCORP. County EL DORADO Population 9 Rpt Dist Beat 011 Type 2 CalTrans Dist Badge 17089 Collision Date 20150626 Time 1752 Day FRI Primary Collision Factor UNSAFE SPEED Violation 22350 Collision Type REAR END Severity PDO # Killed 0 # Injured 0 Tow Away? N Process Date 20151103 Weather1 CLEAR Weather2 Rdwy Surface DRY Rdwy Cond1 NO UNUSL CND Rdwy Cond2 Spec Cond 0 Hit and Run Motor Veh Involved With OTHER MV Lighting DAYLIGHT Ped Action Cntrl Dev FNCTNG Loc Type Ramp/Int														
PARTY INFO														
Party Type Age Sex Race Sobriety1 Sobriety2 Move Pre Coll Dir SW Veh CHP Veh Make Year Sp Info OAF1 Viol OAF2 Safety Equip Role Ext of Inj Age Sex Seat Pos Safety Equip Ejected 1F DRVR 48 F H HNBD PROC ST E A 0100 TOYOT 2007 - 3 N - M G PASS 9 F 4 P Q 0 PASS 7 M 6 P Q 0 2 DRVR 34 M W HNBD SLOWING E A 0100 TOYOT 2009 - 3 N - M G PASS 63 M 3 M G 0 PASS 998 M 5 P Q 0 PASS 34 F 6 P G 0														
Primary Rd BASS LAKE RD Distance (ft) 425 Direction N Secondary Rd MADERA WAY NCIC 9245 State Hwy? N Route Postmile Prefix Postmile Side of Hwy City UNINCORP. County EL DORADO Population 9 Rpt Dist Beat 001 Type 3 CalTrans Dist Badge 016465 Collision Date 20150730 Time 0745 Day THU Primary Collision Factor WRONG SIDE Violation 21460A Collision Type SIDESWIPE Severity INJURY # Killed 0 # Injured 2 Tow Away? Y Process Date 20151019 Weather1 CLEAR Weather2 Rdwy Surface DRY Rdwy Cond1 NO UNUSL CND Rdwy Cond2 Spec Cond 0 Hit and Run Motor Veh Involved With OTHER MV Lighting DAYLIGHT Ped Action Cntrl Dev NT PRS/FCTR Loc Type Ramp/Int														
PARTY INFO														
Party Type Age Sex Race Sobriety1 Sobriety2 Move Pre Coll Dir SW Veh CHP Veh Make Year Sp Info OAF1 Viol OAF2 Safety Equip Role Ext of Inj Age Sex Seat Pos Safety Equip Ejected 1F DRVR 44 M W HNBD OPPOS LN S A 0700 TOYT 2001 - 3 N - M G DRVR COMP PN 44 M 1 M G 0 2 DRVR 47 M A HNBD PROC ST N A 0100 HOND 1990 - 3 N - P G DRVR COMP PN 47 M 1 P G 0														
Primary Rd BASS LAKE RD Distance (ft) 100 Direction S Secondary Rd PARKDALE LN NCIC 9245 State Hwy? N Route Postmile Prefix Postmile Side of Hwy City UNINCORP. County EL DORADO Population 9 Rpt Dist Beat 001 Type 3 CalTrans Dist Badge 018656 Collision Date 20150805 Time 2140 Day WED Primary Collision Factor IMPROP TURN Violation 22107 Collision Type HIT OBJECT Severity PDO # Killed 0 # Injured 0 Tow Away? N Process Date 20151019 Weather1 CLEAR Weather2 Rdwy Surface DRY Rdwy Cond1 NO UNUSL CND Rdwy Cond2 Spec Cond 0 Hit and Run Motor Veh Involved With FIXED OBJ Lighting DARK - NO ST LTS Ped Action Cntrl Dev NT PRS/FCTR Loc Type Ramp/Int														
PARTY INFO														
Party Type Age Sex Race Sobriety1 Sobriety2 Move Pre Coll Dir SW Veh CHP Veh Make Year Sp Info OAF1 Viol OAF2 Safety Equip Role Ext of Inj Age Sex Seat Pos Safety Equip Ejected 1F DRVR 19 F W HNBD UNS TURN S A 0700 MERC 2001 - 3 N - M G PASS 20 F 3 M G 0														
Primary Rd GREEN VALLEY RD Distance (ft) 1 Direction Secondary Rd BASS LAKE RD NCIC 9245 State Hwy? N Route Postmile Prefix Postmile Side of Hwy City UNINCORP. County EL DORADO Population 9 Rpt Dist Beat 011 Type 2 CalTrans Dist Badge 012833 Collision Date 20150831 Time 0543 Day MON Primary Collision Factor R-O-W AUTO Violation 21453C Collision Type BROADSIDE Severity INJURY # Killed 0 # Injured 2 Tow Away? Y Process Date 20151019 Weather1 CLEAR Weather2 Rdwy Surface DRY Rdwy Cond1 NO UNUSL CND Rdwy Cond2 Spec Cond 0 Hit and Run Motor Veh Involved With OTHER MV Lighting DARK - ST LTS Ped Action Cntrl Dev FNCTNG Loc Type Ramp/Int														
PARTY INFO														
Party Type Age Sex Race Sobriety1 Sobriety2 Move Pre Coll Dir SW Veh CHP Veh Make Year Sp Info OAF1 Viol OAF2 Safety Equip Role Ext of Inj Age Sex Seat Pos Safety Equip Ejected 1F DRVR 25 M H HNBD LFT TURN N A 0100 CHRY 2006 - 3 N - L G DRVR COMP PN 25 M 1 L G 0 2 DRVR 38 M W HNBD PROC ST E A 0100 HONDA 2000 - 3 N - L G DRVR COMP PN 38 M 1 L G 0														
Primary Rd BASS LAKE ROAD Distance (ft) 375 Direction N Secondary Rd MADERA WAY NCIC 9245 State Hwy? N Route Postmile Prefix Postmile Side of Hwy City UNINCORP. County EL DORADO Population 9 Rpt Dist Beat 001 Type 3 CalTrans Dist Badge 013342 Collision Date 20150906 Time 1135 Day SUN Primary Collision Factor UNSAFE SPEED Violation 22350 Collision Type OVERTURNED Severity INJURY # Killed 0 # Injured 1 Tow Away? Y Process Date 20151019 Weather1 CLEAR Weather2 Rdwy Surface DRY Rdwy Cond1 NO UNUSL CND Rdwy Cond2 Spec Cond 0 Hit and Run Motor Veh Involved With NON-CLSN Lighting DAYLIGHT Ped Action Cntrl Dev NT PRS/FCTR Loc Type Ramp/Int														
PARTY INFO														
Party Type Age Sex Race Sobriety1 Sobriety2 Move Pre Coll Dir SW Veh CHP Veh Make Year Sp Info OAF1 Viol OAF2 Safety Equip Role Ext of Inj Age Sex Seat Pos Safety Equip Ejected 1F DRVR 74 M W HNBD RAN OFF RD S C 0200 DUCAT 2008 - 3 N - - W DRVR COMP PN 74 M 1 P W 0														

Report run on: 8/5/2019
Total Count: 113

#190942 2009 - AV 2018/2019 COLLISIONS ON BASS LAKE RD BTWN SERRANO PKWY & GREEN VALLEY RD, EL DORADO COUNTY

Case Listing
Page 12

Primary Rd BASS LAKE RD Distance (ft) 1056 Direction S Secondary Rd MAGNOLIA HILLS D NCIC 9245 State Hwy? N Route Postmile Prefix Postmile Side of Hwy
City UNINCORP. County EL DORADO Population 9 Rpt Dist Beat 001 Type 3 CalTrans Dist Badge 016451 Collision Date 20151219 Time 0200 Day SAT
Primary Collision Factor WRONG SIDE Violation 21650 Collision Type HIT OBJECT Severity PDO # Killed 0 # Injured 0 Tow Away? N Process Date 20160204
Weather1 RAINING Weather2 RAINING Rdwly Surface WET Rdwly Cond1 NO UNUSL CND Rdwly Cond2 Spec Cond 0
Hit and Run MSDMNR Motor Veh Involved With FIXED OBJ Lighting DARK - NO ST LTS Ped Action Cntrl Dev NT PRS/FCTR Loc Type Ramp/Int

PARTY INFO

VICTIM INFO

Party Type Age Sex Race Sobriety1 Sobriety2 Move Pre Coll Dir SW Veh CHP Veh Make Year Sp Info OAF1 Viol OAF2 Safety Equip Role Ext of Inj Age Sex Seat Pos Safety Equip Ejected
1F DRVR 21 M W IMP UNK IMP UNK RAN OFF RD N A 0100 ACURA 1997 - 3 N - M G
Primary Rd BASS LAKE ROAD Distance (ft) 825 Direction N Secondary Rd MAGNOLIA HILLS D NCIC 9245 State Hwy? N Route Postmile Prefix Postmile Side of Hwy
City UNINCORP. County EL DORADO Population 9 Rpt Dist Beat 001 Type 3 CalTrans Dist Badge 012833 Collision Date 20151221 Time 0350 Day MON
Primary Collision Factor UNSAFE SPEED Violation 22350 Collision Type HIT OBJECT Severity PDO # Killed 0 # Injured 0 Tow Away? Y Process Date 20160107
Weather1 CLOUDY Weather2 RAINING Rdwly Surface WET Rdwly Cond1 NO UNUSL CND Rdwly Cond2 Spec Cond 0
Hit and Run Motor Veh Involved With FIXED OBJ Lighting DARK - NO ST LTS Ped Action Cntrl Dev NT PRS/FCTR Loc Type Ramp/Int

PARTY INFO

VICTIM INFO

Party Type Age Sex Race Sobriety1 Sobriety2 Move Pre Coll Dir SW Veh CHP Veh Make Year Sp Info OAF1 Viol OAF2 Safety Equip Role Ext of Inj Age Sex Seat Pos Safety Equip Ejected
1F DRVR 20 M W HNBD RAN OFF RD S D 2200 CHEV 2003 - 3 N - M G
Primary Rd BASS LAKE ROAD Distance (ft) 42 Direction S Secondary Rd SANDHURST HILL R NCIC 9245 State Hwy? N Route Postmile Prefix Postmile Side of Hwy
City UNINCORP. County EL DORADO Population 9 Rpt Dist Beat 001 Type 3 CalTrans Dist Badge 015421 Collision Date 20160201 Time 1950 Day MON
Primary Collision Factor IMPROP TURN Violation 22107 Collision Type HIT OBJECT Severity PDO # Killed 0 # Injured 0 Tow Away? N Process Date 20160208
Weather1 CLEAR Weather2 RAINING Rdwly Surface DRY Rdwly Cond1 NO UNUSL CND Rdwly Cond2 Spec Cond 0
Hit and Run Motor Veh Involved With FIXED OBJ Lighting DARK - NO ST LTS Ped Action Cntrl Dev NT PRS/FCTR Loc Type Ramp/Int

PARTY INFO

VICTIM INFO

Party Type Age Sex Race Sobriety1 Sobriety2 Move Pre Coll Dir SW Veh CHP Veh Make Year Sp Info OAF1 Viol OAF2 Safety Equip Role Ext of Inj Age Sex Seat Pos Safety Equip Ejected
1F DRVR 20 M O HNBD SLOWING N C 0200 KAWA 2014 - 3 N - - W
Primary Rd BASS LAKE RD Distance (ft) 322 Direction N Secondary Rd MADERA WAY NCIC 9245 State Hwy? N Route Postmile Prefix Postmile Side of Hwy
City UNINCORP. County EL DORADO Population 9 Rpt Dist Beat 001 Type 3 CalTrans Dist Badge 016465 Collision Date 20160305 Time 1350 Day SAT
Primary Collision Factor UNSAFE SPEED Violation 22350 Collision Type HIT OBJECT Severity PDO # Killed 0 # Injured 0 Tow Away? Y Process Date 20160310
Weather1 CLOUDY Weather2 RAINING Rdwly Surface WET Rdwly Cond1 NO UNUSL CND Rdwly Cond2 Spec Cond 0
Hit and Run Motor Veh Involved With FIXED OBJ Lighting DAYLIGHT Ped Action Cntrl Dev NT PRS/FCTR Loc Type Ramp/Int

PARTY INFO

VICTIM INFO

Party Type Age Sex Race Sobriety1 Sobriety2 Move Pre Coll Dir SW Veh CHP Veh Make Year Sp Info OAF1 Viol OAF2 Safety Equip Role Ext of Inj Age Sex Seat Pos Safety Equip Ejected
1F DRVR 18 F W HNBD UNS TURN S A 0700 FORD 2003 - 3 N - M G PASS 18 M 3 M G 0
Primary Rd BASS LAKE RD Distance (ft) 250 Direction S Secondary Rd PARKDALE LN NCIC 9245 State Hwy? N Route Postmile Prefix Postmile Side of Hwy
City UNINCORP. County EL DORADO Population 9 Rpt Dist Beat 001 Type 3 CalTrans Dist Badge 017364 Collision Date 20160310 Time 1456 Day THU
Primary Collision Factor DRVR ALCDRUG Violation 23152F Collision Type HIT OBJECT Severity PDO # Killed 0 # Injured 0 Tow Away? Y Process Date 20160317
Weather1 CLOUDY Weather2 RAINING Rdwly Surface WET Rdwly Cond1 NO UNUSL CND Rdwly Cond2 Spec Cond 0
Hit and Run Motor Veh Involved With FIXED OBJ Lighting DAYLIGHT Ped Action Cntrl Dev NT PRS/FCTR Loc Type Ramp/Int

PARTY INFO

VICTIM INFO

Party Type Age Sex Race Sobriety1 Sobriety2 Move Pre Coll Dir SW Veh CHP Veh Make Year Sp Info OAF1 Viol OAF2 Safety Equip Role Ext of Inj Age Sex Seat Pos Safety Equip Ejected
1F DRVR 59 F W HBD-UI DRUG RAN OFF RD N D 2200 CHEV 2004 - 3 A 22107 N M G
Primary Rd BASS LAKE RD Distance (ft) 140 Direction S Secondary Rd MADERA WAY NCIC 9245 State Hwy? N Route Postmile Prefix Postmile Side of Hwy
City UNINCORP. County EL DORADO Population 9 Rpt Dist Beat 001 Type 3 CalTrans Dist Badge 018656 Collision Date 20160429 Time 0120 Day FRI
Primary Collision Factor UNSAFE SPEED Violation 22350 Collision Type OVERTURNED Severity INJURY # Killed 0 # Injured 1 Tow Away? Y Process Date 20160506
Weather1 CLEAR Weather2 RAINING Rdwly Surface DRY Rdwly Cond1 NO UNUSL CND Rdwly Cond2 Spec Cond 0
Hit and Run Motor Veh Involved With NON-CLSN Lighting DARK - NO ST LTS Ped Action Cntrl Dev NT PRS/FCTR Loc Type Ramp/Int

PARTY INFO

VICTIM INFO

Party Type Age Sex Race Sobriety1 Sobriety2 Move Pre Coll Dir SW Veh CHP Veh Make Year Sp Info OAF1 Viol OAF2 Safety Equip Role Ext of Inj Age Sex Seat Pos Safety Equip Ejected
1F DRVR 17 F W HNBD PROC ST N A 0100 TOYT 2008 - 3 N - L G DRVR OTH VIS 17 F 1 L G 0
Primary Rd BASS LAKE ROAD Distance (ft) 33 Direction S Secondary Rd GREEN VALLEY RD NCIC 9245 State Hwy? N Route Postmile Prefix Postmile Side of Hwy
City UNINCORP. County EL DORADO Population 9 Rpt Dist Beat 001 Type 3 CalTrans Dist Badge 017089 Collision Date 20160505 Time 1855 Day THU
Primary Collision Factor IMPROP TURN Violation 22107 Collision Type HIT OBJECT Severity PDO # Killed 0 # Injured 0 Tow Away? Y Process Date 20160511
Weather1 CLOUDY Weather2 RAINING Rdwly Surface WET Rdwly Cond1 NO UNUSL CND Rdwly Cond2 Spec Cond 0
Hit and Run Motor Veh Involved With FIXED OBJ Lighting DAYLIGHT Ped Action Cntrl Dev FNCTNG Loc Type Ramp/Int

PARTY INFO

VICTIM INFO

Party Type Age Sex Race Sobriety1 Sobriety2 Move Pre Coll Dir SW Veh CHP Veh Make Year Sp Info OAF1 Viol OAF2 Safety Equip Role Ext of Inj Age Sex Seat Pos Safety Equip Ejected
1F DRVR 51 M W HNBD UNS TURN S A 0100 BMW 2007 - 3 N - L G

Report run on: 8/5/2019
Total Count: 113

#190942 2009 - AV 2018/2019 COLLISIONS ON BASS LAKE RD BTWN SERRANO PKWY & GREEN VALLEY RD, EL DORADO COUNTY

Case Listing
Page 13

Primary Rd BASS LAKE ROAD Distance (ft) 75 Direction S Secondary Rd SANDHURST HILL R NCIC 9245 State Hwy? N Route Postmile Prefix Postmile Side of Hwy
City UNINCORP. County EL DORADO Population 9 Rpt Dist Beat 001 Type 3 CalTrans Dist Badge 017089 Collision Date 20160506 Time 1540 Day FRI
Primary Collision Factor UNSAFE SPEED Violation 22350 Collision Type OVERTURNED Severity INJURY # Killed 0 # Injured 1 Tow Away? Y Process Date 20160518
Weather1 CLOUDY Weather2 Rdry Surface DRY Rdry Cond1 NO UNUSL CND Rdry Cond2 Spec Cond 0
Hit and Run Motor Veh Involved With NON-CLSN Lighting DAYLIGHT Ped Action Cntrl Dev NT PRS/FCTR Loc Type Ramp/Int

PARTY INFO

VICTIM INFO

Party Type	Age	Sex	Race	Sobriety1	Sobriety2	Move Pre Coll Dir	SW Veh	CHP Veh	Veh Make	Year	Sp Info	OAF1 Viol	OAF2 Safety Equip	Role	Ext of Inj	Age	Sex	Seat Pos	Safety Equip	Ejected					
1F	DRVR	22	F	W	HNBD	PROC ST	S	A	0700	GMC	1999	-	3	N	-	M	G	DRVR	COMP PN	22	F	1	M	G	0

Primary Rd BASS LAKE RD Distance (ft) 741 Direction N Secondary Rd GATEWAY DR NCIC 9245 State Hwy? N Route Postmile Prefix Postmile Side of Hwy
City UNINCORP. County EL DORADO Population 9 Rpt Dist Beat 001 Type 3 CalTrans Dist Badge 016495 Collision Date 20160614 Time 1755 Day TUE
Primary Collision Factor DRVR ALC/DRG Violation 23152A Collision Type OVERTURNED Severity INJURY # Killed 0 # Injured 1 Tow Away? Y Process Date 20160623
Weather1 CLOUDY Weather2 Rdry Surface DRY Rdry Cond1 NO UNUSL CND Rdry Cond2 Spec Cond 0
Hit and Run Motor Veh Involved With NON-CLSN Lighting DAYLIGHT Ped Action Cntrl Dev NT PRS/FCTR Loc Type Ramp/Int

PARTY INFO

VICTIM INFO

Party Type	Age	Sex	Race	Sobriety1	Sobriety2	Move Pre Coll Dir	SW Veh	CHP Veh	Veh Make	Year	Sp Info	OAF1 Viol	OAF2 Safety Equip	Role	Ext of Inj	Age	Sex	Seat Pos	Safety Equip	Ejected						
1F	DRVR	55	M	A	HBD-UI	RAN OFF RD	N	A	0700	TOYO	1999	-	3	A	22107	-	M	G	DRVR	OTH VIS	55	M	1	M	G	0

Primary Rd BASS LAKE RD Distance (ft) 600 Direction N Secondary Rd BRIDLEWOOD DR NCIC 9245 State Hwy? N Route Postmile Prefix Postmile Side of Hwy
City UNINCORP. County EL DORADO Population 9 Rpt Dist Beat 001 Type 3 CalTrans Dist Badge 017737 Collision Date 20160704 Time 1750 Day MON
Primary Collision Factor IMPROP TURN Violation 22107 Collision Type HIT OBJECT Severity INJURY # Killed 0 # Injured 2 Tow Away? Y Process Date 20160705
Weather1 CLEAR Weather2 Rdry Surface DRY Rdry Cond1 NO UNUSL CND Rdry Cond2 Spec Cond 0
Hit and Run Motor Veh Involved With FIXED OBJ Lighting DAYLIGHT Ped Action Cntrl Dev NT PRS/FCTR Loc Type Ramp/Int

PARTY INFO

VICTIM INFO

Party Type	Age	Sex	Race	Sobriety1	Sobriety2	Move Pre Coll Dir	SW Veh	CHP Veh	Veh Make	Year	Sp Info	OAF1 Viol	OAF2 Safety Equip	Role	Ext of Inj	Age	Sex	Seat Pos	Safety Equip	Ejected					
1F	DRVR	28	M	A	HNBD	OTHER	S	A	0100	SUBA	2014	-	3	N	-	L	G	PASS		24	F	3	L	G	0

Primary Rd BASS LAKE ROAD Distance (ft) 92 Direction S Secondary Rd SANDHURST HILL R NCIC 9245 State Hwy? N Route Postmile Prefix Postmile Side of Hwy
City UNINCORP. County EL DORADO Population 9 Rpt Dist Beat 001 Type 3 CalTrans Dist Badge 017089 Collision Date 20160714 Time 1315 Day THU
Primary Collision Factor IMPROP TURN Violation 22107 Collision Type HEAD-ON Severity PDO # Killed 0 # Injured 0 Tow Away? Y Process Date 20160728
Weather1 CLEAR Weather2 Rdry Surface DRY Rdry Cond1 NO UNUSL CND Rdry Cond2 Spec Cond 0
Hit and Run Motor Veh Involved With OTHER MV Lighting DAYLIGHT Ped Action Cntrl Dev NT PRS/FCTR Loc Type Ramp/Int

PARTY INFO

VICTIM INFO

Party Type	Age	Sex	Race	Sobriety1	Sobriety2	Move Pre Coll Dir	SW Veh	CHP Veh	Veh Make	Year	Sp Info	OAF1 Viol	OAF2 Safety Equip	Role	Ext of Inj	Age	Sex	Seat Pos	Safety Equip	Ejected						
1F	DRVR	19	M	W	HNBD	RAN OFF RD	S	A	0100	BMW	1999	-	3	A	21460A	-	L	G	PASS		17	F	3	L	G	0

Primary Rd BASS LAKE RD Distance (ft) 45 Direction W Secondary Rd SANDHURST HILL R NCIC 9245 State Hwy? N Route Postmile Prefix Postmile Side of Hwy
City UNINCORP. County EL DORADO Population 9 Rpt Dist Beat 001 Type 3 CalTrans Dist Badge 018799 Collision Date 20160813 Time 2110 Day SAT
Primary Collision Factor IMPROP TURN Violation 22107 Collision Type HIT OBJECT Severity PDO # Killed 0 # Injured 0 Tow Away? Y Process Date 20160817
Weather1 CLEAR Weather2 Rdry Surface DRY Rdry Cond1 NO UNUSL CND Rdry Cond2 Spec Cond 0
Hit and Run Motor Veh Involved With FIXED OBJ Lighting DARK - NO ST LTS Ped Action Cntrl Dev NT PRS/FCTR Loc Type Ramp/Int

PARTY INFO

VICTIM INFO

Party Type	Age	Sex	Race	Sobriety1	Sobriety2	Move Pre Coll Dir	SW Veh	CHP Veh	Veh Make	Year	Sp Info	OAF1 Viol	OAF2 Safety Equip	Role	Ext of Inj	Age	Sex	Seat Pos	Safety Equip	Ejected							
1F	DRVR	72	M	W	HNBD	RAN OFF RD	W	D	2200	GMC	1995	-	3	N	-	M	G										

Primary Rd BASS LAKE RD Distance (ft) 101 Direction S Secondary Rd MADERA WAY NCIC 9245 State Hwy? N Route Postmile Prefix Postmile Side of Hwy
City UNINCORP. County EL DORADO Population 9 Rpt Dist Beat 001 Type 3 CalTrans Dist Badge 012833 Collision Date 20160817 Time 0019 Day WED
Primary Collision Factor UNSAFE SPEED Violation 22350 Collision Type REAR END Severity PDO # Killed 0 # Injured 0 Tow Away? N Process Date 20160818
Weather1 CLEAR Weather2 Rdry Surface DRY Rdry Cond1 NO UNUSL CND Rdry Cond2 Spec Cond 0
Hit and Run Motor Veh Involved With OTHER MV Lighting DARK - NO ST LTS Ped Action Cntrl Dev NT PRS/FCTR Loc Type Ramp/Int

PARTY INFO

VICTIM INFO

Party Type	Age	Sex	Race	Sobriety1	Sobriety2	Move Pre Coll Dir	SW Veh	CHP Veh	Veh Make	Year	Sp Info	OAF1 Viol	OAF2 Safety Equip	Role	Ext of Inj	Age	Sex	Seat Pos	Safety Equip	Ejected							
1F	DRVR	25	M	W	HNBD	PROC ST	N	A	0100	CHRS	2005	-	2	N	-	M	G										

2	DRVR	18	F	W	HNBD	STOPPED	N	A	0100	BMW	1999	-	3	N	-	M	G	PASS		18	F	3	M	G	0		
---	------	----	---	---	------	---------	---	---	------	-----	------	---	---	---	---	---	---	------	--	----	---	---	---	---	---	--	--

Primary Rd BASS LAKE RD Distance (ft) 1 Direction Secondary Rd WOODLEIGH LN NCIC 9245 State Hwy? N Route Postmile Prefix Postmile Side of Hwy
 City UNINCORP. County EL DORADO Population 9 Rpt Dist Beat 001 Type 3 CalTrans Dist Badge 017737 Collision Date 20161004 Time 1930 Day TUE
 Primary Collision Factor IMPROP TURN Violation 22107 Collision Type HIT OBJECT Severity PDO # Killed 0 # Injured 0 Tow Away? N Process Date 20161012
 Weather1 CLEAR Weather2 Rdw Surface DRY Rdw Cond1 NO UNUSL CND Rdw Cond2 Spec Cond 0
 Hit and Run Motor Veh Involved With FIXED OBJ Lighting DARK - NO ST LTS Ped Action Cntrl Dev NT PRS/FCTR Loc Type Ramp/Int

PARTY INFO

VICTIM INFO

Party Type	Age	Sex	Race	Sobriety1	Sobriety2	Move Pre Coll	Dir	SW Veh	CHP Veh	Make	Year	Sp Info	OAF1 Viol	OAF2 Safety Equip	Role	Ext of Inj	Age	Sex	Seat Pos	Safety Equip	Ejected	
1F	DRVR	17	M	W	HNBD	OTHER	S	A	0100	HONDA	2001	-	3	N	-	M	G					

Primary Rd BASS LAKE RD Distance (ft) 20 Direction N Secondary Rd HILL RD NCIC 9245 State Hwy? N Route Postmile Prefix Postmile Side of Hwy
 City UNINCORP. County EL DORADO Population 9 Rpt Dist Beat 001 Type 3 CalTrans Dist Badge 016451 Collision Date 20161217 Time 0820 Day SAT
 Primary Collision Factor UNSAFE SPEED Violation 22350 Collision Type OVERTURNED Severity PDO # Killed 0 # Injured 0 Tow Away? Y Process Date 20161227
 Weather1 CLEAR Weather2 Rdw Surface DRY Rdw Cond1 NO UNUSL CND Rdw Cond2 Spec Cond 0
 Hit and Run Motor Veh Involved With FIXED OBJ Lighting DAYLIGHT Ped Action Cntrl Dev NT PRS/FCTR Loc Type Ramp/Int

PARTY INFO

VICTIM INFO

Party Type	Age	Sex	Race	Sobriety1	Sobriety2	Move Pre Coll	Dir	SW Veh	CHP Veh	Make	Year	Sp Info	OAF1 Viol	OAF2 Safety Equip	Role	Ext of Inj	Age	Sex	Seat Pos	Safety Equip	Ejected	
1F	DRVR	18	F	W	HNBD	RAN OFF RD	S	A	0100	HOND	1997	-	3	N	-	M	G					

Primary Rd BASS LAKE RD Distance (ft) 800 Direction N Secondary Rd BRIDLEWOOD DR NCIC 9245 State Hwy? N Route Postmile Prefix Postmile Side of Hwy
 City UNINCORP. County EL DORADO Population 9 Rpt Dist Beat 001 Type 3 CalTrans Dist Badge 017737 Collision Date 20161218 Time 1850 Day SUN
 Primary Collision Factor IMPROP TURN Violation 22107 Collision Type HIT OBJECT Severity PDO # Killed 0 # Injured 0 Tow Away? Y Process Date 20161227
 Weather1 CLEAR Weather2 Rdw Surface DRY Rdw Cond1 NO UNUSL CND Rdw Cond2 Spec Cond 0
 Hit and Run Motor Veh Involved With FIXED OBJ Lighting DARK - ST LTS Ped Action Cntrl Dev NT PRS/FCTR Loc Type Ramp/Int

PARTY INFO

VICTIM INFO

Party Type	Age	Sex	Race	Sobriety1	Sobriety2	Move Pre Coll	Dir	SW Veh	CHP Veh	Make	Year	Sp Info	OAF1 Viol	OAF2 Safety Equip	Role	Ext of Inj	Age	Sex	Seat Pos	Safety Equip	Ejected	
1F	DRVR	58	F	W	HNBD	OTHER	N	D	2200	CHEV	2001	-	3	N	-	M	G					

Primary Rd BASS LAKE ROAD Distance (ft) 85 Direction N Secondary Rd MADERA WAY NCIC 9245 State Hwy? N Route Postmile Prefix Postmile Side of Hwy
 City UNINCORP. County EL DORADO Population 9 Rpt Dist Beat 001 Type 3 CalTrans Dist Badge 018756 Collision Date 20161224 Time 1635 Day SAT
 Primary Collision Factor IMPROP TURN Violation 22107 Collision Type HIT OBJECT Severity PDO # Killed 0 # Injured 0 Tow Away? Y Process Date 20161228
 Weather1 CLEAR Weather2 Rdw Surface DRY Rdw Cond1 NO UNUSL CND Rdw Cond2 Spec Cond 0
 Hit and Run MSDMNR Motor Veh Involved With FIXED OBJ Lighting DAYLIGHT Ped Action Cntrl Dev NT PRS/FCTR Loc Type Ramp/Int

PARTY INFO

VICTIM INFO

Party Type	Age	Sex	Race	Sobriety1	Sobriety2	Move Pre Coll	Dir	SW Veh	CHP Veh	Make	Year	Sp Info	OAF1 Viol	OAF2 Safety Equip	Role	Ext of Inj	Age	Sex	Seat Pos	Safety Equip	Ejected	
1F	DRVR	998		IMP UNK	IMP UNK	RAN OFF RD	S	A	0700	TOYO	2015	-	3	N	-	L	G					

Primary Rd BASS LAKE RD Distance (ft) 1056 Direction S Secondary Rd MAGNOLIA HILLS D NCIC 9245 State Hwy? N Route Postmile Prefix Postmile Side of Hwy
 City UNINCORP. County EL DORADO Population 9 Rpt Dist Beat 001 Type 3 CalTrans Dist Badge 018466 Collision Date 20170121 Time 0335 Day SAT
 Primary Collision Factor UNSAFE SPEED Violation 22350 Collision Type HIT OBJECT Severity PDO # Killed 0 # Injured 0 Tow Away? Y Process Date 20170201
 Weather1 RAINING Weather2 Rdw Surface WET Rdw Cond1 NO UNUSL CND Rdw Cond2 Spec Cond 0
 Hit and Run MSDMNR Motor Veh Involved With FIXED OBJ Lighting DARK - NO ST LTS Ped Action Cntrl Dev NT PRS/FCTR Loc Type Ramp/Int

PARTY INFO

VICTIM INFO

Party Type	Age	Sex	Race	Sobriety1	Sobriety2	Move Pre Coll	Dir	SW Veh	CHP Veh	Make	Year	Sp Info	OAF1 Viol	OAF2 Safety Equip	Role	Ext of Inj	Age	Sex	Seat Pos	Safety Equip	Ejected	
1F	DRVR	998		IMP UNK	IMP UNK	RAN OFF RD	N	A	0100	HYUN	2009	-	N	-	B	B						

Primary Rd BASS LAKE RD Distance (ft) 528 Direction N Secondary Rd MADERA WAY NCIC 9245 State Hwy? N Route Postmile Prefix Postmile Side of Hwy
 City UNINCORP. County EL DORADO Population 9 Rpt Dist Beat 001 Type 3 CalTrans Dist Badge 018756 Collision Date 20170204 Time 0922 Day SAT
 Primary Collision Factor UNSAFE SPEED Violation 22350 Collision Type OVERTURNED Severity PDO # Killed 0 # Injured 0 Tow Away? Y Process Date 20170213
 Weather1 CLOUDY Weather2 Rdw Surface WET Rdw Cond1 NO UNUSL CND Rdw Cond2 Spec Cond 0
 Hit and Run Motor Veh Involved With NON-CLSN Lighting DAYLIGHT Ped Action Cntrl Dev NT PRS/FCTR Loc Type Ramp/Int

PARTY INFO

VICTIM INFO

Party Type	Age	Sex	Race	Sobriety1	Sobriety2	Move Pre Coll	Dir	SW Veh	CHP Veh	Make	Year	Sp Info	OAF1 Viol	OAF2 Safety Equip	Role	Ext of Inj	Age	Sex	Seat Pos	Safety Equip	Ejected	
1F	DRVR	26	M	O	HNBD	RAN OFF RD	S	A	0100	TOYO	1999	-	3	N	-	M	G					

Primary Rd BASS LAKE ROAD Distance (ft) 80 Direction S Secondary Rd SANDHURST HILL R NCIC 9245 State Hwy? N Route Postmile Prefix Postmile Side of Hwy
 City UNINCORP. County EL DORADO Population 9 Rpt Dist Beat 001 Type 3 CalTrans Dist Badge 017756 Collision Date 20170502 Time 1710 Day TUE
 Primary Collision Factor WRONG SIDE Violation 21650 Collision Type OVERTURNED Severity INJURY # Killed 0 # Injured 1 Tow Away? Y Process Date 20170504
 Weather1 CLEAR Weather2 Rdw Surface DRY Rdw Cond1 NO UNUSL CND Rdw Cond2 Spec Cond 0
 Hit and Run Motor Veh Involved With NON-CLSN Lighting DAYLIGHT Ped Action Cntrl Dev FNCTNG Loc Type Ramp/Int

PARTY INFO

VICTIM INFO

Party Type	Age	Sex	Race	Sobriety1	Sobriety2	Move Pre Coll	Dir	SW Veh	CHP Veh	Make	Year	Sp Info	OAF1 Viol	OAF2 Safety Equip	Role	Ext of Inj	Age	Sex	Seat Pos	Safety Equip	Ejected	
1F	DRVR	45	M	W	HNBD	RAN OFF RD	S	C	0200	HONDA	2013	-	3	N	-	G						

Total Count: 113

Primary Rd	GREEN VALLEY RI	Distance (ft)	490	Direction	W	Secondary Rd	BASS LAKE RD	NCIC	9245	State Hwy?	N	Route		Postmile Prefix		Postmile		Side of Hwy	
City	UNINCORP.	County	EL DORADO	Population	9	Rpt Dist	Beat 011	Type	2	CalTrans Dist		Badge	017897	Collision Date	20170510	Time	0525	Day	WED
Primary Collision Factor	NOT DRIVER	Violation		Collision Type	HIT OBJECT	Severity	PDO	# Killed	0	# Injured	0	Tow Away?	N	Process Date	20170518	Spec Cond	0		
Weather1	CLEAR	Weather2		Rdwy Surface	DRY	Rdwy Cond1	NO UNUSL CND	Rdwy Cond2											
Hit and Run		Motor Veh Involved With	ANIMAL	Lighting	DUSK/DAWN	Ped Action		Cntrl Dev	NT PRS/FCTR	Loc Type		Ramp/Int							

PARTY INFO

VICTIM INFO

Party Type	Age	Sex	Race	Sobriety1	Sobriety2	Move Pre Coll	Dir	SW Veh	CHP Veh	Veh Make	Year	Sp Info	OAF1 Viol	OAF2 Safety Equip	Role	Ext of Inj	Age	Sex	Seat Pos	Safety Equip	Ejected	
1	DRVR	29	M	W	HNBD	PROC ST	W	D		2200	CHEV	2015	-	3	N	-	M	G				

Primary Rd	GREEN VALLEY RI	Distance (ft)	1056	Direction	W	Secondary Rd	BASS LAKE RD	NCIC	9245	State Hwy?	N	Route		Postmile Prefix		Postmile		Side of Hwy	
City	UNINCORP.	County	EL DORADO	Population	9	Rpt Dist	Beat 011	Type	2	CalTrans Dist		Badge	016629	Collision Date	20170511	Time	0730	Day	THU
Primary Collision Factor	OTHER IMPROV DRV	Violation		Collision Type	HIT OBJECT	Severity	INJURY	# Killed	0	# Injured	2	Tow Away?	N	Process Date	20170518	Spec Cond	0		
Weather1	CLOUDY	Weather2		Rdwy Surface	DRY	Rdwy Cond1	NO UNUSL CND	Rdwy Cond2											
Hit and Run		Motor Veh Involved With	FIXED OBJ	Lighting	DAYLIGHT	Ped Action		Cntrl Dev	NT PRS/FCTR	Loc Type		Ramp/Int							

PARTY INFO

VICTIM INFO

Party Type	Age	Sex	Race	Sobriety1	Sobriety2	Move Pre Coll	Dir	SW Veh	CHP Veh	Veh Make	Year	Sp Info	OAF1 Viol	OAF2 Safety Equip	Role	Ext of Inj	Age	Sex	Seat Pos	Safety Equip	Ejected	
1F	BICY	13	M	W	HNBD	OTHER	W	L		0400	HAVOC	-	3	N	-	-	W					
2	BICY	14	M	W	HNBD	OTHER	W	L		0400	CANNO	-	3	M	-	-	W					

Primary Rd	BRIDLEWOOD DR	Distance (ft)	415	Direction	E	Secondary Rd	BASS LAKE ROAD	NCIC	9245	State Hwy?	N	Route		Postmile Prefix		Postmile		Side of Hwy	
City	UNINCORP.	County	EL DORADO	Population	9	Rpt Dist	Beat 001	Type	3	CalTrans Dist		Badge	015563	Collision Date	20170704	Time	0110	Day	TUE
Primary Collision Factor	IMPROV TURN	Violation	22107	Collision Type	HIT OBJECT	Severity	INJURY	# Killed	0	# Injured	1	Tow Away?	Y	Process Date	20170713	Spec Cond	0		
Weather1	CLEAR	Weather2		Rdwy Surface	DRY	Rdwy Cond1	NO UNUSL CND	Rdwy Cond2											
Hit and Run		Motor Veh Involved With	PKD MV	Lighting	DARK - ST LTS	Ped Action		Cntrl Dev	NT PRS/FCTR	Loc Type		Ramp/Int							

PARTY INFO

VICTIM INFO

Party Type	Age	Sex	Race	Sobriety1	Sobriety2	Move Pre Coll	Dir	SW Veh	CHP Veh	Veh Make	Year	Sp Info	OAF1 Viol	OAF2 Safety Equip	Role	Ext of Inj	Age	Sex	Seat Pos	Safety Equip	Ejected	
1F	DRVR	21	F	W	HNBD	FATG	PROC ST	E	A	0100	HONDA	2013	-	3	N	-	L	G				
2	PRKD	998				PARKED	E	A		0100	VOLKS	2004	-	-	-	-	-	-				

Primary Rd	BASS LAKE RD	Distance (ft)	110	Direction	N	Secondary Rd	LAMBETH DR	NCIC	9245	State Hwy?	N	Route		Postmile Prefix		Postmile		Side of Hwy	
City	UNINCORP.	County	EL DORADO	Population	9	Rpt Dist	Beat 001	Type	3	CalTrans Dist		Badge	018663	Collision Date	20170721	Time	2009	Day	FRI
Primary Collision Factor	DRVR ALC DRG	Violation	23152A	Collision Type	HIT OBJECT	Severity	INJURY	# Killed	0	# Injured	1	Tow Away?	Y	Process Date	20170728	Spec Cond	0		
Weather1	CLEAR	Weather2		Rdwy Surface	DRY	Rdwy Cond1	NO UNUSL CND	Rdwy Cond2											
Hit and Run		Motor Veh Involved With	FIXED OBJ	Lighting	DAYLIGHT	Ped Action		Cntrl Dev	NT PRS/FCTR	Loc Type		Ramp/Int							

PARTY INFO

VICTIM INFO

Party Type	Age	Sex	Race	Sobriety1	Sobriety2	Move Pre Coll	Dir	SW Veh	CHP Veh	Veh Make	Year	Sp Info	OAF1 Viol	OAF2 Safety Equip	Role	Ext of Inj	Age	Sex	Seat Pos	Safety Equip	Ejected	
1F	DRVR	25	M	W	HBD-UI	UNS TURN	S	A		0100	INFI	2005	-	3	A	22107	-	L	G			

Primary Rd	BASS LAKE ROAD	Distance (ft)	13	Direction	S	Secondary Rd	HILL ROAD	NCIC	9245	State Hwy?	N	Route		Postmile Prefix		Postmile		Side of Hwy	
City	UNINCORP.	County	EL DORADO	Population	9	Rpt Dist	Beat 001	Type	3	CalTrans Dist		Badge	015421	Collision Date	20170809	Time	2000	Day	WED
Primary Collision Factor	DRVR ALC DRG	Violation	23152A	Collision Type	HIT OBJECT	Severity	PDO	# Killed	0	# Injured	0	Tow Away?	Y	Process Date	20170816	Spec Cond	0		
Weather1	CLEAR	Weather2		Rdwy Surface	DRY	Rdwy Cond1	NO UNUSL CND	Rdwy Cond2											
Hit and Run		Motor Veh Involved With	FIXED OBJ	Lighting	DUSK/DAWN	Ped Action		Cntrl Dev	NT PRS/FCTR	Loc Type		Ramp/Int							

PARTY INFO

VICTIM INFO

Party Type	Age	Sex	Race	Sobriety1	Sobriety2	Move Pre Coll	Dir	SW Veh	CHP Veh	Veh Make	Year	Sp Info	OAF1 Viol	OAF2 Safety Equip	Role	Ext of Inj	Age	Sex	Seat Pos	Safety Equip	Ejected	
1F	DRVR	71	F	W	HBD-UI	RAN OFF RD	S	A		0100	TOYO	2012	-	3	F	-	L	G				

Primary Rd	BASS LAKE ROAD	Distance (ft)	330	Direction	N	Secondary Rd	MADERA WAY	NCIC	9245	State Hwy?	N	Route		Postmile Prefix		Postmile		Side of Hwy	
City	UNINCORP.	County	EL DORADO	Population	9	Rpt Dist	Beat 001	Type	3	CalTrans Dist		Badge	013342	Collision Date	20171031	Time	0635	Day	TUE
Primary Collision Factor	UNSAFE SPEED	Violation	22350	Collision Type	HIT OBJECT	Severity	PDO	# Killed	0	# Injured	0	Tow Away?	Y	Process Date	20171107	Spec Cond	0		
Weather1	CLEAR	Weather2		Rdwy Surface	DRY	Rdwy Cond1	NO UNUSL CND	Rdwy Cond2											
Hit and Run		Motor Veh Involved With	FIXED OBJ	Lighting	DARK - NO ST LTS	Ped Action		Cntrl Dev	NT PRS/FCTR	Loc Type		Ramp/Int							

PARTY INFO

VICTIM INFO

Party Type	Age	Sex	Race	Sobriety1	Sobriety2	Move Pre Coll	Dir	SW Veh	CHP Veh	Veh Make	Year	Sp Info	OAF1 Viol	OAF2 Safety Equip	Role	Ext of Inj	Age	Sex	Seat Pos	Safety Equip	Ejected	
1F	DRVR	18	F	W	HNBD	RAN OFF RD	S	A		0700	LANDR	2000	-	3	N	-	M	G				

Report run on: 8/5/2019
Total Count: 113

#190942 2009 - AV 2018/2019 COLLISIONS ON BASS LAKE RD BTWN SERRANO PKWY & GREEN VALLEY RD, EL DORADO COUNTY

Case Listing
Page 16

Primary Rd BASS LAKE RD Distance (ft) 40 Direction N Secondary Rd HILL RD NCIC 9245 State Hwy? N Route Postmile Prefix Postmile Side of Hwy
City UNINCORP. County EL DORADO Population 9 Rpt Dist Beat 001 Type 3 CalTrans Dist Badge 016371 Collision Date 20171115 Time 2235 Day WED
Primary Collision Factor DRVR ALCJDRG Violation 23152A Collision Type HIT OBJECT Severity INJURY # Killed 0 # Injured 2 Tow Away? Y Process Date 20171128
Weather1 CLOUDY Weather2 RAINING Rdwy Surface WET Rdwy Cond1 NO UNUSL CND Rdwy Cond2 Spec Cond 0
Hit and Run Motor Veh Involved With FIXED OBJ Lighting DARK - NO ST LTS Ped Action Cntrl Dev NT PRS/FCTR Loc Type Ramp/Int

PARTY INFO

VICTIM INFO

Party Type	Age	Sex	Race	Sobriety1	Sobriety2	Move Pre Coll	Dir	SW Veh	CHP Veh	Veh Make	Year	Sp Info	OAF1 Viol	OAF2 Safety Equip	Role	Ext of Inj	Age	Sex	Seat Pos	Safety Equip	Ejected					
1F	DRVR	38	M	W	HBD-UI	UNS	TURN	S	A	0100	FORD	2013	-	3	A	22107	-	L	H	DRVR MINOR	38	M	1	L	G	0
																PASS POSSIBLE	47	F	3	M	H	0				

Primary Rd BASS LAKE ROAD Distance (ft) 500 Direction N Secondary Rd MADERA WAY NCIC 9245 State Hwy? N Route Postmile Prefix Postmile Side of Hwy
City UNINCORP. County EL DORADO Population 9 Rpt Dist Beat 001 Type 3 CalTrans Dist Badge 013342 Collision Date 20171126 Time 1405 Day SUN
Primary Collision Factor UNSAFE SPEED Violation 22350 Collision Type HIT OBJECT Severity PDO # Killed 0 # Injured 0 Tow Away? Y Process Date 20171206
Weather1 RAINING Weather2 Rdwy Surface WET Rdwy Cond1 NO UNUSL CND Rdwy Cond2 Spec Cond 0
Hit and Run Motor Veh Involved With FIXED OBJ Lighting DAYLIGHT Ped Action Cntrl Dev FNCTNG Loc Type Ramp/Int

PARTY INFO

VICTIM INFO

Party Type	Age	Sex	Race	Sobriety1	Sobriety2	Move Pre Coll	Dir	SW Veh	CHP Veh	Veh Make	Year	Sp Info	OAF1 Viol	OAF2 Safety Equip	Role	Ext of Inj	Age	Sex	Seat Pos	Safety Equip	Ejected	
1F	DRVR	19	M	W	HNBD	RAN OFF RD	S	A	0100	FORD	1994	-	3	N	-	M	G					

Primary Rd BASS LAKE RD Distance (ft) 415 Direction S Secondary Rd WOODLEIGH LN NCIC 9245 State Hwy? N Route Postmile Prefix Postmile Side of Hwy
City UNINCORP. County EL DORADO Population 9 Rpt Dist Beat 001 Type 3 CalTrans Dist Badge 012833 Collision Date 20171225 Time 1948 Day MON
Primary Collision Factor DRVR ALCJDRG Violation 23152A Collision Type SIDESWIPE Severity INJURY # Killed 0 # Injured 4 Tow Away? Y Process Date 20180103
Weather1 CLOUDY Weather2 Rdwy Surface DRY Rdwy Cond1 NO UNUSL CND Rdwy Cond2 Spec Cond 0
Hit and Run Motor Veh Involved With OTHER MV Lighting DARK - NO ST LTS Ped Action Cntrl Dev NT PRS/FCTR Loc Type Ramp/Int

PARTY INFO

VICTIM INFO

Party Type	Age	Sex	Race	Sobriety1	Sobriety2	Move Pre Coll	Dir	SW Veh	CHP Veh	Veh Make	Year	Sp Info	OAF1 Viol	OAF2 Safety Equip	Role	Ext of Inj	Age	Sex	Seat Pos	Safety Equip	Ejected				
1F	DRVR	20	F	O	HBD-UI	OPPOS LN	S	A	0100	HONDA	2017	-	3	A	21460A	-	L	H	DRVR SERIOUS	20	F	1	L	H	0
																PASS SERIOUS	21	F	3	B	G	0			
																PASS MINOR	26	M	6	L	H	0			
																PASS POSSIBLE	29	M	4	M	H	0			

2 DRVR 67 F A HNBD PROC ST N A 0100 BMW 2000 - 3 N - M G
Primary Rd WOODLEIGH LN Distance (ft) 15 Direction E Secondary Rd BASS LAKE RD NCIC 9245 State Hwy? N Route Postmile Prefix Postmile Side of Hwy
City UNINCORP. County EL DORADO Population 9 Rpt Dist Beat 001 Type 3 CalTrans Dist Badge 017856 Collision Date 20180111 Time 1417 Day THU
Primary Collision Factor IMPROP TURN Violation 22100A Collision Type BROADSIDE Severity PDO # Killed 0 # Injured 0 Tow Away? Y Process Date 20180117
Weather1 CLEAR Weather2 Rdwy Surface DRY Rdwy Cond1 NO UNUSL CND Rdwy Cond2 Spec Cond 0
Hit and Run Motor Veh Involved With OTHER MV Lighting DAYLIGHT Ped Action Cntrl Dev NT PRS/FCTR Loc Type Ramp/Int

PARTY INFO

VICTIM INFO

Party Type	Age	Sex	Race	Sobriety1	Sobriety2	Move Pre Coll	Dir	SW Veh	CHP Veh	Veh Make	Year	Sp Info	OAF1 Viol	OAF2 Safety Equip	Role	Ext of Inj	Age	Sex	Seat Pos	Safety Equip	Ejected	
1F	DRVR	17	M	W	HNBD	RGT TURN	E	A	0100	ACUR	1999	-	3	N	-	M	G					
2	DRVR	36	F	W	HNBD	SLOWING	W	A	0700	TOYO	2017	-	3	N	-	M	G					

Primary Rd GREEN VALLEY RD Distance (ft) 1 Direction N Secondary Rd BASS LAKE RD NCIC 9245 State Hwy? N Route Postmile Prefix Postmile Side of Hwy
City UNINCORP. County EL DORADO Population 9 Rpt Dist Beat 011 Type 2 CalTrans Dist Badge 017897 Collision Date 20180121 Time 1728 Day SUN
Primary Collision Factor UNSAFE SPEED Violation 22350 Collision Type HIT OBJECT Severity INJURY # Killed 0 # Injured 1 Tow Away? Y Process Date 20180123
Weather1 CLEAR Weather2 Rdwy Surface DRY Rdwy Cond1 NO UNUSL CND Rdwy Cond2 Spec Cond 0
Hit and Run Motor Veh Involved With FIXED OBJ Lighting DARK - ST LTS Ped Action Cntrl Dev FNCTNG Loc Type Ramp/Int

PARTY INFO

VICTIM INFO

Party Type	Age	Sex	Race	Sobriety1	Sobriety2	Move Pre Coll	Dir	SW Veh	CHP Veh	Veh Make	Year	Sp Info	OAF1 Viol	OAF2 Safety Equip	Role	Ext of Inj	Age	Sex	Seat Pos	Safety Equip	Ejected			
1F	DRVR	17	F	H	HNBD	LFT TURN	W	A	0100	CHRY	2002	-	3	N	-	L	G	DRVR MINOR	17	F	1	L	G	0

Primary Rd BASS LAKE RD Distance (ft) 700 Direction N Secondary Rd MADERA WAY NCIC 9245 State Hwy? N Route Postmile Prefix Postmile Side of Hwy
City UNINCORP. County EL DORADO Population 9 Rpt Dist Beat 001 Type 3 CalTrans Dist Badge 018601 Collision Date 20180126 Time 1525 Day FRI
Primary Collision Factor UNSAFE SPEED Violation 22350 Collision Type OVERTURNED Severity INJURY # Killed 0 # Injured 1 Tow Away? N Process Date 20180416
Weather1 CLEAR Weather2 Rdwy Surface DRY Rdwy Cond1 NO UNUSL CND Rdwy Cond2 Spec Cond 0
Hit and Run Motor Veh Involved With NON-CLSN Lighting DAYLIGHT Ped Action Cntrl Dev NT PRS/FCTR Loc Type Ramp/Int

PARTY INFO

VICTIM INFO

Party Type	Age	Sex	Race	Sobriety1	Sobriety2	Move Pre Coll	Dir	SW Veh	CHP Veh	Veh Make	Year	Sp Info	OAF1 Viol	OAF2 Safety Equip	Role	Ext of Inj	Age	Sex	Seat Pos	Safety Equip	Ejected			
1F	DRVR	60	M	W	HNBD	RAN OFF RD	N	C	0200	HONDA	2003	-	3	N	-	P	W	DRVR MINOR	60	M	1	P	W	1

Total Count: 113

Primary Rd GREEN VALLEY RD Distance (ft) 502 Direction W Secondary Rd BASS LAKE ROAD NCIC 9245 State Hwy? N Route Postmile Prefix Postmile Side of Hwy
 City UNINCORP. County EL DORADO Population 9 Rpt Dist Beat 011 Type 2 CalTrans Dist Badge 015421 Collision Date 20180226 Time 1605 Day MON
 Primary Collision Factor UNSAFE SPEED Violation 22350 Collision Type HEAD-ON Severity INJURY # Killed 0 # Injured 2 Tow Away? Y Process Date 20180227
 Weather1 RAINING Weather2 SNOWING Rdw Surface SNOWY OR ICY Rdw Cond1 NO UNUSL CND Rdw Cond2 Spec Cond 0
 Hit and Run Motor Veh Involved With OTHER MV Lighting DAYLIGHT Ped Action Cntrl Dev NT PRS/FCTR Loc Type Ramp/Int

PARTY INFO

VICTIM INFO

Party	Type	Age	Sex	Race	Sobriety1	Sobriety2	Move	Pre Coll	Dir	SW	Veh	CHP	Veh	Make	Year	Sp	Info	OAF1	Viol	OAF2	Safety	Equip	Role	Ext of Inj	Age	Sex	Seat	Pos	Safety	Equip	Ejected
1F	DRVR	60	M	O	HNBD		OPPOS LN	W	A		0100	TOYOT	2015	-	3	A	22107	-	L	G		DRVR	MINOR	60	M	1	L	G	0		
2	DRVR	65	M	W	HNBD		PROC ST	E	A		0700	NISSA	2015	-	3	N		-	L	G		DRVR	MINOR	65	M	1	L	G	0		
3	DRVR	48	M	W	HNBD		SLOWING	E	A		0100	VOLK	2014	-	3	N		-	M	G											

Primary Rd N/B BASS LAKE RD Distance (ft) 300 Direction S Secondary Rd BRIDLEWOOD DR NCIC 9245 State Hwy? N Route Postmile Prefix Postmile Side of Hwy
 City UNINCORP. County EL DORADO Population 9 Rpt Dist Beat 001 Type 3 CalTrans Dist Badge 018624 Collision Date 20180526 Time 0200 Day SAT
 Primary Collision Factor UNSAFE SPEED Violation 22350 Collision Type HIT OBJECT Severity PDO # Killed 0 # Injured 0 Tow Away? Y Process Date 20180604
 Weather1 CLOUDY Weather2 Rdw Surface DRY Rdw Cond1 NO UNUSL CND Rdw Cond2 Spec Cond 0
 Hit and Run Motor Veh Involved With OTHER OBJ Lighting DARK - NO ST LTS Ped Action Cntrl Dev NT PRS/FCTR Loc Type Ramp/Int

PARTY INFO

VICTIM INFO

Party	Type	Age	Sex	Race	Sobriety1	Sobriety2	Move	Pre Coll	Dir	SW	Veh	CHP	Veh	Make	Year	Sp	Info	OAF1	Viol	OAF2	Safety	Equip	Role	Ext of Inj	Age	Sex	Seat	Pos	Safety	Equip	Ejected
1F	DRVR	19	M	W	HNBD		PROC ST	N	A		0100	FORD	2017	-	3	N		-	L	G											

Primary Rd BASS LAKE RD Distance (ft) 10 Direction N Secondary Rd SANDHURST HILL R NCIC 9245 State Hwy? N Route Postmile Prefix Postmile Side of Hwy
 City UNINCORP. County EL DORADO Population 9 Rpt Dist Beat 001 Type 3 CalTrans Dist Badge 018893 Collision Date 20180618 Time 2155 Day MON
 Primary Collision Factor DRVR ALC|DRG Violation 23152F Collision Type HIT OBJECT Severity PDO # Killed 0 # Injured 0 Tow Away? Y Process Date 20180626
 Weather1 CLEAR Weather2 Rdw Surface DRY Rdw Cond1 NO UNUSL CND Rdw Cond2 Spec Cond 0
 Hit and Run Motor Veh Involved With OTHER OBJ Lighting DARK - NO ST LTS Ped Action Cntrl Dev NT PRS/FCTR Loc Type Ramp/Int

PARTY INFO

VICTIM INFO

Party	Type	Age	Sex	Race	Sobriety1	Sobriety2	Move	Pre Coll	Dir	SW	Veh	CHP	Veh	Make	Year	Sp	Info	OAF1	Viol	OAF2	Safety	Equip	Role	Ext of Inj	Age	Sex	Seat	Pos	Safety	Equip	Ejected
1F	DRVR	18	F	W			DRUG	RAN OFF RD	N	A		0100	FORD	2010	-	3	A	22350	-	M	G										

Primary Rd BASS LAKE ROAD Distance (ft) 75 Direction N Secondary Rd SANDHURST HILL R NCIC 9245 State Hwy? N Route Postmile Prefix Postmile Side of Hwy
 City UNINCORP. County EL DORADO Population 9 Rpt Dist Beat 001 Type 3 CalTrans Dist Badge 013342 Collision Date 20180618 Time 1020 Day MON
 Primary Collision Factor IMPROP TURN Violation 22107 Collision Type HIT OBJECT Severity INJURY # Killed 0 # Injured 1 Tow Away? Y Process Date 20180622
 Weather1 CLEAR Weather2 Rdw Surface DRY Rdw Cond1 NO UNUSL CND Rdw Cond2 Spec Cond 0
 Hit and Run Motor Veh Involved With FIXED OBJ Lighting DAYLIGHT Ped Action Cntrl Dev NT PRS/FCTR Loc Type Ramp/Int

PARTY INFO

VICTIM INFO

Party	Type	Age	Sex	Race	Sobriety1	Sobriety2	Move	Pre Coll	Dir	SW	Veh	CHP	Veh	Make	Year	Sp	Info	OAF1	Viol	OAF2	Safety	Equip	Role	Ext of Inj	Age	Sex	Seat	Pos	Safety	Equip	Ejected
1F	DRVR	65	F	W	HNBD		RAN OFF RD	S	A		0700	FORD	2012	-	3	N		-	L	G		DRVR	MINOR	65	F	1	L	G	0		

Primary Rd BASS LAKE RD Distance (ft) 450 Direction N Secondary Rd MADERA WAY NCIC 9245 State Hwy? N Route Postmile Prefix Postmile Side of Hwy
 City UNINCORP. County EL DORADO Population 9 Rpt Dist Beat 001 Type 3 CalTrans Dist Badge 017364 Collision Date 20180707 Time 2110 Day SAT
 Primary Collision Factor UNSAFE SPEED Violation 22350 Collision Type HIT OBJECT Severity INJURY # Killed 0 # Injured 1 Tow Away? Y Process Date 20180718
 Weather1 CLEAR Weather2 Rdw Surface DRY Rdw Cond1 NO UNUSL CND Rdw Cond2 Spec Cond 0
 Hit and Run Motor Veh Involved With FIXED OBJ Lighting DARK - NO ST LTS Ped Action Cntrl Dev NT PRS/FCTR Loc Type Ramp/Int

PARTY INFO

VICTIM INFO

Party	Type	Age	Sex	Race	Sobriety1	Sobriety2	Move	Pre Coll	Dir	SW	Veh	CHP	Veh	Make	Year	Sp	Info	OAF1	Viol	OAF2	Safety	Equip	Role	Ext of Inj	Age	Sex	Seat	Pos	Safety	Equip	Ejected
1F	DRVR	17	M	W			FATG	RAN OFF RD	N	D		2200	DODG	1999	-	3	N		-	M	G		DRVR	SERIOUS	17	M	1	M	G	0	

Primary Rd BASS LAKE ROAD Distance (ft) 200 Direction N Secondary Rd MADERA WAY NCIC 9245 State Hwy? N Route Postmile Prefix Postmile Side of Hwy
 City UNINCORP. County EL DORADO Population 9 Rpt Dist Beat 001 Type 3 CalTrans Dist Badge 017728 Collision Date 20181003 Time 1930 Day WED
 Primary Collision Factor UNSAFE SPEED Violation 22350 Collision Type OVERTURNED Severity PDO # Killed 0 # Injured 0 Tow Away? Y Process Date 20181010
 Weather1 CLOUDY Weather2 RAINING Rdw Surface WET Rdw Cond1 NO UNUSL CND Rdw Cond2 Spec Cond 0
 Hit and Run Motor Veh Involved With NON-CLSN Lighting DARK - NO ST LTS Ped Action Cntrl Dev NT PRS/FCTR Loc Type Ramp/Int

PARTY INFO

VICTIM INFO

Party	Type	Age	Sex	Race	Sobriety1	Sobriety2	Move	Pre Coll	Dir	SW	Veh	CHP	Veh	Make	Year	Sp	Info	OAF1	Viol	OAF2	Safety	Equip	Role	Ext of Inj	Age	Sex	Seat	Pos	Safety	Equip	Ejected
1F	DRVR	25	F	W	HNBD		PROC ST	S	A		0100	HONDA	2003	-	3	N		-	M	G											

Total Count: 113

Primary Rd		Distance (ft)	Direction	Secondary Rd	NCIC	State Hwy?	Route	Postmile Prefix	Postmile	Side of Hwy														
BASS LAKE RD		1		PARKDALE LN	9245	N																		
UNINCORP.		EL DORADO	Population 9	Rpt Dist	Beat 001	Type 3	CalTrans Dist	Badge 015328	Collision Date 20181025	Time 0657 Day THU														
STOP SGN SIG		Violation 22450A	Collision Type BROADSIDE	Severity PDO	# Killed 0	# Injured 0	Tow Away? Y	Process Date 20181105																
CLEAR		Weather2	Rdwy Surface DRY	Rdwy Cond1 NO UNUSL CND	Rdwy Cond2			Spec Cond 0																
Hit and Run		Motor Veh Involved With OTHER MV	Lighting DAYLIGHT	Ped Action	Cntrl Dev FNCTNG	Loc Type	Ramp/Int																	
PARTY INFO																								
Party	Type	Age	Sex	Race	Sobriety1	Sobriety2	Move Pre Coll Dir	SW Veh	CHP Veh	Make	Year	Sp Info	OAF1 Viol	OAF2 Safety Equip	Role	Ext of Inj	Age	Sex	Seat Pos	Safety Equip	Ejected			
1F	DRVR	30	M	H	HNBD		SLOWING	W	A	0100	TOYO	2000	- 3	N	-	M	G							
2	DRVR	41	M	O	HNBD		PROC ST	N	D	2200	GMC	2018	- 3	N	-	M	G							
BASS LAKE RD		5		BRIDLEWOOD DR	9245	N																		
UNINCORP.		EL DORADO	Population 9	Rpt Dist	Beat 001	Type 3	CalTrans Dist	Badge 015328	Collision Date 20181206	Time 1545 Day THU														
UNSAFE SPEED		Violation 22350	Collision Type REAR END	Severity PDO	# Killed 0	# Injured 0	Tow Away? Y	Process Date 20181214																
CLEAR		Weather2	Rdwy Surface DRY	Rdwy Cond1 NO UNUSL CND	Rdwy Cond2			Spec Cond 0																
Hit and Run		Motor Veh Involved With OTHER MV	Lighting DAYLIGHT	Ped Action	Cntrl Dev NT PRS/FCTR	Loc Type	Ramp/Int																	
PARTY INFO																								
Party	Type	Age	Sex	Race	Sobriety1	Sobriety2	Move Pre Coll Dir	SW Veh	CHP Veh	Make	Year	Sp Info	OAF1 Viol	OAF2 Safety Equip	Role	Ext of Inj	Age	Sex	Seat Pos	Safety Equip	Ejected			
1F	DRVR	17	M	W	HNBD		SLOWING	S	A	0700	TOYO	2008	- 3	N	-	M	G							
2	DRVR	51	M	W	HNBD		STOPPED	S	D	2200	TOYO	2006	- 3	N	-	M	G							
BASS LAKE ROAD		60		SANDHURST HILL R	9245	N																		
UNINCORP.		EL DORADO	Population 9	Rpt Dist	Beat 001	Type 3	CalTrans Dist	Badge 018624	Collision Date 20181229	Time 0200 Day SAT														
UNSAFE SPEED		Violation 22350	Collision Type OVERTURNED	Severity PDO	# Killed 0	# Injured 0	Tow Away? Y	Process Date 20190102																
CLEAR		Weather2	Rdwy Surface DRY	Rdwy Cond1 NO UNUSL CND	Rdwy Cond2			Spec Cond 0																
Hit and Run		MSDMNR	Motor Veh Involved With OTHER OBJ	Lighting DARK - NO ST LTS	Ped Action	Cntrl Dev FNCTNG	Loc Type	Ramp/Int																
PARTY INFO																								
Party	Type	Age	Sex	Race	Sobriety1	Sobriety2	Move Pre Coll Dir	SW Veh	CHP Veh	Make	Year	Sp Info	OAF1 Viol	OAF2 Safety Equip	Role	Ext of Inj	Age	Sex	Seat Pos	Safety Equip	Ejected			
1F	DRVR	998		W	HNBD		WRONG WY	N	A	0700	TOYO	2002	- 3	N	-	M	B							
BASS LAKE RD		100		MADERA WAY	9245	N																		
UNINCORP.		EL DORADO	Population 9	Rpt Dist	Beat 001	Type 3	CalTrans Dist	Badge 018724	Collision Date 20190103	Time 1910 Day THU														
IMPROP TURN		Violation 22107	Collision Type HIT OBJECT	Severity PDO	# Killed 0	# Injured 0	Tow Away? Y	Process Date 20190109																
CLEAR		Weather2	Rdwy Surface DRY	Rdwy Cond1 NO UNUSL CND	Rdwy Cond2			Spec Cond 0																
Hit and Run		MSDMNR	Motor Veh Involved With FIXED OBJ	Lighting DARK - ST LTS	Ped Action	Cntrl Dev NT PRS/FCTR	Loc Type	Ramp/Int																
PARTY INFO																								
Party	Type	Age	Sex	Race	Sobriety1	Sobriety2	Move Pre Coll Dir	SW Veh	CHP Veh	Make	Year	Sp Info	OAF1 Viol	OAF2 Safety Equip	Role	Ext of Inj	Age	Sex	Seat Pos	Safety Equip	Ejected			
1F	DRVR	998		W	HNBD		UNSAFE TURN	N	A	0100	DODGE	2008	- 3	N	-	L	B							
BASS LAKE RD		1		PARKDALE LN	9245	N																		
UNINCORP.		EL DORADO	Population 9	Rpt Dist	Beat 001	Type 3	CalTrans Dist	Badge 015328	Collision Date 20190110	Time 0600 Day THU														
STOP SGN SIG		Violation 22450A	Collision Type BROADSIDE	Severity INJURY	# Killed 0	# Injured 1	Tow Away? Y	Process Date 20190110																
CLEAR		Weather2	Rdwy Surface WET	Rdwy Cond1 NO UNUSL CND	Rdwy Cond2			Spec Cond 0																
Hit and Run		Motor Veh Involved With OTHER MV	Lighting DAYLIGHT	Ped Action	Cntrl Dev FNCTNG	Loc Type	Ramp/Int																	
PARTY INFO																								
Party	Type	Age	Sex	Race	Sobriety1	Sobriety2	Move Pre Coll Dir	SW Veh	CHP Veh	Make	Year	Sp Info	OAF1 Viol	OAF2 Safety Equip	Role	Ext of Inj	Age	Sex	Seat Pos	Safety Equip	Ejected			
1F	DRVR	45	F	W	HNBD		SLOWING	N	A	0100	HOND	2009	- 3	N	-	M	G							
2	DRVR	53	F	O	HNBD		LFT TURN	W	A	0700	NISS	2014	- 3	N	-	L	G	DRVR POSSIBLE	53	F	1	L	G	0
BASS LAKE RD		10		WOODLEIGH LN	9245	N																		
UNINCORP.		EL DORADO	Population 9	Rpt Dist	Beat 001	Type 3	CalTrans Dist	Badge 015328	Collision Date 20190301	Time 0618 Day FRI														
UNSAFE SPEED		Violation 22350	Collision Type REAR END	Severity INJURY	# Killed 0	# Injured 2	Tow Away? Y	Process Date 20190301																
CLEAR		Weather2	Rdwy Surface DRY	Rdwy Cond1 NO UNUSL CND	Rdwy Cond2			Spec Cond 0																
Hit and Run		Motor Veh Involved With OTHER MV	Lighting DUSK/DAWN	Ped Action	Cntrl Dev NT PRS/FCTR	Loc Type	Ramp/Int																	
PARTY INFO																								
Party	Type	Age	Sex	Race	Sobriety1	Sobriety2	Move Pre Coll Dir	SW Veh	CHP Veh	Make	Year	Sp Info	OAF1 Viol	OAF2 Safety Equip	Role	Ext of Inj	Age	Sex	Seat Pos	Safety Equip	Ejected			
1F	DRVR	24	M	W	HNBD		SLOWING	S	A	0100	TOYO	2016	- 3	N	-	L	G	DRVR POSSIBLE	24	M	1	L	G	0
2	DRVR	36	M	H	HNBD		STOPPED	S	D	2200	FORD	2002	- 3	N	-	M	G	DRVR POSSIBLE	36	M	1	M	G	0

Total Count: 113

Primary Rd BASS LAKE RD Distance (ft) 260 Direction S Secondary Rd HILL ROAD NCIC 9245 State Hwy? N Route Postmile Prefix Postmile Side of Hwy
 City UNINCORP. County EL DORADO Population 9 Rpt Dist Beat 001 Type 3 CalTrans Dist Badge 016451 Collision Date 20190308 Time 1800 Day FRI
 Primary Collision Factor WRONG SIDE Violation 21460A Collision Type HEAD-ON Severity INJURY # Killed 0 # Injured 3 Tow Away? Y Process Date 20190312
 Weather1 CLEAR Weather2 Rdwy Surface DRY Rdwy Cond1 NO UNUSL CND Rdwy Cond2 Spec Cond 0
 Hit and Run Motor Veh Involved With OTHER MV Lighting DARK - NO ST LTS Ped Action Cntrl Dev NT PRS/FCTR Loc Type Ramp/Int

PARTY INFO

VICTIM INFO

Party	Type	Age	Sex	Race	Sobriety1	Sobriety2	Move	Pre Coll	Dir	SW Veh	CHP Veh	Veh Make	Year	Sp Info	OAF1 Viol	OAF2 Safety Equip	Role	Ext of Inj	Age	Sex	Seat Pos	Safety Equip	Ejected
1F	DRVR	39	F	W		FATG	OPPOS LN	N	A	0800	HOND	2004	-	3	N	-	L G	DRVR MINOR	39	F	1	L G	0
2	DRVR	53	F	W	HNBD		PROC ST	S	A	0800	HOND	2011	-	3	N	-	L G	DRVR MINOR	53	F	1	L G	0
																		PASS POSSIBLE	14	F	3	L G	0

Primary Rd BASS LAKE RD Distance (ft) 1056 Direction S Secondary Rd BRIDLEWOOD DR NCIC 9245 State Hwy? N Route Postmile Prefix Postmile Side of Hwy
 City UNINCORP. County EL DORADO Population 9 Rpt Dist Beat 001 Type 3 CalTrans Dist Badge 015609 Collision Date 20190326 Time 1420 Day TUE
 Primary Collision Factor IMPROP TURN Violation 22107 Collision Type SIDESWIPE Severity PDO # Killed 0 # Injured 0 Tow Away? N Process Date 20190328
 Weather1 CLOUDY Weather2 Rdwy Surface DRY Rdwy Cond1 NO UNUSL CND Rdwy Cond2 Spec Cond 0
 Hit and Run MSDMNR Motor Veh Involved With OTHER MV Lighting DAYLIGHT Ped Action Cntrl Dev NT PRS/FCTR Loc Type Ramp/Int

PARTY INFO

VICTIM INFO

Party	Type	Age	Sex	Race	Sobriety1	Sobriety2	Move	Pre Coll	Dir	SW Veh	CHP Veh	Veh Make	Year	Sp Info	OAF1 Viol	OAF2 Safety Equip	Role	Ext of Inj	Age	Sex	Seat Pos	Safety Equip	Ejected
1F	DRVR	998			IMP UNK	IMP UNK	PROC ST	S	D	2200	DODGE	-	3	N	-	B B							
2	DRVR	21	M	W	HNBD		PROC ST	N	J	4100	MERB	2013	-	3	N	-	M G						

Primary Rd GATEWAY DR Distance (ft) 80 Direction E Secondary Rd BASS LAKE RD NCIC 9245 State Hwy? N Route Postmile Prefix Postmile Side of Hwy
 City UNINCORP. County EL DORADO Population 9 Rpt Dist Beat 001 Type 3 CalTrans Dist Badge 017364 Collision Date 20190401 Time 1550 Day MON
 Primary Collision Factor UNSAFE SPEED Violation 22350 Collision Type HEAD-ON Severity INJURY # Killed 0 # Injured 1 Tow Away? Y Process Date 20190403
 Weather1 RAINING Weather2 Rdwy Surface WET Rdwy Cond1 NO UNUSL CND Rdwy Cond2 Spec Cond 0
 Hit and Run Motor Veh Involved With OTHER MV Lighting DAYLIGHT Ped Action Cntrl Dev NT PRS/FCTR Loc Type Ramp/Int

PARTY INFO

VICTIM INFO

Party	Type	Age	Sex	Race	Sobriety1	Sobriety2	Move	Pre Coll	Dir	SW Veh	CHP Veh	Veh Make	Year	Sp Info	OAF1 Viol	OAF2 Safety Equip	Role	Ext of Inj	Age	Sex	Seat Pos	Safety Equip	Ejected
1F	DRVR	43	M	H	HNBD		RGT TURN	E	A	0700	TOYT	2002	-	3	N	-	M G	DRVR MINOR	43	M	1	M G	0
2	DRVR	53	M	H	HNBD		PROC ST	W	E	2235	FORD	2007	-	3	N	-	M G						

The

BASS LAKE BULLETIN

Vol. V No. 12

The Voice of the Bass Lake Community

December 2007

www.basslakeaction.org

DEVELOPMENT, ROAD ISSUES DOMINATE AGENDAS

EDH APAC REVIEWS SERRANO VILLAGE J-7 DEVELOPMENT PLANS

Parker Development has begun the approval process for a proposal (Planned Development 07-0029 and Tentative Map 07-1457 – Serrano Associates LLC) to build a number of two- and three-story cluster homes on land next to Bridlewood Canyon designated as Serrano Village J-7. The triangular parcel is bounded by Bridlewood Canyon on the east and south sides, while the western side abuts that part of Bass Lake that extends south of Bass Lake Road.

The project was reviewed by the El Dorado Hills Area Planning Advisory Committee (APAC) on November 14, 2007, as part of the approval process. After a presentation by the applicant and comments from the public, APAC recommended approval of the application with several limitations.

APAC is concerned that the proposed three-story residences along the eastern and southern boundaries of the project, coupled with the short setback from the neighboring Bridlewood Canyon boundary, would create substantial visual impact and would be inconsistent with the policies set forth in the El Dorado Hills Specific Plan.

The design guidelines in the Specific Plan provide that “buildings in general shall be limited to two stories except where topography allows higher structures to be built without causing a significant visual impact” (Appendix B, Design Guidelines, Section 2.1.a). APAC is concerned that three-story dwellings built along the project’s boundary with Bridlewood Canyon could have a significant negative visual impact. APAC recommends that no three-story buildings be built along the project’s immediate boundary with Bridlewood Canyon.

Also, several APAC members noted that the Specific Plan provides for the matching of lot densities along the eastern boundary of

the Specific Plan area (Section 2.4, Location of Dwelling Unit Types). They are concerned that the “six-pack” residence design coupled with the fifteen-foot setback currently proposed could create an inconsistent density along the proposed development’s boundary with Bridlewood Canyon.

APAC is concerned that the traffic circulation pattern for the proposed project provides that future residents may make unregulated left turns across Bass Lake Road to enter or leave the project. The Committee is concerned that Bass Lake Road is becoming a well-traveled road, and such left turns may be hazardous. APAC recommends that the County Department of Transportation do a very thorough review of the left-turn traffic pattern associated with entering and exiting the proposed project.

APAC’s concerns were sent to County Project Planner Mel Pabalinas for inclusion with the materials that will go to the Planning Commission. ~

BLAC COMMENTS ON SERRANO VILLAGE J-7 DEVELOPMENT

Parker Development representative Kirk Bone has met several times with Bass Lake Action Committee in an effort to garner support for Parker’s proposal to develop the parcel adjacent to Bridlewood Canyon known as Village J-7 and build a number of two- and three-story cluster homes on the parcel.

Parker is requesting county approval to subdivide the parcel into 72 residential single-family attached lots and 14 landscaped home-owners-association-maintained lots. The lots will range from 2,594 square feet to 5,637 square feet in size. The 9.86 acre property is located on the south side of Bass Lake Road approximately 300 feet south of the intersection with Bridlewood Drive.

(continued on next page)



Map showing location of Serrano Village J-7 adjacent to Bridlewood Canyon

COMMENTS *(continued)*

BLAC shares the concerns of the El Dorado Area Planning Advisory Committee, in that the proposed three-story houses planned along the boundary of neighboring Bridlewood Canyon would be incompatible with the existing Bridlewood architecture. BLAC is also concerned that the fifteen-foot rear setbacks of the project would create substantial visual impact and the smaller lot densities would be inconsistent with the policies set forth in the El Dorado Hills Specific Plan.

BLAC is additionally concerned that the addition of an entry and exit from the J-7 homes will add to a series of driveways on a short curved stretch of Bass Lake Road that requires left turns in order for emerging motorists to travel south on the roadway.

Another issue is that any road improvements will require that the roadway be relocated to the center of the 100-foot right-of-way along that route. Such a realignment could take out a substantial part of the existing land and driveway now in front of Bridlewood Canyon (see photos on this and the front page).

BLAC members were generally pleased with the outreach by Parker and recently offered several suggestions with respect to the project and the planned improvements for that portion of Bass Lake Road that passes in front of the development.

BLAC has made known its concerns about the road improvements to county officials, including DOT Deputy Director Russ Nygaard. It is hoped that the road issues will be settled by the time BLAC hosts Mr. Nygaard as a guest speaker in February 2008 and he can then give a full report. ~

COUNTY HOLDS TAC MEETING ON J-7 PROJECT

The county held a Technical Advisory Committee (TAC) meeting on November 26, 2007, to discuss Parker Development's request for approval of a request for a tentative subdivision map and planned development (PD 07-0029 & TM 07-1457)



to subdivide and develop Village J-7. The property, identified by Assessor's Parcel Number 123-040-11, consists of 9.86 acres, and is located on the south side of Bass Lake Road approximately 300 feet south of the intersection with Bridlewood Drive, in the El Dorado Hills area. The meeting was called by El Dorado County Project Planner Mel Pabalinas.

The purpose of a TAC meeting is to review preliminary project design to ensure conformance with County policy and ordinances. The meeting may also provide early identification of possible issues giving the applicant the opportunity to seek solutions or consider design alternatives before formal filing of an application. The staff may also suggest alternatives for the project which, in the experience of the staff, have improved chances of a recommendation for county approval.

BLAC representative Greg Violette attended the TAC meeting and raised BLAC's concerns about the project, including the set back distance, three story structures and traffic.

Greg suggested that it was the responsibility of the Department of Transportation to do a thorough review of the Bass Lake Road traffic corridor as a whole and not as unrelated parts. Greg specifically raised the issue of line-of-sight for cars exiting Village J-7



onto Bass Lake Road. Parker Development representative Kirk Bone also urged DOT to thoroughly review the entire Bass Lake Road corridor, not only the portions of the road that front Parker's developments.

The DOT representatives at the meeting sought to allay the BLAC concerns by asserting that the proposed modifications to Bass Lake Road would address that issue.

Present plans call for the road to narrow over the portion of road way that crosses the waters of Bass Lake then widen out in front of Bridlewood Canyon.

DOT informed Parker that Parker would be responsible for road improvements to the right of way, though Parker would be eventually eligible for reimbursement for doing so.

Any comments on the project and the road mitigation plans should be addressed to Mr. Pabalinas at the El Dorado County Planning Services, 2850 Fairlane Court, Placerville, CA 95667. ~

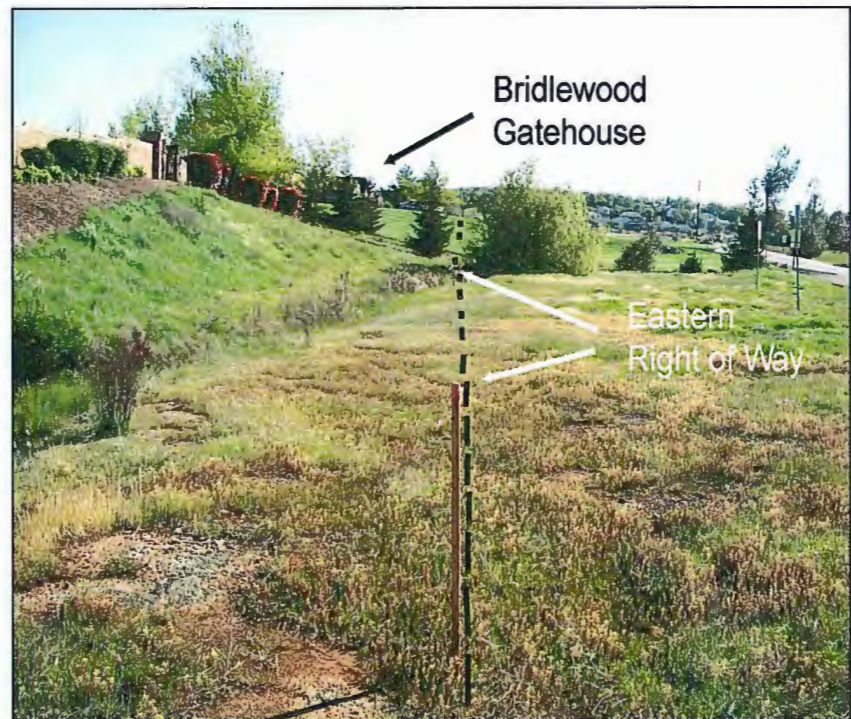

Photo showing the extent of the eastern side of the right of way for Bass Lake Road as it passes in front of Woodridge and Bridlewood Canyon

THE PRESIDENT'S LETTER



Hello Everyone,

Here we are approaching another Christmas season, a season of joy and thankfulness. Joy because we have had a wonderful year, thankfulness because we live in our beautiful community in the foothills.

Fran and I have had occasion to look around us and marvel at the changes that have occurred over the last few years. Our trees are becoming mature, and our garden is growing lush.

The other day someone who has lived in this area a long time remarked that when our hills were covered with nothing but oak trees and grassland, there were few birds to be seen. Now we are blessed with many beautiful birds. I believe that the masses of trees and bushes that have been planted, and the numerous water features, now bring the birds to El Dorado Hills.

We see birds at our fountain all the time. Bright green finches, brilliantly-hued hummingbirds, and all kinds of bluebirds, to mention a few. Almost every day finds us thumbing through the bird book trying to identify a new bird we have seen.

Then there are the birds that hop along the ground, eating what must be the seeds that fall from our plants, and the ones flitting through the trees, eating the berries there.

I see also that the Canada geese that winter over at Bass Lake are back. They seem to spend the night at Bass Lake then head off east in the morning to somewhere else to spend the day. They usually fly right over our house in a vee formation, honking loudly, every morning and every evening. What a sight.

So we all have much for which to be thankful, including all of our neighbors and friends up and down Bass Lake Road. May you all have a Merry Christmas and a Happy New Year!

John E. Thomson

President

COMMUNITY SERVICES DISTRICT UNVEILS STREETSCAPE MASTER PLAN

The El Dorado Hills Community Services District Planning Department will accept comments on Version I of the proposed El Dorado Hills Streetscape Master Plan and the Initial Study and Negative Declaration associated with the Streetscape Master Plan for the thirty day period ending on December 8, 2007.

The term "streetscape" typically refers to exterior public spaces located between street curbs and building facades. In rural neighborhoods, streetscape typically refers to the public space between the edge of the road and the private property lines. Examples of streetscape components are paving (sidewalks, curbs, accessible sidewalk ramps), plantings (street trees, supplemental plantings, container plantings), and street furnishings (benches, bus shelters, sign poles, fences, utility covers, lighting). A streetscape plan also may include fencing, pedestrian crosswalks, and traffic calming measures located within the vehicular space.

The El Dorado Hills Streetscape Master Plan does not address objects mounted to building facades such as signs, canopies, awnings, window boxes, railings, and other architectural features. The Streetscape Master Plan is intended to act as a guide for the progressive development and improvement of streetscapes along the arterial and collector streets within El Dorado Hills. The object of the Streetscape Master Plan is to support harmony and consistency along our community collector routes, enhancing the beauty and charm of El Dorado Hills.

It is hoped that with this first version of the Streetscape Master Plan (and subsequent updates), a consistent and cohesive streetscape will gradually evolve. It is not the intent of the initial Streetscape Master Plan to complete an immediate, sweeping transformation of the streetscapes within El Dorado Hills, but to be the impetus to move towards streetscapes that depict the culture of El Dorado Hills and reflect the pride that residents have in their community.

The Master Plan documents may be reviewed on the El Dorado Hills Community Services District website edhcsd.org and comments should be directed to Associate Planner Kent Malonson at the Harvard way offices of the CSD. ~

CP SPORTS COMPLEX DECLARED OUT OF BOUNDS

The El Dorado County Planning Commission has recommend restricting the use of a proposed ball field in Cameron Park after hearing the outspoken concerns of nearby neighbors.

Light of the Hills Lutheran Church was seeking approval to revise a special use permit for its property at Rodeo Road and Coach Lane south of Highway 50 in Cameron Park, and to extend the permit to an adjoining 5-acre parcel where it proposes to develop a multipurpose ball field.

The proposed ball field would be used for church-sponsored activities, such as carnivals and picnics now held in the parking lot, and for sports events, But residents of neighboring Cameron Estates packed the commission hearing room October 25 to protest the church's plan to make the ball field available to community sports leagues.

A neighbor said he feared "the result will be to turn that parcel into a veritable sports complex." Several other Cameron Estates residents said they didn't object to the church's building plans or to a ball field for church functions. But they complained that opening the field to community leagues would result in increased traffic congestion and noise.

Other neighbors said the ball field would draw additional traffic to an already congested area near a commercial center that includes a grocery store and restaurants, and contended that the ball field would lower property values in the area. One neighbor added that she would not have purchased a home next to a sports field.

Planning Commission members said they believed Cameron Estates residents had valid concerns about use of the field by community sports leagues. The commission recommended restricting the field to church activities, prohibiting its use by nonchurch sports leagues for either practice or games, and limiting use to between 9 a.m. and 6 p.m.

Planning staff members will prepare amended conditions for commission approval on November 8, after which the commission will forward its recommendation to the Board of Supervisors, which is scheduled to consider the matter at 2 p.m. December 11.

(continued on page 4)

CP SPORTS FIELD *(continued)*

A church spokesman noted that proposed conditions of approval for the project prohibited lights and sound systems on the field and limited use to the daytime. Citing the shortage of playing fields available for use by community sports leagues in the Cameron Park area, the spokesman said the church didn't want to limit use to just its members. But he said the field would be fenced and scheduling would be handled through the church office.

The outcry of the Cameron Estates neighborhood was reminiscent of the opposition of neighbors to the building of a proposed sports complex on the county park land on Bass Lake Road several years ago. ~

**NEW CHP COMMANDER TO ADDRESS BLAC**

Bass Lake Action Committee will host a discussion with California Highway Patrol Captain Bill Donovan at the regular BLAC meeting on January 7, 2008. Captain Donovan is the new commander of the Placerville CHP station, which covers El Dorado Hills.

Last month Captain Donovan announced a program to reallocate resources in El Dorado County to allow for a greater focus on several high-traffic areas, beginning with El Dorado Hills. This reallocation of resources will involve bringing in CHP officers from outside the county to help target areas within the county that have been identified as chronic traffic hot spots. The three-pronged program will combine educating the public through non-ticketed traffic stops, enforcement as necessary, and traffic engineering (working with the county Department of Transportation on street signage and design).

El Dorado Hills has been targeted as a starting point of the program specifically because of its dense population and high

traffic volume, including a high number of complaints from community members ranging from excessive speeds along certain stretches of roadway to parking problems around local schools.

The meeting will be held on January 7, 2008, at the home of John and Fran Thomson, 501 Kirkwood Court in El Dorado Hills, beginning at 7:00 PM. For further information contact Kathy Prevost at 530-6722-6836. ~

**BLAC ELECTS 2008 BOARD OF DIRECTORS**

The Bass Lake Action Committee elected its Board of Directors to serve in 2008 at the regular membership meeting on December 1, 2006. The many members present re-elected the 2008 board with a resounding vote, sweeping the incumbents into office for another year. The 2008 Board, which is made up of the officers, will include President John Thomson, Vice President Kathy Prevost, Secretary Fran Thomson, Treasurer Tasha Boutselis, and Director-at-Large Hal Erpenbeck.

The membership meeting was followed by the annual Christmas party, which was a delicious pot-luck affair held at the home of Andi and Tom Stuchell in Woodridge.

BLAC President John Thomson promised the group that BLAC would continue to look out for the interests of the neighborhoods along Bass Lake Road, and wished everyone a Merry Christmas and a Happy New Year. ~

Bass Lake Action Committee
501 Kirkwood Court
El Dorado Hills, CA 95762

Best Wishes
for a
Merry Christmas



The Bass Lake Bulletin is published monthly by the Bass Lake Action Committee, El Dorado Hills, California
Copyright © 2007. Reproduction is permitted if appropriate attribution is given to the Bass Lake Bulletin

John E. Thomson, Ph.D.,
President and Editor
doctorjet@basslakeaction.org
530-677-3039

For additional information
see our website
or contact
Vice President Kathy Prevost
kathyp@basslakeaction.org
530-672-6836