

INDEX OF SHEETS

SHEET	PLAN SHEET	TITLE
1		TITLE SHEET
2	CD-1	SURVEY AND CONTROL
3	X-1	TYPICAL SECTIONS
4-5	L1-L2	LAYOUT
6-9	C1-C4	CONSTRUCTION DETAILS
10	EC-1	EROSION CONTROL
11-14	SC1-SC4	STAGE CONSTRUCTION
15-17	SPD1-SPD3	SIGNING AND PAVEMENT DELINEATION

COUNTY OF EL DORADO, CA COMMUNITY DEVELOPMENT AGENCY TRANSPORTATION DIVISION

PROJECT PLANS FOR THE CONSTRUCTION OF PLEASANT VALLEY ROAD AT OAK HILL ROAD INTERSECTION IMPROVEMENTS

IN THE COUNTY OF EL DORADO, DISTRICT 3
2.5 MILES EAST OF DIAMOND SPRINGS

To be supplemented with Standard Plans and Specifications dated May 2006, including the amendments to the May 2006 Standard Specifications, updated August 15, 2008, of the California Department of Transportation, unless otherwise noted.

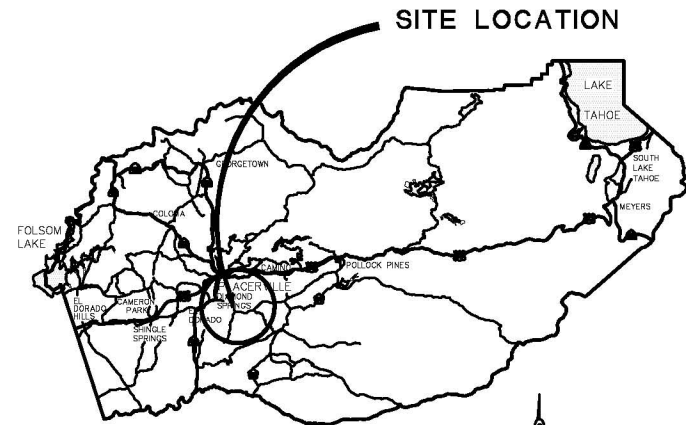

VICINITY MAP
COUNTY OF EL DORADO

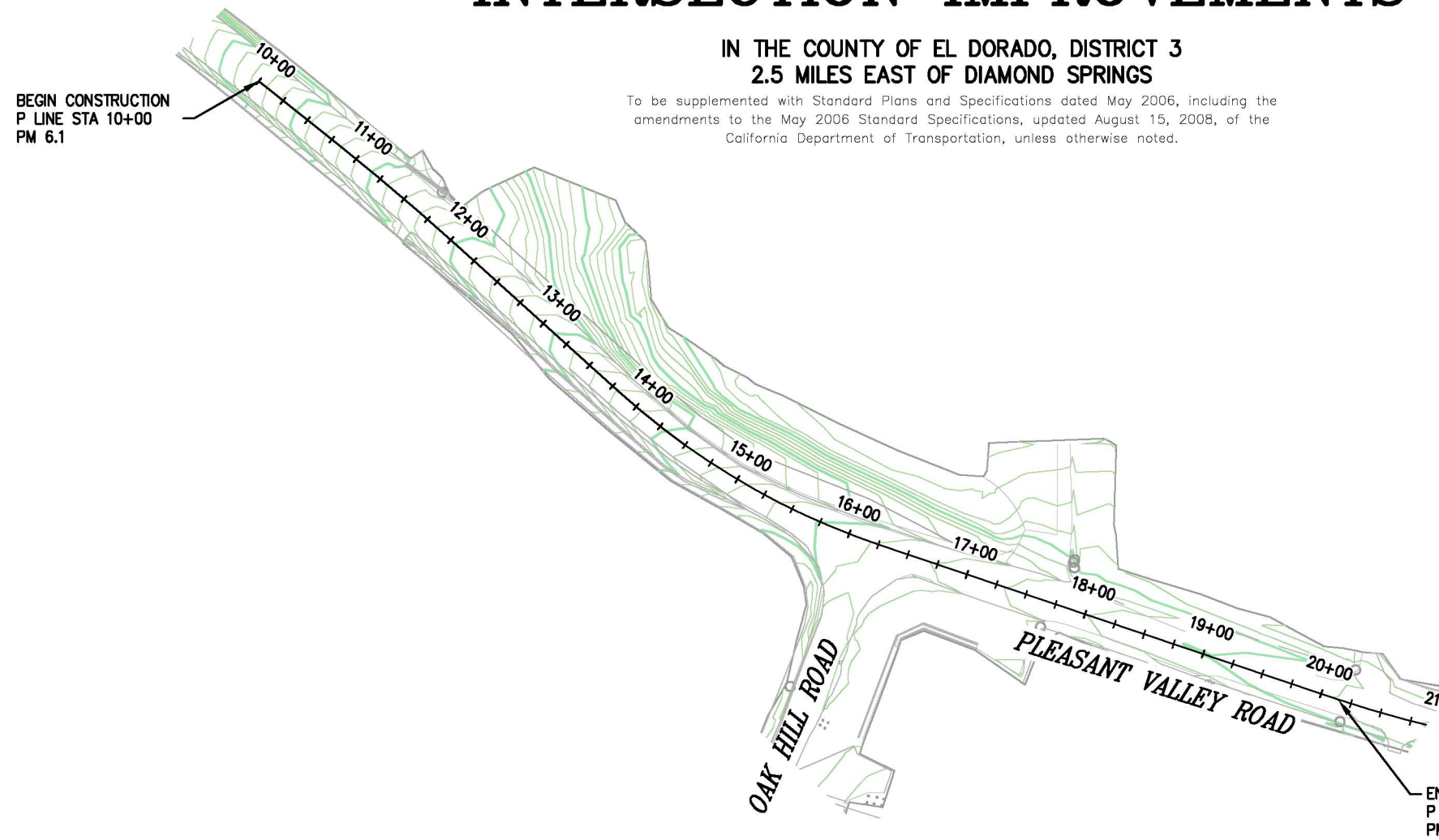

SITE PLAN
SCALE: 1"=60'

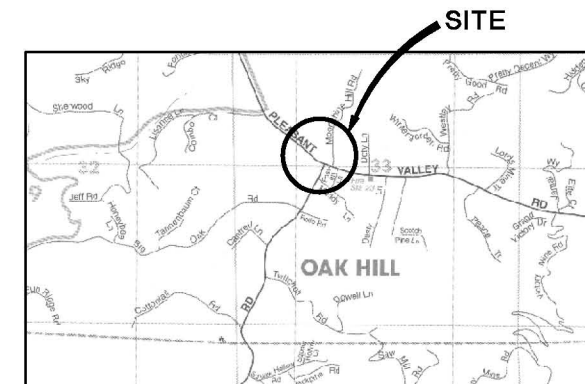

LOCATION MAP
NOT TO SCALE

BOARD OF SUPERVISORS

I	RON MIKULACO
II	RAYMOND J. NUTTING
III	BRIAN VEERKAMP
IV	RON V. BRIGGS
V	NORMA SANTIAGO

**COUNTY OF EL DORADO, CA
COMMUNITY DEVELOPMENT AGENCY
TRANSPORTATION DIVISION**

(530) 621-5900
2850 FAIRLANE CT
PLACERVILLE, CA 95667

ADOPTED AND APPROVED BY:

DATE	DATE	DATE
RON V. BRIGGS CHAIR, COUNTY OF EL DORADO BOARD OF SUPERVISORS	KIMBERLY A. KERR INTERIM TRANSPORTATION DIRECTOR, ACTING COMMUNITY DEVELOPMENT AGENCY DIRECTOR COUNTY OF EL DORADO	MATTHEW D. SMELTZER P.E. NO. C56812 DEPUTY DIRECTOR OF ENGINEERING UNIT, COUNTY OF EL DORADO TRANSPORTATION DIVISION

CONTRACTOR'S LICENSE CLASSIFICATION: Bidders shall be properly licensed to perform the Work pursuant to the State Contractor's License Act (Business and Professions Code section 7000 et seq.) and shall possess a CLASS A LICENSE or equivalent combination of Classes required by the categories and type of Work included in the Contract Documents and Plans. If the Contractor possesses a Class A license instead of the equivalent combination of Classes required by the categories and type of work included in the Contract Documents and Plans, then the Contractor or a subcontractor must also possess a CLASS C27 "Landscaping Contractor" license. Failure of the successful Bidder to obtain proper and adequate licensing at the time bids are submitted shall constitute a failure to execute the Contract, and forfeiture as provided under that section.

REVISIONS		
MARK	DATE	BY

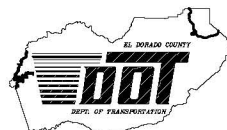

M Saed
SUBMITTED BY:
CIVIL ENGINEER
STATE OF CALIFORNIA NO.

6-11-13
DATE

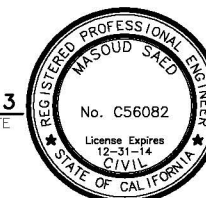

FEDERAL AID PROJECT No. HS1PL-5925(061)
PW NO. 10-30506 CONTRACT NO. 73358

**PLEASANT VALLEY ROAD AT
OAK HILL ROAD
INTERSECTION IMPROVEMENTS**

TITLE SHEET

SHEET 1 OF 17

ORIGINAL SCALE IS IN INCHES
Drawing name: C:\Civil 3D Projects\73358 Pleasant Vv at Oak Hill\CADD Files\Streets\CD-1.dwg Layout Tab: CD-1 Jun 04 2013 - 2:21pm BRichards
FOR REDUCED PLANS

ALIGNMENT CURVE DATA					
CURVE #	RADIUS	LENGTH	CHORD DIRECTION	START POINT	END POINT
C1	2000.00	124.46	S49° 40' 41"E	2011593.1698, 6911993.6047	2011512.6482, 6912088.4785
C2	600.00	246.06	S59° 38' 38"E	2011394.6101, 6912219.0921	2011271.1272, 6912429.9325
C3	1000.00	185.36	S76° 46' 12"E	2011149.0006, 6912792.6622	2011106.6398, 6912972.8431

ALIGNMENT LINE DATA				
LINE #	LENGTH	BEARING	START POINT	END POINT
L1	81.52	S51° 27' 39"E	2011643.9609, 6911929.8412	2011593.1698, 6911993.6047
L2	176.05	S47° 53' 43"E	2011512.6482, 6912088.4785	2011394.6101, 6912219.0921
L3	382.74	S71° 23' 32"E	2011271.1272, 6912429.9325	2011149.0006, 6912792.6622
L4	32.79	S82° 04' 48"E	2011106.6398, 6912972.8431	2011102.1222, 6913005.3167
L5	50.63	N18° 35' 57"E	2011231.6578, 6912547.1612	2011279.6476, 6912563.3109
L6	12.63	N18° 26' 24"E	2011279.6476, 6912563.3109	2011291.6253, 6912567.3046
L7	20.13	N0° 32' 57"E	2011291.6253, 6912567.3046	2011311.7502, 6912567.4975
L8	36.53	N0° 16' 57"E	2011311.7502, 6912567.4975	2011348.2746, 6912567.6775

CONTROL TABLE				
CONTROL NUMBER	NORTHING	EASTING	ELEVATION	DESCRIPTION
1	2011196.654	6912592.631	2173.036	CP OAK HILL 1
2	2011335.7243	6912339.8431	2167.42	CP OAK HILL 2
11	2011473.2703	6912101.0036	2154.75	CP
14	2011729.4783	6911781.9800	2129.14	AUX CP
16	2011128.6300	6912953.7100	2176.33	AUX CP
17	2011373.1600	6912430.6700	2179.34	AUX CP
22	2011351.6530	6912629.2712	2178.88	CP 10IN

△ DENOTES TARGET LOCATION AND ELEVATION

HORIZONTAL DATUM

BEARINGS, DISTANCES, STATIONING AND COORDINATES SHOWN ARE ON THE CALIFORNIA STATE COORDINATE SYSTEM, NAD 83 ZONE 2 (1991.35)
DISTANCES SHOWN ARE GRID DISTANCES. DIVIDE DISTANCES SHOWN BY 0.99984031 TO OBTAIN GROUND DISTANCES.

VERTICAL DATUM

ELEVATIONS SHOWN HEREON ARE REFERENCED TO NGVD 29 FROM GPS OBSERVATIONS

REVISION	NUMBER	DATE	DESCRIPTION	BY



PREPARED UNDER THE SUPERVISION OF:
Loren A. Massey
PROFESSIONAL LAND SURVEYOR
DATE: _____

DESIGNED: MS
DRAWN: RR
CHECKED: TL
DATE: 06/04/13
ROAD NUMBER: 77 / 31



COUNTY OF EL DORADO, CA
COMMUNITY DEVELOPMENT AGENCY
TRANSPORTATION DIVISION

PLEASANT VALLEY ROAD AT
OAK HILL ROAD
INTERSECTION IMPROVEMENTS

SHEET
CD-1
2 OF 17
W.D. No. 73358

SURVEY AND CONTROL DIAGRAM
SCALE : 1" = 40'

ORIGINAL SCALE IS IN INCHES
 Drawing name: C:\Civil 3D Projects\73358 Pleasant Vv at Oak Hill\CADD Files\Sheets\X-1.dwg
 Layout Tab: X-1 Jun 10, 2013 10:13am BRichards
 FOR REDUCED PLANS

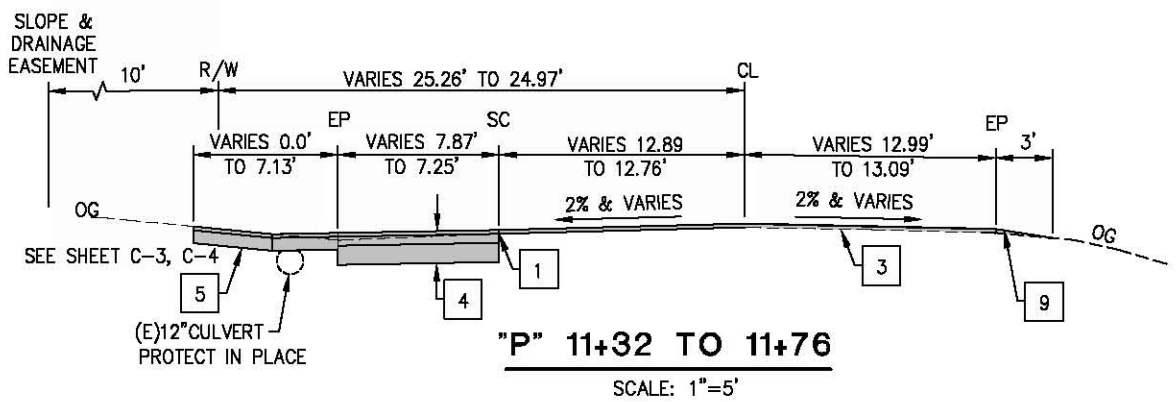
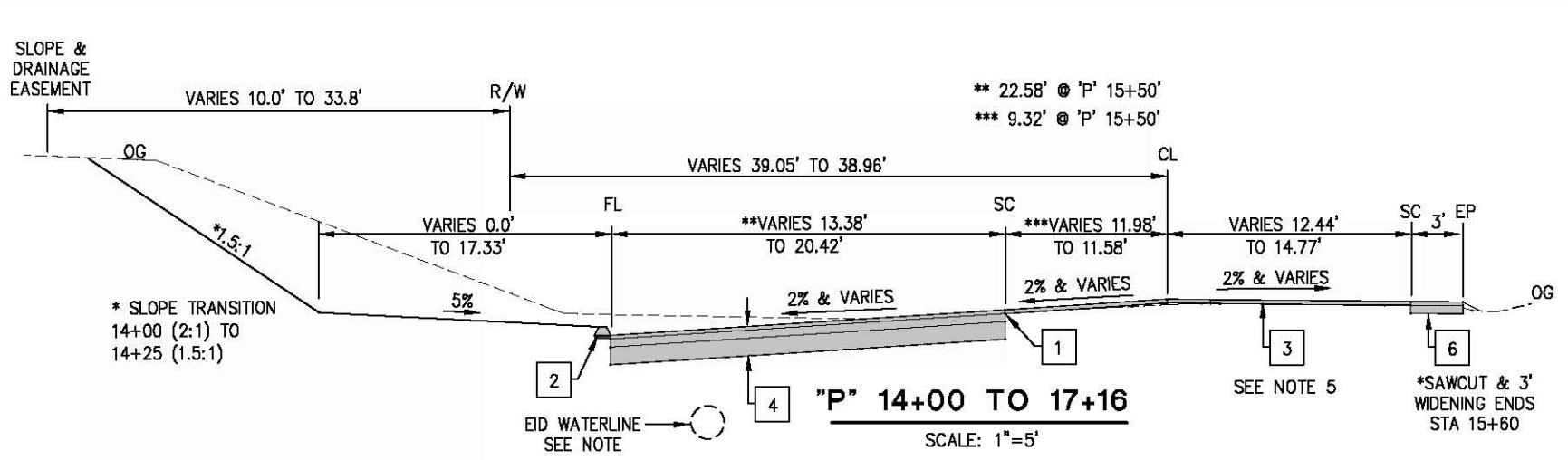
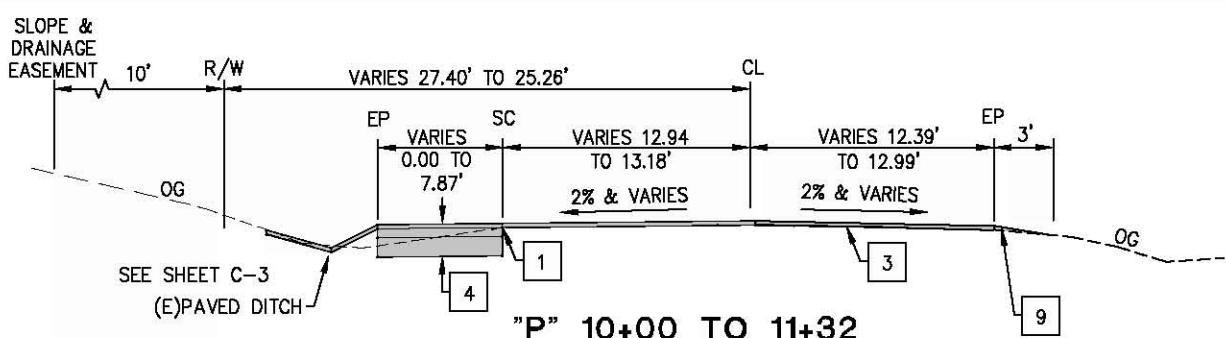

ABBREVIATIONS:

- EP —EDGE OF PAVEMENT
- CL —CENTERLINE
- FL —FLOWLINE
- SC —SAWCUT
- OG —ORIGINAL GROUND

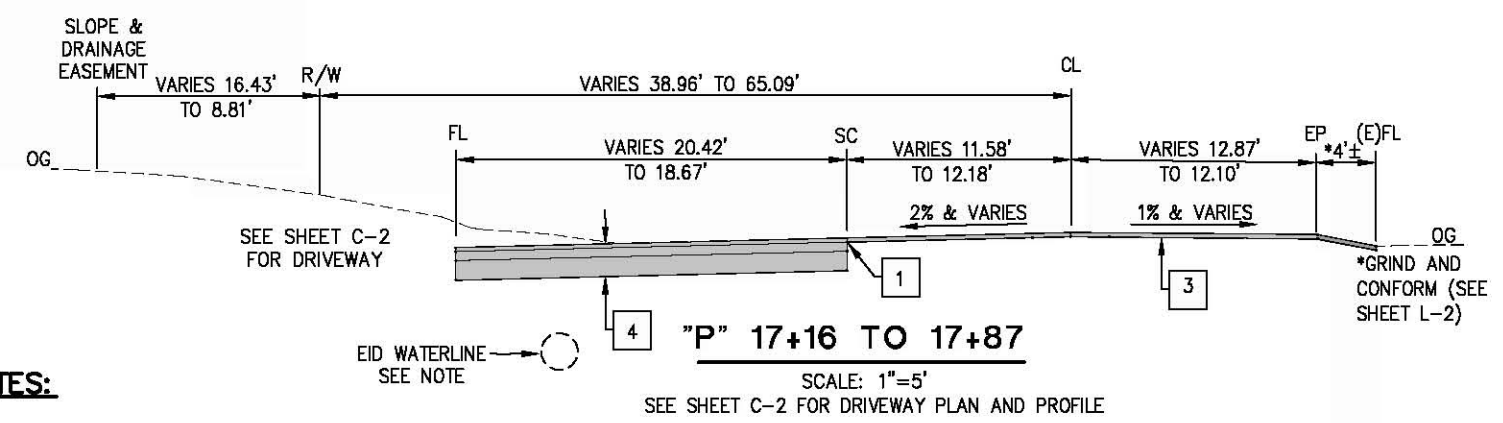

CONSTRUCTION NOTES:

- 1 — SAWCUT ALONG EXISTING ETW
- 2 — HMA DIKE (TYPE A)
- 3 — 0.20' HMA (TYPE A) OVERLAY
- 4 — 0.67' HMA (TYPE A) [INCLUDING OVERLAY]
1.0' AB (CLASS 2)
- 5 — 0.25' HMA (TYPE A) SEE SHEET C-3, C-4
0.67' AB (CLASS 2)
- 6 — 0.45' HMA (TYPE A) (SEE SC SHEETS)
DOES NOT INCLUDE FINAL 0.20' OVERLAY.
- 7 — SHOULDER BACKING
- 8 — HMA SHOULDER
- 9 — SHOULDER BACKING

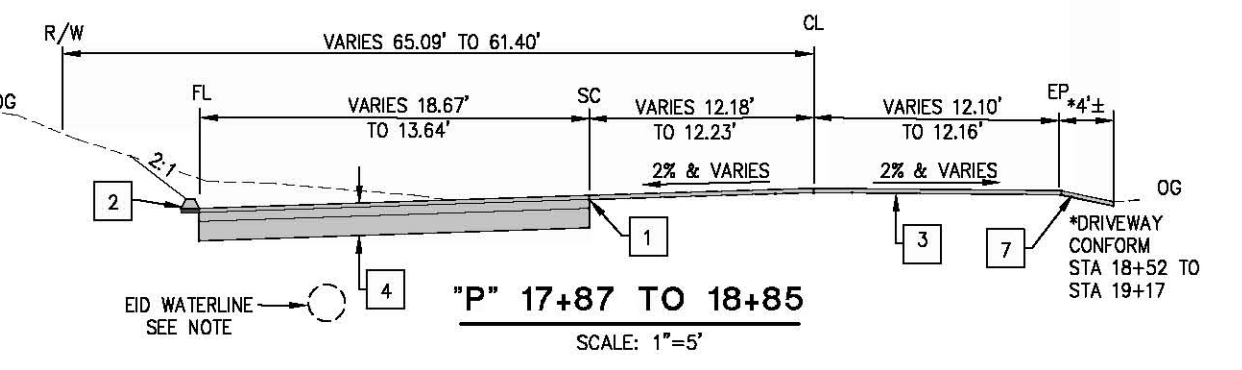
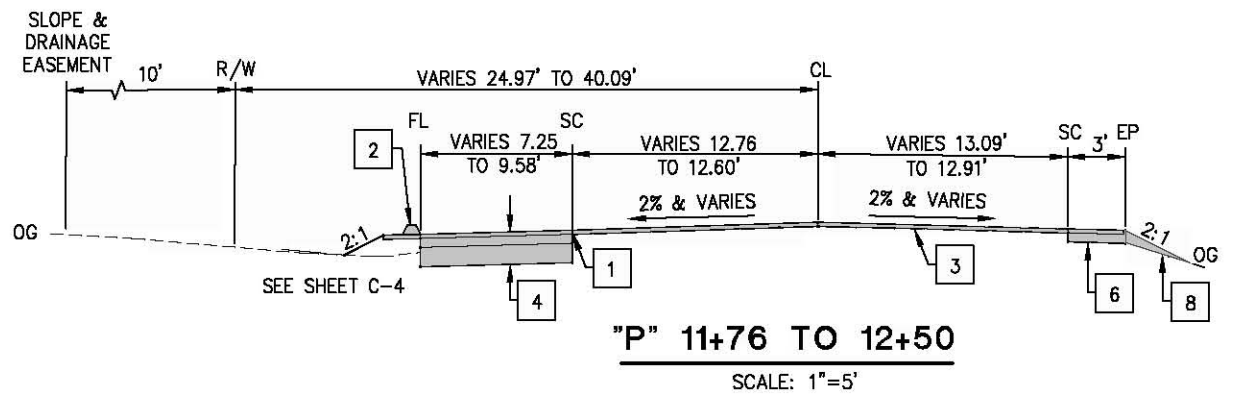

GENERAL NOTES:

1. HMA OVERLAY AND NEW PAVEMENT SECTIONS SHALL MATCH EXISTING CROSS SLOPE OF ROAD.
2. CUT OR FILL SLOPES SHALL BE 2:1 OR FLATTER.
3. EXISTING EID WATERLINE IS 4'± IN DEPTH, STATION 15+60 TO 18+00.
4. SEE SC-1 FOR TEMPORARY PAVING OF RIGHT SHOULDER FROM STATION 10+00 TO 11+76.
5. SEE L-1 FOR HMA VARIABLE THICKNESS FROM STATION 14+75 TO 15+75. CONCURRENT HMA WITH OVERLAY FOR ENTIRE ROADWAY.

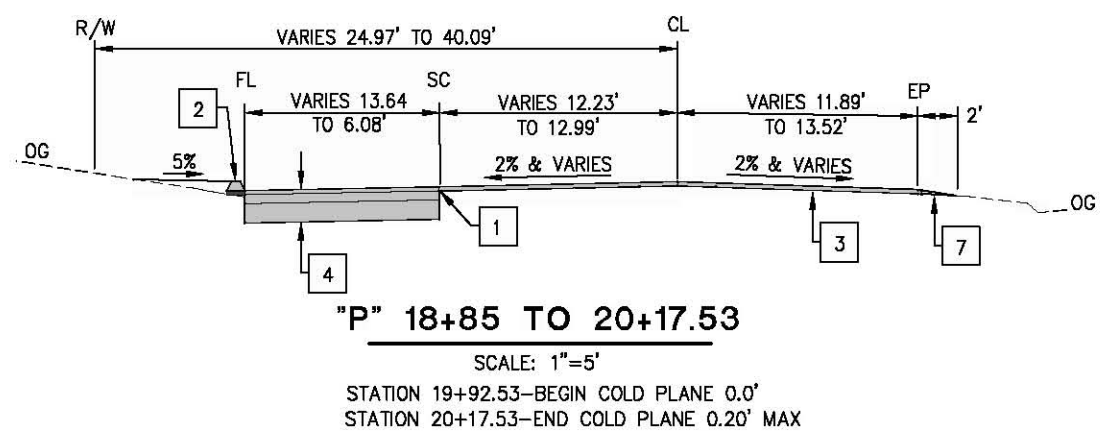
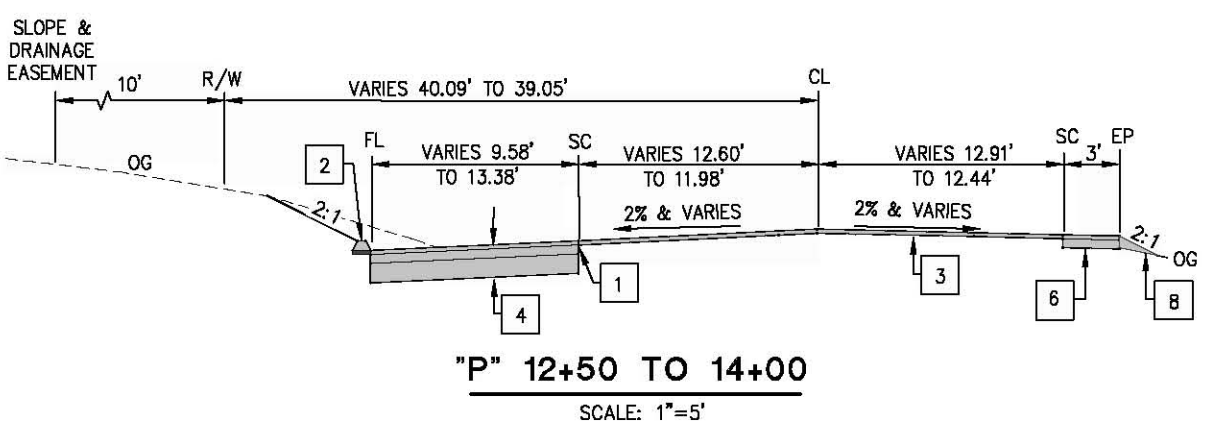

TYPICAL SECTIONS
SCALE : AS NOTED

REVISION	NUMBER	DATE	DESCRIPTION	BY



PREPARED UNDER THE SUPERVISION OF:
Msaed
 REGISTERED CIVIL ENGINEER

DESIGNED: MS RR
 CHECKED: TL DATE: 06/10/13
 ROAD NUMBER: 77 / 31

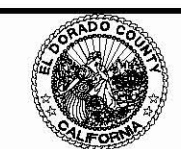

COUNTY OF EL DORADO, CA
 COMMUNITY DEVELOPMENT AGENCY
 TRANSPORTATION DIVISION

PLEASANT VALLEY ROAD
 AT OAK HILL ROAD
 INTERSECTION IMPROVEMENTS

SHEET
X-1
 3 OF 17
 W.D. No. 73358

ORIGINAL SCALE IS IN INCHES
 Drawing name: C:\Civil 3D Projects\73358 Pleasant Vly at Oak Hill\CADD Files\Streets\L-1.dwg Layout Tab: L-1 Jun 10, 2013 1:15pm BRichards
 FOR REDUCED PLANS

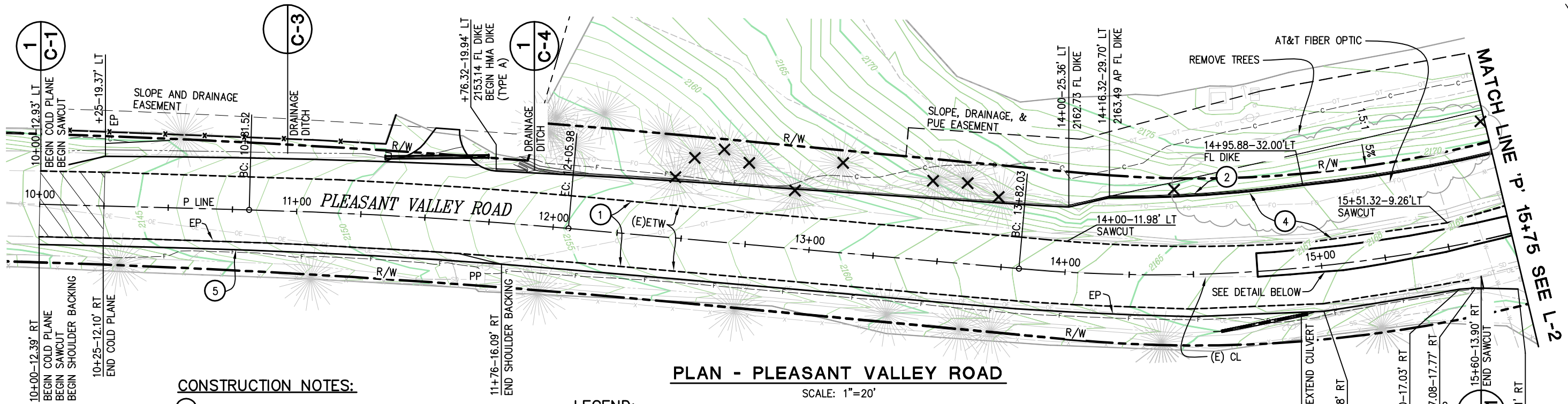

PLAN - PLEASANT VALLEY ROAD

SCALE: 1"=20'

CONSTRUCTION NOTES:

- ① - SAWCUT ON EXISTING ETW
- ② - HMA DIKE TYPE A
- ④ - 0.67' HMA (TYPE A)
1.0' AB (CLASS 2) [INCLUDING OVERLAY]
- ⑤ - TEMPORARY PAVED SHOULDER. SEE SC-1 SHEET FOR LIMITS.

LEGEND:

- X - REMOVE EXISTING TREES
- [Hatched Box] - 0.20' COLD PLANE AND CONFORM
- [Grey Box] - HMA VARIABLE THICKNESS

GENERAL NOTES:

1. STATION/OFFSETS PER P-LINE ALIGNMENT.
2. CONTRACTOR SHALL LOCATE ALL EXISTING UNDERGROUND UTILITIES BEFORE ANY EXCAVATION.

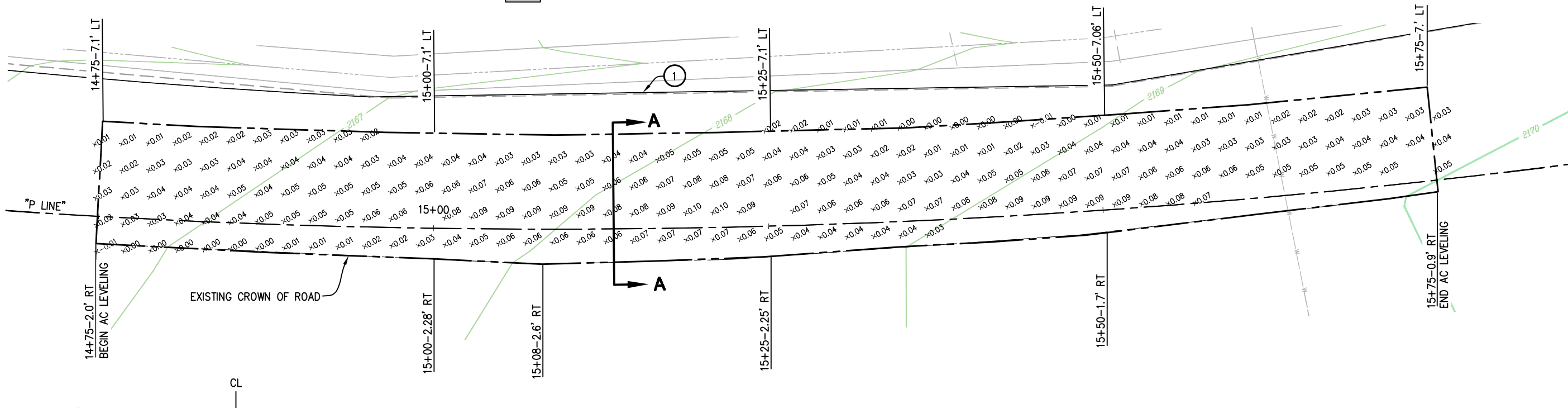

DETAIL-HMA VARIABLE THICKNESS

SCALE: 1"=4'H

x0.01 - AMOUNT OF LEVELING REQUIRED

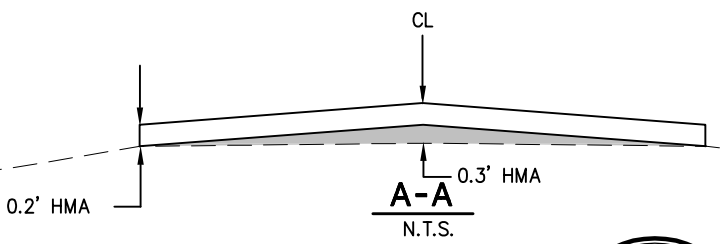

PREPARED UNDER THE SUPERVISION OF:
M Saed
 REGISTERED CIVIL ENGINEER

DESIGNED: MS
 DRAWN: RR
 CHECKED: TL
 DATE: 06/10/13
 ROAD NUMBER: 77 / 31



COUNTY OF EL DORADO, CA
 COMMUNITY DEVELOPMENT AGENCY
 TRANSPORTATION DIVISION

PLEASANT VALLEY ROAD AT
 OAK HILL ROAD
 INTERSECTION IMPROVEMENTS

LAYOUT
 SCALE : AS NOTED

SHEET
 L-1
 4 OF 17
 W.O. No. 73358

PLEASANT OAK BAPTIST CHURCH

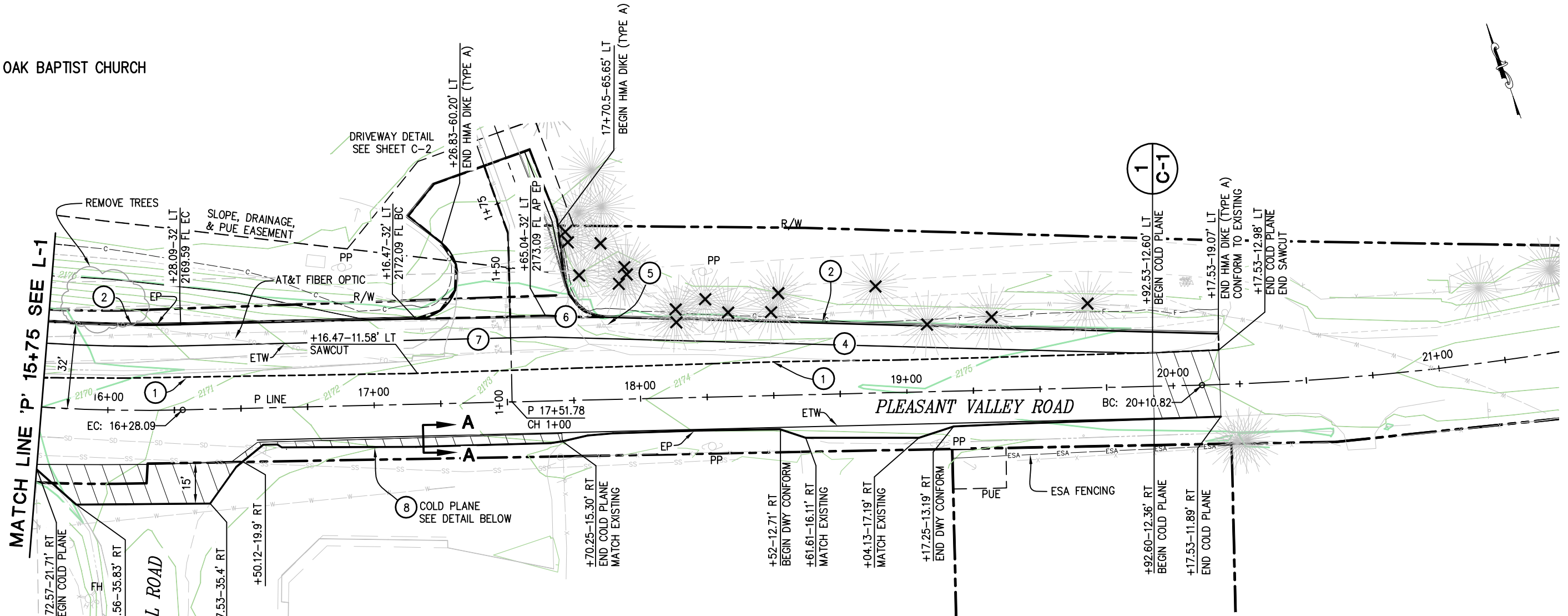

PLAN - PLEASANT VALLEY ROAD

SCALE: 1"=20'

GENERAL NOTE:

- 1. STATION/OFFSETS PER P-LINE ALIGNMENT.

CONSTRUCTION NOTES:

- ① — SAWCUT ON EXISTING ETW
- ② — HMA DIKE TYPE A
- ④ — 0.67' HMA (TYPE A) [INCLUDING OVERLAY]
1.0' AB (CLASS 2)
- ⑤ — RELOCATE ROAD SIGN, SEE SPD-2
- ⑥ — RELOCATE MAIL BOXES, SEE SPD-2
- ⑦ — ADJUST WATER VALVE COVERS TO GRADE BY OTHERS (3 TOTAL)
- ⑧ — COLD PLANE 0.20' AT (E) FL, STA 16+71 TO 17+70

LEGEND:

- X — REMOVE EXISTING TREES
- [Hatched Box] — 0.20' COLD PLANE AND CONFORM
- ESA--- — ENVIROMENTALLY SENSITIVE AREA FENCING
- PUE — PUBLIC UTILITY EASEMENT

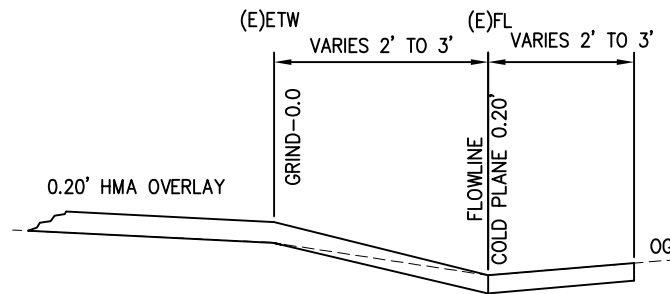

A-A
STATION 16+71 TO 17+70
N.T.S.

ORIGINAL SCALE IS IN INCHES
Drawing name: C:\Civil 3D\Projects\73358 Pleasant_Vy at Oak Hill\CADD_Files\Streets\L-2.dwg Layout Tab: L-2 Jun 11, 2013 11:26am BRichards
FOR REDUCED PLANS

REVISION	NUMBER	DATE	DESCRIPTION	BY



PREPARED UNDER THE SUPERVISION OF:
M Saed
REGISTERED CIVIL ENGINEER

DESIGNED: MS	DRAWN: RR
CHECKED: TL	DATE: 06/11/13
ROAD NUMBER: 77 / 31	



COUNTY OF EL DORADO, CA
COMMUNITY DEVELOPMENT AGENCY
TRANSPORTATION DIVISION

PLEASANT VALLEY ROAD AT
OAK HILL ROAD
INTERSECTION IMPROVEMENTS

LAYOUT
SCALE : 1" = 20'

SHEET	L-2
5 OF 17	
W.O. No.	73358

Drawing name: C:\Civil 3D Projects\73358 Pleasant Vly at Oak Hill\CADD Files\Sheets\C-1.dwg Layout Tab: C-1 Jun 05, 2013 1:31pm BRichards

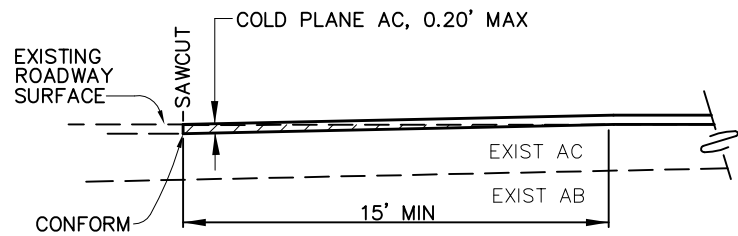

1 COLD PLANE CONFORM DETAIL
N.T.S.

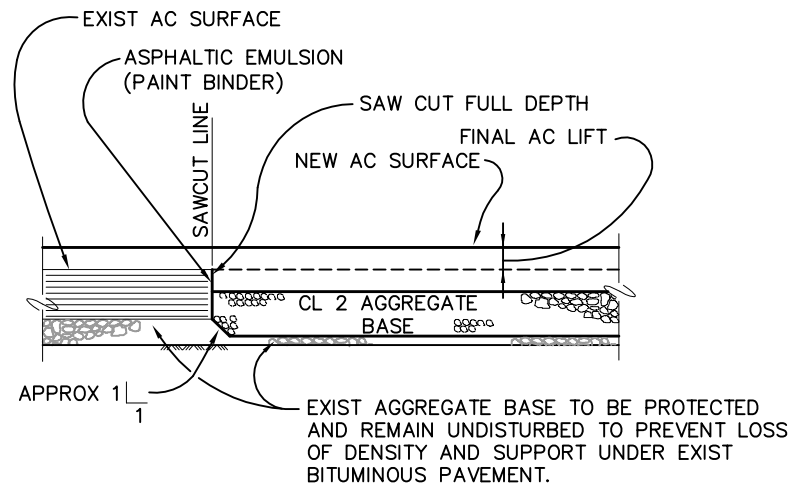

2 ASPHALT PAVEMENT JOINT DETAIL
N.T.S.

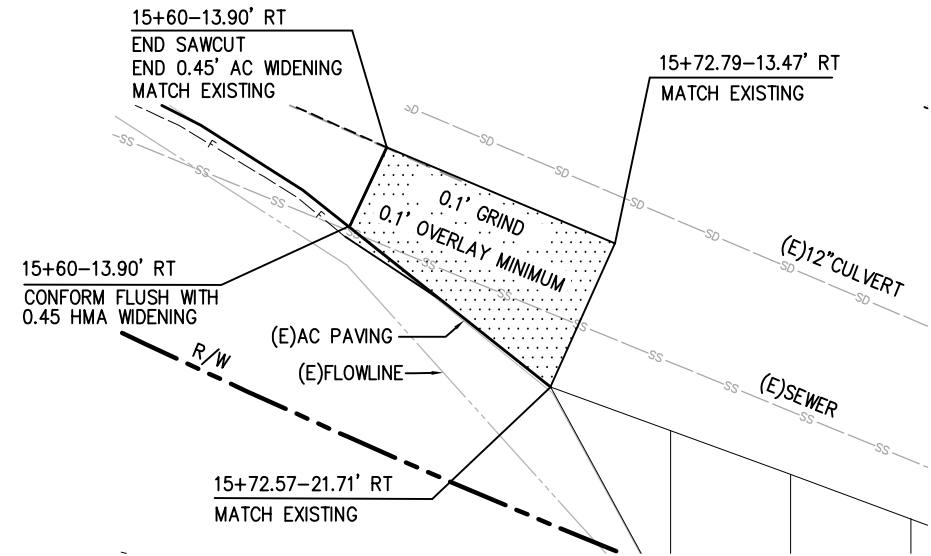

4 STAGE 1 CONFORM DETAIL
SCALE: 1"=5'

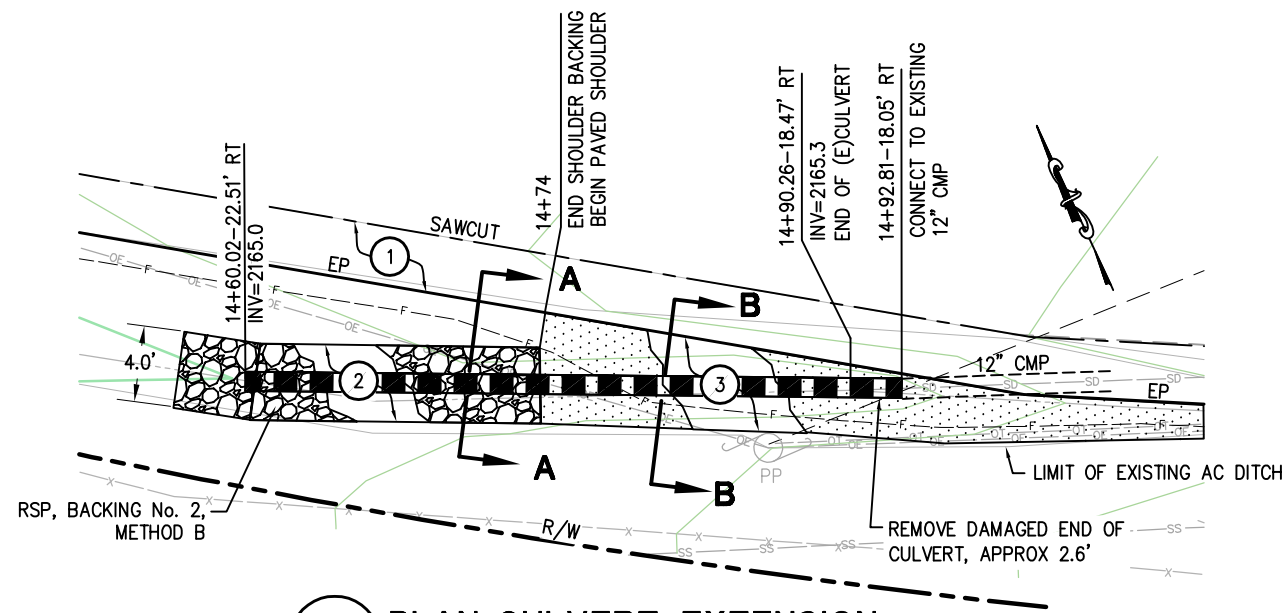

3 PLAN-CULVERT EXTENSION
SCALE: 1"=5'

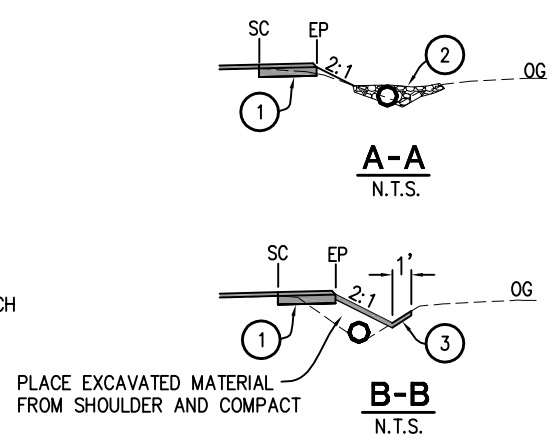

RSP-CULVERT EXTENSION
BACKING No.2 METHOD B

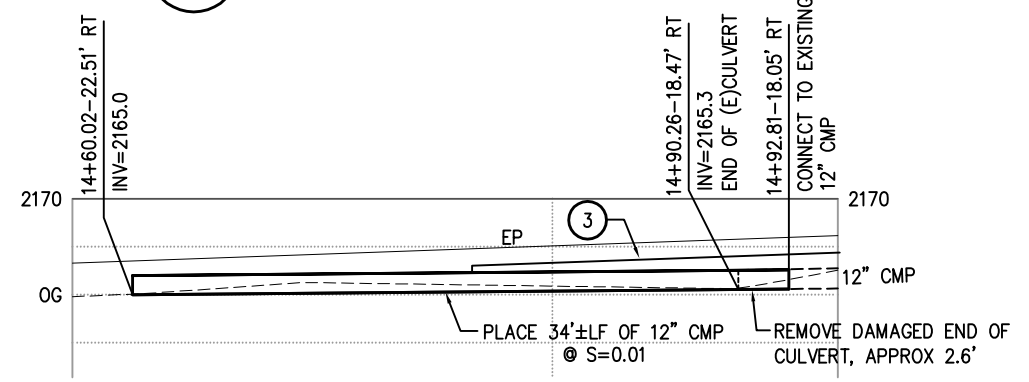

PROFILE-CULVERT EXTENSION
SCALE: 1"=5'H,V

CONSTRUCTION NOTES:

- ① — 0.45' HMA OVER COMPACTED NATIVE (EXCLUDING FINAL 0.20' OVERLAY)
- ② — RSP, BACKING No. 2, METHOD B (SEE RSP DETAIL) STA 14+56 TO 14+74
- ③ — 0.20' HMA OVER COMPACTED NATIVE STA 14+74 TO 15+60
- ④ — EXISTING CULVERT CROSSING OAK HILL ROAD SHALL BE CLEANED OF DEBRIS.

DRAINAGE PLAN SHEET NO.	12" CMP	REMOVE (E) 12" CMP	RSP (BACKING No. 2, METHOD B)	DESCRIPTION
C-1	LF	LF	CY	
	34	2.6	4	S=0.01
TOTAL	34	2.6	4	

DRAINAGE QUANTITY TABLE

CONSTRUCTION DETAILS
SCALE: 1" = 20'

REVISION	NUMBER	DATE	DESCRIPTION	BY



PREPARED UNDER THE SUPERVISION OF:
M Saed
REGISTERED CIVIL ENGINEER

DESIGNED: MS
DRAWN: RR
CHECKED: TL
DATE: 06/04/13
ROAD NUMBER: 77 / 31



COUNTY OF EL DORADO, CA
COMMUNITY DEVELOPMENT AGENCY
TRANSPORTATION DIVISION

PLEASANT VALLEY ROAD AT
OAK HILL ROAD
INTERSECTION IMPROVEMENTS

SHEET
C-1
6 OF 17
W.O. No. 73358

Drawing name: C:\Civil 3D Projects\73358 Pleasant Vly at Oak Hill\CADD Files\Sheets\C-2.dwg Layout Tab: C-2 Jun 11, 2013 - 10:29am BRichards

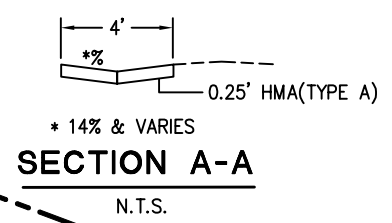
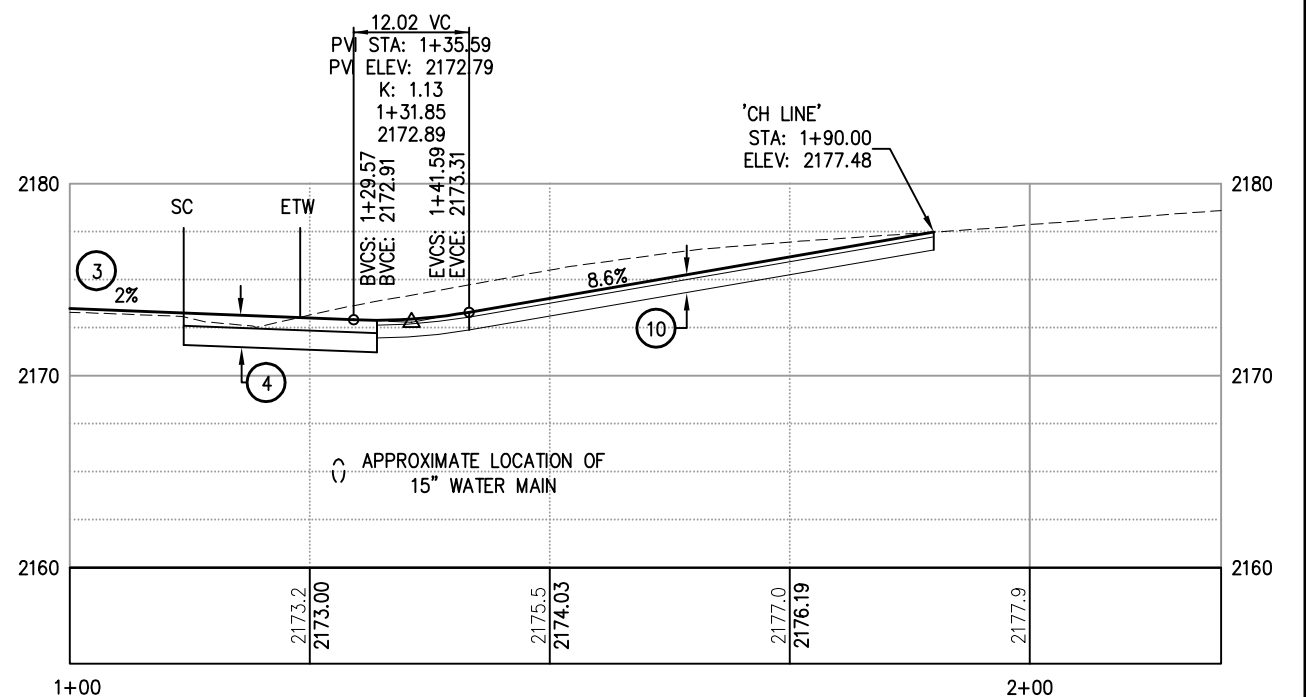
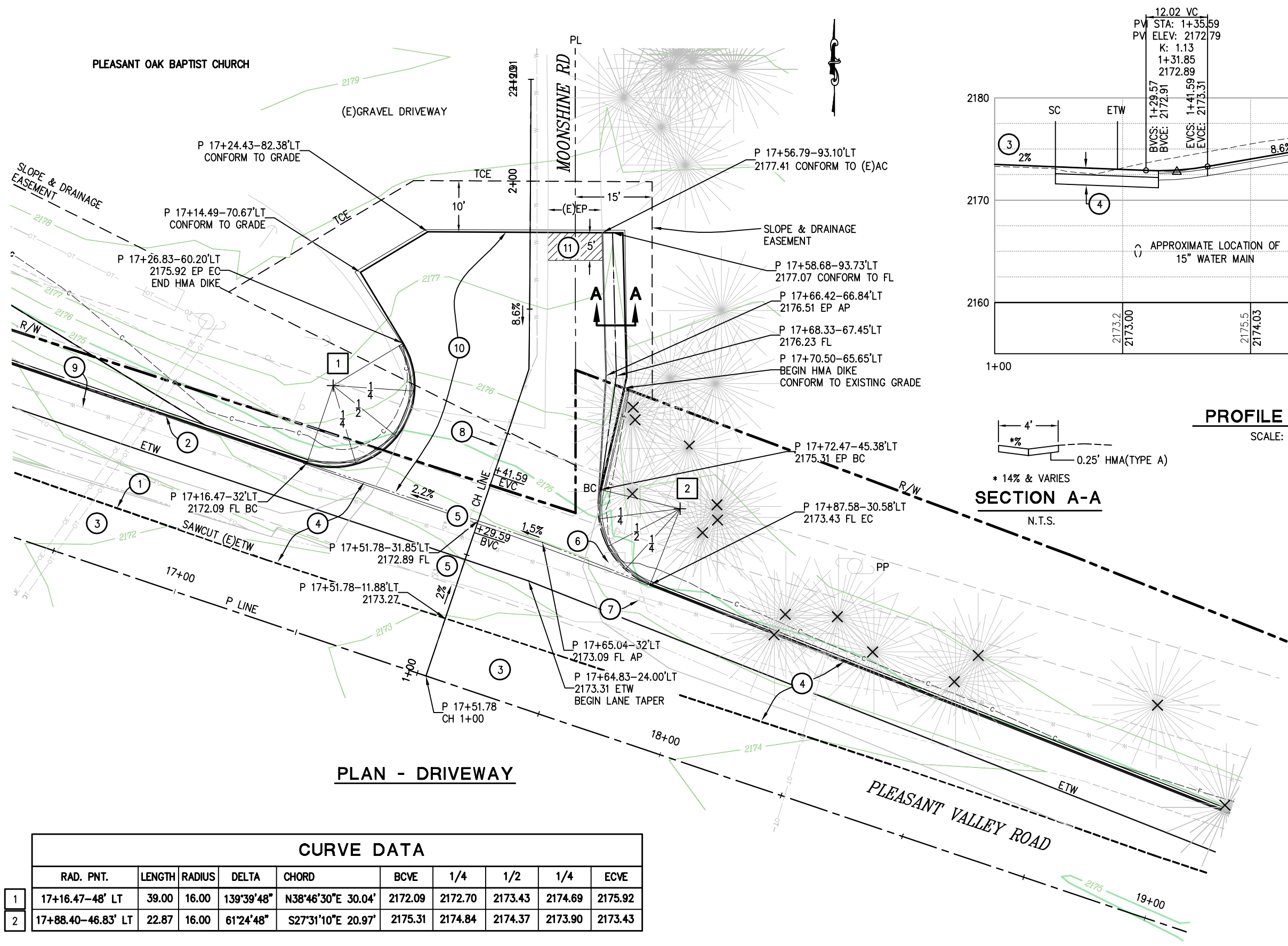

PROFILE - CH LINE
SCALE: 1"=5V,10'H

- LEGEND:**
- ✕ — TREES TO BE REMOVED (SEE LAYOUT SHEETS FOR ADDITIONAL TREES)

GENERAL NOTE:

1. STATION OFFSET CALLOUTS PER P LINE ALIGNMENT.

- CONSTRUCTION NOTES:**
- ① — SAWCUT ON EXISTING ETW
 - ② — TYPE A HMA DIKE
 - ③ — 0.20' HMA (TYPE A) OVERLAY
 - ④ — 0.67' HMA (TYPE A) [INCLUDING OVERLAY]
1.0' AB (CLASS 2)
 - ⑤ — ADJUST (3) WATER VALVES TO GRADE BY OTHERS
 - ⑥ — RELOCATE MAIL BOXES (SEE SHT SPD-2)
 - ⑦ — RELOCATE ROAD SIGN (SEE SHT SPD-2)
 - ⑧ — 8" EID WATERLINE (E). LOCATE BEFORE ANY EXCAVATION
 - ⑨ — 15" EID WATERLINE(E). LOCATE BEFORE ANY EXCAVATION
 - ⑩ — 0.25' HMA (TYPE A)
0.67' AB (CLASS 2)
 - ⑪ — GRIND AND CONFORM TO EXISTING AC

CURVE DATA

	RAD. PNT.	LENGTH	RADIUS	DELTA	CHORD	BCVE	1/4	1/2	1/4	ECVE
1	17+16.47-48' LT	39.00	16.00	139°39'48"	N38°46'30"E 30.04'	2172.09	2172.70	2173.43	2174.69	2175.92
2	17+88.40-46.83' LT	22.87	16.00	61°24'48"	S27°31'10"E 20.97'	2175.31	2174.84	2174.37	2173.90	2173.43

CONSTRUCTION DETAILS
SCALE: 1" = 10'

REVISION	NUMBER	DATE	DESCRIPTION	BY



PREPARED UNDER THE SUPERVISION OF:
M Saed
REGISTERED CIVIL ENGINEER

DESIGNED: MS
DRAWN: RR
CHECKED: TL
DATE: 06/11/13
ROAD NUMBER: 77 / 31



COUNTY OF EL DORADO, CA
COMMUNITY DEVELOPMENT AGENCY
TRANSPORTATION DIVISION

PLEASANT VALLEY ROAD AT
OAK HILL ROAD
INTERSECTION IMPROVEMENTS

SHEET
C-2
7 OF 17
W.O. No. **73358**

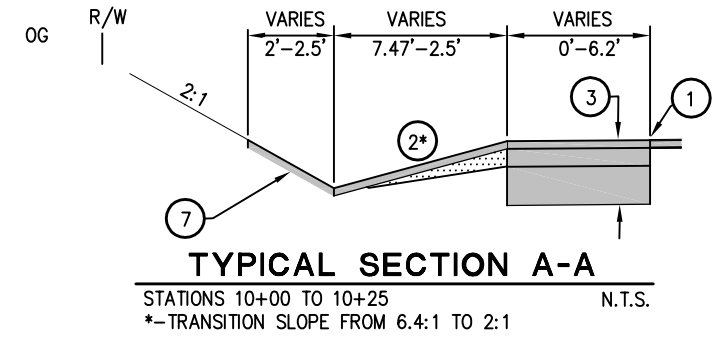
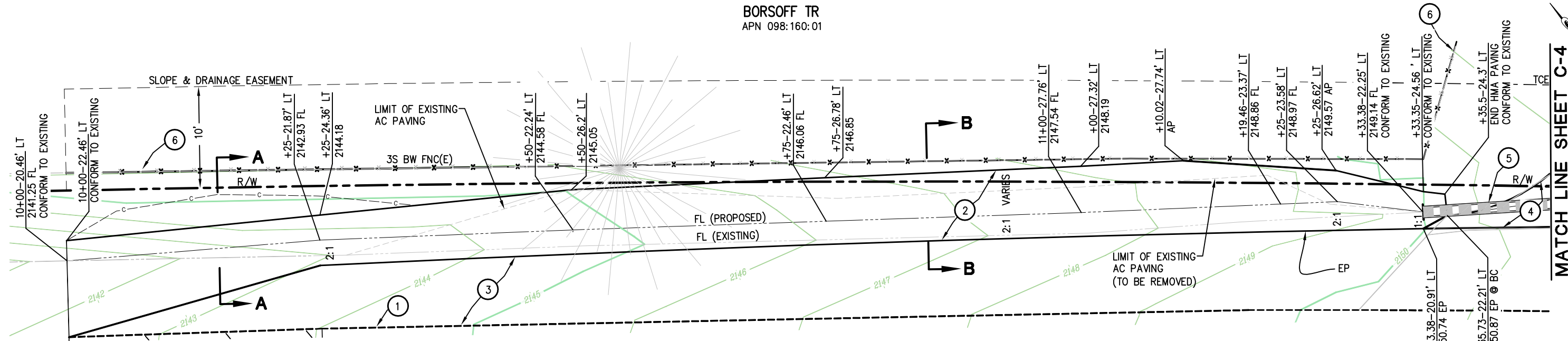

LEGEND:
 HMA DEEP LIFT TYPE A (TOTAL-5 CY)

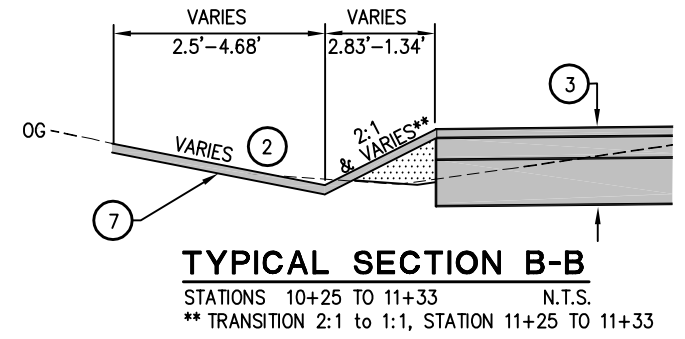

- GENERAL NOTE:**
1. STATION OFFSET CALLOUTS PER P LINE ALIGNMENT.
- CONSTRUCTION NOTES:**
- ① - SAWCUT ON EXISTING ETW
 - ② - 0.20' HMA (TYPE A)
 - ③ - 0.67' HMA (TYPE A) [INCLUDING OVERLAY]
1.0' AB (CLASS 2)
 - ④ - 0.25' HMA (TYPE A)
0.67' AB (CLASS 2)
 - ⑤ - EXISTING 1.0' CMP CULVERT. PROTECT IN PLACE
 - ⑥ - NEW FENCING TO BE INSTALLED AT THE COMPLETION OF WORK. CONTRACTOR SHALL PLACE REFERENCE STAKES BEFORE REMOVING EXISTING FENCING. STATIONS 10+00 TO 11+35
 - ⑦ - APPLY TACK COAT BEFORE HMA PAVING

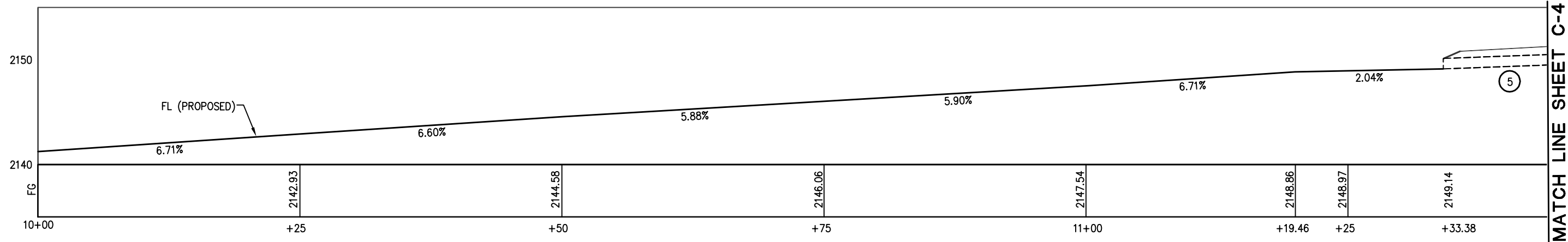

PROFILE - FLOWLINE DRAINAGE DITCH
SCALE: 1:5H,V

ORIGINAL SCALE IS IN INCHES
Drawing name: C:\Civil 3D\Projects\73358 Pleasant Valley at Oak Hill\CADD Files\Sheets\C-3.dwg Layout Tab: C-3 Jun 11, 2013 12:37pm BRichards

REVISION	NUMBER	DATE	DESCRIPTION	BY



PREPARED UNDER THE SUPERVISION OF:

 REGISTERED CIVIL ENGINEER

DESIGNED: MS
 DRAWN: RR
 CHECKED: TL
 DATE: 06/11/13
 ROAD NUMBER: 77 / 31



COUNTY OF EL DORADO, CA
 COMMUNITY DEVELOPMENT AGENCY
 TRANSPORTATION DIVISION

PLEASANT VALLEY ROAD AT
 OAK HILL ROAD
 INTERSECTION IMPROVEMENTS

SHEET
C-3
 8 OF 17
 W.O. No. 73358

ORIGINAL SCALE IS IN INCHES
 Drawing name: C:\Civil 3D Projects\73358 Pleasant Vly at Oak Hill\CADD Files\Streets\C-4.dwg Layout Tab: C-4 Jun 11, 2013 12:20pm BRichards
 FOR REDUCED PLANS

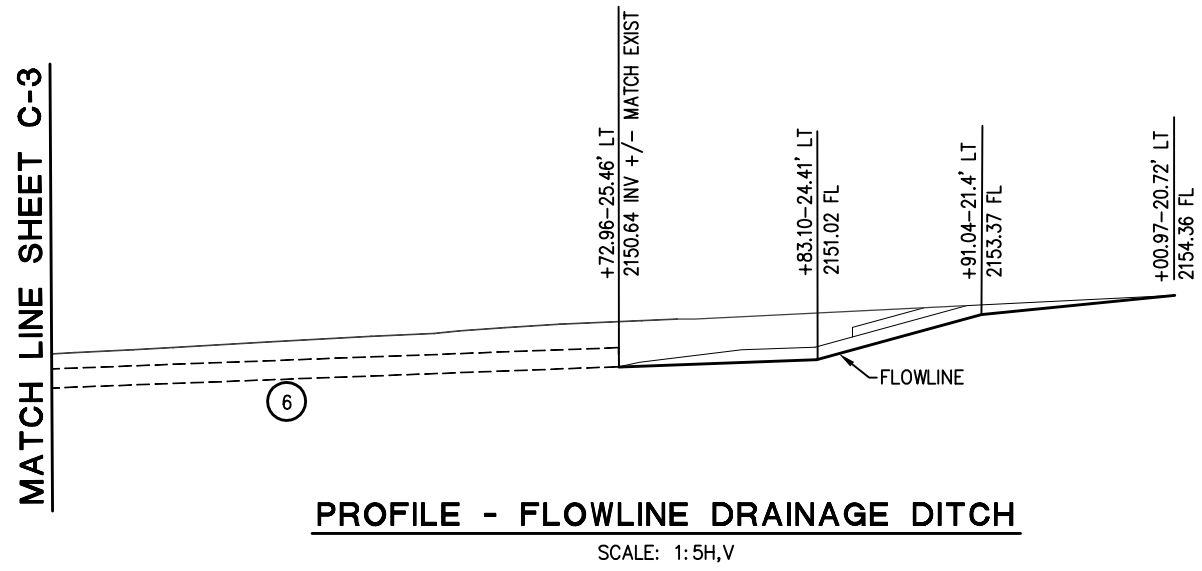
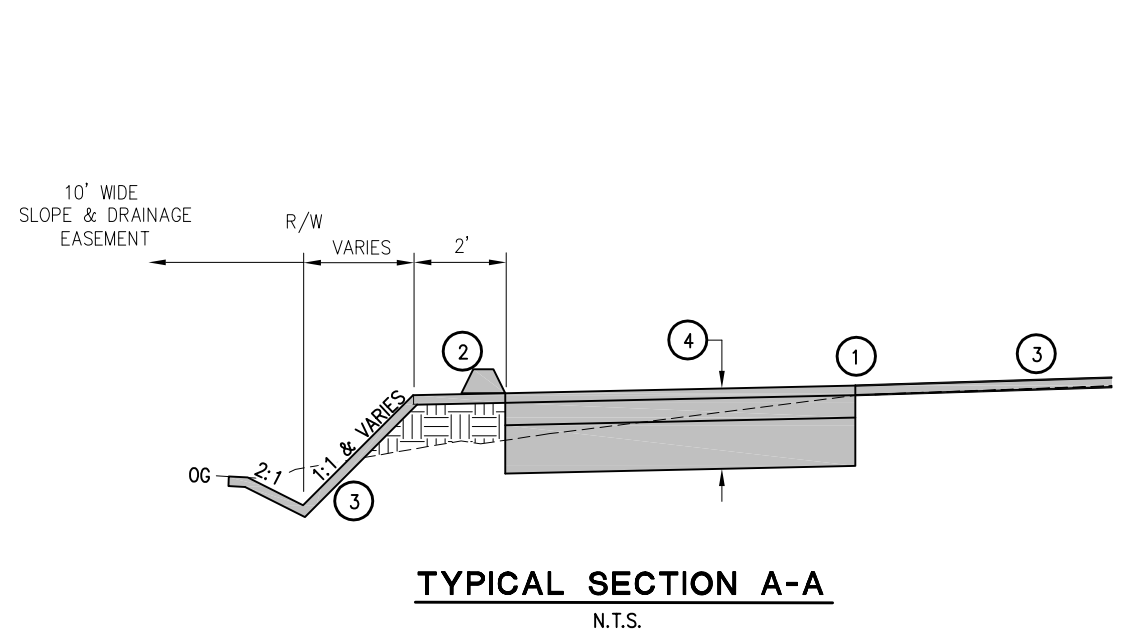
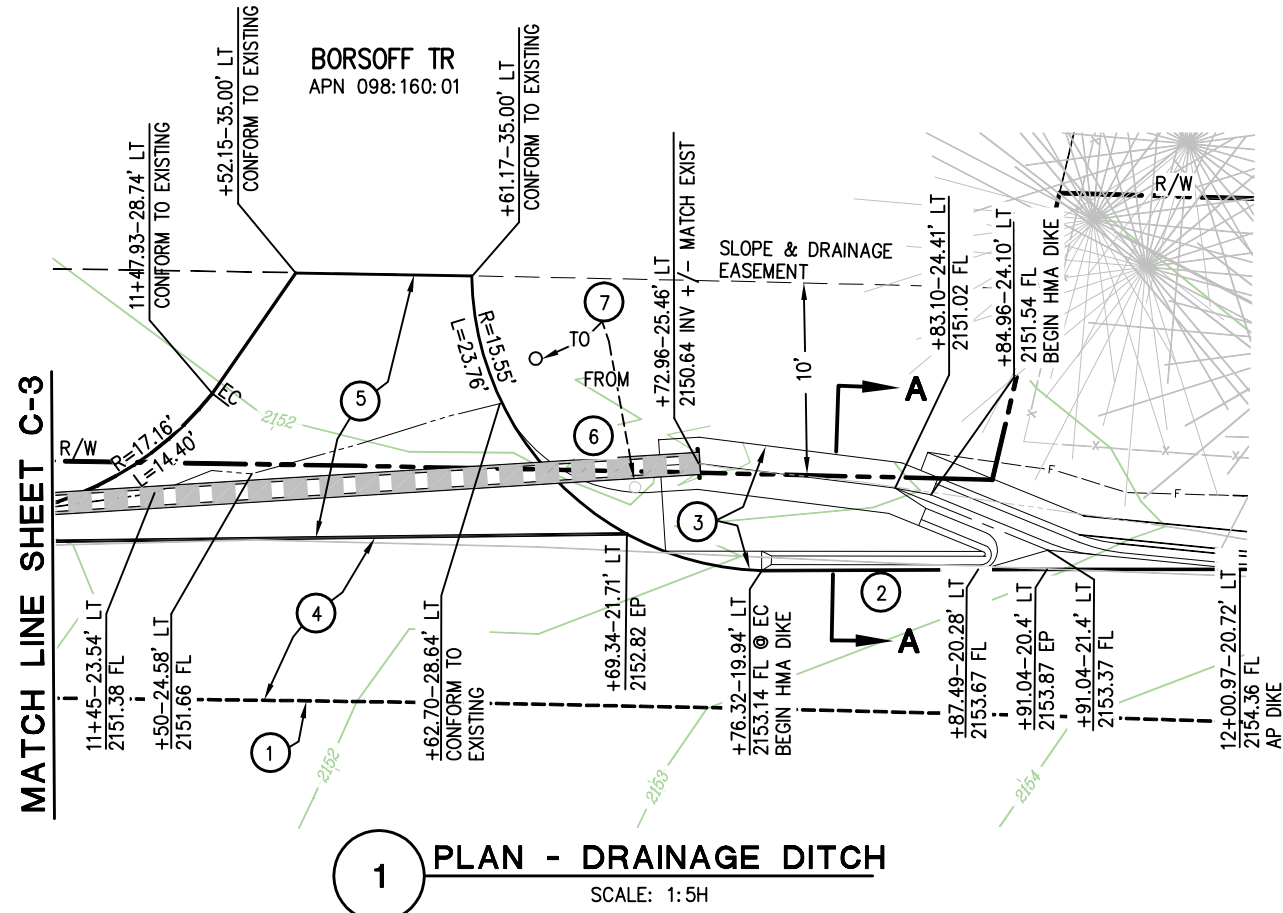

GENERAL NOTE:

- 1. STATION OFFSET CALLOUTS PER P LINE ALIGNMENT.

CONSTRUCTION NOTES:

- ① — SAWCUT ON EXISTING ETW
- ② — TYPE A HMA DIKE
- ③ — 0.20' HMA (TYPE A)
- ④ — 0.67' HMA (TYPE A) 1.0' AB (CLASS 2) [INCLUDING OVERLAY]
- ⑤ — 0.25' HMA (TYPE A) 0.67' AB (CLASS 2)
- ⑥ — EXISTING 1.0' CMP CULVERT. PROTECT IN PLACE.
- ⑦ — TEMPORARILY RELOCATE MAILBOX DURING CONSTRUCTION, RESET IN ORIGINAL LOCATION AT THE COMPLETION OF WORK. TEMPORARY LOCATION SHALL BE APPROVED BY USPS.

CONSTRUCTION DETAILS
SCALE : AS NOTED

REVISION	NUMBER	DATE	DESCRIPTION	BY



PREPARED UNDER THE SUPERVISION OF :
M Saed
 REGISTERED CIVIL ENGINEER

DESIGNED: MS
 DRAWN: RR
 CHECKED: TL
 DATE: 06/11/13
 ROAD NUMBER: 77 / 31



COUNTY OF EL DORADO, CA
 COMMUNITY DEVELOPMENT AGENCY
 TRANSPORTATION DIVISION

PLEASANT VALLEY ROAD AT
 OAK HILLS ROAD
 INTERSECTION IMPROVEMENTS

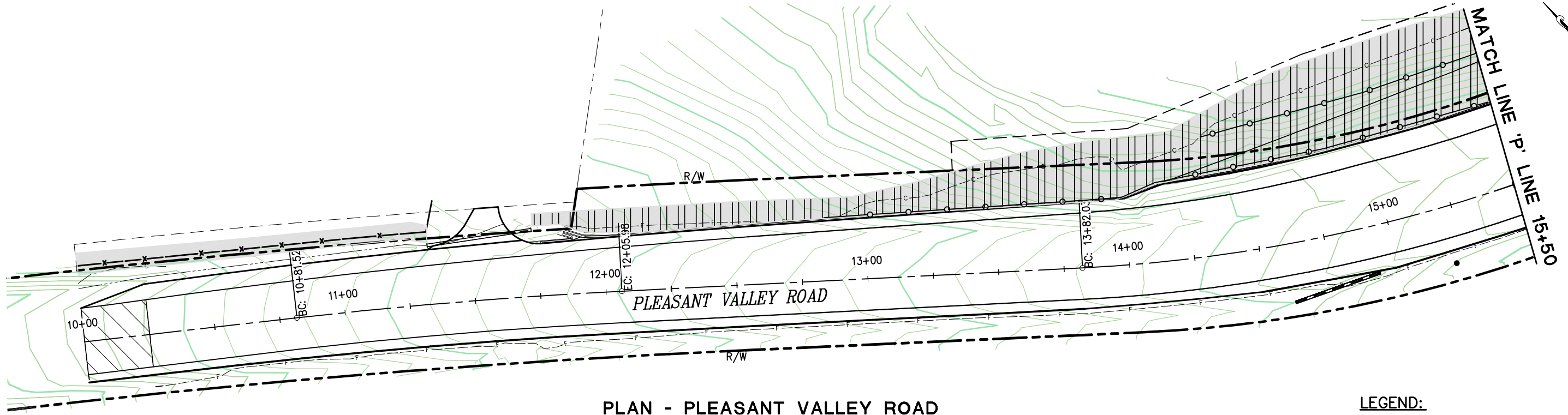

SHEET
C-4
 9 OF 17
 W.O. No. 73358

ORIGINAL SCALE IS IN INCHES
 Drawing name: C:\Civil 3D\Projects\73358 Pleasant_Vy at Oak Hill\CADD Files\Streets\EC-1.dwg Layout Tab: EC-1 Jun 05, 2013 - 9:58am BRichards

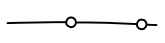

PLAN - PLEASANT VALLEY ROAD

LEGEND:

-  FIBER ROLL
-  EROSION CONTROL (TYPE D)
-  EROSION CONTROL BLANKET

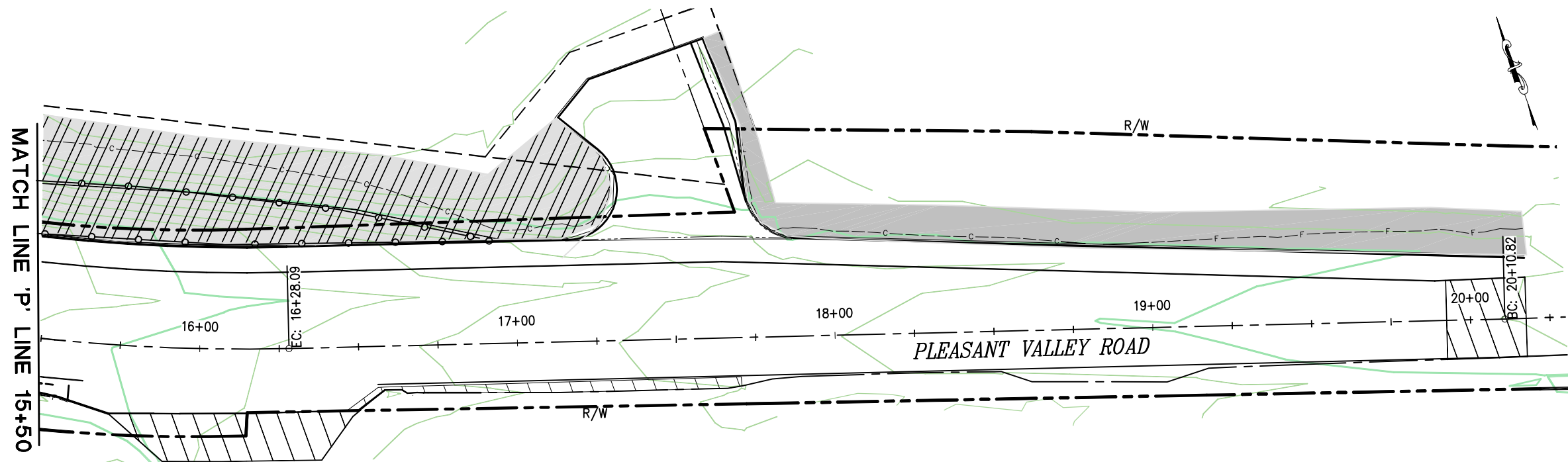

PLAN - PLEASANT VALLEY ROAD

CONSTRUCTION NOTES:

1. FIBER ROLLS TO BE INSTALLED LEVEL ON CONTOURS. LOCATIONS SHOWN ON THE PLAN ARE APPROXIMATE AND SHALL BE ADJUSTED AS REQUIRED DURING CONSTRUCTION.

**EROSION CONTROL
 SCALE : 1" = 20'**

REVISION	NUMBER	DATE	DESCRIPTION	BY



PREPARED UNDER THE SUPERVISION OF :
M Saed
 REGISTERED CIVIL ENGINEER

DESIGNED: MS
 DRAWN: RR
 CHECKED: TL
 DATE: 06/04/13
 ROAD NUMBER: 77 / 31



**COUNTY OF EL DORADO, CA
 COMMUNITY DEVELOPMENT AGENCY
 TRANSPORTATION DIVISION**

**PLEASANT VALLEY ROAD AT
 OAK HILL ROAD
 INTERSECTION IMPROVEMENTS**

SHEET
EC-1
 10 OF 17
 W.O. No. **73358**

Drawing name: C:\Civil 3D Projects\73358 Pleasant Vly at Oak Hill\CADD Files\Sheets\SC-1.dwg Layout Tab: SC-1 Jun 04, 2013 8:58am BRichards

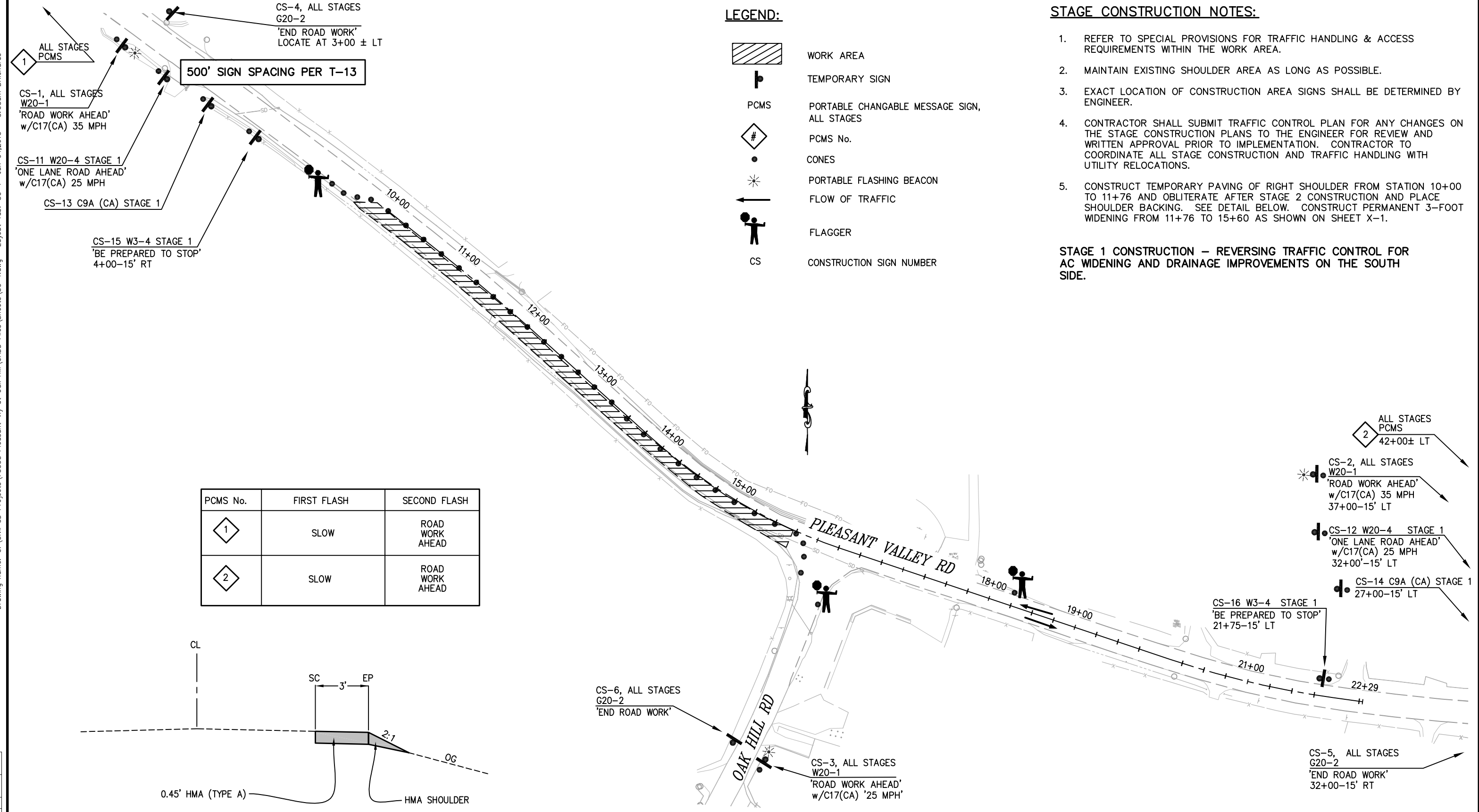

LEGEND:

- WORK AREA
- TEMPORARY SIGN
- PCMS
- PCMS No.
- CONES
- PORTABLE FLASHING BEACON
- FLOW OF TRAFFIC
- FLAGGER
- CS
- CONSTRUCTION SIGN NUMBER

STAGE CONSTRUCTION NOTES:

1. REFER TO SPECIAL PROVISIONS FOR TRAFFIC HANDLING & ACCESS REQUIREMENTS WITHIN THE WORK AREA.
2. MAINTAIN EXISTING SHOULDER AREA AS LONG AS POSSIBLE.
3. EXACT LOCATION OF CONSTRUCTION AREA SIGNS SHALL BE DETERMINED BY ENGINEER.
4. CONTRACTOR SHALL SUBMIT TRAFFIC CONTROL PLAN FOR ANY CHANGES ON THE STAGE CONSTRUCTION PLANS TO THE ENGINEER FOR REVIEW AND WRITTEN APPROVAL PRIOR TO IMPLEMENTATION. CONTRACTOR TO COORDINATE ALL STAGE CONSTRUCTION AND TRAFFIC HANDLING WITH UTILITY RELOCATIONS.
5. CONSTRUCT TEMPORARY PAVING OF RIGHT SHOULDER FROM STATION 10+00 TO 11+76 AND OBLITERATE AFTER STAGE 2 CONSTRUCTION AND PLACE SHOULDER BACKING. SEE DETAIL BELOW. CONSTRUCT PERMANENT 3-FOOT WIDENING FROM 11+76 TO 15+60 AS SHOWN ON SHEET X-1.

STAGE 1 CONSTRUCTION – REVERSING TRAFFIC CONTROL FOR AC WIDENING AND DRAINAGE IMPROVEMENTS ON THE SOUTH SIDE.

PCMS No.	FIRST FLASH	SECOND FLASH
1	SLOW	ROAD WORK AHEAD
2	SLOW	ROAD WORK AHEAD

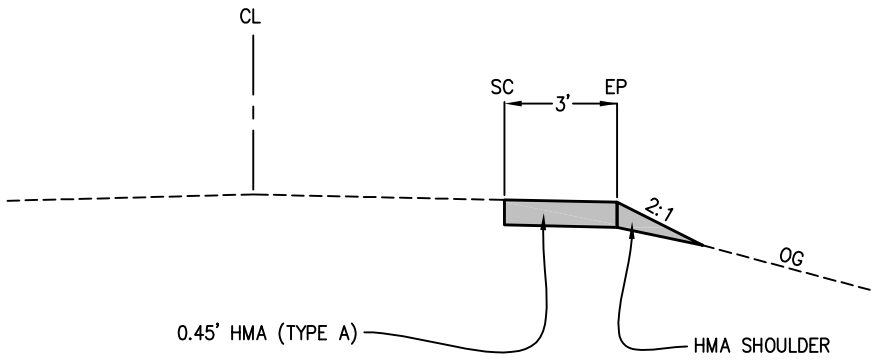

TEMPORARY PAVING OF RIGHT SHOULDER DETAIL
STATION 10+00 TO 11+76
N.T.S

PLAN - PLEASANT VALLEY ROAD









STAGE 1 CONSTRUCTION
SCALE : 1" = 50'

<p>REVISION</p> <table border="1" style="width: 100%; border-collapse: collapse;"> <tr> <th>NUMBER</th> <th>DATE</th> <th>DESCRIPTION</th> <th>BY</th> </tr> <tr> <td> </td> <td> </td> <td> </td> <td> </td> </tr> </table>	NUMBER	DATE	DESCRIPTION	BY						<p>PREPARED UNDER THE SUPERVISION OF :</p> <p><i>M Saed</i></p> <p>REGISTERED CIVIL ENGINEER</p>	DESIGNED: MS	DRAWN: RR	<p>COUNTY OF EL DORADO, CA COMMUNITY DEVELOPMENT AGENCY TRANSPORTATION DIVISION</p>	<p>PLEASANT VALLEY ROAD AT OAK HILL ROAD INTERSECTION IMPROVEMENTS</p>	<p>SHEET SC-1 11 OF 17 W.O. No. 73358</p>
	NUMBER	DATE	DESCRIPTION	BY											

Drawing name: C:\Civil 3D Projects\73358 Pleasant Vly at Oak Hill\CADD Files\Sheets\SC-2.dwg Layout Tab: SC-2 Jun 10, 2013 - 2:27pm BRichards

PCMS No.	FIRST FLASH	SECOND FLASH
1	SLOW	ROAD WORK AHEAD
2	SLOW	ROAD WORK AHEAD

LEGEND:

-  CONSTRUCT THIS STAGE
-  TEMPORARY SIGN
-  FLOW OF TRAFFIC
-  PORTABLE FLASHING BEACON
-  PCMS
-  PCMS No.
-  TEMPORARY RAIL (TYPE K)
-  TEMPORARY CRASH CUSHION ABSORB 350 OR EQUAL
-  CONES

STAGE CONSTRUCTION NOTES:

1. REFER TO SPECIAL PROVISIONS FOR TRAFFIC HANDLING & ACCESS REQUIREMENTS WITHIN THE WORK AREA.
2. MAINTAIN EXISTING SHOULDER AREA AS LONG AS POSSIBLE.
3. EXACT LOCATION OF CONSTRUCTION AREA SIGNS SHALL BE DETERMINED BY ENGINEER.
4. CONTRACTOR SHALL SUBMIT TRAFFIC CONTROL PLAN FOR ANY CHANGES ON THE STAGE CONSTRUCTION PLANS TO THE ENGINEER FOR REVIEW AND WRITTEN APPROVAL PRIOR TO IMPLEMENTATION. CONTRACTOR TO COORDINATE ALL STAGE CONSTRUCTION AND TRAFFIC HANDLING WITH UTILITY RELOCATIONS.
5. OBLITERATE PAVED SHOULDER FROM STATION 10+00 TO 11+76 AT THE COMPLETION OF STAGE 2 CONSTRUCTION AND PLACE SHOULDER BACKING.

STAGE 2 CONSTRUCTION - REMOVE EXISTING CL STRIPING PRIOR TO PLACING TEMPORARY PAVEMENT MARKERS. PLACE K-RAIL AND CRASH CUSHIONS. CONSTRUCT IMPROVEMENTS ON THE NORTH SIDE.

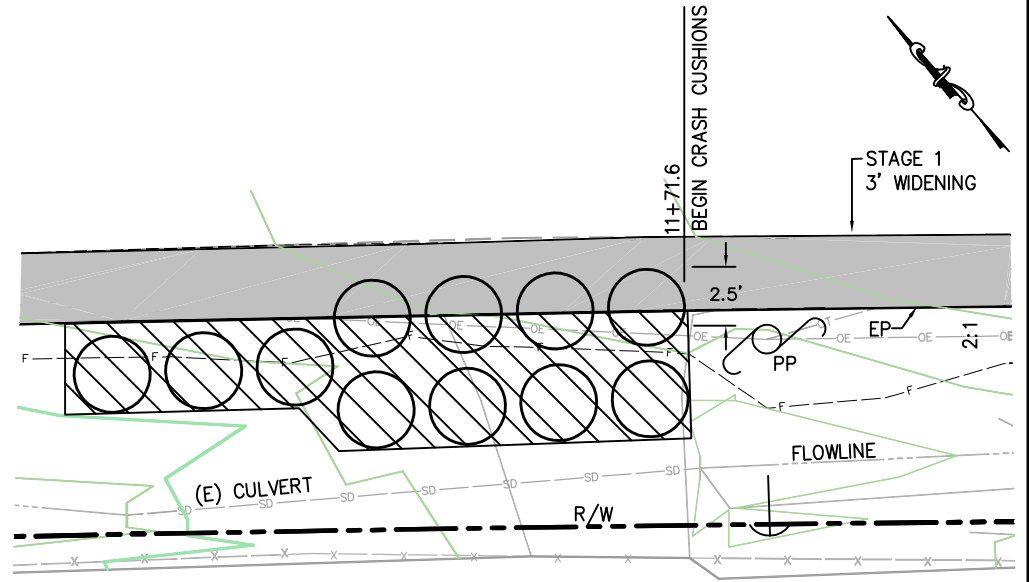
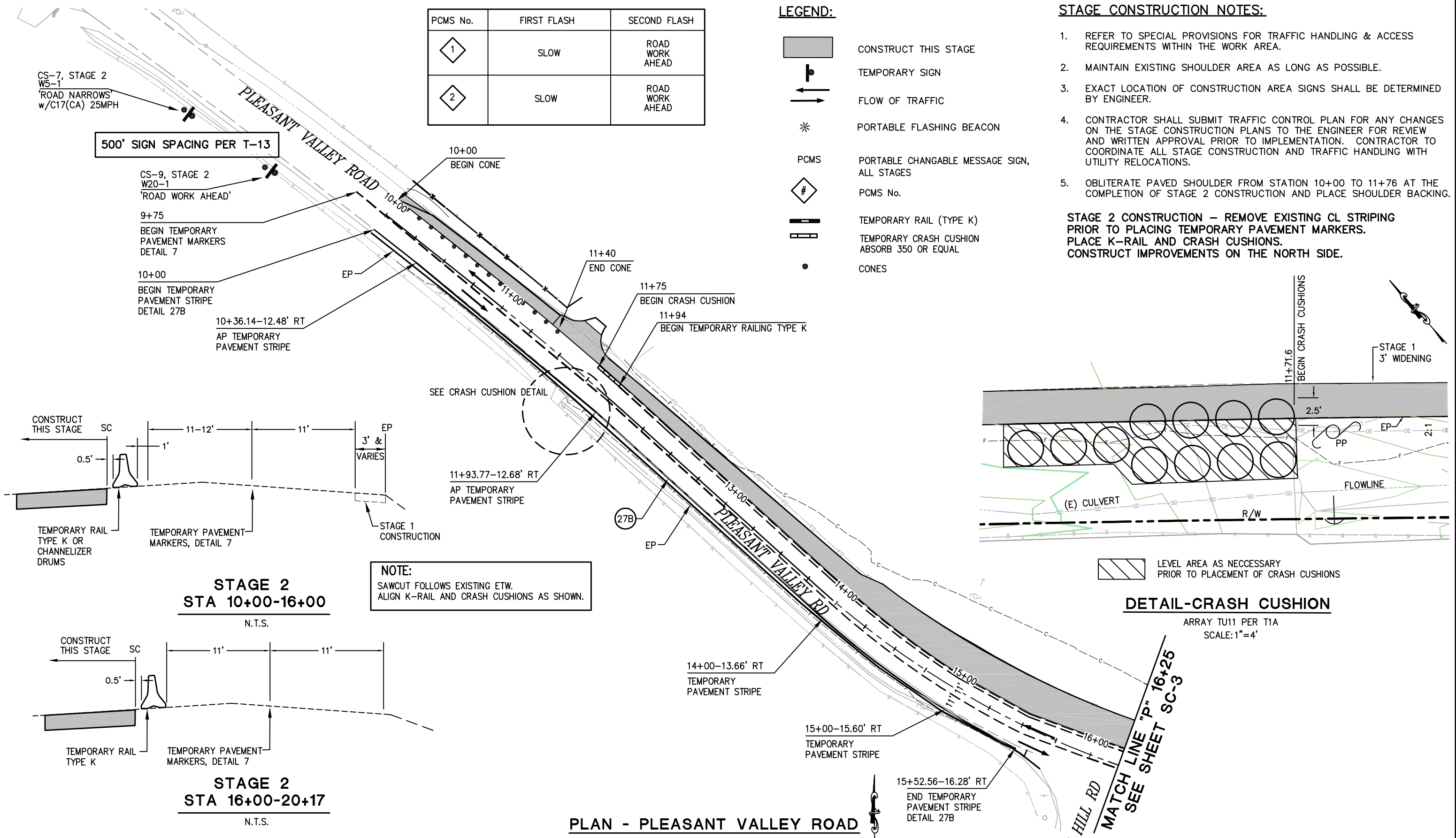

**STAGE 2
STA 10+00-16+00**
N.T.S.

**STAGE 2
STA 16+00-20+17**
N.T.S.

NOTE:
SAWCUT FOLLOWS EXISTING ETW.
ALIGN K-RAIL AND CRASH CUSHIONS AS SHOWN.

PLAN - PLEASANT VALLEY ROAD

DETAIL-CRASH CUSHION

ARRAY TU11 PER T1A
SCALE: 1"=4'

**STAGE 2 CONSTRUCTION
SCALE: 1" = 30'**

REVISION	NUMBER	DATE	DESCRIPTION	BY



PREPARED UNDER THE SUPERVISION OF:
M Saed
REGISTERED CIVIL ENGINEER

DESIGNED: MS
DRAWN: RR
CHECKED: TL
DATE: 06/04/13
ROAD NUMBER: 77 / 31



**COUNTY OF EL DORADO, CA
COMMUNITY DEVELOPMENT AGENCY
TRANSPORTATION DIVISION**









**PLEASANT VALLEY ROAD AT
OAK HILL ROAD
INTERSECTION IMPROVEMENTS**

SHEET
SC-2
12 OF 17
W.O. No. 73358

Drawing name: C:\Civil 3D Projects\73358 Pleasant Vly at Oak Hill\CADD Files\Sheets\SC-3.dwg Layout Tab: SC-3 Jun 04, 2013 - 11:29am BRichards

FOR REDUCED PLANS ORIGINAL SCALE IS IN INCHES

PCMS No.	FIRST FLASH	SECOND FLASH
1	SLOW	ROAD WORK AHEAD
2	SLOW	ROAD WORK AHEAD

- LEGEND:**
-  CONSTRUCT THIS STAGE
 -  TEMPORARY SIGN
 -  FLOW OF TRAFFIC
 -  TYPE II BARRICADE WITH FLASHING BEACON ALL STAGES
 -  PCMS
 -  PCMS No.
 -  TEMPORARY RAIL (TYPE K)
 -  TEMPORARY CRASH CUSHION ABSORB 350 OR EQUAL
 -  CONES

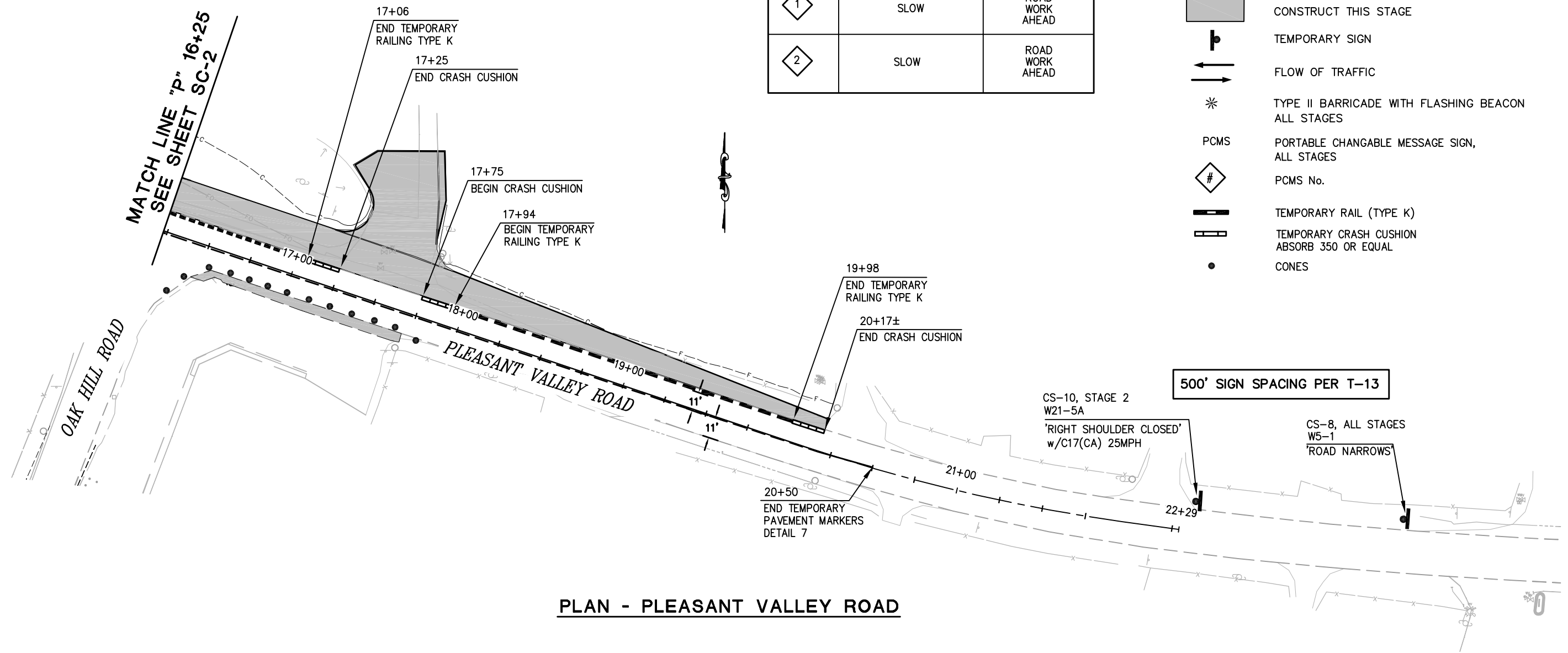

2
1
0

STAGE 2 CONSTRUCTION
SCALE : 1" = 30'

REVISION	NUMBER	DATE	DESCRIPTION	BY



PREPARED UNDER THE SUPERVISION OF:
M Saed
REGISTERED CIVIL ENGINEER

DESIGNED: MS
DRAWN: RR
CHECKED: TL
DATE: 06/04/13
ROAD NUMBER: 77 / 31



COUNTY OF EL DORADO, CA
COMMUNITY DEVELOPMENT AGENCY
TRANSPORTATION DIVISION

PLEASANT VALLEY ROAD AT
OAK HILL ROAD
INTERSECTION IMPROVEMENTS

SHEET
SC-3
13 OF 17
W.O. No. **73358**

Drawing name: C:\Civil 3D Projects\73358 Pleasant Vly at Oak Hill\CADD Files\Sheets\SC-4.dwg Layout Tab: SC-4 Jun 10, 2013 - 2:24pm BRichards
 ORIGINAL SCALE IS IN INCHES
 FOR REDUCED PLANS

TEMPORARY PAVEMENT MARKERS					
LOCATION	'P' LINE	PAVEMENT MARKER		DETAIL NO.	DESCRIPTION
		TWO WAY RETROREFLECTIVE TYPE D (EA)	NON REFLECTIVE TYPE AY (EA)		
PLEASANT VALLEY ROAD STA 10+00 - 20+50		46	92	7 - A20A	CENTERLINE 2 DIRECTION
TOTAL		46	92		

TEMPORARY CRASH CUSHIONS ARRAY TU11 PER T1A		
LOCATION	'P' LINE	EA.
STA 11+71.6 RT		11
TOTAL		11

TEMPORARY STRIPING DETAIL 27B PER A20B		
LOCATION	'P' LINE	L.F.
STA 10.00 RT TO 15+52 RT		552
TOTAL		552

CONSTRUCTION AREA SIGNS						
SIGN NO.	CONSTRUCTION STAGE	SIGN	CODE	PANEL SIZE INCHES	POST SIZE & LENGTH	INSTALL EA.
CS-1	ALL	ROAD WORK AHEAD	W20-1 w/ C17(CA)	36 x 36	4x4x12	1
CS-2	ALL	ROAD WORK AHEAD	W20-1 w/ C17(CA)	36 x 36	4x4x12	1
CS-3	ALL	ROAD WORK AHEAD	W20-1 w/ C17(CA)	36 x 36	4x4x12	1
CS-4	ALL	END ROAD WORK	G20-2	36 x 18	4x4x12	1
CS-5	ALL	END ROAD WORK	G20-2	36 x 18	4x4x12	1
CS-6	ALL	END ROAD WORK	G20-2	36 x 18	4x4x12	1
CS-7	STAGE 2	ROAD NARROWS	W5-1	36 x 36	4x4x12	1
CS-8	STAGE 2	ROAD NARROWS	W5-1	36 x 36	4x4x12	1
CS-9	STAGE 2	ROAD WORK AHEAD	W20-1	36 x 36	4x4x12	1
CS-10	STAGE 2	RIGHT SHOULDER CLOSED	W21-5A	36 x 36	4x4x12	1
CS-11	STAGE 1	ONE LANE ROAD AHEAD	W20-4 w/C17CA)	36 x 36	TEMPORARY	1
CS-12	STAGE 1	ONE LANE ROAD AHEAD	W20-4 w/C17CA)	36 x 36	TEMPORARY	1
CS-13	STAGE 1	FLAGGER	C9A	36 x 36	TEMPORARY	1
CS-14	STAGE 1	FLAGGER	C9A	36 x 36	TEMPORARY	1
CS-15	STAGE 1	BE PREPARED TO STOP	W3-4	36 x 36	TEMPORARY	1
CS-16	STAGE 1	BE PREPARED TO STOP	W3-4	36 x 36	TEMPORARY	1

TEMPORARY RAIL TYPE K SHALL INCLUDE TOP MOUNTED REFLECTORS		
LOCATION	'P' LINE	L.F.
PLEASANT VALLEY ROAD STA 11+94 - 17+06 STA 17+94 - 19+98		512 204
TOTAL		716

REMOVE PAVEMENT MARKER		
LOCATION	'P' LINE	EA.
PLEASANT VALLEY ROAD STA 10+00 - 20+50		138
TOTAL		138

TEMPORARY CRASH CUSHIONS ABSORB 350 OR EQUAL		
LOCATION	'P' LINE	EA.
STA 11+75 LT		1
STA 17+25 LT		1
STA 17+75 LT		1
STA 19+98 LT		1
TOTAL		4

STAGE CONSTRUCTION
SCALE : NONE

REVISION	NUMBER	DATE	DESCRIPTION	BY



PREPARED UNDER THE SUPERVISION OF :
M Saed
 REGISTERED CIVIL ENGINEER
 DATE: _____

DESIGNED: MS
 DRAWN: RR
 CHECKED: TL
 DATE: 06/10/13
 ROAD NUMBER: 77 / 31



COUNTY OF EL DORADO, CA
 COMMUNITY DEVELOPMENT AGENCY
 TRANSPORTATION DIVISION

PLEASANT VALLEY ROAD AT
 OAK HILL ROAD
 INTERSECTION IMPROVEMENTS

SHEET
SC-4
 14 OF 17
 W.O. No. 73358

Drawing name: C:\Civil 3D Projects\73358 Pleasant Vly at Oak Hill\CADD Files\Sheets\SPD-1.dwg Layout Tab: SPD-1 Jun 05,2013 - 10:08am BRichards

GENERAL NOTE:

1. STATION OFFSET CALLOUTS PER P ALIGNMENT.

LEGEND:

(22) PAVEMENT MARKING DETAIL

SIGNING AND STRIPING NOTES:

1. LOCATION OF SIGNS IS APPROXIMATE, EXACT LOCATION AND POSITION OF SIGNS, DELINEATORS, OBJECT MARKERS, AND RUMBLE STRIPS TO BE DETERMINED BY THE ENGINEER.
2. SIGN DESIGNATION, PAVEMENT MARKINGS AND ARROWS TO CONFORM TO THE CALIFORNIA MANUAL ON UNIFORM TRAFFIC CONTROL DEVICES.
3. STRIPING (MARKING) DETAIL NUMBERS DESIGNATED IN CIRCLES CORRESPOND TO CALIFORNIA DEPARTMENT OF TRANSPORTATION STANDARD PLANS DETAILS SHEETS A20-A, A20-B, AND A20-D, DATED MAY 2006.
4. SIGN POST LENGTHS GIVEN ARE APPROXIMATE. ACTUAL LENGTHS TO BE DETERMINED BY THE ENGINEER AFTER GRADING OPERATIONS ARE COMPLETED.
5. ALL STRIPING SHALL BE SPRAYED THERMOPLASTIC. ALL PAVEMENT MARKINGS, CROSSWALKS, AND LIMIT LINES, SHALL BE THERMOPLASTIC, UNLESS OTHERWISE NOTED.
6. VERIFY HORIZONTAL AND VERTICAL LOCATION OF EXISTING UTILITIES PRIOR TO SIGN POST INSTALLATION.
7. ALL EXISTING MARKERS WITHIN THE CONSTRUCTION AREA SHALL BE REMOVED AND SALVAGED UNLESS OTHERWISE NOTED.
8. THIS PLAN SHOWS ONLY PERMANENT CONSTRUCTION SIGNS DURING CONSTRUCTION. CONTRACTOR WILL PLACE ADDITIONAL CONSTRUCTION SIGNS FOR LANE CLOSURES OR TRAFFIC HANDLING DURING CONSTRUCTION IN ACCORDANCE WITH STANDARD PLANS AND SPECIFICATIONS.
9. ALL CONSTRUCTION SIGNS SHALL HAVE WOOD POSTS.
10. ALL PERMANENT SIGNS SHALL BE 0.08 INCH ALUMINUM PANELS.

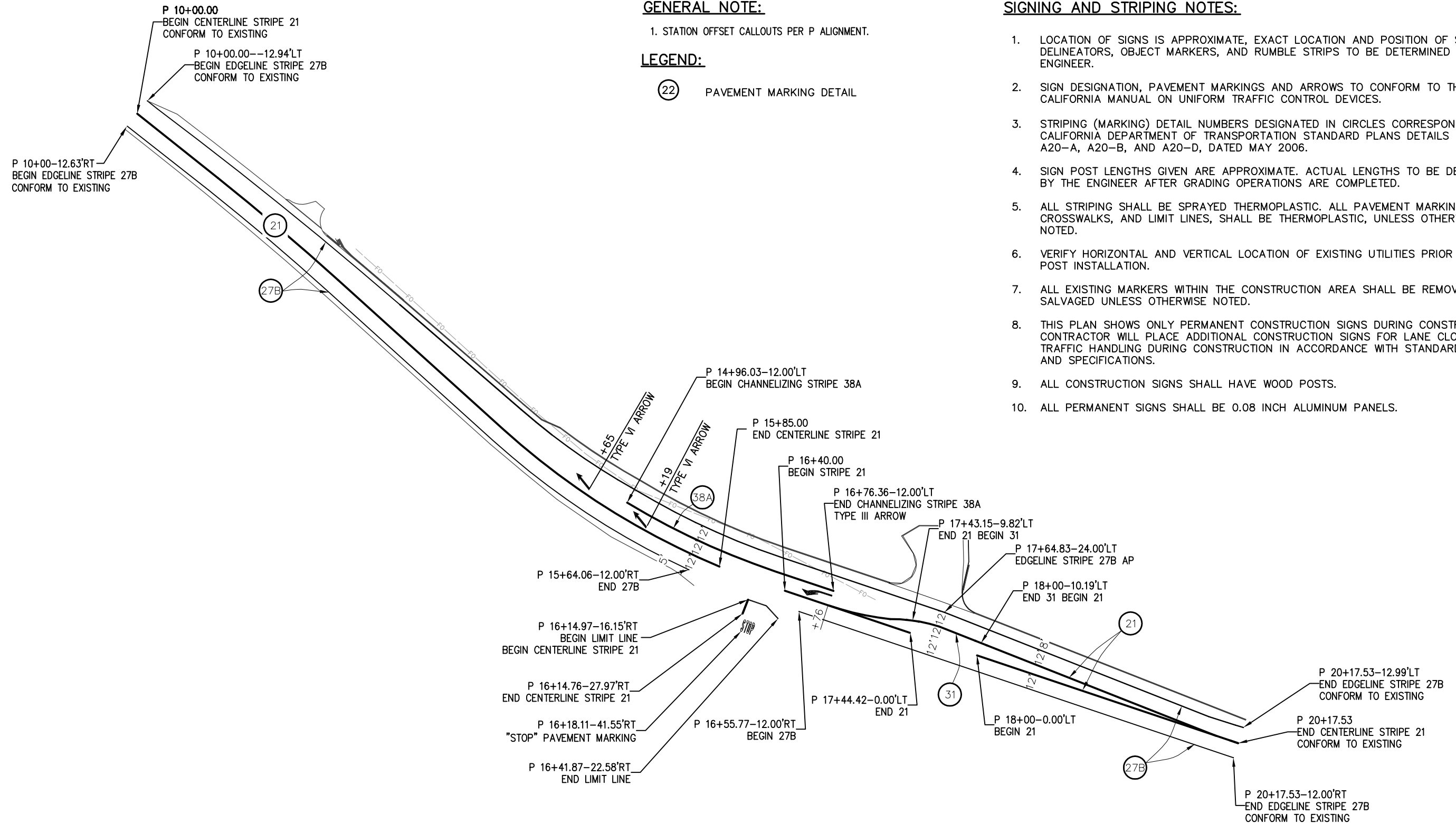

PLAN - PLEASANT VALLEY ROAD

**SIGNING AND PAVEMENT DELINEATION
SCALE : 1" = 40'**

REVISION	NUMBER	DATE	DESCRIPTION	BY



PREPARED UNDER THE SUPERVISION OF:
M Saed
REGISTERED CIVIL ENGINEER

DESIGNED: MS
DRAWN: RR
CHECKED: TL
DATE: 06/04/13
ROAD NUMBER: 77 / 31



**COUNTY OF EL DORADO, CA
COMMUNITY DEVELOPMENT AGENCY
TRANSPORTATION DIVISION**

**PLEASANT VALLEY ROAD AT
OAK HILL ROAD
INTERSECTION IMPROVEMENTS**

SHEET
SPD-1
15 OF 17
W.O. No. **73358**

Drawing name: C:\Civil 3D Projects\73358 Pleasant Vly at Oak Hill\CADD Files\Sheets\SPD-2.dwg
 Layout Tab: EDC Plan 20 Scale Jun 05,2013 -- 9:36am BRichards
 ORIGINAL SCALE IS IN INCHES
 FOR REDUCED PLANS

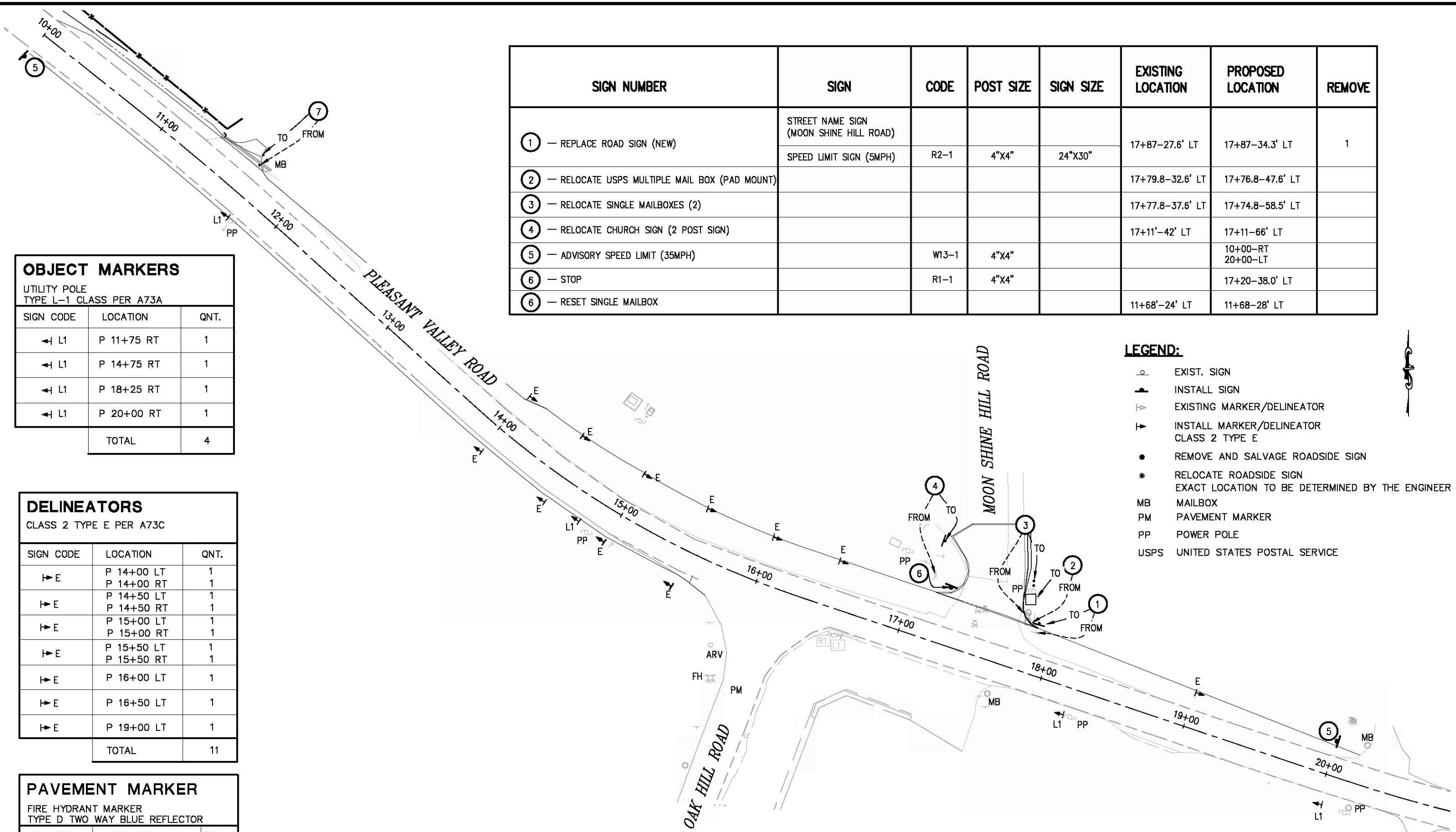

SIGN NUMBER	SIGN	CODE	POST SIZE	SIGN SIZE	EXISTING LOCATION	PROPOSED LOCATION	REMOVE
①	REPLACE ROAD SIGN (NEW) STREET NAME SIGN (MOON SHINE HILL ROAD)				17+87-27.6' LT	17+87-34.3' LT	1
	SPEED LIMIT SIGN (5MPH)	R2-1	4"X4"	24"X30"			
②	RELOCATE USPS MULTIPLE MAIL BOX (PAD MOUNT)				17+79.8-32.6' LT	17+76.8-47.6' LT	
③	RELOCATE SINGLE MAILBOXES (2)				17+77.8-37.6' LT	17+74.8-58.5' LT	
④	RELOCATE CHURCH SIGN (2 POST SIGN)				17+11'-42' LT	17+11-66' LT	
⑤	ADVISORY SPEED LIMIT (35MPH)					10+00-RT 20+00-LT	
⑥	STOP					17+20-38.0' LT	
⑥	RESET SINGLE MAILBOX						
					11+68'-24' LT	11+68-28' LT	

OBJECT MARKERS
UTILITY POLE
TYPE L-1 CLASS PER A73A

SIGN CODE	LOCATION	QNT.
L1	P 11+75 RT	1
L1	P 14+75 RT	1
L1	P 18+25 RT	1
L1	P 20+00 RT	1
TOTAL		4

DELINEATORS
CLASS 2 TYPE E PER A73C

SIGN CODE	LOCATION	QNT.
E	P 14+00 LT	1
E	P 14+00 RT	1
E	P 14+50 LT	1
E	P 14+50 RT	1
E	P 15+00 LT	1
E	P 15+00 RT	1
E	P 15+50 LT	1
E	P 15+50 RT	1
E	P 16+00 LT	1
E	P 16+50 LT	1
E	P 19+00 LT	1
TOTAL		11

PAVEMENT MARKER
FIRE HYDRANT MARKER
TYPE D TWO WAY BLUE REFLECTOR

SIGN CODE	LOCATION	QNT.
PM	P 16+13.7-71.9' RT	1

- LEGEND:**
- EXIST. SIGN
 - INSTALL SIGN
 - EXISTING MARKER/DELINEATOR
 - INSTALL MARKER/DELINEATOR CLASS 2 TYPE E
 - REMOVE AND SALVAGE ROADSIDE SIGN
 - RELOCATE ROADSIDE SIGN EXACT LOCATION TO BE DETERMINED BY THE ENGINEER
 - MB MAILBOX
 - PM PAVEMENT MARKER
 - PP POWER POLE
 - USPS UNITED STATES POSTAL SERVICE

PLAN - PLEASANT VALLEY ROAD

SIGNING AND PAVEMENT DELINEATION
SCALE : 1" = 30'

REVISION	NUMBER	DATE	DESCRIPTION	BY



PREPARED UNDER THE SUPERVISION OF:
Msaed
REGISTERED CIVIL ENGINEER

DESIGNED: OT
DRAWN: RR
CHECKED: TL
DATE: 06/04/13
ROAD NUMBER: 77 / 31



COUNTY OF EL DORADO, CA
COMMUNITY DEVELOPMENT AGENCY
TRANSPORTATION DIVISION

PLEASANT VALLEY ROAD AT
OAK HILL ROAD
INTERSECTION IMPROVEMENTS

SHEET
SPD-2
16 OF 17
W.D. No. 73358

Drawing name: C:\Civil 3D Projects\73358 Pleasant Vly at Oak Hill\CADD Files\Sheets\SPD-3.dwg Layout Tab: EDC Plan 20 Scale Jun 04,2013 - 1:32pm BRichards
 ORIGINAL SCALE IS IN INCHES
 FOR REDUCED PLANS

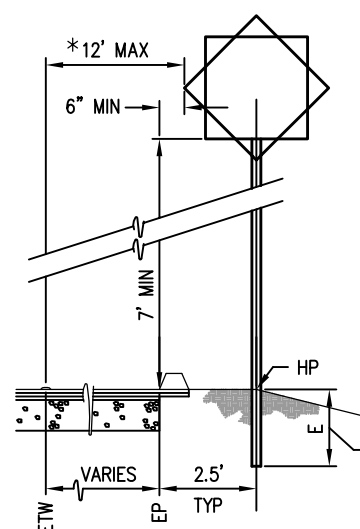

* WHERE CLEARANCE FROM ETW IS GREATER THAN 12', USE STD PLAN RS-1

NOTE:
 WHERE HP OF EMBANKMENT SLOPE STEEPER THAN 1:4 (VERT:HORIZ) IS LESS THAN 2' FROM SIGN POST, "E" SHALL BE INCREASED BY 1/3

1 SIGN LOCATION DETAIL
 NTS

TRAFFIC STRIPE					
LOCATION	DETAIL NO.	DESCRIPTION	8" WIDE		4" WIDE
			WHITE	WHITE	YELLOW
			FT	FT	FT
P 10+00 - 15+85	21 - A20A	NO PASSING 2 DIRECTION			1,170
P 16+40 - 16+76 P 16+76 - 17+43.15-9.82 LT P 16+40 - 17+44.02-0.0 LT P 18+00-10.19 LT - 20+17.53 P 18+00-0.0 LT - 20+17.53	21 - A20A	NO PASSING 2 DIRECTION			72 136 208 436 436
P 14+96.03 - 16+76	38A - A20D	CHANNELIZING	180		
P 10+00 - 15+64 RT	27B - A20B	EDGE LINE		564	
P 16+55.77 - 20+17 RT	27B - A20B	EDGE LINE		362	
P 10+00 - 20+17 LT	27B - A20B	EDGE LINE		1017	
P 17+43.15 - 9.82 LT TO P 18+00 - 10.19 LT	31 - A20B	TWO WAY TURN LANE			114
P 16+14.97 - 16.15' RT TO P 16+14.76 - 27.97' RT	21 - A20A	NO PASSING 2 DIRECTION			24
TOTAL			180	1943	2596

PAVEMENT MARKINGS				
DESCRIPTION	DETAIL	S.F.	STND.	REMARKS
LIMIT LINE AT STOP SIGN	LIMIT LINE	12" WIDE	A-24-E	1 @ 29'=29 S.F.
PAVEMENT MARKING WORDS	STOP	22	A-24-D	1 @ 22=22 S.F.
PAVEMENT MARKING ARROWS	TYPE VI	42	A-24-A	2 @ 42=84 S.F.
PAVEMENT MARKING ARROWS	TYPE III	42	A-24-B	1 @ 42=42 S.F.
TOTAL				177 S.F.

SIGNING AND PAVEMENT DELINEATION
 SCALE : NONE

REVISION	NUMBER	DATE	DESCRIPTION	BY



PREPARED UNDER THE SUPERVISION OF :
M Saed
 REGISTERED CIVIL ENGINEER
 DATE: _____

DESIGNED: MS
 DRAWN: RR
 CHECKED: TL
 DATE: 06/04/13
 ROAD NUMBER: 77 / 31



COUNTY OF EL DORADO, CA
 COMMUNITY DEVELOPMENT AGENCY
 TRANSPORTATION DIVISION

PLEASANT VALLEY ROAD AT
 OAK HILL ROAD
 INTERSECTION IMPROVEMENTS

SHEET
SPD-3
 17 OF 17
 W.O. No. **73358**