

INDEX OF SHEETS

SHEET NO.	SHEET NAME	TITLE
1	i	TITLE SHEET
2	ii	GENERAL NOTES, ABBREVIATIONS, & LEGEND
3	iii	SHEET INDEX MAP
4	S-1	ALIGNMENT DATA & SURVEY CONTROL
5	P-1	SUMMIT DRIVE & LAMOR COURT PLAN & PROFILE, STA 10+00.00 TO STA 12+00.00 & STA 11+50.00 TO STA 13+00.00
6	P-2	MTN CANARY DRIVE PLAN & PROFILE, STA 10+50.00 TO STA 15+75.00
7	P-3	MTN CANARY DR & ECHO VIEW DR PLAN & PROFILE, STA 15+75.00 TO STA 17+50.00, STA 22+00.00 TO STA 23+00.00, & STA 11+50.00 TO STA 13+50.00
8	P-4	ECHO VIEW DRIVE PLAN & PROFILE, STA 21+50.00 TO STA 26+35.00
9-11	D-1 THRU D-3	DETAIL SHEETS
12	X-1	CROSS-SECTIONS & RLC PROFILES
13	EC-1	TEMPORARY EROSION CONTROL
14	EC-2	TEMPORARY EROSION CONTROL DETAILS
15	R-1	REVEGETATION PLAN
16	T-1	TRAFFIC CONTROL PLAN
17	L-1	LAND COVERAGE

DEPARTMENT OF TRANSPORTATION
COUNTY OF EL DORADO, CA

PROJECT PLANS FOR THE CONSTRUCTION OF
**ECHO VIEW 2
EROSION CONTROL PROJECT**

IN THE COUNTY OF EL DORADO, DISTRICT 5,
ECHO VIEW ESTATES UNIT NOS. 1 AND 2, AND PORTION OF
SOUTHEAST 1/4 SECTION 18, T12N, R18E, MDM

To be supplemented with Standard Plans and Specifications dated May 2006, including the amendments to the May 2006 Standard Specifications of the California Department of Transportation, unless otherwise noted.

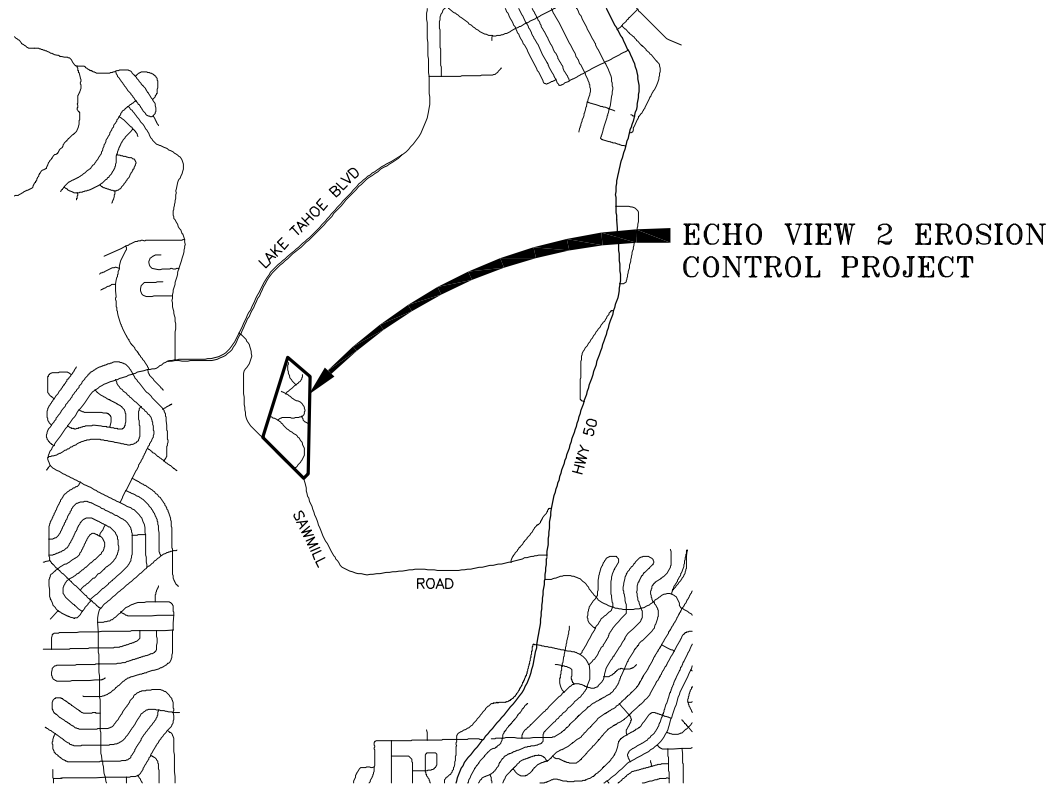
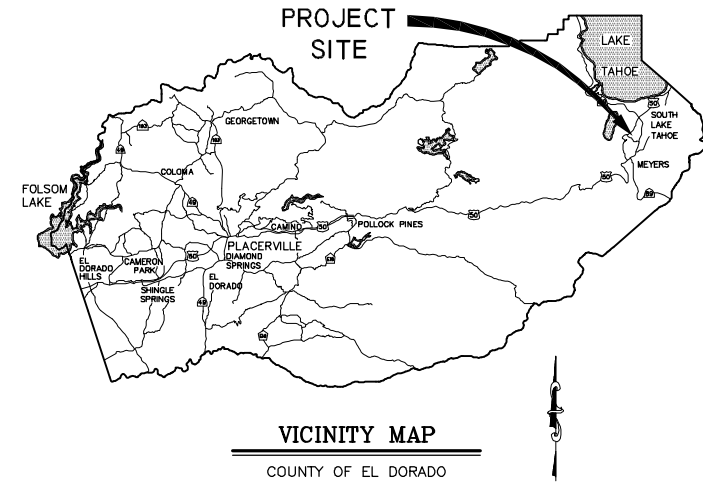

LOCATION MAP

SCALE: 1" = 2000'

FUNDING AGENCIES

USDA FOREST SERVICE



Donald S. Palaroan
SUBMITTED BY: DONALDO S. PALAROAN P.E. DATE 03/20/12
SENIOR CIVIL ENGINEER
STATE OF CALIFORNIA NO. 66083

BOARD OF SUPERVISORS

I	JOHN R. KNIGHT
II	RAYMOND J. NUTTING
III	JAMES SWEENEY
IV	RON V. BRIGGS
V	NORMA SANTIAGO

COUNTY OF EL DORADO
DEPARTMENT OF
TRANSPORTATION

(530) 573-7900
924 B EMERALD BAY RD
SOUTH LAKE TAHOE, CA
96150

(530) 621-5900
2850 FAIRLANE CT
PLACERVILLE, CA
95667

ADOPTED AND APPROVED BY:

DATE	DATE	DATE
JOHN R. KNIGHT CHAIR, COUNTY OF EL DORADO BOARD OF SUPERVISORS	KIMBERLY A. KERR INTERIM DIRECTOR, COUNTY OF EL DORADO DEPARTMENT OF TRANSPORTATION	STEVE P. KOOSMAN, RCE NO. 85757 ACTING DEPUTY DIRECTOR OF ENGINEERING, TRANSPORTATION PLANNING AND LAND DEVELOPMENT

CONTRACT NO. PW 11-30617, CIP NO. 95169

ECHO VIEW 2
EROSION CONTROL PROJECT
TITLE SHEET

SHEET I OF 17

CONTRACTOR'S LICENSE CLASSIFICATION: Bidders shall be properly licensed to perform the Work pursuant to the State Contractor's License Law (Business and Professions Code section 7000 et seq.) and shall possess a CLASS A LICENSE or equivalent combination of Classes required by the categories and type of Work included in the Contract Documents and Plans, at the time the Contract is awarded, and shall maintain a valid license through completion and acceptance of the Work including guarantee and warranty period. If the Contractor possesses a Class A license instead of the equivalent combination of Classes required by the categories and type of work included in the Contract Documents and Plans, then the Contractor or a subcontractor must also possess a CLASS C27 "Landscaping Contractor" license. Failure of the successful Bidder to obtain proper and adequate licensing for an award of the Contract shall constitute a failure to execute the Contract, and shall result in forfeiture of the Bidders security.

REVISIONS		
MARK	DATE	BY



GENERAL NOTES

- 1. ALL IMPROVEMENTS SHALL BE ACCOMPLISHED UNDER THE APPROVAL, INSPECTION, AND TO THE SATISFACTION OF THE EL DORADO COUNTY DEPARTMENT OF TRANSPORTATION (DOT). IMPROVEMENT CONSTRUCTION SHALL COMPLY WITH THESE PLANS AND THE MAY 2006 CALTRANS STANDARD PLANS, UNLESS NOTED OTHERWISE. ALL REFERENCES TO THE "STANDARD SPECIFICATIONS" SHALL MEAN THE STATE OF CALIFORNIA, DEPARTMENT OF TRANSPORTATION (CALTRANS) STANDARD SPECIFICATIONS, MAY 2006, INCLUDING THE AMENDMENTS TO THE MAY 2006 STANDARD SPECIFICATIONS, AND AMENDMENTS TO CONSTRUCTION NOT SPECIFIED ON THESE PLANS OR IN SPECIFIC EL DORADO COUNTY (COUNTY) ORDINANCES SHALL CONFORM TO THE REQUIREMENTS OF THE STANDARD SPECIFICATIONS. THE CONTRACTOR IS OBLIGATED TO BE FAMILIAR WITH APPLICABLE SECTIONS OF THE STANDARD SPECIFICATIONS NOT DISCUSSED IN THE GENERAL NOTES. THE CONTRACT SPECIAL PROVISIONS SHALL SUPERSEDE THOSE OF THE STANDARD SPECIFICATIONS WHERE DISCREPANCIES OCCUR.

ABBREVIATIONS

NOTE: LOWER CASE TEXT WITHIN PLAN SET INDICATES EXISTING
Table with 2 columns: Abbreviation and Description. Includes symbols like Delta, Aspen, AB, AC, ACS, ACP, AP, APN, APPVD, AV/AR, BC, BCR, BGN, BLVD, BO, BP, BVCE, BVCS, C, CALC'S, CC, CF, CHD, CIR, CL, CLF, CLR, CO, CO, CONC, CONST, CMP, CT, CTC, CY, C&G, D, DBL, DET, DI, DIA OR Ø, DISS, DR, D/W, E, EA, EC, ECR, EG, ELEV, ELEC, ENGR, EP, ESMT, EVCE, EVCS, EX OR EXIST, F, FES, FF, FG, FH, FL, FS, G, GA, GB, GLS, GV, GW, H, HDPE, HP, ID, IE, INST, INTRXN, L, LC, LF, LP, LT, LTB, LTD, MAT'L, MISC, MOC, MTN, N, NIC, NTS, OAE, OC, OD, OH, P, PC, PCC, PERF, PL, POC, POCVCE, POCVCS, POR, PORVCE, PORVCS, PP, PRC, PROP, PT, PUE, PVC, PVIE, PVIS, PVMT, R, R&R, RC, RCP, RD, REF, REQ'D, RLC, ROW, RR, RSP, RT, S, SCO, SD, SDMH, SEZ, SF, SHT, SL, SLI, SLO, SMH, ST, STA, STD, STL, SWPPP, STPUD, T, TBC, TBD, TBM, TBR, TD, TERM, TG, TTL, TRANS, TRM, TRPA, TW, TYP, UG, UKN, USFS, V, W, W/O, WC, WV, LAKE TAHOE DATUM, MATERIAL, MISCELLANEOUS, MID POINT ON CURVE, MOUNTAIN, NORTH, NOT IN CONTRACT, NOT TO SCALE, OR APPROVED EQUAL, ON CENTER, OUTSIDE DIAMETER, OVERHEAD, PINE, POINT OF BEGINNING OF CURVE, PORTLAND CEMENT CONCRETE, PERFORATED, PROPERTY LINE, POINT OF COMPOUND CURVE, POINT OF COMPOUND VERTICAL CURVE ELEVATION, POINT OF COMPOUND VERTICAL CURVE STATION, PORTION, POINT OF REVERSE VERTICAL CURVE ELEVATION, POINT OF REVERSE VERTICAL CURVE STATION, POWER/UTILITY POLE, POINT OF REVERSE CURVE, PROPOSED, POINT OR POINT OF TANGENCY, PUBLIC UTILITY EASEMENT, POLYVINYL CHLORIDE, POINT OF VERTICAL INTERSECTION ELEVATION, POINT OF VERTICAL INTERSECTION STATION, PAVEMENT, RADIUS, REMOVE & REPLACE, RELATIVE COMPACTION, REINFORCED CONCRETE PIPE, ROAD, REFERENCE, REQUIRED, ROCK-LINED CHANNEL, RIGHT-OF-WAY, RAILROAD, ROCK SLOPE PROTECTION, RIGHT, SOUTH OR SANITARY SEWER, SEWER CLEAN OUT, STORM DRAIN, STORM DRAIN MANHOLE, STREAM ENVIRONMENT ZONE, SQUARE FEET, SHEET, SLOPE LENGTH, SLOPE LENGTH IN PAVEMENT, SLOPE LENGTH OUT OF PAVEMENT, SEWER MANHOLE, SEDIMENT TRAP OR STREET, STATION, STANDARD, STEEL, STORM WATER POLLUTION PREVENTION PLAN, SOUTH TAHOE PUBLIC UTILITY DISTRICT, TELEPHONE, TOP BACK OF CURB, TOP BACK OF DIKE, TEMPORARY BENCHMARK, TO BE REMOVED, TOP OF DIKE, TERMINAL, TOP OF GRATE, TOTAL, TRANSITION, TURF REINFORCEMENT MAT, TAHOE REGIONAL PLANNING AGENCY, TOP OF WALL, TYPICAL, UNDERGROUND, UNKNOWN, UNITED STATES FOREST SERVICE, VERTICAL, WEST OR WATER, WITH, WITHOUT, WILLOW CLUSTER, WATER VALVE.

LEGEND

Table with 2 columns: EXISTING (SCREENED AND/OR DASHED) and PROPOSED. Lists symbols for CENTERLINE, SAWCUT (AS NOTED), AC REMOVE AND REPLACE (INCLUDING D/W), AC REMOVE, FILL EXISTING CHANNEL, ELEVATION, ELEVATION, EG CL, PROPOSED (PROFILE ONLY), SEDIMENT TRAP, BRIDGE DRAIN, SD PIPE, (MATERIAL AS NOTED), FLARED END SECTION, DETAIL REF NUMBER SHEET NUMBER, ROCK, ONE-QUARTER DELTA, FILTER FENCE OR CONSTRUCTION LIMIT FENCE, SLOPE RATIO, H: V, ROCK LINED CHANNEL, FLOWLINE, CUT, FILL, CUT OR FILL SLOPE, CABLE TELEVISION, CHARTER COMMUNICATIONS, (775) 588-1077, NATURAL GAS, SOUTHWEST GAS, (530) 543-3225, ELECTRIC, LIBERTY ENERGY, (530) 541-6400, SEWER & WATER, SOUTH TAHOE PUD, (530) 544-6474, TELEPHONE, AT&T, (530) 888-2031, STORM DRAIN, EL DORADO COUNTY DOT, (530) 573-3180.

DRAWING NUMBER: S:\D\EL_DORADO\PROJECTS\2011\03\02\11\02_11\Notes.dwg ORIGINAL SCALE IS IN INCHES 2 FOR REDUCED PLANS REVISION

Table with 4 columns: NUMBER, DATE, DESCRIPTION, BY. Includes a revision history table.



PREPARED UNDER THE SUPERVISION OF: [Signature] REGISTERED CIVIL ENGINEER 03/20/12 DATE:

Table with 2 columns: DESIGNED: ALD, DRAWN: ALD, CHECKED: DSP, DATE: 03/20/12, ROAD NUMBER: ---

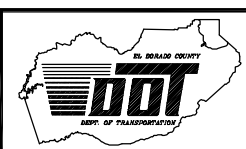

EL DORADO COUNTY DEPARTMENT OF TRANSPORTATION

ECHO VIEW 2 ECP GENERAL NOTES, ABBREVIATIONS, & LEGEND 12-0274.C.2

SHEET ii of 17 CONTRACT NO. PW 11-30617 CIP NO. 95169

FOR REDUCED PLANS ORIGINAL SCALE IS IN INCHES 2 1 0

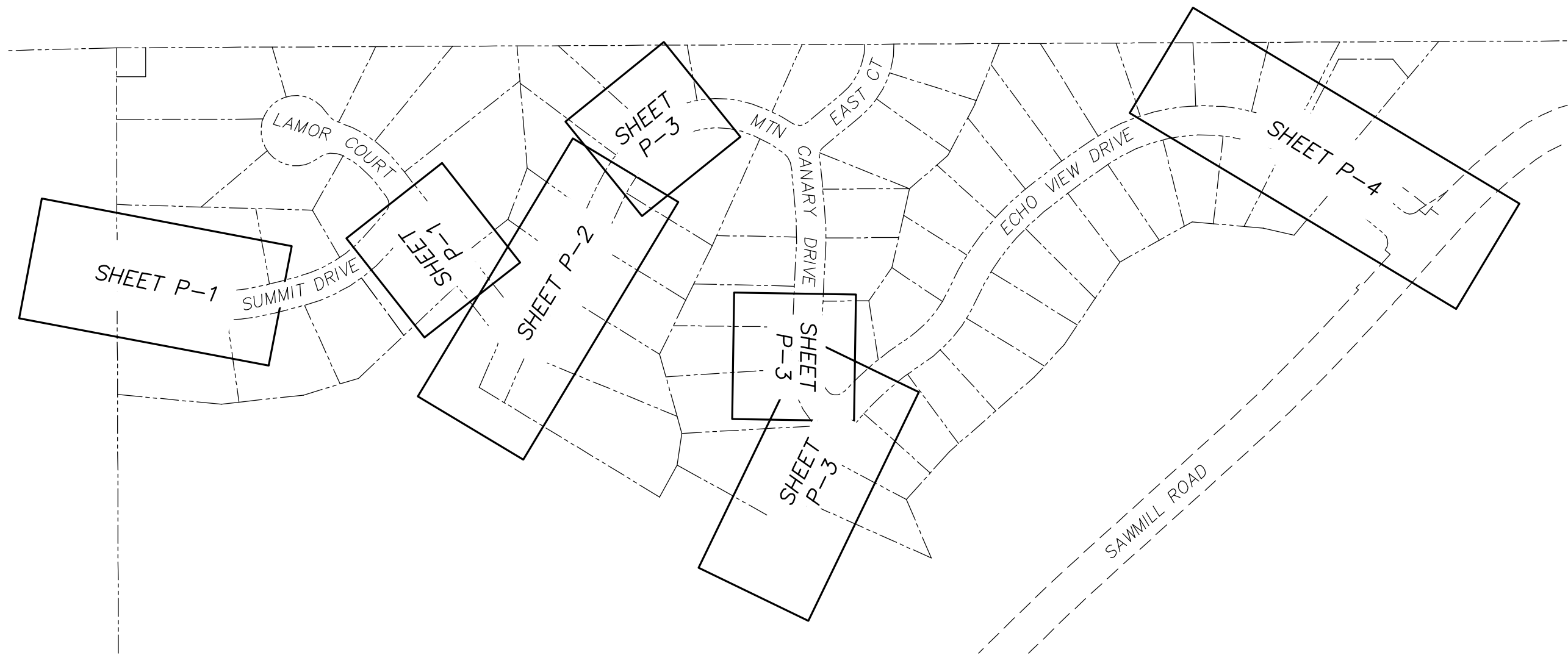

SCALE: 1" = 100'

REVISION	NUMBER	DATE	DESCRIPTION	BY



PREPARED UNDER THE SUPERVISION OF :

 REGISTERED CIVIL ENGINEER
 DATE: 03/20/12

DESIGNED: ALD
 DRAWN: ALD
 CHECKED: DSP
 DATE: 03/2012
 ROAD NUMBER: ---

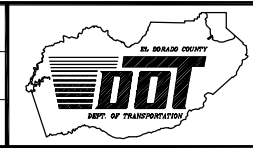

EL DORADO COUNTY
 DEPARTMENT OF TRANSPORTATION

ECHO VIEW 2 ECP
 SHEET INDEX MAP
 12-0274.C.3

SHEET
 iii
 3 OF 17
 CONTRACT NO.
 PW 11-30617
 CIP NO.
 95169

DRAWING NAME: S:\CIVIL_3D_PROJECTS\858569\Engineering\MPL\PLAN04_SC-1.dwg

ORIGINAL SCALE IS IN INCHES

FOR REDUCED PLANS

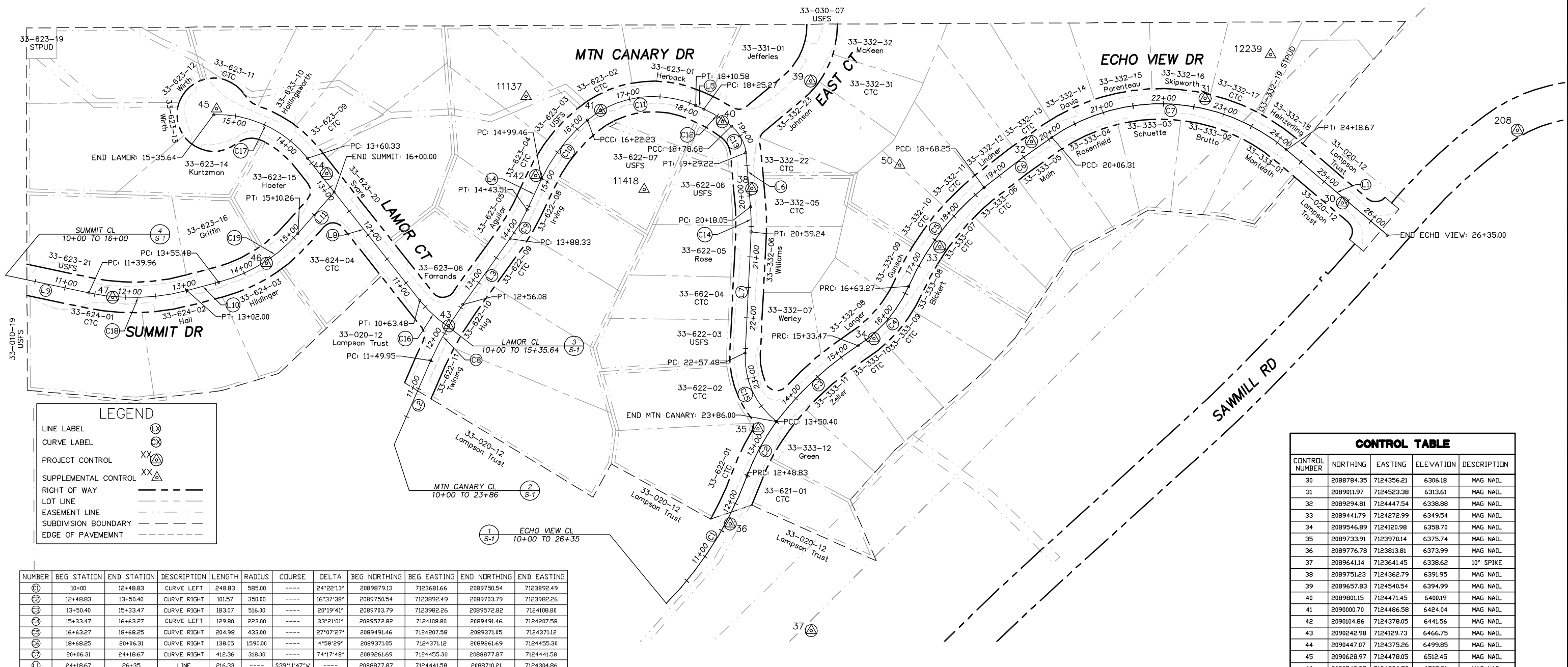

LEGEND

LINE LABEL	(X)
CURVE LABEL	(C)
PROJECT CONTROL	XX (A)
SUPPLEMENTAL CONTROL	XX (A)
RIGHT OF WAY	---
LOT LINE	---
EASEMENT LINE	---
SUBDIVISION BOUNDARY	---
EDGE OF PAVEMENT	---

CONTROL TABLE

CONTROL NUMBER	NORTHING	EASTING	ELEVATION	DESCRIPTION
30	2088784.35	7124356.21	6306.18	MAG NAIL
31	2089011.97	7124523.38	6313.61	MAG NAIL
32	2089294.81	7124447.54	6338.88	MAG NAIL
33	2089441.79	7124272.99	6349.54	MAG NAIL
34	2089546.89	7124120.98	6358.70	MAG NAIL
35	2089733.91	7123970.14	6375.74	MAG NAIL
36	2089776.78	7123813.81	6373.99	MAG NAIL
37	2089641.14	7123641.45	6338.62	10' SPIKE
38	2089751.23	7124362.79	6391.95	MAG NAIL
39	2089657.83	7124540.54	6394.99	MAG NAIL
40	2089801.15	7124471.45	6400.19	MAG NAIL
41	2090000.70	7124486.58	6424.04	MAG NAIL
42	2090104.86	7124378.05	6441.56	MAG NAIL
43	2090242.98	7124129.73	6466.75	MAG NAIL
44	2090447.07	7124375.26	6499.85	MAG NAIL
45	2090628.97	7124478.05	6512.45	MAG NAIL
46	2090542.87	7124226.72	6505.21	MAG NAIL
47	2090793.52	7124166.82	6488.08	MAG NAIL
50	2089509.72	7124405.56	6367.48	HUB & MAG NAIL
208	2088500.34	7124480.23	6303.22	10' SPIKE
11137	2090123.02	7124507.18	6433.95	HUB & MAG NAIL
11418	2089927.16	7124358.25	6414.64	HUB & MAG NAIL
12239	2088906.20	7124596.75	6315.90	HUB & MAG NAIL

NUMBER	BEG STATION	END STATION	DESCRIPTION	LENGTH	RADIUS	COURSE	DELTA	BEG NORTHING	BEG EASTING	END NORTHING	END EASTING
C1	10+00	12+48.83	CURVE LEFT	248.83	585.00	---	24°22'13"	2089879.13	7123681.66	2089750.54	7123892.49
C2	12+48.83	15+50.40	CURVE RIGHT	101.57	350.00	---	16°37'38"	2089750.54	7123892.49	2089703.79	7123982.26
C3	13+50.40	15+33.47	CURVE RIGHT	183.07	516.00	---	20°19'41"	2089703.79	7123982.26	2089572.82	7124108.80
C4	15+33.47	16+63.27	CURVE LEFT	129.80	223.00	---	33°21'01"	2089572.82	7124108.80	2089491.46	7124207.58
C5	16+63.27	18+68.25	CURVE RIGHT	204.98	433.00	---	27°07'27"	2089491.46	7124207.58	2089371.05	7124371.12
C6	18+68.25	20+06.31	CURVE RIGHT	138.05	1590.00	---	4°58'29"	2089371.05	7124371.12	2089261.69	7124455.30
C7	20+06.31	24+18.67	CURVE RIGHT	412.36	318.00	---	74°17'48"	2089261.69	7124455.30	2088877.87	7124441.58
L1	24+18.67	26+35	LINE	216.33	---	S39°11'47"W	---	2088877.87	7124441.58	2088710.21	7124304.86

ECHO VIEW CL ALIGNMENT
10+00 TO 26+35
1 S-1

NUMBER	BEG STATION	END STATION	DESCRIPTION	LENGTH	RADIUS	COURSE	DELTA	BEG NORTHING	BEG EASTING	END NORTHING	END EASTING
C16	10+00	10+63.48	CURVE RIGHT	63.48	200.00	---	18°11'09"	2090243.61	7124128.28	2090290.89	7124170.25
C18	10+63.48	13+60.33	LINE	296.85	---	N50°41'20"E	---	2090290.89	7124170.25	2090478.95	7124399.93
C17	13+60.33	15+35.64	CURVE LEFT	175.31	187.50	---	53°34'17"	2090478.95	7124399.93	2090633.45	7124468.40

LAMOR CL ALIGNMENT
10+00 TO 15+35.64
3 S-1

NUMBER	BEG STATION	END STATION	DESCRIPTION	LENGTH	RADIUS	COURSE	DELTA	BEG NORTHING	BEG EASTING	END NORTHING	END EASTING
C8	10+00	11+49.95	LINE	149.95	---	S67°26'23"E	---	2090388.70	7123933.67	2090271.17	7124072.14
C9	11+49.95	12+56.08	CURVE RIGHT	106.13	500.00	---	12°09'40"	2090271.17	7124072.14	2090220.40	7124165.11
C10	12+56.08	13+88.33	LINE	132.26	---	S55°16'43"E	---	2090220.40	7124165.11	2090145.07	7124273.82
C11	13+88.33	14+43.51	CURVE LEFT	55.18	300.00	---	10°32'16"	2090145.07	7124273.82	2090117.97	7124321.79
C12	14+43.51	14+99.46	LINE	55.96	---	S65°48'59"E	---	2090117.97	7124321.79	2090095.05	7124372.84
C13	14+99.46	16+22.23	CURVE RIGHT	122.77	277.00	---	25°23'37"	2090095.05	7124372.84	2090021.98	7124470.24
C14	16+22.23	18+10.58	CURVE RIGHT	188.35	170.00	---	63°28'54"	2090021.98	7124470.24	2089845.16	7124497.24
C15	18+10.58	18+25.27	LINE	14.69	---	S23°03'31"W	---	2089845.16	7124497.24	2089831.64	7124491.48
C16	18+25.27	18+78.68	CURVE RIGHT	53.41	205.00	---	14°55'40"	2089831.64	7124491.48	2089785.76	7124464.43
C17	18+78.68	19+29.22	CURVE RIGHT	50.54	63.00	---	45°57'36"	2089785.76	7124464.43	2089761.89	7124421.42
C18	19+29.22	20+18.05	LINE	88.84	---	S83°56'47"W	---	2089761.89	7124421.42	2089752.52	7124333.08
C19	20+18.05	20+59.24	CURVE RIGHT	41.19	300.00	---	7°52'00"	2089752.52	7124333.08	2089751.00	7124291.96
C20	20+59.24	22+57.48	LINE	198.23	---	N88°11'13"W	---	2089751.00	7124291.96	2089757.27	7124093.82
C21	22+57.48	23+86	CURVE LEFT	128.52	134.00	---	54°57'17"	2089757.27	7124093.82	2089703.72	7123982.36

MTN CANARY CL ALIGNMENT
10+00 TO 23+86
2 S-1

NUMBER	BEG STATION	END STATION	DESCRIPTION	LENGTH	RADIUS	COURSE	DELTA	BEG NORTHING	BEG EASTING	END NORTHING	END EASTING
C9	10+00	11+39.96	LINE	139.96	---	S10°52'37"W	---	2090969.99	7124199.78	2090832.54	7124173.37
C10	11+39.96	13+02	CURVE RIGHT	162.04	350.00	---	26°31'37"	2090832.54	7124173.37	2090672.08	7124180.06
C11	13+02	13+55.48	LINE	53.47	---	S15°39'00"E	---	2090672.08	7124180.06	2090620.59	7124194.48
C12	13+55.48	15+10.26	CURVE LEFT	154.78	260.00	---	34°06'33"	2090620.59	7124194.48	2090492.26	7124276.89
C13	15+10.26	16+00	LINE	89.74	---	S49°45'33"E	---	2090492.26	7124276.89	2090434.29	7124345.39

SUMMIT CL ALIGNMENT
10+00 TO 16+00
4 S-1

HORIZONTAL DATUM
BASIS OF BEARING FOR SURVEY CONTROL IS GRID NORTH, CALIFORNIA COORDINATE SYSTEM (NAD 83) ZONE 2, US SURVEY FT, 1991.35 EPOCH, ESTABLISHED USING CONVENTIONAL MEASUREMENTS TO CONTROL POINTS SHOWN ON THIS SHEET.

VERTICAL DATUM
ELEVATION DATUM IS BASED UPON THE NORTH AMERICAN VERTICAL DATUM OF 1929. TBM POINTS ARE CONTROL POINTS SHOWN ON THIS SHEET.

GRID
SCALE: 1" = 80'

REVISION	NUMBER	DATE	DESCRIPTION	BY



PREPARED UNDER THE SUPERVISION OF:
Lora A. Manasco
PROFESSIONAL LAND SURVEYOR
December 30, 2011

DESIGNED: ALD
DRAWN: KIS
CHECKED: LAM
DATE: 01/2012
ROAD NUMBER: ---

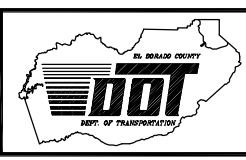

EL DORADO COUNTY
DEPARTMENT OF TRANSPORTATION

ECHO VIEW 2 ECP
ALIGNMENT DATA & SURVEY CONTROL
12-0274.C.4
SHEET S-1
CONTRACT NO. PW 11-30617
CIP NO. 95169

!! WARNING !!
 THE LOCATION AND/OR ELEVATION OF EXISTING UNDERGROUND UTILITIES SHOWN ON THESE PLANS ARE ONLY APPROXIMATE. CONTRACTOR TO VERIFY LOCATION AND ELEVATION OF ALL EXISTING UNDERGROUND UTILITIES.

NOTE:
 THIS PROJECT IS LOCATED IN AN ENVIRONMENTALLY SENSITIVE AREA. THE CONTRACTOR SHALL EXERCISE UTMOST CARE TO PROTECT AND MAINTAIN EXISTING VEGETATION AND MINIMIZE SOIL COMPACTION WITHIN CONSTRUCTION AREAS.

NOTE:
 ON SLOPES TO RECEIVE RSP, EXISTING ESTABLISHED VEGETATION SHALL BE PROTECTED IN PLACE, SEE SPECIAL PROVISIONS

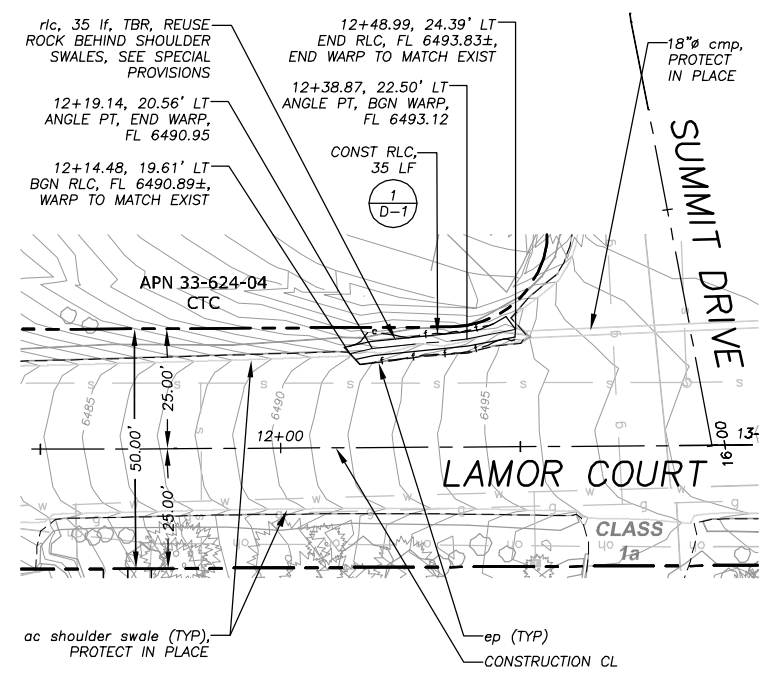
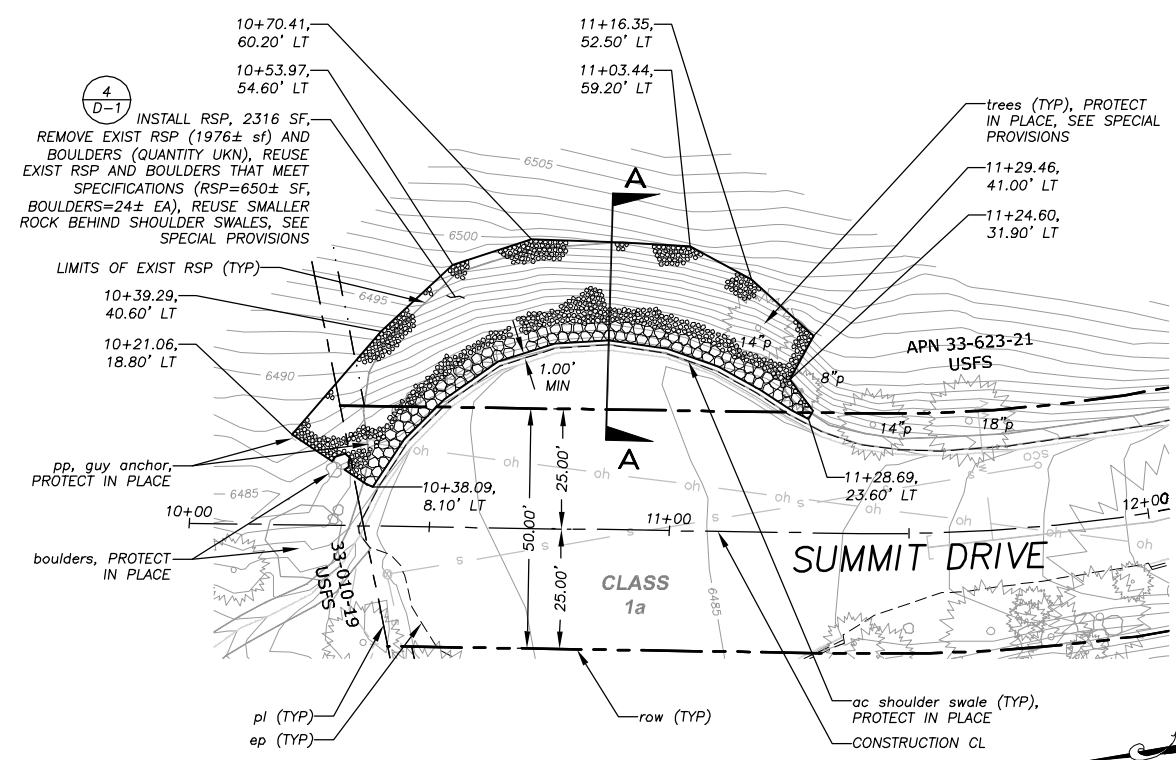

NOTE:
 RIGHT-OF-WAY MONUMENTATION NEAR STA 10+31, 25' LT, DISTURBED BY CONSTRUCTION ACTIVITIES SHALL BE REPLACED BY OTHERS, SEE SPECIAL PROVISIONS.

NOTE:
 SALVAGE SOIL FROM RLC, 5 CY, SEE SPECIAL PROVISIONS

PLAN & PROFILE
 SCALE: HORIZ 1" = 20'
 VERT 1" = 5'

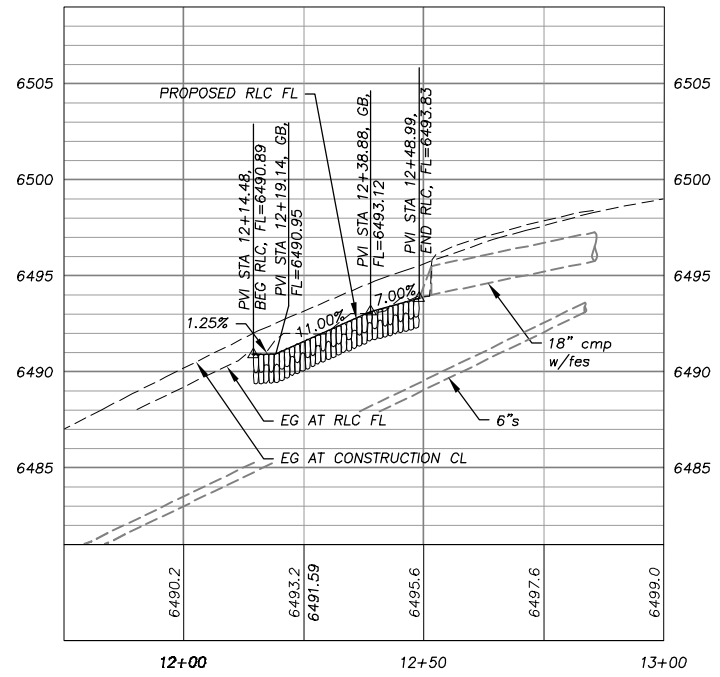
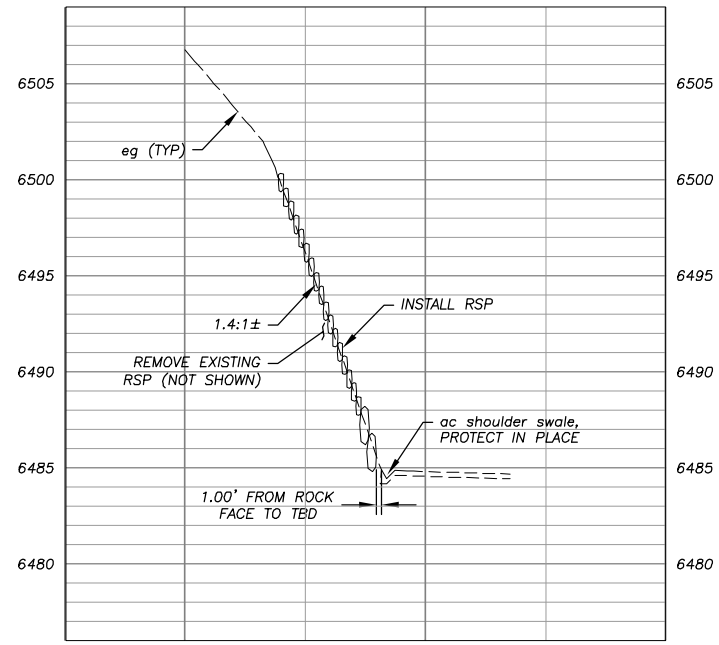

DRAWING NAME: S:\DNL_3D_PROJECTS\95869\Engineering\MP\AN\05 E12 P-1.dwg Layout Tab: P-1 Mar 20, 2012 - 10:06am ADI\an

FOR REDUCED PLANS ORIGINAL SCALE IS IN INCHES

REVISION	NUMBER	DATE	DESCRIPTION	BY



PREPARED UNDER THE SUPERVISION OF:
David J. ...
 REGISTERED CIVIL ENGINEER
 No. 66083
 Exp. 06-30-14
 DATE: 03/20/12

DESIGNED: ALD
 DRAWN: ALD
 CHECKED: DSP
 DATE: 03/20/12
 ROAD NUMBER: ---

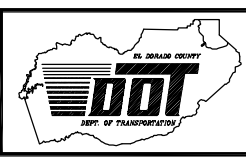

EL DORADO COUNTY
 DEPARTMENT OF TRANSPORTATION

ECHO VIEW 2 ECP
 SUMMIT DRIVE & LAMOR COURT PLAN & PROFILE
 STA 10+00.00 TO STA 12+00.00
 & STA 11+50.00 TO STA 13+00.00

SHEET
 P-1
 5 of 17
 CONTRACT NO.
 PW 11-30617
 CIP NO.
 95169

!! WARNING !!
 THE LOCATION AND/OR ELEVATION OF EXISTING UNDERGROUND UTILITIES SHOWN ON THESE PLANS ARE ONLY APPROXIMATE. CONTRACTOR TO VERIFY LOCATION AND ELEVATION OF ALL EXISTING UNDERGROUND UTILITIES.

NOTE: THIS PROJECT IS LOCATED IN AN ENVIRONMENTALLY SENSITIVE AREA. THE CONTRACTOR SHALL EXERCISE UTMOST CARE TO PROTECT AND MAINTAIN EXISTING VEGETATION AND MINIMIZE SOIL COMPACTION WITHIN CONSTRUCTION AREAS.

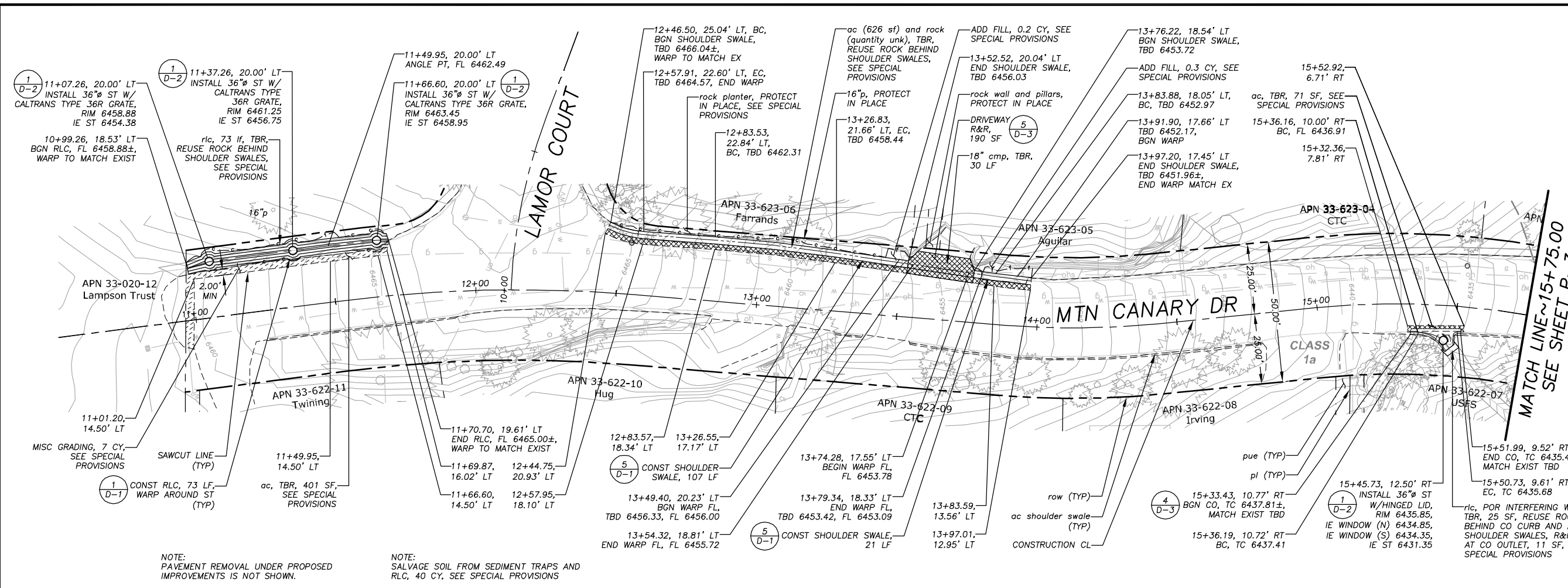

NOTE: PAVEMENT REMOVAL UNDER PROPOSED IMPROVEMENTS IS NOT SHOWN.

NOTE: SALVAGE SOIL FROM SEDIMENT TRAPS AND RLC, 40 CY, SEE SPECIAL PROVISIONS

PLAN & PROFILE
 SCALE: HORIZ 1" = 20'
 VERT 1" = 5'

Drawing name: \\D:\1. 3D PROJECTS\61669\Engineering\MP\AN\06 E12 P-2.dwg
 Layout: Tab: P-2, Mar 20/2012 - 10:35am ADJ
 ORIGINAL SCALE IS IN INCHES
 2
 1
 0
 FOR REDUCED PLANS
 REVISION

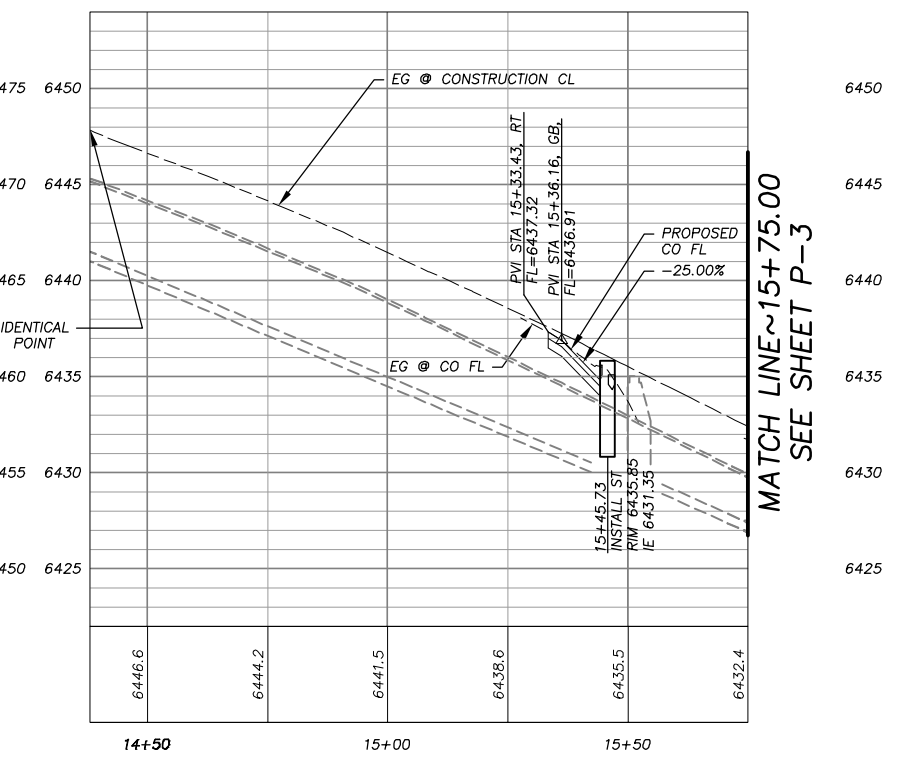
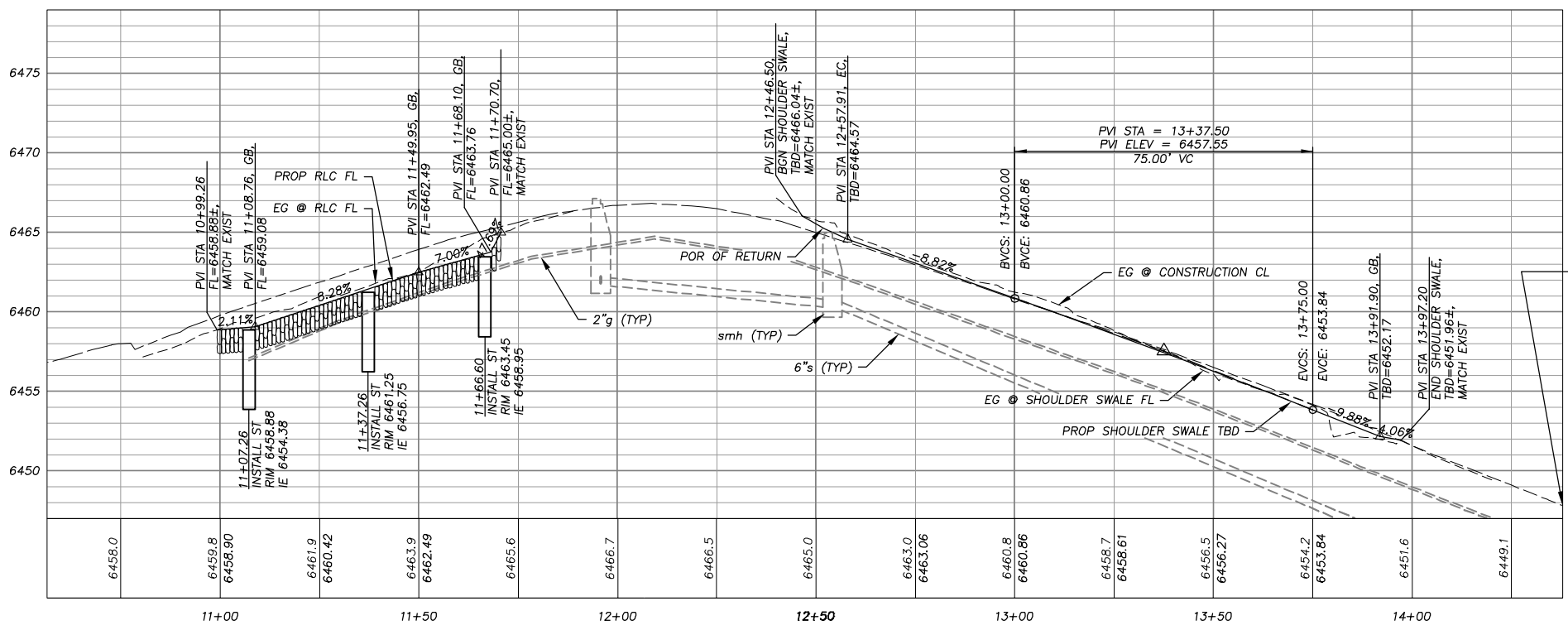

REVISION	NUMBER	DATE	DESCRIPTION	BY



PREPARED UNDER THE SUPERVISION OF:
David J. ...
 REGISTERED CIVIL ENGINEER
 DATE: 03/20/12

DESIGNED: ALD
 DRAWN: ALD
 CHECKED: DSP
 DATE: 03/20/12
 ROAD NUMBER: ---

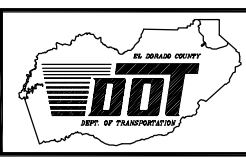

EL DORADO COUNTY
 DEPARTMENT OF TRANSPORTATION

ECHO VIEW 2 ECP
 MTN CANARY DRIVE PLAN & PROFILE
 STA 10+50.00 TO STA 15+75.00
 12-0274.C.6

SHEET
P-2
 6 OF 17
 CONTRACT NO.
PW 11-30617
 CIP NO.
95169

Drawing name: \\V:\V\3D PROJECTS\64689\MP\AN\07\02_P-3.dwg
 Layout: Tab: P-3_Mar 20/2012 - 10:31am ADI\m

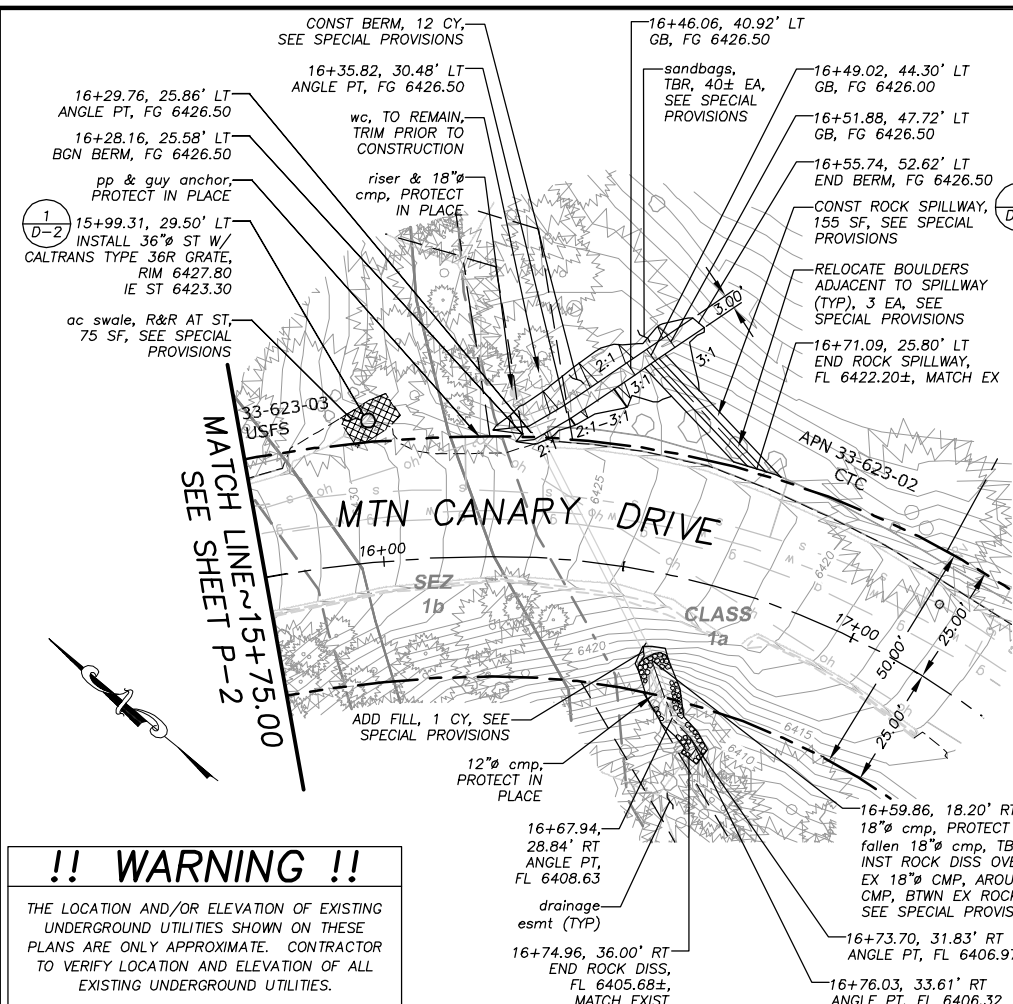

!! WARNING !!

THE LOCATION AND/OR ELEVATION OF EXISTING UNDERGROUND UTILITIES SHOWN ON THESE PLANS ARE ONLY APPROXIMATE. CONTRACTOR TO VERIFY LOCATION AND ELEVATION OF ALL EXISTING UNDERGROUND UTILITIES.

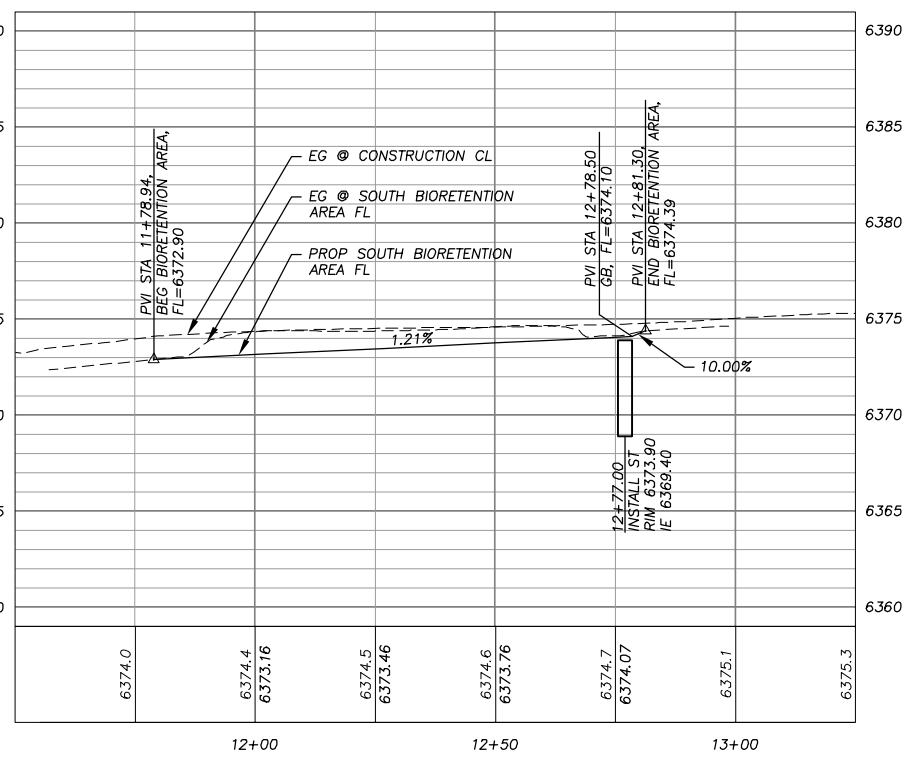
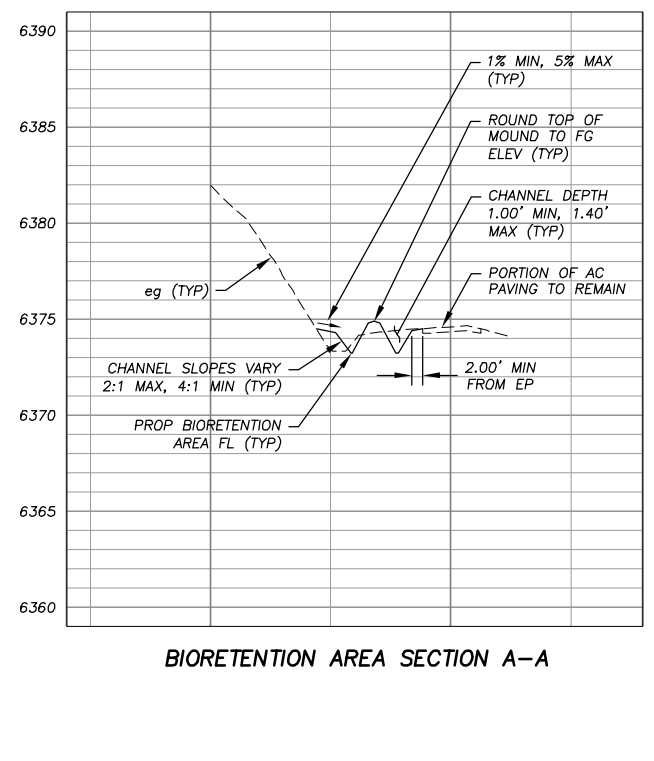
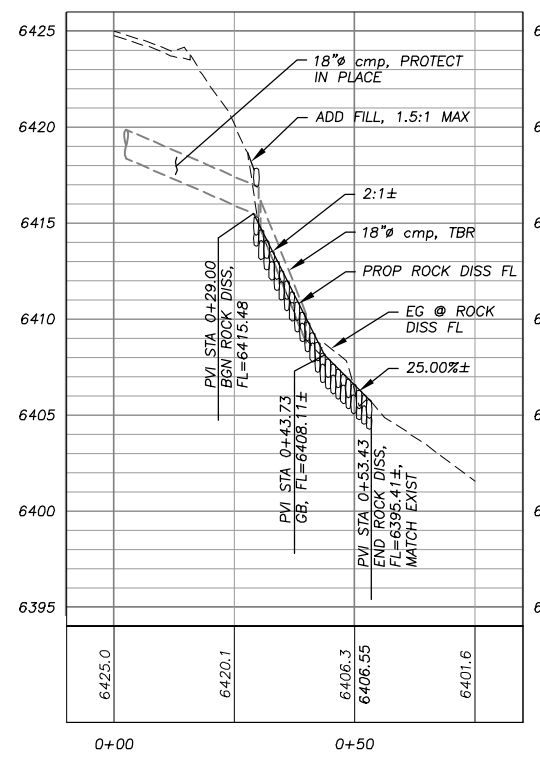
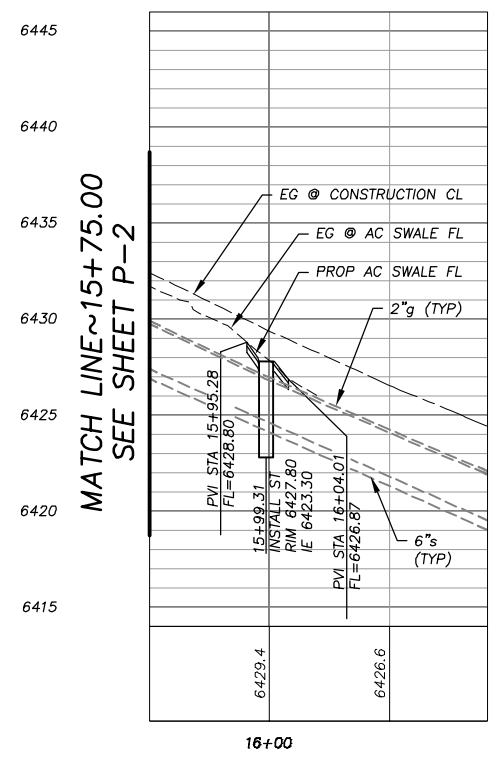
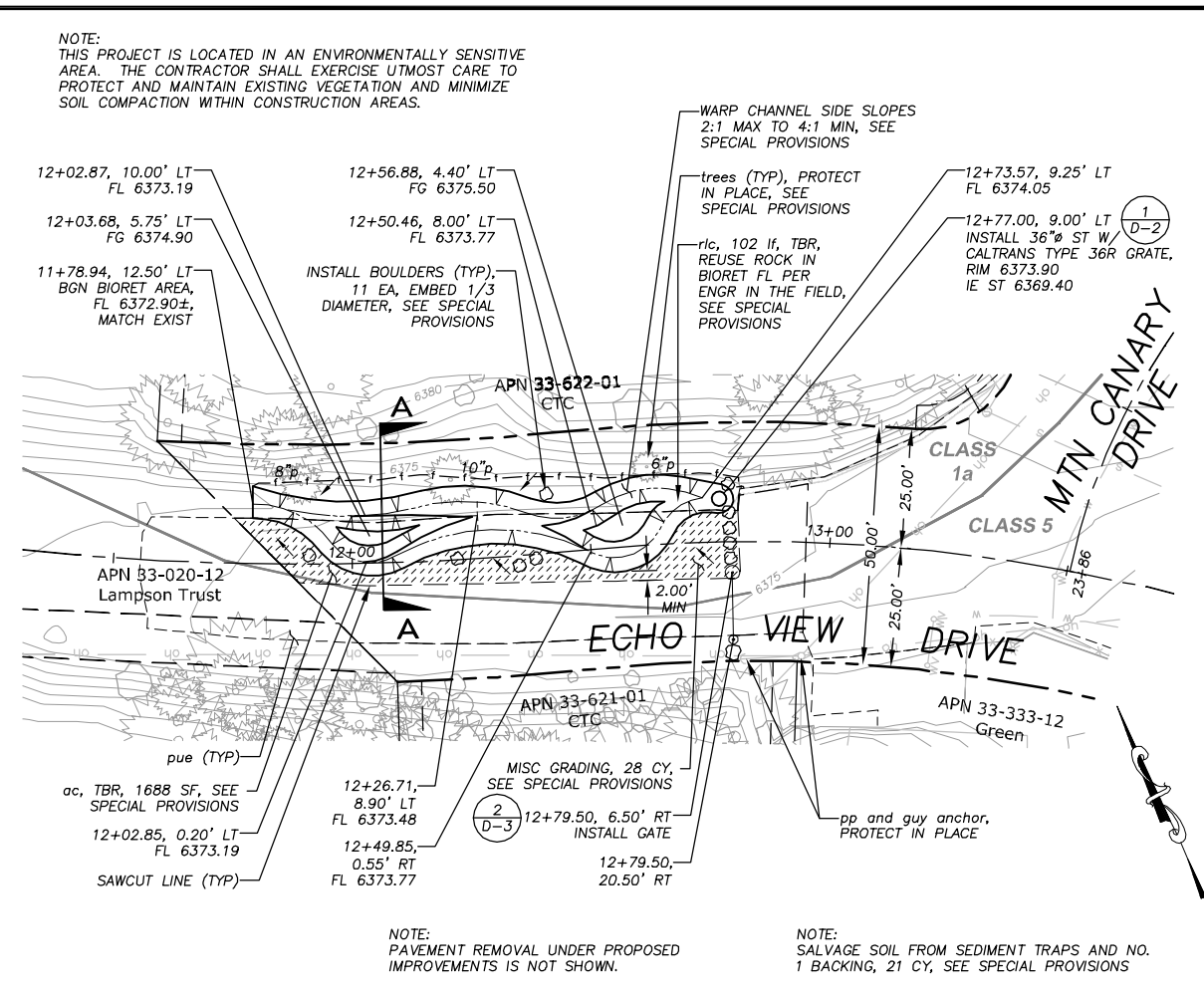
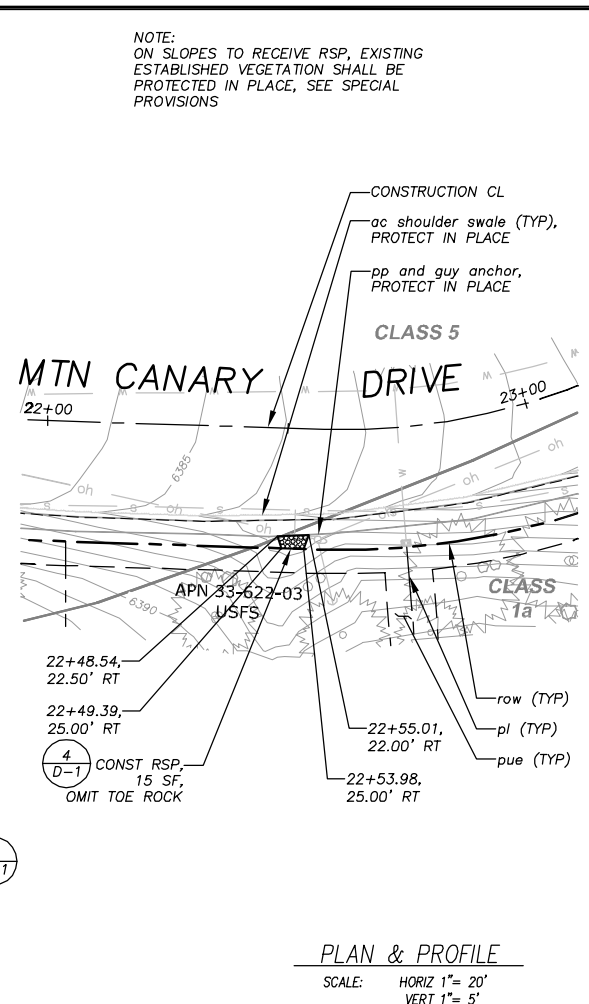

REVISION	NUMBER	DATE	DESCRIPTION	BY

DESIGNED: ALD
DRAWN: ALD
CHECKED: DSP
DATE: 03/2012
ROAD NUMBER: ---

PREPARED UNDER THE SUPERVISION OF:
[Signature]
REGISTERED CIVIL ENGINEER
DATE: 03/20/12

EL DORADO COUNTY
DEPARTMENT OF TRANSPORTATION

ECHO VIEW 2 ECP
MTN CANARY DR & ECHO VIEW DR PLAN & PROFILE
STA 15+75.00 TO STA 17+50.00, STA 22+00.00 TO STA 23+00.00, & STA 11+50.00 TO STA 11+56.00

SHEET P-3
7 OF 17
CONTRACT NO. PW 11-30617
CIP NO. 95169

NOTE: THIS PROJECT IS LOCATED IN AN ENVIRONMENTALLY SENSITIVE AREA. THE CONTRACTOR SHALL EXERCISE UTMOST CARE TO PROTECT AND MAINTAIN EXISTING VEGETATION AND MINIMIZE SOIL COMPACTION WITHIN CONSTRUCTION AREAS.

!! WARNING !!
THE LOCATION AND/OR ELEVATION OF EXISTING UNDERGROUND UTILITIES SHOWN ON THESE PLANS ARE ONLY APPROXIMATE. CONTRACTOR TO VERIFY LOCATION AND ELEVATION OF ALL EXISTING UNDERGROUND UTILITIES.

NOTE: SALVAGE SOIL FROM SEDIMENT TRAPS, PIPE AND FES INSTALLATION, ROCK DISSIPATORS, AND RLCs, 130 CY, SEE SPECIAL PROVISIONS.

NOTE: PROPERTY CORNER AND/OR RIGHT-OF-WAY MONUMENTATION NEAR STA 24+19, 25' LT, AND STA 24+32, 25' LT, DISTURBED BY CONSTRUCTION ACTIVITIES SHALL BE REPLACED BY OTHERS, SEE SPECIAL PROVISIONS.

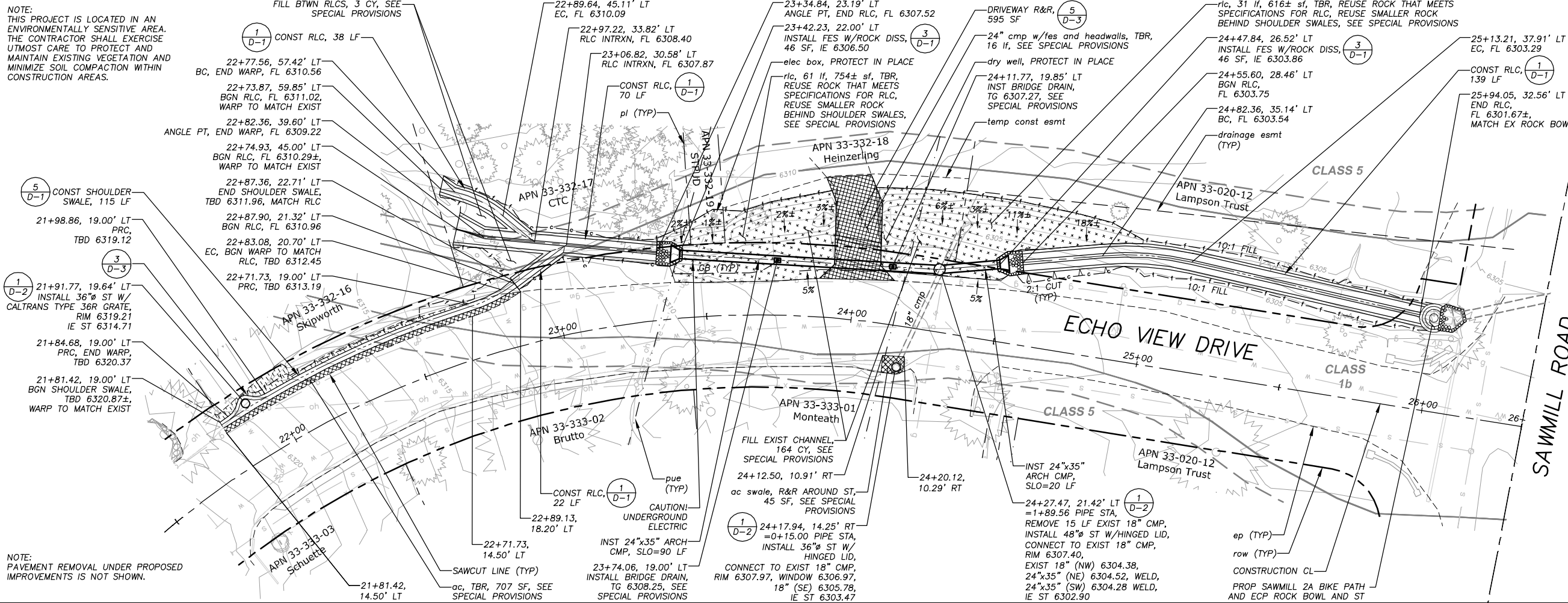

PLAN & PROFILE
SCALE: HORIZ 1" = 20'
VERT 1" = 5'

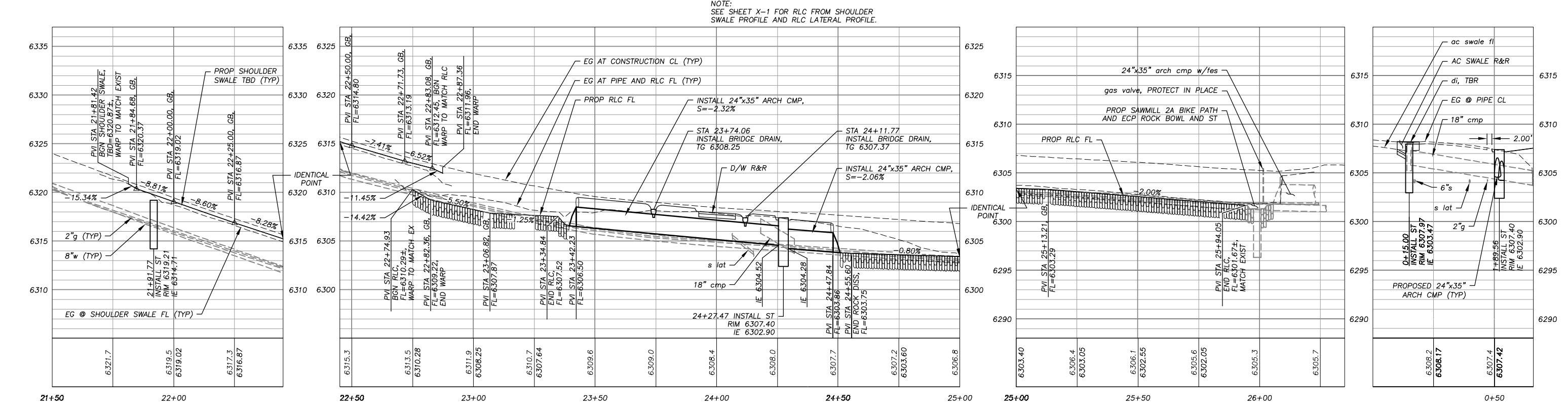

STS NR STA 24+20 LT & RT

DRAWING NAME: S:\VOLUME_30_PROJECTS\Engineering\MP-A\08 02 P-4.dwg
LAYOUT: Tab: P-4, Mar 20/2012 - 10:39am Alden

REVISION	NUMBER	DATE	DESCRIPTION	BY



PREPARED UNDER THE SUPERVISION OF:
[Signature]
REGISTERED CIVIL ENGINEER
DATE: 03/20/12

DESIGNED: ALD
DRAWN: ALD
CHECKED: DSP
DATE: 03/20/12
ROAD NUMBER: ---

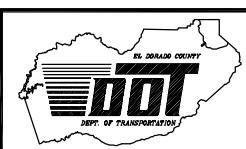

EL DORADO COUNTY
DEPARTMENT OF TRANSPORTATION

ECHO VIEW 2 ECP
ECHO VIEW DRIVE PLAN & PROFILE
STA 21+50.00 TO STA 26+35.00
10-0274.C.8

SHEET
P-4
8 OF 17
CONTRACT NO.
PW 11-30617
CIP NO.
95169

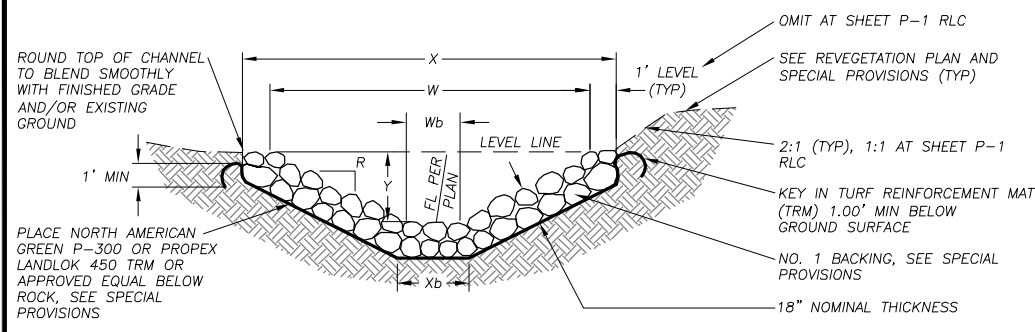

PLAN SHEET	STATIONING	LF	TOP WIDTH, X (EXCAVATION)	TOP WIDTH, W (ROCK FS)	BOTTOM WIDTH, Xb (EXCAVATION)	BOTTOM WIDTH, Wb (ROCK FS)	DEPTH, Y	SLOPE RATIO, R
P-1	12+14.48 TO 12+48.99	35	3.00'	3.00'	---	---	1.00'	1.5:1
P-2	10+99.26 TO 11+70.70	73	5.00'	3.00'	2.24'	1.00'	1.00'	1:1
P-4	22+87.90 TO 23+06.82	22	5.00'	3.00'	---	---	1.00'	1.5:1
P-4	22+73.87 TO 22+97.22	38	5.00'	3.00'	---	---	1.00'	1.5:1
P-4	22+74.93 TO 23+34.84	70	7.70'	5.50'	1.91'	1.00'	1.50'	1.5:1
P-4	24+55.60 TO 25+94.05	139	8.00'	6.00'	2.41'	1.50'	1.50'	1.5:1

- NOTES:
- "Y" DEPICTS MIN REQ'D DEPTH OF CHANNEL. FINISHED TOP WIDTH AND SIDE SLOPE HEIGHT MAY VARY DEPENDING ON EXISTING TERRAIN AND THE NEED TO MAINTAIN A 2' SHOULDER AT ROADWAYS. SEE PLANS AND CROSS-SECTIONS FOR GRADING LIMITS.
 - DUE TO NARROW SITE CONSTRAINTS, THE ROCK USED FOR THE SHEET P-1 RLC SHOULD BE WITHIN THE SMALLER RANGE OF THE SIZES SPECIFIED FOR NO. 1 BACKING IN THE SPECIAL PROVISIONS.
 - SEE SPECIAL PROVISIONS FOR SUBGRADE COMPACTION REQUIREMENTS.

ROCK-LINED CHANNEL

1
D-1

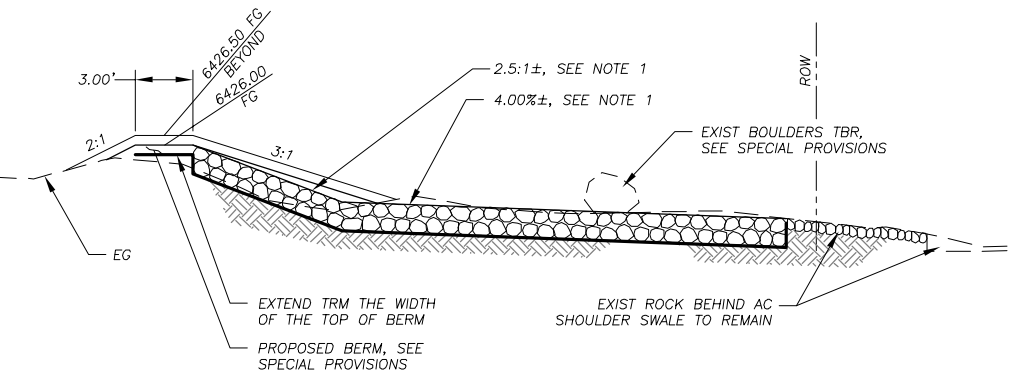
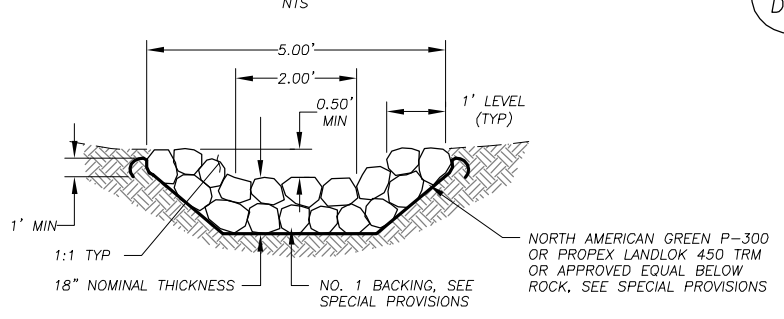

- NOTES:
- SITE CONDITIONS AT TIME OF CONSTRUCTION MAY REQUIRE THE SPILLWAY FL TO BE ALTERED SLIGHTLY FROM THAT SHOWN. CONTRACTOR SHALL MAINTAIN 0.50' MIN FL DEPTH FROM TOE OF 3:1 SLOPE TO WITHIN 5 FEET OF EXISTING ROCK BEHIND AC SHOULDER SWALE. WITHIN THE LAST 5 FEET, CONTRACTOR SHALL FLATTEN SPILLWAY TO MATCH THE GRADE OF THE EXISTING ROCK.
 - SEE SPECIAL PROVISIONS FOR SUBGRADE COMPACTION REQUIREMENTS.

ROCK SPILLWAY

2
D-1

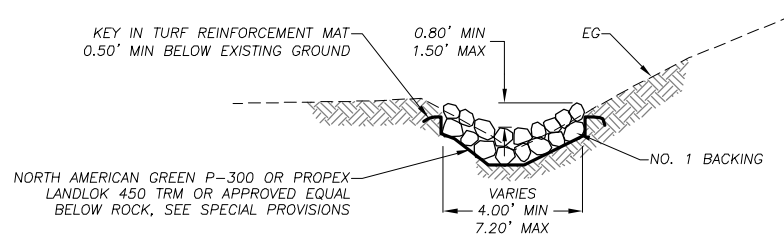
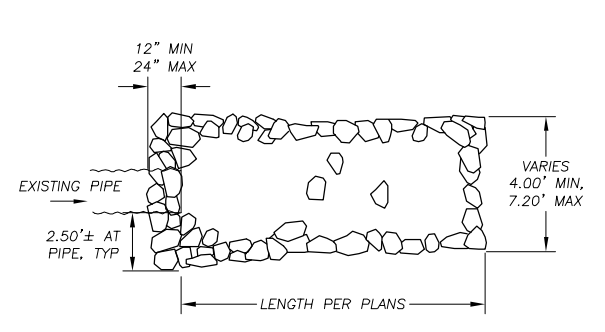

- NOTES:
- SITE CONDITIONS AT TIME OF CONSTRUCTION MAY REQUIRE THE VARIABLE WIDTH DIMENSIONS TO BE ALTERED SLIGHTLY FROM THAT SHOWN.
 - SEE SPECIAL PROVISIONS FOR SUBGRADE COMPACTION REQUIREMENTS.

MTN CANARY DRIVE

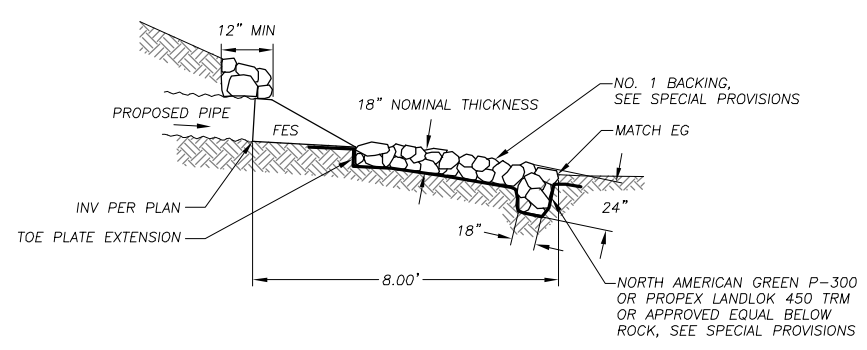
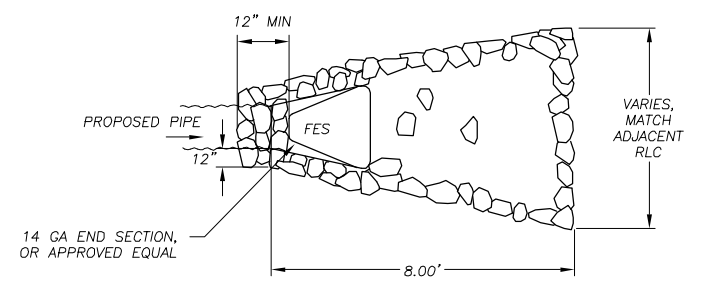

- NOTES:
- ALL FES SHALL BE GALVANIZED.
 - SEE SPECIAL PROVISIONS FOR SUBGRADE COMPACTION REQUIREMENTS.

ECHO VIEW DRIVE

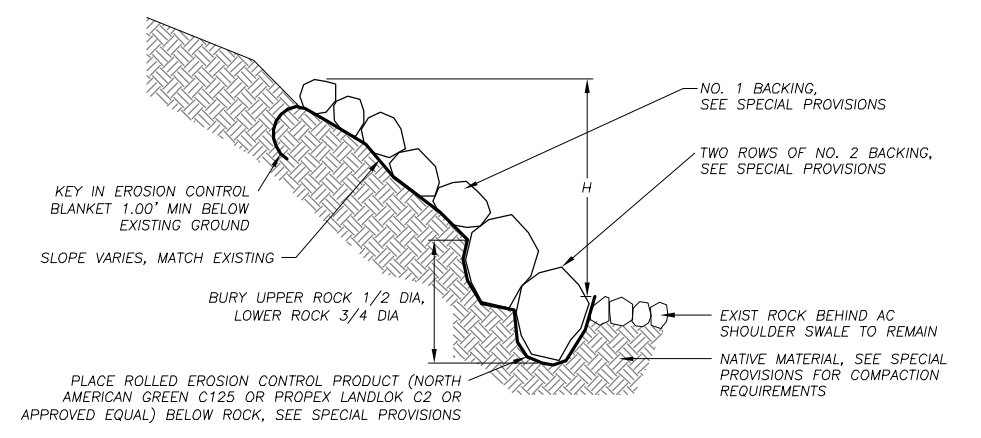

PLAN SHEET	STATIONING	AVERAGE HEIGHT, H	MAXIMUM HEIGHT, H	SLOPE RATIO, R
P-1	10+21.06 TO 11+28.69	13.00'	16.20'	2.5:1 TO 1.4:1

SUMMIT DRIVE

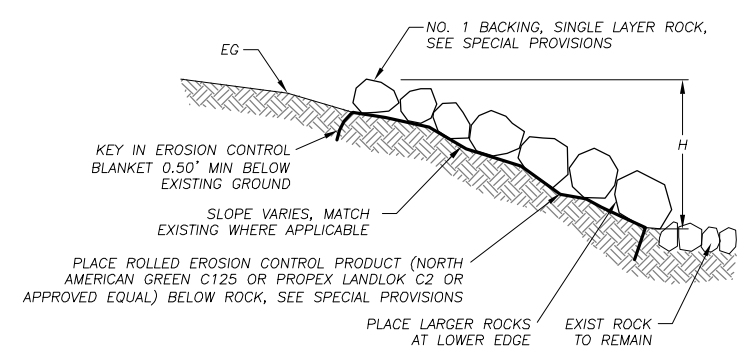

PLAN SHEET	STATIONING	AVERAGE HEIGHT, H	MAXIMUM HEIGHT, H	SLOPE RATIO, R
P-3	22+48.54 TO 22+55.01	1.00'	---	10:1

MTN CANARY DRIVE

- NOTE:
- SEE SPECIAL PROVISIONS FOR SUBGRADE COMPACTION REQUIREMENTS.

ROCK SLOPE PROTECTION

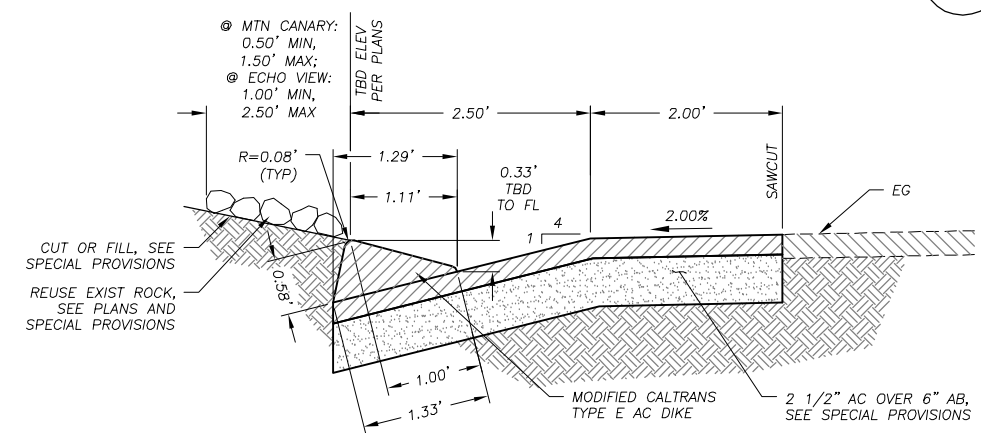

- NOTES:
- SEE DETAIL SHEET D-3 FOR SHOULDER SWALE WARP AROUND ST.
 - SEE SPECIAL PROVISIONS FOR AC, AGGREGATE BASE, AND SUBGRADE COMPACTION REQUIREMENTS.

SHOULDER SWALE

5
D-1

DRAWING NAME: S:\CIVIL_3D_PROJECTS\585659\Engineering\MPL\AK09_EV2_D-1_D-3.dwg

REVISION	NUMBER	DATE	DESCRIPTION	BY



PREPARED UNDER THE SUPERVISION OF:

 REGISTERED CIVIL ENGINEER
 DATE: 03/20/12

DESIGNED: ALD
 DRAWN: ALD
 CHECKED: DSP
 DATE: 03/20/12
 ROAD NUMBER: ---

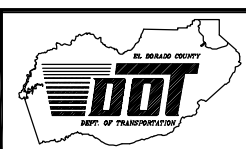

EL DORADO COUNTY
 DEPARTMENT OF TRANSPORTATION

ECHO VIEW 2 ECP
 DETAIL SHEET

SHEET
D-1
 9 OF 17
 CONTRACT NO.
PW 11-30617
 CIP NO.
95169

12-0274.C.S.

Drawing name: S:\CIVIL\3D PROJECTS\58569\Engineering\WPLAN\09_EV2_D-1_D-2.dwg
FOR REDUCED PLANS ORIGINAL SCALE IS IN INCHES
2
1
0

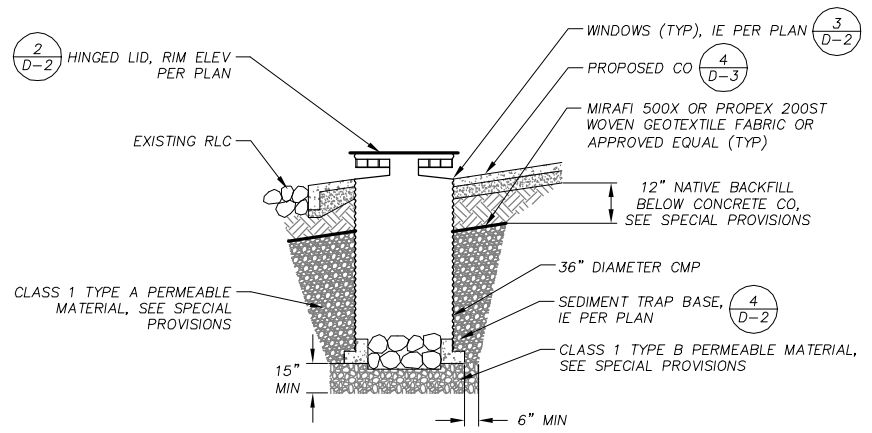

MTN CANARY DRIVE STA 15+45.73

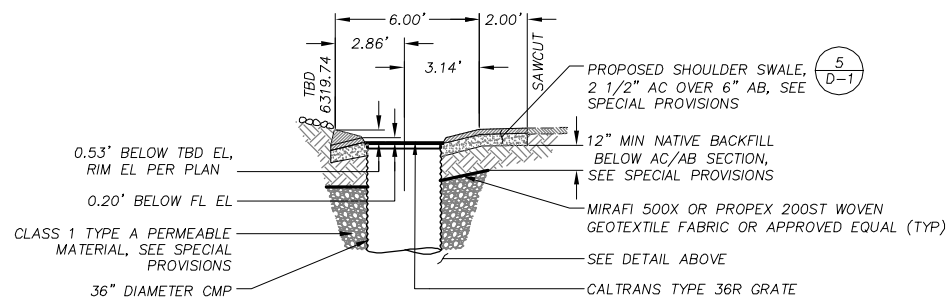

ECHO VIEW DRIVE STA 21+91.77

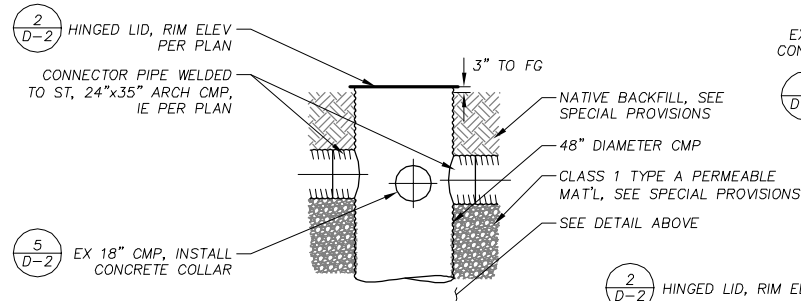

ECHO VIEW DRIVE STA 24+27.47

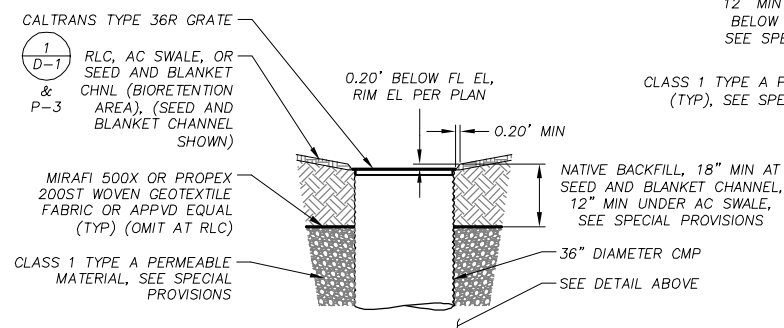

- NOTES:
- SEE REVEGETATION PLAN AND SPECIAL PROVISIONS FOR TREATMENT OF DISTURBED AREAS AROUND SEDIMENT TRAPS.
 - SEE SPECIAL PROVISIONS FOR SUBGRADE AND NATIVE COMPACTION REQUIREMENTS.

SEDIMENT TRAP

NTS

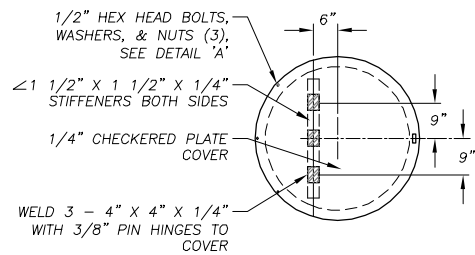

DETAIL 'A'

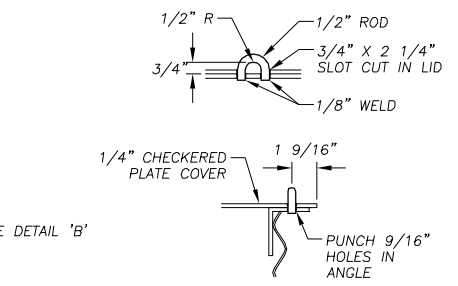

DETAIL 'B'

HINGED LID

NTS

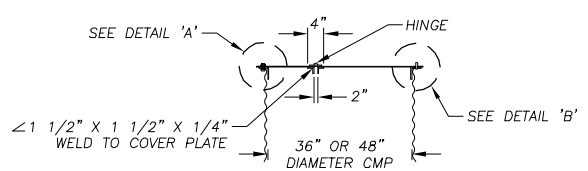

HINGED LID

NTS

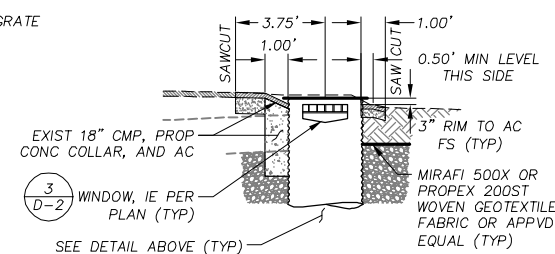

PERPENDICULAR TO ROAD

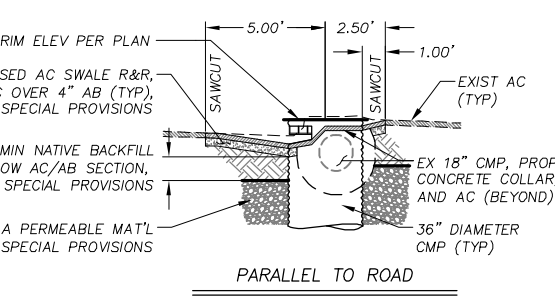

ECHO VIEW DRIVE STA 24+17

PARALLEL TO ROAD

1 D-2

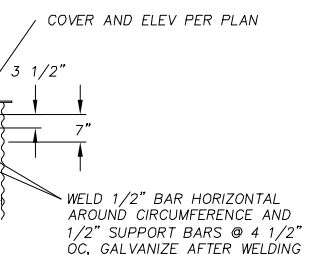

SEDIMENT TRAP WINDOW

NTS

3 D-2

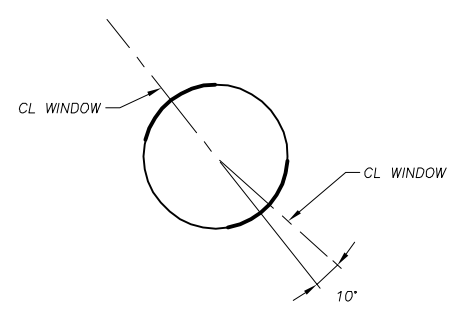

36" SEDIMENT TRAP AT MOUNTAIN CANARY DRIVE STA 15+45.73

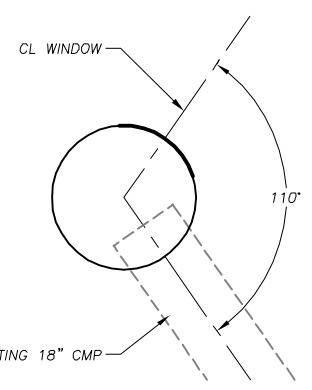

36" SEDIMENT TRAP AT ECHO VIEW DRIVE STA 24+17.94

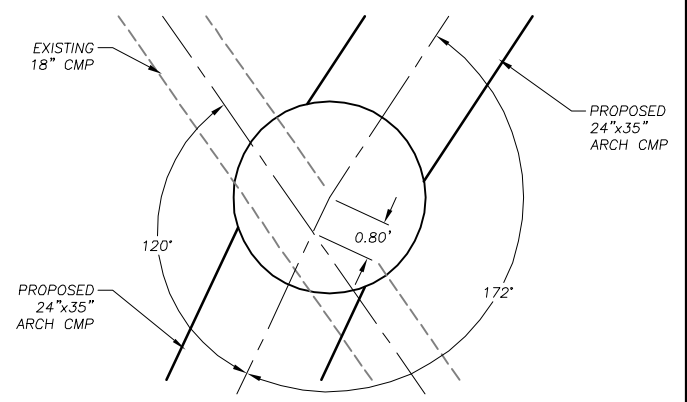

48" SEDIMENT TRAP AT ECHO VIEW DRIVE STA 24+27.47

SEDIMENT TRAP HORIZONTAL CONTROL

NTS

6 D-2

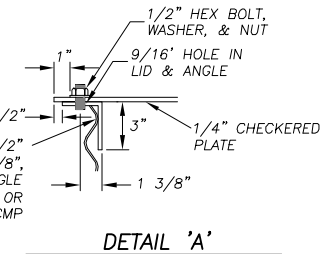

DETAIL 'A'

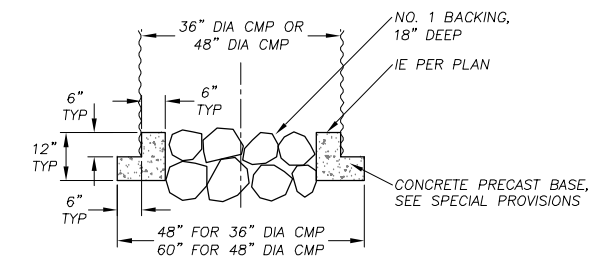

SEDIMENT TRAP BASE

NTS

4 D-2

- NOTES:
- SEE SPECIAL PROVISIONS FOR CONCRETE SPECIFICATIONS.
 - SEE SPECIAL PROVISIONS FOR SUBGRADE COMPACTION REQUIREMENTS.

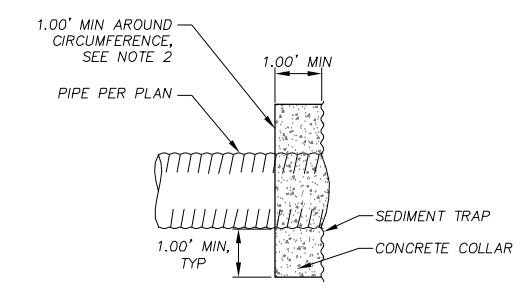

CONCRETE COLLAR

NTS

5 D-2

- NOTES:
- SEE PLANS FOR LOCATIONS WHERE WELDING IS REQUIRED IN PLACE OF CONCRETE COLLARS.
 - FOR ST AT ECHO VIEW STA 24+18 RT, REDUCE CONCRETE HEIGHT TO MATCH AC SUBGRADE.
 - SEE SPECIAL PROVISIONS FOR CONCRETE SPECIFICATIONS.



PREPARED UNDER THE SUPERVISION OF:
David J. ...
REGISTERED CIVIL ENGINEER
DATE: 03/20/12

DESIGNED: ALD
DRAWN: ALD
CHECKED: DSP
DATE: 03/20/12
ROAD NUMBER: ---

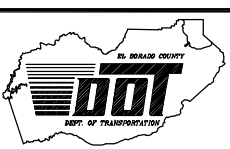

EL DORADO COUNTY
DEPARTMENT OF TRANSPORTATION

ECHO VIEW 2 ECP
DETAIL SHEET

12-0274.C.10

SHEET
D-2
10 OF 17
CONTRACT NO.
PW 11-30617
CIP NO.
95169

REVISION	NUMBER	DATE	DESCRIPTION	BY

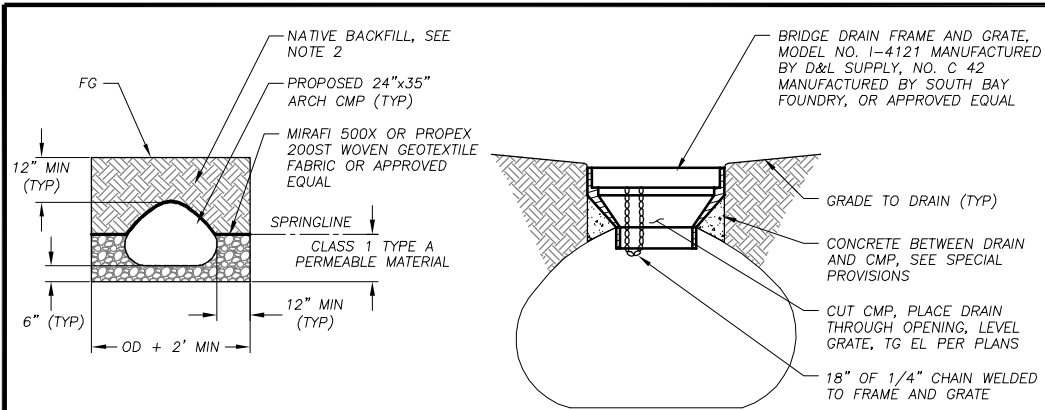

- NOTES:
- SEE SPECIAL PROVISIONS FOR COMPACTION REQUIREMENTS.
 - WHERE 12" MINIMUM COVER CANNOT BE MAINTAINED AT DRIVEWAY CROSSING, SLURRY CEMENT SHALL REPLACE NATIVE BACKFILL, SEE SPECIAL PROVISIONS.

PIPE TRENCH AND BRIDGE DRAIN

1
D-3

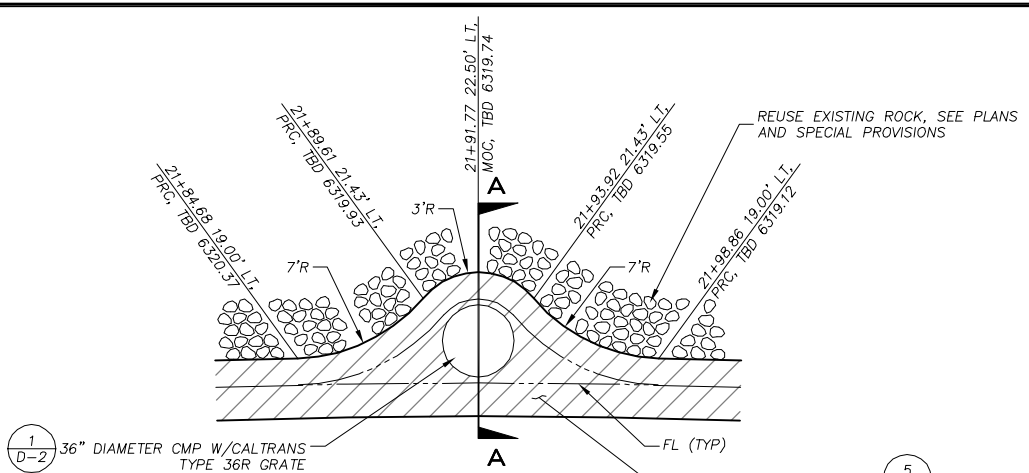

- NOTES:
- STATIONING SHOWN IS ECHO VIEW CL STATIONING.
 - SEE SPECIAL PROVISIONS FOR AC, AGGREGATE BASE, AND SUBGRADE COMPACTION REQUIREMENTS.

SHOULDER SWALE AROUND ST

3
D-3

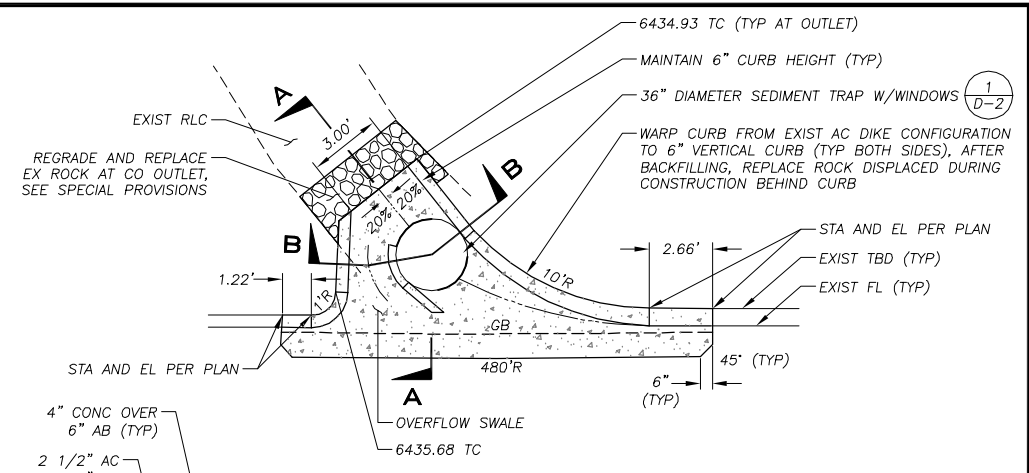

- NOTES:
- SEE SPECIAL PROVISIONS FOR SUBGRADE COMPACTION REQUIREMENTS.

CONCRETE CURB OPENING

4
D-3

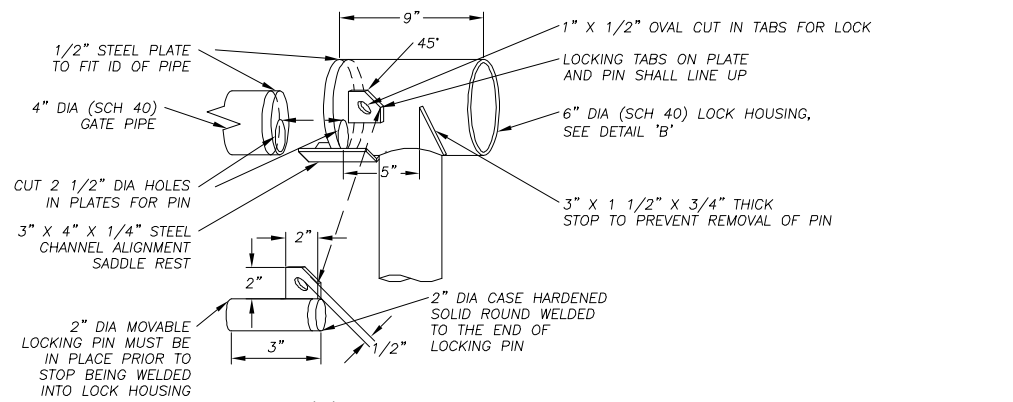

DETAIL 'A'

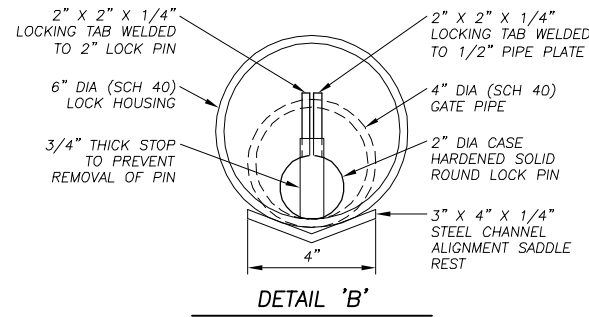

DETAIL 'B'

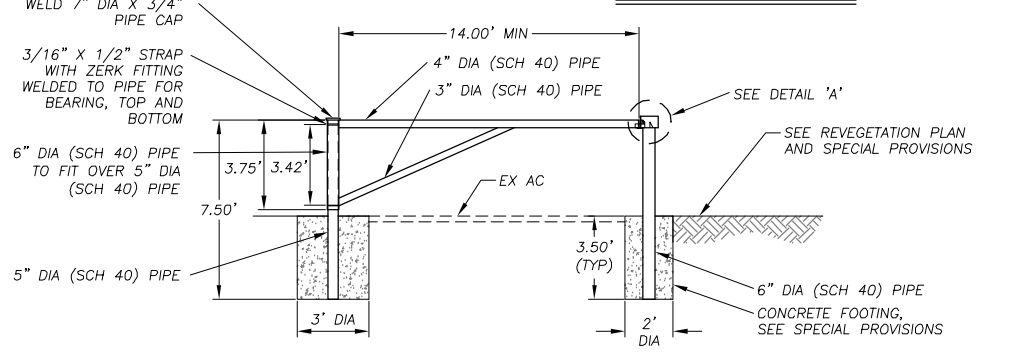

- NOTE:
- ALL PIPES SHALL BE POWDER COATED DARK GREEN AT SHOP PRIOR TO INSTALLATION.

ACCESS GATE

2
D-3

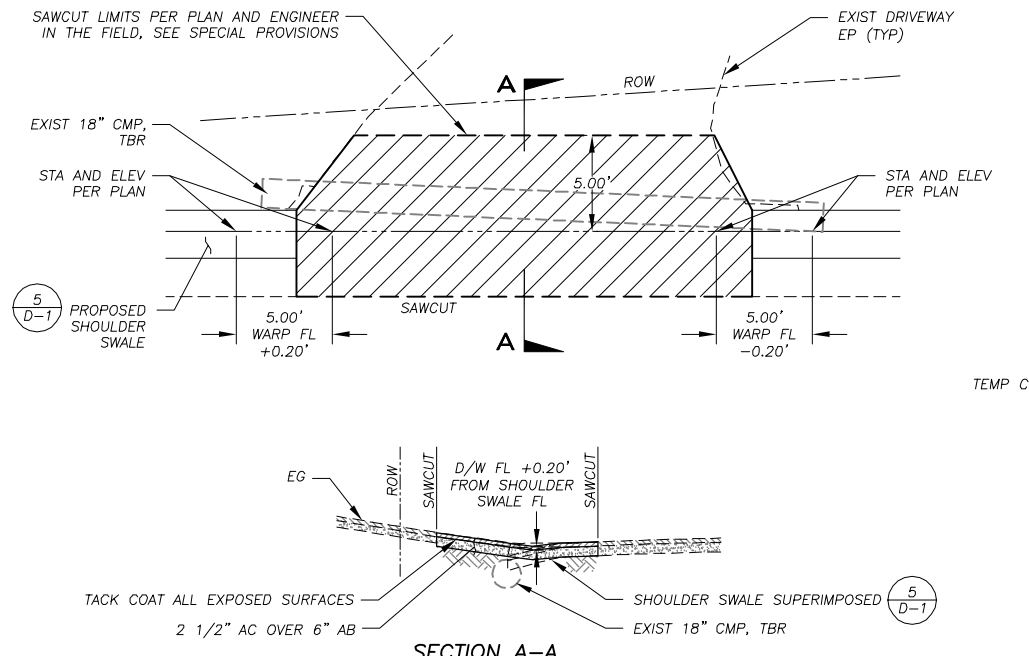

SECTION A-A

MTN CANARY DR STA 13+64

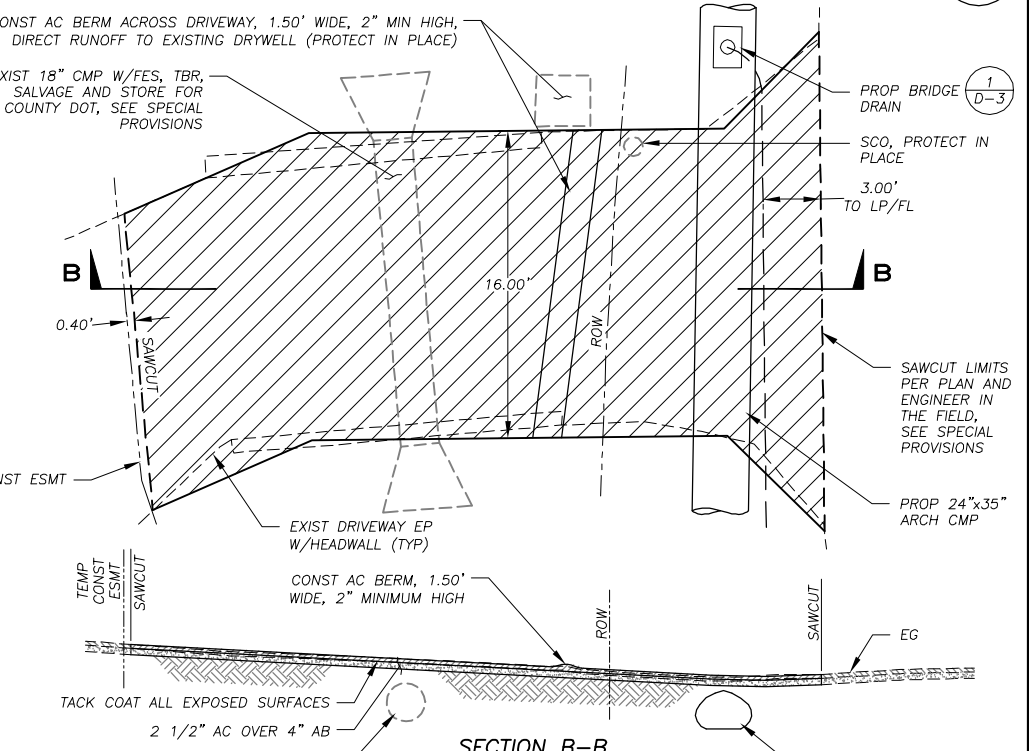

SECTION B-B

ECHO VIEW DR STA 24+00

AC DRIVEWAY R&R

5
D-3

DRAWING NAME: S:\CIVIL\3D PROJECTS\95659\Engineering\PLAN\09 EVO 2-D-3.dwg

ORIGINAL SCALE IS IN INCHES

REVISION	NUMBER	DATE	DESCRIPTION	BY



PREPARED UNDER THE SUPERVISION OF:

 REGISTERED CIVIL ENGINEER
 DATE: 03/20/12

DESIGNED: ALD
 CHECKED: DSP
 ROAD NUMBER: ---



EL DORADO COUNTY
 DEPARTMENT OF TRANSPORTATION

ECHO VIEW 2 ECP
 DETAIL SHEET
 12-0274.C.11

SHEET
 D-3
 11 OF 17
 CONTRACT NO.
 PW 11-30617
 CIP NO.
 95169

FOR REDUCED PLANS ORIGINAL SCALE IS IN INCHES DRAWING NAME: S:\CIVIL 3D PROJECTS\58569\Engineering\PLAN\10 EV2 X-1.dwg

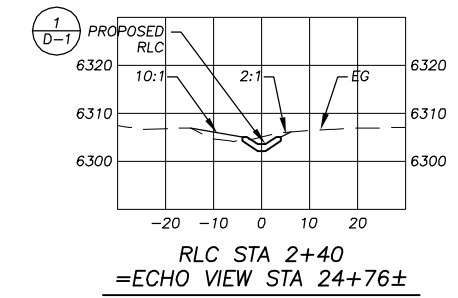
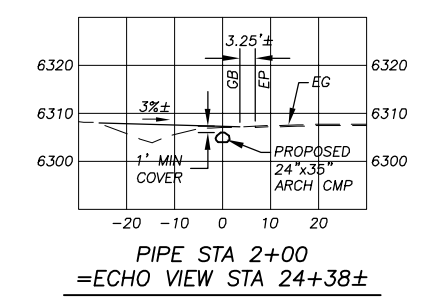
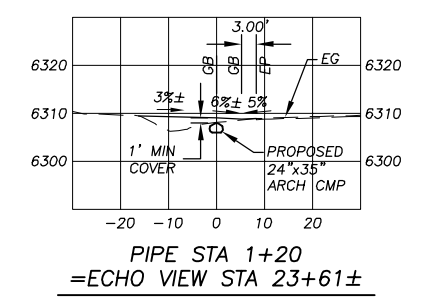
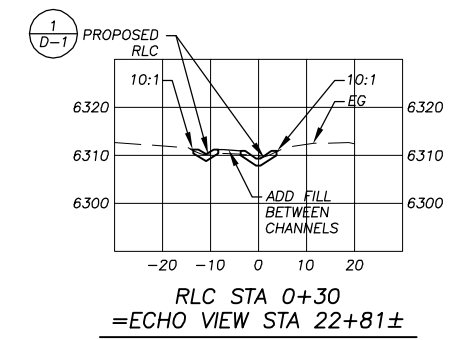
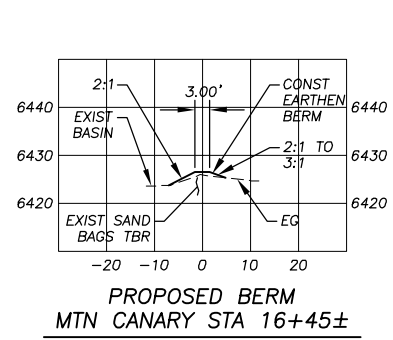

SCALE: HORIZ 1"=20'
VERT 1"=20'

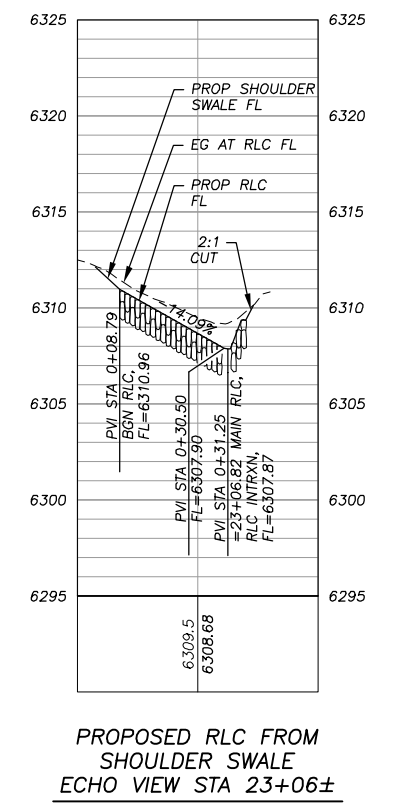
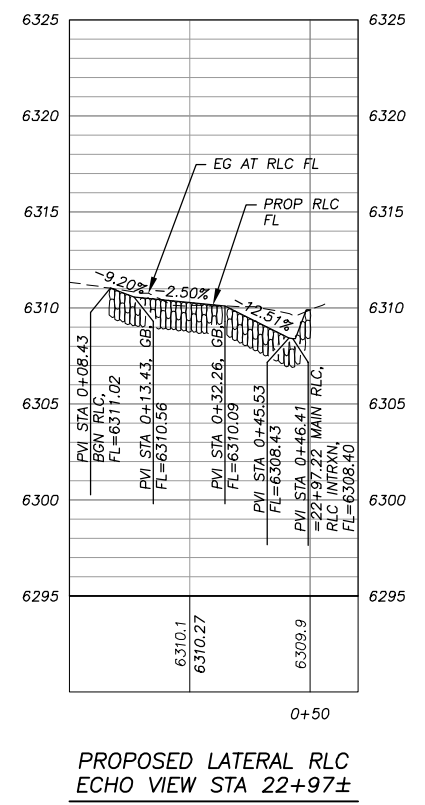

SCALE: HORIZ 1"=20'
VERT 1"=5'

REVISION	NUMBER	DATE	DESCRIPTION	BY



PREPARED UNDER THE SUPERVISION OF:

 REGISTERED CIVIL ENGINEER
 DATE: 03/20/12

DESIGNED: ALD
 DRAWN: ALD
 CHECKED: DSP
 DATE: 03/2012
 ROAD NUMBER: ---

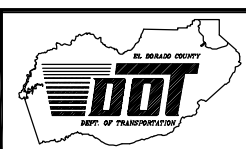

EL DORADO COUNTY
 DEPARTMENT OF TRANSPORTATION

**ECHO VIEW 2 ECP
 CROSS-SECTIONS & RLC PROFILES**
 12-0274.C.12

SHEET
X-1
 12 OF 17
 CONTRACT NO.
PW 11-30617
 CIP NO.
95169

!! WARNING !!

THE LOCATION AND/OR ELEVATION OF EXISTING UNDERGROUND UTILITIES SHOWN ON THESE PLANS ARE ONLY APPROXIMATE. CONTRACTOR TO VERIFY LOCATION AND ELEVATION OF ALL EXISTING UNDERGROUND UTILITIES.

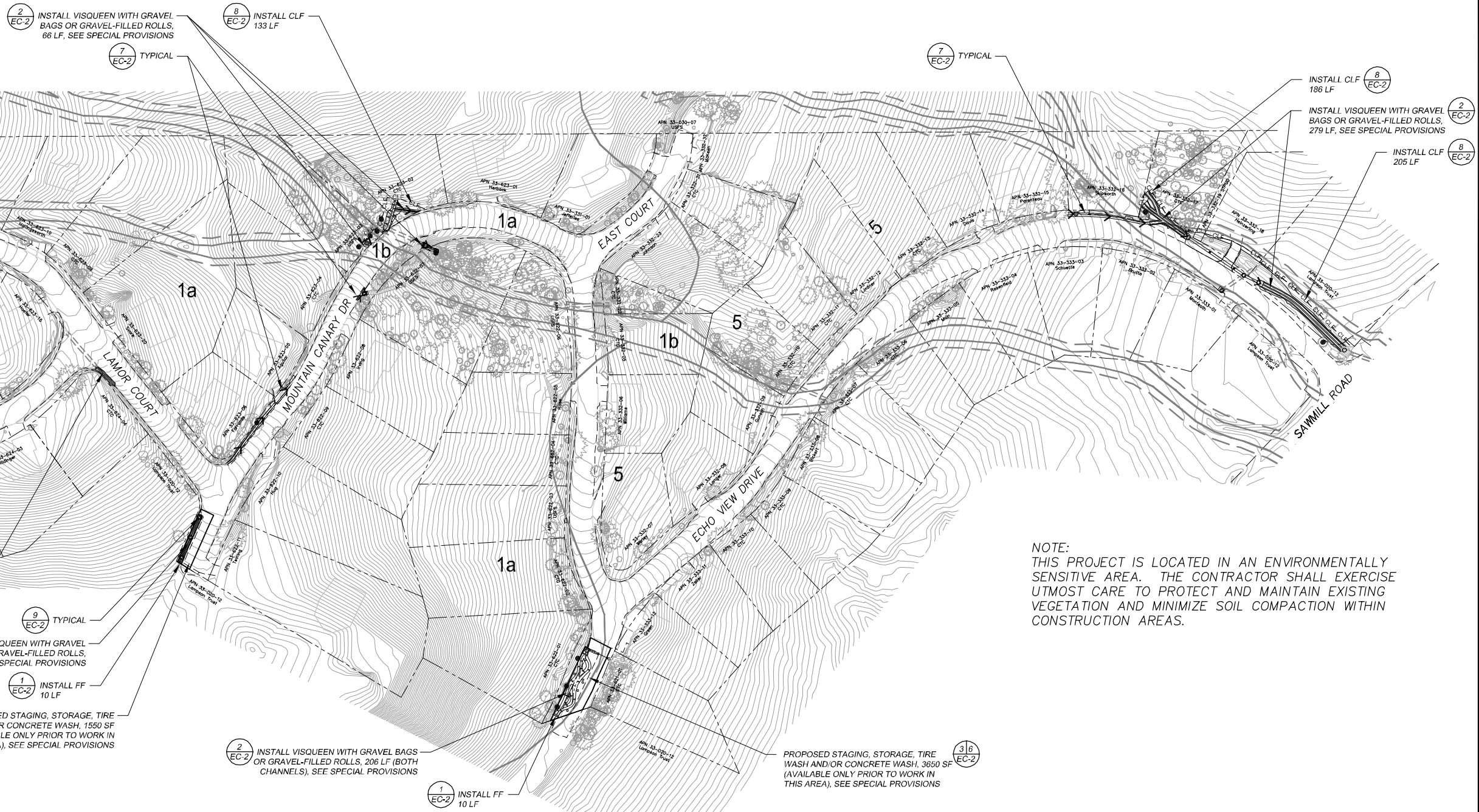

NOTE: THIS PROJECT IS LOCATED IN AN ENVIRONMENTALLY SENSITIVE AREA. THE CONTRACTOR SHALL EXERCISE UTMOST CARE TO PROTECT AND MAINTAIN EXISTING VEGETATION AND MINIMIZE SOIL COMPACTION WITHIN CONSTRUCTION AREAS.

NOTES:

- SEE SPECIAL PROVISIONS FOR SPECIFICATIONS REGARDING FILTER FABRIC, WEIGHTED FIBER ROLLS, GRAVEL BAGS, VISQUEEN, GRAVEL-FILLED ROLLS, AND FENCE POSTS.
- LOCATIONS AND LF OF FILTER FENCE REQUIRED FOR THE STAGING AREAS ARE NOT SHOWN. QUANTITIES FOR THESE AREAS ARE INCLUDED IN THE BID SCHEDULE. THE CONTRACTOR IS TO INCLUDE THESE AREAS IN ITS TEMPORARY EROSION CONTROL PLAN SUBMITTAL.
- DIMENSION LIMITS OF FILTER FENCE AND CONSTRUCTION LIMIT FENCE DO NOT INCLUDE MINIMUM LIMITS FOR TREE PROTECTION. TREE PROTECTION FENCING TO BE PER DETAIL AND/OR AS DETERMINED IN THE FIELD.
- ALL AMOUNTS SHOWN IN BID SCHEDULE ARE ESTIMATES ONLY. CONTRACTOR SHALL MAKE ALL NECESSARY CHANGES TO THE TEMPORARY EROSION CONTROL PLAN WITH ITS SUBMITTAL IN ORDER TO COMPLY WITH TRPA AND LAHONTAN SWPPP REQUIREMENTS.
- CONTRACTOR WILL BE PAID FOR ACTUAL QUANTITIES OF TEMPORARY EROSION CONTROL DEVICES INSTALLED AND SATISFACTORILY MAINTAINED.
- A FINE OF \$100/DAY WILL BE LEVIED AGAINST THE CONTRACTOR FOR EACH DAY CONTRACTOR DELAYS IN RESPONDING TO ENGINEER'S REQUEST TO INSTALL NEW TEMPORARY EROSION CONTROL DEVICES AND OR MAINTAIN EXISTING TEMPORARY EROSION CONTROL DEVICES.

LEGEND

--- COUNTY RIGHT-OF-WAY OR PROPERTY LINE	CLF-CLF-CLF CONSTRUCTION LIMIT FENCE
- - - - - EXISTING EDGE OF PAVEMENT	- FF - FF - FF - FF - FILTER FENCE
--- LAND CAPABILITY BOUNDARY	> PROPOSED SWALE, ROCK DISSIPATOR, ROCK SPILLWAY, AND CO SEDIMENT CONTROL
--- 10' SEZ SETBACK	o PROPOSED OR EXISTING SEDIMENT TRAP
□ PROPOSED STAGING AND STORAGE	--- PROPOSED STORM DRAIN PIPE
- - - - - EXISTING STORM DRAIN PIPE	--- PROPOSED RLC OR ROCK SPILLWAY
• WOODEN TREE TRUNK PROTECTION	▣ PROPOSED ROCK DISSIPATOR (CONFIGURATION APPROX)

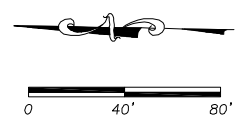

DRAWING NAME: S:\CIVIL_3D\PROJECTS\105838\Engineering\PLAN\11-EC-04.dwg

ORIGINAL SCALE IS IN INCHES

FOR REDUCED PLANS

REVISION	NUMBER	DATE	DESCRIPTION	BY



PREPARED UNDER THE SUPERVISION OF:

 REGISTERED CIVIL ENGINEER 03/20/12
 DATE:

DESIGNED: ALD
 CHECKED: DSP
 ROAD NUMBER: ---

DRAWN: ALD
 DATE: 03/20/12

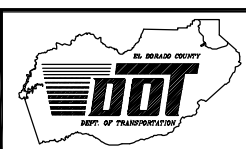

EL DORADO COUNTY
 DEPARTMENT OF TRANSPORTATION

ECHO VIEW 2 ECP
 TEMPORARY EROSION CONTROL
 12-0274.C.13

SHEET
EC-1
 13 OF 17
 CONTRACT NO. PW 11-30617
 CIP NO. 95169

ORIGINAL SCALE IS IN INCHES
 2
 1
 0
 FOR REDUCED PLANS
 REVISION

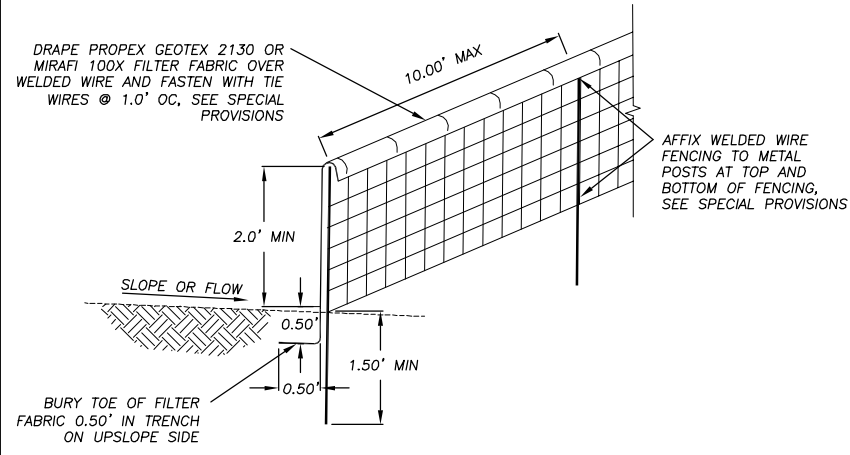

- NOTES:
- CONTRACTOR MAY USE PRE MANUFACTURED SEDIMENT CONTROL FENCE AS APPROVED BY THE ENGINEER, SEE SPECIAL PROVISIONS.
 - PLACE FENCING SUCH THAT STORM RUNOFF CANNOT PASS AROUND OR UNDER FENCE.

FILTER FENCE (FF)
NTS

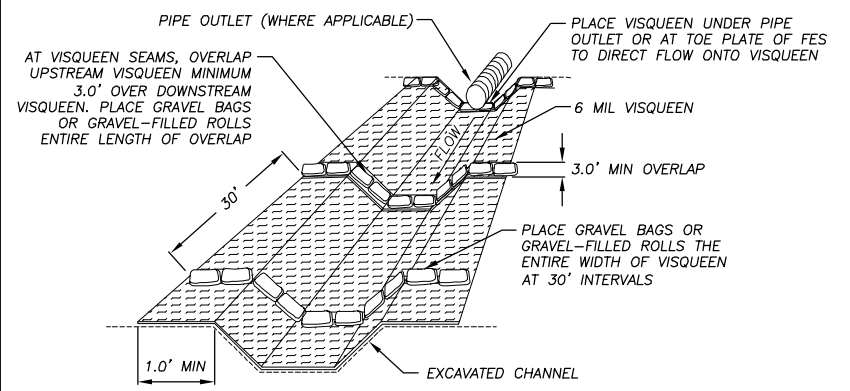

VISQUEEN WITH GRAVEL BAGS OR GRAVEL-FILLED ROLLS
NTS

- GENERAL NOTES:
- SEE SPECIAL PROVISIONS FOR SPECIFICATIONS REGARDING FILTER FABRIC, WEIGHTED FIBER ROLLS, GRAVEL BAGS, VISQUEEN, GRAVEL-FILLED ROLLS, RICE FIBER ROLLS, AND FENCE POSTS.
 - SPACING INTERVALS FOR RICE FIBER ROLL OVER PIPE OUT OF PAVEMENT AND C&G SEDIMENT CONTROL SHALL BE AT 50' OC FOR SLOPES GREATER THAN 5% AND AT 100' OC FOR SLOPES LESS THAN OR EQUAL TO 5%.
 - LOCATIONS AND LF OF FILTER FENCE REQUIRED FOR THE STAGING AREAS ARE NOT SHOWN. THE CONTRACTOR IS TO INCLUDE THESE AREAS IN HIS TEMPORARY EROSION CONTROL PLAN SUBMITTAL.
 - LENGTHS OF FILTER FENCE AND CONSTRUCTION LIMIT FENCE DOES NOT INCLUDE MINIMUM LIMITS FOR TREE PROTECTION. TREE PROTECTION FENCING TO BE PER DETAIL THIS SHEET AND/OR AS DETERMINED IN THE FIELD.

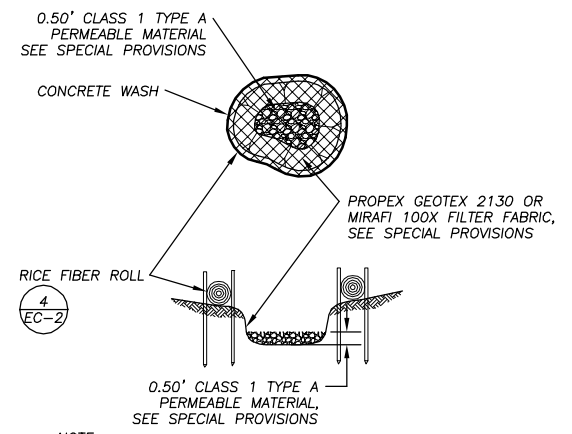

TYPICAL CONCRETE WASH AREA
NTS

NOTE:
CONCRETE WASH SHALL BE SIZED FOR WASHING ALL CONCRETE EQUIPMENT WITHOUT OVERTOPPING BASIN.

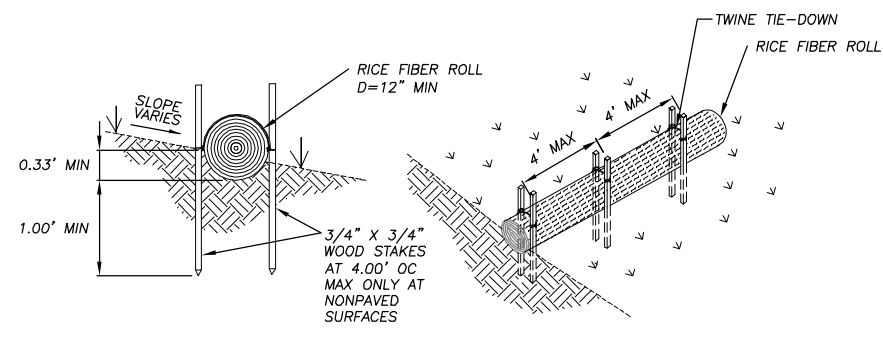

TYPICAL RICE FIBER ROLL INSTALLATION
NTS

NOTE:
INSTALL RICE FIBER ROLL LEVEL ALONG CONTOUR.

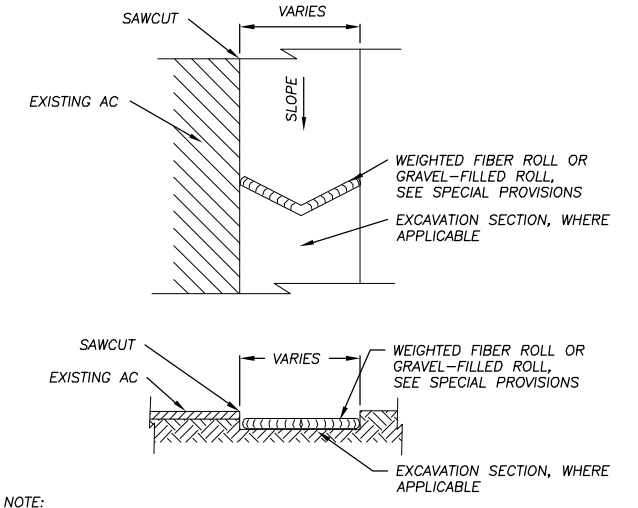

WEIGHTED FIBER ROLLS OR GRAVEL-FILLED ROLLS
NTS

NOTE:
SPACING INTERVALS FOR WEIGHTED FIBER ROLL OR GRAVEL-FILLED ROLL TEMPORARY SEDIMENT CONTROL ON GRADE SHALL BE AT 50' OC FOR SLOPES GREATER THAN 5% AND AT 100' OC FOR SLOPES LESS THAN OR EQUAL TO 5%.

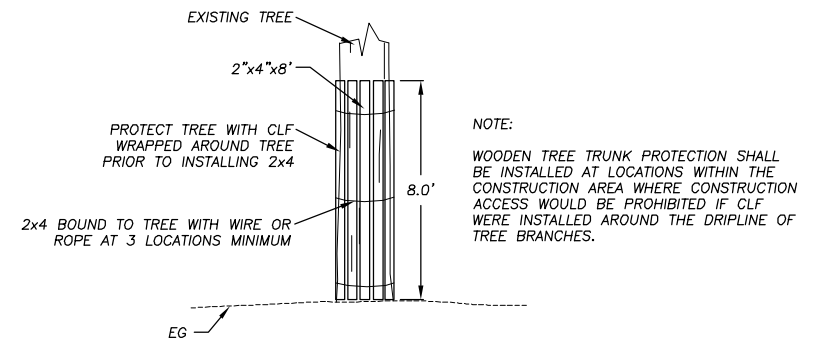

WOODEN TREE TRUNK PROTECTION
NTS

NOTE:
WOODEN TREE TRUNK PROTECTION SHALL BE INSTALLED AT LOCATIONS WITHIN THE CONSTRUCTION AREA WHERE CONSTRUCTION ACCESS WOULD BE PROHIBITED IF CLF WERE INSTALLED AROUND THE DRIFLINE OF TREE BRANCHES.

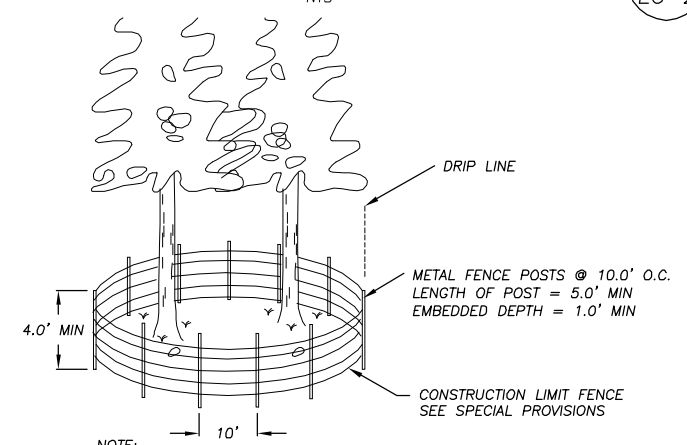

CONSTRUCTION LIMIT FENCE (CLF)
NTS

NOTE:
DETAIL ABOVE IS TYPICAL FOR SOME DRIFLINE LOCATIONS, CONSTRUCTION LIMIT FENCE SHALL BE STAKED IN THE FIELD BY ENGINEER.

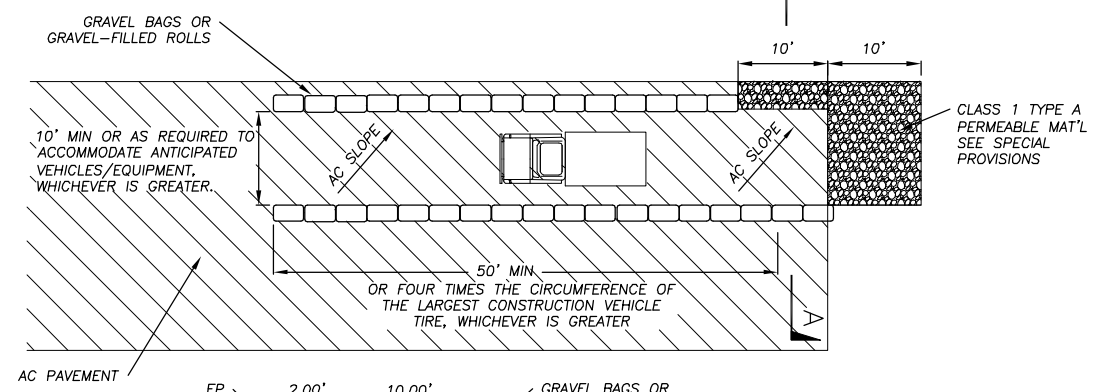

SECTION A-A
TYPICAL TIRE WASH AREA
NTS

NOTE:
POSITION GRAVEL BAGS OR GRAVEL-FILLED ROLLS TO DIVERT RUNOFF TO EXISTING SWALES, WHERE APPLICABLE.

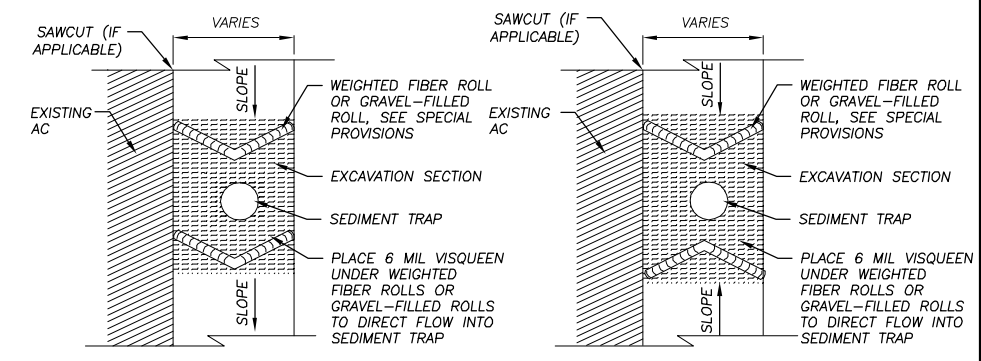

SEDIMENT TRAP INLET PROTECTION
NTS

REVISION	NUMBER	DATE	DESCRIPTION	BY



PREPARED UNDER THE SUPERVISION OF:

 REGISTERED CIVIL ENGINEER
 DATE: 03/20/12

DESIGNED: ALD
 DRAWN: ALD
 CHECKED: DSP
 DATE: 03/20/12
 ROAD NUMBER: ---

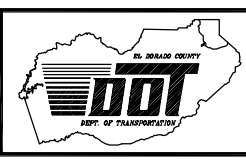

EL DORADO COUNTY
 DEPARTMENT OF TRANSPORTATION

ECHO VIEW 2 ECP
 TEMPORARY EROSION CONTROL DETAILS
 12-0274.C.14

SHEET
EC-2
 14 OF 17
 CONTRACT NO.
PW 11-30617
 CIP NO.
95169

Drawing name: S:\CIVIL 3D PROJECTS\58565\Engineering\MPL\AN13 EV2 R-1.dwg
 ORIGINAL SCALE IS IN INCHES
 FOR REDUCED PLANS

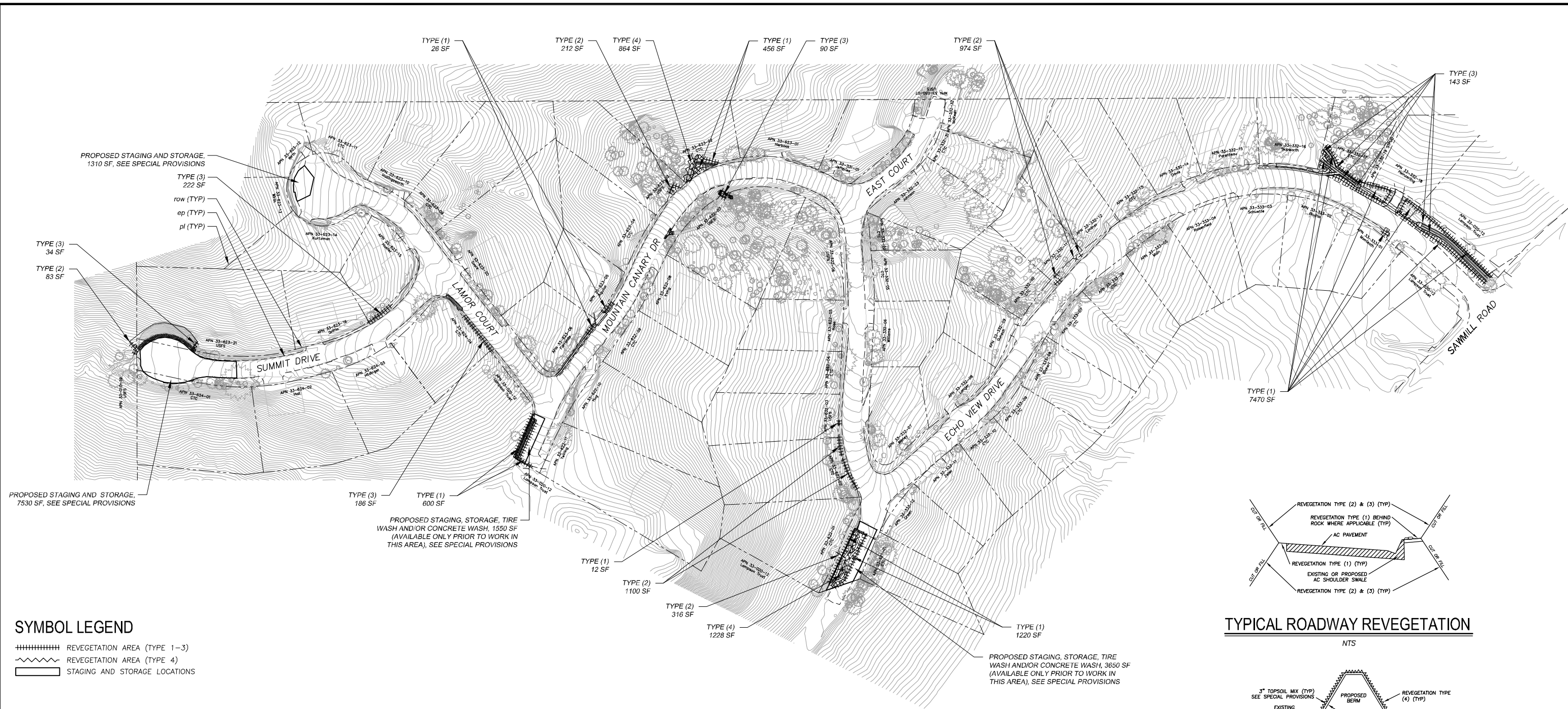

SYMBOL LEGEND

- ||||| REVEGETATION AREA (TYPE 1-3)
- ~ REVEGETATION AREA (TYPE 4)
- ▭ STAGING AND STORAGE LOCATIONS

DEFINITIONS

AMENDMENT - BIOSOL @600 LBS./ACRE (OR EQUAL)
 BLANKET BASIN BOTTOM - SC150BN (OR EQUAL)
 BLANKET SLOPES - CF4 (OR EQUAL)
 MULCH - APPLIED WITH BLOWER EQUIPMENT
 HUMUS - CONTRACTOR SHALL APPLY HUMUS WITH BLOWER EQUIPMENT PER SPECIAL PROVISIONS
 TOPSOIL MIX - CONTRACTOR SHALL BLEND SOIL SALVAGED FROM EXCAVATED AREAS (3 PARTS) WITH HUMUS (1 PART). SEE SPECIAL PROVISIONS.
 TACKIFIER - CONTRACTOR SHALL APPLY WOOD-CELLULOSE FIBER MULCH/TACKIFIER OVER AREAS THAT RECEIVE MULCH. SEE SPECIAL PROVISIONS.

REVEGETATION WORK LEGEND

- TYPE (1) - CONTRACTOR TO PLACE 2" COMPACTED TOPSOIL MIX, CALIFORNIA CONSERVATION CORPS (CCC) TO ADD SEED AND SOIL AMENDMENT, CONTRACTOR TO APPLY 1" MULCH, CONTRACTOR TO APPLY TACKIFIER. SEE SPECIAL PROVISIONS FOR LOCATIONS WHERE SCARIFYING IS REQUIRED.
- TYPE (2) - CCC TO LOOSEN SOIL ON SLOPE, CONTRACTOR TO APPLY 1" HUMUS, CCC TO MIX HUMUS WITH LOOSENED SOIL AND ADD SEED AND SOIL AMENDMENT, CONTRACTOR TO APPLY 1" MULCH, CONTRACTOR TO APPLY TACKIFIER.
- TYPE (3) - CCC TO LOOSEN SOIL ON SLOPE, CONTRACTOR TO APPLY 1" HUMUS, CCC TO MIX HUMUS WITH LOOSENED SOIL AND ADD SEED, SOIL AMENDMENT, AND BLANKET; CONTRACTOR TO APPLY 1" MULCH, CONTRACTOR TO APPLY TACKIFIER.
- TYPE (4) - CONTRACTOR PLACES 3" COMPACTED TOPSOIL MIX IN CHANNEL/BASIN BOTTOM AND/OR ON CHANNEL/BASIN SLOPE/BERMS; CCC PLACE SEED AND BLANKET; CONTRACTOR APPLIES 1" MULCH AND TACKIFIER ON THE TOP OF BASIN BERMS AND ON THE OUTSIDE SLOPES OF BASIN BERMS.
- TYPE (5) - N/A
- TYPE (6) - N/A
- TYPE (7) - N/A

NOTES

1. REVEGETATION TYPE (1) FOR AREAS ADJACENT TO SHOULDER SWALE INSTALLATION, ROAD SHOULDERING, ROCK DISSIPATORS, PIPE INSTALLATION, FILLING THE EXISTING CHANNEL, MISCELLANEOUS GRADING, DISTURBED AREAS ADJACENT TO IMPROVEMENTS, AND STAGING AREAS, UNLESS NOTED OTHERWISE.
2. REVEGETATION TYPE (2) FOR AREAS ADJACENT TO SWALES/CHANNELS, AND ON SLOPES EQUAL TO OR FLATTER THAN 3:1.
3. REVEGETATION TYPE (3) FOR AREAS ADJACENT TO SWALES/CHANNELS, AND ON SLOPES STEEPER THAN 3:1.
4. REVEGETATION TYPE (4) FOR AREAS ASSOCIATED WITH THE BIORETENTION AREA CHANNELS AND BASIN BERM.
5. AMENDMENT AND MULCH SHALL NOT BE APPLIED TO AREAS WITHIN BASINS OR CHANNELS.
6. ALL REVEGETATION AREAS DESCRIBED ABOVE WILL BE IRRIGATED WITH A WATER TRUCK BY THE COUNTY FOR TWO YEARS FOLLOWING INSTALLATION TO ENSURE OPTIMUM PLANT SURVIVAL.
7. SEE PLAN SHEETS FOR SOIL SALVAGE LOCATIONS AND QUANTITIES.
8. SEE SPECIAL PROVISIONS FOR LOCATIONS WHERE SCARIFYING IS REQUIRED PRIOR TO REVEGETATION TREATMENT.

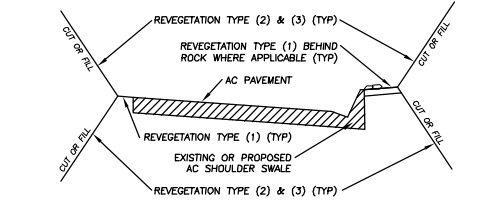

TYPICAL ROADWAY REVEGETATION
NTS

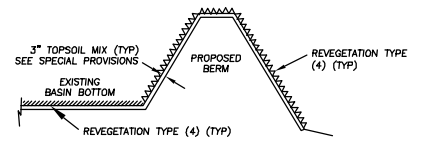

TYPICAL BERM REVEGETATION
NTS

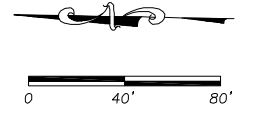

REVISION	NUMBER	DATE	DESCRIPTION	BY



PREPARED UNDER THE SUPERVISION OF:

 REGISTERED CIVIL ENGINEER
 DATE: 03/20/12

DESIGNED: ALD
 DRAWN: ALD
 CHECKED: DSP
 DATE: 03/20/12
 ROAD NUMBER: ---

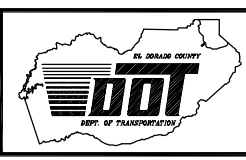

EL DORADO COUNTY
 DEPARTMENT OF TRANSPORTATION

ECHO VIEW 2 ECP
REVEGETATION PLAN
 12-0274.C.15

SHEET
R-1
 15 OF 17
 CONTRACT NO.
PW 11-30617
 CIP NO.
95169

Drawing name: S:\CIVIL 3D PROJECTS\58565\Engineering\PLAN\14 EV2 T-1.dwg

FOR REDUCED PLANS ORIGINAL SCALE IS IN INCHES

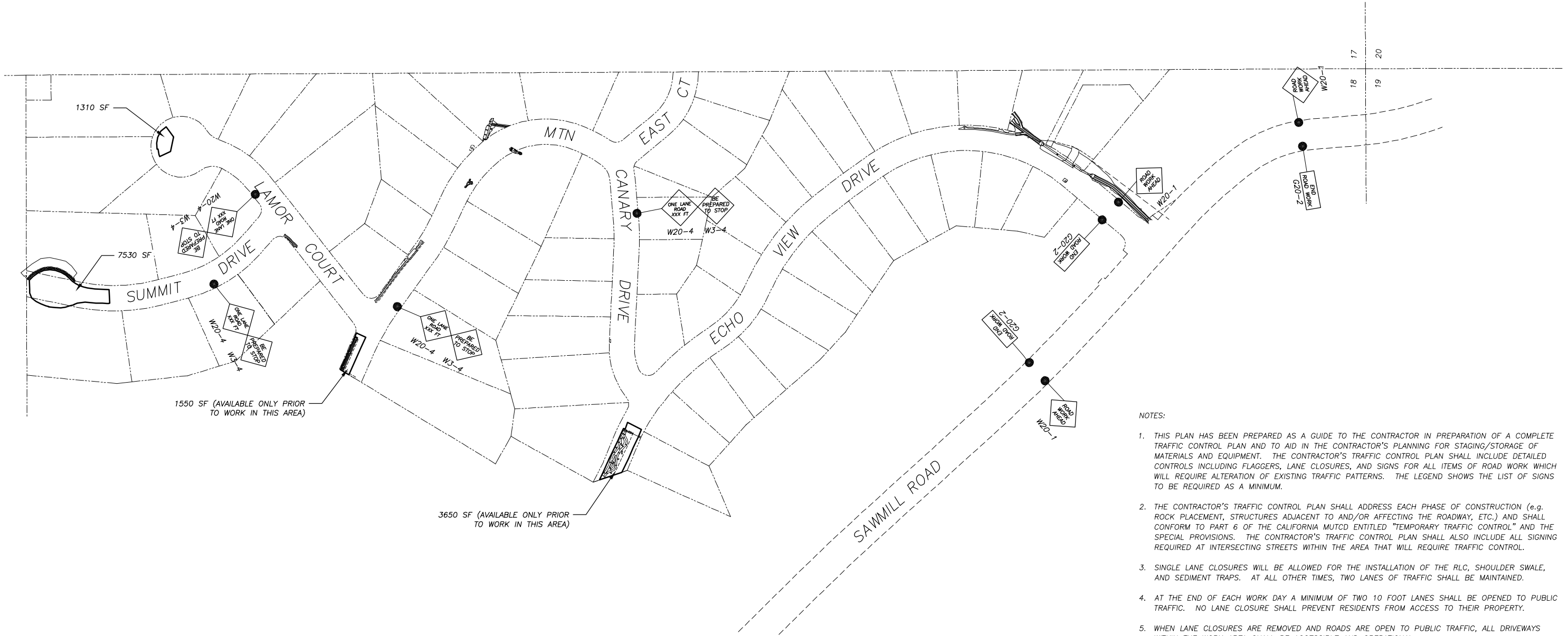

LEGEND

- PROPOSED STAGING AREA WITH SF
- APPROXIMATE SIGN LOCATION
- W20-1 "ROAD WORK AHEAD" SIGN
- W20-4 "ONE LANE ROAD XXX FT" SIGN
- G20-2 "END ROAD WORK" SIGN
- W3-4 "BE PREPARED TO STOP" SIGN

NOTES:

1. THIS PLAN HAS BEEN PREPARED AS A GUIDE TO THE CONTRACTOR IN PREPARATION OF A COMPLETE TRAFFIC CONTROL PLAN AND TO AID IN THE CONTRACTOR'S PLANNING FOR STAGING/STORAGE OF MATERIALS AND EQUIPMENT. THE CONTRACTOR'S TRAFFIC CONTROL PLAN SHALL INCLUDE DETAILED CONTROLS INCLUDING FLAGGERS, LANE CLOSURES, AND SIGNS FOR ALL ITEMS OF ROAD WORK WHICH WILL REQUIRE ALTERATION OF EXISTING TRAFFIC PATTERNS. THE LEGEND SHOWS THE LIST OF SIGNS TO BE REQUIRED AS A MINIMUM.
2. THE CONTRACTOR'S TRAFFIC CONTROL PLAN SHALL ADDRESS EACH PHASE OF CONSTRUCTION (e.g. ROCK PLACEMENT, STRUCTURES ADJACENT TO AND/OR AFFECTING THE ROADWAY, ETC.) AND SHALL CONFORM TO PART 6 OF THE CALIFORNIA MUTCD ENTITLED "TEMPORARY TRAFFIC CONTROL" AND THE SPECIAL PROVISIONS. THE CONTRACTOR'S TRAFFIC CONTROL PLAN SHALL ALSO INCLUDE ALL SIGNING REQUIRED AT INTERSECTING STREETS WITHIN THE AREA THAT WILL REQUIRE TRAFFIC CONTROL.
3. SINGLE LANE CLOSURES WILL BE ALLOWED FOR THE INSTALLATION OF THE RLC, SHOULDER SWALE, AND SEDIMENT TRAPS. AT ALL OTHER TIMES, TWO LANES OF TRAFFIC SHALL BE MAINTAINED.
4. AT THE END OF EACH WORK DAY A MINIMUM OF TWO 10 FOOT LANES SHALL BE OPENED TO PUBLIC TRAFFIC. NO LANE CLOSURE SHALL PREVENT RESIDENTS FROM ACCESS TO THEIR PROPERTY.
5. WHEN LANE CLOSURES ARE REMOVED AND ROADS ARE OPEN TO PUBLIC TRAFFIC, ALL DRIVEWAYS WITHIN THE WORK AREA SHALL BE ACCESSIBLE AND OPERATIONAL.
6. THE CONTRACTOR SHALL NOT EXCAVATE MORE THAN CAN BE INSTALLED AND BACKFILLED IN ONE WORKING DAY.
7. CONTRACTOR'S TRAFFIC CONTROL PLAN SHALL INCLUDE SIGNAGE ON SAWMILL ROAD FOR TRAFFIC CONTROL RELATED TO TRUCKS ENTERING THE ROADWAYS FROM THE PROJECT.
8. CONTRACTOR'S ATTENTION IS DIRECTED TO THE SWPPP, TEMPORARY EROSION CONTROL AND REVEGETATION PLAN SHEETS, AND THE SPECIAL PROVISIONS REGARDING TEMPORARY EROSION CONTROL REQUIREMENTS FOR STAGING AREAS.
9. STAGING AREAS SHOWN ARE FOR THE TEMPORARY STORAGE OF CONSTRUCTION MATERIALS AND EQUIPMENT WHICH ARE TO BE USED ON THIS PROJECT. SEE SPECIAL PROVISIONS FOR STAGING/STORAGE REQUIREMENTS AND REQUIREMENTS TO SPREAD WOOD CHIPS ON UNPAVED STAGING/STORAGE AREAS.

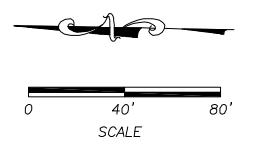

REVISION	NUMBER	DATE	DESCRIPTION	BY



PREPARED UNDER THE SUPERVISION OF:

 REGISTERED CIVIL ENGINEER
 DATE: 03/20/12

DESIGNED: ALD
 DRAWN: ALD
 CHECKED: DSP
 DATE: 03/2012
 ROAD NUMBER: ---

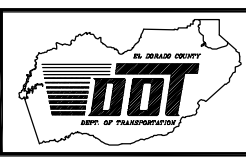

EL DORADO COUNTY
 DEPARTMENT OF TRANSPORTATION

ECHO VIEW 2 ECP
TRAFFIC CONTROL PLAN
 12-0274.C.16

SHEET
T-1
 16 OF 17
 CONTRACT NO. PW 11-30617
 CIP NO. 95169

FOR REDUCED PLANS
 ORIGINAL SCALE IS IN INCHES
 2
 1
 0
 Drawing name: S:\CIVIL 3D PROJECTS\85169\Engineering\PLAN\15 EV2 L-1.dwg

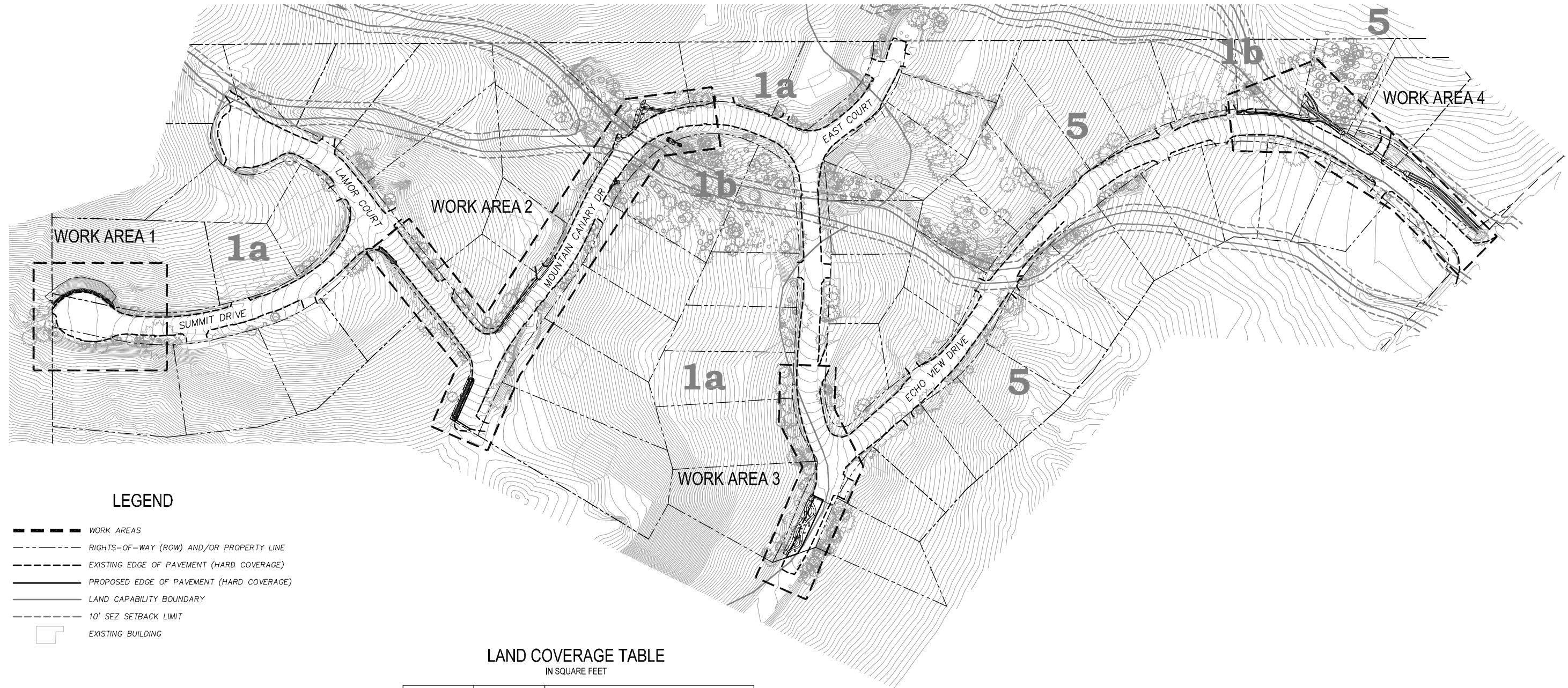

LEGEND

- WORK AREAS
- - - RIGHTS-OF-WAY (ROW) AND/OR PROPERTY LINE
- EXISTING EDGE OF PAVEMENT (HARD COVERAGE)
- PROPOSED EDGE OF PAVEMENT (HARD COVERAGE)
- LAND CAPABILITY BOUNDARY
- 10' SEZ SETBACK LIMIT
- EXISTING BUILDING

LAND COVERAGE TABLE
IN SQUARE FEET

	WORK AREA	LAND CAPABILITY CLASSIFICATIONS					
		1a		1b		5	
		Hard	Soft	Hard	Soft	Hard	Soft
EXISTING	1	8272	827	0	0	0	0
	2	27716	3395	1060	161	0	0
	3	4261	547	0	0	8307	727
	4	0	0	8949	996	5787	822
TOTAL		40249	4769	10009	1157	14094	1549
PROPOSED	1	8272	827	0	0	0	0
	2	27315	3375	1060	161	0	0
	3	2727	505	0	0	8147	781
	4	0	0	8956	948	5606	824
TOTAL		38314	4707	10016	1109	13753	1605
COVERAGE TRANSFER (IN)/OUT		1935	62	-7	48	341	-56

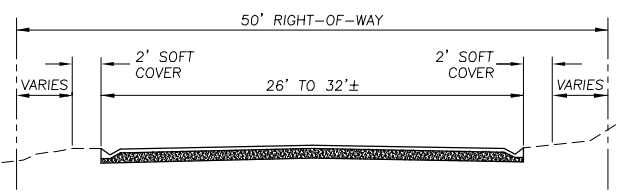

TYPICAL ROADWAY SECTION

NTS

- NOTES:
- A 2 FT ROAD SHOULDER, AS SHOWN, WAS DEFINED AS SOFT COVER THROUGHOUT THE PROJECT AREA.
 - LAND CAPABILITY WAS VERIFIED BY TRPA 10/07.
 - NO ADDITIONAL COVERAGE IS PROPOSED WITHIN AN SEZ AREA, THEREFORE NO MITIGATION IS NEEDED. TRPA CODE 20.3.C(2)(e).

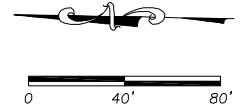

REVISION	NUMBER	DATE	DESCRIPTION	BY



PREPARED UNDER THE SUPERVISION OF:
[Signature]
 REGISTERED CIVIL ENGINEER
 DATE: 03/20/12

DESIGNED: ALD
 DRAWN: ALD
 CHECKED: DSP
 DATE: 03/20/12
 ROAD NUMBER: ---

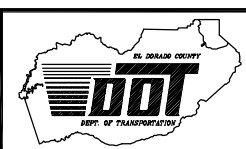

EL DORADO COUNTY
 DEPARTMENT OF TRANSPORTATION

ECHO VIEW 2 ECP
 LAND COVERAGE
 12-0274.C.17

SHEET
L-1
 17 OF 17
 CONTRACT NO.
PW 11-30617
 CIP NO.
95169