

Section 8.2
Tahoe EIP
Individual Project Summaries



Abrasives Study

CIP Project Summary

Project No: 95961

Type: Miscellaneous

Supervisor District(s) 5

Project Description:

Evaluation of alternative abrasives and road sweeping/vacuuming as source control BMPs for load reduction of fine sediment particles and phosphorus in urban roadway stormwater. Tahoe Engineering will be working with the Principal investigators from Texas Southern University and UC Davis to conduct the following research. The results of study will provide the County additional information to assist with achieving the State Water Quality Control Board Lahontan Region National Pollutant Discharge Elimination System Permit requirements.

Original Budget: \$39,339

Expenditures thru 6/30/2012: \$0

Project Initiation Date: 05/25/12

Revenue	by Funding Source	Prior FY*	FY 13/14	FY 14/15	FY 15/16	FY 16/17	FY 17/18	FY 18/19- 22/23	FY 23/24- 32/33	Total
Miscellaneous Reimbursement		\$8	\$26	\$6	\$0	\$0	\$0	\$0	\$0	\$39
Total		\$8	\$26	\$6	\$0	\$0	\$0	\$0	\$0	\$39

Expenditures	Prior FY*	FY 13/14	FY 14/15	FY 15/16	FY 16/17	FY 17/18	FY 18/19- 22/23	FY 23/24- 32/33	Total
Environmental Monitoring	\$0	\$4	\$0	\$0	\$0	\$0	\$0	\$0	\$4
Env Monitoring - Staff	\$8	\$22	\$6	\$0	\$0	\$0	\$0	\$0	\$35
Total	\$8	\$26	\$6	\$0	\$0	\$0	\$0	\$0	\$39

*Prior FY includes actual revenue and expenditures through 06/30/12, plus amounts budgeted through 06/30/13.



Apache Avenue/US 50 Intersection Signalization

CIP Project Summary

Project No: 73120

Type: Intersection

Supervisor District(s) 5

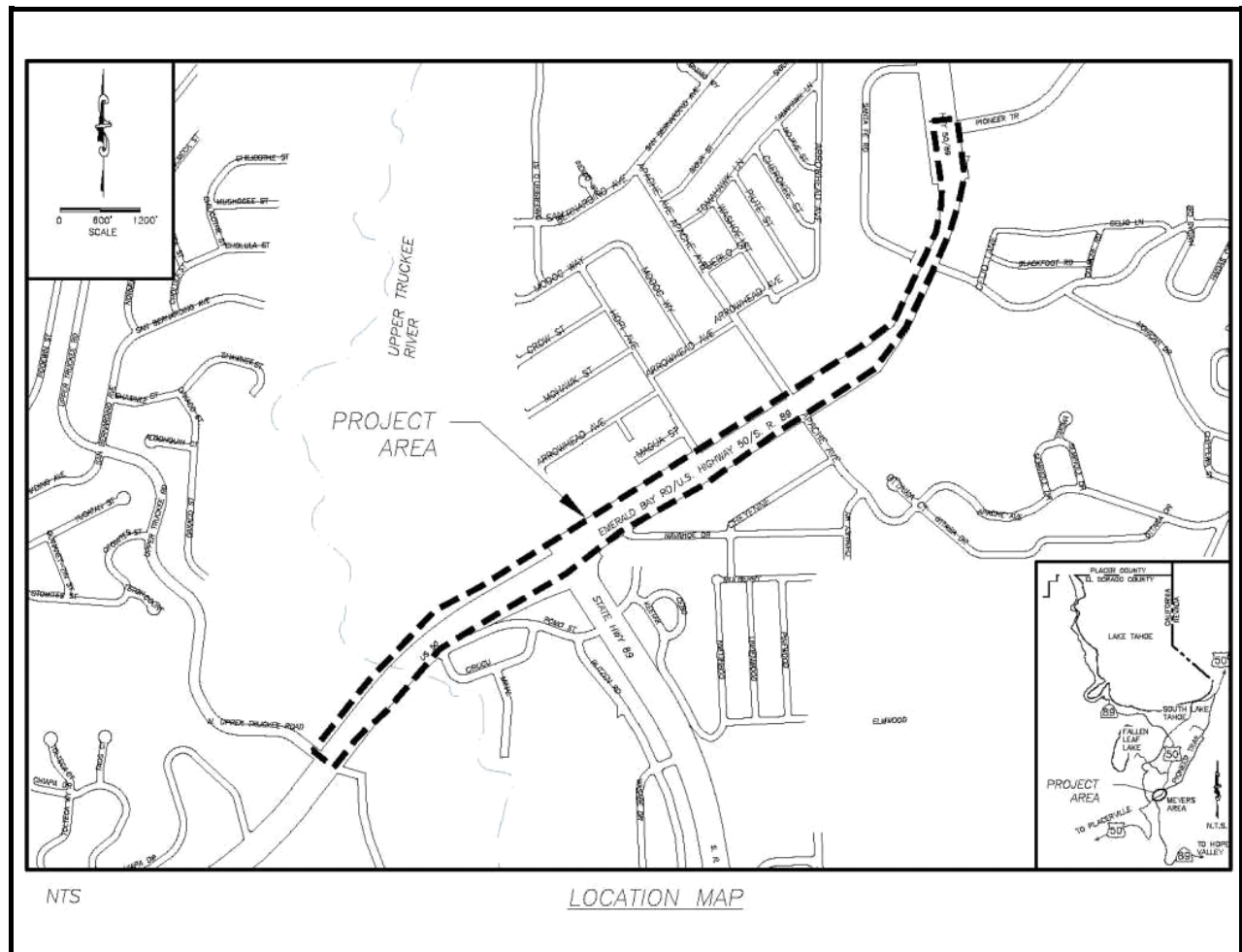

Project Description:

Perform Operational Study and Signalize Intersection at the Apache/Hwy 50 intersection. Coordinate with Caltrans to perform an operational study on this intersection to evaluate traffic flow and circulation. The study will also include a regional component which analyzes the entire Meyers area from Chiapa Road through State Route 89/US 50 intersection to Sawmill Road. US 50 is a state highway and as such the state should participate in advancement of a project to signalize this intersection. Regional Surface Transportation Program funding from Tahoe Regional Planning Agency (TRPA) is programmed for the operational study.

Original Budget: \$13,389,000

Expenditures thru 6/30/2012: \$122,912

Project Initiation Date: 12/06/10

*Prior FY includes actual revenue and expenditures through 06/30/12, plus amounts budgeted through 06/30/13.



Apache Avenue/US 50 Intersection Signalization

Financing Plan & Tentative Schedule

Project No: 73120

Type: Intersection

Supervisor District(s) 5

All Figures in Thousands

Revenue	by Funding Source	Prior FY*	FY 13/14	FY 14/15	FY 15/16	FY 16/17	FY 17/18	FY 18/19- 22/23	FY 23/24- 32/33	Total
Anticipated Grant		\$0	\$0	\$0	\$0	\$0	\$0	\$0	\$0	\$0
Congestion Mitigation and Air Quality Program		\$22	\$0	\$0	\$0	\$150	\$350	\$0	\$0	\$522
RSTP Exchange Funds-TRPA		\$173	\$97	\$105	\$100	\$105	\$100	\$0	\$0	\$680
State Cooperative Agreement		\$0	\$0	\$0	\$0	\$1,690	\$1,201	\$0	\$0	\$2,891
Tahoe Regional Planning Agency/Air Quality		\$0	\$20	\$25	\$100	\$160	\$100	\$0	\$0	\$405
Tahoe Regional Planning Agency/Water Quality		\$0	\$0	\$10	\$10	\$35	\$55	\$0	\$0	\$110
Transportation Enhancement Activities		\$0	\$0	\$0	\$0	\$120	\$0	\$0	\$0	\$120
Total		\$195	\$117	\$140	\$210	\$2,260	\$1,806	\$0	\$0	\$4,728

All Figures in Thousands

Expenditures	Prior FY*	FY 13/14	FY 14/15	FY 15/16	FY 16/17	FY 17/18	FY 18/19- 22/23	FY 23/24- 32/33	Total
Planning/Env - Consultant	\$76	\$50	\$75	\$15	\$0	\$0	\$0	\$0	\$216
Planning/Env - Staff	\$44	\$67	\$55	\$25	\$0	\$0	\$0	\$0	\$191
Survey - Staff	\$3	\$0	\$10	\$10	\$0	\$0	\$0	\$0	\$23
Design - Consultant	\$58	\$0	\$0	\$25	\$35	\$0	\$0	\$0	\$118
Design - Staff	\$14	\$0	\$0	\$85	\$205	\$0	\$0	\$0	\$304
Right of Way - Acquisition	\$0	\$0	\$0	\$0	\$160	\$0	\$0	\$0	\$160
Right of Way - Consultant	\$0	\$0	\$0	\$15	\$5	\$0	\$0	\$0	\$20
Right of Way - Staff	\$0	\$0	\$0	\$35	\$40	\$0	\$0	\$0	\$75
Construction Mgmt - Consultant	\$0	\$0	\$0	\$0	\$25	\$20	\$0	\$0	\$45
Construction Mgmt - Staff	\$0	\$0	\$0	\$0	\$255	\$255	\$0	\$0	\$510
Direct Construction Costs	\$0	\$0	\$0	\$0	\$1,500	\$1,500	\$0	\$0	\$3,000
Env Monitoring - Consultant	\$0	\$0	\$0	\$0	\$2	\$1	\$0	\$0	\$3
Env Monitoring - Staff	\$0	\$0	\$0	\$0	\$8	\$5	\$0	\$0	\$13
Plant Establishment - Consultant	\$0	\$0	\$0	\$0	\$11	\$10	\$0	\$0	\$21
Plant Establishment - Staff	\$0	\$0	\$0	\$0	\$15	\$15	\$0	\$0	\$30
Total	\$195	\$117	\$140	\$210	\$2,260	\$1,806	\$0	\$0	\$4,728

Project Schedule	Prior FY*	FY 13/14	FY 14/15	FY 15/16	FY 16/17	FY 17/18	FY 18/19- 22/23	FY 23/24- 32/33	
Planning/Environmental									
Design									
Right Of Way									
Construction									

**FY 18/19 - 22/23 and FY 23/24 - 32/33 revenue and expenditures are not included for the Tahoe EIP, as it is a five-year program.

*Prior FY includes actual revenue and expenditures through 06/30/12, plus amounts budgeted through 06/30/13.



Boulder Mountain Erosion Control Project

CIP Project Summary

Project No: 95153

Type: Erosion Control - (EIP)

Supervisor District(s) 5

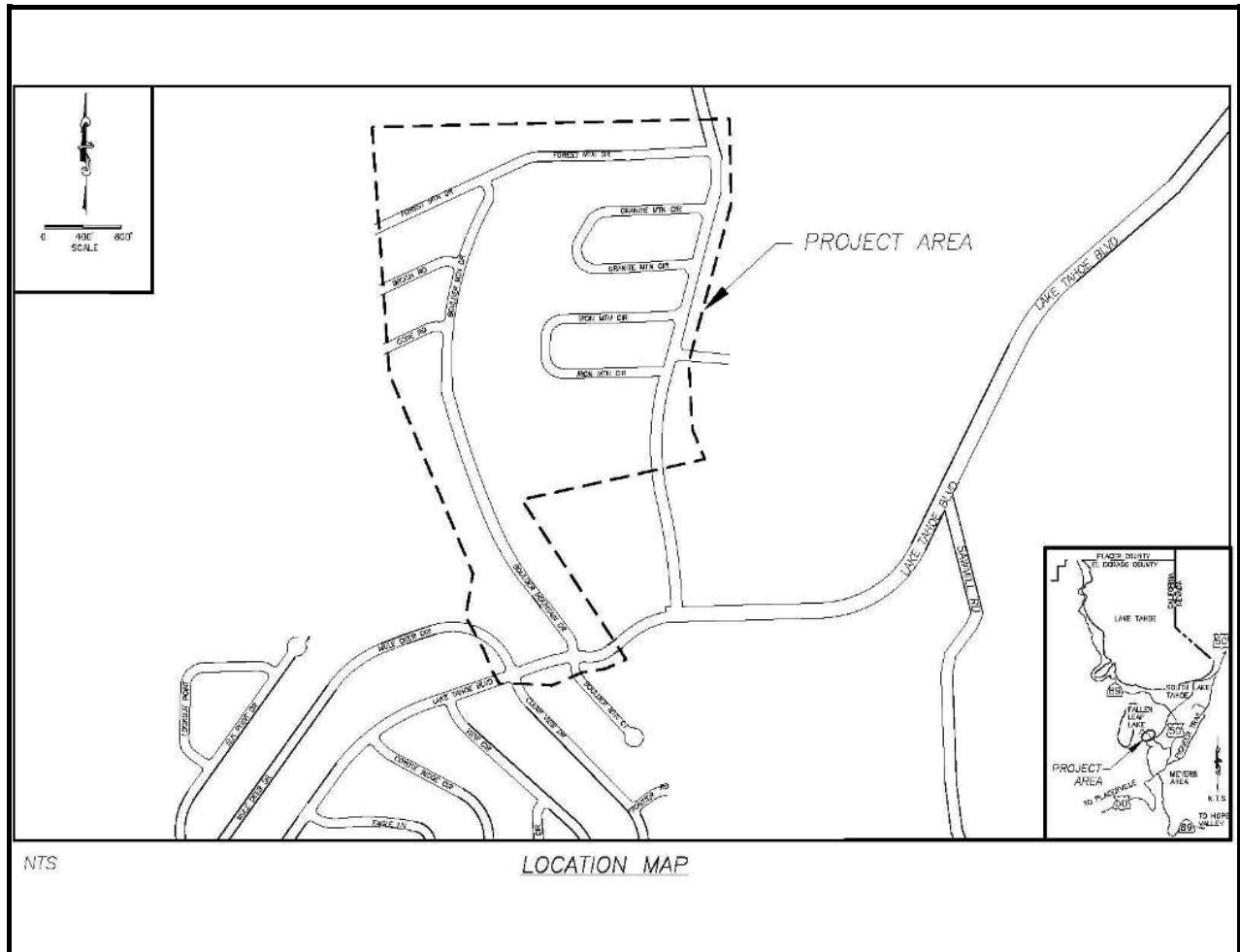

Project Description:

The Boulder Mountain Erosion Control Project includes Mountain View Estates subdivision Unit No. 10 and a portion of Unit No. 7 and encompasses the area south of Angora Highlands, north of Lake Tahoe Blvd and west of Tahoe Mountain Road. The Project goals are to treat eroding cut and fill slopes in the County right-of-way. Remove the very fine/fine particles up to 11% of the total load from the County right-of-way prior to reaching the Angora Creek. Revegetation of disturbed areas including the restoration of the Boulder Mountain Drive pavement. Stabilize areas around the County right-of-way impacted by the Angora Fire.

Original Budget: \$2,793,500

Expenditures thru 6/30/2012: \$284,785

Project Initiation Date: 04/15/08

*Prior FY includes actual revenue and expenditures through 06/30/12, plus amounts budgeted through 06/30/13.



Boulder Mountain Erosion Control Project

Financing Plan & Tentative Schedule

Project No: 95153

Type: Erosion Control - (EIP)

Supervisor District(s) 5

All Figures in Thousands

Revenue by Funding Source	Prior FY*	FY 13/14	FY 14/15	FY 15/16	FY 16/17	FY 17/18	FY 18/19-22/23	FY 23/24-32/33	Total
Miscellaneous Reimbursement	\$0	\$23	\$0	\$0	\$0	\$0	\$0	\$0	\$23
Tahoe Regional Planning Agency/Water Quality	\$13	\$4	\$0	\$0	\$0	\$0	\$0	\$0	\$17
United States Forest Service Planning Grant	\$429	\$0	\$0	\$0	\$0	\$0	\$0	\$0	\$429
United States Forest Service Site Improvement Grant	\$0	\$569	\$16	\$15	\$0	\$0	\$0	\$0	\$600
Total	\$442	\$597	\$16	\$15	\$0	\$0	\$0	\$0	\$1,069

All Figures in Thousands

Expenditures	Prior FY*	FY 13/14	FY 14/15	FY 15/16	FY 16/17	FY 17/18	FY 18/19-22/23	FY 23/24-32/33	Total
Planning/Env - Staff	\$5	\$0	\$0	\$0	\$0	\$0	\$0	\$0	\$5
Design - Consultant	\$44	\$0	\$0	\$0	\$0	\$0	\$0	\$0	\$44
Design - Staff	\$354	\$0	\$0	\$0	\$0	\$0	\$0	\$0	\$354
Right of Way - Acquisition	\$2	\$0	\$0	\$0	\$0	\$0	\$0	\$0	\$2
Right of Way - Consultant	\$1	\$0	\$0	\$0	\$0	\$0	\$0	\$0	\$1
Right of Way - Staff	\$10	\$0	\$0	\$0	\$0	\$0	\$0	\$0	\$10
Construction Mgmt - Staff	\$1	\$89	\$0	\$0	\$0	\$0	\$0	\$0	\$90
Direct Construction Costs	\$0	\$500	\$0	\$0	\$0	\$0	\$0	\$0	\$500
Env Monitoring - Consultant	\$2	\$3	\$1	\$0	\$0	\$0	\$0	\$0	\$6
Env Monitoring - Staff	\$23	\$5	\$5	\$5	\$0	\$0	\$0	\$0	\$38
Plant Establishment - Staff	\$0	\$0	\$10	\$10	\$0	\$0	\$0	\$0	\$20
Total	\$442	\$597	\$16	\$15	\$0	\$0	\$0	\$0	\$1,069

Project Schedule	Prior FY*	FY 13/14	FY 14/15	FY 15/16	FY 16/17	FY 17/18	FY 18/19-22/23	FY 23/24-32/33	
Planning/Environmental									
Design									
Right Of Way									
Construction									

**FY 18/19 - 22/23 and FY 23/24 - 32/33 revenue and expenditures are not included for the Tahoe EIP, as it is a five-year program.

*Prior FY includes actual revenue and expenditures through 06/30/12, plus amounts budgeted through 06/30/13.



Chiapa Erosion Control Project

CIP Project Summary

Project No: 95174

Type: Erosion Control - (EIP)

Supervisor District(s) 5

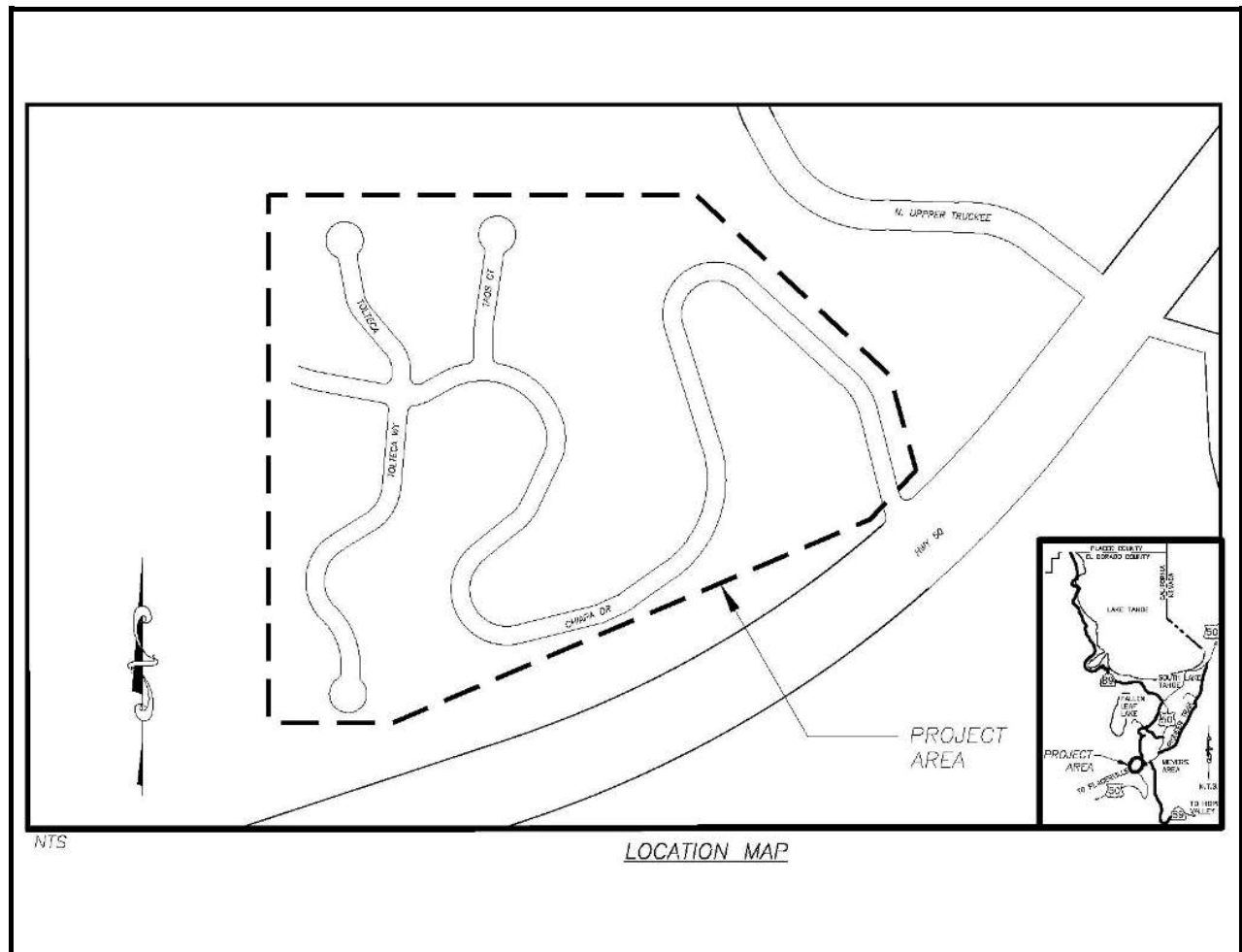

Project Description:

The Chiapa Erosion Control Project encompasses the streets of Chiapa Drive, Tolteca Court and Taos Court. The main goal of the Project is to improve the clarity of Lake Tahoe by reducing the detrimental water quality impacts of Tahoe Paradise Unit No. 34 subdivision on Lake Tahoe clarity. The objective of the Project is the reduction in the transport of fine sediment from the Project area by constructing water quality Best Management Practices (BMPs) prior to reaching Cold Creek to the maximum extent practicable.

Original Budget: \$2,083,600

Expenditures thru 6/30/2012: \$0

Project Initiation Date: 06/23/09

*Prior FY includes actual revenue and expenditures through 06/30/12, plus amounts budgeted through 06/30/13.



Chiapa Erosion Control Project

Financing Plan & Tentative Schedule

Project No: 95174

Type: Erosion Control - (EIP)

Supervisor District(s) 5

All Figures in Thousands

Revenue by Funding Source	Prior FY*	FY 13/14	FY 14/15	FY 15/16	FY 16/17	FY 17/18	FY 18/19-22/23	FY 23/24-32/33	Total
California Tahoe Conservancy Site Improvement Grant	\$0	\$0	\$0	\$0	\$0	\$216	\$0	\$0	\$216
Tahoe Regional Planning Agency/Water Quality	\$0	\$0	\$0	\$0	\$0	\$91	\$0	\$0	\$91
United States Forest Service Planning Grant	\$0	\$0	\$0	\$0	\$0	\$166	\$0	\$0	\$166
United States Forest Service Site Improvement Grant	\$0	\$0	\$0	\$0	\$0	\$0	\$0	\$0	\$0
Total	\$0	\$0	\$0	\$0	\$0	\$473	\$0	\$0	\$473

All Figures in Thousands

Expenditures	Prior FY*	FY 13/14	FY 14/15	FY 15/16	FY 16/17	FY 17/18	FY 18/19-22/23	FY 23/24-32/33	Total
Planning/Env - Staff	\$0	\$0	\$0	\$0	\$0	\$66	\$0	\$0	\$66
Design - Consultant	\$0	\$0	\$0	\$0	\$0	\$35	\$0	\$0	\$35
Design - Staff	\$0	\$0	\$0	\$0	\$0	\$335	\$0	\$0	\$335
Right of Way - Acquisition	\$0	\$0	\$0	\$0	\$0	\$13	\$0	\$0	\$13
Right of Way - Consultant	\$0	\$0	\$0	\$0	\$0	\$6	\$0	\$0	\$6
Right of Way - Staff	\$0	\$0	\$0	\$0	\$0	\$18	\$0	\$0	\$18
Construction Mgmt - Staff	\$0	\$0	\$0	\$0	\$0	\$0	\$0	\$0	\$0
Direct Construction Costs	\$0	\$0	\$0	\$0	\$0	\$0	\$0	\$0	\$0
Plant Establishment - Consultant	\$0	\$0	\$0	\$0	\$0	\$0	\$0	\$0	\$0
Plant Establishment - Staff	\$0	\$0	\$0	\$0	\$0	\$0	\$0	\$0	\$0
Total	\$0	\$0	\$0	\$0	\$0	\$473	\$0	\$0	\$473

Project Schedule	Prior FY*	FY 13/14	FY 14/15	FY 15/16	FY 16/17	FY 17/18	FY 18/19-22/23	FY 23/24-32/33	
Planning/Environmental									
Design									
Right Of Way									
Construction									

**FY 18/19 - 22/23 and FY 23/24 - 32/33 revenue and expenditures are not included for the Tahoe EIP, as it is a five-year program.

*Prior FY includes actual revenue and expenditures through 06/30/12, plus amounts budgeted through 06/30/13.



Christmas Valley Phase 2C Erosion Control Project

CIP Project Summary

Project No: 95190

Type: Erosion Control - (EIP)

Supervisor District(s) 5

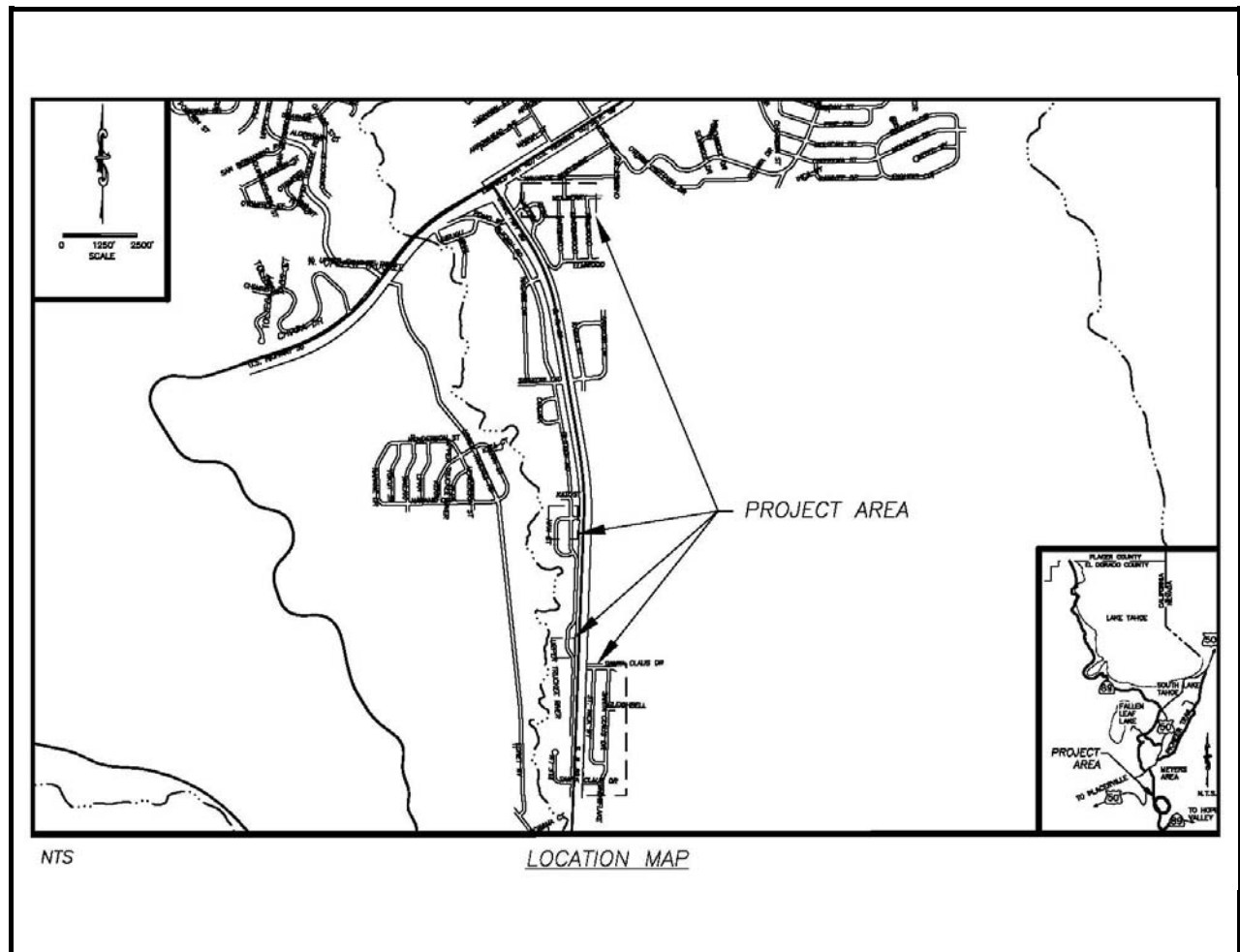

Project Description:

The Christmas Valley Phase 2C Erosion Control Project encompasses the streets of Santa Claus Drive, Saint Nick Way, the southernmost end of Blitzen Road, and Elf Lane (includes Christmas Valley Unit Nos. 1 and 2). The main goals of the Project are related to improving the water quality of runoff to Lake Tahoe by reducing erosion and sediment flow originating in the Project area. The Project goals are remove/reduce fine sediment originating from the Project areas prior to reaching the Upper Truckee River to the maximum extent practicable. Remove/reduce coarse sediment originating from the Project areas prior to reaching the Upper Truckee River to the maximum extent practicable.

Original Budget: \$4,997,500

Expenditures thru 6/30/2012: \$284,242

Project Initiation Date: 04/15/05

*Prior FY includes actual revenue and expenditures through 06/30/12, plus amounts budgeted through 06/30/13.



Christmas Valley Phase 2C Erosion Control Project

Financing Plan & Tentative Schedule

Project No: 95190

Type: Erosion Control - (EIP)

Supervisor District(s) 5

All Figures in Thousands

Revenue by Funding Source	Prior FY*	FY 13/14	FY 14/15	FY 15/16	FY 16/17	FY 17/18	FY 18/19-22/23	FY 23/24-32/33	Total
California Tahoe Conservancy Planning Grant	\$138	\$0	\$0	\$0	\$0	\$0	\$0	\$0	\$138
California Tahoe Conservancy Right of Way Grant	\$30	\$0	\$0	\$0	\$0	\$0	\$0	\$0	\$30
California Tahoe Conservancy Site Improvement Grant	\$745	\$212	\$0	\$0	\$0	\$0	\$0	\$0	\$957
Tahoe Regional Planning Agency/Water Quality	\$73	\$5	\$2	\$6	\$0	\$0	\$0	\$0	\$86
United States Forest Service Site Improvement Grant	\$52	\$25	\$14	\$5	\$0	\$0	\$0	\$0	\$95
Total	\$1,037	\$242	\$16	\$11	\$0	\$0	\$0	\$0	\$1,305

All Figures in Thousands

Expenditures	Prior FY*	FY 13/14	FY 14/15	FY 15/16	FY 16/17	FY 17/18	FY 18/19-22/23	FY 23/24-32/33	Total
Survey - Staff	\$12	\$0	\$0	\$0	\$0	\$0	\$0	\$0	\$12
Design - Consultant	\$0	\$0	\$0	\$0	\$0	\$0	\$0	\$0	\$0
Design - Staff	\$160	\$0	\$0	\$0	\$0	\$0	\$0	\$0	\$160
Right of Way - Acquisition	\$9	\$0	\$0	\$0	\$0	\$0	\$0	\$0	\$9
Right of Way - Consultant	\$18	\$0	\$0	\$0	\$0	\$0	\$0	\$0	\$18
Right of Way - Staff	\$87	\$0	\$0	\$0	\$0	\$0	\$0	\$0	\$87
Construction Mgmt - Consultant	\$0	\$0	\$0	\$0	\$0	\$0	\$0	\$0	\$0
Construction Mgmt - Staff	\$118	\$48	\$0	\$0	\$0	\$0	\$0	\$0	\$165
Direct Construction Costs	\$616	\$163	\$0	\$0	\$0	\$0	\$0	\$0	\$779
Env Monitoring - Consultant	\$1	\$1	\$1	\$1	\$0	\$0	\$0	\$0	\$4
Env Monitoring - Staff	\$5	\$5	\$8	\$5	\$0	\$0	\$0	\$0	\$23
Plant Establishment - Consultant	\$10	\$8	\$0	\$0	\$0	\$0	\$0	\$0	\$18
Plant Establishment - Staff	\$1	\$18	\$7	\$5	\$0	\$0	\$0	\$0	\$31
Total	\$1,037	\$242	\$16	\$11	\$0	\$0	\$0	\$0	\$1,305

Project Schedule	Prior FY*	FY 13/14	FY 14/15	FY 15/16	FY 16/17	FY 17/18	FY 18/19-22/23	FY 23/24-32/33	
Planning/Environmental									
Design									
Right Of Way									
Construction									

**FY 18/19 - 22/23 and FY 23/24 - 32/33 revenue and expenditures are not included for the Tahoe EIP, as it is a five-year program.

*Prior FY includes actual revenue and expenditures through 06/30/12, plus amounts budgeted through 06/30/13.



Country Club Heights Erosion Control Project

CIP Project Summary

Project No: 95191

Type: Erosion Control - (EIP)

Supervisor District(s) 5

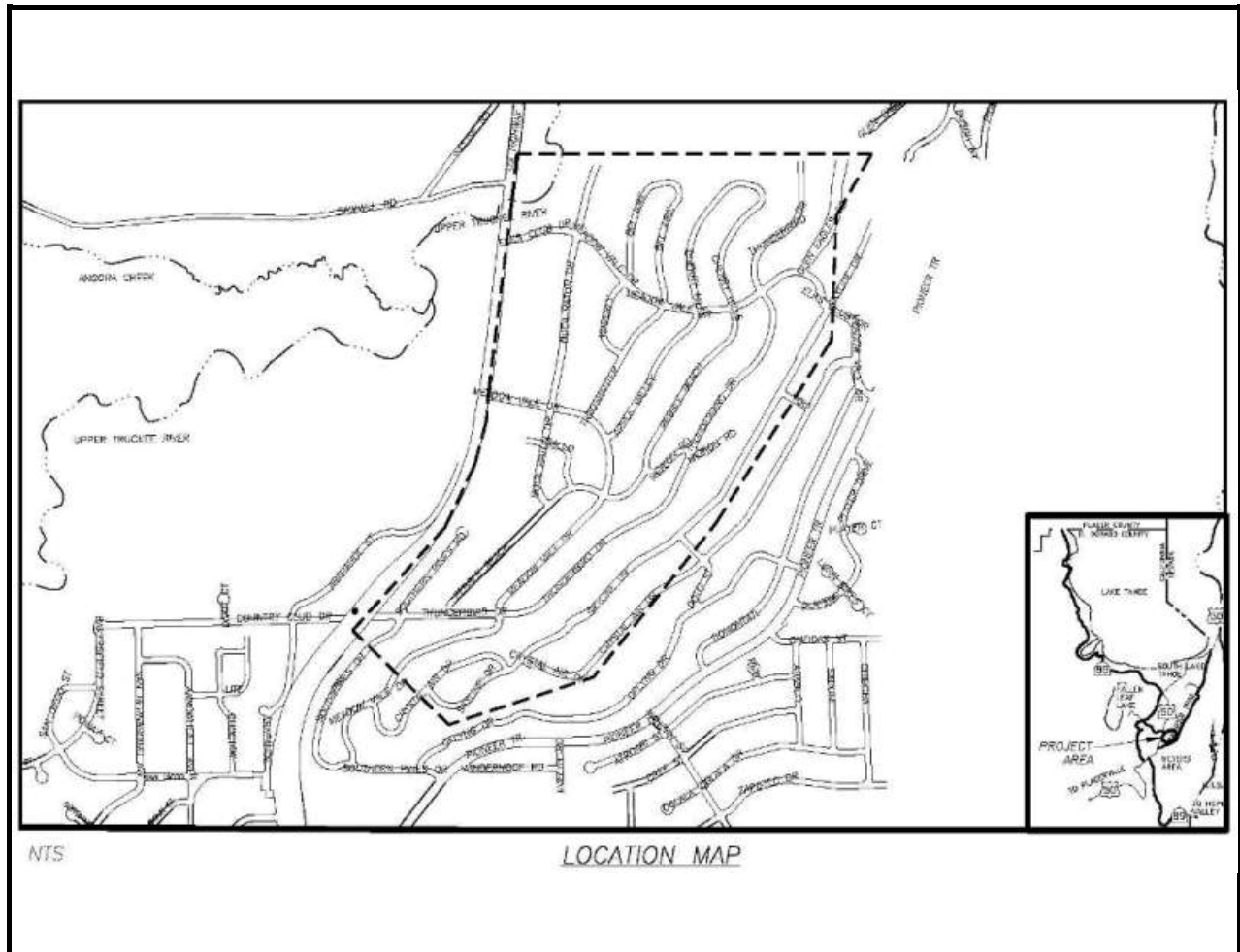

Project Description:

The Country Club Heights Erosion Control Project is within the Country Club Heights subdivision (Units 1-5), more specifically between Crystal Air Drive at the upper southerly boundary to U.S. Highway 50 to the north and Thunderbird Drive at the upper westerly boundary to the Upper Truckee River to the west. The main goal of this Project is to reduce very fine/fine sediment from the County right-of-way from reaching the Upper Truckee River near Elks Club Road to the Total Maximum Daily Level (TMDL) set by Lahontan Regional Water Quality Control Board under the National Pollution Discharge Elimination System (NPDES) permit conditions.

Original Budget: \$3,610,600

Expenditures thru 6/30/2012: \$6,659

Project Initiation Date: 07/01/11

*Prior FY includes actual revenue and expenditures through 06/30/12, plus amounts budgeted through 06/30/13.



Country Club Heights Erosion Control Project

Financing Plan & Tentative Schedule

Project No: 95191

Type: Erosion Control - (EIP)

Supervisor District(s) 5

All Figures in Thousands

Revenue by Funding Source	Prior FY*	FY 13/14	FY 14/15	FY 15/16	FY 16/17	FY 17/18	FY 18/19-22/23	FY 23/24-32/33	Total
California Tahoe Conservancy Site Improvement Grant	\$0	\$0	\$0	\$0	\$0	\$0	\$0	\$0	\$0
Tahoe Regional Planning Agency/Water Quality	\$0	\$0	\$0	\$50	\$15	\$13	\$0	\$0	\$78
United States Forest Service Planning Grant	\$53	\$57	\$15	\$0	\$0	\$0	\$0	\$0	\$125
United States Forest Service Site Improvement Grant	\$0	\$0	\$58	\$425	\$10	\$0	\$0	\$0	\$493
Total	\$53	\$57	\$73	\$475	\$25	\$13	\$0	\$0	\$696

All Figures in Thousands

Expenditures	Prior FY*	FY 13/14	FY 14/15	FY 15/16	FY 16/17	FY 17/18	FY 18/19-22/23	FY 23/24-32/33	Total
Planning/Env - Consultant	\$25	\$2	\$0	\$0	\$0	\$0	\$0	\$0	\$27
Planning/Env - Staff	\$10	\$0	\$0	\$0	\$5	\$0	\$0	\$0	\$15
Survey - Staff	\$0	\$20	\$10	\$0	\$0	\$0	\$0	\$0	\$30
Design - Consultant	\$0	\$0	\$0	\$0	\$0	\$0	\$0	\$0	\$0
Design - Staff	\$14	\$29	\$40	\$55	\$0	\$0	\$0	\$0	\$138
Right of Way - Acquisition	\$0	\$0	\$0	\$0	\$0	\$0	\$0	\$0	\$0
Right of Way - Consultant	\$0	\$0	\$0	\$0	\$0	\$0	\$0	\$0	\$0
Right of Way - Staff	\$0	\$0	\$0	\$0	\$0	\$0	\$0	\$0	\$0
Construction Mgmt - Consultant	\$0	\$0	\$0	\$0	\$0	\$0	\$0	\$0	\$0
Construction Mgmt - Staff	\$0	\$0	\$0	\$70	\$0	\$0	\$0	\$0	\$70
Direct Construction Costs	\$0	\$0	\$0	\$350	\$0	\$0	\$0	\$0	\$350
Env Monitoring - Consultant	\$0	\$1	\$0	\$0	\$0	\$0	\$0	\$0	\$1
Env Monitoring - Staff	\$4	\$5	\$3	\$0	\$10	\$5	\$0	\$0	\$27
Plant Establishment - Consultant	\$0	\$0	\$10	\$0	\$0	\$0	\$0	\$0	\$10
Plant Establishment - Staff	\$0	\$0	\$10	\$0	\$10	\$8	\$0	\$0	\$28
Total	\$53	\$57	\$73	\$475	\$25	\$13	\$0	\$0	\$696

Project Schedule	Prior FY*	FY 13/14	FY 14/15	FY 15/16	FY 16/17	FY 17/18	FY 18/19-22/23	FY 23/24-32/33	
Planning/Environmental									
Design									
Right Of Way									
Construction									

**FY 18/19 - 22/23 and FY 23/24 - 32/33 revenue and expenditures are not included for the Tahoe EIP, as it is a five-year program.

*Prior FY includes actual revenue and expenditures through 06/30/12, plus amounts budgeted through 06/30/13.



CSA # 5 Upper Area Erosion Control Project

CIP Project Summary

Project No: 95196

Type: Erosion Control - (EIP)

Supervisor District(s) 5

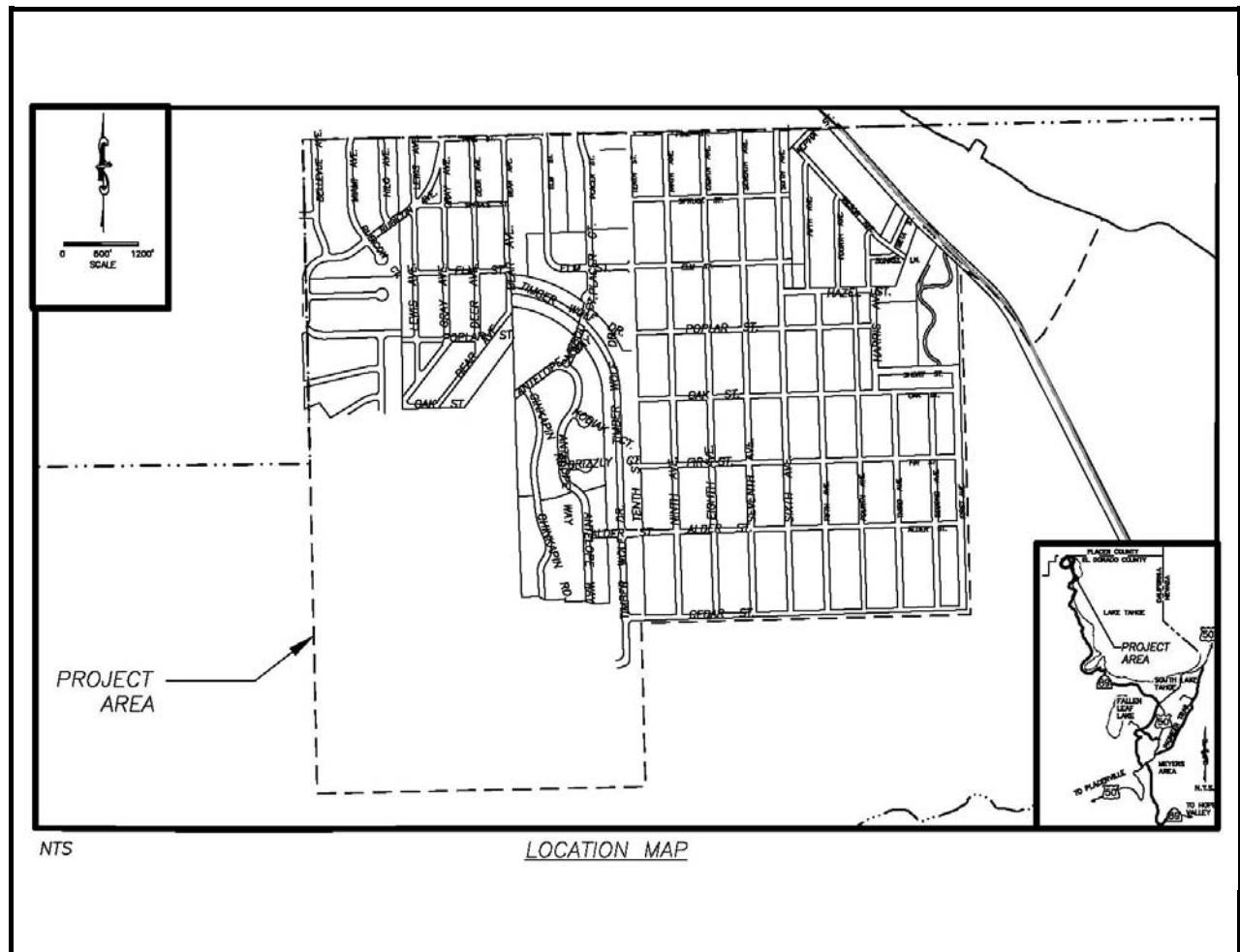

Project Description:

The CSA # 5 Upper Area Erosion Control Project includes the developed portions of the Tahoe Cedars subdivision southwest of Highway 89 between the El Dorado County Line and Poplar Street. The goal of the Project is to reduce the concentration of fine sediment in the storm water which exits the Project area before reaching Lake Tahoe. The funding for this Project will be provided by the California Tahoe Conservancy Soil Erosion Control Grants Program.

Original Budget: \$395,000

Expenditures thru 6/30/2012: \$0

Project Initiation Date: 03/25/13

*Prior FY includes actual revenue and expenditures through 06/30/12, plus amounts budgeted through 06/30/13.



CSA # 5 Upper Area Erosion Control Project

Financing Plan & Tentative Schedule

Project No: 95196

Type: Erosion Control - (EIP)

Supervisor District(s) 5

All Figures in Thousands

Revenue by Funding Source	Prior FY*	FY 13/14	FY 14/15	FY 15/16	FY 16/17	FY 17/18	FY 18/19-22/23	FY 23/24-32/33	Total
California Tahoe Conservancy Site Improvement Grant	\$0	\$56	\$340	\$0	\$0	\$0	\$0	\$0	\$395
Total	\$0	\$56	\$340	\$0	\$0	\$0	\$0	\$0	\$395

All Figures in Thousands

Expenditures	Prior FY*	FY 13/14	FY 14/15	FY 15/16	FY 16/17	FY 17/18	FY 18/19-22/23	FY 23/24-32/33	Total
Environmental Monitoring	\$0	\$0	\$10	\$0	\$0	\$0	\$0	\$0	\$10
Design Engineering & Admin - SI - Staff	\$0	\$56	\$20	\$0	\$0	\$0	\$0	\$0	\$75
Constr/Eng/Admin - Staff	\$0	\$0	\$60	\$0	\$0	\$0	\$0	\$0	\$60
Direct Construction Costs	\$0	\$0	\$245	\$0	\$0	\$0	\$0	\$0	\$245
Plant Establishment	\$0	\$0	\$5	\$0	\$0	\$0	\$0	\$0	\$5
Total	\$0	\$56	\$340	\$0	\$0	\$0	\$0	\$0	\$395

Project Schedule	Prior FY*	FY 13/14	FY 14/15	FY 15/16	FY 16/17	FY 17/18	FY 18/19-22/23	FY 23/24-32/33	
Planning/Environmental									
Design									
Right Of Way									
Construction									

**FY 18/19 - 22/23 and FY 23/24 - 32/33 revenue and expenditures are not included for the Tahoe EIP, as it is a five-year program.

*Prior FY includes actual revenue and expenditures through 06/30/12, plus amounts budgeted through 06/30/13.



CSA #5 Erosion Control Project

CIP Project Summary

Project No: 95157

Type: Erosion Control - (EIP)

Supervisor District(s) 5

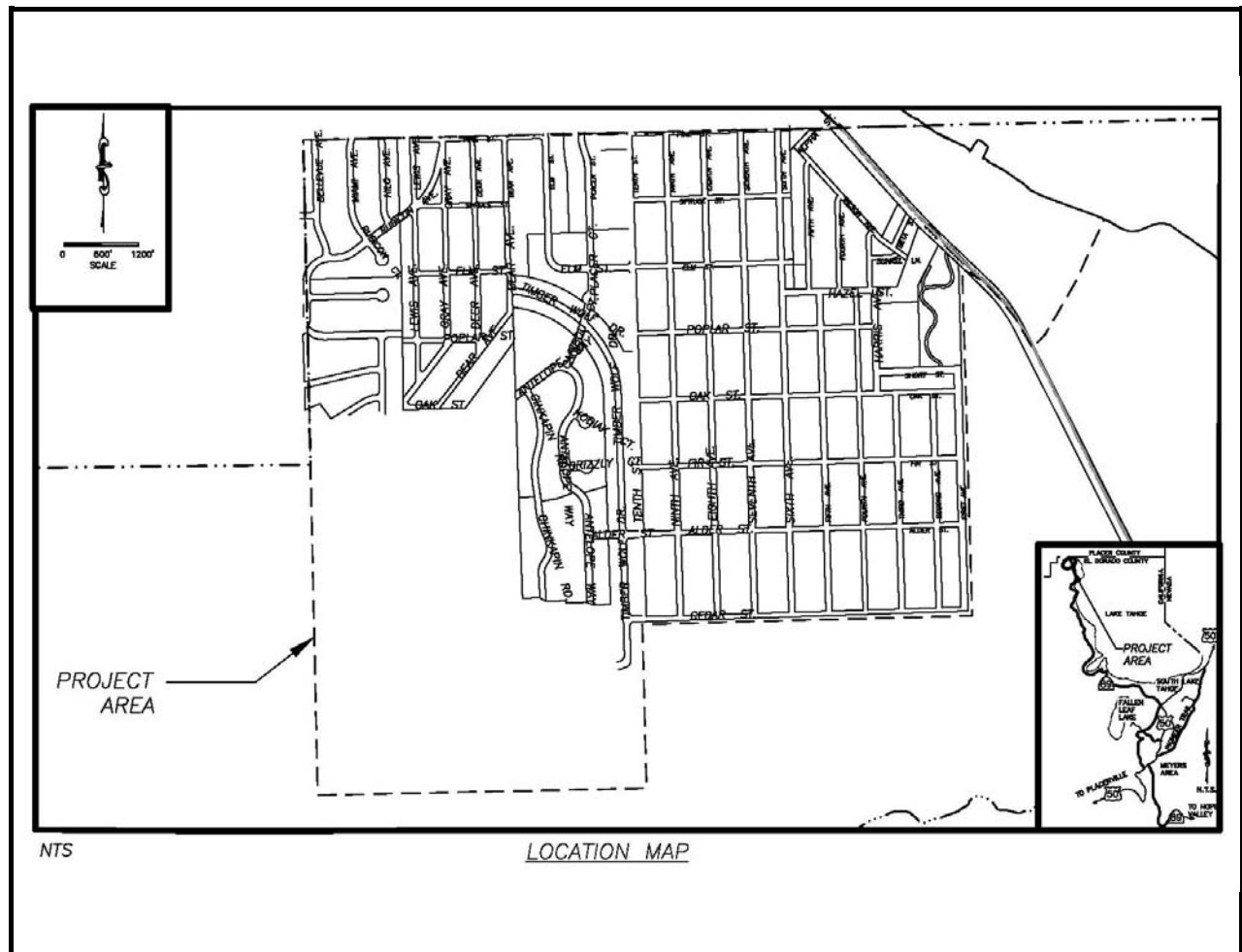

Project Description:

This Project will be the first phase within the overall Environmental Improvement Plan (EIP # 10062) currently named the Tahoe Cedars/Westlake Storm Water Management and Erosion Control Project.

The CSA #5 Erosion Control Project will complete the storm water management/erosion control improvements within this urban watershed. The goal of the Project is to reduce the concentration of fine sediment in the storm water which exits in the Project area before reaching Lake Tahoe. The funding for this Project will be provided by the California Tahoe Conservancy Soil Erosion Control Grants Program.

The updated goals for this Project relate to the Total Maximum Daily Load draft documents which identify very fine sediment (20 um or less) within the urban areas as one source of pollutant loading creating the clarity decline within Lake Tahoe.

Original Budget: \$1,450,000

Expenditures thru 6/30/2012: \$1,422

Project Initiation Date: 10/26/98

*Prior FY includes actual revenue and expenditures through 06/30/12, plus amounts budgeted through 06/30/13.



CSA #5 Erosion Control Project

Financing Plan & Tentative Schedule

Project No: 95157

Type: Erosion Control - (EIP)

Supervisor District(s) 5

All Figures in Thousands

Revenue by Funding Source	Prior FY*	FY 13/14	FY 14/15	FY 15/16	FY 16/17	FY 17/18	FY 18/19-22/23	FY 23/24-32/33	Total
California Tahoe Conservancy Site Improvement Grant	\$0	\$0	\$0	\$0	\$0	\$0	\$0	\$0	\$0
Tahoe Regional Planning Agency/Water Quality	\$0	\$0	\$15	\$15	\$0	\$0	\$0	\$0	\$30
United States Forest Service Planning Grant	\$30	\$39	\$132	\$23	\$54	\$0	\$0	\$0	\$277
United States Forest Service Site Improvement Grant	\$0	\$0	\$0	\$392	\$47	\$10	\$0	\$0	\$449
Total	\$30	\$39	\$147	\$430	\$100	\$10	\$0	\$0	\$756

All Figures in Thousands

Expenditures	Prior FY*	FY 13/14	FY 14/15	FY 15/16	FY 16/17	FY 17/18	FY 18/19-22/23	FY 23/24-32/33	Total
Planning/Env - Consultant	\$2	\$20	\$0	\$0	\$0	\$0	\$0	\$0	\$22
Planning/Env - Staff	\$27	\$19	\$10	\$0	\$0	\$0	\$0	\$0	\$56
Design - Staff	\$0	\$0	\$122	\$40	\$0	\$0	\$0	\$0	\$162
Construction Mgmt - Consultant	\$0	\$0	\$0	\$5	\$0	\$0	\$0	\$0	\$5
Construction Mgmt - Staff	\$0	\$0	\$0	\$60	\$25	\$0	\$0	\$0	\$85
Direct Construction Costs	\$0	\$0	\$0	\$300	\$50	\$0	\$0	\$0	\$350
Env Monitoring - Consultant	\$0	\$0	\$5	\$5	\$5	\$0	\$0	\$0	\$15
Env Monitoring - Staff	\$0	\$0	\$10	\$10	\$10	\$0	\$0	\$0	\$30
Plant Establishment - Consultant	\$0	\$0	\$0	\$0	\$0	\$0	\$0	\$0	\$0
Plant Establishment - Staff	\$0	\$0	\$0	\$10	\$10	\$10	\$0	\$0	\$30
Total	\$30	\$39	\$147	\$430	\$100	\$10	\$0	\$0	\$756

Project Schedule	Prior FY*	FY 13/14	FY 14/15	FY 15/16	FY 16/17	FY 17/18	FY 18/19-22/23	FY 23/24-32/33	
Planning/Environmental									
Design									
Right Of Way									
Construction									

**FY 18/19 - 22/23 and FY 23/24 - 32/33 revenue and expenditures are not included for the Tahoe EIP, as it is a five-year program.

*Prior FY includes actual revenue and expenditures through 06/30/12, plus amounts budgeted through 06/30/13.



Echo View 2 Erosion Control Project

CIP Project Summary

Project No: 95169

Type: Erosion Control - (EIP)

Supervisor District(s) 5

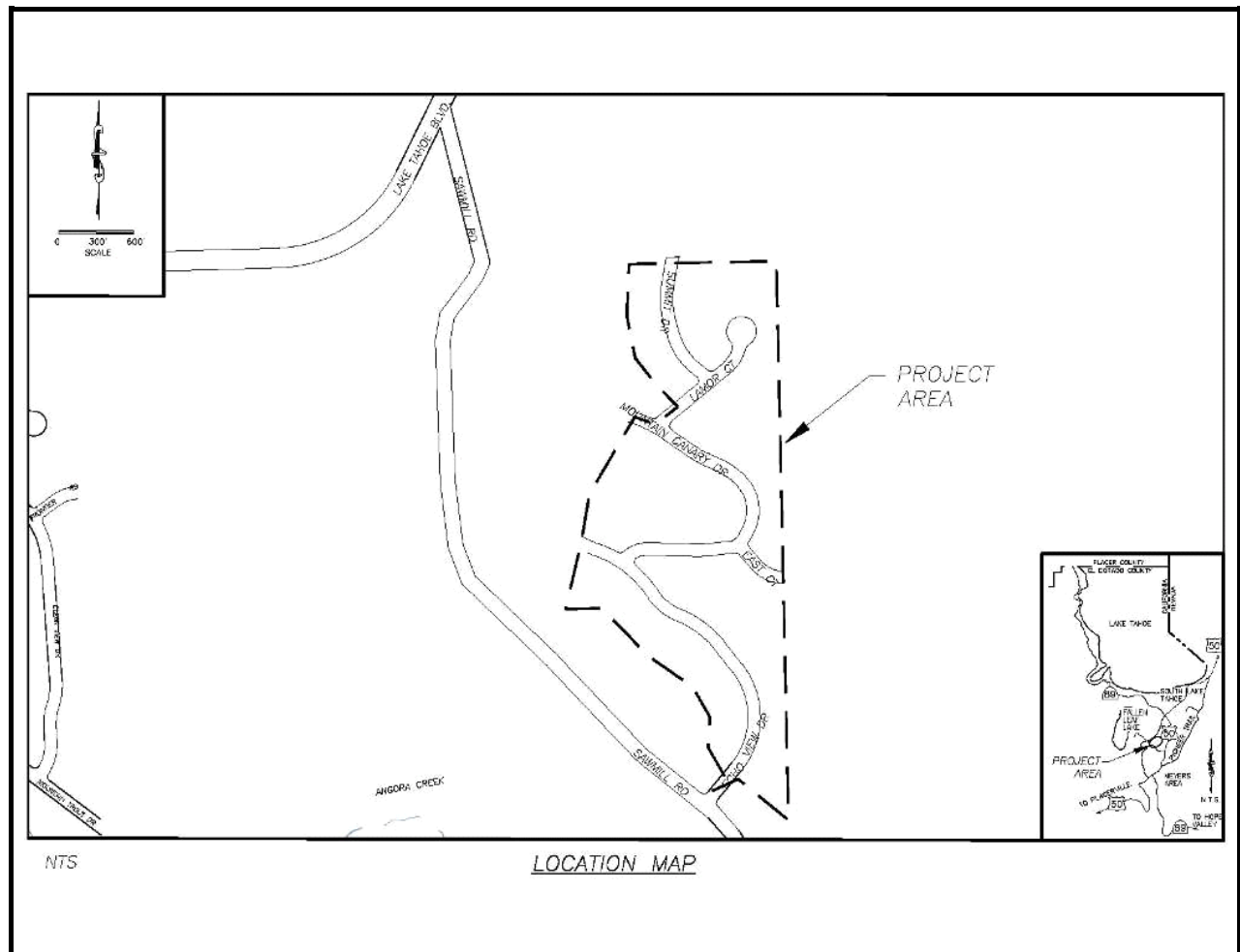

Project Description:

This Project is the second Phase of the Echo View Estates Erosion Control Project which was completed in 1988. The primary goal of this Project is to help improve the clarity of Lake Tahoe by reducing water quality impacts caused by the development of the Echo View Estates subdivision on Angora Creek., which is a tributary to the Upper Truckee River. The objective of the Project is to reduce the transport of fine sediment from the Project area by constructing and enhancing water quality Best Management Practices (BMPs) with the Project area.

Original Budget: \$2,501,031

Expenditures thru 6/30/2012: \$343,885

Project Initiation Date: 06/15/07

*Prior FY includes actual revenue and expenditures through 06/30/12, plus amounts budgeted through 06/30/13.



Echo View 2 Erosion Control Project

Financing Plan & Tentative Schedule

Project No: 95169

Type: Erosion Control - (EIP)

Supervisor District(s) 5

All Figures in Thousands

Revenue by Funding Source	Prior FY*	FY 13/14	FY 14/15	FY 15/16	FY 16/17	FY 17/18	FY 18/19-22/23	FY 23/24-32/33	Total
California Tahoe Conservancy Planning Grant	\$140	\$0	\$0	\$0	\$0	\$0	\$0	\$0	\$140
Tahoe Regional Planning Agency/Water Quality	\$54	\$3	\$13	\$0	\$0	\$0	\$0	\$0	\$69
United States Forest Service Planning Grant	\$168	\$0	\$0	\$0	\$0	\$0	\$0	\$0	\$168
United States Forest Service Site Improvement Grant	\$390	\$10	\$0	\$0	\$0	\$0	\$0	\$0	\$400
Total	\$752	\$13	\$13	\$0	\$0	\$0	\$0	\$0	\$777

All Figures in Thousands

Expenditures	Prior FY*	FY 13/14	FY 14/15	FY 15/16	FY 16/17	FY 17/18	FY 18/19-22/23	FY 23/24-32/33	Total
Planning/Env - Consultant	\$21	\$0	\$0	\$0	\$0	\$0	\$0	\$0	\$21
Survey - Consultant	\$59	\$0	\$0	\$0	\$0	\$0	\$0	\$0	\$59
Survey - Staff	\$51	\$0	\$0	\$0	\$0	\$0	\$0	\$0	\$51
Design - Consultant	\$0	\$0	\$0	\$0	\$0	\$0	\$0	\$0	\$0
Design - Staff	\$187	\$0	\$0	\$0	\$0	\$0	\$0	\$0	\$187
Right of Way - Acquisition	\$3	\$0	\$0	\$0	\$0	\$0	\$0	\$0	\$3
Right of Way - Consultant	\$2	\$0	\$0	\$0	\$0	\$0	\$0	\$0	\$2
Right of Way - Staff	\$14	\$0	\$0	\$0	\$0	\$0	\$0	\$0	\$14
Construction Mgmt - Consultant	\$0	\$0	\$0	\$0	\$0	\$0	\$0	\$0	\$0
Construction Mgmt - Staff	\$93	\$0	\$0	\$0	\$0	\$0	\$0	\$0	\$93
Direct Construction Costs	\$308	\$0	\$0	\$0	\$0	\$0	\$0	\$0	\$308
Env Monitoring - Staff	\$5	\$3	\$3	\$0	\$0	\$0	\$0	\$0	\$10
Plant Establishment - Consultant	\$9	\$0	\$0	\$0	\$0	\$0	\$0	\$0	\$9
Plant Establishment - Staff	\$1	\$10	\$10	\$0	\$0	\$0	\$0	\$0	\$21
Total	\$752	\$13	\$13	\$0	\$0	\$0	\$0	\$0	\$777

Project Schedule	Prior FY*	FY 13/14	FY 14/15	FY 15/16	FY 16/17	FY 17/18	FY 18/19-22/23	FY 23/24-32/33	
Planning/Environmental									
Design									
Right Of Way									
Construction									

**FY 18/19 - 22/23 and FY 23/24 - 32/33 revenue and expenditures are not included for the Tahoe EIP, as it is a five-year program.

*Prior FY includes actual revenue and expenditures through 06/30/12, plus amounts budgeted through 06/30/13.



Forest View Water Quality Project

CIP Project Summary

Project No: 95195

Type: Erosion Control - (EIP)

Supervisor District(s) 5

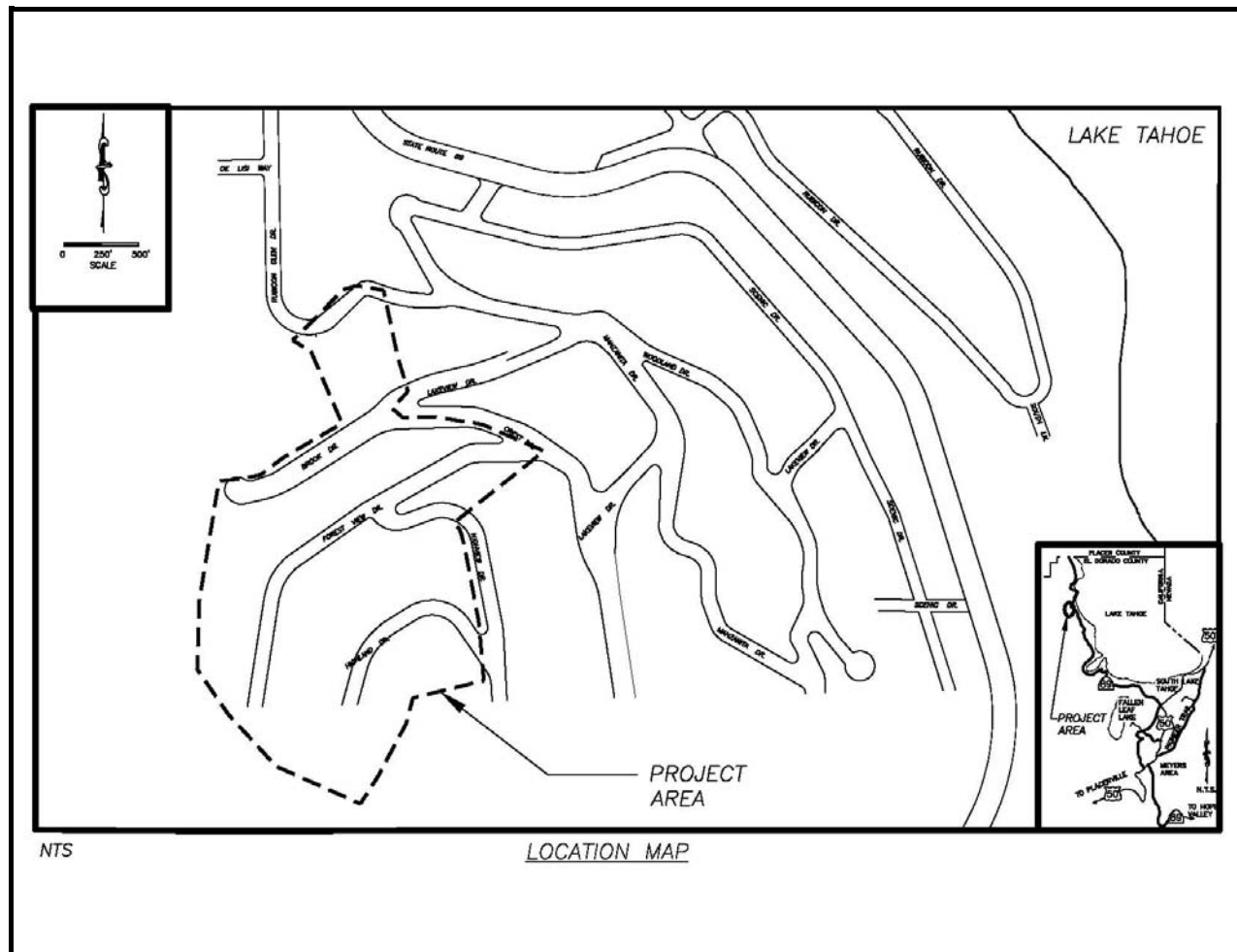

Project Description:

The Forest View Water Quality Project is within the Rubicon Properties Unit No. 2 subdivision which is roughly bordered by Lonely Gulch to the north, Woodland Drive to the east, Highland Drive to the south, and the Forest View to the west. The Project is within the Tahoe Regional Planning Agency (TRPA) Plan Area Statement area 149-Rubicon as well as part of the Environmental Improvement Program (EIP) Project #713. As part of EIP 713, Transportation Tahoe Engineering Division constructed the Rubicon IV Erosion Control Project. The project addressed most sources of erosion, but had minimal treatment and also helped to connect the storm water flows to Lonely Gulch. The main goal of this Project are to reduce the very fine and fine sediment which will improve the clarity of Lake Tahoe.

Original Budget: \$100,500

Expenditures thru 6/30/2012: \$0

Project Initiation Date: 04/01/13

*Prior FY includes actual revenue and expenditures through 06/30/12, plus amounts budgeted through 06/30/13.



Forest View Water Quality Project

Financing Plan & Tentative Schedule

Project No: 95195

Type: Erosion Control - (EIP)

Supervisor District(s) 5

All Figures in Thousands

Revenue by Funding Source	Prior FY*	FY 13/14	FY 14/15	FY 15/16	FY 16/17	FY 17/18	FY 18/19-22/23	FY 23/24-32/33	Total
California Tahoe Conservancy Site Improvement Grant	\$0	\$101	\$305	\$0	\$0	\$0	\$0	\$0	\$405
Total	\$0	\$101	\$305	\$0	\$0	\$0	\$0	\$0	\$405

All Figures in Thousands

Expenditures	Prior FY*	FY 13/14	FY 14/15	FY 15/16	FY 16/17	FY 17/18	FY 18/19-22/23	FY 23/24-32/33	Total
Design Engineering & Admin	\$0	\$101	\$20	\$0	\$0	\$0	\$0	\$0	\$120
Constr/Eng/Admin - Staff	\$0	\$0	\$60	\$0	\$0	\$0	\$0	\$0	\$60
Direct Construction Costs	\$0	\$0	\$205	\$0	\$0	\$0	\$0	\$0	\$205
Env Monitoring - Staff	\$0	\$0	\$10	\$0	\$0	\$0	\$0	\$0	\$10
Plant Establishment - Staff	\$0	\$0	\$10	\$0	\$0	\$0	\$0	\$0	\$10
Total	\$0	\$101	\$305	\$0	\$0	\$0	\$0	\$0	\$405

Project Schedule	Prior FY*	FY 13/14	FY 14/15	FY 15/16	FY 16/17	FY 17/18	FY 18/19-22/23	FY 23/24-32/33	
Planning/Environmental									
Design									
Right Of Way									
Construction									

**FY 18/19 - 22/23 and FY 23/24 - 32/33 revenue and expenditures are not included for the Tahoe EIP, as it is a five-year program.

*Prior FY includes actual revenue and expenditures through 06/30/12, plus amounts budgeted through 06/30/13.



Glenridge Erosion Control Project

CIP Project Summary

Project No: 95180

Type: Erosion Control - (EIP)

Supervisor District(s) 5

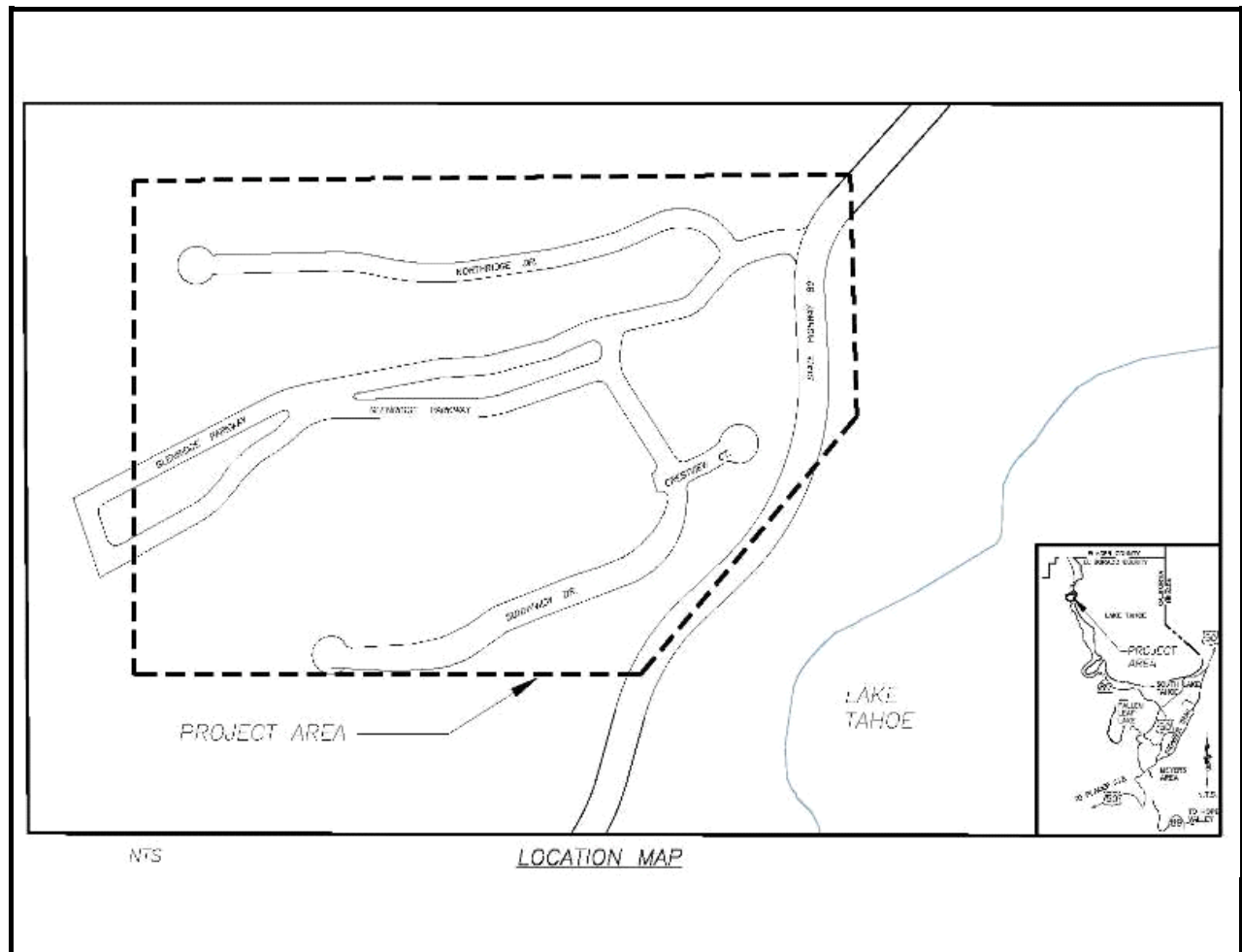

Project Description:

The Glenridge Erosion Control Project is bounded by the County of El Dorado and Placer County line to the north, forested lands to the west, State Route 89 to the east and Sunnyview Drive to the south. The main goal of the Project is to improve the clarity of Lake Tahoe by reducing the detrimental water quality impacts of the Glenridge Park Unit No. 1 subdivision on Lake Tahoe clarity. The objective of the Project is the reduction in the transport of fine sediment from the Project area by constructing water quality Best Management Practices (BMPs) prior to reaching Cold Creek to the maximum extent practicable.

Original Budget: \$2,797,000

Expenditures thru 6/30/2012: \$0

Project Initiation Date: 06/23/09

*Prior FY includes actual revenue and expenditures through 06/30/12, plus amounts budgeted through 06/30/13.



Glenridge Erosion Control Project

Financing Plan & Tentative Schedule

Project No: 95180

Type: Erosion Control - (EIP)

Supervisor District(s) 5

All Figures in Thousands

Revenue by Funding Source	Prior FY*	FY 13/14	FY 14/15	FY 15/16	FY 16/17	FY 17/18	FY 18/19-22/23	FY 23/24-32/33	Total
California Tahoe Conservancy Planning Grant	\$0	\$0	\$0	\$0	\$0	\$150	\$0	\$0	\$150
California Tahoe Conservancy Site Improvement Grant	\$0	\$0	\$0	\$0	\$0	\$0	\$0	\$0	\$0
Tahoe Regional Planning Agency/Water Quality	\$0	\$0	\$0	\$0	\$0	\$43	\$0	\$0	\$43
United States Forest Service Planning Grant	\$0	\$0	\$0	\$0	\$0	\$200	\$0	\$0	\$200
United States Forest Service Site Improvement Grant	\$0	\$0	\$0	\$0	\$0	\$0	\$0	\$0	\$0
Total	\$0	\$0	\$0	\$0	\$0	\$393	\$0	\$0	\$393

All Figures in Thousands

Expenditures	Prior FY*	FY 13/14	FY 14/15	FY 15/16	FY 16/17	FY 17/18	FY 18/19-22/23	FY 23/24-32/33	Total
Planning/Env - Consultant	\$0	\$0	\$0	\$0	\$0	\$1	\$0	\$0	\$1
Planning/Env - Staff	\$0	\$0	\$0	\$0	\$0	\$89	\$0	\$0	\$89
Design - Staff	\$0	\$0	\$0	\$0	\$0	\$300	\$0	\$0	\$300
Right of Way - Acquisition	\$0	\$0	\$0	\$0	\$0	\$0	\$0	\$0	\$0
Right of Way - Consultant	\$0	\$0	\$0	\$0	\$0	\$0	\$0	\$0	\$0
Right of Way - Staff	\$0	\$0	\$0	\$0	\$0	\$3	\$0	\$0	\$3
Construction Mgmt - Consultant	\$0	\$0	\$0	\$0	\$0	\$0	\$0	\$0	\$0
Construction Mgmt - Staff	\$0	\$0	\$0	\$0	\$0	\$0	\$0	\$0	\$0
Direct Construction Costs	\$0	\$0	\$0	\$0	\$0	\$0	\$0	\$0	\$0
Plant Establishment - Consultant	\$0	\$0	\$0	\$0	\$0	\$0	\$0	\$0	\$0
Plant Establishment - Staff	\$0	\$0	\$0	\$0	\$0	\$0	\$0	\$0	\$0
Total	\$0	\$0	\$0	\$0	\$0	\$393	\$0	\$0	\$393

Project Schedule	Prior FY*	FY 13/14	FY 14/15	FY 15/16	FY 16/17	FY 17/18	FY 18/19-22/23	FY 23/24-32/33	
Planning/Environmental									
Design									
Right Of Way									
Construction									

**FY 18/19 - 22/23 and FY 23/24 - 32/33 revenue and expenditures are not included for the Tahoe EIP, as it is a five-year program.

*Prior FY includes actual revenue and expenditures through 06/30/12, plus amounts budgeted through 06/30/13.



Golden Bear Erosion Control Project

CIP Project Summary

Project No: 95176

Type: Erosion Control - (EIP)

Supervisor District(s) 5

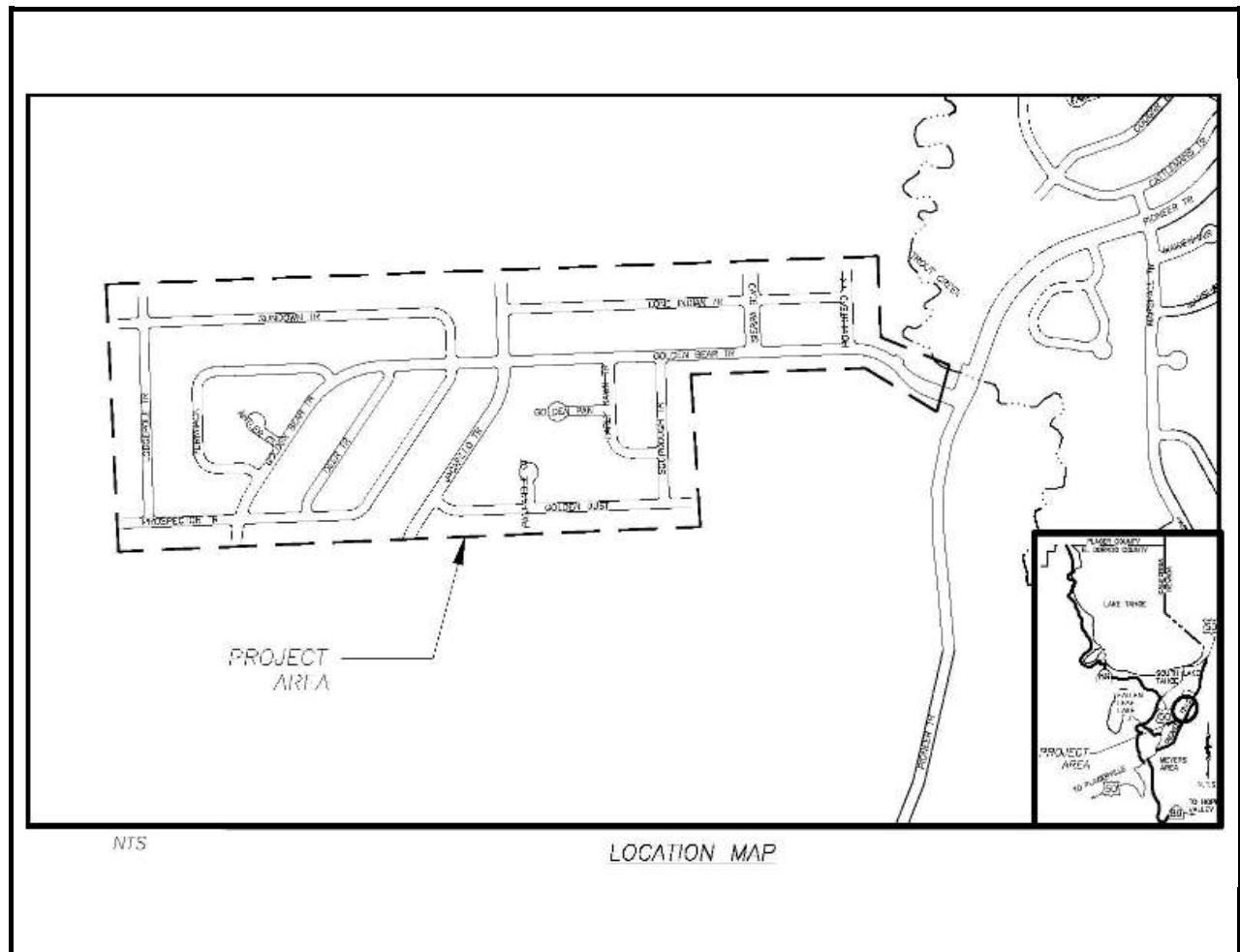

Project Description:

The Golden Bear Erosion Control Project is within the Tahoe Regional Planning Agency (TRPA) Plan Area Statement area 115-Golden Bear, 095-Trout/Cold Creek, and 100-Truckee Marsh (Figure A). In addition it is identified in the Environmental Improvement Program (EIP) as Area #703 requiring erosion control and water quality treatment Best Management Practices (BMPs). The subdivision was constructed with conveyance systems in the County ROW, including curb and gutter, drainage inlets, and underground storm drain pipe. These systems were designed to convey, but not to treat the storm water. The main goal of the Project is to reduce the very fine and fine sediment from the Montgomery Estates Unit No. 7 subdivision which will improve the clarity of Lake Tahoe.

Original Budget: \$3,034,271

Expenditures thru 6/30/2012: \$48,633

Project Initiation Date: 12/15/10

*Prior FY includes actual revenue and expenditures through 06/30/12, plus amounts budgeted through 06/30/13.



Golden Bear Erosion Control Project

Financing Plan & Tentative Schedule

Project No: 95176

Type: Erosion Control - (EIP)

Supervisor District(s) 5

All Figures in Thousands

Revenue by Funding Source	Prior FY*	FY 13/14	FY 14/15	FY 15/16	FY 16/17	FY 17/18	FY 18/19-22/23	FY 23/24-32/33	Total
California Tahoe Conservancy Site Improvement Grant	\$0	\$2	\$225	\$0	\$0	\$0	\$0	\$0	\$227
Tahoe Regional Planning Agency/Stream Environmental Zone	\$0	\$0	\$0	\$0	\$5	\$0	\$0	\$0	\$5
Tahoe Regional Planning Agency/Water Quality	\$30	\$2	\$10	\$5	\$0	\$0	\$0	\$0	\$47
United States Forest Service Planning Grant	\$69	\$75	\$2	\$0	\$0	\$0	\$0	\$0	\$146
United States Forest Service Site Improvement Grant	\$21	\$0	\$0	\$0	\$0	\$0	\$0	\$0	\$21
Total	\$120	\$79	\$237	\$5	\$5	\$0	\$0	\$0	\$446

All Figures in Thousands

Expenditures	Prior FY*	FY 13/14	FY 14/15	FY 15/16	FY 16/17	FY 17/18	FY 18/19-22/23	FY 23/24-32/33	Total
Environmental Monitoring	\$0	\$0	\$10	\$0	\$0	\$0	\$0	\$0	\$10
Planning/Env - Consultant	\$31	\$0	\$0	\$0	\$0	\$0	\$0	\$0	\$31
Planning/Env - Staff	\$3	\$15	\$0	\$0	\$0	\$0	\$0	\$0	\$18
Survey - Staff	\$1	\$4	\$0	\$0	\$0	\$0	\$0	\$0	\$5
Design - Consultant	\$0	\$0	\$0	\$0	\$0	\$0	\$0	\$0	\$0
Design - Staff	\$81	\$60	\$22	\$0	\$0	\$0	\$0	\$0	\$163
Right of Way - Consultant	\$1	\$0	\$0	\$0	\$0	\$0	\$0	\$0	\$1
Construction Mgmt - Staff	\$4	\$0	\$65	\$0	\$0	\$0	\$0	\$0	\$69
Direct Construction Costs	\$0	\$0	\$135	\$0	\$0	\$0	\$0	\$0	\$135
Plant Establishment - Consultant	\$0	\$0	\$0	\$0	\$0	\$0	\$0	\$0	\$0
Plant Establishment - Staff	\$0	\$0	\$5	\$5	\$5	\$0	\$0	\$0	\$15
Total	\$120	\$79	\$237	\$5	\$5	\$0	\$0	\$0	\$446

Project Schedule	Prior FY*	FY 13/14	FY 14/15	FY 15/16	FY 16/17	FY 17/18	FY 18/19-22/23	FY 23/24-32/33	
Planning/Environmental									
Design									
Right Of Way									
Construction									

**FY 18/19 - 22/23 and FY 23/24 - 32/33 revenue and expenditures are not included for the Tahoe EIP, as it is a five-year program.

*Prior FY includes actual revenue and expenditures through 06/30/12, plus amounts budgeted through 06/30/13.



Highway 89 Class 1 Trail

CIP Project Summary

Project No: 95708

Type: Erosion Control - (EIP)

Supervisor District(s) 5

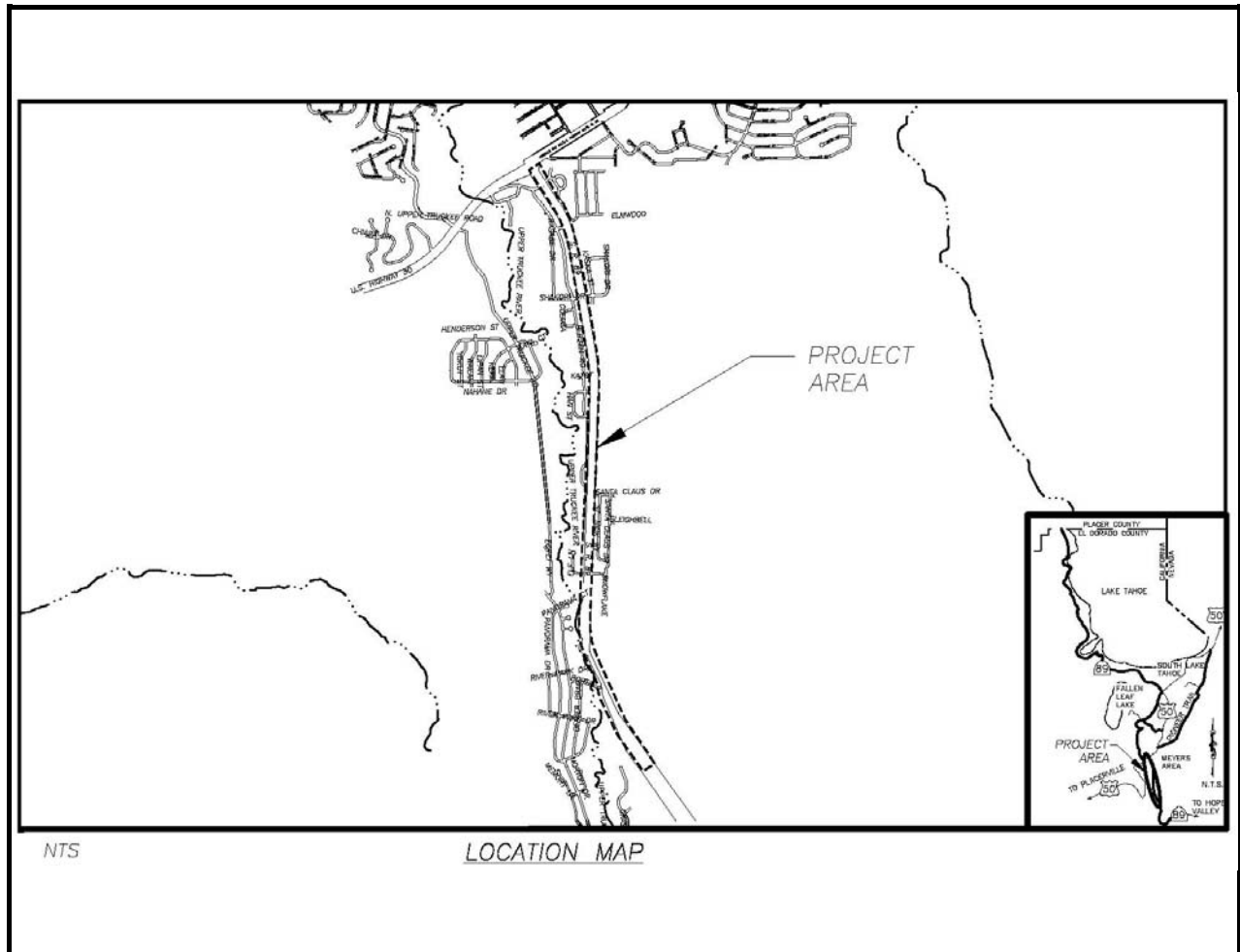

Project Description:

The Class I bikeway along State Route 89 from Portal Road to US Highway 50 in Christmas Valley is intended to improve the regional bicycle path network by providing a critical link through the Christmas Valley area. The purpose of the project is to provide access to local businesses, schools, and offices for bicyclists and pedestrians, to reduce vehicular transportation, and to enhance recreational opportunities within the Lake Tahoe Basin. This bicycle facility will connect to the existing Pat Lowe Memorial Bike Path in community of Meyers.

Original Budget: \$3,000,000

Expenditures thru 6/30/2012: \$0

Project Initiation Date: 02/13/07

*Prior FY includes actual revenue and expenditures through 06/30/12, plus amounts budgeted through 06/30/13.



Highway 89 Class 1 Trail

Financing Plan & Tentative Schedule

Project No: 95708

Type: Erosion Control - (EIP)

Supervisor District(s) 5

All Figures in Thousands

Revenue by Funding Source	Prior FY*	FY 13/14	FY 14/15	FY 15/16	FY 16/17	FY 17/18	FY 18/19-22/23	FY 23/24-32/33	Total
Bicycle Transportation Account (BTA)	\$0	\$0	\$0	\$24	\$55	\$49	\$0	\$0	\$128
California Tahoe Conservancy Site Improvement Grant	\$0	\$0	\$0	\$0	\$0	\$604	\$0	\$0	\$604
RSTP Exchange Funds-TRPA	\$0	\$0	\$58	\$35	\$0	\$0	\$0	\$0	\$93
Safe Routes to School	\$0	\$0	\$0	\$0	\$450	\$210	\$0	\$0	\$660
Tahoe Regional Planning Agency/Air Quality	\$0	\$0	\$0	\$100	\$250	\$25	\$0	\$0	\$375
Total	\$0	\$0	\$58	\$159	\$755	\$888	\$0	\$0	\$1,859

All Figures in Thousands

Expenditures	Prior FY*	FY 13/14	FY 14/15	FY 15/16	FY 16/17	FY 17/18	FY 18/19-22/23	FY 23/24-32/33	Total
Planning/Env - Consultant	\$0	\$0	\$25	\$5	\$0	\$1	\$0	\$0	\$31
Planning/Env - Staff	\$0	\$0	\$33	\$10	\$0	\$8	\$0	\$0	\$50
Design - Staff	\$0	\$0	\$0	\$144	\$0	\$0	\$0	\$0	\$144
Construction Mgmt - Consultant	\$0	\$0	\$0	\$0	\$0	\$7	\$0	\$0	\$7
Construction Mgmt - Staff	\$0	\$0	\$0	\$0	\$55	\$128	\$0	\$0	\$182
Direct Construction Costs	\$0	\$0	\$0	\$0	\$700	\$720	\$0	\$0	\$1,420
Env Monitoring - Staff	\$0	\$0	\$0	\$0	\$0	\$10	\$0	\$0	\$10
Env Monitoring - Staff	\$0	\$0	\$0	\$0	\$0	\$0	\$0	\$0	\$0
Plant Establishment - Consultant	\$0	\$0	\$0	\$0	\$0	\$0	\$0	\$0	\$0
Plant Establishment - Staff	\$0	\$0	\$0	\$0	\$0	\$15	\$0	\$0	\$15
Total	\$0	\$0	\$58	\$159	\$755	\$888	\$0	\$0	\$1,859

Project Schedule	Prior FY*	FY 13/14	FY 14/15	FY 15/16	FY 16/17	FY 17/18	FY 18/19-22/23	FY 23/24-32/33	
Planning/Environmental									
Design									
Right Of Way									
Construction									

**FY 18/19 - 22/23 and FY 23/24 - 32/33 revenue and expenditures are not included for the Tahoe EIP, as it is a five-year program.

*Prior FY includes actual revenue and expenditures through 06/30/12, plus amounts budgeted through 06/30/13.



Lake Tahoe Boulevard Bike Trail Project

CIP Project Summary

Project No: 95186

Type: Erosion Control - (EIP)

Supervisor District(s) 5

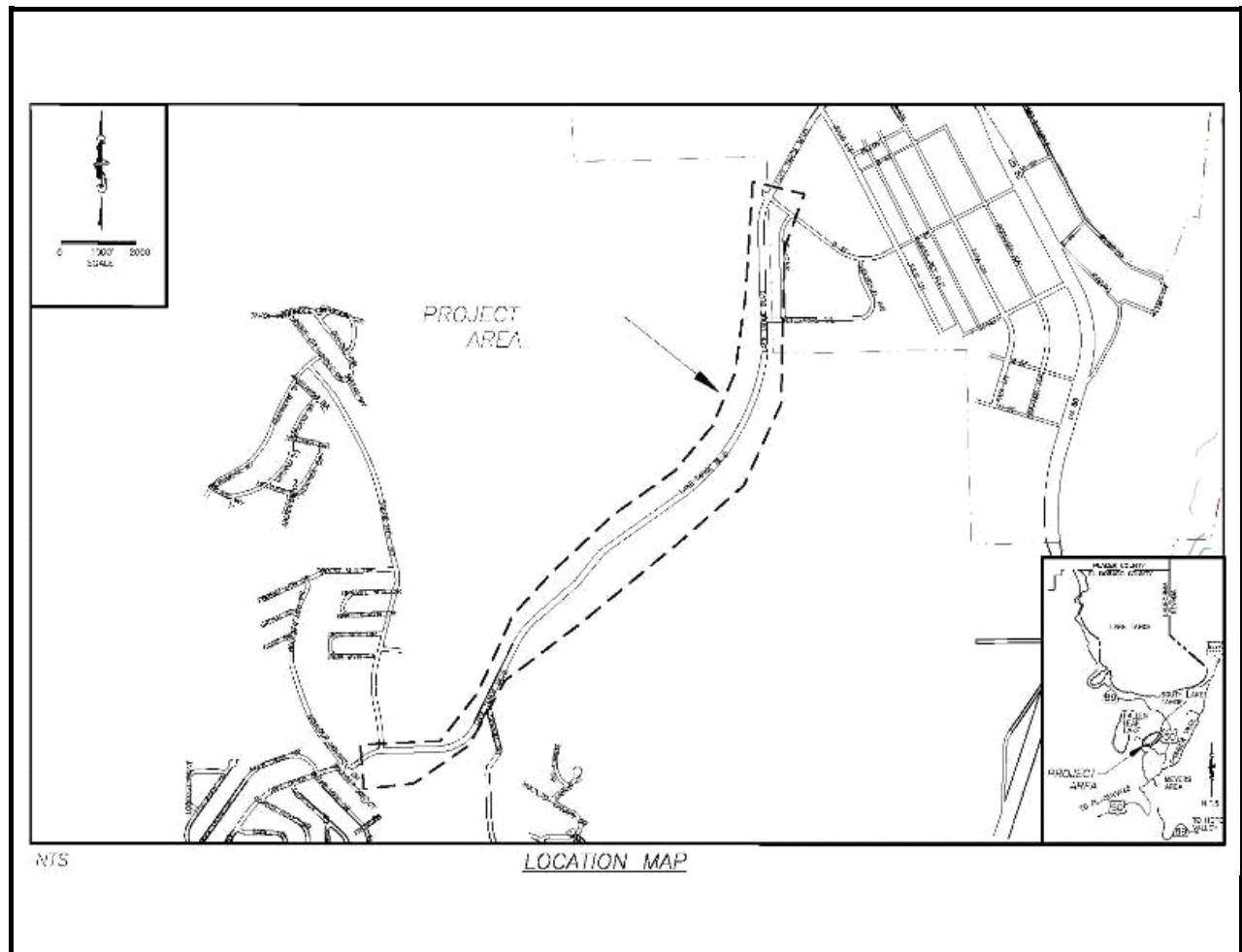

Project Description:

The Project proposes to construct a Class I multi-use path along Lake Tahoe Blvd from Sawmill Road to the City of South Lake Tahoe city limits and connect to the Class 2 bike lane at Viking Road. The purpose of the project is to provide access to local businesses, schools, and offices for bicyclists and pedestrians, to reduce vehicular transportation, and to enhance recreational opportunities within the Lake Tahoe Basin. This bicycle facility will connect to the existing Sawmill 2 Bike Path at the Sawmill Road/ Lake Tahoe Blvd intersection.

Original Budget: \$5,819,729

Expenditures thru 6/30/2012: \$403,028

Project Initiation Date: 12/15/05

*Prior FY includes actual revenue and expenditures through 06/30/12, plus amounts budgeted through 06/30/13.



Lake Tahoe Boulevard Bike Trail Project

Financing Plan & Tentative Schedule

Project No: 95186

Type: Erosion Control - (EIP)

Supervisor District(s) 5

All Figures in Thousands

Revenue by Funding Source	Prior FY*	FY 13/14	FY 14/15	FY 15/16	FY 16/17	FY 17/18	FY 18/19-22/23	FY 23/24-32/33	Total
Bicycle Transportation Account (BTA)	\$0	\$0	\$0	\$0	\$0	\$0	\$0	\$0	\$0
California Tahoe Conservancy Planning Grant	\$122	\$0	\$0	\$0	\$0	\$0	\$0	\$0	\$122
California Tahoe Conservancy Site Improvement Grant	\$0	\$0	\$0	\$0	\$0	\$0	\$0	\$0	\$0
Congestion Mitigation and Air Quality Program	\$178	\$323	\$0	\$0	\$0	\$0	\$0	\$0	\$501
RSTP Exchange Funds-TRPA	\$120	\$107	\$100	\$5	\$0	\$0	\$0	\$0	\$331
Safe Routes to School	\$0	\$450	\$0	\$0	\$0	\$0	\$0	\$0	\$450
Tahoe Regional Planning Agency/Air Quality	\$62	\$106	\$163	\$10	\$11	\$0	\$0	\$0	\$352
United States Forest Service Site Improvement Grant	\$0	\$0	\$0	\$0	\$0	\$0	\$0	\$0	\$0
Total	\$482	\$986	\$263	\$15	\$11	\$0	\$0	\$0	\$1,757

All Figures in Thousands

Expenditures	Prior FY*	FY 13/14	FY 14/15	FY 15/16	FY 16/17	FY 17/18	FY 18/19-22/23	FY 23/24-32/33	Total
Planning/Env - Consultant	\$76	\$0	\$0	\$0	\$0	\$0	\$0	\$0	\$76
Planning/Env - Staff	\$315	\$0	\$0	\$0	\$0	\$0	\$0	\$0	\$315
Planning/Environmental	\$15	\$0	\$0	\$0	\$0	\$0	\$0	\$0	\$15
Survey - Staff	\$0	\$25	\$0	\$0	\$0	\$0	\$0	\$0	\$25
Design - Staff	\$64	\$10	\$0	\$0	\$0	\$0	\$0	\$0	\$74
Right of Way - Consultant	\$6	\$0	\$0	\$0	\$0	\$0	\$0	\$0	\$6
Right of Way - Staff	\$4	\$0	\$0	\$0	\$0	\$0	\$0	\$0	\$4
Construction Mgmt - Consultant	\$0	\$14	\$0	\$0	\$0	\$0	\$0	\$0	\$14
Construction Mgmt - Staff	\$0	\$106	\$50	\$0	\$0	\$0	\$0	\$0	\$156
Direct Construction Costs	\$0	\$800	\$200	\$0	\$0	\$0	\$0	\$0	\$1,000
Env Monitoring - Consultant	\$2	\$0	\$0	\$0	\$0	\$0	\$0	\$0	\$2
Env Monitoring - Staff	\$0	\$2	\$1	\$1	\$1	\$0	\$0	\$0	\$5
Plant Establishment - Consultant	\$0	\$25	\$6	\$4	\$0	\$0	\$0	\$0	\$34
Plant Establishment - Staff	\$0	\$5	\$7	\$10	\$10	\$0	\$0	\$0	\$32
Total	\$482	\$986	\$263	\$15	\$11	\$0	\$0	\$0	\$1,757

Project Schedule	Prior FY*	FY 13/14	FY 14/15	FY 15/16	FY 16/17	FY 17/18	FY 18/19-22/23	FY 23/24-32/33	
Planning/Environmental									
Design									
Right Of Way									
Construction									

**FY 18/19 - 22/23 and FY 23/24 - 32/33 revenue and expenditures are not included for the Tahoe EIP, as it is a five-year program.

*Prior FY includes actual revenue and expenditures through 06/30/12, plus amounts budgeted through 06/30/13.



Lake Tahoe Boulevard Erosion Control Project

CIP Project Summary

Project No: 95163

Type: Erosion Control - (EIP)

Supervisor District(s) 5

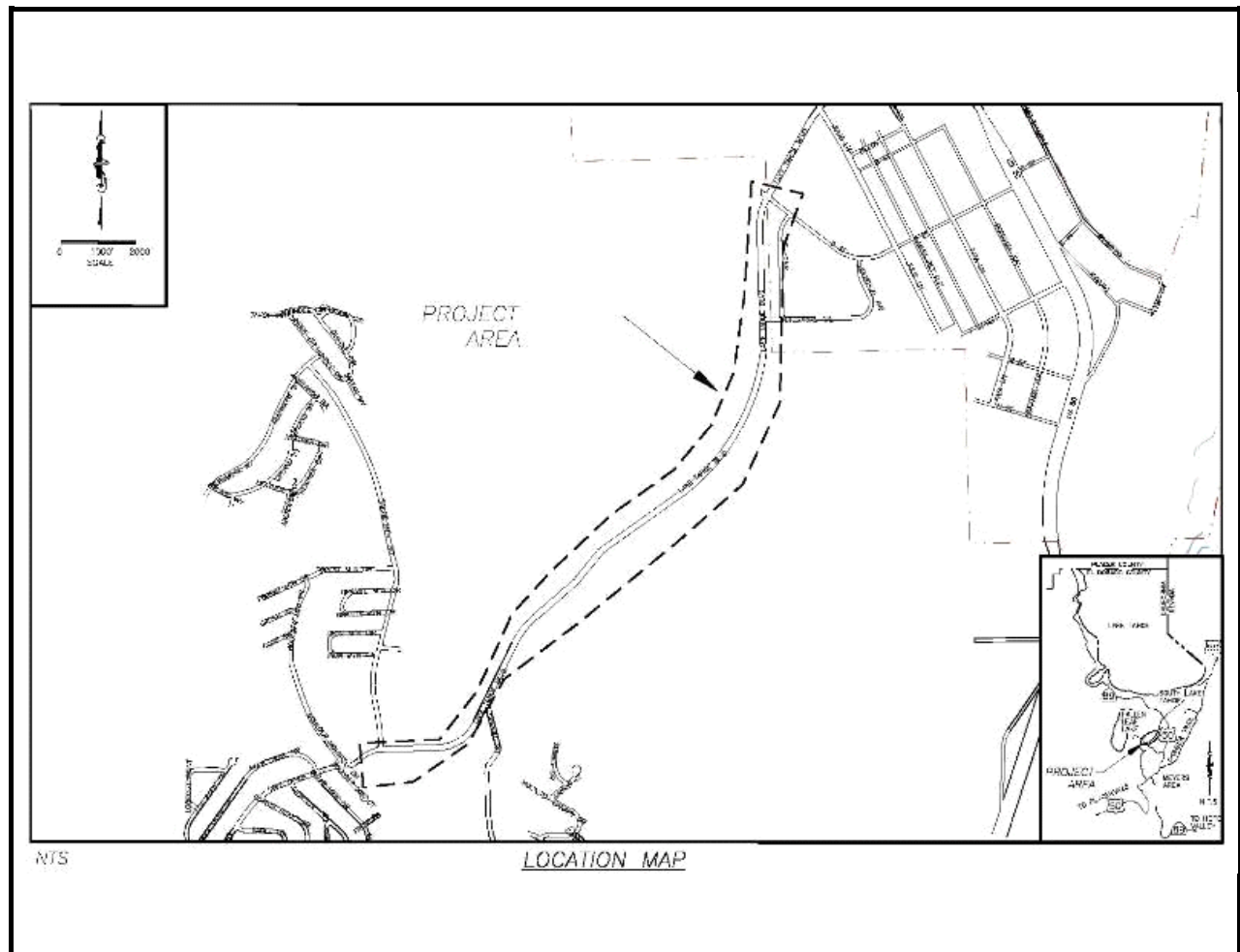

Project Description:

This is one of three Project components within this area, CIP No. 95186 which contains a Class I multi-use path and the restoration of the stream environment zone (SEZ) (CIP No. 95175) to its natural function near the intersection of Lake Tahoe Blvd and Sawmill Road. This component, along with CIP No. 95175 is combined as one. The Project will implement erosion source controls, storm water treatment facilities and SEZ enhancements along the Lake Tahoe Boulevard corridor from Clear View Drive to Industrial Ave. The Project intends connect the Class 2 bike lanes at Clear View Drive and tie into the Class 1 bike facilities at Sawmill Road.

Original Budget: \$2,141,077

Expenditures thru 6/30/2012: \$176,769

Project Initiation Date: 02/15/07

*Prior FY includes actual revenue and expenditures through 06/30/12, plus amounts budgeted through 06/30/13.



Lake Tahoe Boulevard Erosion Control Project

Financing Plan & Tentative Schedule

Project No: 95163

Type: Erosion Control - (EIP)

Supervisor District(s) 5

All Figures in Thousands

Revenue by Funding Source	Prior FY*	FY 13/14	FY 14/15	FY 15/16	FY 16/17	FY 17/18	FY 18/19-22/23	FY 23/24-32/33	Total
California Tahoe Conservancy Planning Grant	\$103	\$0	\$0	\$0	\$0	\$0	\$0	\$0	\$103
Tahoe Regional Planning Agency/Water Quality	\$45	\$0	\$0	\$5	\$5	\$0	\$0	\$0	\$54
United States Forest Service Planning Grant	\$0	\$0	\$0	\$0	\$0	\$0	\$0	\$0	\$0
United States Forest Service Site Improvement Grant	\$86	\$60	\$450	\$198	\$7	\$0	\$0	\$0	\$801
Total	\$234	\$60	\$450	\$203	\$12	\$0	\$0	\$0	\$959

All Figures in Thousands

Expenditures	Prior FY*	FY 13/14	FY 14/15	FY 15/16	FY 16/17	FY 17/18	FY 18/19-22/23	FY 23/24-32/33	Total
Survey - Staff	\$0	\$0	\$0	\$0	\$0	\$0	\$0	\$0	\$0
Design - Consultant	\$45	\$0	\$0	\$0	\$0	\$0	\$0	\$0	\$45
Design - Staff	\$168	\$59	\$0	\$0	\$0	\$0	\$0	\$0	\$226
Right of Way - Staff	\$1	\$2	\$0	\$0	\$0	\$0	\$0	\$0	\$2
Construction Mgmt - Consultant	\$0	\$0	\$5	\$5	\$0	\$0	\$0	\$0	\$10
Construction Mgmt - Staff	\$15	\$0	\$75	\$30	\$0	\$0	\$0	\$0	\$120
Direct Construction Costs	\$0	\$0	\$350	\$150	\$0	\$0	\$0	\$0	\$500
Env Monitoring - Consultant	\$1	\$0	\$1	\$1	\$1	\$0	\$0	\$0	\$3
Env Monitoring - Staff	\$4	\$0	\$5	\$5	\$5	\$0	\$0	\$0	\$19
Plant Establishment - Consultant	\$0	\$0	\$6	\$2	\$1	\$0	\$0	\$0	\$9
Plant Establishment - Staff	\$0	\$0	\$9	\$10	\$5	\$0	\$0	\$0	\$24
Total	\$234	\$60	\$450	\$203	\$12	\$0	\$0	\$0	\$959

Project Schedule	Prior FY*	FY 13/14	FY 14/15	FY 15/16	FY 16/17	FY 17/18	FY 18/19-22/23	FY 23/24-32/33	
Planning/Environmental									
Design									
Right Of Way									
Construction									

**FY 18/19 - 22/23 and FY 23/24 - 32/33 revenue and expenditures are not included for the Tahoe EIP, as it is a five-year program.

*Prior FY includes actual revenue and expenditures through 06/30/12, plus amounts budgeted through 06/30/13.



Lake Tahoe Boulevard SEZ Project

CIP Project Summary

Project No: 95175

Type: Erosion Control - (EIP)

Supervisor District(s) 5

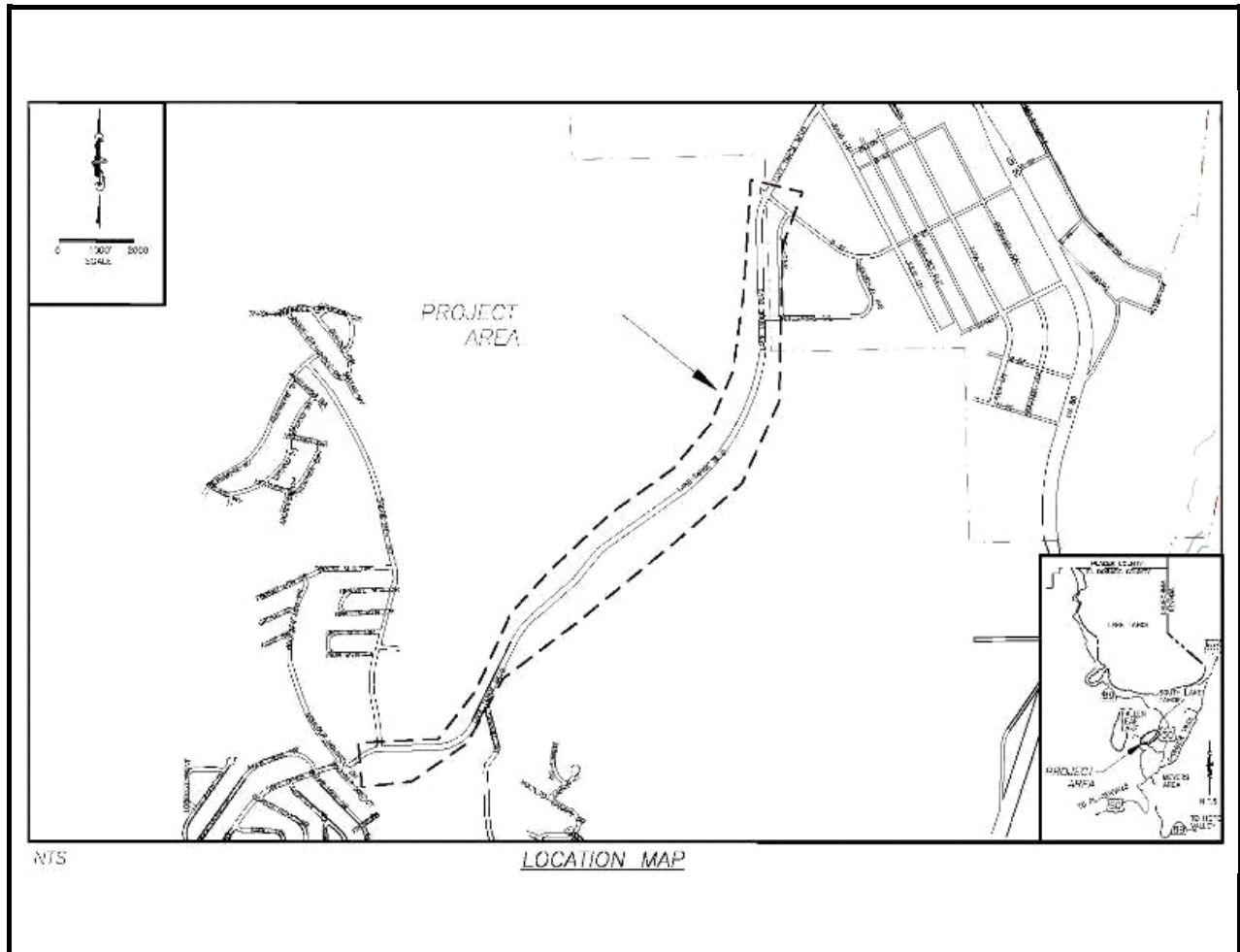

Project Description:

This is one of three Project components within this area, CIP No. 95186 which contains a Class I multi-use path and CIP No. 95163 contains water quality/ erosion control improvements along with the the construction of Class 2 bike lanes. This component, along with CIP No. 95163 is combined as one. The Project will implement erosion source controls, storm water treatment facilities and stream environment zone (SEZ) enhancements along the Lake Tahoe Boulevard corridor from Clear View Drive to Industrial Ave.

Original Budget: \$7,346,266

Expenditures thru 6/30/2012: \$212,119

Project Initiation Date: 10/15/05

*Prior FY includes actual revenue and expenditures through 06/30/12, plus amounts budgeted through 06/30/13.



Lake Tahoe Boulevard SEZ Project

Financing Plan & Tentative Schedule

Project No: 95175

Type: Erosion Control - (EIP)

Supervisor District(s) 5

All Figures in Thousands

Revenue by Funding Source	Prior FY*	FY 13/14	FY 14/15	FY 15/16	FY 16/17	FY 17/18	FY 18/19-22/23	FY 23/24-32/33	Total
California Tahoe Conservancy Planning Grant	\$130	\$0	\$0	\$0	\$0	\$0	\$0	\$0	\$130
California Tahoe Conservancy Site Improvement Grant	\$0	\$0	\$0	\$68	\$350	\$0	\$0	\$0	\$418
RSTP Exchange Funds-TRPA	\$0	\$0	\$0	\$0	\$81	\$0	\$0	\$0	\$81
Tahoe Regional Planning Agency/Air Quality	\$8	\$0	\$0	\$0	\$0	\$0	\$0	\$0	\$8
Tahoe Regional Planning Agency/Stream Environmental Zone	\$75	\$3	\$35	\$35	\$40	\$0	\$0	\$0	\$187
United States Forest Service Planning Grant	\$0	\$0	\$0	\$0	\$0	\$0	\$0	\$0	\$0
United States Forest Service Site Improvement Grant	\$22	\$20	\$133	\$121	\$0	\$0	\$0	\$0	\$296
Total	\$235	\$22	\$168	\$224	\$471	\$0	\$0	\$0	\$1,120

All Figures in Thousands

Expenditures	Prior FY*	FY 13/14	FY 14/15	FY 15/16	FY 16/17	FY 17/18	FY 18/19-22/23	FY 23/24-32/33	Total
Planning/Env - Consultant	\$111	\$0	\$0	\$0	\$0	\$0	\$0	\$0	\$111
Survey - Staff	\$0	\$0	\$0	\$0	\$0	\$0	\$0	\$0	\$0
Design - Staff	\$111	\$22	\$0	\$0	\$0	\$0	\$0	\$0	\$133
Right of Way - Consultant	\$2	\$0	\$0	\$0	\$0	\$0	\$0	\$0	\$2
Construction Mgmt - Consultant	\$0	\$0	\$5	\$5	\$5	\$0	\$0	\$0	\$15
Construction Mgmt - Staff	\$0	\$0	\$36	\$45	\$85	\$0	\$0	\$0	\$166
Direct Construction Costs	\$0	\$0	\$100	\$150	\$350	\$0	\$0	\$0	\$600
Env Monitoring - Consultant	\$11	\$0	\$1	\$1	\$1	\$0	\$0	\$0	\$13
Env Monitoring - Staff	\$0	\$0	\$4	\$4	\$6	\$0	\$0	\$0	\$13
Plant Establishment - Consultant	\$0	\$0	\$8	\$5	\$5	\$0	\$0	\$0	\$18
Plant Establishment - Staff	\$0	\$0	\$15	\$15	\$20	\$0	\$0	\$0	\$50
Total	\$235	\$22	\$168	\$224	\$471	\$0	\$0	\$0	\$1,120

Project Schedule	Prior FY*	FY 13/14	FY 14/15	FY 15/16	FY 16/17	FY 17/18	FY 18/19-22/23	FY 23/24-32/33	
Planning/Environmental									
Design									
Right Of Way									
Construction									

**FY 18/19 - 22/23 and FY 23/24 - 32/33 revenue and expenditures are not included for the Tahoe EIP, as it is a five-year program.

*Prior FY includes actual revenue and expenditures through 06/30/12, plus amounts budgeted through 06/30/13.



Meyers Erosion Control Project

CIP Project Summary

Project No: 95179

Type: Erosion Control - (EIP)

Supervisor District(s) 5

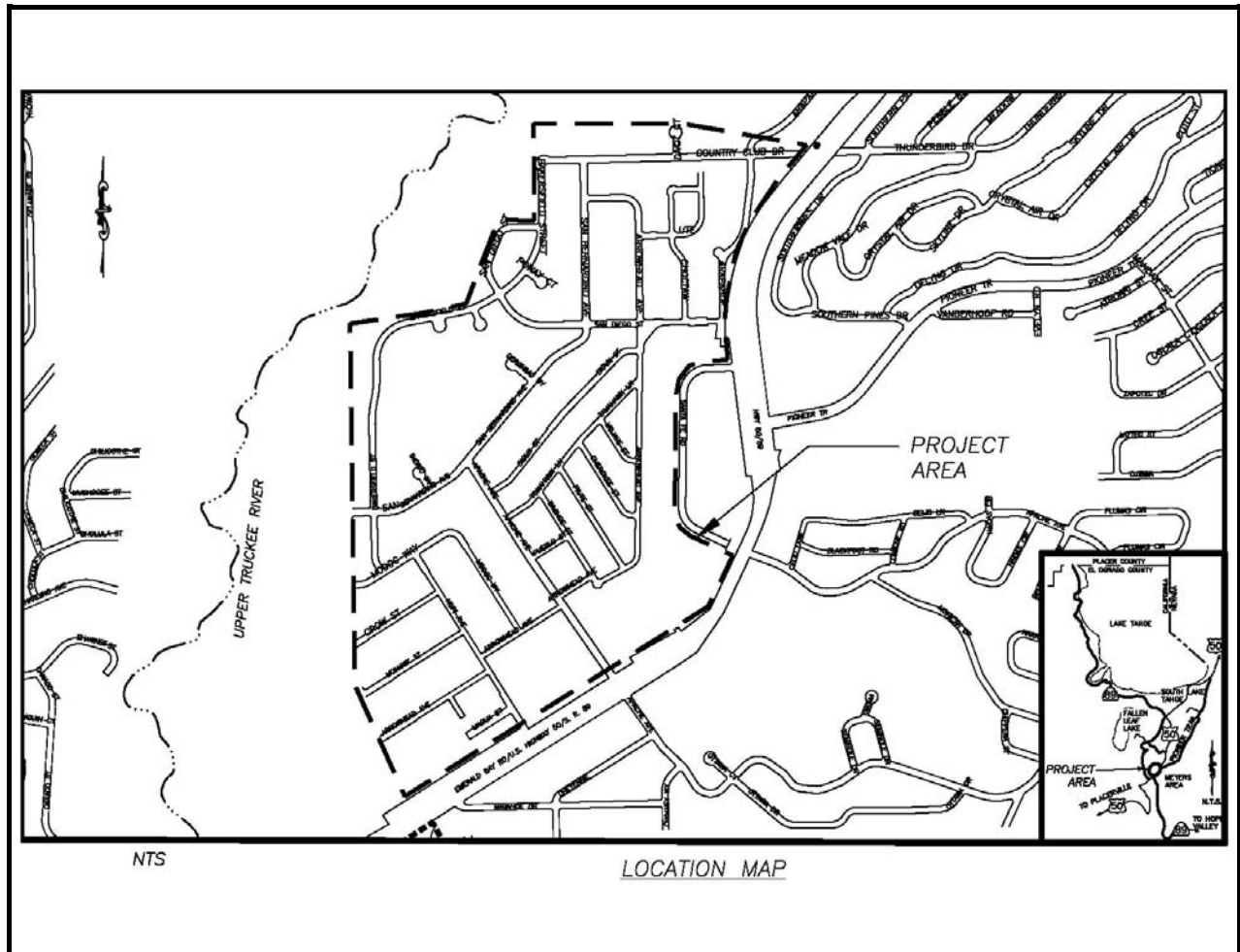

Project Description:

The Meyers Erosion Control Project is located in Tahoe Paradise-Meadowvale, Tahoe Paradise-Mandan and Meyers Residential. The main goal of the Project is to improve the clarity of Lake Tahoe by reducing the detrimental water quality impacts of the Meyers residential area on Lake Tahoe clarity. The objective of the Project is the reduction in the transport of fine sediment from the Project area by constructing water quality Best Management Practices (BMPs) within the Project area. This Project will be split into several areas with the main area focused on the US 50/Meyers corridor area based on the Pollutant Load reductions models.

Original Budget: \$2,722,500

Expenditures thru 6/30/2012: \$167,095

Project Initiation Date: 12/15/10

*Prior FY includes actual revenue and expenditures through 06/30/12, plus amounts budgeted through 06/30/13.



Meyers Erosion Control Project

Financing Plan & Tentative Schedule

Project No: 95179

Type: Erosion Control - (EIP)

Supervisor District(s) 5

All Figures in Thousands

Revenue by Funding Source	Prior FY*	FY 13/14	FY 14/15	FY 15/16	FY 16/17	FY 17/18	FY 18/19-22/23	FY 23/24-32/33	Total
California Tahoe Conservancy Planning Grant	\$8	\$0	\$0	\$0	\$0	\$0	\$0	\$0	\$8
Tahoe Regional Planning Agency/Stream Environmental Zone	\$0	\$28	\$0	\$85	\$75	\$20	\$0	\$0	\$208
Tahoe Regional Planning Agency/Water Quality	\$0	\$0	\$0	\$0	\$0	\$0	\$0	\$0	\$0
United States Forest Service Planning Grant	\$271	\$61	\$0	\$0	\$0	\$0	\$0	\$0	\$332
United States Forest Service Site Improvement Grant	\$0	\$0	\$420	\$0	\$0	\$0	\$0	\$0	\$420
Total	\$279	\$89	\$420	\$85	\$75	\$20	\$0	\$0	\$968

All Figures in Thousands

Expenditures	Prior FY*	FY 13/14	FY 14/15	FY 15/16	FY 16/17	FY 17/18	FY 18/19-22/23	FY 23/24-32/33	Total
Planning/Env - Consultant	\$20	\$2	\$0	\$0	\$0	\$0	\$0	\$0	\$22
Planning/Env - Staff	\$84	\$0	\$0	\$0	\$0	\$0	\$0	\$0	\$84
Survey - Staff	\$61	\$2	\$10	\$0	\$0	\$0	\$0	\$0	\$73
Design - Consultant	\$0	\$0	\$0	\$0	\$0	\$0	\$0	\$0	\$0
Design - Staff	\$92	\$72	\$0	\$0	\$0	\$0	\$0	\$0	\$164
Right of Way - Acquisition	\$1	\$0	\$0	\$0	\$0	\$0	\$0	\$0	\$1
Right of Way - Consultant	\$3	\$0	\$0	\$0	\$0	\$0	\$0	\$0	\$3
Right of Way - Staff	\$5	\$2	\$0	\$0	\$0	\$0	\$0	\$0	\$7
Construction Mgmt - Staff	\$0	\$0	\$80	\$5	\$5	\$0	\$0	\$0	\$90
Direct Construction Costs	\$0	\$0	\$300	\$15	\$15	\$0	\$0	\$0	\$330
Env Monitoring - Consultant	\$3	\$2	\$0	\$5	\$5	\$3	\$0	\$0	\$17
Env Monitoring - Staff	\$10	\$10	\$10	\$25	\$15	\$8	\$0	\$0	\$78
Plant Establishment - Consultant	\$0	\$0	\$0	\$15	\$15	\$0	\$0	\$0	\$30
Plant Establishment - Staff	\$0	\$0	\$20	\$20	\$20	\$10	\$0	\$0	\$70
Total	\$279	\$89	\$420	\$85	\$75	\$20	\$0	\$0	\$968

Project Schedule	Prior FY*	FY 13/14	FY 14/15	FY 15/16	FY 16/17	FY 17/18	FY 18/19-22/23	FY 23/24-32/33	
Planning/Environmental									
Design									
Right Of Way									
Construction									

**FY 18/19 - 22/23 and FY 23/24 - 32/33 revenue and expenditures are not included for the Tahoe EIP, as it is a five-year program.

*Prior FY includes actual revenue and expenditures through 06/30/12, plus amounts budgeted through 06/30/13.



Montgomery Estates Area 1A Erosion Control Project

CIP Project Summary

Project No: 95155

Type: Erosion Control - (EIP)

Supervisor District(s) 5

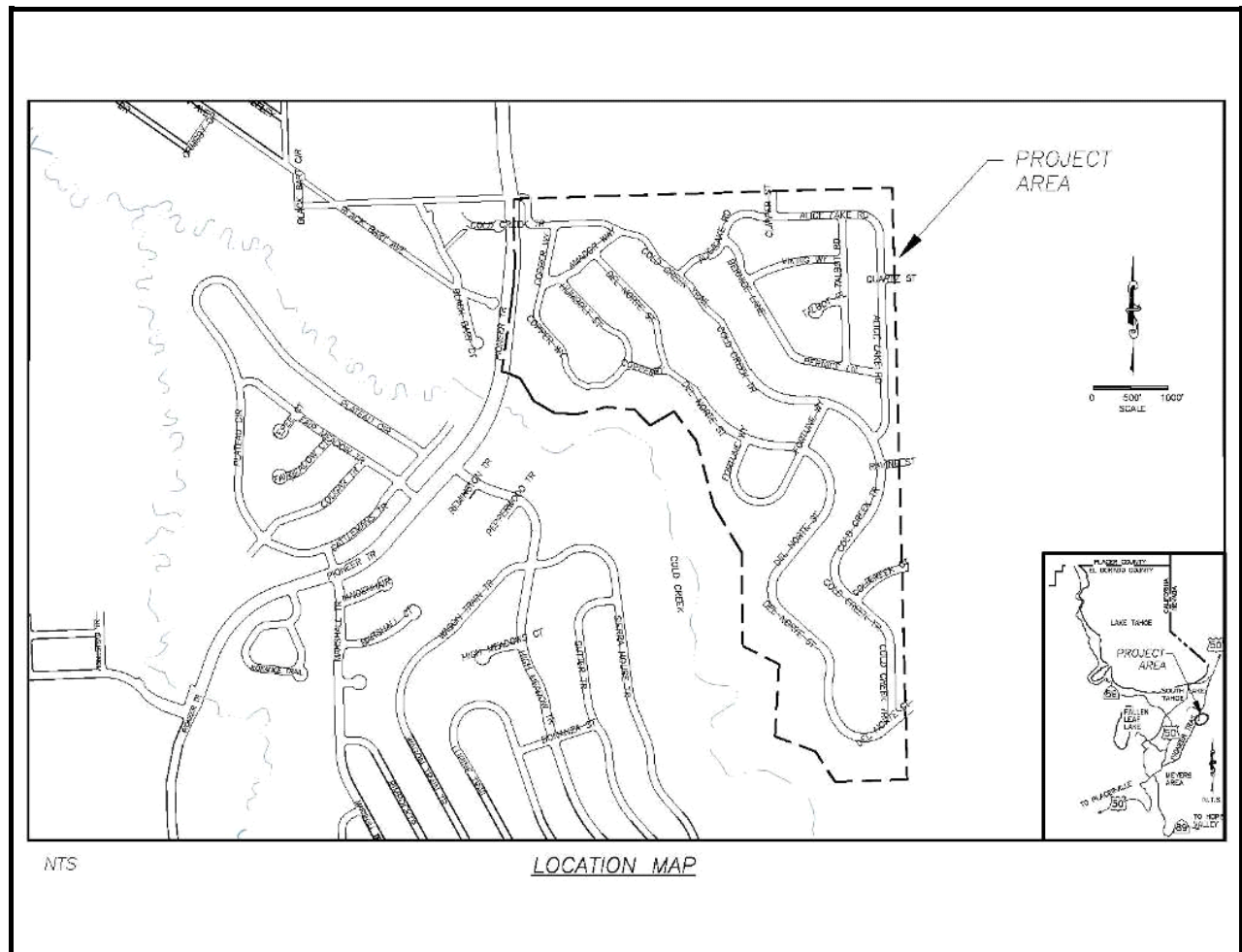

Project Description:

The Montgomery Estates Area 1A Erosion Control Project encompasses the streets of Fortune Way, Del Norte Street, Cold Creek Trail, Copper Way and Alice Lake Road. The main goals of the Project are related to improving the water quality of runoff to Lake Tahoe by reducing erosion and sediment flow originating in the Project area. The Project goals are remove/reduce fine sediment originating from the Project areas prior to reaching Cold Creek to the maximum extent practicable. Remove/reduce coarse sediment originating from the Project areas prior to reaching the Cold Creek to the maximum extent practicable.

Original Budget: \$3,214,876

Expenditures thru 6/30/2012: \$1,867,256

Project Initiation Date: 12/15/01

*Prior FY includes actual revenue and expenditures through 06/30/12, plus amounts budgeted through 06/30/13.



Montgomery Estates Area 1A Erosion Control Project

Financing Plan & Tentative Schedule

Project No: 95155

Type: Erosion Control - (EIP)

Supervisor District(s) 5

All Figures in Thousands

Revenue by Funding Source	Prior FY*	FY 13/14	FY 14/15	FY 15/16	FY 16/17	FY 17/18	FY 18/19-22/23	FY 23/24-32/33	Total
California Tahoe Conservancy Planning Grant	\$370	\$0	\$0	\$0	\$0	\$0	\$0	\$0	\$370
Erosion Control Discretionary	\$0	\$0	\$0	\$0	\$0	\$0	\$0	\$0	\$0
Tahoe Regional Planning Agency/Water Quality	\$252	\$0	\$0	\$0	\$0	\$0	\$0	\$0	\$252
United States Forest Service Planning Grant	\$853	\$0	\$0	\$0	\$0	\$0	\$0	\$0	\$853
United States Forest Service Site Improvement Grant	\$408	\$8	\$10	\$0	\$0	\$0	\$0	\$0	\$426
Total	\$1,883	\$8	\$10	\$0	\$0	\$0	\$0	\$0	\$1,901

All Figures in Thousands

Expenditures	Prior FY*	FY 13/14	FY 14/15	FY 15/16	FY 16/17	FY 17/18	FY 18/19-22/23	FY 23/24-32/33	Total
Design - Consultant	\$777	\$0	\$0	\$0	\$0	\$0	\$0	\$0	\$777
Design - Staff	\$612	\$0	\$0	\$0	\$0	\$0	\$0	\$0	\$612
Right of Way - Acquisition	\$12	\$0	\$0	\$0	\$0	\$0	\$0	\$0	\$12
Right of Way - Staff	\$23	\$0	\$0	\$0	\$0	\$0	\$0	\$0	\$23
Construction Mgmt - Consultant	\$2	\$0	\$0	\$0	\$0	\$0	\$0	\$0	\$2
Construction Mgmt - Staff	\$104	\$0	\$0	\$0	\$0	\$0	\$0	\$0	\$104
Direct Construction Costs	\$255	\$0	\$0	\$0	\$0	\$0	\$0	\$0	\$255
Env Monitoring - Consultant	\$55	\$0	\$0	\$0	\$0	\$0	\$0	\$0	\$55
Env Monitoring - Staff	\$35	\$4	\$0	\$0	\$0	\$0	\$0	\$0	\$38
Plant Establishment - Consultant	\$0	\$1	\$0	\$0	\$0	\$0	\$0	\$0	\$1
Plant Establishment - Staff	\$10	\$3	\$10	\$0	\$0	\$0	\$0	\$0	\$23
Total	\$1,883	\$8	\$10	\$0	\$0	\$0	\$0	\$0	\$1,901

Project Schedule	Prior FY*	FY 13/14	FY 14/15	FY 15/16	FY 16/17	FY 17/18	FY 18/19-22/23	FY 23/24-32/33	
Planning/Environmental									
Design									
Right Of Way									
Construction									

**FY 18/19 - 22/23 and FY 23/24 - 32/33 revenue and expenditures are not included for the Tahoe EIP, as it is a five-year program.

*Prior FY includes actual revenue and expenditures through 06/30/12, plus amounts budgeted through 06/30/13.



Montgomery Estates Area 1B Erosion Control Project

CIP Project Summary

Project No: 95193

Type: Erosion Control - (EIP)

Supervisor District(s) 5

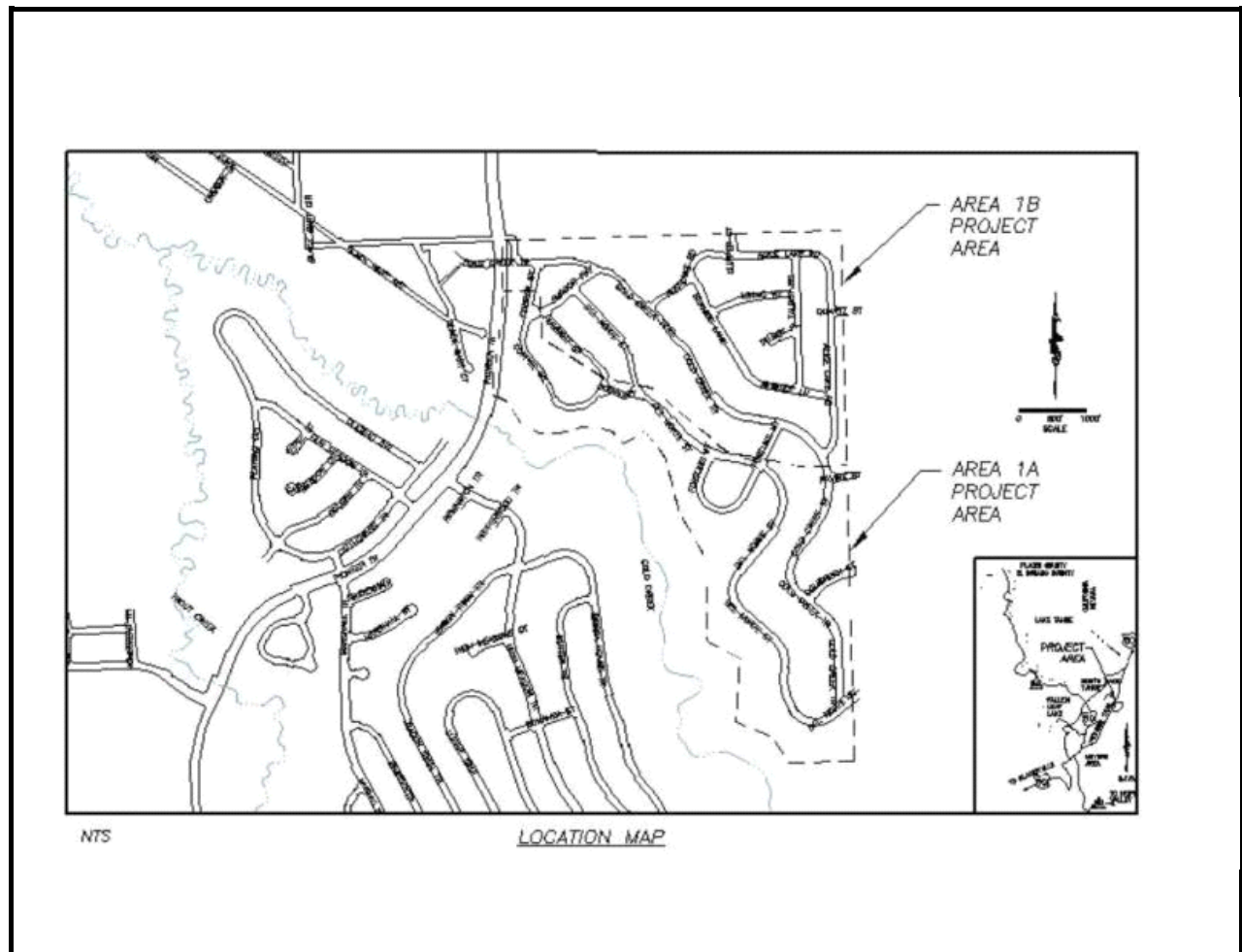

Project Description:

The Montgomery Estates Area 1B Erosion Control Project is the second phase within the Area 1 project area (CIP No. 95155). The Area 1B Project area encompasses the streets of Del Norte Street, Amador Way, Cold Creek Trail, Talbot Court and Alice Lake Road. The main goals of the Project are related to improving the water quality of runoff to Lake Tahoe by reducing erosion and sediment flow originating in the Project area. The Project goals are remove/reduce fine sediment originating from the Project areas prior to reaching Cold Creek to the maximum extent practicable. Remove/reduce coarse sediment originating from the Project areas prior to reaching the Cold Creek to the maximum extent practicable.

Original Budget: \$919,000

Expenditures thru 6/30/2012: \$81,166

Project Initiation Date: 09/01/11

*Prior FY includes actual revenue and expenditures through 06/30/12, plus amounts budgeted through 06/30/13.



Montgomery Estates Area 1B Erosion Control Project

Financing Plan & Tentative Schedule

Project No: 95193

Type: Erosion Control - (EIP)

Supervisor District(s) 5

All Figures in Thousands

Revenue by Funding Source	Prior FY*	FY 13/14	FY 14/15	FY 15/16	FY 16/17	FY 17/18	FY 18/19-22/23	FY 23/24-32/33	Total
Tahoe Regional Planning Agency/Water Quality	\$10	\$2	\$2	\$0	\$0	\$0	\$0	\$0	\$14
United States Forest Service Site Improvement Grant	\$649	\$9	\$8	\$0	\$0	\$0	\$0	\$0	\$666
Total	\$659	\$11	\$10	\$0	\$0	\$0	\$0	\$0	\$680

All Figures in Thousands

Expenditures	Prior FY*	FY 13/14	FY 14/15	FY 15/16	FY 16/17	FY 17/18	FY 18/19-22/23	FY 23/24-32/33	Total
Design - Consultant	\$1	\$0	\$0	\$0	\$0	\$0	\$0	\$0	\$1
Design - Staff	\$51	\$0	\$0	\$0	\$0	\$0	\$0	\$0	\$51
Right of Way - Acquisition	\$3	\$0	\$0	\$0	\$0	\$0	\$0	\$0	\$3
Right of Way - Consultant	\$7	\$0	\$0	\$0	\$0	\$0	\$0	\$0	\$7
Right of Way - Staff	\$9	\$0	\$0	\$0	\$0	\$0	\$0	\$0	\$9
Construction Mgmt - Consultant	\$1	\$0	\$0	\$0	\$0	\$0	\$0	\$0	\$1
Construction Mgmt - Staff	\$108	\$1	\$0	\$0	\$0	\$0	\$0	\$0	\$109
Direct Construction Costs	\$450	\$0	\$0	\$0	\$0	\$0	\$0	\$0	\$450
Env Monitoring - Consultant	\$1	\$1	\$0	\$0	\$0	\$0	\$0	\$0	\$2
Env Monitoring - Staff	\$6	\$5	\$2	\$0	\$0	\$0	\$0	\$0	\$13
Plant Establishment - Consultant	\$12	\$0	\$0	\$0	\$0	\$0	\$0	\$0	\$12
Plant Establishment - Staff	\$10	\$5	\$8	\$0	\$0	\$0	\$0	\$0	\$23
Total	\$659	\$11	\$10	\$0	\$0	\$0	\$0	\$0	\$680

Project Schedule	Prior FY*	FY 13/14	FY 14/15	FY 15/16	FY 16/17	FY 17/18	FY 18/19-22/23	FY 23/24-32/33	
Planning/Environmental									
Design									
Right Of Way									
Construction									

**FY 18/19 - 22/23 and FY 23/24 - 32/33 revenue and expenditures are not included for the Tahoe EIP, as it is a five-year program.

*Prior FY includes actual revenue and expenditures through 06/30/12, plus amounts budgeted through 06/30/13.



Montgomery Estates Area 2 Erosion Control Project

CIP Project Summary

Project No: 95170

Type: Erosion Control - (EIP)

Supervisor District(s) 5

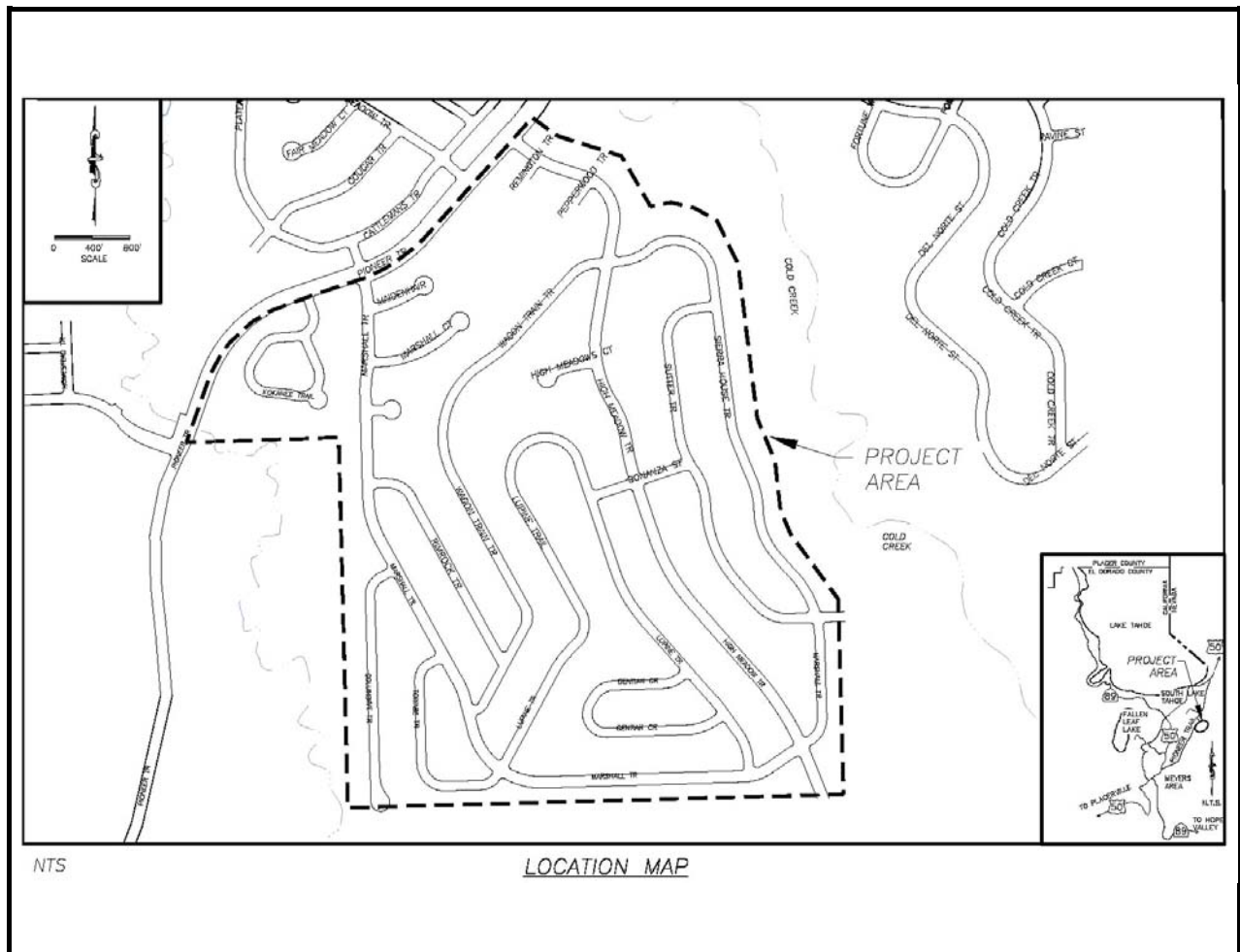

Project Description:

The Montgomery Estates Area 2 Erosion Control is bounded by Pioneer Trail to the south, Trout Creek to the east and Cold Creek to the west. The main goal of the Project is to improve the clarity of Lake Tahoe by reducing the detrimental water quality impacts of the Montgomery Estates subdivision on Lake Tahoe clarity. The objective of the Project is the reduction in the transport of fine sediment from the Project area by constructing water quality Best Management Practices (BMPs) prior to reaching Cold Creek to the maximum extent practicable.

Original Budget: \$1,984,300

Expenditures thru 6/30/2012: \$146,568

Project Initiation Date: 12/15/01

*Prior FY includes actual revenue and expenditures through 06/30/12, plus amounts budgeted through 06/30/13.



Montgomery Estates Area 2 Erosion Control Project

Financing Plan & Tentative Schedule

Project No: 95170

Type: Erosion Control - (EIP)

Supervisor District(s) 5

All Figures in Thousands

Revenue by Funding Source	Prior FY*	FY 13/14	FY 14/15	FY 15/16	FY 16/17	FY 17/18	FY 18/19-22/23	FY 23/24-32/33	Total
State Water Resources Control Board	\$45	\$96	\$16	\$0	\$0	\$0	\$0	\$0	\$157
Tahoe Regional Planning Agency/Water Quality	\$27	\$1	\$5	\$0	\$0	\$0	\$0	\$0	\$33
United States Forest Service Planning Grant	\$49	\$0	\$0	\$0	\$0	\$0	\$0	\$0	\$49
United States Forest Service Site Improvement Grant	\$221	\$480	\$10	\$15	\$0	\$0	\$0	\$0	\$726
Total	\$343	\$577	\$31	\$15	\$0	\$0	\$0	\$0	\$965

All Figures in Thousands

Expenditures	Prior FY*	FY 13/14	FY 14/15	FY 15/16	FY 16/17	FY 17/18	FY 18/19-22/23	FY 23/24-32/33	Total
Planning/Env - Consultant	\$18	\$0	\$0	\$0	\$0	\$0	\$0	\$0	\$18
Planning/Env - Staff	\$59	\$0	\$0	\$0	\$0	\$0	\$0	\$0	\$59
Survey - Staff	\$44	\$0	\$0	\$0	\$0	\$0	\$0	\$0	\$44
Design - Consultant	\$0	\$0	\$0	\$0	\$0	\$0	\$0	\$0	\$0
Design - Staff	\$180	\$0	\$0	\$0	\$0	\$0	\$0	\$0	\$180
Right of Way - Staff	\$5	\$0	\$0	\$0	\$0	\$0	\$0	\$0	\$5
Construction Mgmt - Consultant	\$0	\$0	\$0	\$0	\$0	\$0	\$0	\$0	\$0
Construction Mgmt - Staff	\$0	\$96	\$0	\$0	\$0	\$0	\$0	\$0	\$96
Direct Construction Costs	\$0	\$450	\$0	\$0	\$0	\$0	\$0	\$0	\$450
Env Monitoring - Consultant	\$5	\$1	\$2	\$2	\$0	\$0	\$0	\$0	\$10
Env Monitoring - Staff	\$31	\$5	\$13	\$8	\$0	\$0	\$0	\$0	\$57
Plant Establishment - Consultant	\$0	\$20	\$1	\$0	\$0	\$0	\$0	\$0	\$21
Plant Establishment - Staff	\$0	\$5	\$15	\$5	\$0	\$0	\$0	\$0	\$25
Total	\$343	\$577	\$31	\$15	\$0	\$0	\$0	\$0	\$965

Project Schedule	Prior FY*	FY 13/14	FY 14/15	FY 15/16	FY 16/17	FY 17/18	FY 18/19-22/23	FY 23/24-32/33	
Planning/Environmental									
Design									
Right Of Way									
Construction									

**FY 18/19 - 22/23 and FY 23/24 - 32/33 revenue and expenditures are not included for the Tahoe EIP, as it is a five-year program.

*Prior FY includes actual revenue and expenditures through 06/30/12, plus amounts budgeted through 06/30/13.



Montgomery Estates Area 3 Erosion Control Project

CIP Project Summary

Project No: 95172

Type: Erosion Control - (EIP)

Supervisor District(s) 5

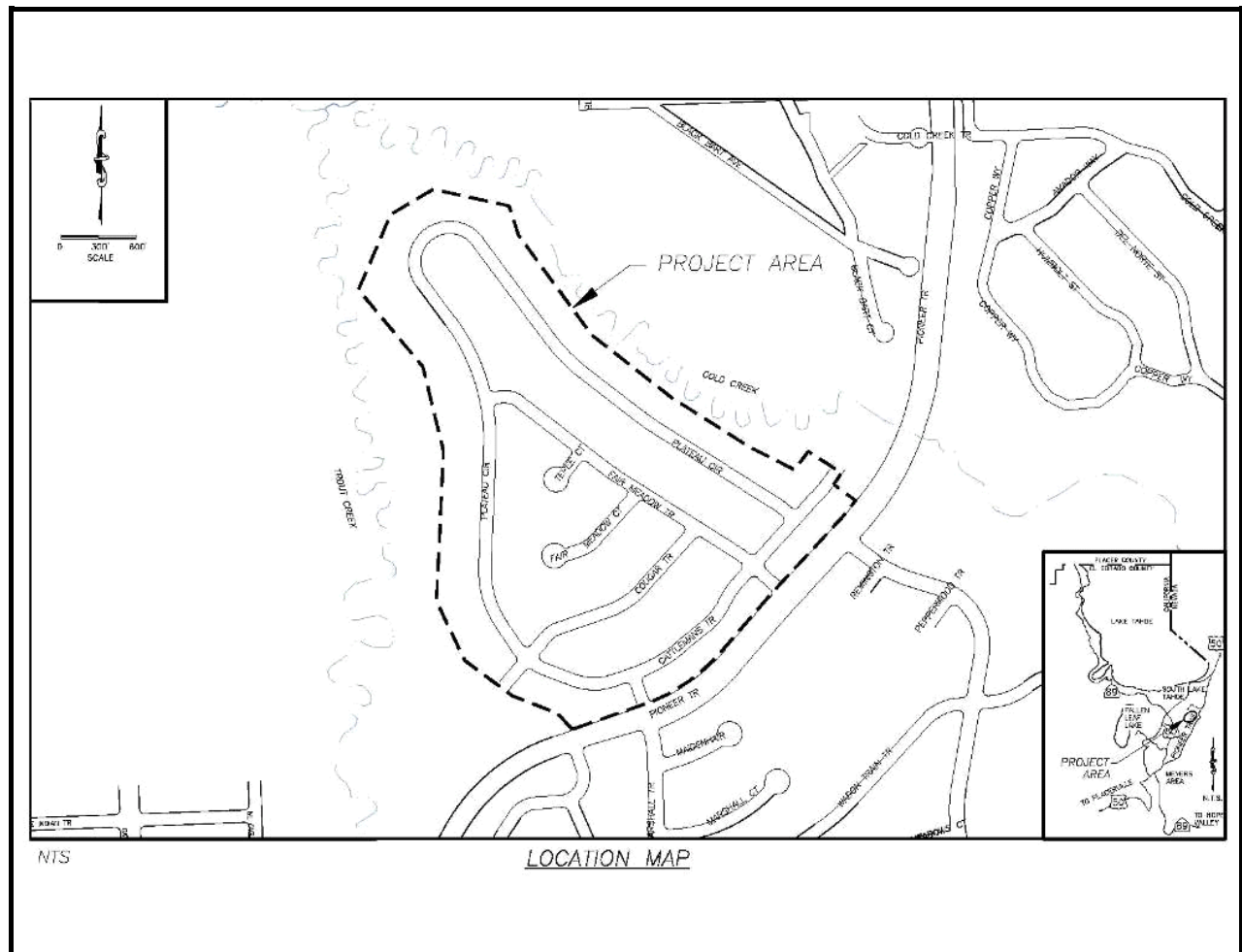

Project Description:

The Montgomery Estates Area 3 Erosion Control is bordered by Trout Creek to the west, Cold Creek to the north and Pioneer Trail to the south. The main goal of the Project is to improve the clarity of Lake Tahoe by reducing the detrimental water quality impacts of the Montgomery Estates subdivision on Lake Tahoe clarity. The objective of the Project is the reduction in the transport of fine sediment from the Project area by constructing water quality Best Management Practices (BMPs) prior to reaching Cold Creek and Trout Creek to the maximum extent practicable.

Original Budget: \$1,032,750

Expenditures thru 6/30/2012: \$41,247

Project Initiation Date: 12/15/01

*Prior FY includes actual revenue and expenditures through 06/30/12, plus amounts budgeted through 06/30/13.



Montgomery Estates Area 3 Erosion Control Project

Financing Plan & Tentative Schedule

Project No: 95172

Type: Erosion Control - (EIP)

Supervisor District(s) 5

All Figures in Thousands

Revenue by Funding Source	Prior FY*	FY 13/14	FY 14/15	FY 15/16	FY 16/17	FY 17/18	FY 18/19-22/23	FY 23/24-32/33	Total
Tahoe Regional Planning Agency/Water Quality	\$5	\$0	\$0	\$5	\$5	\$0	\$0	\$0	\$15
United States Forest Service Planning Grant	\$41	\$65	\$0	\$0	\$0	\$0	\$0	\$0	\$107
United States Forest Service Site Improvement Grant	\$37	\$0	\$185	\$5	\$0	\$0	\$0	\$0	\$227
Total	\$83	\$65	\$185	\$10	\$5	\$0	\$0	\$0	\$348

All Figures in Thousands

Expenditures	Prior FY*	FY 13/14	FY 14/15	FY 15/16	FY 16/17	FY 17/18	FY 18/19-22/23	FY 23/24-32/33	Total
Design - Consultant	\$17	\$0	\$0	\$0	\$0	\$0	\$0	\$0	\$17
Design - Staff	\$59	\$60	\$0	\$0	\$0	\$0	\$0	\$0	\$119
Design Engineering & Admin	\$0	\$3	\$0	\$0	\$0	\$0	\$0	\$0	\$3
Right of Way - Consultant	\$0	\$0	\$0	\$0	\$0	\$0	\$0	\$0	\$0
Right of Way - Staff	\$1	\$0	\$0	\$0	\$0	\$0	\$0	\$0	\$1
Construction Mgmt - Consultant	\$0	\$0	\$0	\$0	\$0	\$0	\$0	\$0	\$0
Construction Mgmt - Staff	\$1	\$0	\$45	\$0	\$0	\$0	\$0	\$0	\$46
Direct Construction Costs	\$0	\$0	\$130	\$0	\$0	\$0	\$0	\$0	\$130
Env Monitoring - Consultant	\$1	\$1	\$2	\$2	\$2	\$0	\$0	\$0	\$8
Env Monitoring - Staff	\$4	\$1	\$3	\$3	\$3	\$0	\$0	\$0	\$15
Plant Establishment - Consultant	\$0	\$0	\$0	\$0	\$0	\$0	\$0	\$0	\$0
Plant Establishment - Staff	\$0	\$0	\$5	\$5	\$0	\$0	\$0	\$0	\$10
Total	\$83	\$65	\$185	\$10	\$5	\$0	\$0	\$0	\$348

Project Schedule	Prior FY*	FY 13/14	FY 14/15	FY 15/16	FY 16/17	FY 17/18	FY 18/19-22/23	FY 23/24-32/33	
Planning/Environmental									
Design									
Right Of Way									
Construction									

**FY 18/19 - 22/23 and FY 23/24 - 32/33 revenue and expenditures are not included for the Tahoe EIP, as it is a five-year program.

*Prior FY includes actual revenue and expenditures through 06/30/12, plus amounts budgeted through 06/30/13.



North Upper Truckee SEZ Restoration Project

CIP Project Summary

Project No: 95166

Type: Erosion Control - (EIP)

Supervisor District(s) 5

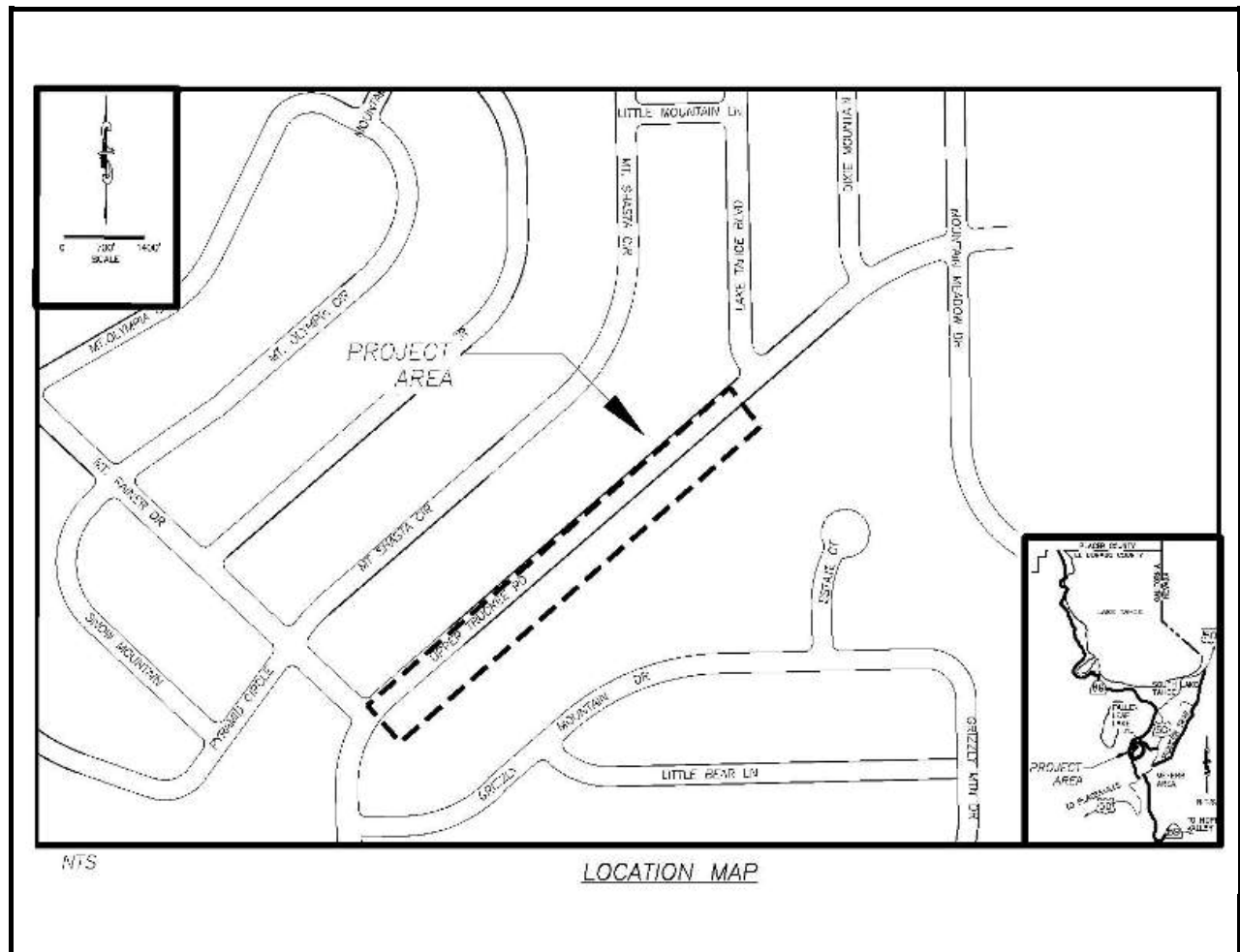

Project Description:

This Project is part of the North Upper Truckee Erosion Control Project series (I&II completed in the 1990s with the main focus on enhancement of the stream environment zone (SEZ) area adjacent to North Upper Truckee Road). The main goal of the Project is to enhance the SEZ area along North Upper Truckee from Lake Tahoe Blvd to Grizzly Mountain Drive.

Original Budget: \$1,200,000

Expenditures thru 6/30/2012: \$0

Project Initiation Date: 02/13/07

*Prior FY includes actual revenue and expenditures through 06/30/12, plus amounts budgeted through 06/30/13.



North Upper Truckee SEZ Restoration Project

Financing Plan & Tentative Schedule

Project No: 95166

Type: Erosion Control - (EIP)

Supervisor District(s) 5

All Figures in Thousands

Revenue by Funding Source	Prior FY*	FY 13/14	FY 14/15	FY 15/16	FY 16/17	FY 17/18	FY 18/19-22/23	FY 23/24-32/33	Total
California Tahoe Conservancy Site Improvement Grant	\$0	\$0	\$0	\$0	\$0	\$0	\$0	\$0	\$0
Tahoe Regional Planning Agency/Stream Environmental Zone	\$0	\$0	\$0	\$0	\$0	\$29	\$0	\$0	\$29
United States Forest Service Planning Grant	\$0	\$0	\$0	\$0	\$0	\$100	\$0	\$0	\$100
Total	\$0	\$0	\$0	\$0	\$0	\$129	\$0	\$0	\$129

All Figures in Thousands

Expenditures	Prior FY*	FY 13/14	FY 14/15	FY 15/16	FY 16/17	FY 17/18	FY 18/19-22/23	FY 23/24-32/33	Total
Planning/Env - Consultant	\$0	\$0	\$0	\$0	\$0	\$6	\$0	\$0	\$6
Planning/Env - Staff	\$0	\$0	\$0	\$0	\$0	\$13	\$0	\$0	\$13
Design - Consultant	\$0	\$0	\$0	\$0	\$0	\$10	\$0	\$0	\$10
Design - Staff	\$0	\$0	\$0	\$0	\$0	\$100	\$0	\$0	\$100
Right of Way - Acquisition	\$0	\$0	\$0	\$0	\$0	\$0	\$0	\$0	\$0
Right of Way - Consultant	\$0	\$0	\$0	\$0	\$0	\$0	\$0	\$0	\$0
Right of Way - Staff	\$0	\$0	\$0	\$0	\$0	\$0	\$0	\$0	\$0
Construction Mgmt - Consultant	\$0	\$0	\$0	\$0	\$0	\$0	\$0	\$0	\$0
Construction Mgmt - Staff	\$0	\$0	\$0	\$0	\$0	\$0	\$0	\$0	\$0
Direct Construction Costs	\$0	\$0	\$0	\$0	\$0	\$0	\$0	\$0	\$0
Plant Establishment - Consultant	\$0	\$0	\$0	\$0	\$0	\$0	\$0	\$0	\$0
Plant Establishment - Staff	\$0	\$0	\$0	\$0	\$0	\$0	\$0	\$0	\$0
Total	\$0	\$0	\$0	\$0	\$0	\$129	\$0	\$0	\$129

Project Schedule	Prior FY*	FY 13/14	FY 14/15	FY 15/16	FY 16/17	FY 17/18	FY 18/19-22/23	FY 23/24-32/33	
Planning/Environmental									
Design									
Right Of Way									
Construction									

**FY 18/19 - 22/23 and FY 23/24 - 32/33 revenue and expenditures are not included for the Tahoe EIP, as it is a five-year program.

*Prior FY includes actual revenue and expenditures through 06/30/12, plus amounts budgeted through 06/30/13.



Passenger Facility

CIP Project Summary

Project No: 95838

Type: Miscellaneous

Supervisor District(s) 5

Project Description:

Transit passenger facilities will be constructed within the unincorporated El Dorado County portion of the Tahoe Basin. The construction of this transit passenger facility will aid in achieving regional transportation goals related to decreasing dependency on the private automobile by making transit more user friendly for both the local population as well as the high number of visitors who frequent the area. Through the implementation of this project, El Dorado County hopes to increase transit ridership to assist in the protection of the Lake Tahoe environment through a reduction in Vehicle Miles Traveled. These facilities will aid in the operation of the system by making it more enticing and visible to the community.

Original Budget: \$151,500

Expenditures thru 6/30/2012: \$12,857

Project Initiation Date: 05/05/09

Revenue	by Funding Source	Prior FY*	FY 13/14	FY 14/15	FY 15/16	FY 16/17	FY 17/18	FY 18/19- 22/23	FY 23/24- 32/33	Total
Caltrans		\$13	\$0	\$0	\$113	\$0	\$0	\$0	\$0	\$125
Tahoe Regional Planning Agency/Air Quality		\$0	\$0	\$0	\$3	\$5	\$0	\$0	\$0	\$8
Total		\$13	\$0	\$0	\$116	\$5	\$0	\$0	\$0	\$133

Expenditures	Prior FY*	FY 13/14	FY 14/15	FY 15/16	FY 16/17	FY 17/18	FY 18/19- 22/23	FY 23/24- 32/33	Total
Planning/Env - Staff	\$0	\$0	\$0	\$6	\$0	\$0	\$0	\$0	\$6
Design - Staff	\$13	\$0	\$0	\$9	\$0	\$0	\$0	\$0	\$21
Construction Mgmt - Staff	\$0	\$0	\$0	\$18	\$3	\$0	\$0	\$0	\$21
Direct Construction Costs	\$0	\$0	\$0	\$80	\$0	\$0	\$0	\$0	\$80
Plant Establishment - Staff	\$0	\$0	\$0	\$4	\$3	\$0	\$0	\$0	\$6
Total	\$13	\$0	\$0	\$116	\$5	\$0	\$0	\$0	\$133

*Prior FY includes actual revenue and expenditures through 06/30/12, plus amounts budgeted through 06/30/13.

This page intentionally left blank



Sawmill 2A Bike Path & Erosion Control Project

CIP Project Summary

Project No: 95165

Type: Erosion Control - (EIP)

Supervisor District(s) 5

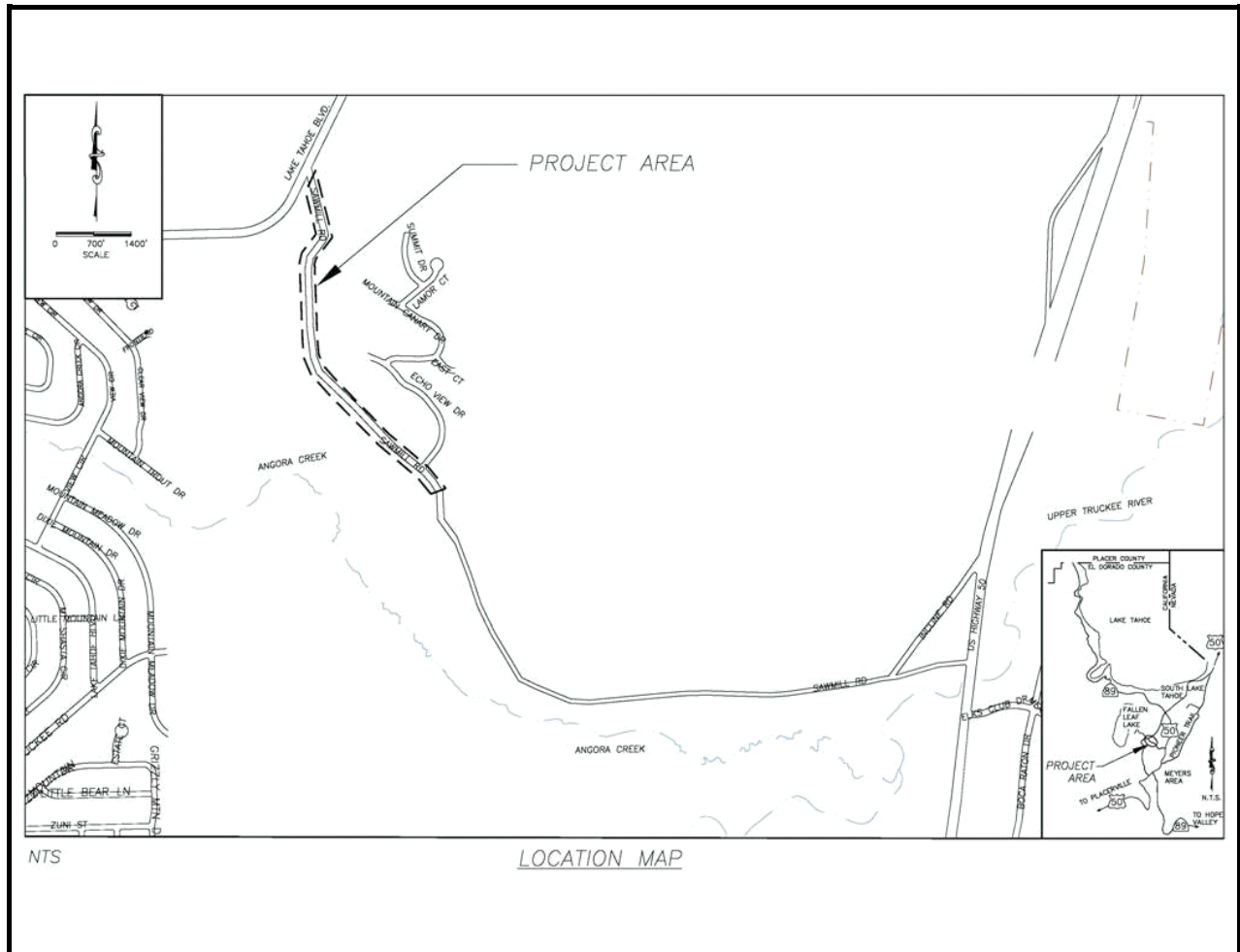

Project Description:

The Sawmill 2 Bike Path and Erosion Control Project (CIP No. 95165) was initiated as one Project. The Project area covered Sawmill Road from US Hwy 50 to Lake Tahoe Boulevard. Due to funding constraints and seasonal construction constraints, the Project was split into two Phases (2A and 2B). The Sawmill 2A Bike Path and Erosion Control Project area covers from Lake Tahoe Blvd to just east of Echo View Drive. The Project includes, but is not limited to, construction of a multi-use path facility, installing erosion control best management practices (BMPs) and revegetation.

Original Budget: \$3,904,998

Expenditures thru 6/30/2012: \$1,844,654

Project Initiation Date: 12/15/05

*Prior FY includes actual revenue and expenditures through 06/30/12, plus amounts budgeted through 06/30/13.



Sawmill 2A Bike Path & Erosion Control Project

Financing Plan & Tentative Schedule

Project No: 95165

Type: Erosion Control - (EIP)

Supervisor District(s) 5

All Figures in Thousands

Revenue by Funding Source	Prior FY*	FY 13/14	FY 14/15	FY 15/16	FY 16/17	FY 17/18	FY 18/19-22/23	FY 23/24-32/33	Total
California Tahoe Conservancy Planning Grant	\$681	\$0	\$0	\$0	\$0	\$0	\$0	\$0	\$681
California Tahoe Conservancy Site Improvement Grant	\$0	\$0	\$0	\$0	\$0	\$0	\$0	\$0	\$0
Congestion Mitigation and Air Quality Program	\$1,024	\$0	\$0	\$0	\$0	\$0	\$0	\$0	\$1,024
RSTP Exchange Funds-TRPA	\$100	\$0	\$0	\$0	\$0	\$0	\$0	\$0	\$100
Tahoe Regional Planning Agency/Air Quality	\$140	\$2	\$10	\$0	\$0	\$0	\$0	\$0	\$152
Tahoe Regional Planning Agency/Water Quality	\$4	\$0	\$0	\$0	\$0	\$0	\$0	\$0	\$4
United States Forest Service Site Improvement Grant	\$678	\$20	\$5	\$0	\$0	\$0	\$0	\$0	\$703
Total	\$2,627	\$22	\$15	\$0	\$0	\$0	\$0	\$0	\$2,664

All Figures in Thousands

Expenditures	Prior FY*	FY 13/14	FY 14/15	FY 15/16	FY 16/17	FY 17/18	FY 18/19-22/23	FY 23/24-32/33	Total
Planning/Env - Consultant	\$309	\$0	\$0	\$0	\$0	\$0	\$0	\$0	\$309
Planning/Env - Staff	\$178	\$0	\$0	\$0	\$0	\$0	\$0	\$0	\$178
Survey - Consultant	\$33	\$0	\$0	\$0	\$0	\$0	\$0	\$0	\$33
Survey - Staff	\$136	\$0	\$0	\$0	\$0	\$0	\$0	\$0	\$136
Design - Staff	\$340	\$0	\$0	\$0	\$0	\$0	\$0	\$0	\$340
Right of Way - Acquisition	\$2	\$0	\$0	\$0	\$0	\$0	\$0	\$0	\$2
Right of Way - Consultant	\$33	\$0	\$0	\$0	\$0	\$0	\$0	\$0	\$33
Right of Way - Staff	\$176	\$0	\$0	\$0	\$0	\$0	\$0	\$0	\$176
Construction Mgmt - Staff	\$216	\$3	\$0	\$0	\$0	\$0	\$0	\$0	\$219
Direct Construction Costs	\$1,141	\$0	\$0	\$0	\$0	\$0	\$0	\$0	\$1,141
Env Monitoring - Consultant	\$20	\$0	\$0	\$0	\$0	\$0	\$0	\$0	\$20
Env Monitoring - Staff	\$3	\$9	\$5	\$0	\$0	\$0	\$0	\$0	\$17
Plant Establishment - Consultant	\$26	\$0	\$0	\$0	\$0	\$0	\$0	\$0	\$26
Plant Establishment - Staff	\$15	\$10	\$10	\$0	\$0	\$0	\$0	\$0	\$35
Total	\$2,627	\$22	\$15	\$0	\$0	\$0	\$0	\$0	\$2,664

Project Schedule	Prior FY*	FY 13/14	FY 14/15	FY 15/16	FY 16/17	FY 17/18	FY 18/19-22/23	FY 23/24-32/33	
Planning/Environmental									
Design									
Right Of Way									
Construction									

**FY 18/19 - 22/23 and FY 23/24 - 32/33 revenue and expenditures are not included for the Tahoe EIP, as it is a five-year program.

*Prior FY includes actual revenue and expenditures through 06/30/12, plus amounts budgeted through 06/30/13.



Sawmill 2B Bike Path and Erosion Control Project

CIP Project Summary

Project No: 95192

Type: Erosion Control - (EIP)

Supervisor District(s) 5

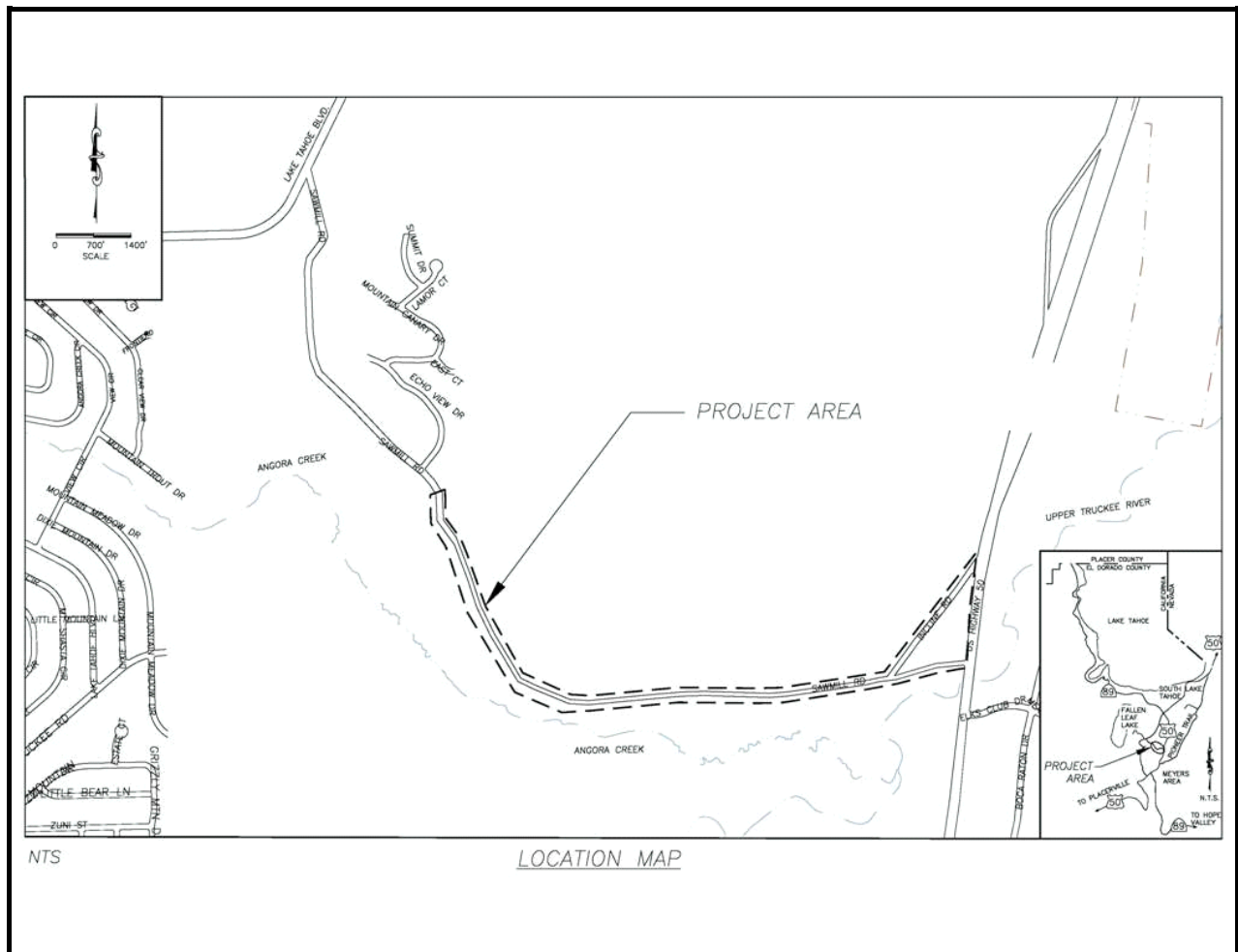

Project Description:

The Sawmill 2 Bike Path and Erosion Control Project (CIP No. 95165) was initiated as one Project. The Project area covered Sawmill Road from US Hwy 50 to Lake Tahoe Boulevard. Due to funding constraints and seasonal construction constraints, the Project was split into two Phases (2A and 2B). The Sawmill 2B Bike Path and Erosion Control Project area covers from US Hwy 50 to the end of Phase 2A near Echo View Drive. The Project includes, but is not limited to, connecting the multi-use path to the existing multi-use path facility at US Hwy 50, installing erosion control best management practices (BMPs) and revegetation.

Original Budget: \$2,006,934

Expenditures thru 6/30/2012: \$117,676

Project Initiation Date: 04/18/11

*Prior FY includes actual revenue and expenditures through 06/30/12, plus amounts budgeted through 06/30/13.



Sawmill 2B Bike Path and Erosion Control Project

Financing Plan & Tentative Schedule

Project No: 95192

Type: Erosion Control - (EIP)

Supervisor District(s) 5

All Figures in Thousands

Revenue by Funding Source	Prior FY*	FY 13/14	FY 14/15	FY 15/16	FY 16/17	FY 17/18	FY 18/19-22/23	FY 23/24-32/33	Total
California Tahoe Conservancy Planning Grant	\$0	\$0	\$0	\$0	\$0	\$0	\$0	\$0	\$0
California Tahoe Conservancy Right of Way Grant	\$85	\$0	\$0	\$0	\$0	\$0	\$0	\$0	\$85
California Tahoe Conservancy Site Improvement Grant	\$0	\$300	\$350	\$0	\$0	\$0	\$0	\$0	\$650
Congestion Mitigation and Air Quality Program	\$158	\$0	\$509	\$0	\$0	\$0	\$0	\$0	\$667
RSTP Exchange Funds-TRPA	\$0	\$348	\$0	\$0	\$0	\$0	\$0	\$0	\$348
Tahoe Regional Planning Agency/Air Quality	\$193	\$76	\$55	\$15	\$15	\$0	\$0	\$0	\$354
United States Forest Service	\$0	\$161	\$0	\$0	\$0	\$0	\$0	\$0	\$161
Total	\$436	\$884	\$914	\$15	\$15	\$0	\$0	\$0	\$2,264

All Figures in Thousands

Expenditures	Prior FY*	FY 13/14	FY 14/15	FY 15/16	FY 16/17	FY 17/18	FY 18/19-22/23	FY 23/24-32/33	Total
Survey - Staff	\$1	\$0	\$0	\$0	\$0	\$0	\$0	\$0	\$1
Design - Consultant	\$17	\$0	\$0	\$0	\$0	\$0	\$0	\$0	\$17
Design - Staff	\$176	\$0	\$0	\$0	\$0	\$0	\$0	\$0	\$176
Right of Way - Acquisition	\$190	\$45	\$0	\$0	\$0	\$0	\$0	\$0	\$235
Right of Way - Consultant	\$29	\$0	\$0	\$0	\$0	\$0	\$0	\$0	\$29
Right of Way - Staff	\$23	\$5	\$0	\$0	\$0	\$0	\$0	\$0	\$28
Construction Mgmt - Staff	\$0	\$215	\$50	\$0	\$0	\$0	\$0	\$0	\$265
Direct Construction Costs	\$0	\$600	\$859	\$0	\$0	\$0	\$0	\$0	\$1,459
Env Monitoring - Staff	\$0	\$0	\$5	\$5	\$5	\$0	\$0	\$0	\$15
Plant Establishment - Consultant	\$0	\$20	\$0	\$0	\$0	\$0	\$0	\$0	\$20
Plant Establishment - Staff	\$0	\$0	\$0	\$10	\$10	\$0	\$0	\$0	\$20
Total	\$436	\$884	\$914	\$15	\$15	\$0	\$0	\$0	\$2,264

Project Schedule	Prior FY*	FY 13/14	FY 14/15	FY 15/16	FY 16/17	FY 17/18	FY 18/19-22/23	FY 23/24-32/33	
Planning/Environmental									
Design									
Right Of Way									
Construction									

**FY 18/19 - 22/23 and FY 23/24 - 32/33 revenue and expenditures are not included for the Tahoe EIP, as it is a five-year program.

*Prior FY includes actual revenue and expenditures through 06/30/12, plus amounts budgeted through 06/30/13.



South Upper Truckee I Erosion Control Project

CIP Project Summary

Project No: 95168

Type: Erosion Control - (EIP)

Supervisor District(s) 5

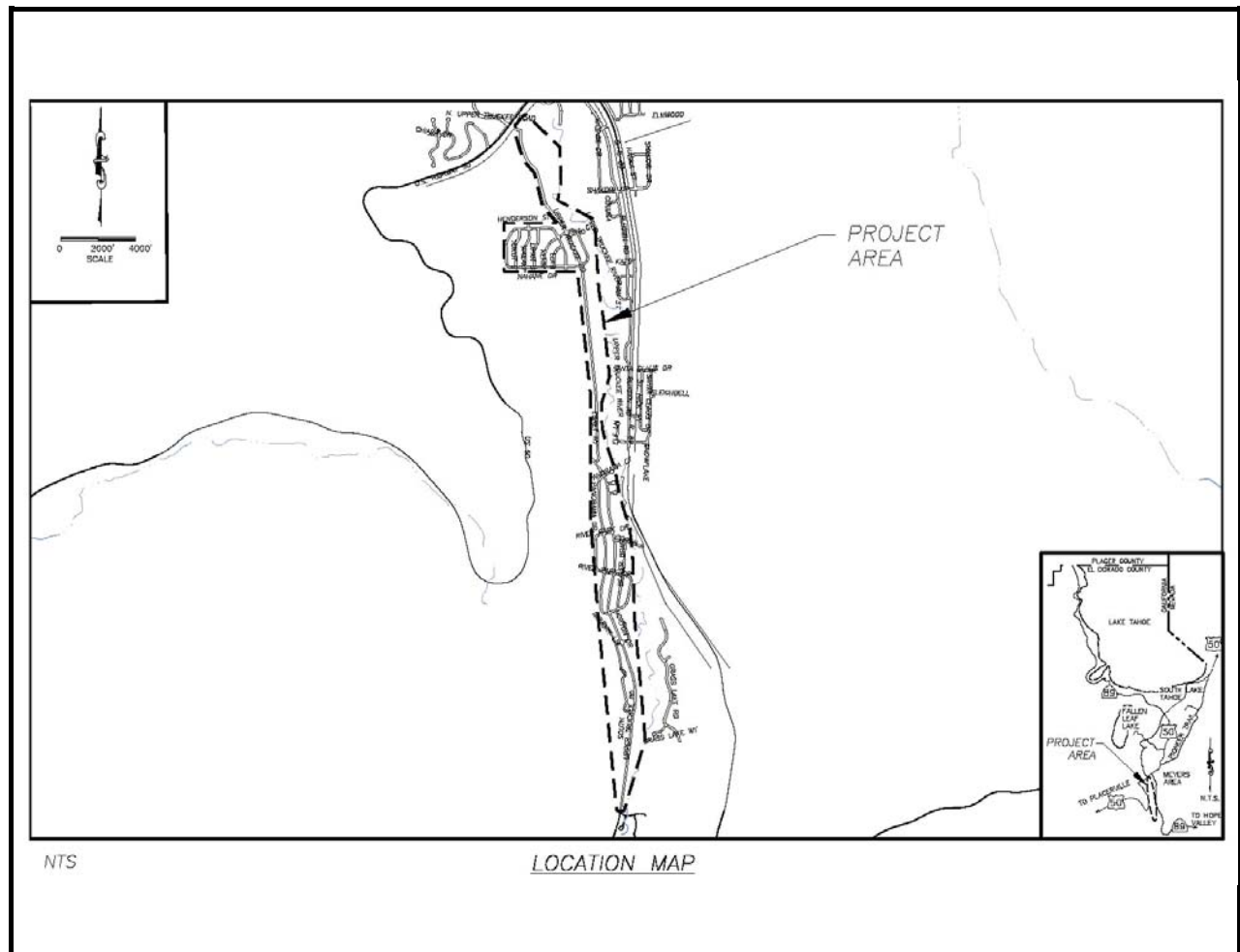

Project Description:

Treat eroding cut and fill slopes in County right-of-way. Reduce the very fine and fine sediment from the urban watersheds. Revegetation of disturbed areas. Install curb and gutter, rock-lined channels, sediment basins. Restore SEZ. Perform right-of-way acquisitions. This Project will most likely be split into several phases. It is anticipated that other grant funding will be available in the future through EIP grant funding programs available to the County.

Original Budget: \$786,000

Expenditures thru 6/30/2012: \$135,921

Project Initiation Date: 12/06/10

*Prior FY includes actual revenue and expenditures through 06/30/12, plus amounts budgeted through 06/30/13.



South Upper Truckee I Erosion Control Project

Financing Plan & Tentative Schedule

Project No: 95168

Type: Erosion Control - (EIP)

Supervisor District(s) 5

All Figures in Thousands

Revenue by Funding Source	Prior FY*	FY 13/14	FY 14/15	FY 15/16	FY 16/17	FY 17/18	FY 18/19-22/23	FY 23/24-32/33	Total
Tahoe Regional Planning Agency/Stream Environmental Zone	\$65	\$0	\$0	\$6	\$6	\$0	\$0	\$0	\$77
Tahoe Regional Planning Agency/Water Quality	\$31	\$0	\$0	\$0	\$0	\$29	\$0	\$0	\$60
United States Forest Service Planning Grant	\$0	\$0	\$0	\$0	\$0	\$110	\$0	\$0	\$110
United States Forest Service Site Improvement Grant	\$40	\$0	\$0	\$0	\$0	\$227	\$0	\$0	\$267
Total	\$136	\$0	\$0	\$6	\$6	\$366	\$0	\$0	\$514

All Figures in Thousands

Expenditures	Prior FY*	FY 13/14	FY 14/15	FY 15/16	FY 16/17	FY 17/18	FY 18/19-22/23	FY 23/24-32/33	Total
Design - Consultant	\$0	\$0	\$0	\$0	\$0	\$0	\$0	\$0	\$0
Design - Staff	\$86	\$0	\$0	\$0	\$0	\$100	\$0	\$0	\$186
Right of Way - Consultant	\$0	\$0	\$0	\$0	\$0	\$0	\$0	\$0	\$0
Right of Way - Staff	\$2	\$0	\$0	\$0	\$0	\$10	\$0	\$0	\$12
Construction Mgmt - Consultant	\$0	\$0	\$0	\$0	\$0	\$0	\$0	\$0	\$0
Construction Mgmt - Staff	\$13	\$0	\$0	\$0	\$0	\$50	\$0	\$0	\$63
Direct Construction Costs	\$24	\$0	\$0	\$0	\$0	\$200	\$0	\$0	\$224
Env Monitoring - Consultant	\$0	\$0	\$0	\$0	\$0	\$1	\$0	\$0	\$1
Env Monitoring - Staff	\$5	\$0	\$0	\$6	\$6	\$5	\$0	\$0	\$22
Plant Establishment - Consultant	\$0	\$0	\$0	\$0	\$0	\$0	\$0	\$0	\$0
Plant Establishment - Staff	\$7	\$0	\$0	\$0	\$0	\$0	\$0	\$0	\$7
Total	\$136	\$0	\$0	\$6	\$6	\$366	\$0	\$0	\$514

Project Schedule	Prior FY*	FY 13/14	FY 14/15	FY 15/16	FY 16/17	FY 17/18	FY 18/19-22/23	FY 23/24-32/33	
Planning/Environmental									
Design									
Right Of Way									
Construction									

**FY 18/19 - 22/23 and FY 23/24 - 32/33 revenue and expenditures are not included for the Tahoe EIP, as it is a five-year program.

*Prior FY includes actual revenue and expenditures through 06/30/12, plus amounts budgeted through 06/30/13.



Tahoe Hills Erosion Control Project

CIP Project Summary

Project No: 95171

Type: Erosion Control - (EIP)

Supervisor District(s) 5

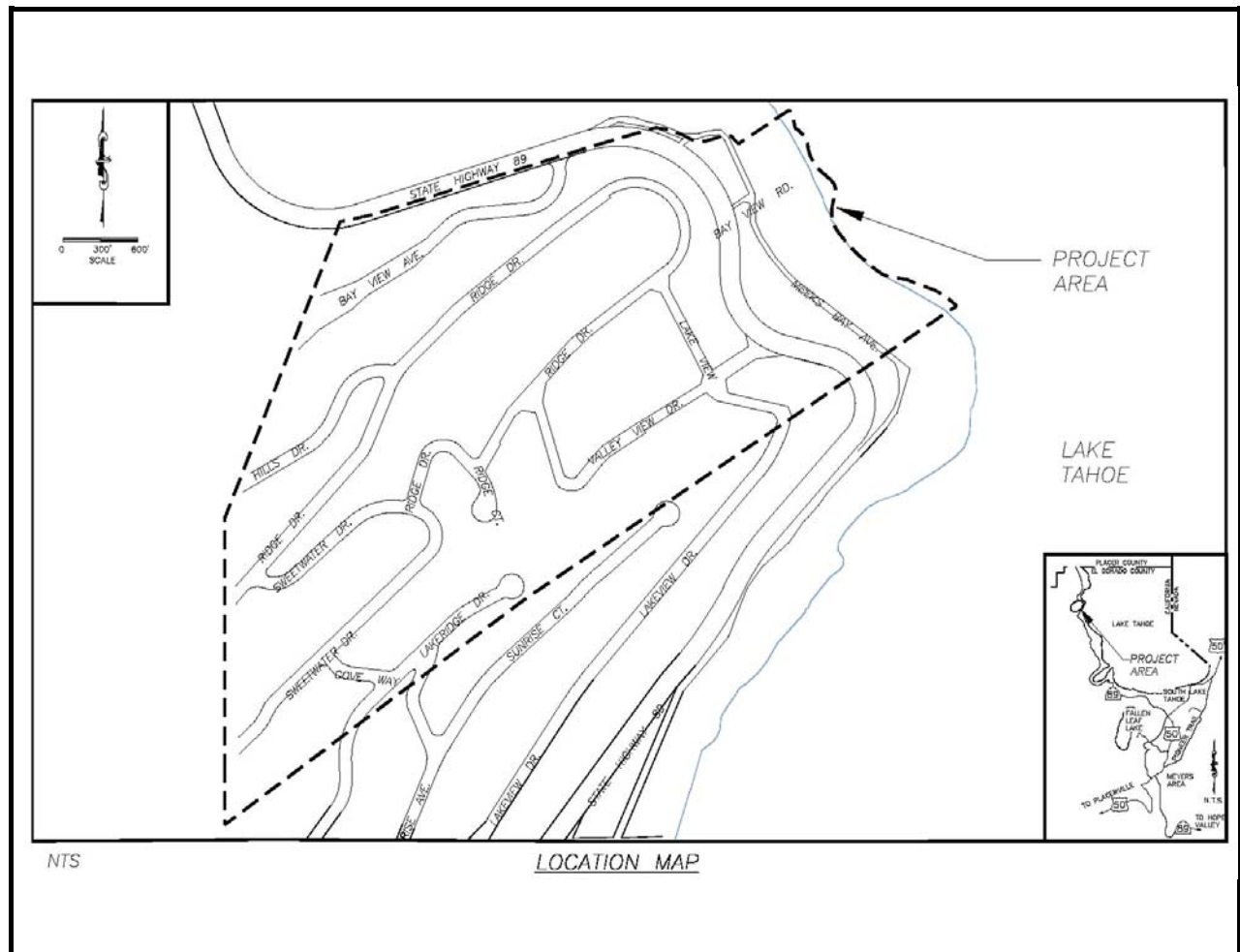

Project Description:

The Tahoe Hills Erosion Control Project is within the Tahoe Hills subdivision which is bordered by Highway 89 to the north and south, and by Lake Tahoe to the east. The Project area encompasses County ROW, Caltrans ROW, California Tahoe Conservancy, United States Forest Service, and privately owned property. The main goal of the Project is to reduce the very fine and fine sediment from the Tahoe Hills subdivision which will ultimately improve the clarity of Lake Tahoe.

Original Budget: \$1,368,000

Expenditures thru 6/30/2012: \$109,629

Project Initiation Date: 11/15/09

*Prior FY includes actual revenue and expenditures through 06/30/12, plus amounts budgeted through 06/30/13.



Tahoe Hills Erosion Control Project

Financing Plan & Tentative Schedule

Project No: 95171

Type: Erosion Control - (EIP)

Supervisor District(s) 5

All Figures in Thousands

Revenue by Funding Source	Prior FY*	FY 13/14	FY 14/15	FY 15/16	FY 16/17	FY 17/18	FY 18/19-22/23	FY 23/24-32/33	Total
Tahoe Regional Planning Agency/Water Quality	\$14	\$21	\$20	\$0	\$2	\$0	\$0	\$0	\$57
United States Forest Service Planning Grant	\$104	\$98	\$2	\$0	\$0	\$0	\$0	\$0	\$205
United States Forest Service Site Improvement Grant	\$65	\$0	\$430	\$22	\$10	\$0	\$0	\$0	\$527
Total	\$184	\$119	\$452	\$22	\$12	\$0	\$0	\$0	\$789

All Figures in Thousands

Expenditures	Prior FY*	FY 13/14	FY 14/15	FY 15/16	FY 16/17	FY 17/18	FY 18/19-22/23	FY 23/24-32/33	Total
Planning/Environmental	\$11	\$0	\$0	\$0	\$0	\$0	\$0	\$0	\$11
Design - Consultant	\$18	\$0	\$0	\$0	\$0	\$0	\$0	\$0	\$18
Design - Staff	\$134	\$98	\$0	\$0	\$0	\$0	\$0	\$0	\$232
Right of Way - Acquisition	\$0	\$1	\$0	\$0	\$0	\$0	\$0	\$0	\$1
Right of Way - Consultant	\$0	\$0	\$0	\$0	\$0	\$0	\$0	\$0	\$0
Right of Way - Staff	\$0	\$6	\$0	\$0	\$0	\$0	\$0	\$0	\$6
Construction Mgmt - Consultant	\$0	\$0	\$0	\$0	\$0	\$0	\$0	\$0	\$0
Construction Mgmt - Staff	\$3	\$0	\$85	\$0	\$0	\$0	\$0	\$0	\$88
Direct Construction Costs	\$0	\$0	\$345	\$0	\$0	\$0	\$0	\$0	\$345
Env Monitoring - Consultant	\$3	\$3	\$2	\$2	\$2	\$0	\$0	\$0	\$12
Env Monitoring - Staff	\$15	\$12	\$10	\$10	\$5	\$0	\$0	\$0	\$52
Plant Establishment - Staff	\$0	\$0	\$10	\$10	\$5	\$0	\$0	\$0	\$25
Total	\$184	\$119	\$452	\$22	\$12	\$0	\$0	\$0	\$789

Project Schedule	Prior FY*	FY 13/14	FY 14/15	FY 15/16	FY 16/17	FY 17/18	FY 18/19-22/23	FY 23/24-32/33	
Planning/Environmental									
Design									
Right Of Way									
Construction									

**FY 18/19 - 22/23 and FY 23/24 - 32/33 revenue and expenditures are not included for the Tahoe EIP, as it is a five-year program.

*Prior FY includes actual revenue and expenditures through 06/30/12, plus amounts budgeted through 06/30/13.



Cost Estimate by Phase Summary

Tahoe

All Figures In Thousands

	Prior*	13/14	14/15	15/16	16/17	17/18	18/19- 22/23	23/24- 32/33	Total
Constr/Eng/Admin - Staff	0	0	120	0	0	0	0	0	120
Construction Mgmt - Consultant	3	14	10	15	30	27	0	0	98
Construction Mgmt - Staff	674	556	486	228	427	433	0	0	2,804
Design - Consultant	975	0	0	25	35	45	0	0	1,080
Design - Staff	2,898	409	184	333	205	835	0	0	4,864
Design Engineering & Admin	0	103	20	0	0	0	0	0	123
Design Engineering & Admin - SI - Staff	0	56	20	0	0	0	0	0	75
Direct Construction Costs	2,793	2,513	2,869	1,045	2,615	2,420	0	0	14,255
Env Monitoring - Consultant	106	12	15	18	18	5	0	0	172
Env Monitoring - Staff	159	86	101	87	73	33	0	0	538
Environmental Monitoring	0	4	20	0	0	0	0	0	24
Planning/Env - Consultant	688	74	100	20	0	8	0	0	890
Planning/Env - Staff	724	101	98	41	5	175	0	0	1,143
Planning/Environmental	26	0	0	0	0	0	0	0	26
Plant Establishment	0	0	5	0	0	0	0	0	5
Plant Establishment - Consultant	58	73	30	26	32	10	0	0	228
Plant Establishment - Staff	44	56	160	119	113	58	0	0	548
Right of Way - Acquisition	221	46	0	0	160	13	0	0	439
Right of Way - Consultant	101	0	0	15	5	6	0	0	127
Right of Way - Staff	359	14	0	35	40	30	0	0	478
Survey - Consultant	92	0	0	0	0	0	0	0	92
Survey - Staff	309	51	30	10	0	0	0	0	400
Totals	10,230	4,167	4,266	2,015	3,757	4,096	0	0	28,530

*Prior FY includes actual revenue and expenditures through 06/30/12, plus amounts budgeted through 06/30/13.



Revenue Source Summary Tahoe

All Figures In Thousands

	<i>Prior*</i>	<i>13/14</i>	<i>14/15</i>	<i>15/16</i>	<i>16/17</i>	<i>17/18</i>	<i>18/19- 22/23</i>	<i>23/24- 32/33</i>	<i>Total</i>
Anticipated Grant	0	0	0	0	0	0	0	0	0
Bicycle Transportation Account (BTA)	0	0	0	24	55	49	0	0	128
California Tahoe Conservancy Planning Grant	1,691	0	0	0	0	150	0	0	1,841
California Tahoe Conservancy Right of Way Grant	115	0	0	0	0	0	0	0	115
California Tahoe Conservancy Site Improvement Grant	745	670	1,219	68	350	820	0	0	3,871
Caltrans	13	0	0	113	0	0	0	0	125
Congestion Mitigation and Air Quality Program	1,382	323	509	0	150	350	0	0	2,714
Erosion Control Discretionary	0	0	0	0	0	0	0	0	0
Miscellaneous Reimbursement	8	49	6	0	0	0	0	0	63
RSTP Exchange Funds-TRPA	393	552	263	140	186	100	0	0	1,632
Safe Routes to School	0	450	0	0	450	210	0	0	1,110
State Cooperative Agreement	0	0	0	0	1,690	1,201	0	0	2,891
State Water Resources Control Board	45	96	16	0	0	0	0	0	157
Tahoe Regional Planning Agency/Air Quality	403	204	253	228	441	125	0	0	1,654
Tahoe Regional Planning Agency/Stream Environmental Zone	140	31	35	126	126	49	0	0	506
Tahoe Regional Planning Agency/Water Quality	557	37	77	96	62	230	0	0	1,057
Transportation Enhancement Activities	0	0	0	0	120	0	0	0	120
United States Forest Service	0	161	0	0	0	0	0	0	161
United States Forest Service Planning Grant	2,067	396	151	23	54	576	0	0	3,266
United States Forest Service Site Improvement Grant	2,671	1,200	1,739	1,198	74	237	0	0	7,118
Totals	10,230	4,167	4,266	2,015	3,757	4,096	0	0	28,530

*Prior FY includes actual revenue and expenditures through 06/30/12, plus amounts budgeted through 06/30/13.