

EXHIBIT 'A'

Carson Crossing Drive Zone of Benefit

Boundary Description

All that real property situate in the County of El Dorado, State of California, lying within Sections 23 and 26, Township 9 North, Range 8 East, M.D.M. and being all of Lots 1 through 11 and Lot 14 as shown on the "Large Lot Final Map of Carson Creek", filed in the office of the County Recorder of El Dorado County in Book 'J' of Maps, Page 130 and being further described as follows:

Beginning at the Northwest corner of said "Large Lot Final Map of Carson Creek", from which a 2 1/4" iron pipe fence corner stamped R.C.E. 20462, 1983 and marked for the Section corner common to Sections 14, 15, 22 and 23, Township 9 North, Range 8 East, M.D.M. bears South 89°26'35" West, 36.68 feet; thence along the North and East lines of said "Large Lot Final Map of Carson Creek" the following five (5) courses:

1. North 89°26'35" East, 2601.77 feet; thence
2. North 89°17'56" East, 1319.66 feet; thence
3. South 00°34'36" East, 2636.36 feet; thence
4. North 89°19'12" East, 1321.37 feet; thence
5. South 00°39'52" East, 121.65 feet to the Northeast corner of Lot 15 of said "Large Lot Final Map of Carson Creek";

thence along the Southeasterly line of said Lot 11 the following sixty three (63) courses:

6. South 50°56'32" West, 84.51 feet; thence
7. along the arc of a curve to the right, having a radius of 100.00 feet, the chord of which bears South 70°08'20" West, 65.76 feet; thence
8. South 89°20'08" West, 145.03 feet; thence
9. South 34°03'32" West, 117.16 feet; thence
10. South 31°40'15" West, 130.05 feet; thence
11. South 49°26'32" West, 76.87 feet; thence
12. South 29°12'26" West, 144.38 feet; thence
13. South 41°21'35" West, 113.73 feet; thence
14. South 59°37'37" West, 44.90 feet; thence
15. along the arc of a curve to the left, having a radius of 200.00 feet; the chord of which bears South 43°44'38" West, 109.47 feet; thence
16. South 27°51'38" West, 106.83 feet; thence
17. South 30°38'54" West, 90.46 feet; thence
18. South 01°17'00" West, 31.67 feet; thence
19. South 74°26'07" East, 98.07 feet; thence
20. North 83°49'52" East, 89.35 feet; thence
21. North 57°20'48" East, 74.38 feet; thence
22. along the arc of a curve to the right, having a radius of 85.00 feet, the chord of which bears North 87°49'38" East, 86.23 feet; thence
23. South 61°41'31" East, 70.05 feet; thence
24. South 40°30'23" East, 65.51 feet; thence

EXHIBIT 'A'

25. along the arc of a curve to the left, having a radius of 70.00 feet, the chord of which bears South 61°59'36" East, 51.28 feet to the Northwest corner of Lot 13 of said "Large Lot Final Map of Carson Creek"; thence
26. continuing along the Southeasterly line of said Lot 11, South 00°39'52" East, 200.45 feet to the Southwest corner of said Lot 13; thence
27. continuing along the Southeasterly line of said Lot 11, North 87°45'27" West, 4.95 feet; thence
28. along the arc of a curve to the right, having a radius of 270.00 feet, the chord of which bears North 66°21'57" West, 196.96 feet; thence
29. South 81°29'57" West, 134.48 feet; thence
30. South 85°45'18" West, 117.95 feet; thence
31. South 40°55'56" West, 137.60 feet; thence
32. along the arc of a curve to the right, having a radius of 100.00 feet, the chord of which bears South 88°49'52" West, 148.39 feet; thence
33. North 43°16'12" West, 20.99 feet; thence
34. South 46°43'48" West, 59.95 feet; thence
35. South 24°50'15" West, 71.21 feet; thence
36. South 08°50'05" West, 202.48 feet; thence
37. South 02°30'35" West, 90.83 feet; thence
38. along the arc of a curve to the right, having a radius of 100.00 feet; the chord of which bears South 38°54'38" West, 118.69 feet; thence
39. South 75°18'40" West, 154.16 feet; thence
40. South 57°01'03" West, 171.10 feet; thence
41. along the arc of a curve to the right, having a radius of 220.00 feet, the chord of which bears South 49°42'22" West, 158.05 feet; thence
42. South 70°45'25" West, 135.63 feet; thence
43. South 56°33'39" West, 82.11 feet; thence
44. South 43°12'30" West, 57.14 feet; thence
45. South 67°23'06" West, 84.26 feet; thence
46. South 52°38'35" West, 84.09 feet; thence
47. South 00°00'00" East, 35.46 feet; thence
48. South 56°49'01" East, 64.86 feet; thence
49. South 37°02'18" East, 30.20 feet; thence
50. along the arc of a curve to the right, having a radius of 100.00 feet, the chord of which bears South 03°30'04" West, 129.99 feet; thence
51. South 44°02'25" West, 205.74 feet; thence
52. South 42°05'22" East, 436.03 feet; thence
53. South 65°28'29" East, 183.81 feet; thence
54. South 49°17'50" East, 143.75 feet; thence
55. South 40°36'29" East, 344.30 feet; thence
56. North 28°40'03" East, 142.97 feet; thence
57. North 44°40'24" East, 67.33 feet; thence
58. along the arc of a curve to the right, having a radius of 100.00 feet, the chord of which bears North 70°06'15" East, 85.88 feet; thence
59. South 84°27'55" East, 64.02 feet; thence

EXHIBIT 'A'

60. along the arc of a curve to the left, having a radius of 40.00 feet, the chord of which bears North 60°16'02" East, 46.19 feet; thence
61. North 24°59'59" East, 0.14 feet to the Northwest corner of Lot 12 of said "Large Lot Final Map of Carson Creek"; thence
62. continuing along the Southeasterly line of said Lot 11, South 40°33'26" East, 213.13 feet to the Southwest corner of said Lot 12; thence
63. continuing along the Southeasterly line of said Lot 11 and along the arc of curve to the right, having a radius of 250.00 feet, the chord of which bears South 72°08'03" West, 223.15 feet; thence
64. South 29°30'38" West, 259.22 feet; thence
65. South 60°28'10" East, 192.32 feet; thence
66. South 54°29'49" East, 167.92 feet; thence
67. South 46°00'36" East, 263.47 feet; thence
68. South 40°33'26" East, 40.16 feet to the Southeast corner of said Lot 11; thence
69. along the Southerly line of said Lot 11, North 81°11'46" West, 866.04 feet to a point on the Southwesterly line of said "Large Lot Final Map of Carson Creek"; thence along the Southwesterly line of said "Large Lot Final Map of Carson Creek" the following four (4) courses:
70. North 38°24'30" West, 465.46 feet; thence
71. along the arc of a curve to the left, having a radius of 1943.08 feet, the chord of which bears North 50°10'26" West, 792.43 feet; thence
72. North 61°56'23" West, 1402.66 feet; thence
73. North 18°06'38" West, 5175.09 feet to the POINT OF BEGINNING, containing 412.533 acres, more or less.

End of Description

This description has been prepared by me or under my direct supervision.

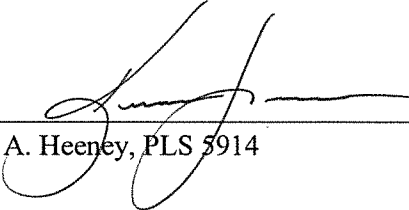
Kevin A. Heeney, PLS 5914

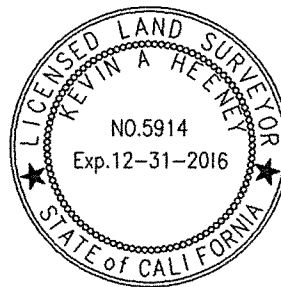

8/21/2015
Date