

- NOTES:
1. BORE UNDER EXIST. T/W & INSTALL NEW 1W-3" TYPE I DUCT & INSTALL NEW 1867 SIZE E HANDHOLE 13' FROM EDGE OF TAXIWAY. ADJUST LOCATION OF HANDHOLES & DUCT TO AVOID T/W LIGHT BY 5' MIN.
 2. INSTALL NEW 100W TRANSFORMER FOR ALL EXISTING SIGNS.
 3. INTERCEPT R/W CIRCUIT CABLE AT EXISTING LIGHT. CONNECT NEW CABLE TO EXISTING CABLE.
 4. ATTACH NEW DUCT TO EXISTING STUB FROM EXISTING LIGHT

- LEGEND
- | | | | |
|--|---|--|---------------------------------------|
| | AIRPORT GRID COORDINATE | | EXISTING CABLE MARKER TO BE ABANDONED |
| | EXISTING HANDHOLE TO REMAIN | | EXISTING HANDHOLE TO REMAIN |
| | EXISTING DUCT | | NEW 1867 SIZE E HANDHOLE |
| | NEW 1W-2" TYPE II DUCT | | EXISTING VASI |
| | NEW 2W-3" TYPE I DUCT | | EXISTING SIGN TO REMAIN |
| | EXISTING WIRE | | |
| | NEW R/W OR PAPI CIRCUIT CABLE | | |
| | NEW ELEVATED R/W EDGE LIGHT | | |
| | R/W EDGE LIGHT LENS COLOR CODE | | |
| | EXISTING LIGHT TO REMAIN | | |
| | EXISTING ELEVATED R/W THRESHOLD LIGHT TO REMAIN | | |
- LENS COLOR LEGEND
- | | |
|---|--------|
| R | RED |
| G | GREEN |
| Y | YELLOW |
| W | WHITE |

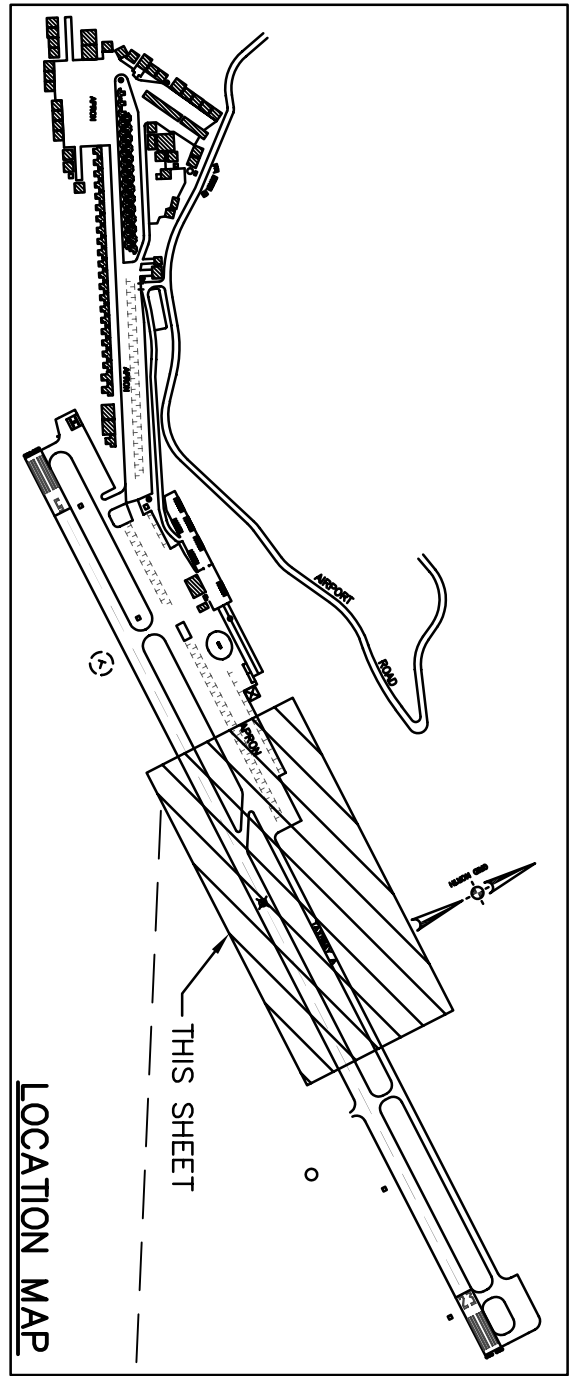

VERIFY SCALES.

BAR IS ONE INCH ON ORIGINAL DRAWING. IF NOT ONE INCH ON THIS SHEET, ADJUST SCALES ACCORDINGLY.

GRID NORTH

MATCH LINE E9300.000 SEE SHEET NO. 6

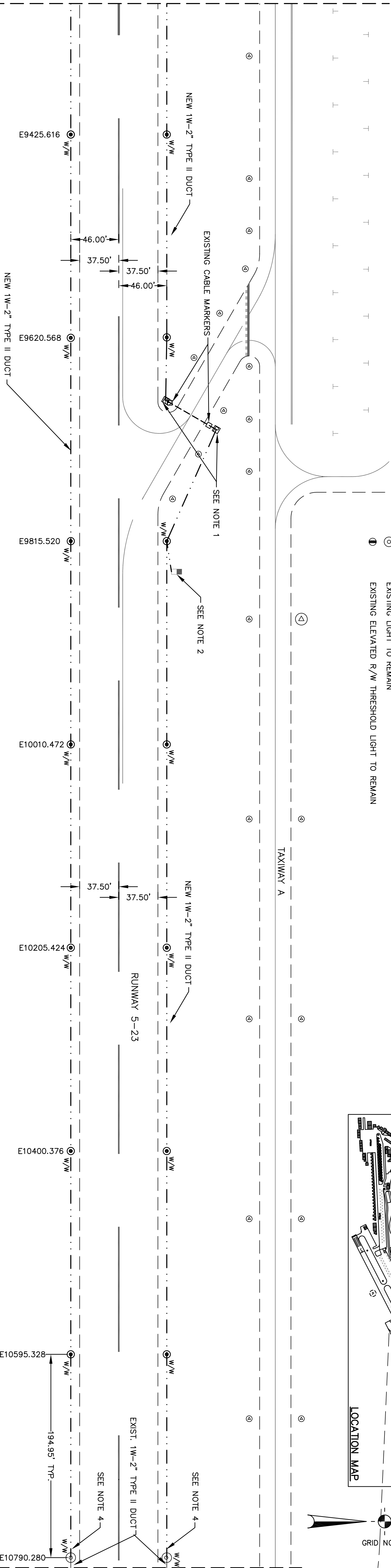

MATCH LINE E10800.000 SEE SHEET NO. 8

DUCT PLAN

MATCH LINE E9300.000 SEE SHEET NO. 6

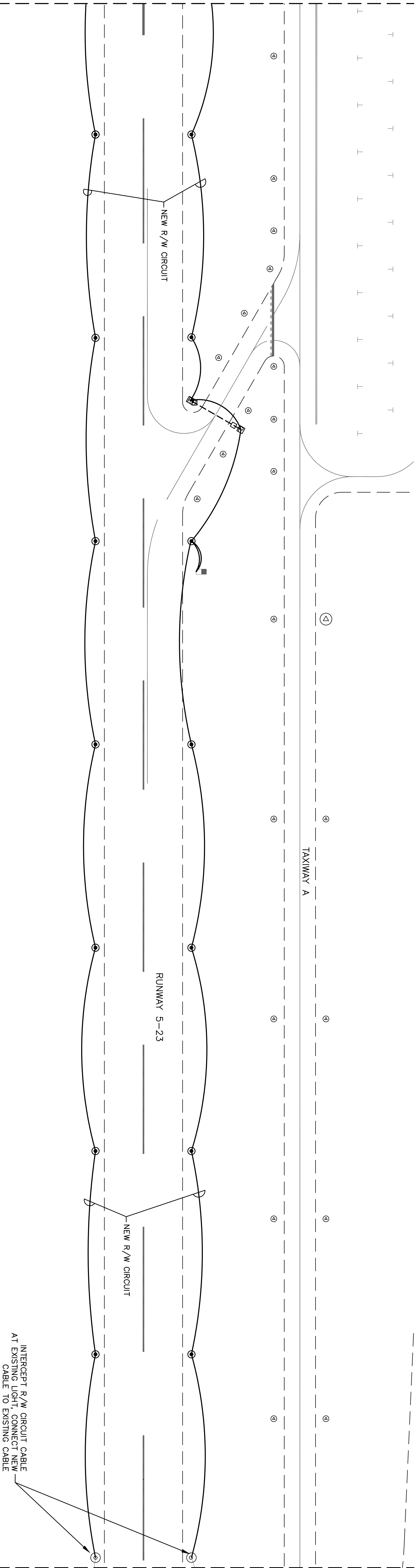

MATCH LINE E10800.000 SEE SHEET NO. 8

PLACERVILLE AIRPORT

PLACERVILLE, CALIFORNIA

R/W LIGHTING REHABILITATION (PHASE II)

LIGHTING, DUCT & WIRING PLAN
E9300.000 TO E10800.000

NO.	REVISIONS	BY	APR	DATE

ENGINEER OF RECORD



Reinald W. Brandley
CONSULTING AIRPORT ENGINEER

6125 King Road, Suite 201 • Loomis, California 95650-8004 • (916) 652-4725

WIRING PLAN

SHEET NUMBER
6 OF 11 SHEETS

DESIGN BY: RWB
DRAWN BY: MSB
CHKD BY: RWB
DATE: JUNE 29, 2006
CONTRACT NO.: -
PROJECT NO.: -
DWG FILE: -
DRAWING SCALE: 1"=50'