

**COUNTY OF EL DORADO, CALIFORNIA
COMMUNITY DEVELOPMENT AGENCY**

TRANSPORTATION DIVISION

CONTRACT DOCUMENTS

INCLUDING
NOTICE TO BIDDERS,
PROPOSAL, AND CONTRACT
FOR

RESURFACING OF TAHOMA ROADWAY

CONTRACT No. 471-C1799

BID OPENING DATE: MAY 18, 2017

**COUNTY OF EL DORADO, CALIFORNIA
COMMUNITY DEVELOPMENT AGENCY
TRANSPORTATION DIVISION**

NOTICE TO BIDDERS

NOTICE IS HEREBY GIVEN by the County of El Dorado, State of California, that sealed bids for work in accordance with the Contract Documents designated:

**RESURFACING OF TAHOMA ROADWAY
CONTRACT NO. 471-C1799**

Will be received by the Community Development Agency, Transportation Division, at the front counter of 2850 Fairlane Court, Building C, Placerville, California, until **May 18, 2017 at 2:00 PM**, at which time bids will be publicly opened and read by the County of El Dorado Community Development Agency, Transportation Division.

No Bid may be withdrawn after the time established for receiving bids or before the award and execution of the Contract, unless the award is delayed for a period exceeding sixty (60) calendar days. Bids must be executed in accordance with the instructions given and forms provided in the bound Contract Documents furnished by the County of El Dorado Community Development Agency, Transportation Division **through Quest Construction Data Network (Quest)**. **The Proposal including the Bidder's Security shall be submitted in a sealed envelope clearly marked:**

**"RESURFACING OF TAHOMA ROADWAY"
CONTRACT NO. 471-C1799**

TO BE OPENED AT 2 P.M. ON May 18, 2017

LOCATION/DESCRIPTION OF THE WORK: The project is located in the South Lake Tahoe/Tahoma area of El Dorado County, CA. The Work to be done is shown in Exhibits A, B and C, and generally consists of, but is not limited to:

- A. The micro-surfacing of rehabilitation of seventy-eight (78) sections of roadway in the Tahoma area.
- B. Other items or details not mentioned above, that are required by the Contract Documents must be performed, constructed, or installed.
- C. Bids are required for the entire Work described herein.
- D. The contract time is THIRTY (30) WORKING DAYS.
- E. For bonding purposes the anticipated project cost is less than \$800,000.00
- F. A pre-bid meeting is scheduled for this project on **May 10, 2017 at 2:00pm** at the County of El Dorado Community Development Agency, Transportation Division, 2441 Headington Road, Placerville, CA. The meeting will be held in the downstairs conference room. Attendance at the pre-bid meeting is not mandatory.
- G. This project is being formally bid in accordance with Public Contract Code 22032 and County of El

OBTAINING OR VIEWING CONTRACT DOCUMENTS: The Contract Documents, including the Project Plans, may be viewed and/or downloaded from the Quest website at <http://www.questcdn.com>. Interested parties may also access the Quest website by clicking on the link next to the Project Name or entering the Quest project #4972543 on the Community Development Agency, Transportation Division's website at <http://www.edcgov.us/DOT/BidsHome.aspx>.

Interested parties may view the Contract Documents, including the Project Plans, on the Quest website at no charge. The digital Contract Documents, including the Project Plans, may be downloaded for \$10.00 by inputting the Quest project # 4972543 on the websites' Project Search page. Please contact QuestCDN.com at (952) 233-1632 or info@questcdn.com for assistance in free membership, registration, downloading, and working with this digital project information. To be included on the planholders list, receive notification of addenda, and to be eligible to bid interested parties must download the Contract Documents, including the Project Plans, from Quest. **Those downloading the Contract Documents assume responsibility and risk for completeness of the downloaded Contract Documents.**

The Contract Documents, including the Project Plans, may be examined in person at the Community Development Agency Transportation Division office at 2850 Fairlane Court, Placerville CA. However the Community Development Agency Transportation Division will no longer sell paper copies of the Contract Documents.

CONTRACTORS LICENSE CLASSIFICATION: Bidders must be properly licensed to perform the Work pursuant to the Contractors' State License Law (Business and Professions Code Section 7000 et seq.) and must possess a **CLASS A** license or equivalent combination of Classes required by the categories and type of Work included in the Contract Documents and Plans at the time the Contract is awarded, and must maintain a valid license through completion and acceptance of the Work, including the guarantee and acceptance period. Failure of the successful Bidder to obtain proper adequate licensing will constitute a failure to execute the Contract and will result in the forfeiture of the Bidder's security.

BUSINESS LICENSE: The County Business License Ordinance provides that it is unlawful for any person to furnish supplies or services or transact any kind of business in the unincorporated territory of County of El Dorado without possessing a County business license unless exempt under County Ordinance Code Section 5.08.070. The Bidder to whom an award is made must comply with all of the requirements of the County Business License Ordinance, where applicable, prior to beginning work under this contract and at all times during the term of this contract.

CONTRACTOR REGISTRATION: No contractor or subcontractor may bid on any public works project, be listed in a bid proposal for any public works project, or engage in the performance of any contract for public work unless registered with the Department of Industrial Relations pursuant to Labor Code sections 1725.5 and 1771.1.

An inadvertent error in listing a subcontractor who is not registered pursuant to Section 1725.5 in a bid proposal shall not be grounds for filing a bid protest or grounds for considering the bid nonresponsive if the requirements of Labor Code section 1771.1 are met.

SUBCONTRACTOR LIST: Each Proposal must have listed therein the name, contractor's license number, and address of each subcontractor to whom the bidder proposes to subcontract portions of the work in an amount in excess of 0.5% of the total bid or \$10,000, whichever is greater, in accordance with the Subletting and Subcontracting Fair Practices Act, commencing with Section 4100 of the Public Contract Code. The Bidder must also describe in the Subcontractor List the work to be performed by each subcontractor listed. The work to be performed by the subcontractor must be shown by listing the bid item number, bid item description, and portion of the work to be performed by the subcontractor in the form of a percentage (not to exceed 100%) calculated by dividing the work to be performed by the subcontractor by the respective bid item amount(s) (not by the total bid price). The percentage of each bid item subcontracted may be submitted with the Bidder's bid or sent via email or fax to Brian Franklin, County of El Dorado Community Development Agency, Transportation Division, email-

Brian.Franklin@edcgov.us, Fax-(530) 626-0387 by 4:00 p.m. on the first business day after the bid opening. The email or fax must contain the name of each subcontractor submitted with the Bidder's bid along with the bid item number, the bid item description, and the percentage of each bid item subcontracted, as described above. At the time bids are submitted, all listed subcontractors must be properly licensed to perform their designated portion of the work. The bidder's attention is directed to other provisions of the Act related to the imposition of penalties for failure to observe its provisions by using unauthorized subcontractors or by making unauthorized substitutions.

An inadvertent error in listing the California Contractor license number on the Subcontractor List will not be grounds for filing a bid protest or grounds for considering the bid non-responsive if the Bidder submits the corrected contractor's license number to Brian Franklin via fax or email as noted above within 24 hours after the bid opening, provided the corrected contractor's license number corresponds to the submitted name and location for that subcontractor.

NONDISCRIMINATION: Bidders must comply with Chapter 5 of Division 4 of Title 2, California Code of Regulations and the following.

**NOTICE OF REQUIREMENT FOR NONDISCRIMINATION PROGRAM
(GOVERNMENT CODE SECTION 12990)**

Comply with Section 7-1.021(2), "Nondiscrimination," of the Standard Specifications, which is applicable to all nonexempt State contracts and subcontracts, and to the "Standard California Nondiscrimination Construction Contract Specifications" set forth therein. The specifications are applicable to all nonexempt State construction contracts and subcontracts of \$5,000 or more.

PREVAILING WAGE REQUIREMENTS:

Bidders must comply with the provisions of California Labor Code Sections 1770 et seq., including but not limited to Sections 1773, 1773.1, 1773.2, 1773.6, and 1773.7, the general prevailing rate of wages in the county in which the Work is to be done has been determined by the Director of the California Department of Industrial Relations. Interested parties can obtain the current wage information by submitting their requests to the Department of Industrial Relations, Division of Labor Statistics and Research, PO Box 420603, San Francisco CA 94142-0603, Telephone (415) 703-4708 or by referring to the website at <http://www.dir.ca.gov/OPRL/PWD>. The rates at the time of the bid advertisement date of a project will remain in effect for the life of the project in accordance with the California Code of Regulations, as modified and effective January 27, 1997.

Copies of the general prevailing rate of wages in the county in which the Work is to be done are also on file at the Community Development Agency, Transportation Division's principal office, and are available upon request.

In accordance with the provisions of Labor Code 1810, eight (8) hours of labor constitutes a legal day's work upon all work done hereunder, and Contractor and any subcontractor employed under the Contract must conform to and be bound by the provisions of Labor Code Sections 1810 through 1815.

This project is subject to the requirements of Title 8, Chapter 8, Subchapter 4.5 of the California Code of Regulations including the obligation to furnish certified payroll records directly to the Compliance Monitoring Unit under the Labor Commissioner within the Department of Industrial Relations Division of Labor Standards Enforcement in accordance with Section 16461.

BID SECURITY: A bid security must be provided with each bid. Bid security must be in an amount of not less than ten percent (10%) of the total amount of the Bid for bid and must be cash, a certified check, or cashier's check drawn to the order of the County of El Dorado or a Bidder's Bond executed by a surety satisfactory to the County of El Dorado **on the form provided in the Proposal section of these Contract Documents.**

BID PROTEST PROCEDURE: The protest procedure is intended to handle and resolve disputes related to the bid award for this project pursuant to County of El Dorado policies and procedures.

The protest procedure is an extension of the bid process and allows those who wish to protest the recommendation of an award after bid the opportunity to be heard.

Policy: Upon completion of the bid evaluation, the Community Development Agency, Transportation Division shall notify all bidders of the recommendation of award, the basis therefore, and the date on which the recommendation for award will be considered and acted upon by the County of El Dorado Community Development Agency Director (Director).

Procedure: If a bidder wishes to protest the award, the procedure shall be as follows:

1. The Community Development Agency, Transportation Division will review the bids received in a timely fashion under the terms and conditions of the Notice to Bidders, and notify the bidders in writing, at the Fax number designated in the bid, of its recommendation including for award or rejection of bids ("All Bidders Letter").
2. Within five (5) business days from the date of the "All Bidders Letter," the Bidder protesting the recommendation for award shall submit a letter of protest to the County of El Dorado, Community Development Agency, Transportation Division, Attention Brian Franklin, 2850 Fairlane Court, Placerville, CA 95667, and state in detail the basis and reasons for the protest. Any letter of protest must be received by the County of El Dorado within five (5) days from the date of the "All Bidders Letter" and must be received no later than 5:00 p.m. on the fifth day. The Bidder must provide facts to support the protest, including any evidence it wishes to be considered, together with the law, rule, regulation, or criteria on which the protest is based.
3. Only a general contractor who submitted a timely bid may file a bid protest. Individuals who did not submit a bid, including but not limited to subcontractors or others with some secondary interest, may not file a bid protest.
4. If the Community Development Agency, Transportation Division finds the protest to be valid, it may modify its award recommendations and notify all bidders of that decision. If the Community Development Agency, Transportation Division does not agree with the protest, or otherwise fails to resolve the protest, the Community Development Agency, Transportation Division will notify the bid protestor and all interested parties of its decision and the date the award will be agendized for the Board of Supervisors' consideration and action. The Community Development Agency, Transportation Division will also include in its report to the Board of Supervisors the details of the bid protest.
5. The Bidder may attend the Board of Supervisors meeting at which the recommendation and bid protest will be considered. The Board of Supervisors will take comment from the Bidder, staff, and members of the public who wish to speak on the item. In the event that the Bidder is not in attendance at that time, the bid protest may be dismissed by the Board of Supervisors without further consideration of the merits; and
6. The decision of the Board of Supervisors on the bid protest shall be final.

AWARD OF CONTRACT: Bids will be considered for award by the Board of Supervisors. The County of El Dorado reserves the right after opening bids to reject any or all bids, to waive any irregularity in a bid, or to make award to the lowest responsive, responsible Bidder and reject all other bids, as it may best serve the interests of the County.

As a condition of award, the successful Bidder will be required to submit bonds and evidence of insurance prior to execution of the Agreement by the County. Failure to meet this requirement constitutes abandonment of the Bid by the Bidder and forfeiture of the Bidder's security. Award will then be made to the next lowest, responsive, responsible Bidder.

RETAINAGE FROM PAYMENTS: The Contractor may elect to receive one hundred percent (100%) of payments due under the Contract from time to time, without retention of any portion of the payment by the County, by depositing securities of equivalent value with the County in accordance with the provisions of Section 22300 of the Public Contract Code. Securities eligible for deposit hereunder are limited to those listed in Section 16430 of the Government Code, or bank or savings and loan certificates of deposit.

PROJECT ADMINISTRATION: Submit all Requests for Information (RFI) during the bid period on the Quest website under the Quest # 4972543 under "Project Q&A." If the response does not require an addendum, a

response will be posted on the Quest website under the RFI under "Project Q&A". It is the bidders' responsibility to check this website under "Project Q&A" for responses to bidders' inquiries during the bid period. Addenda will be uploaded in pdf format to Quest's website and Quest will issue an automatic email notification to all planholders that have acquired the Contract Documents digitally through Quest. The list of planholders will be available on Quest's website under "View Planholders."

No oral responses to any questions concerning the content of the Contract Documents will be given. All responses will be in the form of written addenda to the Contract Documents or written responses to bidders' inquiries. Responses to bidders' inquiries and addenda will be posted on the Quest website as described above.

ORDER OF PRECEDENCE: In the event of any conflict between or among the terms and conditions of this Notice to Bidders and the documents referred to and incorporated herein, such conflict shall be resolved by giving precedence in the following order of priority:

- 1. The text of this Notice to Bidders
- 2. The Draft Agreement
- 3. The Proposal
- 4. Exhibit A
- 5. Exhibit B

BY ORDER OF the Director of the Community Development Agency, County of El Dorado, State of California.

Authorized by the Board of Supervisors on April 25, 2017 at Placerville, California.

By _____
Bard R. Lower
Director, Transportation Division

By _____
Roger Niello
Interim Director, Community Development Agency

COMPLETING BID IN PENCIL, ERASURES, OVERWRITES, AND USE OF CORRECTION FLUID OR TAPE ARE NOT ACCEPTABLE. BID PROPOSALS WITH PENCIL, ERASURES, OVERWRITES, OR USE OF CORRECTION FLUID OR TAPE MAY BE REJECTED. ALL CHANGES MUST BE LINED OUT AND CORRECTIONS INSERTED ADJACENT TO AND INITIALED BY THE BIDDER'S AUTHORIZED REPRESENTATIVE.

PROPOSAL

(to be submitted with Bidder's Security)

TO: COUNTY OF EL DORADO,
STATE OF CALIFORNIA
COMMUNITY DEVELOPMENT AGENCY
TRANSPORTATION DIVISION,

for the

RESURFACING OF TAHOMA ROADWAY CONTRACT No. 471-C1799

NAME OF BIDDER _____

MAILING
ADDRESS _____

CITY, STATE,
ZIP _____

PHYSICAL ADDRESS _____
(Please include even if Mailing Address used)

CITY, STATE, ZIP _____

TELEPHONE NO: AREA CODE () _____

FAX NO: AREA CODE () _____

EMAIL ADDRESS _____

The work for which this Proposal is submitted is for the application of Type II / Emulsified Asphalt Slurry Seal over road sections in accordance with these Contract Documents (including the payment of not less than the State general prevailing wage rates set forth herein), the Project Plans described below, including any addenda thereto, the Contract annexed hereto, Exhibits A, B, C and also in accordance with the California Department of Transportation Standard Plans 2015, the Standard Specifications 2015, the Manual on Uniform Traffic Control Devices, the Labor Surcharge and Equipment Rental Rates in effect on the date the work is accomplished, and in accordance with the General Prevailing Wage rates. The Project Plans and Contract Documents for the work to be done are entitled:

RESURFACING OF TAHOMA ROADWAY
Contract No. 471-C1799
April 25, 2017

County of El Dorado
Proposal
Page P-1

**RESURFACING OF TAHOMA ROADWAY
CONTRACT NO. 471-C1799**

Bids are to be submitted for the entire Work. The amount of the bid for comparison purposes will be the total of all the items.

The Bidder shall set forth for each unit basis item of work a unit price and a total for the item, and for each lump sum item a total for the item, all in clearly legible figures in the respective spaces provided for this purpose. In the case of unit basis items, the amount set forth under the "Item Total" column shall be the product of the unit price bid and the estimated quantity for the item.

In case of discrepancy between the item price and the total set forth for a unit basis item, the unit price shall prevail, except as provided in (a) or (b), as follows:

- (a) If the amount set forth as a unit price is unreadable or otherwise unclear, or is omitted, or is the same as the amount as the entry in the item total column, then the amount set forth in the total column for the item shall prevail and shall be divided by the estimated quantity for the item and the price thus obtained shall be the unit price;
- (b) (Decimal Errors) If the product of the entered unit price and the estimated quantity is exactly off by a factor of ten, one hundred, etc., or one-tenth, or one-hundredth, etc., from the entered total, the discrepancy will be resolved by using the entered unit price or item total, whichever most closely approximates percentage wise the unit price or item total in the Community Development Agency, Transportation Division's Final Estimate of cost.

If this Proposal is accepted and the undersigned Bidder fails to enter into the Contract and furnish the two bonds in the sums required by the State Contract Act, with surety satisfaction to the County of El Dorado and in accordance with the Special Provisions within ten (10) days, not including Saturdays, Sundays, and legal holidays, of the date of the letter notice from the County of El Dorado that the Contract has been awarded, the County of El Dorado may, at its sole option, determine that the Bidder has abandoned the Contract, and thereupon this Proposal and the acceptance thereof shall be null and void and the forfeiture of such security accompanying this Proposal shall operate and the same shall be the property of the County of El Dorado.

The undersigned, as Bidder, declares under penalty of perjury under the laws of the State of California that the only persons or parties interested in this Proposal, as principals, are those named herein; that this Proposal is made without collusion with any other person, firm, or corporation; that it has carefully examined the location of the proposed work, the annexed proposed form of Contract, and the Plans therein referred to; and that it proposes, and agrees if this Proposal is accepted, that it will contract with the County of El Dorado, in the form of the copy of the Draft Contract annexed hereto, to provide all necessary machinery, tools, apparatus, and other means of construction, and to do all the work and furnish all the materials specified in the Contract, in the manner and time therein prescribed, and according to the requirements of the Engineer as therein set forth, and that it will take in full payment therefore the following item prices, to wit:

RESURFACING OF TAHOMA ROADWAY

CONTRACT NO. 471-C1799

PROPOSAL PAY ITEMS AND BID PRICE SCHEDULE

LUMP SUM BID: (Figure) \$ _____

LUMP SUM BID (Words):

SUBCONTRACTOR LIST

The Bidder must list the name, address, license number, and DIR number of each subcontractor to whom the Bidder proposes to subcontract portions of the Work in excess of 0.5% of the total bid or \$10,000.00 whichever is greater, in accordance with the Public Contract Code commencing with Section 4100 and as required by the Contract Documents. The Bidder must also list the Work portion to be performed by each subcontractor by listing the bid item number, bid item description, and portion of the Work to be performed by the subcontractor in the form of a percentage calculated by dividing the Work to be performed by the subcontractor by the respective bid item amount(s) (not by the total bid price).

Firm Name Address City, State, Zip Code	Phone Fax	License No. DIR No.	Bid Item Number Bid Item Description	Percentage of Each Bid Item Subcontracted
<i>Name</i>	<i>Phone</i>	<i>License No.</i>		
<i>Address</i>				
<i>City, State, Zip Code</i>	<i>Fax</i>	<i>DIR No.</i>		
<i>Name</i>	<i>Phone</i>	<i>License No.</i>		
<i>Address</i>				
<i>City, State, Zip Code</i>	<i>Fax</i>	<i>DIR No.</i>		
<i>Name</i>	<i>Phone</i>	<i>License No.</i>		
<i>Address</i>				
<i>City, State, Zip Code</i>	<i>Fax</i>	<i>DIR No.</i>		

Public Contract Code Section 10285.1 Statement

In conformance with Public Contract Code Section 10285.1 (Chapter 376, Stats. 1985), the Bidder hereby declares under penalty of perjury under the laws of the State of California that the Bidder has _____, has not _____ been convicted within the preceding three years of any offenses referred to in that section, including any charge of fraud, bribery, collusion, conspiracy, or any other act in violation of any state or Federal antitrust law in connection with the bidding upon, award of, or performance of, any public works contract, as defined in Public Contract Code Section 1101, with any public entity, as defined in Public Contract Code Section 1100, including the Regents of the University of California or the Trustees of the California State University. The term "Bidder" is understood to include any partner, member, officer, director, responsible managing officer, or responsible managing employee thereof, as referred to in Section 10285.1.

Note: The Bidder must place a check mark after "has" or "has not" in one of the blank spaces provided. The above Statement is part of the Proposal. Signing this Proposal on the signature portion thereof shall also constitute signature of this Statement. Bidders are cautioned that making a false certification may subject the certifier to criminal prosecution.

Public Contract Code Section 10162 Questionnaire

In conformance with Public Contract Code Section 10162, the Bidder shall complete, under penalty of perjury, the following questionnaire:

Has the Bidder, any officer of the Bidder, or any employee of the Bidder who has a proprietary interest in the Bidder, ever been disqualified, removed, or otherwise prevented from bidding on, or completing a federal, state, or local government project because of a violation of law or a safety regulation?

Yes _____ No _____

If the answer is yes, explain the circumstances in the following space:

Public Contract Code Section 10232 Statement

In conformance with Public Contract Code Section 10232, the Bidder hereby states under penalty of perjury under the laws of the State of California that no more than one final unappealable finding of contempt of court by a Federal Court has been issued against the Bidder within the immediately preceding two year period because of the Bidder's failure to comply with an order of a Federal Court which orders the Bidder to comply with an order of the National Labor Relations Board.

Note: The above Statement and Questionnaire are part of the Proposal. Signing this Proposal on the signature portion thereof shall also constitute signature of this Statement and Questionnaire.

Bidders are cautioned that making a false certification may subject the certifier to criminal prosecution.

NONCOLLUSION AFFIDAVIT

(Title 23 United States Code Section 112 and
Public Contract Code Section 7106)

In conformance with Title 23 United States Code Section 112 and Public Contract Code Section 7106 the Bidder declares that the bid is not made in the interest of, or on behalf of, any undisclosed person, partnership, company, association, organization, or corporation; that the bid is genuine and not collusive or sham; that the Bidder has not directly or indirectly induced or solicited any other bidder to put in a false or sham bid, and has not directly or indirectly colluded, conspired, connived, or agreed with any bidder or anyone else to put in a sham bid, or that anyone shall refrain from bidding; that the Bidder has not in any manner, directly or indirectly, sought by agreement, communication, or conference with anyone to fix the bid price of the bidder or any other bidder, or to fix any overhead, profit, or cost element of the bid price, or of that of any other bidder, or to secure any advantage against the public body awarding the Contract of anyone interested in the proposed Contract; that all statements contained in the bid are true; and, further, that the Bidder has not, directly or indirectly, submitted his or her bid price or any breakdown thereof, or the contents thereof, or divulged information or data relative thereto, or paid, and will not pay, any fee to any corporation, partnership, company association, organization, bid depository, or to any member or agent thereof to effectuate a collusive or sham bid.

NOTE:

The above Noncollusion Affidavit is part of the Proposal. Signing this Proposal on the signature portion thereof shall also constitute signature of this Noncollusion Affidavit.

Bidders are cautioned that making a false certification may subject the certifier to criminal prosecution.

Accompanying this proposal is

(NOTICE: INSERT THE WORDS "CASH(\$___),"CASHIER'S CHECK," "CERTIFIED CHECK," OR "BIDDERS BOND," AS THE CASE MAY BE)

in amount equal to at least ten percent of the amount of the total bid.

The names of all persons interested in the forgoing Proposal as principals are as follows:

IMPORTANT NOTICE: If the Bidder or other interested person is a corporation, state legal name of corporation and place of incorporation, also names of the president, secretary, treasurer, and executive officer thereof; if a partnership, state name of partnership, also names of all individual partners; if Bidder or other interested person is an individual, state first and last names in full.

Licensed in accordance with an act providing for the registration of Contractors,

License No. _____ Classification(s) _____

(A Copy of the afore-referenced license must be attached hereto.)

ADDENDA: This Proposal is submitted with respect to the changes to the Contract included in addenda number (s) _____

(Fill in addenda numbers if addenda have been received and insert, in this Proposal, any Proposal Pay Items and Bid Price Schedules that were received as part of the addenda)

By my signature on this Proposal I certify, under penalty of perjury under the laws of the State of California, that the foregoing questionnaire and statements of Public Contract Code Sections 10162, 10232, and 10285.1 are true and correct and that the Bidder has complied with the requirements of Sections 4104 of the Subletting and Subcontracting Fair Practices Act and of Section 8103 of the Fair Employment and Housing Commission Regulations (Chapter 5 of Division 4 of Title 2 of the California Code of Regulations). By my signature on this Proposal I further certify, under penalty of perjury under the laws of the State of California and the United States of America, that the Noncollusion Affidavit required by Title 23 United States Code, Section 112 and Public Contract Code Section 7106 if elected, are true and correct.

The person or persons executing this Proposal on behalf of a corporation or partnership shall be prepared to demonstrate by resolution, article, or otherwise, that such person is or that such persons are appropriately authorized to act in these regards for such corporation or partnership. Such authority shall be demonstrated to the satisfaction of the County of El Dorado.

If the signature is by an agent other than an officer of a corporation or a member of a partnership, a power of attorney authorizing said act by the agent on behalf of his principal shall be submitted with the bid forms; otherwise, the bid may be disregarded as irregular and unauthorized.

The Bidder's execution on the signature portion of this Proposal shall constitute an endorsement and execution of those affidavits, declarations and certifications which are part of this Proposal.

Executed this _____ day of _____, 20__

at _____ County, State of _____



Name and Title of Bidder _____

Name of Firm _____

END OF PROPOSAL

COUNTY OF EL DORADO

BIDDER'S BOND

this form MUST be used

KNOW ALL PEOPLE BY THESE PRESENTS, THAT WE _____

_____, as

PRINCIPAL, and _____

as Surety are held and firmly bound unto the County of El Dorado, a political subdivision of the State of California (hereinafter referred to as "Obligee"), in the penal sum of **TEN (10) PERCENT OF THE AMOUNT OF THE TOTAL BID PRICE** of the Principal above named, submitted by said Principal to the Obligee for the work described below, for the payment of which sum in lawful money of the United States, well and truly to be made to the Obligee, we the Principal and Surety bind ourselves, our heirs, executors, administrators and successors, jointly and severally, firmly by these presents. In no case shall the liability of the Surety hereunder exceed the sum of

TEN PERCENT (10%) OF THE AMOUNT OF THE TOTAL BID PRICE

THE CONDITION OF THIS OBLIGATION IS SUCH, THAT:

WHEREAS, the Principal has submitted the above-mentioned Bid to the Obligee, as aforesaid, for certain construction specifically described as follows, for which bids are to be opened at Placerville, El Dorado County, California, for the construction of the

**Resurfacing of Tahoma Roadway
CONTRACT No. 471-C1799**

NOW, THEREFORE, if the aforesaid Principal is awarded the Contract and, within the time and manner required under the Contract Documents, after the prescribed forms are presented to it for signature, enters into a written contract, in the prescribed form, in accordance with the Bid, and files two bonds with the Obligee, one to guarantee faithful performance and the other to guarantee payment for labor and materials, as required by law, then this obligation shall be null and void; otherwise, it shall remain in full force and virtue.

In the event suit is brought upon this bond by the Obligee and judgment is recovered, the Surety shall pay all costs incurred by the Obligee in such suit, including a reasonable attorney's fee to be fixed by the Court.

IN WITNESS WHEREOF, we have set our hands and seals on this _____ day of _____ 20__

Bond No. _____

(seal) _____ Principal

(seal) _____ Surety

Address: _____

(NOTE: Signature of those executing for the Surety shall be properly acknowledged, and accompanied by a Certificate of Acknowledgment.)

SURETY

ACKNOWLEDGMENT

A notary public or other officer completing this certificate verifies only the identity of the individual who signed the document to which this certificate is attached, and not the truthfulness, accuracy, or validity of that document.

State of California

County of _____

On _____ before me, _____,
(here insert name and title of the officer)

personally appeared _____

_____ ,

who proved to me on the basis of satisfactory evidence to be the person(s) whose name(s) is/are subscribed to the within instrument and acknowledged to me that he/she/they executed the same in his/her/their authorized capacity(ies), and that by his/her/their signature(s) on the instrument the person(s), or the entity upon behalf of which the person(s) acted, executed the instrument.

I certify under PENALTY OF PERJURY under the laws of the State of California that the foregoing paragraph is true and correct.

WITNESS my hand and official seal.

Signature _____

(Seal)



COUNTY OF EL DORADO COMMUNITY DEVELOPMENT AGENCY TRANSPORTATION DIVISION

AGREEMENT FOR CONSTRUCTION SERVICES

THIS AGREEMENT made and entered into by and between the **COUNTY OF EL DORADO**, a political subdivision of the State of California, acting through the governing body or board thereof (hereinafter referred to as "County"), and , a duly qualified to conduct business in the State of California, whose principal place of business is (hereinafter referred to as "Contractor");

RECITALS

That for and in consideration of the mutual promises, covenants, agreements, and conditions herein contained, the parties hereto agree with each other as follows:

1. Contract Documents

The complete Agreement between the parties consists of and is set forth in the Contract Documents. The Contract Documents consist of: (a) this Agreement including any Exhibits hereto, and any amendments thereto in accordance with the provisions herein; (b) an executed Subcontractors Listing Form, if applicable; (c) executed Certificate of Insurance forms; (d) an executed California Form 590; (e) an executed Department of the Treasury Internal Revenue Service Form W-9 or County Payee Data Record Form, whichever is applicable; and (f) all executed Change Orders. All obligations of the parties are contained in the Contract Documents, and by acceptance of this Agreement the parties hereto agree to be bound by the provisions of all of said documents. All of said documents are intended to cooperate so that any work called for in one and not mentioned in the other or vice versa, is to be executed the same as if mentioned in all of them.

2. The Work

Contractor agrees to furnish all tools, equipment, vehicles, apparatus, facilities, labor, materials, supplies, and services to provide application of Type II / Emulsified Asphalt Slurry Seal over road sections in the South Lake Tahoe/Tahoma area.

Services shall include, but not be limited to, notifying the residents of the work to be performed; cleaning the road surfaces as necessary with a pick-up type sweeper prior to the application of surfacing materials; protection of the existing manhole covers, water valve boxes, and any other utility covers; application of Type II / Emulsified Asphalt Slurry Seal; and traffic control measures adequate for the application of surfacing materials until the surfacing materials have sufficiently cured to allow traffic access to the resurfaced areas.

Contractor shall furnish test reports for aggregate and emulsion used in conjunction with the work to County's Contract Administrator at the time the work is completed. Spoils shall be properly disposed of off-site at no additional cost to County. All materials and application methods shall be in conformance with the 2015 Caltrans Standard Specifications, including any amendments thereto as shown in Exhibit A, marked "Project Specifications."

The Work shall be performed in accordance with all of the terms and conditions of the Contract Documents.

3. **Location of Work**

Said work is to be performed as described in Exhibit B, marked "Micro-Surfacing Locations" and Exhibit C, marked "Micro-Surfacing Location Map."

4. **Contract Price**

As compensation agreed upon for said Work, County shall pay or cause to be paid to Contractor, in full, and for the full contract price and compensation for said completion of the Work, including without limitation, all bonds and insurance, **THE NOT TO EXCEED SUM OF DOLLARS (\$)** which sum constitutes the Contract Price for the complete Project (the "Contract Price").

5. **Time of Completion**

Time is of the essence. The Work under the Agreement shall be completed **within (60) Calendar Days** from the date specified in the official Notice to Proceed with the Work, unless an extension of time or suspension of Work is authorized in writing in accordance with a Contract Change Order.

It is agreed by the parties to this Agreement that if all the Work called for under the Contract Documents in all parts and requirements is not finished or completed within the number of calendar days as set forth above, damage will be sustained by County, and that it is and will be impracticable and extremely difficult to ascertain and determine the actual damage which County will sustain in the event of and by reason of the delay; and it is therefore agreed that Contractor will pay to County the sum of **DOLLARS (\$)** per calendar day, as liquidated damages and not as a penalty, for each and every calendar day's delay in finishing the work in excess of the number of calendar days prescribed herein; and Contractor agrees to pay the liquidated damages herein provided for, and further agrees that County may deduct the amount thereof from any moneys due or that may become due Contractor under the Agreement.

6. **Payment**

Payment shall be made to Contractor as follows:

ONE LUMP SUM UPON COMPLETION AND ACCEPTANCE OF PROJECT

Retention of 5% of the total Contract Price will be held at the option of County. Payment by County as herein provided shall not be construed as an absolute acceptance of defects in the Work or improper materials. County shall promptly pay Contractor in accordance with Public Contract Code Section 20104.50.

7. **Performance Bond**

As a part of the execution of this Agreement, Contractor shall furnish a bond of a surety company authorized to do business in the State of California, conditioned upon the faithful performance of all covenants and stipulations under this Agreement. The amount of this bond shall be one hundred percent (100%) of the total Contract Price and shall be executed upon the form provided by County.

8. **Payment Bond**

As a part of the execution of this Agreement, Contractor shall furnish a bond of a surety company authorized to do business in the State of California, conditioned upon the payment in full of all claims for labor and materials in accordance with the provisions of the law of the State of California. The amount of this bond shall be one hundred percent (100%) of the total Contract Price and shall be executed upon the form provided by County.

9. Notification of Surety Company

The surety company shall familiarize itself with all of the conditions and provisions of this Agreement, and shall waive the right of special notification of any change or modifications of this Agreement or extension of time, or of decreased or increased work, or of the cancellation of the Agreement, or of any other act or acts by County or its authorized agents, under the terms of this Agreement; and failure to so notify the aforesaid surety company of changes shall in no way relieve the surety company of its obligation under this Agreement.

10. Payment of Prevailing Wages

Contractor shall pay and require payment of wages according to a scale of prevailing wage rates determined by California law, which scale is on file at County's Transportation Division's principal office and shall comply with all applicable wage requirements, as set forth in Labor Code Sections 1770 et seq., 1773.2, 1775, 1776, 1810 and 1813. In accordance with the provisions of Labor Code Section 1810, eight (8) hours of labor shall constitute a legal day's work upon all work done hereunder, and Contractor and any subcontractor employed under this Agreement shall also conform to and be bound by the provisions of Labor Code Sections 1810 through 1815.

11. Apprentices

Attention is directed to Sections 1777.5, 1777.6 and 1777.7 of the California Labor Code and Title 8, California Code of Regulations Section 200 et seq. To ensure compliance and complete understanding of the law regarding apprentices, and specifically the required ratio thereunder, each Contractor or subcontractor should, where some question exists, contact the Division of Apprenticeship Standards, 455 Golden Gate Avenue, San Francisco, CA 94102, or one of its branch offices prior to commencement of work on the public works contract. Responsibility for compliance with this section lies with Contractor.

It is County policy to encourage the employment and training of apprentices on public works contracts as may be permitted under local apprenticeship standards.

12. Certified Payroll

As required under the provisions of Labor Code Section 1776, Contractor and any subcontractors shall keep accurate payroll records as follows:

1. The payroll records shall show the name, address, social security number, work classification, straight time and overtime hours worked each day and week, and the actual per diem wages paid to each journeyman, apprentice, worker, or other employee employed by Contractor or subcontractors in connection with this Project.
2. A certified copy of all payroll records enumerated above shall be available for inspection at all reasonable hours at the principal office of Contractor as follows:
 - a. Make available or furnish to the employee or his or her authorized representative on request.
 - b. Make available for inspection or furnished upon request to a representative of County, the State Division of Labor Standards Enforcement, and the Division of Apprenticeship Standards of the State Department of Industrial Relations.
 - c. Make available upon request by the public for inspection or copies thereof made; provided, however, that a request by the public shall be made through either County, the State Division of Labor Standards Enforcement, or the State Division of Apprenticeship Standards. The requesting party shall, prior to being provided the records, reimburse the costs of preparation by Contractor, subcontractor, and the entity through which the

request was made. The public shall not be given access to the records at the principal office of Contractor.

- d. All contractors and subcontractors must furnish electronic certified payroll records directly to the Department of Industrial Relations.

13. Registration of Contractors

No contractor or subcontractor may bid on any public works project, be listed in a bid proposal for any public works project, or engage in the performance of any contract for public work unless registered with the Department of Industrial Relations pursuant to Labor Code sections 1725.5 and 1771.1.

Contractor shall post job site notices as prescribed by Title 8 of California Code of Regulations Section 16451.

14. Records Examination and Audit Requirements

Contractor and its subcontractors, if any are authorized hereunder, shall maintain all books, documents, papers, accounting records, and other evidence pertaining to the performance of the Agreement, including but not limited to, the costs of administering the various aspects of the Agreement. In accordance with Government Code Section 8546.7, all of the above-referenced parties shall make such materials available at their respective offices at all reasonable times during the contract period and for four (4) years from the date that final payment by County and all other pending matters are closed. Representatives of County, the State Auditor, and any duly authorized representative of other government agencies shall have access to any books, documents, papers and records that are pertinent to the Agreement for audit, examination, excerpts, and transactions and copies thereof shall be furnished upon request.

15. Payment of all Federal, State, or City Taxes

Any federal, state, or city tax payable on the articles furnished by Contractor under the Agreement shall be included in the Contract Price and paid by Contractor.

16. Compliance with all Applicable Laws

Contractor shall conform to and abide by all Federal, State and local building, labor and safety laws, ordinances, rules and regulations. All Work and materials shall be in full accordance with the latest rules and regulations of the State Fire Marshal, safety orders of the Division of Industrial Safety, California Electrical Code, California Building Code, California Plumbing Code, and any and all other applicable laws and regulations. Nothing in the Contract Documents, including but not limited to the plans and specifications, is to be construed to permit work not conforming to these codes, laws, and regulations.

17. Nondiscrimination

- A. County may require Contractor's services on projects involving funding from various state and/or federal agencies, and as a consequence, Contractor shall comply with all applicable nondiscrimination statutes and regulations during the performance of this Agreement including but not limited to the following: Contractor and its employees and representatives shall not unlawfully discriminate against any employee or applicant for employment because of race, religion, color, national origin, ancestry, physical disability, mental disability, medical condition, marital status, age, genetic information, gender, gender identity, gender expression, sexual orientation, or military or veteran status; Contractor shall, unless exempt, comply with the applicable provisions of the Fair Employment and Housing Act (Government Code, Sections 12900 et seq.) and applicable regulations promulgated thereunder (California Code of Regulations, Title 2, Sections 7285.0 et seq.); the applicable regulations of the Fair Employment and Housing Commission implementing Government Code, Section 12990, set forth in Chapter 5 of Division 4 of Title 2 of the California Code of Regulations incorporated into this Agreement by reference and

made a part hereof as if set forth in full; and Title VI of the Civil Rights Act of 1964, as amended. Contractor and its employees and representatives shall give written notice of their obligations under this clause as required by law.

- B. Where applicable, Contractor shall include these nondiscrimination and compliance provisions in any of its agreements that affect or are related to the services performed herein.
- C. Contractor's signature shall provide any certifications necessary under the federal laws, the laws of the State of California, including but not limited to Government Code Section 12990 and Title 2, California Code of Regulations, Section 8103.

18. Reporting Accidents

Contractor shall prepare and submit (within 24 hours of such incidents) reports of accidents at the site and anywhere else the work is in progress in which bodily injury is sustained or property loss in excess of Five Hundred Dollars (\$500.00) occurs.

19. Workers' Compensation

Contractor shall comply with Labor Code Sections 3700 et seq., requiring it to obtain Workers' Compensation Insurance, and sign a certificate of knowledge thereof.

CERTIFICATE OF KNOWLEDGE - LABOR CODE SECTION 3700

I am aware of the provisions of Section 3700 of the Labor Code which require every employer to be insured against liability for workers' compensation or to undertake self-insurance in accordance with the provisions of that Code, and I will comply with such provisions before commencing the performance of the work of this Agreement.

Signed: _____ Dated: _____

20. Deviation from Plans and Specifications

No deviation shall be made from the plans and/or the specifications, if any, without the prior written approval of Contract Administrator.

21. Unity of Plans and Specifications

The plans and specifications, if any, are one document, and any work shown or mentioned, in one and not in the other, or vice versa, shall be furnished or performed as though mentioned or shown in both.

22. Relocation of Utilities

As required by Section 4215 of the California Government Code, County will assume responsibility for the removal, relocation, and protection of main or trunk-line utility facilities existing on the construction site, if such facilities are not shown in the plans and specifications, and County shall compensate Contractor for the costs of locating and repairing damage to such facilities not due to the failure of Contractor to exercise reasonable care.

Nothing herein shall be deemed to require County to indicate the presence of existing service laterals or appurtenances whenever the presence of such utilities on the site of the construction project can be inferred from the presence of other visible facilities, such as buildings, meter and junction boxes, on or adjacent to the site of the construction.

If Contractor, while performing the Work under the Agreement, discovers utility facilities not identified in the Contract Documents, including the plans or specifications, Contractor shall immediately notify the Contract Administrator or Project Manager. County shall not be liable for Contractor's performance of unauthorized work.

23. Notice of Discovery of Hazardous Waste or Unusual Conditions

- A. Contractor shall promptly, and before the following conditions are disturbed, notify County in writing, in the event Contractor encounters, after excavating to a depth of greater than four (4) feet, any of the following:
 - 1. Material that Contractor believes may be hazardous waste, as defined in section 25117 of the Health and Safety Code, which is required to be removed to a Class I, Class II, or Class III disposal site in accordance with provisions of existing law;
 - 2. Subsurface or latent physical conditions at the site differing materially from those indicated in the Contract Documents; or
 - 3. Unknown physical conditions at the site of any unusual nature, differing materially from those ordinarily encountered and generally recognized as inherent in the Work provided for in the Agreement.
- B. County shall promptly investigate the conditions, and if it finds that the conditions do materially so differ, involve hazardous waste, or cause a decrease or increase in Contractor's cost of or time required for performance of any part of the Work, an adjustment, excluding loss of anticipated profits, will be made and the Contract Documents will be modified by a Change Order. County will notify Contractor of County's determination as to whether or not an adjustment of the Contract Documents is warranted.
- C. In the event a dispute arises between County and Contractor as to whether the conditions materially differ, or involve hazardous waste, or cause a decrease or increase in Contractor's cost of or time required for performance of any part of the Work, Contractor shall not be excused from any scheduled completion date provided for by the Agreement, but shall proceed with all Work to be performed under the Agreement. Contractor shall retain any and all rights provided either by contract or by law which pertain to the resolution of disputes and protests between Contractor and County.

24. Subcontracting

The provisions of Sections 4100-4114, inclusive, of the Public Contract Code regarding subcontracting shall apply to this Agreement, and Contractor represents that it will comply with all provisions therein. For the purposes of this Agreement, no subcontractors are authorized to perform any portion of the Work.

25. Additional Work

County reserves the right to make such alterations, deviations, or additions to or deletions from the plans and specifications, including the right to increase or decrease the quantity of any item or portion of work or to delete any items or portion of work, as may be deemed by the Contract Administrator or Project Manager to be necessary or advisable, and to require such additional work to be required for the proper completion of the whole Work contemplated.

Any such changes will be set forth in a Contract Change Order (Change Order) which will specify the additional work, adjustment of performance time, if any, and basis for additional or reduced compensation, if any. Any Change Order shall not become effective until approved by the Director of Transportation, or where required, by the Board of Supervisors.

26. Termination by County for Convenience

County reserves the right to terminate the Agreement at any time upon determination by County's representative that termination of the Agreement is in the best interest of County. County shall issue Contractor a written notice specifying that the Agreement is to be terminated.

Upon receipt of said written notice, Contractor shall stop all work under the Agreement except: (1) work specifically directed to be completed prior to termination, (2) work the Inspector deems necessary to secure the Project for termination, (3) removal of equipment and plant from the site of the Work, (4) action that is necessary to protect materials from damage, (5) disposal of materials not yet used in the Work as directed by County, and (6) clean up of the site.

If the Agreement is terminated for County's convenience as provided herein, all finished or unfinished work and materials previously paid for shall, at the option of County, become its property. Contractor shall be paid an amount which reflects costs incurred for work provided to the date of notification of termination. In addition, Contractor shall be paid the reasonable cost, as solely judged by County, and without profit, for all work performed to secure the Project for termination.

27. Termination by County for Cause

If Contractor is adjudged as bankrupt or insolvent or makes a general assignment for the benefit of its creditors, if a trustee or receiver is appointed for Contractor or for any of its property, or if Contractor files a petition to take advantage of any debtor's act or to reorganize under the bankruptcy or applicable laws, or on more than one occasion fails to supply sufficient skilled workmen or suitable material or equipment, or on more than one occasion fails to make prompt payments to subcontractors for labor, materials, or equipment, or disregards the authority of County's representative, or the Engineer, if one is appointed, or otherwise violates any provision of the Contract Documents, then County may, without prejudice to any other right or remedy and after giving Contractor a minimum of ten (10) days from delivery of a written termination notice, terminate the services of Contractor and take equipment and machinery thereon owned by Contractor and finish the Work by whatever method County may deem expedient. In such case, Contractor shall not be entitled to receive any further payment until the Work is finished.

Without prejudice to other rights or remedies County may have, if Contractor fails to begin delivery of materials and equipment, to commence Work within the time specified, to maintain the rate of delivery of material, to execute the Work in the manner and at such locations as specified, or fails to maintain a work program which will ensure County's interest, or, if Contractor is not carrying out the intent of the Agreement, an Inspector's written notice may be served upon Contractor demanding satisfactory compliance with the Agreement. If Contractor does not comply with such notice within five (5) days after receiving it, or after starting to comply, fails to continue, County may exclude it from the premises and take possession of all material and equipment, and complete the Work by County's own forces, by letting the unfinished Work to another Contractor, or by a combination of such methods.

Where Contractor's services have been so terminated by County, said termination shall not affect any right of County against Contractor then existing or which may thereafter accrue. Any retention or payment of monies by County due Contractor will not release Contractor from compliance with the Contract Documents.

If the unpaid balance of the Contract Price exceeds the direct and indirect costs of completing the Work, including compensation for additional professional services, such excess shall be paid to Contractor. If the sums under the Agreement are insufficient for completion, Contractor shall pay to County within five (5) days after the completion, all costs in excess of the Contract Price. In any event, the cost of completing the Work shall be charged against Contractor and may be deducted from any money due or becoming due from County.

The provisions of this Article shall be in addition to all other rights and remedies available to County under law.

If after notice of termination, it is determined for any reason that Contractor was not in default, the rights and obligations of the parties shall be the same as if the notice of termination had not been issued. The Agreement shall be equitably adjusted to compensate for such termination.

28. Successors and Assigns

This Agreement shall bind and inure to the heirs, devisees, assignees, and successors in interest of Contractor and to the successors in interest of County in the same manner as if such parties had been expressly named herein.

29. Assignment of Contract

Neither the Contract nor any part thereof, or any monies due or to become due hereunder, may be assigned by Contractor without the written approval of County. County may assign this Contract to a lender, or any third party that assumes the obligations of County hereunder.

30. Amendments

This Agreement may be amended by mutual consent of the parties hereto. Said amendment shall become effective only when in writing and fully executed by duly authorized officers of the parties hereto.

31. Separate Contracts

County reserves the right to let other contracts in connection with the Work. Contractor shall afford all other such contractors reasonable opportunity for storage of their materials, shall provide that the execution of its work properly connects and coordinates with theirs, and shall cooperate with them to the end of facilitating the Work.

32. Indemnity

To the fullest extent allowed by law, Contractor shall defend, indemnify, and hold County and its officers, directors, and employees harmless against and from any and all claims, suits, losses, damages, and liability for damages, including attorney's fees and other costs of defense brought for or on account of injuries to or death of any person, including but not limited to, workers and the public, or on account of injuries to or death of County employees, or damage to property, or any economic, consequential, or special damages which are claimed or which shall in any way arise out of or be connected with Contractor's services, operations, or performance hereunder, regardless of the existence or degree of fault or negligence on the part of County, Contractor, subcontractors or employees of any of these, except for the active or sole negligence of County, its officers, directors, and employees, or where expressly prescribed by statute.

The duty to indemnify and hold harmless County specifically includes the duties to defend set forth in Section 2778 of the Civil Code. The insurance obligations of Contractor are separate, independent obligations under the Contract Documents, and the provisions of this defense and indemnity are not intended to modify nor should they be construed as modifying or in any way limiting the insurance obligations set forth in the Contract Documents. This indemnity requirement applies to any claims, suits, losses, damages and liability for damages, including attorney's fees and other costs, arising from alleged defects in the content or the manner of submission of the Contractor's bid for the Contract.

33. Insurance

GENERAL INSURANCE REQUIREMENTS: Contractor shall provide proof of a policy of insurance satisfactory to County's Risk Management Division and documentation evidencing that Contractor maintains insurance that meets the following requirements:

1. Full Workers' Compensation and Employers' Liability Insurance covering all employees of Contractor as required by law in the State of California.

-
2. Commercial General Liability Insurance of not less than One Million Dollars (\$1,000,000) combined single limit per occurrence for bodily injury and property damage, including but not limited to endorsements for the following coverage: premises, personal injury, operations, products and completed operations, blanket contractual, and independent contractors' liability and a \$2,000,000 aggregate limit.
 3. Automobile Liability Insurance of not less than One Million Dollars (\$1,000,000) is required in the event motor vehicles are used by Contractor in performance of the Contract.
 4. In the event Contractor is a licensed professional and is performing professional services under this Agreement, Professional Liability Insurance is required with a limit of liability of not less than One Million Dollars (\$1,000,000).
 5. Explosion, Collapse and Underground coverage is required when the scope of work includes XCU exposures.

PROOF OF INSURANCE REQUIREMENTS:

1. Contractor shall furnish proof of coverage satisfactory to County's Risk Management Division as evidence that the insurance required herein is being maintained. The insurance will be issued by an insurance company acceptable to County's Risk Management Division, or be provided through partial or total self-insurance likewise acceptable to the Risk Management Division.
2. The County of El Dorado, its officers, officials, employees, and volunteers shall be included as additional insured, but only insofar as the operations under this Agreement are concerned. This provision shall apply to all general and excess liability insurance policies. Proof that County is named additional insured shall be made by providing the Risk Management Division with a certified copy, or other acceptable evidence, of an endorsement to Contractor's insurance policy naming County as additional insured.
3. In the event Contractor cannot provide an occurrence policy, Contractor shall provide insurance covering claims made as a result of performance of this Agreement for not less than three (3) years following completion of performance of this Agreement.
4. Any deductibles or self-insured retentions must be declared to and approved by County. At the option of County, either: the insurer shall reduce or eliminate such deductibles or self-insured retentions as respects County, its officers, officials, employees, and volunteers; or Contractor shall procure a bond guaranteeing payment of losses and related investigations, claim administration, and defense expenses.
5. Contractor shall require each of its subcontractors to procure and maintain Commercial General Liability Insurance, Automobile Liability Insurance, and Workers' Compensation Insurance of the types and in the amounts specified above, or shall insure the activities of its subcontractors in its own policy in like amounts. Contractor shall also require each of its subcontractors to name Contractor and the County of El Dorado as additional insureds on each subcontractor's general and excess liability insurance policies. Upon request by County Contractor shall furnish proof of coverage satisfactory to County as evidence that the subcontractor insurance required herein is being maintained.

INSURANCE NOTIFICATION REQUIREMENTS:

1. Contractor agrees that no cancellation or material change in any policy shall become effective except upon prior written notice to Community Development Agency, Contract Services Unit, 2850 Fairlane Court, Placerville, California 95667.
2. Contractor agrees that the insurance required herein shall be in effect at all times during the term of this Agreement, inclusive of the guarantee/warranty period specified herein below. In the event said

insurance coverage expires at any time or times during the term of this Agreement, Contractor shall immediately provide a new certificate of insurance as evidence of the required insurance coverage. In the event Contractor fails to keep in effect at all times insurance coverage as herein provided, County may, in addition to any other remedies it may have, terminate this Agreement upon the occurrence of such event. New certificates of insurance are subject to the approval of County's Risk Management Division.

ADDITIONAL STANDARDS: Certificates shall meet such additional standards as may be determined by County's Department of Transportation either independently or in consultation with County's Risk Management Division, as essential for protection of County.

COMMENCEMENT OF PERFORMANCE: Contractor shall not commence performance of this Agreement unless and until compliance with each and every requirement of the insurance provisions is achieved.

MATERIAL BREACH: Failure of Contractor to maintain the insurance required herein, or to comply with any of the requirements of the insurance provisions, shall constitute a material breach of the entire Agreement.

REPORTING PROVISIONS: Any failure to comply with the reporting provisions of the policies shall not affect the coverage provided to County, its officers, officials, employees or volunteers.

PRIMARY COVERAGE: Contractor's insurance coverage shall be primary insurance as respects County, its officers, officials, employees and volunteers. Any insurance or self-insurance maintained by County, its officers, officials, employees, or volunteers shall be in excess of Contractor's insurance and shall not contribute with it.

PREMIUM PAYMENTS: The insurance companies shall have no recourse against County, its officers, agents, employees, or volunteers, or any of them for payment of any premiums or assessments under any policy issued by any insurance company.

CONTRACTOR'S OBLIGATIONS: Contractor's indemnity and other obligations shall not be limited by the insurance required herein and shall survive the expiration of this Agreement.

34. Independent Contractor/Liability

Contractor is, and shall be at all times, deemed independent and shall be wholly responsible for the manner in which it performs services required by terms of this Agreement. Contractor exclusively assumes responsibility for acts of its employees, associates, and subcontractors, if any are authorized herein, as they relate to services to be provided under this Agreement during the course and scope of their employment.

Contractor shall be responsible for performing the work under this Agreement in a safe, professional, skillful, and workmanlike manner and shall be liable for its own negligence and negligent acts of its employees. County shall have no right of control over the manner in which work is to be done and shall, therefore, not be charged with responsibility of preventing risk to Contractor or its employees.

35. Interest of Public Official

No official or employee of County who exercises any functions or responsibilities in review or approval of services to be provided by Contractor under this Agreement shall participate in or attempt to influence any decision relating to this Agreement which affects personal interest or interest of any corporation, partnership, or association in which he/she is directly or indirectly interested; nor shall any such official or employee of County have any interest, direct or indirect, in this Agreement or the proceeds thereof.

36. Interest of Contractor

Contractor covenants that Contractor presently has no personal interest or financial interest, and shall not acquire same in any manner or degree in either: 1) any other contract connected with or directly affected by the services

to be performed by this Agreement; or, 2) any other entities connected with or directly affected by the services to be performed by this Agreement. Contractor further covenants that in the performance of this Agreement no person having any such interest shall be employed by Contractor.

37. Conflict of Interest

The parties to this Agreement have read and are aware of the provisions of Government Code Section 1090 et seq. and Section 87100 relating to conflict of interest of public officers and employees. Contractor attests that it has no current business or financial relationship with any County employee(s) that would constitute a conflict of interest with provision of services under this contract and will not enter into any such business or financial relationship with any such employee(s) during the term of this Agreement. County represents that it is unaware of any financial or economic interest of any public officer or employee of Contractor relating to this Agreement. It is further understood and agreed that if such a financial interest does exist at the inception of this Agreement either party may immediately terminate this Agreement by giving written notice as detailed in Article 27, Termination by County for Cause, hereto.

38. Licenses

Contractor warrants and represents that it holds a valid California license pursuant to the Contractors' State License Law (Business and Professions Code Sections 7000, et seq.), that its license is in good standing and that it possesses a Class License as required by the categories and type of the Work. Copies of Contractor's State Contractors' license must be provided with this Agreement.

39. Business License

County's Business License Ordinance provides that it is unlawful for any person to furnish supplies or services or transact any kind of business in the unincorporated territory of County of El Dorado without possessing a County business license unless exempt under County Ordinance Code Section 5.08.070. Contractor warrants and represents that it shall comply with all of the requirements of County's Business License Ordinance, where applicable, prior to beginning work under this Agreement and at all times during the term of this Agreement.

40. Cleaning Up

Contractor shall not allow the site of the Work to become littered with trash, rubbish, or waste material, and shall maintain the site of Work in a neat and orderly condition throughout the performance of the Work. At the end of each work day, Contractor shall clean up all debris and waste materials generated by the Work and shall properly dispose of all trash, rubbish, and waste materials off site at no additional cost to County.

41. Access to the Work

County, and any state or local authorities having jurisdiction over the Project, shall at all times have access to the Work.

42. Acceptance of Work

The Work will be accepted by County in writing in the form of a recorded Notice of Acceptance signed by the Director of Transportation when the whole shall have been completed satisfactorily, as determined by County or its duly authorized representative. Acceptance of the Work shall not constitute an acceptance of latent defects nor relieve Contractor of responsibility for any act or omission which is a violation of the Agreement. County will release retention withheld, if any, thirty-five (35) days after the Notice of Acceptance is recorded.

43. **Resolution of Claims**

Contractor's attention is invited to Public Contract Code Sections 20104, et seq., for resolution of construction claims, and specifically Section 20104.2. Claims pertaining to this Agreement shall be governed by the provisions of those sections.

44. **Environmental and Toxic Warranty**

Contractor warrants that its operations concerning the Project are not and will not be in violation of any applicable federal, state, or local environmental statute, law, or regulation dealing with hazardous materials substances or toxic substances.

45. **Guarantee**

Final Guarantee: Contractor shall guarantee all materials and equipment furnished and work performed for a period of one (1) year. Contractor warrants and guarantees for a period of one (1) year from the date of Acceptance of the Work that the Work is free from all defects due to faulty materials or workmanship and Contractor shall promptly make such corrections as may be necessary, including repairs of any damage to other parts of the Work resulting from such defects. County will give notice of observed defects with reasonable promptness. In the event that Contractor should fail to make such repairs, adjustments, or other work that may be made necessary by such defects, County may do so and charge Contractor the cost thereby incurred.

Extended Guarantees: If a guaranty exceeding one (1) year is provided by the supplier or manufacturer of any equipment or materials used in this Project, then the guarantee for such equipment or materials shall be extended for such term. Contractor expressly agrees to act as co-guarantor of such equipment and materials, and Contractor shall supply County with all warranty and guaranty documents relative to equipment and materials incorporated in the job and guaranteed by its suppliers or manufacturers.

Warranty: Contractor warrants to County that materials and equipment furnished under the Contract will be of good quality and new, unless otherwise required or permitted by the Contract, that the Work will be free from defects or flaws and is of the highest quality of workmanship and that the Work will conform with the requirements of the Contract. Work not conforming to these requirements, including substitutions not properly approved and authorized, shall be considered defective.

If within one (1) year from the date of the Acceptance of the Work or such longer period of time as may be prescribed by law or regulations or by the terms of any applicable special guarantee required by the contract documents, any work is found to be defective, Contractor shall promptly, without cost to County and in accordance with County's written instruction, correct such defective work. If work is rejected by County, defective material or work will be removed from site and replaced with non-defective materials or work. If Contractor is unable to promptly and properly correct any defective work, County may at its option have the work corrected by such other means as County deems appropriate and hold Contractor liable for all direct, indirect and consequential costs caused by such defective work. Said warranty shall apply to all work found to be "defective" which is attributable to the quality or quantity of the materials used, the quality of the workmanship or for performance of the Contract.

46. Notice

Any notice or other correspondence required to be given under this Agreement by either party to the other may be affected by personal delivery in writing or by mail, postage prepaid. Notices personally delivered during normal business hours shall be deemed received on the actual date of delivery; mailed notices shall be deemed received one (1) day after affixed postmark. Notices and correspondence to County shall be in duplicate and shall be delivered to it as follows:

To County:

County of El Dorado
Community Development Agency
Transportation Division
2441 Headington Road
Placerville, California 95667

Attn.: Don Spear, Deputy Director-
Maintenance and Operations Unit

With a Copy To:

County of El Dorado
Community Development Agency
Administration and Finance Division
2850 Fairlane Court
Placerville, California 95667

Attn.: Michele Weimer
Administrative Services Officer
Contracts and Procurement Unit

Notices and correspondence to Contractor shall be delivered when personally delivered to, or if mailed, addressed to Contractor at:

~~Contractor's Business Name~~
~~Street Address~~
~~City, State Zip~~
Attn.: ~~Name of Notices Recipient~~
~~Title of Notices Recipient~~

Either party may change its address for notices or for its principal place of business by giving written notice pursuant to this Article.

47. Change of Address

In the event of a change in address for Contractor's principal place of business, Contractor's Agent for Service of Process, or Notices to Contractor, Contractor shall notify County in writing as provided in Article 46, Notice. Said notice shall become part of this Agreement upon acknowledgment in writing by County's Contract Administrator, and no further amendment of the Agreement shall be necessary provided that such change of address does not conflict with any other provisions of this Agreement.

48. Drug-Free Workplace

Contractor shall comply with Government Code section 8355.

49. California Residency (Form 590)

All independent Contractors providing services to County must file a State of California Form 590, certifying their California residency or, in the case of a corporation, certifying that they have a permanent place of business in California. Contractor will be required to submit a Form 590 prior to execution of an Agreement or County shall withhold seven (7) percent of each payment made to Contractor during the term of this Agreement. This requirement applies to any Agreement/Contract exceeding \$1,500.00.

Or if Consultant is a nonresident, use the Nonresident Withholding article.

50. Nonresident Withholding

If Consultant is not a California resident, Consultant shall provide documentation that the State of California has granted a withholding exemption or authorized reduced withholding prior to execution of this Agreement or County shall withhold seven (7%) percent of each payment made to the Consultant during term of the Agreement as required by law. This requirement applies to any agreement/contract exceeding \$1,500.00. Consultant shall indemnify and hold County harmless for any action taken by the California Franchise Tax Board.

51. County Payee Data Record Form

All independent contractors or corporations providing services to County who do not have a Department of the Treasury Internal Revenue Service Form W-9 (Form W-9) on file with County must file a County Payee Data Record Form with County.

52. Taxes

Contractor certifies that as of today's date, it is not in default on any unsecured property taxes or other taxes or fees owed by Consultant to County. Contractor agrees that it shall not default on any obligations to County during the term of this Agreement.

53. Venue

The Contract Documents and all provisions thereto shall be governed by the laws of the State of California. Any litigation arising herein shall be brought in the County of El Dorado.

54. Contract Administrator

The County Officer or employee with responsibility for administering this Agreement is , Community Development Agency, Transportation Division, or successor.

55. Authorized Signatures

The parties to this Agreement warrant and represent that the undersigned individuals executing this Agreement on their respective behalves are fully authorized to do so by law or other appropriate instrument and to bind upon said parties the obligations set forth herein.

56. Partial Invalidity

If any provision, part of a provision, sentence, or word of this Agreement is held by a court of competent jurisdiction to be invalid, void or unenforceable, the remaining provisions, parts of provisions, sentences, and words will continue in full force and effect without being impaired or invalidated in any way.

57. No Third Party Beneficiaries

Nothing in this Agreement is intended, nor will be deemed, to confer rights or remedies upon any person or legal entity not a party to this Agreement.

58. Counterparts

This Agreement may be executed in one or more counterparts, each of which shall be an original and all of which together shall constitute one and the same instrument.

59. Entire Agreement

This document and the documents referred to herein or exhibits hereto are the entire Agreement between the parties and they incorporate or supersede all prior written or oral agreements or understandings.

SAMPLE

Contract Administrator Concurrence:

By: _____

Dated: _____

Transportation Division
Community Development Agency

Requesting Division Concurrence

By: _____

Dated: _____

Bard R. Lower
Transportation Division Director
Community Development Agency

Requesting Department Concurrence:

By: _____

Dated: _____

Roger Niello, Interim Director
Community Development Agency

SAMPLE

IN WITNESS WHEREOF, the parties hereto have executed this Agreement on the dates indicated below, the latest of which shall be deemed to be the effective date of this Agreement.

-- COUNTY OF EL DORADO --

By: _____

Dated: _____

Board of Supervisors
"County"

Attest:
James S. Mitrison
Clerk of the Board of Supervisors

By: _____
Deputy Clerk

Dated: _____

-- CONTRACTOR --

By: _____

Dated: _____

President
"Contractor"

By: _____

Dated: _____

Corporate Secretary



State of California - Department of Fish and Wildlife
2017 ENVIRONMENTAL FILING FEE CASH RECEIPT
 DFW 753.5a (Rev. 01/01/17) Previously DFG 753.5a

Print **StartOver** **Finalize&Email**

RECEIPT NUMBER:
 09 — 03/02/17 — 20
 STATE CLEARINGHOUSE NUMBER (If applicable)

SEE INSTRUCTIONS ON REVERSE. TYPE OR PRINT CLEARLY.

LEAD AGENCY EL DORADO COUNTY DEPT OF TRANSPORTATION	LEAD AGENCY EMAIL	DATE 03/02/17
COUNTY/STATE AGENCY OF FILING El Dorado	DOCUMENT NUMBER 09-2017-20	

PROJECT TITLE
TAHOMA MICRO-SURFACING PROJECT

PROJECT APPLICANT NAME DONNA KEELER	PROJECT APPLICANT EMAIL	PHONE NUMBER (530) 621-3829
PROJECT APPLICANT ADDRESS 2850 FAIRLANE CT	CITY PLACERVILLE	STATE CA
		ZIP CODE 95667

PROJECT APPLICANT (Check appropriate box)

Local Public Agency School District Other Special District State Agency Private Entity

CHECK APPLICABLE FEES:

<input type="checkbox"/> Environmental Impact Report (EIR)	\$3,078.25	\$	0.00
<input type="checkbox"/> Mitigated/Negative Declaration (MND)(ND)	\$2,216.25	\$	0.00
<input type="checkbox"/> Certified Regulatory Program document (CRP)	\$1,046.50	\$	0.00

- Exempt from fee
- Notice of Exemption (attach)
 - CDFW No Effect Determination (attach)
 - Fee previously paid (attach previously issued cash receipt copy)

<input type="checkbox"/> Water Right Application or Petition Fee (State Water Resources Control Board only)	\$850.00	\$	0.00
<input type="checkbox"/> County documentary handling fee		\$	50.00
<input type="checkbox"/> Other		\$	

PAYMENT METHOD:

- Cash Credit Check Other

TOTAL RECEIVED \$ 50.00

SIGNATURE 	AGENCY OF FILING PRINTED NAME AND TITLE MELISSA FISHER, DEPUTY
---------------	---

CEQA Notice of Exemption

To: County of El Dorado, Recorder-Clerk's Office
360 Fair Lane
Placerville, CA 95667

From: El Dorado County
Department of Transportation
2850 Fairlane Court
Placerville, CA 95667

Project Title: Tahoma Micro-Surfacing Project.

Project Location – Specific: This project is located in the community of Tahoma on the west side of Lake Tahoe, adjacent to Highway 89 southwest of the Placer County line.

Project Location – City: Unincorporated

Project Location – County: El Dorado

Description of Project:

The Tahoma Community Micro-Surfacing Project includes placement of composite material and shoulder backing to meet the new edge of pavement. Micro-surfacing is being applied as a maintenance treatment to improve the functional characteristics of the pavement surface. The project limits are from the Placer County line to the east, north to Lake Tahoe, east to Quiet Avenue and Sugar Pine Point State Park, south to U.S Forest Service Lands boundary. The total area is approximately 1 square mile, totaling approximately 294,000 square yards of micro-surfacing material. The existing pavement width to be rehabilitated varies from 40 to 70 ft. No trees or ditches will be affected by this activity. The project will require lane closures but no road closure is anticipated. Duration of construction activity is anticipated to be approximately 2 months (40 working days).

Name of Public Agency Approving Project: El Dorado County Department of Transportation

Name of Person or Agency Carrying Out Project: El Dorado County Department of Transportation

Exempt Status: (check one)

- Ministerial (Sec. 21080(b)(1); 15268);
- Declared Emergency (Sec. 21080(b)(3); 15269(a);
- Emergency Project (Sec. 21080(b)(4); 15269(b)(c);
- Categorical Exemption. State type and section number: Sec. 15301, Class 1(c) and (d)
- Statutory Exemption: State Code Number: _____

FILED
MAR 02 2017
WILLIAM SCHULTZ, Recorder-Clerk
By: *[Signature]*

Reasons why project is exempt:

The work consists of minor alteration, repair and replacement of an existing public facility involving negligible expansion of use beyond that existing at the time of this determination. The work would result in minor modification to existing facilities to improve and maintain the existing pavement and shoulder.

Lead Agency

Contact Person: Donna Keeler, Senior Planner **Phone:** 530-621-3829

Signature: *[Signature: Donna Keeler]*

Date: 3-1-2017

EXHIBIT A

PROJECT SPECIFICATIONS

Your attention is directed to California Public Contract Code 9204, which describes procedures for the resolution of claims on public works projects. Among other things, section 9204 requires the claimant to furnish reasonable documentation to support a claim, requires public entity to respond to the claim within 45 days of receipt of the claim, and allows for claimant to demand an informal meet and confer conference for settlement of the issues in dispute. For any portion of a claim that remains in dispute, section 9204 requires submission of the claim to nonbinding mediation. Additionally, section 9204 requires the public entity to make any payment due on any undisputed portion of the claim within 60 days of the public entity's written response and to pay interest at the rate of 7 percent per annum on any amounts not paid in a timely manner. The claims procedures described within the Contract Documents (including, but not limited to, Sections 5-1.43 and 9-1.17 of the 2015 Standard Specifications) are in addition to the procedures required by section 9204 and, in the event of a conflict between those various procedures, the most stringent procedures will control.

The work, in general, includes the following:

- Five (5) day advance notification for residents on each affected roadway. Advance notification includes placing door hangers with a description of the Project on every residence affected by the Project; and
- All work required to provide traffic control (reversing controls) in accordance with the most current requirements of the Manual of Uniform Traffic Control Devices (MUTCD). Reversing controls are allowed on local roads between 7:00 am and 6:00 pm on weekdays; and
- All work required to furnish and place micro-surfacing as described below in the Project Specifications.

The dimensions of each roadway section are listed in Exhibit B. Exhibit C shows the approximate locations of the roadway sections requiring micro-surfacing. The total area to be micro-surfaced is 2,639,842 SQFT.

All micro-surfacing specifications shall be in accordance with the most recent California Department of Transportation Standard Specifications Chapter 37:

37-3 SLURRY SEALS AND MICRO-SURFACINGS

37-3.01 GENERAL

37-3.01A General

37-3.01A(1) Summary

Section 37-3.01 includes general specifications for applying slurry seals and micro-surfacings.

37-3.01A(2) Definitions

Reserved

37-3.01A(3) Submittals

At least 15 days before starting placement of a slurry seal or micro-surfacing, submit:

1. Samples for:
 - 1.1. Asphaltic emulsion slurry seal, two 1-quart wide mouth plastic containers with screw top lid of asphaltic emulsion
 - 1.2. Polymer modified asphaltic emulsion slurry seal, two 1-quart wide mouth plastic containers with screw top lid of polymer modified asphaltic emulsion
 - 1.3. Micro-surfacing, two 1-quart wide mouth plastic containers with screw top lid of micro-surfacing emulsion

2. Asphaltic emulsion, polymer modified asphaltic emulsion, or micro-surfacing emulsion data as follows:
 - 2.1. Supplier and Type/Grade of asphaltic emulsion
 - 2.2. Type of modifier polymer for polymer modified asphaltic emulsion or micro-surfacing emulsion
 - 2.3. Copy of the specified test results for asphaltic emulsion, polymer modified asphaltic emulsion, or micro-surfacing emulsion
3. 50 lb of aggregate
4. Aggregate test results for the followings:
 - 4.1. Gradation
 - 4.2. Los Angeles Rattler
 - 4.3. Percent of crushed particles
 - 4.4. Sand equivalent
 - 4.5. Durability

At least 10 days before starting placement of a slurry seal or micro-surfacing, submit a laboratory report of test results and the proposed mix design from an authorized laboratory. The authorized laboratory must sign the laboratory report and mix design.

The report must include:

1. Test results used in the mix design compared with specification requirements
2. Proportions based on the dry weight of aggregate, including ranges, for:
 - 2.1. Aggregate
 - 2.2. Water
 - 2.3. Additives
 - 2.4. Mineral filler
 - 2.5. Slurry seal emulsion or micro-surfacing emulsion residual asphalt content
3. Recommended changes to the proportions based on heating the mixture to 100 degrees F and mixing for 60 seconds, if atmospheric temperatures during application will be 90 degrees F or above, for:
 - 3.1. Water
 - 3.2. Additives
 - 3.3. Mineral filler
4. Quantitative moisture effects on the aggregate's unit weight determined under ASTM C29M

If the mix design consists of the same materials covered by a previous laboratory report, you may submit the previous laboratory report that must include material testing data performed within the previous 12 months for authorization.

If you change any of the materials in the mix design, submit a new mix design and laboratory report at least 10 days before starting slurry seal or micro-surfacing work.

Submit a certificate of compliance as specified for asphaltic emulsion in section 94-1.01C with each shipment of asphaltic emulsion, polymer modified asphaltic emulsion or micro-surfacing emulsion.

Submit quality control test results for the quality characteristics within the reporting times allowance after sampling shown in the following table:

Quality Control Test Reporting Requirements

Quality characteristic	Maximum reporting time allowance
Los Angeles Rattler loss (max, %)	2 business days
Percent of crushed particles (min, %)	2 business days
Durability (min)	2 business days
Resistance of fine aggregate to degradation by abrasion in the Micro-Deval Apparatus (% loss by weight)	2 business days
Gradation (% passing by weight)	48 hours
Sand equivalent (min)	48 hours
Moisture content (%)	48 hours

Within 3 days after taking asphaltic emulsion, polymer modified asphaltic emulsion or micro-surfacing emulsion quality control samples, submit the authorized laboratory's test results.

37-3.01A(4) Quality Assurance

37-3.01A(4)(a) General

Your authorized laboratory must be able to perform International Slurry Surfacing Association tests and mix design.

37-3.01A(4)(b) Quality Control

37-3.01A(4)(b)(i) General

Reserved

37-3.01A(4)(b)(ii) Aggregate

For aggregate, the authorized laboratory must perform sampling and testing at the specified frequency and location for the following quality characteristics:

Aggregate Quality Control

Quality characteristic	Test method	Minimum sampling and testing frequency	Location of sampling
Los Angeles Rattler loss (max, %) At 500 revolutions	California Test 211	1st day of production	See California Test 125
Percent of crushed particles (min, %)	AASHTO T 335	1st day of production	See California Test 125
Sand equivalent (min)	California Test 217	1 per working stockpile per day	See California Test 125
Resistance of fine aggregate to degradation by abrasion in the Micro-Deval Apparatus (% loss by weight)	ASTM D7428	1 per working stockpile per day	See California Test 125
Gradation (% passing by weight)	California Test 202	1 per working stockpile per day	See California Test 125
Moisture content, from field stockpile (%)	AASHTO T 255 ^a	1 per working stockpile per day	See California Test 125

^aTest aggregate moisture at field stockpile every 2 hours if you are unable to maintain the moisture content to within a maximum daily variation of ±0.5 percent.

37-3.01A(4)(b)(iii) Slurry Seals and Micro-surfacings

Reserved

37-3.01A(4)(c) Department Acceptance

Slurry Seal and micro-surfacing acceptance is based on:

1. Visual inspection for the following:
 - 1.1. Uniform surface texture throughout the work limits.
 - 1.2. Marks in the surface:
 - 1.2.1. Up to 4 marks in the completed slurry seal or micro-surfacing surface that are up to 1 inch wide and up to 6 inches long per 1000 square feet of slurry seal or micro-surfacing placed.
 - 1.2.2. No marks in the completed slurry seal or micro-surfacing surface that are over 1 inch wide or 6 inches long.
 - 1.3. Excessive raveling consisting of the separation of the aggregate from the asphaltic emulsion, polymer modified asphaltic emulsion or micro-surfacing emulsion.
 - 1.4. Bleeding consists of the occurrence of a film of asphaltic material on the surface of the slurry seal or micro-surfacing.
 - 1.5. Delaminating of slurry seal or micro-surfacing from the existing pavement.
 - 1.6. Rutting or wash-boarding.
2. Department's sampling and testing for compliance with the requirements for aggregate shown in the following table:

Aggregate Gradation Acceptance Criteria

Quality characteristic	Test method	Requirements		
Gradation (% passing by weight) Sieve Size:	California Test 202	Type I	Type II	Type III
3/8"		--	100	100
No. 4		100	94-100	70-90
No. 8		90-100	65-90	45-70
No. 16		60-90	40-70	28-50
No. 30		40-65	25-50	19-34
No. 200		10-20	5-15	5-15

An aggregate gradation test represents 300 tons or 1 day's production, whichever is less.

If test results for aggregate gradation do not comply with the specifications, you may remove the slurry seal or micro-surfacing represented by the test results or request it remain in place with a payment deduction. If your request is authorized, the Department deducts:

1. \$1.75 per ton of slurry seal for each noncompliant aggregate gradation
2. \$2.00 per ton of micro-surfacing for each noncompliant aggregate gradation

37-3.01B Materials

37-3.01B(1) General

Additional water must not cause separation of the asphaltic emulsion, polymer modified asphaltic emulsion or micro-surfacing emulsion from the aggregate before placement.

You may use an additive that does not adversely affect the slurry seal or micro-surfacing.

37-3.01B(2) Aggregate

Aggregate must be rock dust. Aggregate must be free from vegetable matter, deleterious substances, caked or clay lumps, and oversized particles.

Aggregate for a slurry seal and micro-surfacing must comply with the gradations shown in the following table:

Aggregate Gradation

Quality characteristic	Test method	Requirements		
		Type I	Type II	Type III
Gradation (% passing by weight) Sieve size:	California Test 202	Type I	Type II	Type III
3/8"		--	100	100
No. 4		100	94–100	70–90
No. 8		90–100	65–90	45–70
No. 16		60–90	40–70	28–50
No. 30		40–65	25–50	19–34
No. 200		10–20	5–15	5–15

37-3.01C Construction

37-3.01C(1) General

Before applying slurry seals or micro-surfacings, cover manholes, valve and monument covers, grates, and other exposed facilities located within the area of application using plastic or oil resistant construction paper secured by tape or adhesive to the facility being covered. Reference the covered facilities with enough control points to relocate the facilities after application of the slurry seals or micro-surfacings.

37-3.01C(2) Proportioning

Proportion slurry seal and micro-surfacing ingredients in compliance with the authorized mix design.

37-3.01C(3) Mixing and Spreading Equipment

37-3.01C(3)(a) General

Mixing and spreading equipment for slurry seals and micro-surfacings must proportion the asphaltic emulsions, water, aggregate, and any additives by volume and mix them in continuous pug mill mixers.

Introduce emulsions into the mixer with a positive displacement pump. If you use a variable-rate pump, the adjusting unit must be sealed in its calibrated position.

Introduce water into the mixer through a meter that measures gallons.

Choose a truck mounted mixer-spreader or continuous self-loading mixer spreader.

37-3.01C(3)(b) Truck Mounted Mixer Spreaders

Truck mounted mixer spreaders must comply with:

1. Rotating and reciprocating equipment must be covered with metal guards.
2. Proportion aggregate using a belt feeder with an adjustable cutoff gate. The Engineer verifies the height of the gate opening.
3. Belt feeder must have a depth monitor device. The depth monitor device must automatically shut down power to the belt feeder when the aggregate depth is less than 70 percent of the target depth.
4. Separate monitor device must detect the revolutions of the belt feeder. This device must automatically shut down power to the belt feeder if it detects no revolutions. If the belt feeder is an integral part of the equipment's drive chain, the monitor device is not required.
5. Aggregate belt feeder must be connected directly to the drive on the emulsion pump. The aggregate feeder drive shaft must have a revolution counter reading the nearest 0.10 revolution for micro-surfacing, and nearest 1 revolution for slurry seal.
6. Emulsion storage must be equipped with a device that automatically shuts down power to the emulsion pump and aggregate belt feeder when the level of stored emulsion is lowered. To allow for normal fluctuations, there may be a delay of 3 seconds between detection of low emulsion storage levels or low aggregate depths and automatic power shut down.
7. Emulsion storage must be located immediately before the emulsion pump.
8. Emulsion storage tank must have a temperature indicator at the pump suction level. The indicator must be accurate to ±5 degrees F.

9. No-flow and revolution warning devices must be in working condition. Low-flow indicators must be visible while walking alongside the equipment.

37-3.01C(3)(c) Continuous Self-Loading Mixer Spreaders

Continuous self-loading mixer spreaders must be automatically sequenced and self-propelled. The mixing machine must deliver each material to a double shafted mixer and discharge the mixed material on a continuous flow basis. The mixing machines must have sufficient storage capacity to maintain a continuous supply of material to the proportioning controls. The mixing machine operators must have full control of forward and reverse speeds during placement.

37-3.01C(3)(d) Spreader Boxes

The spreader boxes used to spread slurry seals and micro-surfacings must be:

1. Capable of spreading the slurry seal or micro-surfacing a minimum of 12 feet wide and preventing the loss of slurry seal or micro-surfacing.
2. Equipped with flexible rubber belting on each side. The belting must contact the pavement to prevent the loss of slurry seal or micro-surfacing from the box.
3. Equipped to uniformly apply the slurry seal or micro-surfacing on superelevated sections and shoulder slopes. Micro-surfacing spreader box must be equipped with reversible motor driven augers.
4. Equipped with a series of strike-off devices at its rear.
 - 4.1. The leading strike off device must be:
 - 4.1.1. Fabricated of a suitable material such as steel or stiff rubber
 - 4.1.2. Designed to maintain close contact with the pavement during spreading
 - 4.1.3. Capable of obtaining the specified thickness
 - 4.1.4. Capable of being adjusted to the various pavement cross sections
 - 4.2. The final strike-off device must be:
 - 4.2.1. Fabricated of flexible material that produces a uniform texture in the finished surface
 - 4.2.2. Cleaned daily and changed if longitudinal scouring occurs in the slurry seal or micro-surfacing
5. Clean and free of slurry seal or micro-surfacing at the start of each work shift.

37-3.01C(3)(e) Shoulder Equipment

Spread the slurry seal or micro-surfacing on shoulders with a device such as an edge box that forms clean and straight joints and edges.

37-3.01C(3)(f) Equipment Calibration

Equipment calibration must comply with the *MPQP*. Notify the Engineer at least 5 business days before calibrating.

If the Department authorizes a truck or continuous mixer spreader, its calibration is valid for 6 months provided you:

1. Use the same truck or continuous mixer spreader verified with a unique identifying number
2. Use the same materials in compliance with the authorized mix design
3. Do not perform any repair or alteration to the proportioning systems

Calibrate the adjustable cut-off gate settings of each truck or continuous mixer spreader on the project to achieve the correct delivery rate of aggregate and emulsion per revolution of the aggregate feeder under the *MPQP*.

Checks must be performed for each aggregate source using an authorized vehicle scale.

Individual checks of the aggregate belt feeder's delivery rate to the pug mill mixer must not vary more than 2 percent from the average of 3 runs of at least 3 tons each.

Before using a variable-rate emulsion pump, the pump must be calibrated and sealed in the calibrated condition under the *MPQP*.

Individual checks of the emulsion pump's delivery rate to the pug mill mixer must not vary more than 2 percent from the average of 3 runs of at least 500 gal each.

37-3.01C(4) Surface Preparation

Immediately before applying slurry seals or micro-surfacings, clean the surface to receive slurry seals or micro-surfacings by removing any extraneous material affecting adhesion of the slurry seal or micro-surfacing with the existing surface. Use self-propelled power brooms or other methods such as flushing to clean the existing pavement.

37-3.01C(5) Placement

37-3.01C(5)(a) General

If truck-mounted mixer-spreaders are used, keep at least 2 operational spreaders at the job site during placement.

Spread slurry seals and micro-surfacings uniformly and do not spot, rehandle, or shift the mixture. However in areas inaccessible to spreading equipment, spread the slurry seal or micro-surfacing mixtures with hand tools or other authorized methods. If placing with hand tools, lightly dampen the area first.

You may fog the roadway surface with water ahead of the spreader box. The fog spray must be adjusted for pavement:

1. Temperature
2. Surface texture
3. Dryness

You determine the application rates for slurry seals or micro-surfacings and the Engineer authorizes the application rates. Spread within 10 percent of authorized rate.

The mixtures must be uniform and homogeneous after spreading, and there must not be separation of the emulsion and aggregate after setting.

37-3.01C(5)(b) Weather Conditions

Only place slurry seals or micro-surfacings if both the pavement and air temperatures are at least 50 degrees F and rising. The expected high temperature must be at least 65 degrees F within 24 hours after placement.

Do not place slurry seals or micro-surfacings if rain is imminent or the air temperature is expected to be below 36 degrees F within 24 hours after placement.

37-3.01C(5)(c) Joints

Transverse and longitudinal joints must be:

1. Uniform
2. Straight
3. Neat in appearance
4. Without material buildup
5. Without uncovered areas

Transverse joints must be butt-type joints.

Prevent double placement at transverse joints over previously placed slurry seals or micro-surfacings.

Place longitudinal joints:

1. On centerlines, lane lines, edge lines, or shoulder lines
2. With overlaps not more than 4 inches

You may request other longitudinal joint patterns if they do not adversely affect the slurry seals or micro-surfacings.

The maximum difference between the pavement surface and the bottom edge of a 12-foot straightedge placed perpendicular to the longitudinal joint must be 0.04 foot.

37-3.01C(5)(d) Finished Surfaces

Finished slurry seals or micro-surfacings must be smooth and free of irregularities such as scratch or tear marks. You may leave up to 4 marks that are up to 1 inch wide and 6 inches long per 75 linear feet of slurry seal or micro-surfacing placed. Do not leave any marks that are over 1 inch wide or 6 inches long.

37-3.01C(5)(e) Maintenance Sweeping

Sweep the slurry seals or micro-surfacings 24 hours after placement without damaging the slurry seals or micro-surfacings. For 4 days afterwards, sweep the slurry seals or micro-surfacings daily unless determined otherwise by the Engineer.

37-3.01C(5)(f) Repair of Early Distress

The slurry seals or micro-surfacings must not show bleeding, raveling, separation, or other distresses for 15 days after placing. If bleeding, raveling, delaminating, rutting, or wash-boarding occurs after placing the slurry seals or micro-surfacings, make repairs using an authorized method.

37-3.01D Payment

Not Used

37-3.03 MICRO-SURFACINGS

37-3.03A General

37-3.03A(1) Summary

Section 37-3.03 includes specifications for applying micro-surfacings.

Applying a micro-surfacing consists of spreading a mixture of a micro-surfacing emulsion, water, additives, mineral filler, and aggregate on the pavement.

37-3.03A(2) Definitions

Reserved

37-3.03A(3) Submittals

Immediately after sampling, submit two 1-quart wide mouth plastic containers of micro-surfacing emulsion taken in the presence of the Engineer. Samples must be submitted in insulated shipping container.

37-3.03A(4) Quality Assurance

37-3.03A(4)(a) General

Reserved

37-3.03A(4)(b) Quality Control

37-3.03A(4)(b)(i) General

Reserved

37-3.03A(4)(b)(ii) Micro-surfacing Emulsions

Take samples from the truck tank at mid load from a sampling tap or thief. Before taking samples, draw and dispose of 1 gallon. In the presence of the Engineer, take two 1-quart wide mouth plastic containers for acceptance testing.

For a micro-surfacing emulsion, the authorized laboratory must perform quality control sampling and testing at the specified frequency and location for the quality characteristics shown in the following table:

Micro-Surfacing Emulsion

Quality characteristic	Test method	Minimum sampling and testing frequency	Sampling location
Tests on emulsion:			
Saybolt Furol Viscosity, at 25°C (Saybolt Furol seconds)	AASHTO T 59	Minimum 1 per day per delivery truck	Delivery truck
Storage stability, 1 day (max, %) ^a			
Sieve test (max, %)			
Residue by evaporation (min, %)	California Test 331	Minimum 1 per day per delivery truck	Delivery truck
Tests on residue from evaporation test:			
Penetration at 25 °C	AASHTO T 49	Minimum 1 per day per delivery truck	Delivery truck
Softening point (min, °C)	AASHTO T 53		

^aStorage stability test will be run if the storage exceeds 48 hours

37-3.03A(4)(c) Department Acceptance

For micro-surfacing emulsions, acceptance is based on the Department's sampling and testing for compliance with the requirements shown in the following table:

Micro-surfacing Emulsion Acceptance Criteria

Quality characteristic	Test method	Requirement
Tests on emulsion:		
Saybolt Furol Viscosity at 25 °C (Saybolt Furol seconds)	AASHTO T 59	15–90
Sieve test (%)	AASHTO T 59	0.30
Storage stability, 1 day (max, %)	AASHTO T 59	0–1
Settlement ^a , 5 days (max, %)	ASTM D244	5
Residue by evaporation (min, %)	California Test 331	62
Tests on residue by evaporation:		
Penetration at 25 °C	AASHTO T 49	40–90
Softening point (min, °C)	AASHTO T 53	57

^aSettlement test on emulsion is not required if used within 48 hours of shipment.

Acceptance of aggregate, except mineral filler, is based on the Department's sampling and testing for compliance with the requirements shown in the following table:

Aggregate Acceptance Criteria

Quality characteristic	Test method	Requirement
Los Angeles Rattler loss (max, %) At 500 revolutions	California Test 211 ^a	35
Percent of crushed particles (min, %)	California Test 205	95
Durability (min)	California Test 229	65
Sand equivalent (min)	California Test 217	
Type II		65
Type III		65

^aCalifornia Test 211 must be performed on the aggregate before crushing. The aggregate supplier must certify that the crushed aggregate being used on the project is manufactured from the source aggregate complying with the LA rattler requirements.

An aggregate sand equivalent test represents 300 tons or 1 day's production, whichever is less.

If the test results for aggregate sand equivalent do not comply with the specifications, you may remove the micro-surfacing represented by the test results or request it remain in place with a payment deduction. If your request is authorized, the Department deducts \$2.00 per ton of micro-surfacing for each noncompliant aggregate sand equivalent test.

37-3.03B Materials

37-3.03B(1) General

Reserved

37-3.03B(2) Micro-surfacing Emulsions

A micro-surfacing emulsion must be a homogeneous mixture of asphalt, an elastomeric polymer and an emulsifier solution.

Add an elastomeric polymer modifier to asphalt or emulsifier solution before emulsification. An elastomeric polymer solid must be a minimum of 3 percent by weight of the micro-surfacing emulsion's residual asphalt.

A micro-surfacing emulsion must comply with the requirements shown in the following table:

Micro-surfacing Emulsion Requirements

Quality characteristic	Test method	Requirement
Tests on emulsion:		
Saybolt Furol Viscosity at 25 °C (Saybolt Furol seconds)	AASHTO T 59	15–90
Sieve test (%)	AASHTO T 59	0.30
Storage stability, 1 day (max, %)	AASHTO T 59	0–1
Settlement ^a , 5 days (max, %)	ASTM D244	5
Residue by evaporation (min, %)	California Test 331	62
Tests on residue by evaporation:		
Penetration at 25 °C	AASHTO T 49	40–90
Softening point (min, °C)	AASHTO T 53	57

^aSettlement test on emulsion is not required if used within 48 hours of shipment.

37-3.03B(3) Aggregate

Aggregate must comply with the quality characteristic requirements shown in the following table:

Aggregate Requirements

Quality characteristic	Test method	Requirement
Los Angeles Rattler loss (max, %) At 500 revolutions	California Test 211 ^a	35
Percent of crushed particles (min, %)	California Test 205	95
Durability (min)	California Test 229	65
Sand equivalent (min)	California Test 217	
Type II		65
Type III		65

^aCalifornia Test 211 must be performed on the source aggregate before crushing. The aggregate supplier must certify that the crushed aggregate being used on the project is manufactured from the source aggregate complying with the LA rattler requirements.

37-3.03B(4) Mineral Fillers

If a mineral filler is used, it must be type I or type II Portland cement. A mineral filler used during mix design must be used during production.

37-3.03B(5) Micro-Surfacing Mix Designs

The micro-surfacing mix design must have the material proportion limits shown in the following table:

Micro-surfacing Mix Design Proportion Limits

Material	Proportion limits
Micro-surfacing emulsion asphalt residual content (% of dry weight of aggregate)	5.5–10.5
Water and additives	As Required
Mineral filler (% of dry weight of aggregate)	0–3

The micro-surfacing mix design must comply with the requirements shown in the following table:

Micro-surfacing Mix Design Requirements

Quality characteristics	Test method ^a	Requirement
Wet cohesion At 30 minutes (set) (min, kg-cm) At 60 minutes (traffic) (min, kg-cm)	Technical Bulletin 139	12 20
Excess asphalt (max, g/m ²)	Technical Bulletin 109	540
Wet stripping (min, %)	Technical Bulletin 114	90
Wet track abrasion loss 6-day soak (max, g/m ²)	Technical Bulletin 100	810
Displacement Lateral (max, %) Specific gravity after 1000 cycles of 57 kg (max)	Technical Bulletin 147A	5 2.10
Classification compatibility (min, grade points)	Technical Bulletin 144	(AAA, BAA) 11
Mix time at 25 °C (min)	Technical Bulletin 113	Controllable to 120 seconds

^aTest methods are by the International Slurry Surfacing Association.

37-3.03B(6) Tack Coats

If there is a bid item for tack coat, you must coat the pavement surface with an asphaltic emulsion mixed with additional water before applying a micro-surfacing. The maximum ratio of water to asphaltic emulsion must be 2 to 1. Apply the tack coat at a rate from 0.08 to 0.15 gal/sq yd. The exact rate must be authorized.

You determine the grade of slow-setting or quick setting asphaltic emulsion to be used.

37-3.03C Construction

37-3.03C(1) General

Reserved

37-3.03C(2) Proportioning

Field conditions may require adjustments to the proportions within the authorized mix design during construction.

37-3.03C(3) Mixing and Spreading Equipment

37-3.03C(3)(a) General

Reserved

37-3.03C(3)(b) Scratch Course Boxes

Spread the scratch courses with the same type of spreader box used to spread micro-surfacings except use an adjustable steel strike-off device instead of a final strike-off device.

37-3.03C(3)(c) Wheel Path Depression Boxes

Each wheel path depression box must have adjustable strike-off device between 5 and 6 feet wide to regulate depth. The wheel path depression box must also have devices such as hydraulic augers capable of:

1. Moving the mixed material from the rear to the front of the filling chamber
2. Guiding larger aggregate into the deeper section of the wheel path depression
3. Forcing the finer material towards the outer edges of the spreader box

37-3.03C(4) Test Strips

If micro-surfacing placement will require more than 1 day, you must construct a test strip. The test strip must be:

1. From 300 to 450 feet long
2. The same as the full production micro-surfacing
3. On 1 of the application courses specified at an authorized location
4. At the same time of day or night the full production micro-surfacing is to be applied

If multiple application courses are specified, you may construct test strips over 2 days or nights.

The Engineer evaluates the test strip after traffic has used it for 12 hours. If the Engineer determines the mix design or placement procedure is unacceptable, make modifications and construct a new test strip for the Engineer's evaluation.

37-3.03C(5) Placement

37-3.03C(5)(a) General

Reserved

37-3.03C(5)(b) Repair Wheel Path Depressions

If repairing wheel path depressions is shown in plans, fill wheel path depressions and irregularities with micro-surfacing material before spreading micro-surfacing. If the depressions are less than 0.04 foot deep, fill with a scratch course. If the depressions are 0.04 foot deep or more, fill the depressions using a wheel path depression box.

Spread scratch courses by adjusting the steel strike-off of a scratch course box until it is directly in contact with the pavement surface.

Spread micro-surfacings with a wheel path depression box leaving a slight crown at the surface. Use multiple applications to fill depressions more than 0.12 foot deep. Do not apply more than 0.12 foot in a single application.

Allow traffic to compact each filled wheel path depression for a minimum of 12 hours before placing additional micro-surfacings.

37-3.03C(5)(c) Micro-surfacing Pavement Surfaces

The micro-surfacing spread rates must be within the ranges shown in the following table:

Micro-surfacing type	Application range (lb of dry aggregate/sq yd)
Type II	10–20
Type III ^a	20–32
Type III ^b	30–32

^aOver asphalt concrete pavement

^bOver concrete pavement and concrete bridge decks

Within 2 hours after placement, micro-surfacings must be set enough to allow traffic without pilot cars. Protect the micro-surfacings from damage until it has set and will not adhere or be picked up by vehicle tires. Micro-surfacings must not exhibit distress from traffic such as bleeding, raveling, separation or other distresses.

Exhibit B
Micro-Surfacing Locations

Road Name	Width	Miles	Length(ft)	Sq Feet	Sq Yd
Bayview Ct	26	0.08	422	10982	1220
Bayview Dr	26	0.53	2798	72758	8084
Beach Ln	18	0.12	634	11405	1267
Brook Dr	23	0.26	1373	31574	3508
Chestview Ct	28	0.05	264	7392	821
Cove Way	27	0.06	317	8554	950
Crest Dr	23	0.31	1637	37646	4183
De Lisi Way	22	0.03	158	3485	387
Forest Dr	19	0.18	950	18058	2006
Forest View Dr	19	0.27	1426	27086	3010
Glen Dr	22	0.44	2323	51110	5679
Glenridge Pkwy	17	0.73	3854	65525	7281
Highland Dr	23	0.07	370	8501	945
Highview Dr	23	0.19	1003	23074	2564
King George Dr	20	0.036	190	3802	422
Lakeridge Ct	27	0.1	528	14256	1584
Lakeridge Dr	26	0.2	1056	27456	3051
Manzanita Dr	21	0.29	1531	32155	3573
Meeks Bay Ave	25	1.02	5386	134640	14960
Mountain Dr	20	0.31	1637	32736	3637
Mountain Dr	17	0.1	528	8976	997
Buttermilk	13	0.02	106	1373	153
Co. Rd. 2538	21	0.07	370	7762	862
North Ln	25	0.13	686	17160	1907
Northridge Dr	26	0.29	1531	39811	4423
Rubicon Dr	18	1.14	6019	108346	12038
Saturn Dr	27	0.15	792	21384	2376
Scenic Dr	23	0.55	2904	66792	7421
Sierra Dr	18	0.34	1795	32314	3590
Silvertip Ct	22	0.06	317	6970	774
Silvertip Dr	27	0.15	792	21384	2376
Sunnyview Ln	17	0.49	2587	43982	4887
Sunrise Ave	27	0.27	1426	38491	4277
Sunrise Ct	27	0.27	1426	38491	4277
Sweetwater Ct	26	0.13	686	17846	1983
Sweetwater Dr	26	0.31	1637	42557	4729
Victoria Cir	23	0.31	1637	37646	4183
Victoria Dr	18	0.29	1531	27562	3062
View Cir	21	0.18	950	19958	2218
Williams Ln	23	0.14	739	17002	1889
Winston Way	23	0.07	370	8501	945
Woodland Ct	21	0.06	317	6653	739
Woodland Dr	28	0.53	2798	78355	8706
10th Ave	30	0.77	4066	121968	13552

Exhibit B
Micro-Surfacing Locations

Road Name	Width	Miles	Length(ft)	Sq Feet	Sq Yd
1st Ave	18	0.1	528	9504	1056
2nd Ave	18	0.34	1795	32314	3590
3rd Ave	18	0.34	1795	32314	3590
4th Ave	17	0.15	792	13464	1496
4th Ave	18	0.5	2640	47520	5280
5th Ave	21	0.69	3643	76507	8501
5th Ave	17	0.7	3696	62832	6981
8th Ave	22	0.74	3907	85958	9551
9th	21	0.74	3907	82051	9117
Alder St	26	0.57	3010	78250	8694
Antelope Way	28	0.48	2534	70963	7885
Bear Ave	22	0.38	2006	44141	4905
Bellevue Ave	26	0.19	1003	26083	2898
Chinkapin Rd	26	0.34	1795	46675	5186
Deer Ave	17	0.24	1267	21542	2394
Fir St	23	0.38	2006	46147	5127
Gray Ave	18	0.24	1267	22810	2534
Grizzly Ct	19	0.04	211	4013	446
Harris Ave	19	0.09	475	9029	1003
Hazel St	19	0.13	686	13042	1449
Hilo Ave	27	0.13	686	18533	2059
Kodiak Ct	18	0.03	158	2851	317
Kona St	18	0.02	106	1901	211
Lewis Ave	17	0.22	1162	19747	2194
McKinney Rd	31	0.23	1214	37646	4183
Miami Ave	27	0.16	845	22810	2534
Miami Ct	27	0.04	211	5702	634
Oak St	17	0.17	898	15259	1695
Pine St	23	0.51	2693	61934	6882
Placer St	26	0.35	1848	48048	5339
Poplar St	20	0.06	317	6336	704
Sunkel Ln	18	0.05	264	4752	528
Timberwolf Dr	28	0.55	2904	81312	9035
Wilson Ave	21	0.31	1637	34373	3819
				2,639,842	293316
				Total Sq Feet	Total Sq Yds

Exhibit C
Micro-Surfacing Location Map

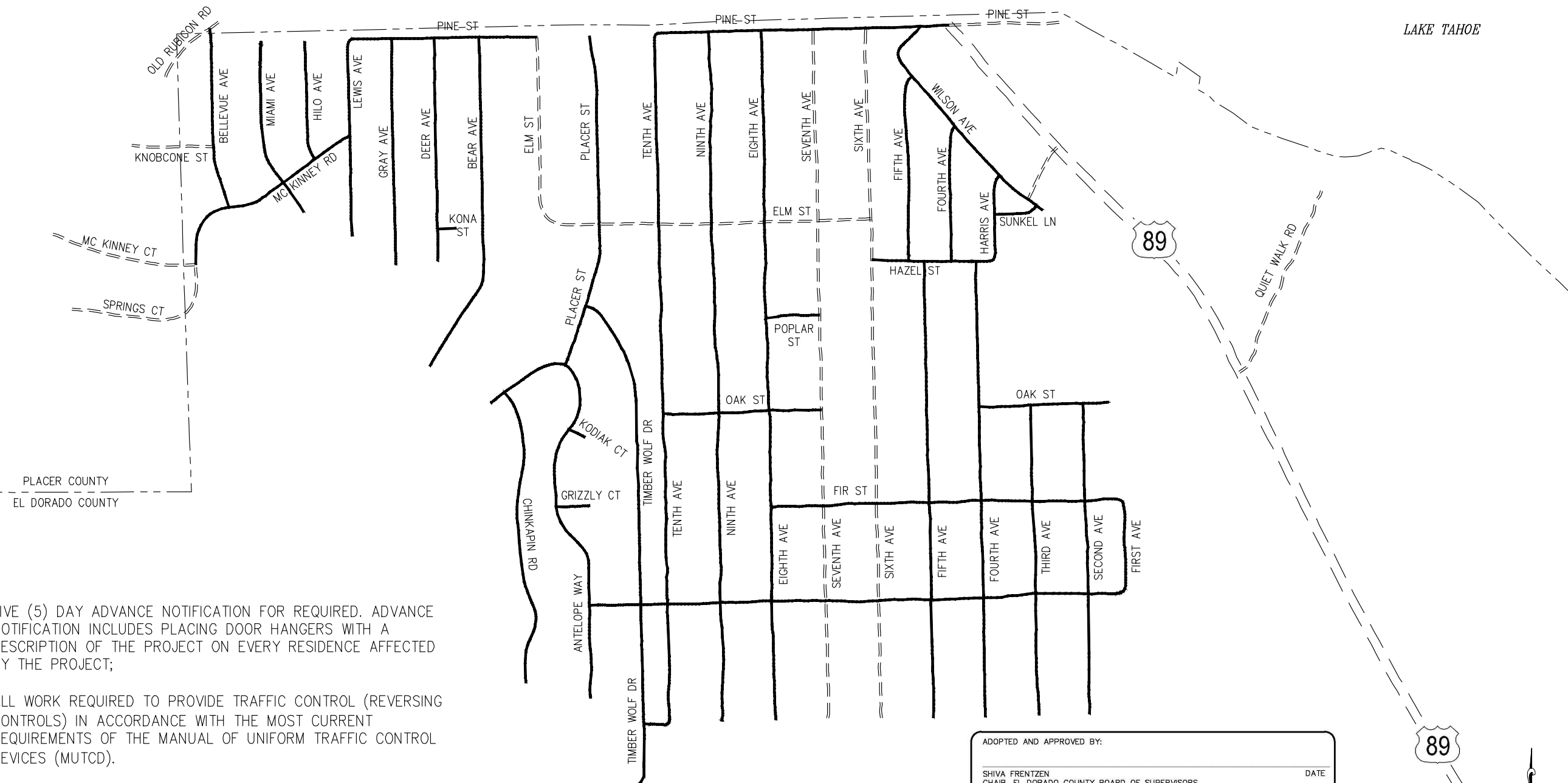

NOTES:

1. FIVE (5) DAY ADVANCE NOTIFICATION FOR REQUIRED. ADVANCE NOTIFICATION INCLUDES PLACING DOOR HANGERS WITH A DESCRIPTION OF THE PROJECT ON EVERY RESIDENCE AFFECTED BY THE PROJECT;
2. ALL WORK REQUIRED TO PROVIDE TRAFFIC CONTROL (REVERSING CONTROLS) IN ACCORDANCE WITH THE MOST CURRENT REQUIREMENTS OF THE MANUAL OF UNIFORM TRAFFIC CONTROL DEVICES (MUTCD).

LEGEND

- PREVIOUS TEST LOCATION
- PROPOSED SURFACE REPAIR

ADOPTED AND APPROVED BY:

SHIVA FRENTZEN
CHAIR, EL DORADO COUNTY BOARD OF SUPERVISORS

APPROVED BY:

ROGER NIELLO, INTERIM DIRECTOR
COMMUNITY DEVELOPMENT AGENCY

JOHN KAHLING P.E. NO. C52426
DEPUTY DIRECTOR, ENGINEERING

DATE _____

DATE _____

DATE _____

PROPOSED REPAIR
SCALE : 1" = 300'

EXHIBIT C



PREPARED UNDER THE SUPERVISION OF :

John Kahling

REGISTERED CIVIL ENGINEER

DATE: 04/07/17

DESIGNED: MAINT DRAWN: DRF

CHECKED: AK DATE: 2/16/2017

ROAD NUMBER:



COUNTY OF EL DORADO
COMMUNITY DEVELOPMENT AGENCY
TRANSPORTATION DIVISION

WEST SHORE ROAD REPAIR

SHEET
L-1
1 OF 3
W.O. No. 49313

FOR REDUCED PLANS ORIGINAL SCALE IS IN INCHES Drawing name: C:\Chil 3D Projects\Tahoe-Chip-Seal.dwg Layout Tab: L-1 Feb 17, 2017 - 3:57pm D\Friestad

Exhibit C
Micro-Surfacing Location Map

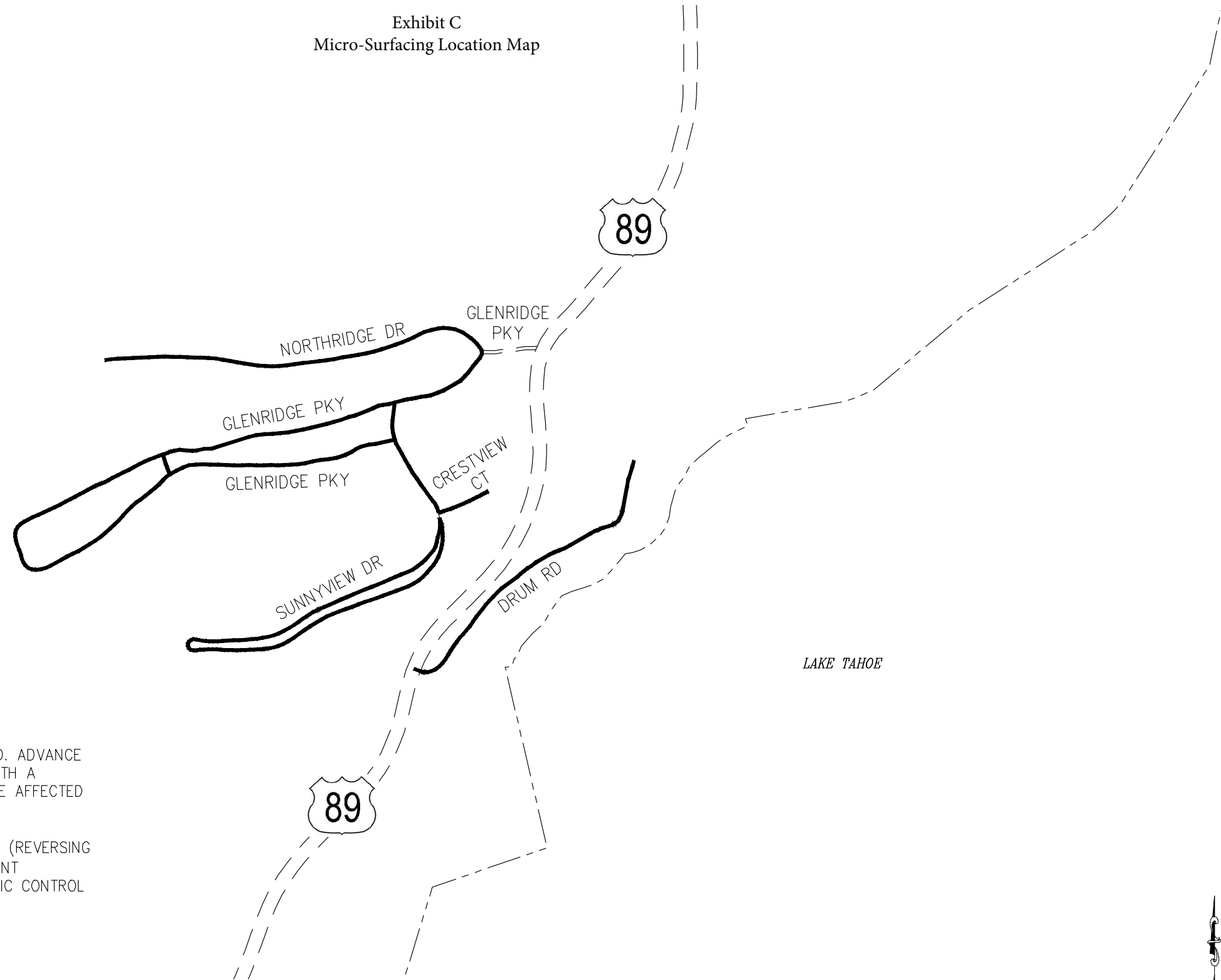

NOTES:

1. FIVE (5) DAY ADVANCE NOTIFICATION FOR REQUIRED. ADVANCE NOTIFICATION INCLUDES PLACING DOOR HANGERS WITH A DESCRIPTION OF THE PROJECT ON EVERY RESIDENCE AFFECTED BY THE PROJECT;
2. ALL WORK REQUIRED TO PROVIDE TRAFFIC CONTROL (REVERSING CONTROLS) IN ACCORDANCE WITH THE MOST CURRENT REQUIREMENTS OF THE MANUAL OF UNIFORM TRAFFIC CONTROL DEVICES (MUTCD).

LEGEND

- PREVIOUS TEST LOCATION
- PROPOSED SURFACE REPAIR

FOR REDUCED PLANS ORIGINAL SCALE IS IN INCHES Drawing name: C:\Chil\3D\Projects\Tahome-Chip-Seal.dwg Layout Tab: L-2 Feb 17, 2017 - 3:57pm DFriedstod

EXHIBIT C

PROPOSED REPAIR
SCALE : 1" = 200'

REVISION	NUMBER	DATE	DESCRIPTION	BY



PREPARED UNDER THE SUPERVISION OF :
John Kahling IV
REGISTERED CIVIL ENGINEER
DATE: 04/07/17

DESIGNED: MAINT
DRAWN: DRF
CHECKED: AK
DATE: 2/16/2017
ROAD NUMBER:



COUNTY OF EL DORADO
COMMUNITY DEVELOPMENT AGENCY
TRANSPORTATION DIVISION

WEST SHORE ROAD REPAIR

SHEET
L-2
2 OF 3
W.O. No. 49313

Exhibit C
Micro-Surfacing Location Map

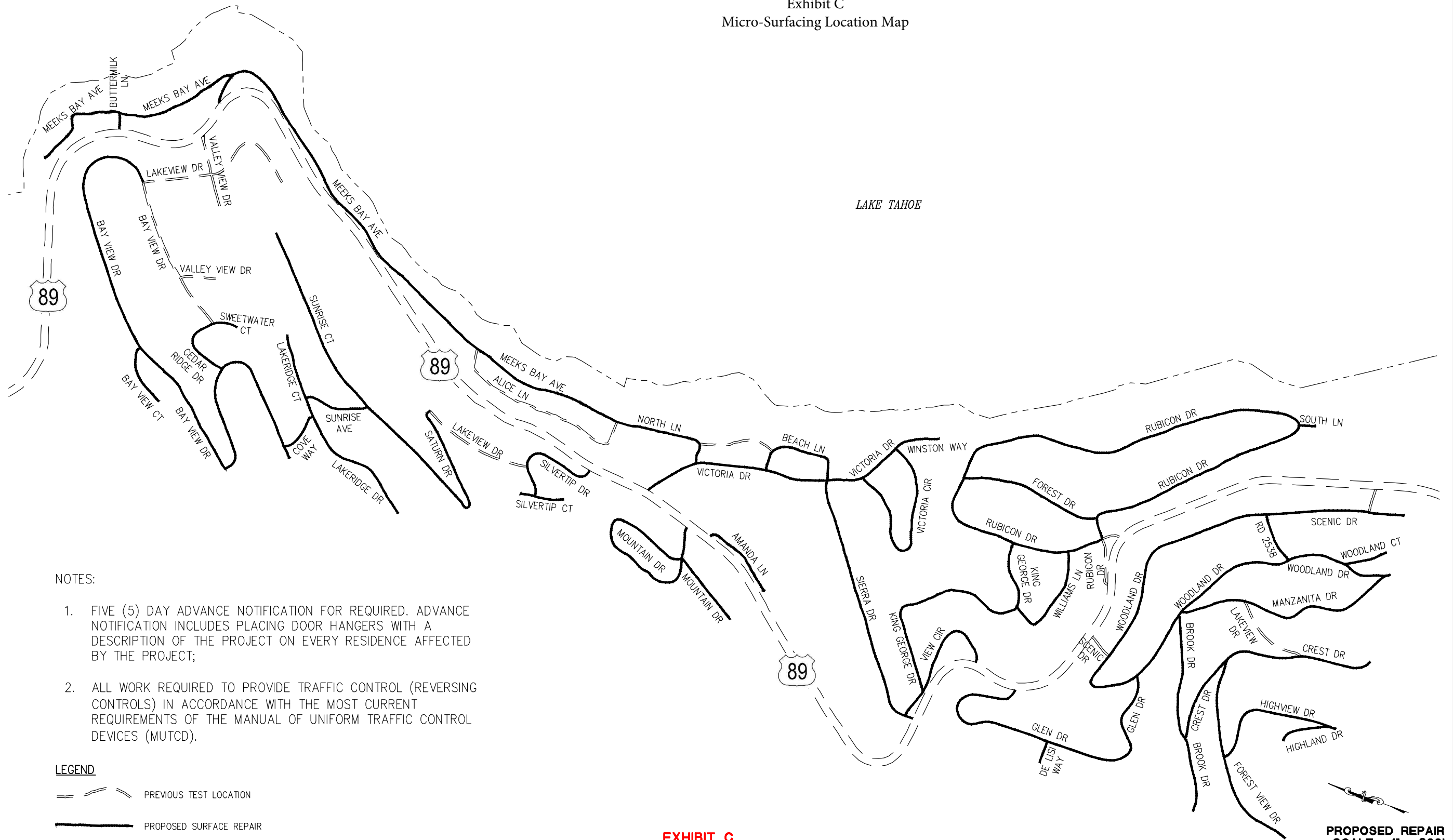

NOTES:

1. FIVE (5) DAY ADVANCE NOTIFICATION FOR REQUIRED. ADVANCE NOTIFICATION INCLUDES PLACING DOOR HANGERS WITH A DESCRIPTION OF THE PROJECT ON EVERY RESIDENCE AFFECTED BY THE PROJECT;
2. ALL WORK REQUIRED TO PROVIDE TRAFFIC CONTROL (REVERSING CONTROLS) IN ACCORDANCE WITH THE MOST CURRENT REQUIREMENTS OF THE MANUAL OF UNIFORM TRAFFIC CONTROL DEVICES (MUTCD).

LEGEND

- PREVIOUS TEST LOCATION
- PROPOSED SURFACE REPAIR

PROPOSED REPAIR
SCALE : 1" = 300'

EXHIBIT C

FOR REDUCED PLANS ORIGINAL SCALE IS IN INCHES Drawing name: C:\Chil 3D Projects\Tahome-Chip-Seal.dwg Layout Tab: L-3 Feb 17, 2017 - 3:56pm DFriedstod

REVISION	NUMBER	DATE	DESCRIPTION	BY



PREPARED UNDER THE SUPERVISION OF:
John Kahling IV
REGISTERED CIVIL ENGINEER
DATE: 04/07/17

DESIGNED: MAINT DRAWN: DRF
CHECKED: AK DATE: 2/16/2017
ROAD NUMBER:



COUNTY OF EL DORADO
COMMUNITY DEVELOPMENT AGENCY
TRANSPORTATION DIVISION

WEST SHORE ROAD REPAIR

SHEET
L-3
3 OF 3
W.O. No. 49313