

RECORDING REQUESTED BY AND  
WHEN RECORDED MAIL TO:

Mark D. Milligan  
Maki Ganno  
P.O. Box 420  
Pollock Pines, CA 95726

\_\_\_\_ Above section for Recorder's use \_\_\_\_\_

Mail Tax Statements to above.  
Exempt from Documentary Transfer Tax  
Per Revenue and Taxation Code 11922

## **QUITCLAIM DEED**

**FOR VALUABLE CONSIDERATION**, receipt of which is hereby acknowledged, the **COUNTY OF EL DORADO**, a political subdivision of the State of California does hereby remise, release, and forever quitclaim to **MARK D. MILLIGAN AND MAKI GANNO, HUSBAND AND WIFE, AS JOINT TENANTS**, all that real property interest situate in the unincorporated area of the County of El Dorado, State of California, described as:

**DESCRIBED IN EXHIBIT 'A' AND DEPICTED IN EXHIBIT 'B' ATTACHED HERETO AND MADE A PART HEREOF, WHICH DESCRIPTION IS BY THIS REFERENCE INCORPORATED HEREIN.**

**GRANTOR:**

**COUNTY OF EL DORADO**

Date: \_\_\_\_\_

By: \_\_\_\_\_  
Ron Briggs, Chairman of the Board  
Board of Supervisors

ATTEST: Suzanne Allen de Sanchez  
Clerk of the Board of Supervisors

By: \_\_\_\_\_

**EXHIBIT 'A'**  
**LEGAL DESCRIPTION**

All that portion of Parcel 2, as said parcel is shown on the map recorded in Book 45, Official Records, at Page 31, in the office of the El Dorado County Recorder, being a portion of the northwest quarter of Section 36, Township 11 North, Range 12 East, M.D.M. unincorporated area of El Dorado County, State of California, and more particularly described as follows:

That certain roadway and Public Utility Easement shown on said map, and labeled as "APPROX. LOCATION 50' WIDE ROADWAY AND PUBLIC UTILITIES EASEMENT. EXACT LOCATION NOT DEFINED PER 1678-OR-490."

See attached Exhibit 'B', attached hereto and made a part hereof.

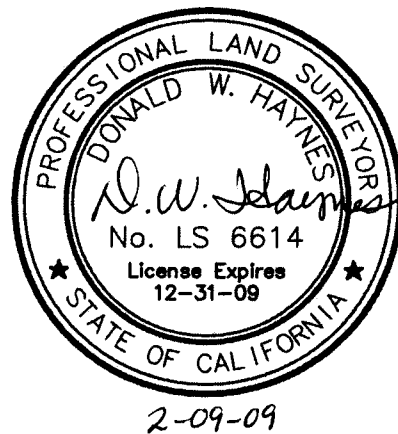

# EXHIBIT 'B'

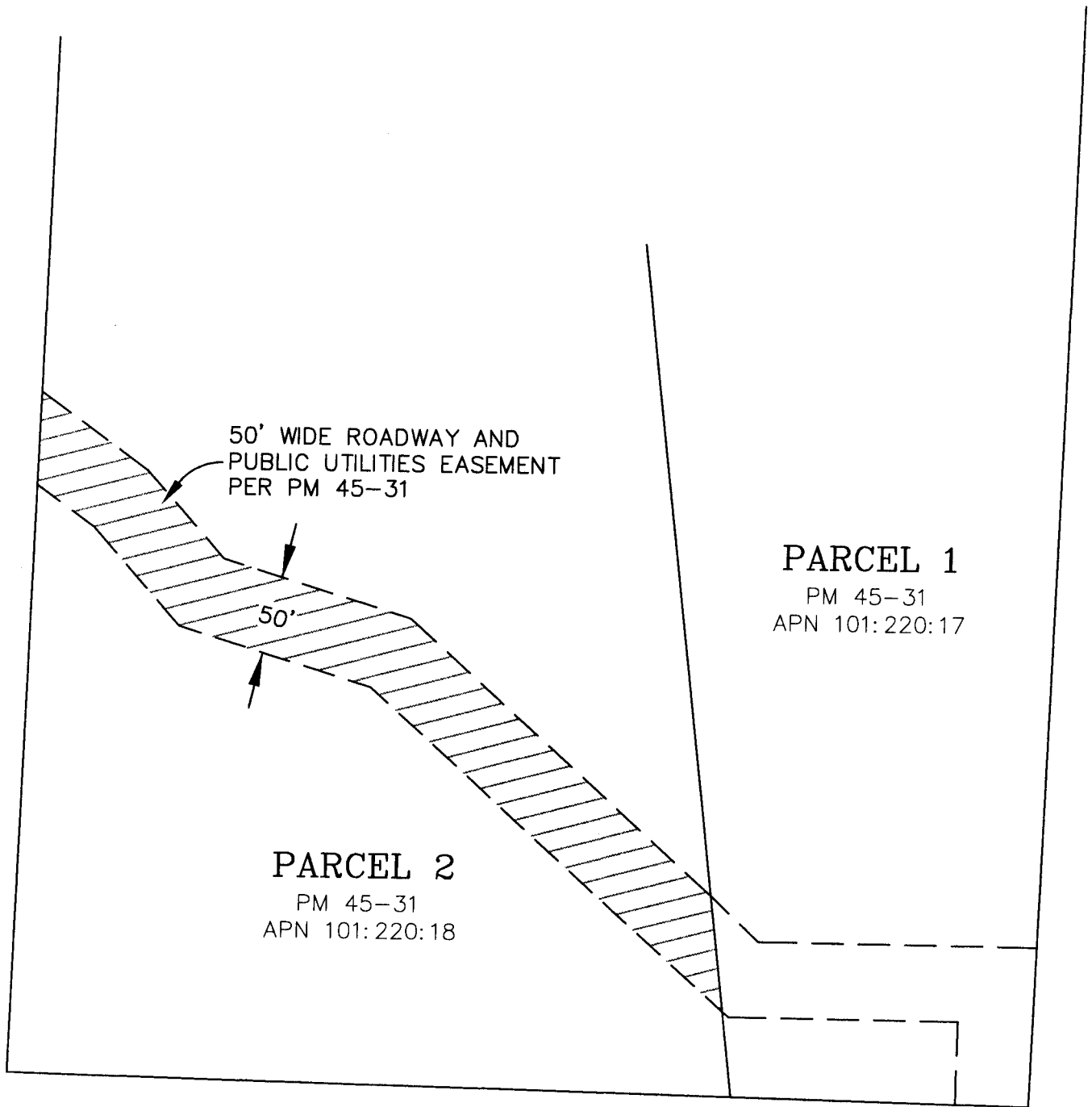

SCALE: 1" = 100'

09-0437.H.3