

#42



LATE DISTRIBUTION

DATE 9/10/2018 BOS 9/11/2018

EDC COB <edc.cob@edcgov.us>

Public Comment: Site 6-Zee Estates S17-0016/AT&T.

1 message

Christina Preston <cpreston@ucdavis.edu>

Fri, Sep 7, 2018 at 11:09 PM

To: edc.cob@edcgov.us

Hello,

I reside on Salmon Falls Rd, Pilot Hill CA 95664. I am writing in support of the cell tower across from Zee Estates. I moved to Pilot Hill two years ago and since then I have had problems with cell phone connectivity on a daily basis. This has been extremely worrying to me since I have had to call in two brush fires and two car crashes while driving on Salmon Falls Rd. My calls are often of poor quality and/or disconnect. I have concerns about bringing my elderly mother to visit the property due to this. In addition to emergency concerns, I have had problematic issues with carrying on day-to-day business. I am in full and complete support of placing a tower at S17-0016/AT&T. It will greatly improve the quality of life in Pilot Hill.

Best Wishes,

Christina Preston
916-579-9990

El Dorado County Board of Supervisors
330 Fair Lane Court
Placerville, CA 95667

September 9, 2018

Reference: Conditional Use Permit for Site 6-Zee Estates S17-0016/AT&T CAF4
Hearing Date: September 11, 2018

Dear Supervisors,

I am writing regarding the conditional use permit for construction and operation of the wireless telecommunication facility at Site 6-Zee Estates. I am the owner of the parcel for which this conditional use permit is being requested and own much of the adjacent property to the north and south that we call the Lotus View Ranch. I am aware that Epic Wireless considered multiple sites in the area, including one other location on my ranch for this project. Ultimately, Epic chose this location for a combination of factors that included; esthetics, safety, proximity to existing power and network, and a broadcast footprint that best serves the community.

After initially being approached by Epic about this facility, I was thrilled at the possibility of getting cell phone and high-speed internet coverage at my ranch — the lack of which has been a source of constant frustration, but I had concerns about the impacts of installing and operating a telecommunication facility on our property. Being an engineer, I spent a great deal of time researching wireless towers and working with Epic to address my concerns about safety, visual impact, noise, power usage, fire suppression, and potential RF hazards. Also, the study conducted by the Planning Department Staff and resulting Mitigated Negative Declaration as well as the Conditions of Approval gave assurance that this project was safe, well thought out, and planned to minimize the impact on neighbors and wildlife. Ultimately, I was satisfied that my concerns were adequately addressed in their design and agreed to the installation at this site, a site which hopefully would minimize impact to our neighbors to the greatest degree possible while still allowing for the technical needs of AT&T.

Whether we agreed to have the tower on our land or not, there was the possibility that a tower would be installed somewhere in the immediate vicinity. By agreeing to host the site I felt that I would at least be able to have some control over its placement as well as to make other requests aimed at minimizing the impact to as many neighbors as possible. The site that was chosen was a compromise that simultaneously met the needs for the AT&T's wireless coverage footprint, was close to necessary utilities (power and fiber), and attempted to minimize visual impact to most of the homes in our community. While it may be difficult to completely hide a transmission tower, by siting it 500 feet away from the main thoroughfare, on a north facing slope that faced the interior of our ranch, hidden in a grove of

trees, and by requiring that the tower be camouflaged, Epic Wireless seems to have minimized the visual impact to the greatest extent possible.

This tower is needed. The Salmon Falls corridor has essentially no wireless connectivity, and internet service is poor or non-existent for all practical purposes. At the same time, the population in the area is rapidly growing as is the traffic along the highway. I believe this tower and the service that it provides will be of great benefit to the community in the form of high speed internet, cell phone service and emergency 911 services. As a consequence of this area becoming more populated and the high levels of traffic along Salmon Falls Road, the risk of accidents and fires is very high. I have witnessed several traffic accidents on Salmon Falls near our property and there have also been four fires within a two-mile radius in the past two years, (all of which required Cal-Fire to bring in planes and helicopters to extinguish). Having a reliable 911 service is essential for dealing with these emergencies.

Our ranch, of which this subject siting parcel is part, comprises nearly 1100 acres of unspoiled land that provides a habitat for wildlife and a buffer from civilization affording peace and quiet to our neighbors, and it offers a place to ride horses, hike, or just be in nature. We have endeavored over the past eight years, in partnership with Cal-Fire and the Department of Agriculture, to restore these historic farm and rangelands to a state that is healthy for the environment and safer for the community by removing ladder fuels, creating access roads, removing noxious vegetation, restoring healthy water ways, etc., all of which benefit our community in one form or another. Opponents of this tower project have cited their appreciation of the "serenity and peacefulness in our wooded hills" and how this tower might spoil that. However, I believe that the serenity and peacefulness of the area is, at least in part, a result of the natural and open space afforded by our ranch. We incur significant costs in holding and maintaining this property in an undeveloped state and the income from this tower, while modest, will help to offset some of the ongoing costs of ownership of our ranch and preserving this "serenity".

Opponents of the tower have also expressed a concern that the access road, Gate Lane, could be made inaccessible in the unlikely event that the tower were to fall. There is a well-maintained, all-season gravel surfaced back road into Gate Lane across our ranch that ends at a gate at the north side of the parcel owned by Robert Sutherland. This road was the original access road to the homes on Gate Lane before Gate Lane was connected to Salmon Falls Road, and it has been in place for many decades. This access route is located at far end of Gate Lane, opposite from Salmon Falls Road. I have attached a map showing the location of the road. Whether the tower is installed or not, our neighbors are welcome to use this route to pass should a fire or tree fall ever block access to Salmon Falls through the normal entrance.

On a personal note, I am a native of this area and have lived within 20 miles of this property for 57 of my 60 years. I have a deep connection with these lands, and grew up exploring its hills, creeks and oak woodlands. While it saddens me at times to witness the development, traffic, and influx of people from the cities; and the resultant need for infrastructure such as wireless towers, there is little that I can do

about the development other than to protect and preserve the land that I am fortunate to be a caretaker of. In offering to host this wireless site, I hope that I have been able to influence the design and siting in such a way as to minimize the impact to the land and our neighbors while creating a benefit in the form of connectivity to the community. Also, I have a home on our ranch property that would benefit greatly from the services provided by this tower.

In summary, this project will make wireless high-speed internet service available to more than 200 existing households in our neighborhood and provide much needed phone and 911 service to the hundreds of vehicles that travel on Salmon Falls Road each day. I urge the Board of Supervisors to allow this permit to proceed as proposed because I feel it is an inevitable infrastructure expansion necessary to support the needs of our community in the 21st century. I believe that Epic Wireless has designed a project that will provide a great benefit to the community, both in safety and convenience, while carefully considering a balance of functionality and esthetics.

Thank you for your consideration; I plan to attend the meeting and would be happy to answer any questions about these comments or our property at that time.

Respectfully,

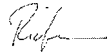
A handwritten signature in black ink, appearing to be the name 'Rufus', written in a cursive style.

Owner, Lotus View Ranch

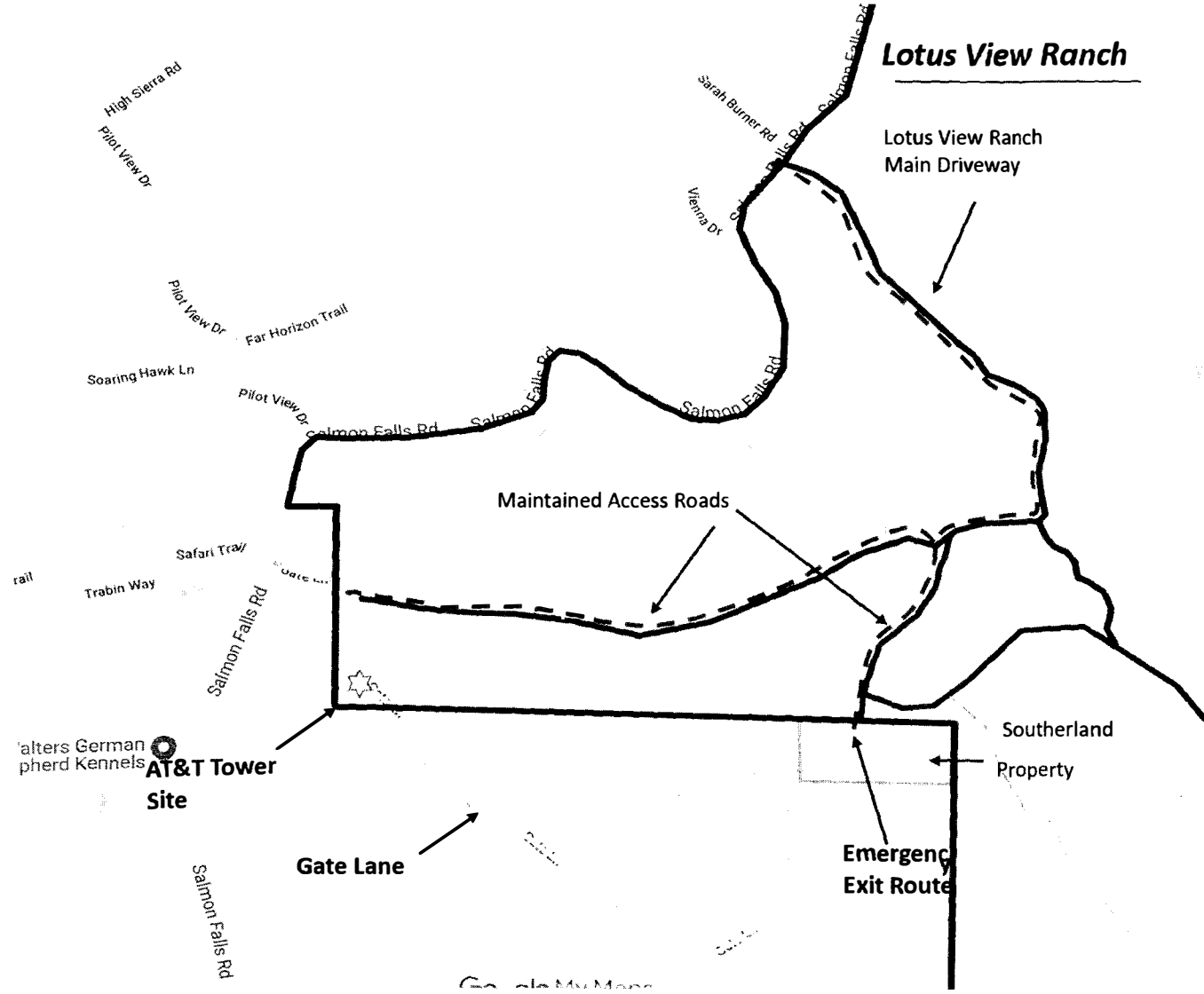

Lotus View Ranch

Lotus View Ranch
Main Driveway

Maintained Access Roads

AT&T Tower
Site

Southerland
Property

Gate Lane

Emergency
Exit Route

Google Maps

9/10/2018

Edcgov.us Mail - Help expand internet access in El Dorado County!



LATE DISTRIBUTION
DATE 9/10/2018

#38, 39, 40, 41, 42, 43

EDC COB <edc.cob@edcgov.us>

Help expand internet access in El Dorado County!

BOS 9/11/2018

1 message

Diana Mittelberger <Diana.Mittelberger.126721010@p2a.co>

Mon, Sep 10, 2018 at 1:03 PM

Reply-To: dmittelberger@gmail.com

To: Clerk of the Board <edc.cob@edcgov.us>

Dear El Dorado County Clerk of the Board,

I am writing in support of the construction of new wireless communications facilities in El Dorado County.

Wireless and high speed broadband has many positive benefits for vital institutions like schools, hospitals and police and fire departments, and residents. New infrastructure delivers community benefits including enhanced public safety, educational access, health care and more.

The approval of this wireless communications facility will help increase network coverage and improve call quality, including emergency response services to improve public safety.

I ask for your support of the proposed new wireless communications facility in El Dorado County.

Regards,

Diana Mittelberger
3820 Cherry Acres Rd
Cool, CA 95614

9/10/2018

Edcgov.us Mail - Help expand internet access in El Dorado County!



EDC COB <edc.cob@edcgov.us>

Help expand internet access in El Dorado County!

1 message

Richard Black <Richard.Black.126768875@p2a.co>

Mon, Sep 10, 2018 at 1:09 PM

Reply-To: rb5232@att.com

To: Clerk of the Board <edc.cob@edcgov.us>

Dear El Dorado County Clerk of the Board,

I am writing in support of the construction of new wireless communications facilities in El Dorado County.

Wireless and high speed broadband has many positive benefits for vital institutions like schools, hospitals and police and fire departments, and residents. New infrastructure delivers community benefits including enhanced public safety, educational access, health care and more.

The approval of this wireless communications facility will help increase network coverage and improve call quality, including emergency response services to improve public safety.

I ask for your support of the proposed new wireless communications facility in El Dorado County.

Regards,

Richard Black
Big Oak Rd
, CA 95667