

INDEX OF SHEETS

SHEET	PLAN SHEET	TITLE
1		TITLE SHEET
2	CD-1	SURVEY AND CONTROL DIAGRAM
3	X-1	TYPICAL SECTIONS
4-5	L-1 THRU L-2	TYPICAL SECTIONS
6	C-1	CONSTRUCTION DETAILS
7	C-2	CONSTRUCTION DETAILS-GUARDRAIL AND FENCING PLAN
8	G-1	GRADING PLAN
9	G-2	ROCK SLOPE PROTECTION
10	G-3	ROCK SLOPE PROTECTION
11-12	D-1 THRU D-2	DRAINAGE PLANS
13-17	SC-1 THRU SC-5	STAGE CONSTRUCTION PLANS
18-19	SPD-1 THRU SPD-2	SIGNING AND PAVEMENT DELINEATION
20-22	TR-1 THRU TR-3	TREE REMOVAL PLAN
23	EC-1	EROSION CONTROL PLAN

STRUCTURE PLANS

24	S-1	GENERAL PLAN
25	S-2	DECK CONTOURS AND INDEX TO PLANS
26	S-3	FOUNDATION PLAN
27	S-4	ABUTMENT 1 LAYOUT
28	S-5	ABUTMENT 2 LAYOUT
29-30	S-6 THRU S-7	ABUTMENT DETAILS
31	S-8	TYPICAL SECTION
32	S-9	GIRDER DETAILS
33	S-10	ANCHORAGE REINFORCEMENT DETAILS
34	S-11	ARCHITECTURAL TREATMENT
35	S-12	STRUCTURE APPROACH TYPE EQ (10)
36	S-13	STRUCTURE APPROACH DRAINAGE DETAILS
37-41	S-14 THRU S-18	LOG OF TEST BORINGS

COUNTY OF EL DORADO, CA  
DEPARTMENT OF TRANSPORTATION

PROJECT PLANS FOR THE CONSTRUCTION OF  
**BASSI RD AT GRANITE CREEK  
BRIDGE REPLACEMENT**

IN THE COUNTY OF EL DORADO, DISTRICT 4  
APPROXIMATELY 1.25 MILES FROM THE HWY 49/LOTUS RD INTERSECTION

To be supplemented with Standard Plans and Specifications dated 2015, including the 2015 Revised Standard Specifications, of the California Department of Transportation, unless otherwise noted.

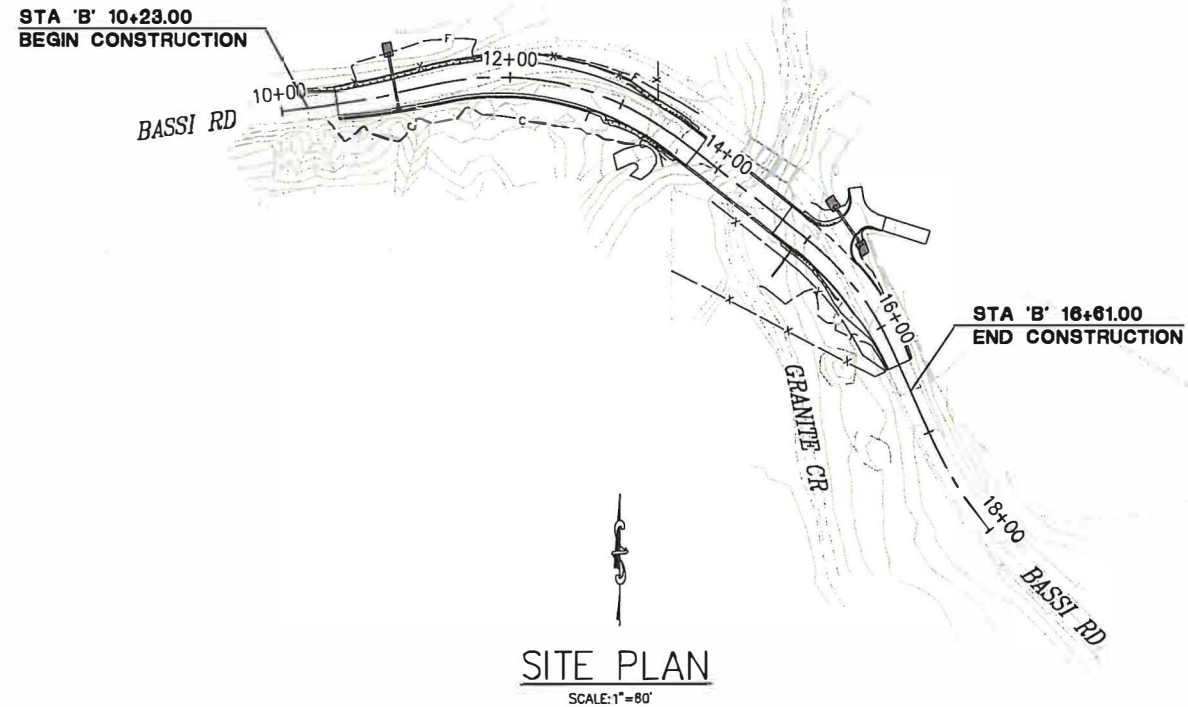
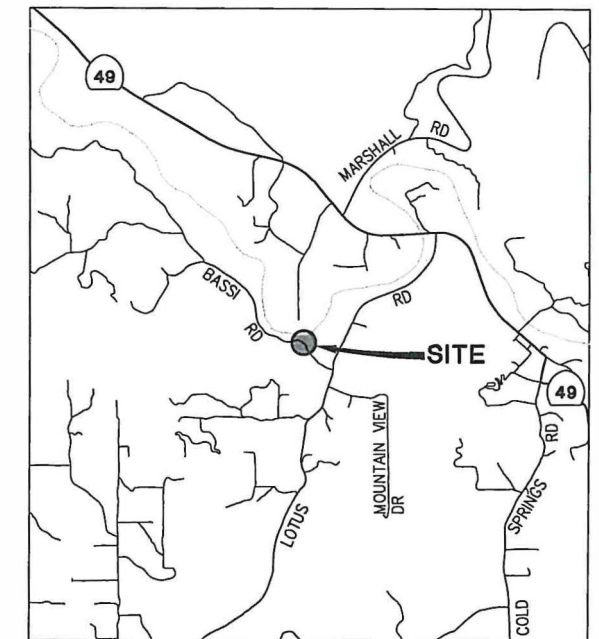
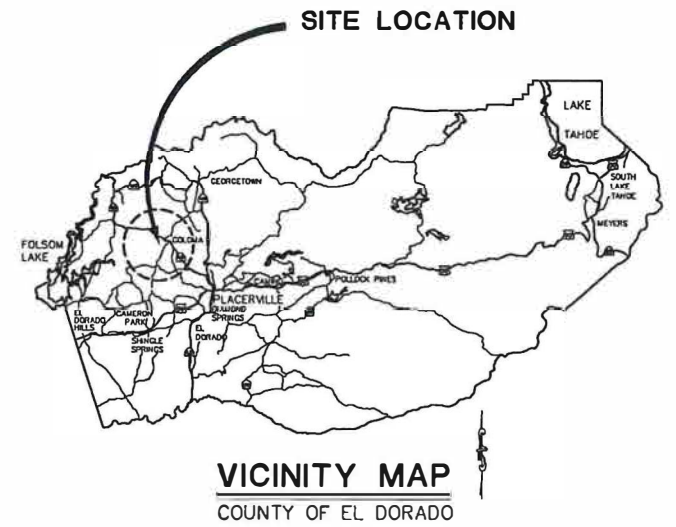

SITE PLAN  
SCALE: 1"=80'

LOCATION MAP  
NOT TO SCALE

FEDERAL AID PROJECT  
BRLO 5925 (094)

CONTRACTOR'S LICENSE CLASSIFICATION: Bidders shall be properly licensed to perform the Work pursuant to the State Contractor's License Act (Business and Professions Code section 7000 et seq.) and shall possess a CLASS A LICENSE or equivalent combination of Classes required by the categories and type of Work included in the Contract Documents and Plans. Failure of the successful Bidder to obtain proper and adequate licensing at the time bids are submitted shall constitute a failure to execute the Contract, and forfeiture as provided under that section.

REVISIONS

MARK	DATE	BY



SUBMITTED BY: *[Signature]*  
CIVIL ENGINEER  
STATE OF CALIFORNIA NO. \_\_\_\_\_  
DATE: 01/29/19

BOARD OF SUPERVISORS  
I JOHN HIDAHL  
II SHIVA FRENTZEN  
III BRIAN VEERKAMP  
IV LORI PARLIN  
V SUE NOVASEL

COUNTY OF EL DORADO  
DEPARTMENT OF TRANSPORTATION  
(530) 621-5900  
2850 FAIRLANE CT  
PLACERVILLE, CA 95667

ADOPTED AND APPROVED BY: *[Signature]* DATE: 1/29/2016  
SUE NOVASEL, CHAIR, EL DORADO COUNTY BOARD OF SUPERVISORS  
APPROVED BY: *[Signature]* DATE: 1/29/19  
RAFAEL MARTINEZ, DIRECTOR, DEPARTMENT OF TRANSPORTATION  
MATTHEW D. SMELTER, P.E. NO. C56603, DEPUTY DIRECTOR, ENGINEERING

CONTRACT NO. 2777 PROJECT NO. 77128  
**BASSI RD AT GRANITE CREEK  
BRIDGE REPLACEMENT**  
TITLE SHEET  
SHEET 1 OF 41