

09-0351  
12-10-09 1

**Notes for 12/8/09 Discussion of Line of Sight Problems on Sierrama Dr. and Rezoning of Z08-0026**

**Good afternoon. My name is John Fleischmann I am pleased to talk to you about line of sight problems on Sierrama Dr. and why we believe it should delay the rezoning Z08-0026 until this is resolved.**

**My wife Anne, and I accept the infill rezoning of this subject parcel, contingent on the developer's providing mitigating improvements to make Sierrama Drive safer for the added traffic. This 5 acre parcel shown in blue on figure 1 of my letters of 12/1/09 and 12/2/09 is the last large parcel on Sierrama Dr. This rezoning will add five extra households on the relatively narrow and curved Sierrama Dr., which is shown in yellow on Figure 1. These 5 extra households will add at least 20 extra trips per day. The added traffic makes it imperative that the road be improved, before this rezoning is finalized.**

**Sierrama Dr. is generally a 20 ft. wide road on a 60 foot right of way. The road has been maintained by the neighbors through the Sierrama Dr Road Association since 1982. It is posted for a speed limit of 15 mph. By DOT recommendations the road should have a line of sight of 150 ft. The road is built on 60 ft. wide parcels that are separate from the numbers shown on figure 1.**

**From discussion that I had last week with Mr. Jonathon Fong and Ms. Claudia Wade, the action required may vary from one section of the road to another section as described in the following paragraphs A, B, C and D.**

**A.) The area that needs improvement as marked by the northern most arrow on figure 1, is the on site improvements on the east and west side of Sierrama Dr. Please confirm that both sides will have the line of sight when traveling north and south equal to the desirable 150 ft.**

John Fleischmann  
#65  
12.10.09

**B.) The two arrows shown on figure 1 just to the south of those discussed in A, indicate that vegetation blocks the view at the curves. These can be improved by cutting back the vegetation at a small cost. The partial blockage of the road view near La Ladera could be improved by cutting back a couple trees and bushes to be able to see cars pulling out of La Ladera. The view blockages from growth on APN 070-180-36 would require more substantial cutting to improve the view from its 20% of the desirable distance, to approach the 150 ft. that DOT recommends. DOT comments are requested.**

**C.) I have recently improved the line of sight from my driveway to the north from 50 ft. to 80 ft. This was partially due to cutting back the shrubs. It can be improved further. This was discussed in my letter of December 1 to Mr. Fong, with figure 2. I have extra copies of this figure 2. Figure 2 shows rocks on the east side of Sierrama Dr. that are colored blue. These rocks are 3 to 5 ft. above the road and 18 inches to 8 ft. from the paved surface. As I was pruning the shrubs in this area, some of the rocks came loose and fell into the ditch. I could not lift the larger rocks. However, regrading could improve the line of sight by removing about 15 rocks and dirt to reduce the 5 ft. height. This would increase the line of sight from about 80 ft. to 100ft. The cost would be about \$1000. We request that the Z08-0026 rezoning be made contingent on the developer doing this work.**

<sup>two</sup> To obtain the 150 ft., line of sight would require the removal of ~~the~~ large boulders that are about 3 ft. high and only <sup>28"</sup>~~18~~ inches from the paved road surface. It is difficult to estimate the cost since the rocks are on top of the 6" water main which could be broken by attempts to remove them. We would appreciate DOT comments on this.

2.) The last area to be discussed is the encroachment of Sierrama Drive to Meder Rd. The line of sight of cars entering Meder Rd. is less than 50 ft. to the east and 150 ft. to the west. Since Meder Rd. has a speed limit of 35 mph the recommended distance is probably 350 ft.

The view to the east is blocked by vegetation on APN 070-062-32. The visibility to the west is limited by changes in elevation of Meder Rd. We believe that DOT should make recommendations of how this should be improved by off site work before the rezoning is approved. I did not include this item in my letter of 12/2/09 because of the different speed limits.

We are quite familiar with the problems at Meder Rd. encroachment since in 1997 El Dorado County made it a requirement for us to pay for the paved radii at this point to be able to obtain a split of our 5 acre parcel into two parcels. This cost us over \$1300. We believe that El Dorado County should follow this precedent before rezoning Z08-0026. The developer will obtain 5 parcels to pay for this work.

3.) We are also interested in knowing the long range plans for Meder Rd. in parts of the two mile section that have not been improved in recent years.

Thank you,



**John Fleischmann**

FIGURE 2

Driveway of  
180-36

4.5 FT

EID WATERBOX

18.5 FT

2.3 FT

REQUESTED REGRADING OF ROAD  
AT APN 070-180-45

TELEPHONE POLE

8 to 10 ft. HIGH ROCKS

Regrade the shoulder for 35 ft,  
remove rocks that block  
the view around the curve

18.5 ft

20 ft

60 FT. R.O.W. OF  
SIERRAMA DR.

24 ft

L.O.S.

22 ft

Driveway of 180-45

Bella Vista Ct.

FIRE HYDRANT

Driveway of 180-37

Joy Lane



Scale 1 in. = 20 ft.

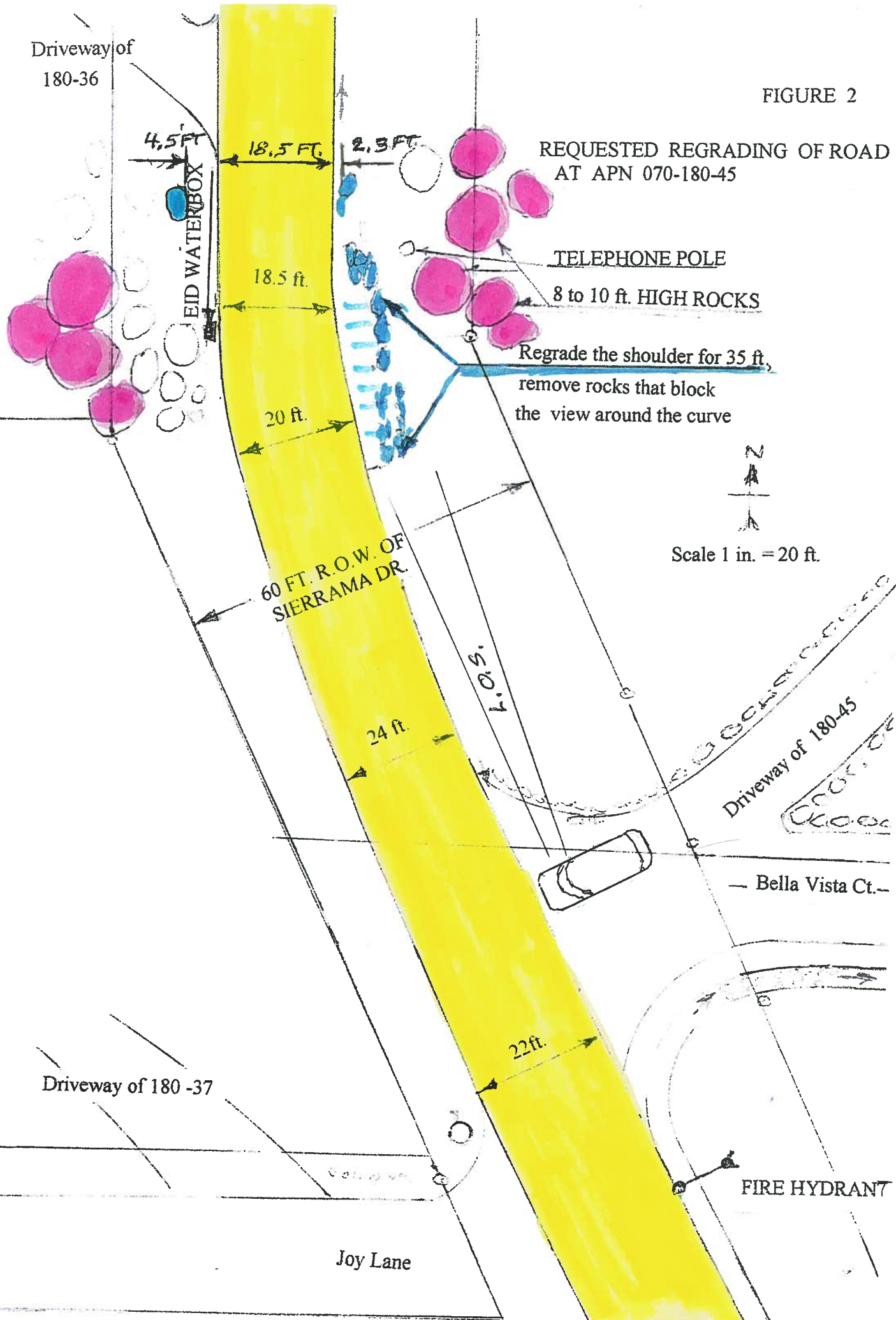

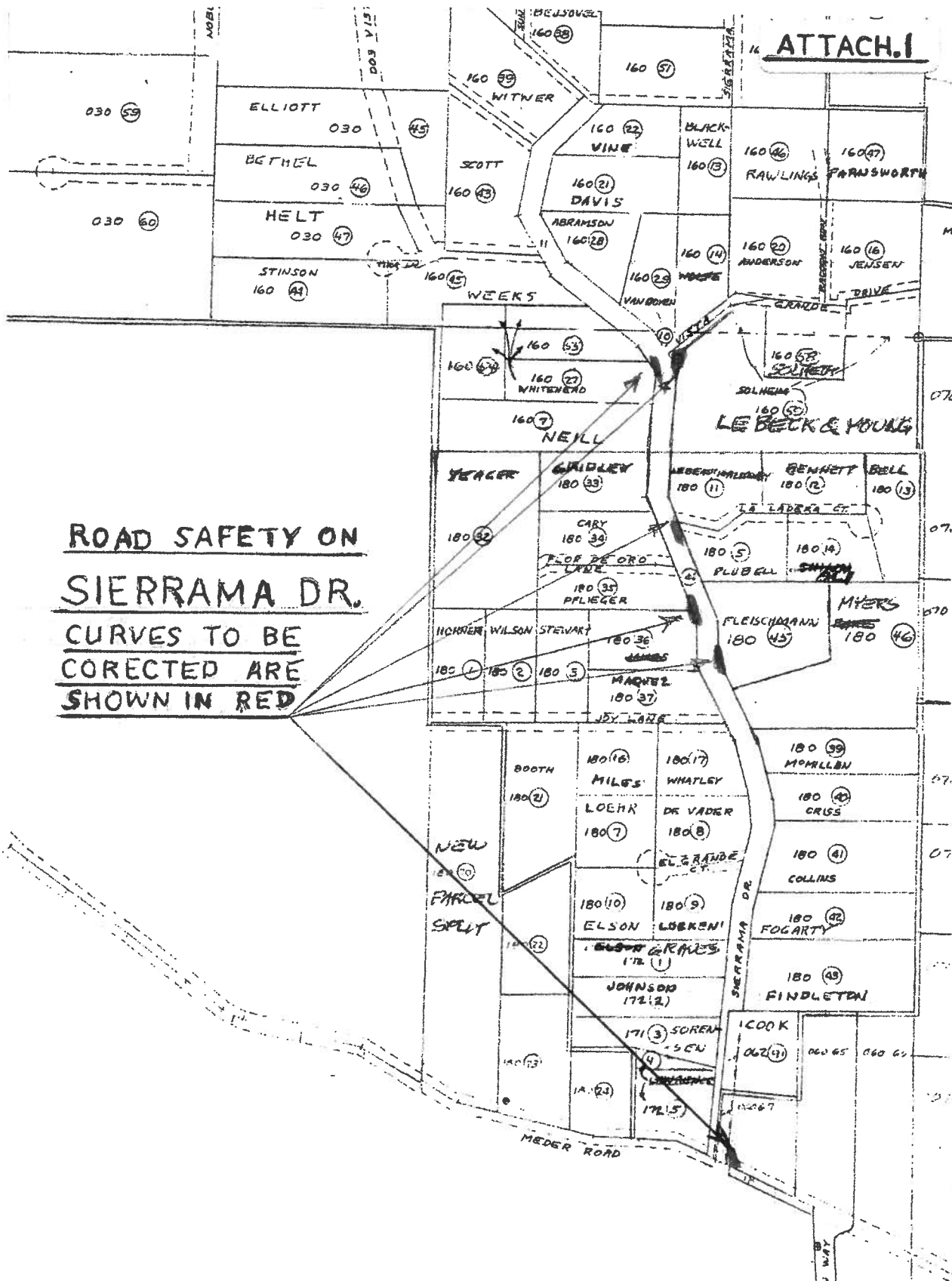

ROAD SAFETY ON  
SIERRAMA DR.  
CURVES TO BE  
CORECTED ARE  
SHOWN IN RED